

| | | | | | | | | |
|------|-------|------------|----|----|----|----|----|----|
| TCP# | 84244 | Start Date | 04 | 18 | 19 | 05 | 03 | 19 |
| TCP# | | Start Date | | | | | | |
| TCP# | | Start Date | | | | | | |

Work Hour: From: 8:30 A.M To 3:30 P.M

Address/Project Street: STONEBRIDGE PKWY.

Address/City, State, Zip: 10641 PROSPECT AVE SANTEE, CA

Contractor/Applicant's Name: DCXCAVATION, INC.

Width/Depth of Trench: -

Approach Speed: 35 MPH

Contractor/Project Street: STONECROFT TERRACE

Cross Street: DOWNING

Sign Spacing: 250'

Telephone: 619.279.0194

Fax:

TRAFFIC CONTROL PLAN/PERMIT
Development Services Department
1222 First Ave. San Diego, CA 92101
(619) 446-5150



THE CITY OF SAN DIEGO

Work Hour: From: 8:30 A.M To 3:30 P.M

Address/Project Street: STONEBRIDGE PKWY.

Address/City, State, Zip: 10641 PROSPECT AVE SANTEE, CA

Contractor/Applicant's Name: DCXCAVATION, INC.

Width/Depth of Trench: -

Approach Speed: 35 MPH

Contractor/Project Street: STONECROFT TERRACE

Cross Street: DOWNING

Sign Spacing: 250'

Telephone: 619.279.0194

Fax:

ACTIVITY TYPE

| | | |
|---|---|--|
| <input type="checkbox"/> STREET CLOSURE | <input type="checkbox"/> SIDEWALK CLOSURE | <input type="checkbox"/> DUMPSTER |
| <input type="checkbox"/> TRAVEL LANE CLOSURE | <input type="checkbox"/> PEDESTRIAN BARRICADE | <input type="checkbox"/> TRENCHING |
| <input type="checkbox"/> TURN LANE CLOSURE | <input type="checkbox"/> DETOUR | <input type="checkbox"/> PARKING METERS |
| <input type="checkbox"/> PARKING LANE CLOSURE | <input type="checkbox"/> FLAGGING | <input type="checkbox"/> FIBER OPTIC |
| <input checked="" type="checkbox"/> BIKE LANE CLOSURE | <input type="checkbox"/> BUS STOPS | <input checked="" type="checkbox"/> IMPROVEMENTS |

STREET CLASSIFICATION

| | |
|---|--|
| <input type="checkbox"/> EXPRESSWAY | <input type="checkbox"/> SIX-LANE PRIMARY ARTERIAL/MAJOR ST. |
| <input type="checkbox"/> FOUR-LANE MAJOR STREET | <input type="checkbox"/> FOUR-LANE COLLECTOR |
| <input type="checkbox"/> THREE-LANE COLLECTOR | <input type="checkbox"/> TWO-LANE COLLECTOR |
| <input type="checkbox"/> CUL-DE-SAC | <input type="checkbox"/> LOCAL RESIDENTIAL |
| <input type="checkbox"/> ALLEY | |

STREET CLASSIFICATION

9. The contractor shall post tow-away/no parking signs twenty-four (24) hours in advance and shall tag the meters (where applicable).

10. Traffic control plans must be submitted in person a minimum of five (5) working days prior to the start of work within the public right-of-way.

11. Extension must be submitted in person **TWO (2) WORKING DAYS IN ADVANCE OF PERMIT EXPIRATION.**

12. Work days are Monday through Friday. No work on Saturdays, Sundays, or holidays unless approved and noted in "comments."

13. Contractor shall contact City Resident Engineer at (619) 627-3200 for inspection of any covered pedestrian walkway during construction of such walkway.

THE CONTRACTOR SHALL NOTIFY ALL AFFECTED AGENCIES 5 WORKING DAYS PRIOR TO STARTING WORK:

POLICE DEPARTMENT DISPATCH (619) 531-2000
FIRE DEPARTMENT DISPATCH (858) 573-1300
ENVIRONMENTAL SERVICES (858) 492-5060
MTS (BUS STOPS) (619) 238-0100 EXT: 6451
MTS (TAXI ZONES)/ MTS (TROLLEY LINES) (619) 235-2644/(619) 595-4960
STREET DIVISION - TRAFFIC SIGNALS (619) 527-7500
UNDERGROUND SERVICE ALERT (800) 422-4133

REQUIREMENTS:

- Traffic control plan shall conform to the latest edition of City of San Diego Standard Drawings, Appendix A; The Manual of Uniform Traffic Control Devices and the California Supplement; and Standard Specifications for Public Works Construction, including Regional Supplement Amendments and City of San Diego Supplement Amendments.
- The contractor is responsible for restoring the road back to satisfactory condition including, but not limited to, paving, striping, markings, and traffic signal loop detectors within five (5) calendar days of completion of work at affected intersection or road segment.
- The City Traffic Engineer reserves the right to observe these traffic control plans in operation and to make any changes as field conditions warrant.
- Trenches shall be backfilled or steel-plated during non-working hours. Steel plates shall have asphaltic concrete berm on all edges. All dirt, dust, and debris shall be removed from street at end of each day and at the end of the job. The street shall be in drivable condition at all times.
- Any work that creates an undue safety risk or creates severe congestion may be shut down by City Traffic Engineers, City Field Inspection, or the Police Department.
- All travel lanes shall be minimum of 12 feet wide, 14 feet adjacent to bike lanes, unless otherwise approved by the City Traffic Engineer.
- Cones and delineators shall have reflectorized sleeves for night work.
- If parking is allowed in advance warning area, advance warning signs shall be mounted on high level devices.

APPLICANT IS RESPONSIBLE FOR FULL AND COMPLETE REPRESENTATION OF THE ACTUAL ROAD CONDITIONS SHOWN ON THIS PLAN INCLUDING, BUT NOT LIMITED TO EXISTING STRIPING, SIGNING, SIDEWALKS, AND BIKE LANES.

PRINTED NAME: BRANDON COATES

PHONE: 619.239.8200

DATE: 03/12/19

SIGNATURE: *Brandon Coates*

AGENT OF CITY TRAFFIC ENGINEER: *MC* DATE: 3/18/19

APPROVED BY: DATE:

AGENT OWNER CONTRACTOR SIGN/BARRICADE CO. OTHERS

COMMENTS: ROAD IMPROVEMENTS PTS#5285 80

Printed on recycled paper. Visit our web site at www.sandiego.gov/development/services.

Upon request, this information is available in alternative formats for persons with disabilities.

DS-269 (03-10)

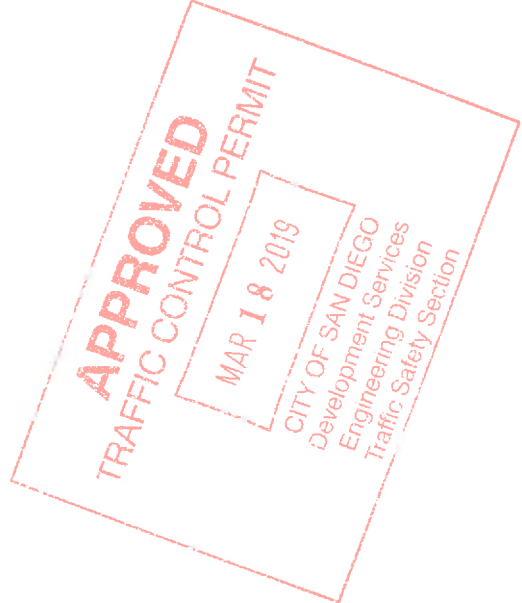
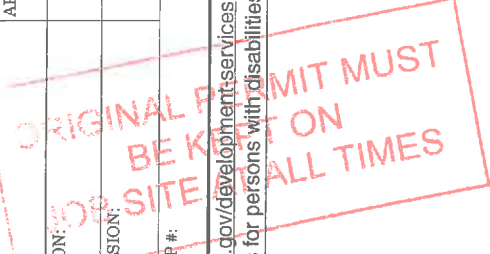

CONSTRUCTION SIGNS:

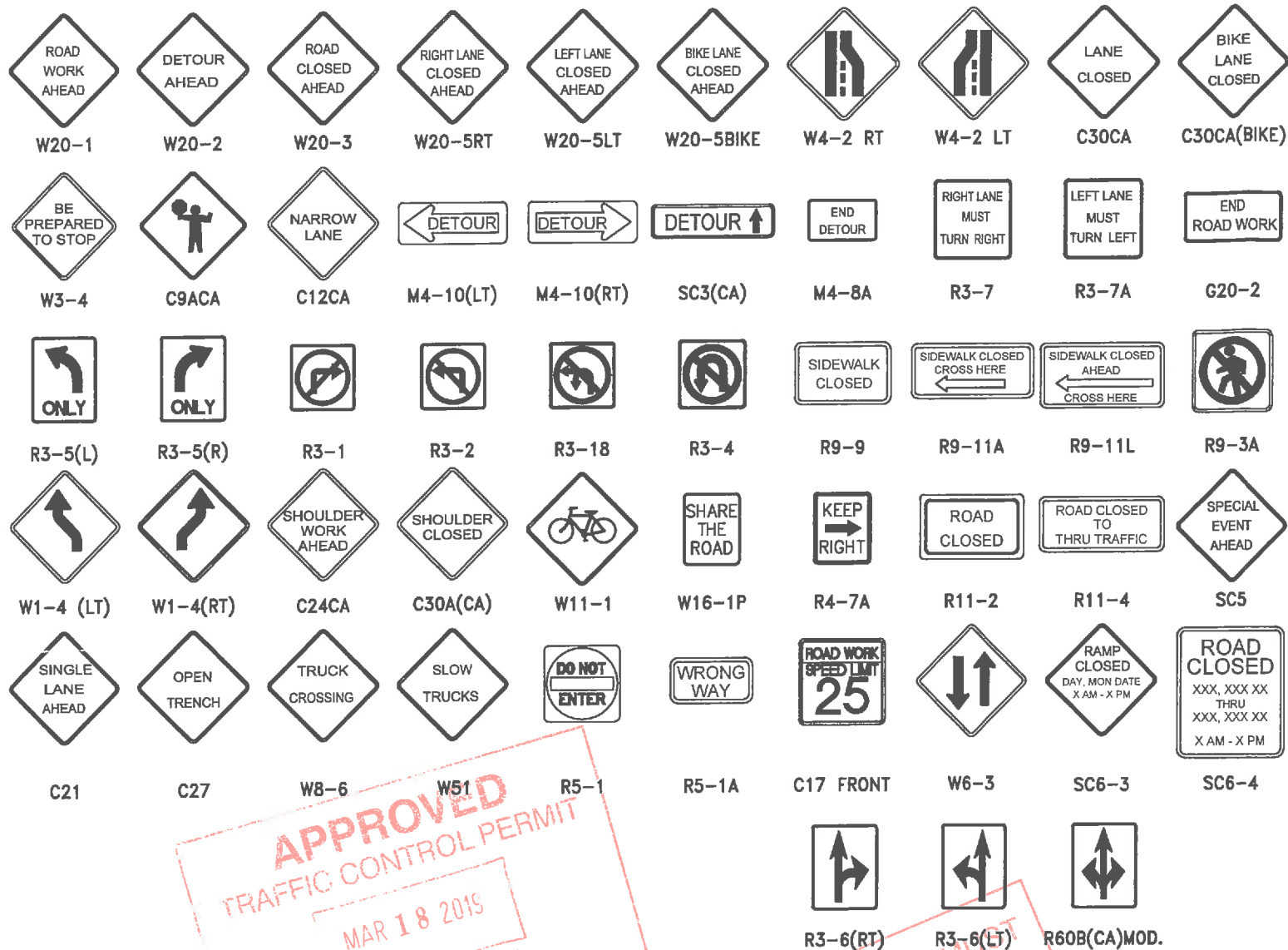

- LEGEND:**
- FLASHING BEACON
 - DIRECTION OF TRAVEL
 - CONE/DELINEATOR
 - BARRICADE
 - FLAGGER
 - SIGN
 - RAILROAD TRACKS
 - FLASHING ARROW SIGN
 - CHANGEABLE MESSAGE SIGN
 - WORK AREA
 - TRAFFIC SIGNAL

APPROVED
 TRAFFIC CONTROL PERMIT
 MAR 18 2015
 CITY OF SAN DIEGO
 Development Services
 Engineering Division
 Traffic Control Section

ORIGINAL PERMIT MUST
 BE KEPT ON
 JOB SITE AT ALL TIMES

TABLE I

RECOMMENDED SIGN SPACING FOR ADVANCE WARNING SIGN SERIES AND MINIMUM TAPER LENGTHS

| APPROACH SPEED (MPH) | MINIMUM DISTANCE IN FEET BETWEEN SIGNS AND FROM LAST SIGN TO TAPER | MAXIMUM DEVICE SPACING IN FEET | MINIMUM TAPER LENGTHS (L) (FEET) | | |
|----------------------|--|--------------------------------|----------------------------------|-------|-------|
| | | | L | 1/2 L | 1/3 L |
| 25 | 100 | 25 | 125 | 65 | 45 |
| 30 | 250 | 30 | 180 | 90 | 60 |
| 35 | 250 | 35 | 245 | 125 | 85 |
| 40 | 250 | 40 | 320 | 160 | 110 |
| 45 | 350 | 45 | 540 | 270 | 180 |
| 50 | 350 | 50 | 600 | 300 | 200 |
| 55+ | 350 | 50 | 660 | 330 | 220 |

L FOR MERGE TAPER
 1/2 L FOR SHIFT TAPER
 1/3 L FOR SHOULDER TAPER

TABLE 2

RECOMMENDED TAPER LENGTH AND MAXIMUM CHANNELIZER / CONE SPACING

| APPROACH SPEED (MPH) | BUFFER LENGTH (FEET) | MAX CONE SPACING | | |
|----------------------|----------------------|------------------|---------|---------------|
| | | TAPER | TANGENT | CONFLICT (**) |
| 25 | 155 | 25 | 50 | 12 |
| 30 | 200 | 30 | 60 | 15 |
| 35 | 250 | 35 | 70 | 17 |
| 40 | 305 | 40 | 80 | 20 |
| 45 | 360 | 45 | 90 | 22 |
| 50 | 425 | 50 | 100 | 25 |
| 50+ | 495 | 55 | 110 | 27 |

NOTES:
 TAPER FORMULA
 L = S x W FOR SPEEDS > 40 MPH.
 L = W x S² FOR SPEEDS < 40 MPH.
 WHERE:
 L = MINIMUM LENGTH OF TAPER (FEET)
 S = APPROACH SPEED (MPH) = POSTED SPEED LIMIT OF OFF-PEAK 85TH% SPEED PRIOR TO WORK STARTING OR ANTICIPATED OPERATING SPEED
 W = WIDTH OF OFFSET (FEET)

(*) THIS TABLE IS PER 2012 CALIFORNIA MUTCD
 (**) FACING OPPOSING TRAFFIC, ADJACENT TO WORK AREA OF CONFLICTING WITH EXISTING STRIPING

CITY OF SAN DIEGO TRAFFIC CONTROL NOTES:

- VALIDATION: THE TRAFFIC CONTROL PLAN IS NOT VALID UNTIL WORK DATES AND WORK HOURS ARE APPROVED. THE CONTRACTOR SHALL SUBMIT TWO (2) REDUCED COPIES OF TRAFFIC CONTROL PLANS (11"X17") TO THE TRAFFIC CONTROL PERMIT COUNTER, 3RD FLOOR DEVELOPMENT SERVICES CENTER, 1222 FIRST AVENUE, SAN DIEGO. THE CONTRACTOR SHALL OBTAIN A TRAFFIC CONTROL PERMIT A MINIMUM OF TWO (2) WORKING DAYS PRIOR TO STARTING WORK, AND A MINIMUM OF FIVE (5) DAYS IF WORK WILL AFFECT A BUS STOP OR AN EXISTING TRAFFIC SIGNAL, OR IF WORK WILL REQUIRE A ROAD OR ALLEY CLOSURE.
- CONTRACTOR SHALL NOTIFY THE CITY TRAFFIC ENGINEER AT (858) 495-4741 A MINIMUM OF FIVE (5) WORKING DAYS PRIOR TO ANY CONSTRUCTION WORK AFFECTING TRAFFIC SIGNALS.
- STANDARDS: THE TRAFFIC CONTROL PLAN SHALL CONFORM TO THE MOST RECENT ADOPTED EDITION OF EACH OF THE FOLLOWING MANUALS:

| DESCRIPTION | EDITION | DOCUMENT NO. |
|---|---------|---------------|
| STANDARD SPECIFICATIONS FOR PUBLIC WORKS CONSTRUCTION (THE "GREENBOOK") | 2015 | PWPI070116-01 |
| CITY OF SAN DIEGO STANDARD DRAWINGS | 2016 | PWPI070116-03 |
| CALIFORNIA MANUAL ON UNIFORM TRAFFIC CONTROL DEVICES (CA MUTCD) | 2014 | PWPI092816-07 |
- NOTIFICATIONS: THE CONTRACTOR SHALL NOTIFY THE FOLLOWING AGENCIES A MINIMUM OF FIVE (5) WORKING DAYS PRIOR TO ANY EXCAVATION, CONSTRUCTION, OR TRAFFIC CONTROL AFFECTING THE AGENCIES LISTED BELOW:

| AGENCY | NOTIFICATION METHOD | PHONE NUMBER |
|-----------------------------------|---------------------------|--------------------------|
| FIRE DEPARTMENT DISPATCH | (STREET OR ALLEY CLOSURE) | (858) 573-1300 |
| POLICE DEPARTMENT DISPATCH | (STREET OR ALLEY CLOSURE) | (619) 531-2000 |
| ENVIRONMENTAL SERVICES | (REFUSE COLLECTION) | (858) 492-5060 |
| STREET DIVISION | (TRAFFIC SIGNALS) | (619) 527-7500 |
| METROPOLITAN TRANSIT SYSTEM (MTS) | (BUS STOPS) | (619) 238-0100 EXT. 6451 |
| METROPOLITAN TRANSIT SYSTEM (MTS) | (TAXI ZONES) | (619) 235-2644 |
| METROPOLITAN TRANSIT SYSTEM (MTS) | (TROLLEY LINES) | (619) 595-4930 |
| UNDERGROUND SERVICE ALERT | (ANY EXCAVATION) | (800) 422-4133 |

THE CONTRACTOR SHALL NOTIFY PROPERTY OWNERS AND TENANTS A MINIMUM OF FIVE (5) WORKING DAYS PRIOR TO CLOSURE OF DRIVEWAYS. THE CONTRACTOR SHALL POST SIGNS NOTIFYING THE PUBLIC A MINIMUM OF FIVE (5) WORKING DAYS PRIOR TO CLOSURE OF STREETS.

THE CONTRACTOR SHALL NOTIFY ENGINEERING FIELD DIVISION AT (858) 627-3200 AND ARRANGE FOR INSPECTION A MINIMUM OF FIVE (5) WORKING DAYS PRIOR TO STARTING ANY WORK INVOLVING NIGHTTIME OR WEEKEND HOURS.
- POSTING PARKING RESTRICTIONS: THE CONTRACTOR SHALL POST TOW-AWAY/NO PARKING SIGNS TWENTY-FOUR (24) HOURS IN ADVANCE OF PARKING REMOVAL. SIGNS SHALL INDICATE SPECIFIC DAYS, DATES, AND TIMES OF RESTRICTIONS. PARKING METERS SHALL BE BAGGED WHERE APPLICABLE.
- EXCAVATIONS: EXCEPT WHEN OTHERWISE SHOWN ON THE PLANS, ALL TRENCHES SHALL BE BACKFILLED OR TRENCH-PLATED AT THE END OF EACH WORKDAY. AN ASPHALT RAMP SHALL BE PLACED AROUND EACH TRENCH PLATE TO PREVENT THE PLATE FROM BEING DISLODGED. CONTRACTOR SHALL MONITOR TRENCH PLATES DURING NON-WORKING HOURS TO ENSURE THAT THEY DO NOT BECOME DISLODGED. UPON COMPLETION OF EXCAVATION BACKFILL, THE CONTRACTOR SHALL PROVIDE A SATISFACTORY SURFACE FOR TRAFFIC. WHEN CONSTRUCTION OPERATIONS ARE NOT ACTIVELY IN PROGRESS, THE CONTRACTOR SHALL MAINTAIN ALL TRAVEL LANES, BIKE LANES, AND PEDESTRIAN WALKWAYS IN THE RIGHT-OF-WAY EXCEPT WHEN OTHERWISE SHOWN ON THE PLANS.
- COVERED PEDESTRIAN WALKWAY: THE CONTRACTOR SHALL CONTACT THE CITY RESIDENT ENGINEER AT (619) 627-3200 FOR INSPECTION OF ANY COVERED PEDESTRIAN WALKWAY DURING CONSTRUCTION OF SUCH WALKWAY.
- RESTORATION OF ROADWAY: THE CONTRACTOR SHALL REPAIR OR REPLACE ALL EXISTING IMPROVEMENTS WITHIN RIGHT-OF-WAY NOT DESIGNATED FOR PERMANENT REMOVAL (TRAFFIC SIGNS, STRIPING, PAVEMENT MARKERS, PAVEMENT MARKINGS, LEGENDS, CURB MARKINGS, LOOP DETECTORS, TRAFFIC SIGNAL EQUIPMENT, ETC.) WHICH ARE DAMAGED OR REMOVED AS A RESULT OF OPERATIONS. REPAIRS AND REPLACEMENTS SHALL BE AT LEAST EQUAL TO EXISTING IMPROVEMENT.
- CHANGE IN WORK: THE CITY ENGINEER RESERVES THE RIGHT TO OBSERVE THESE TRAFFIC CONTROL PLANS IN OPERATION AND TO MAKE ANY CHANGES AS HELD CONDITIONS WARRANT. ANY CHANGES SHALL BE DOCUMENTED AND SUPERCEDE THESE PLANS.

TRAFFIC CONTROL PLANS

CO's

TRAFFIC CONTROL, INC.

LIC# 818076

1221 S. 26TH ST
 SAN DIEGO, CA 92113
 OFFICE: (858) 259-0300
 FAX: (858) 259-0357

MAILING ADDRESS:
 P.O. BOX 13459
 SAN DIEGO, CA 92170

STONEBRIDGE PKWY & GREENSTONE CT

30' 60' 1" = 60' 120'

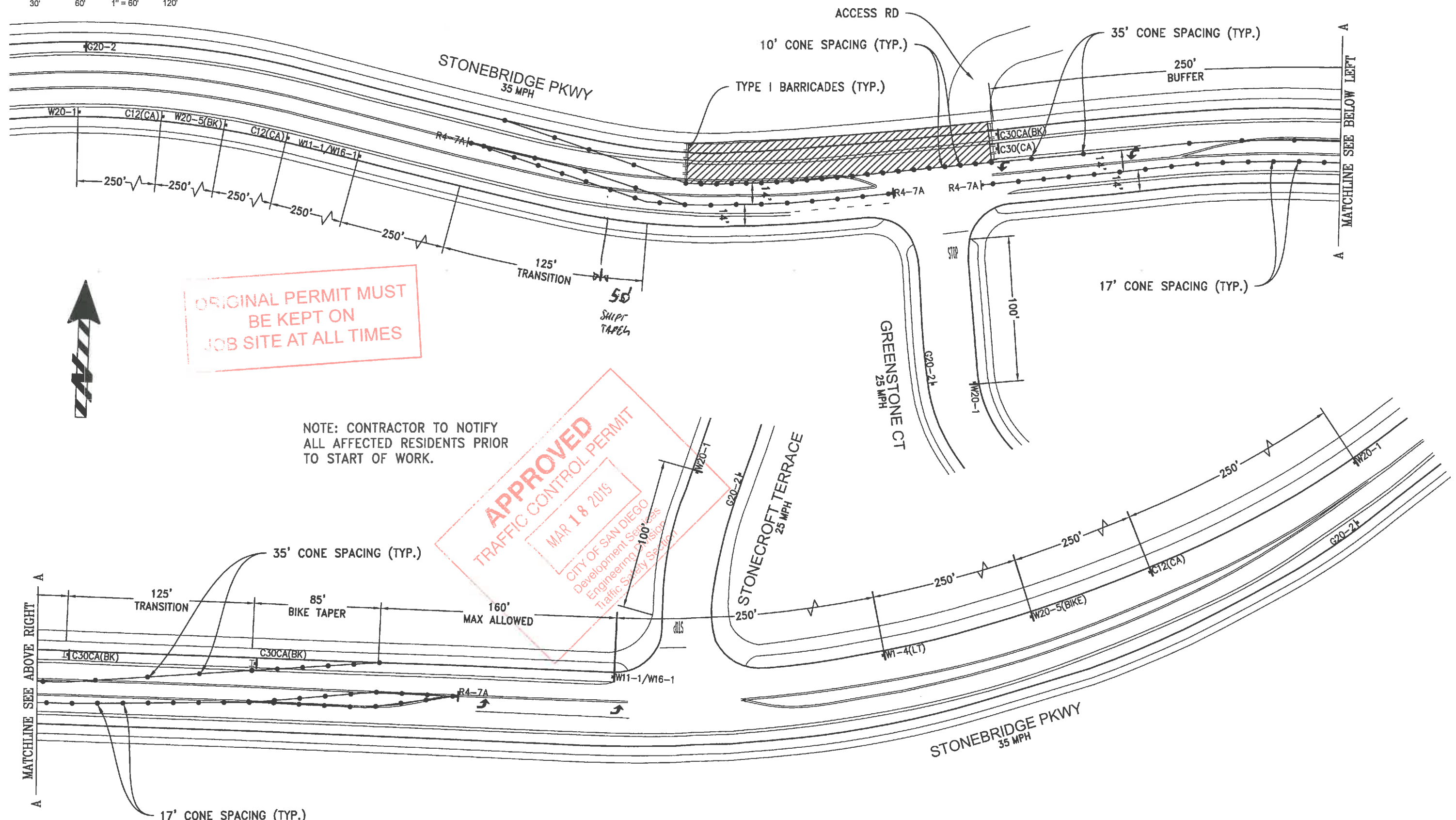

ORIGINAL PERMIT MUST BE KEPT ON JOB SITE AT ALL TIMES

NOTE: CONTRACTOR TO NOTIFY ALL AFFECTED RESIDENTS PRIOR TO START OF WORK.

APPROVED
TRAFFIC CONTROL PERMIT
 MAR 18 2019
 CITY OF SAN DIEGO
 Development Services
 Engineering Division
 Traffic Safety Section

CO's
TRAFFIC CONTROL, INC.
 LIC# 818076

1221 S. 26TH ST
 SAN DIEGO, CA 92113
 OFFICE: (858) 259-0300
 FAX: (858) 259-0357

| | |
|--------------------------|-----|
| POSTED SPEED LIMIT (MPH) | 35 |
| SIGN SPACING (FEET) | 250 |
| TAPER LENGTH (FEET) | 245 |
| CONE SPACING (FEET) | 35 |

JAVIER VAZQUEZ JR
 DRAWN BY:
 PROJECT NUMBER:
 March 18, 2019
 DATE:

| | |
|---------------------|--------------|
| ROAD IMPROVEMENTS | |
| PROJECT INFORMATION | |
| DCXCAVATION INC | |
| COMPANY | |
| VAL CROMWELL | 619.279.0194 |
| PROJECT CONTACT | PHONE |

| | |
|-----------------------|--------------|
| TRAFFIC CONTROL PLANS | |
| CITY OF SAN DIEGO | |
| 1210 - E2 | SHEET 1 OF 1 |