



# Traffic Control Permit (TCP) Multiple Location List

(Franchise Utility Company Only - May Not Be submitted By Contractor)

THE CITY OF SAN DIEGO

**APPROVED**  
TRAFFIC CONTROL PERMIT  
SEP 14 2017  
CITY OF SAN DIEGO  
Development Services  
Engineering Division  
Traffic Safety Section

To: City of San Diego, Traffic Permit Section

Date: 9/13/2017

From: (Company): SDG&E

Phone No.: 619-778-2405

Contact Person: Rod Nelson

Fax.: \_\_\_\_\_

W.O. or Account #: Permit # \_\_\_\_\_

TCP No. \_\_\_\_\_

City Use Only

Authorized # \_\_\_\_\_

By Felipe Ariza

Yes  No \_\_\_\_\_

Date Reviewed 9/13/17

**TYPE OF WORK**

- 1 = Lane Closure
- 2 = Street Closure
- 3 = Sidewalk Closure
- 4 = Alley Closure
- 5 = Parking Lane
- 6 = Detour
- 7 = Trenching
- 8 = Flagging

Location	From	To	Start Date *	End Date *	Work Hours **	Thomas Bros.	Type of Work
Carroll Canyon Road	Scranton Street	Youngstown Way	9/17/17	10/6/17	9:00PM - 5:00AM	1208-D7, E7, F7	1,5,7,8
Scranton Road	Carroll Canyon Road	Mira Mesa Blvd	9/17/17	10/6/17	9:00PM - 5:00AM	1208-E7	8
Younstown Way	Carroll Canyon Road	Oberlin Drive	9/17/17	10/6/17	9:00PM - 5:00AM	1208-F7	8

**ORIGINAL PERMIT MUST BE KEPT ON JOB SITE ALL TIMES**

**Comments:** Trenching crew - Phases 1 and Caltrans Phases C-1 through C-4 - Sunday through Thursday night work, 9pm - 5am

Must be submitted a minimum of 2 working days prior to start of work. All columns must be filled out for proper authorization

Fax or mail to: City of San Diego • Traffic Control Permit Section • 1222 First Avenue, MS 501 • San Diego, CA 92101. Fax (619) 446-5489 Office (619) 446-5150

\* Work Days: Monday Through Friday \*\* Work Hours : 8:30 AM - 3:30PM. Unless other hours are preapproved)

No Work on Saturdays, Sundays, or Holidays Unless Approved and Noted In Comments

Minimum of 5 working days required for construction work which affects traffic signal e-mail info to: [jvaca@sandiego.gov](mailto:jvaca@sandiego.gov)

**ATTENTION UTILITY COMPANY**

Special Inspection Fees May Be Applied By City of San Diego For Any Night or Weekend Work.

**SIGN LEGEND**

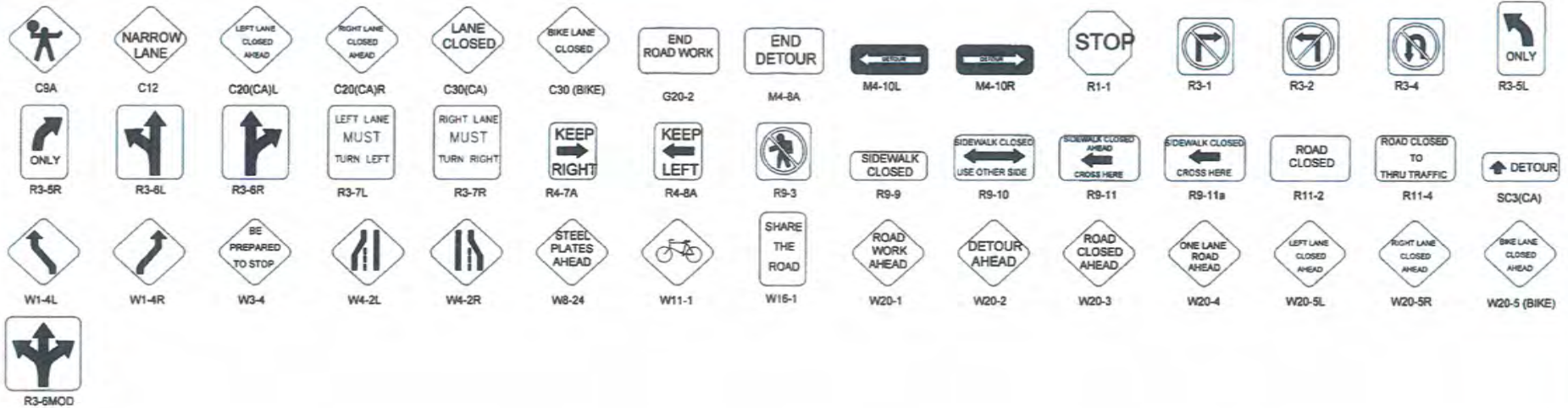

APPROACH SPEED (MPH)	MINIMUM DISTANCE (FEET) BETWEEN SIGNS AND FROM LAST SIGN TO TAPER	MINIMUM TAPER LENGTHS (L) (FEET) FOR 12-FOOT LANE			BUFFER LENGTH (FEET)	MAX CONE SPACING		
		L	1/2L	1/3L		TAPER	TANGENT	CONFLICT
25	100	125	65	45	155	25	50	12
30	250	180	90	60	200	30	60	15
35	250	245	125	85	250	35	70	17
40	250	320	160	110	305	40	80	20
45	350	540	270	180	360	45	90	22
50	350	600	300	200	425	50	100	25
55+	350	660	330	220	495	55	110	27

**LEGEND**

- APPROXIMATE POTHOLE LOCATION
- SIGN
- TRAFFIC CONES / DELINEATOR
- BARRICADE
- FLAGGER
- FLASHING ARROW SIGN
- WORK ZONE
- CONSTRUCTION VEHICLE
- BUS STOP

APPROVED  
 TRAFFIC CONTROL PERMIT  
 SEP 14 2017  
 CITY OF SAN DIEGO  
 Development Services  
 Engineering Division  
 Traffic Safety Section

ORIGINAL PERMIT MUST  
 BE KEPT  
 ON JOB SITE ALL TIMES

**AIRX** SURVEYORS, INC.  
 Gail McMorrin  
 President  
 2534 EAST EL NORTE PARKWAY, SUITE C  
 ESCONDIDO, CA 92027  
 PHONE: (760) 480-2347  
 CELL: (760) 419-3736

<b>PROJECT NAME:</b> TL23071 – Sycamore Canyon Substation To Penasquitos Substation – 230 KV Underground		<b>DATE:</b> Mar 2, 2017
<b>AIRX JOB#:</b> X160218	<b>THOMAS GRID#:</b> –	<b>DESIGNED BY:</b> Clint Jones
<b>TYPE OF WORK:</b> TRENCHING / CONDUIT		<b>DRAWN FOR:</b> SAN DIEGO COUNTY
<b>MISC/POTHOLES#:</b>		<b>SHEET 1 OF 4</b>





**ORIGINAL PERMIT MUST BE KEPT ON JOB SITE ALL TIMES**

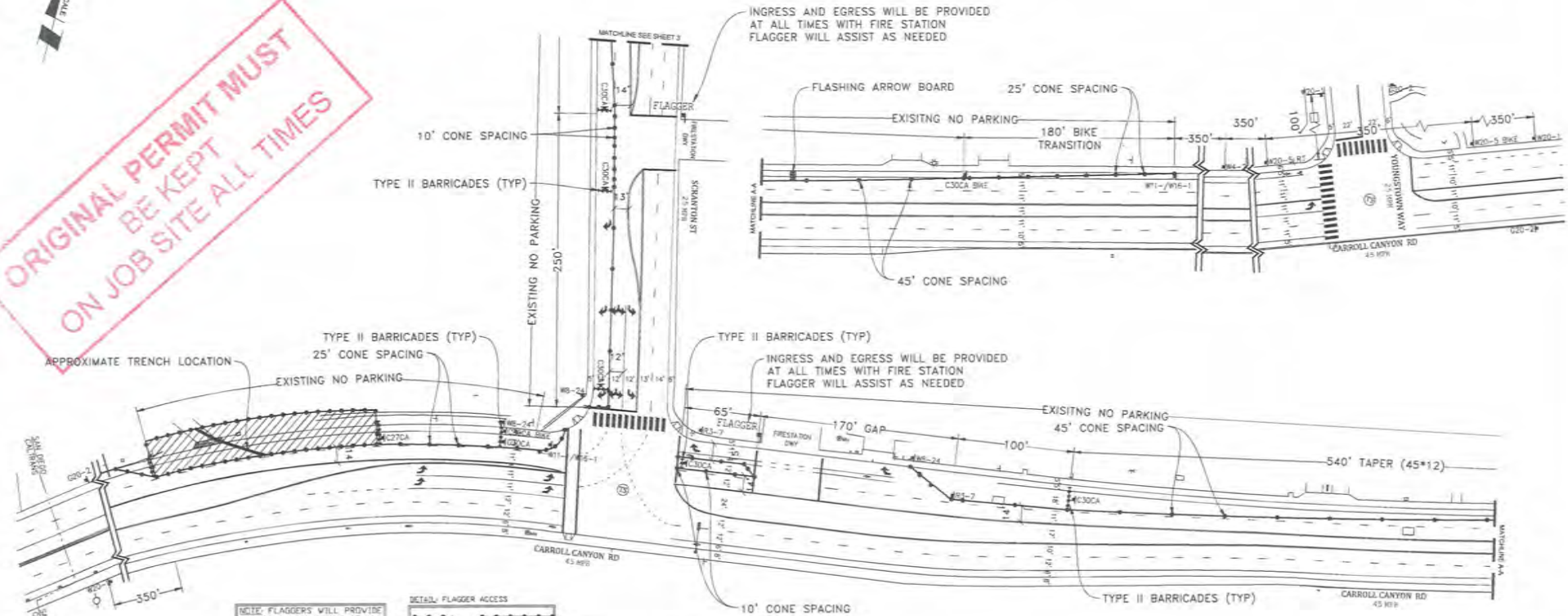

NOTE: FLAGGERS WILL PROVIDE ACCESS TO DRIVEWAYS AT ALL TIMES

NOTE: FLAGGERS WILL SAFELY GUIDE PEDESTRIANS THROUGH WORK AREA

NOTE: CONTRACTOR WILL ALLOW FIRE STATION INGRESS AND EGRESS AT ALL TIMES

NOTE: 18"-24" STEEL PLATES AHEAD SIGNS WILL REMAIN IN PLACE FOR DURATION OF WORK

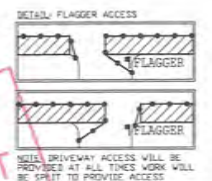

NOTE: CONTRACTOR WILL COORDINATE ALL WORK WITH FIRE STATION PRIOR TO START OF WORK

NOTE: CONTRACTOR WILL COORDINATE ALL WORK WITH TRANSIT DEPARTMENT 5 DAYS PRIOR TO START OF WORK

NOTE: CONTRACTOR WILL COORDINATE ALL WORK WITH EXISTING PROJECTS AND NOT CONFLICT WITH EXISTING TRAFFIC CONTROL

NOTE: CONTRACTOR WILL COORDINATE ALL WORK WITH RESIDENTS PRIOR TO START OF WORK

NOTE: CONTRACTOR WILL COORDINATE ALL WORK WITH BUSINESSES PRIOR TO START OF WORK

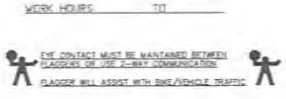

- LEGEND**
- SIGN
  - SIGNAL
  - TRAFFIC CONES / DELINEATOR
  - BARRICADE
  - FLAGGER
  - FLASHING ARROW SIGN
  - WORK ZONE
  - BUS STOP

**APPROVED TRAFFIC CONTROL PERMIT**

**SEP 14 2017**

CITY OF SAN DIEGO  
Development Services  
Engineering Division  
Traffic Safety Section

UTILITY SURVEYORS, INC.

**AIRX**

Gail McMoran  
President

2534 EAST EL NORTE PARKWAY, SUITE C  
SAN DIEGO, CA 92127  
PHONE: (760) 485-0547  
CELL: (760) 419-5728

<b>PROJECT NAME:</b> TL23071 - SYCAMORE CANYON SUBSTATION TO PENASQUITOS - 230 KV UNDERGROUND	
AIRX JOB#: X160218	THOMAS GRID#: -
TYPE OF WORK: TRENCHING / CONDUIT	DRAWN FOR: CITY OF SAN DIEGO
MISC: POTHOLES#	

**PHASE 1**

DATE: Mar. 6, 2017
DESIGNED BY: Clint Jones
<b>SHEET 002 OF 148</b>



**APPROVED**  
TRAFFIC CONTROL PERMIT  
SEP 14 2017

CITY OF SAN DIEGO  
Development Services  
Engineering Division  
Traffic Safety Section

**ORIGINAL PERMIT MUST  
BE KEPT  
ON JOB SITE ALL TIMES**

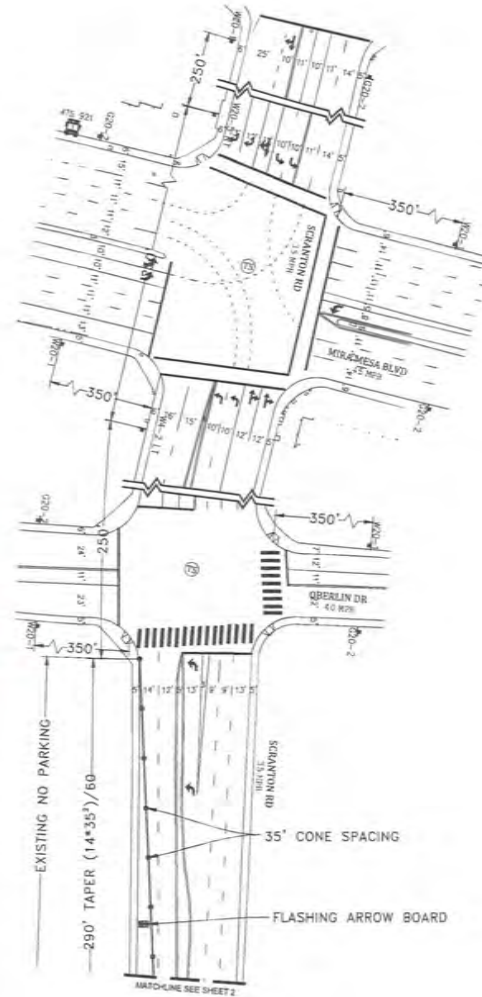

**LEGEND**

- SIGN
- SIGNAL
- TRAFFIC CONES / DELINEATOR
- BARRICADE
- FLAGGER
- FLASHING ARROW SIGN
- WORK ZONE
- BUS STOP

NOTE: CONTRACTOR WILL COORDINATE ALL WORK WITH RESIDENTS PRIOR TO START OF WORK

NOTE: CONTRACTOR WILL COORDINATE ALL WORK WITH BUSINESSES PRIOR TO START OF WORK

NOTE: FLAGGERS WILL PROVIDE ACCESS TO DRIVEWAYS AT ALL TIMES

NOTE: FLAGGERS WILL SAFELY GUIDE PEDESTRIANS THROUGH WORK AREAS

NOTE: CONTRACTOR WILL ALLOW FIRE STATION INGRESS AND EGRESS AT ALL TIMES

NOTE: W8-24 (STEEL PLATES AHEAD) SIGNS WILL REMAIN IN PLACE FOR DURATION OF WORK

NOTE: EYE CONTACT MUST BE MAINTAINED BETWEEN FLAGGERS OR USE 2-WAY COMMUNICATION  
FLAGGER WILL ASSIST WITH BIKES/VEHICLE TRAFFIC

**DETAIL: FLAGGER ACCESS**

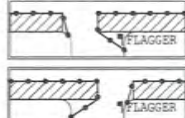

NOTE: DRIVEWAY ACCESS WILL BE PROVIDED AT ALL TIMES WORK WILL BE SPLIT TO PROVIDE ACCESS

NOTE: CONTRACTOR WILL COORDINATE ALL WORK WITH FIRE STATION PRIOR TO START OF WORK

NOTE: CONTRACTOR WILL COORDINATE ALL WORK WITH TRANSIT DEPARTMENT 5 DAYS PRIOR TO START OF WORK

NOTE: CONTRACTOR WILL COORDINATE ALL WORK WITH EXISTING PROJECTS AND NOT CONFLICT WITH EXISTING TRAFFIC CONTROL

WORK HOURS: \_\_\_\_\_ TO \_\_\_\_\_

**PHASE 1 (CONT)**

**AIRX** SURVEYORS, INC.  
Gail McMoran  
President  
2534 EAST EL NORTE PARKWAY, SUITE C  
ESCONDIDO, CA 92027  
PHONE: (760) 440-2547  
CELL: (760) 419-3728

PROJECT NAME: TL23071 - SYCAMORE CANYON SUBSTATION TO PENASQUITOS - 230 KV UNDERGROUND	
AIRX JOB#: X160218	THOMAS GRID#: --
TYPE OF WORK: TRENCHING / CONDUIT	DRAWN FOR: CITY OF SAN DIEGO
MISCPOTHLES#	

DATE: Mar. 6, 2017
DESIGNED BY: Clint Jones
SHEET 003 OF 148



**SIGN LEGEND**



**TABLE 1**

SPEED (S)	TAPER LENGTH CRITERIA AND CHANNELIZING DEVICE SPACING							
	MINIMUM TAPER LENGTH * FOR MOUTH OF OFFSET 12 FEET (W)				MAXIMUM CHANNELIZING DEVICE SPACING			
	TANGENT 2L	MERGING L/2	SHIFTING L/2	SHOULDER L/3	TAPER	TANGENT	CONFLICT	Z **
20	190	80	40	27	28	40	10	
25	250	125	63	42	25	50	12	
30	360	180	90	60	30	60	15	
35	490	245	123	82	35	70	17	
40	640	320	160	107	40	80	20	
45	1080	540	270	180	45	90	22	
50	1200	600	300	200	50	100	25	
55	1320	660	330	220	50	100	25	
60	1440	720	360	240	50	100	25	
65	1560	780	390	260	50	100	25	
70	1680	840	420	280	50	100	25	
75	1800	900	450	300	50	100	25	

\* - For other offsets, use the following merging taper length formula for L:  
 For speed of 40 mph or less, L = 85S/750  
 For speed of 45 mph or more, L = 9S  
 Where: L = Taper length in feet  
 W = Width of offset in feet  
 S = Posted speed (55th, 85th-percentile speed prior to work starting, or the anticipated operating speed in mph)

\*\* - Use for taper and tangent sections where there are no pavement markings or where there is a conflict between existing pavement markings and channelizers (OK)

**TABLE 2**

SPEED *	Min D **	DOWNGRADE Min D ***		
		-3%	-6%	-9%
		ft	ft	ft
20	115	116	120	
25	151	156	173	
30	200	205	217	
35	250	257	271	
40	305	315	333	
45	360	378	400	
50	425	446	474	
55	495	520	553	
60	570	598	638	
65	645	682	728	
70	730	771	825	
75	820	868	927	

\* - Speed is posted speed limit, off-peak 85th-percentile speed prior to work starting, or the anticipated operating speed in mph  
 \*\* - Longitudinal buffer space or flagger station spacing  
 \*\*\* - Use on sustained downgrade steeper than -3 percent and longer than 1 mile.

**TABLE 3**

ROAD TYPE	DISTANCE BETWEEN SIGNS *		
	A	B	C
	ft	ft	ft
URBAN - 25 mph OR LESS	100	100	100
URBAN - MORE THAN 25 mph TO 40 mph	250	250	250
URBAN - MORE THAN 40 mph	350	350	350
RURAL	500	500	500
EXPRESSWAY / FREEWAY	1000	1500	2040

\* - The distances are approximate, are intended for guidance purposes only, and should be applied with engineering judgment. These distances should be adjusted by the Engineer for field conditions, if necessary, by increasing or decreasing the recommended distances.

**LEGEND**

- APPROXIMATE TRENCH LOCATION
- ⬇ SIGN
- TRAFFIC CONES / DELINEATOR
- I BARRICADE
- ⚠ FLAGGER
- ⚡ FLASHING ARROW SIGN
- ▨ WORK ZONE

11176776 0459  
8/16/17

**ORIGINAL PERMIT MUST BE KEPT ON JOB SITE ALL TIMES**

**RECEIVED**  
AUG 16 2017  
CALTRANS-PERMIT

**PROJECT NAME:** TL23071 - Sycamore Canyon Substation To Penasquitos Substation - 230 KV Underground

**AIRX** SURVEYORS, INC.  
Gail McMorran  
President  
2634 EAST EL NORTE PARKWAY SUITE C  
ESCONDIDO, CA 92027  
PHONE: (760) 432-2117  
CELL: (760) 419-9728

**NIV5**  
15092 AVENUE OF SCIENCE, SUITE 200  
SAN DIEGO, CA 92126  
P: 858.385.0500 WWW.NIV5.COM

**AIRX JOB#:** X160218

**MISC/POTHOLE#:**

**TYPE OF WORK:** TRENCHING / CONDUIT

**THOMAS GRID#:** 1208-E7

**DRAWN FOR:** CALTRANS



**DATE:** 7/12/2017  
**DESIGNED:** Clint Jones  
**CHECKED BY:** Mark Webb

**SHEET 1 OF 16**

**ORIGINAL PERMIT MUST BE KEPT ON JOB SITE ALL TIMES**

**APPROVED TRAFFIC CONTROL PERMIT**  
**SEP 14 2017**  
 CITY OF SAN DIEGO  
 Development Services  
 Engineering Division  
 Traffic Safety Section

SCALE 1"=60'

NOTE: W8-24 (STEEL PLATES AHEAD) SIGNS WILL REMAIN IN PLACE FOR DURATION OF WORK

DETOUR MAP (NOT TO SCALE)

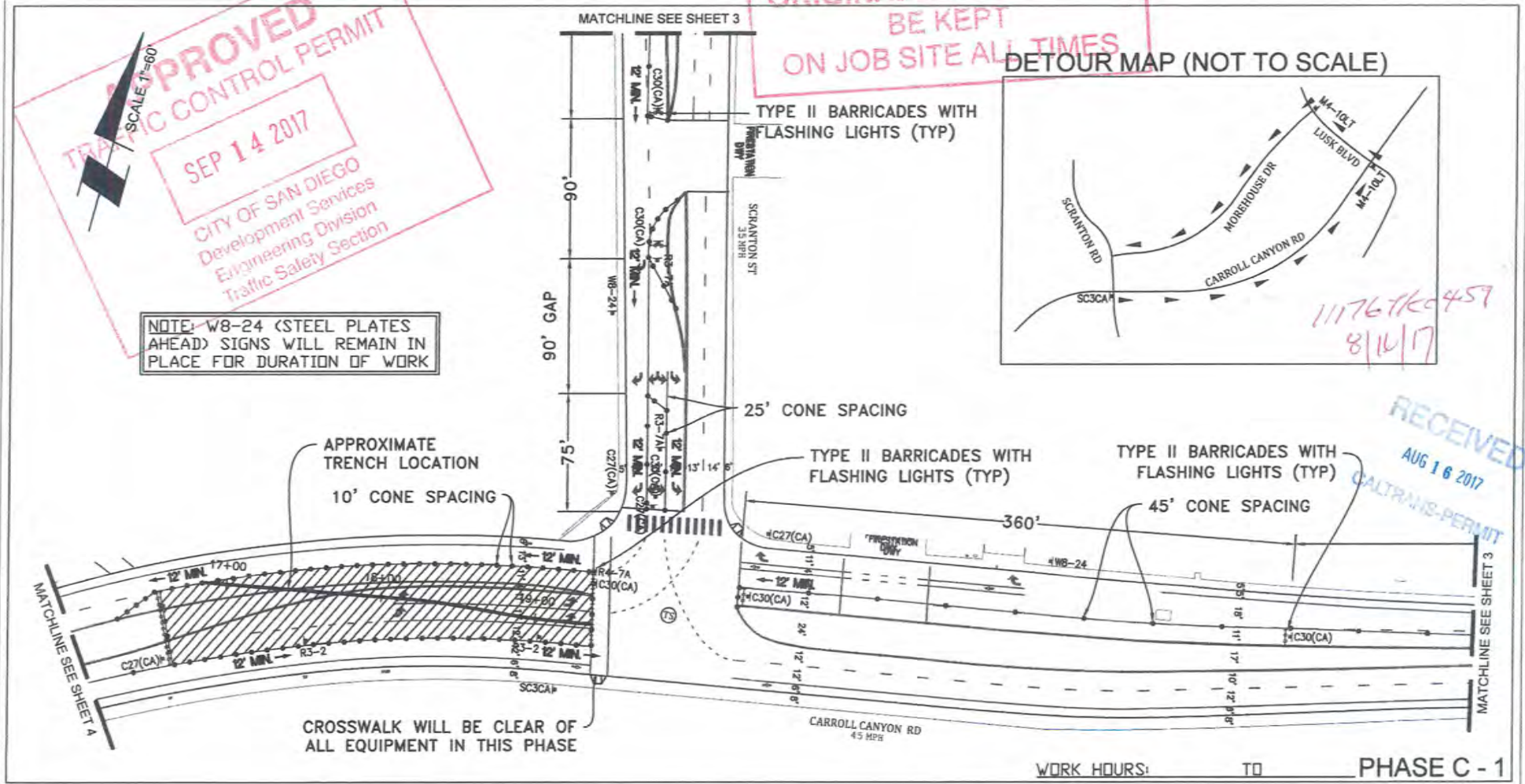
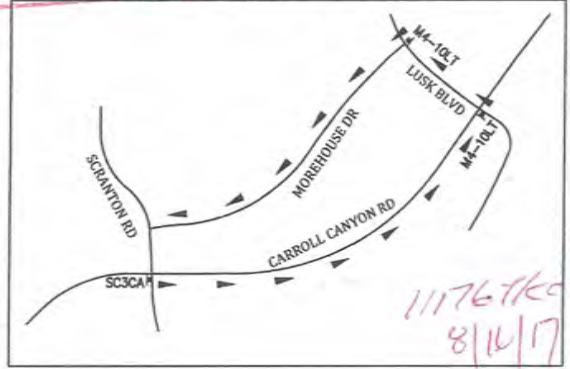

**RECEIVED**  
 AUG 16 2017  
 CALTRANS-PERMIT

WORK HOURS: TO PHASE C - 1

<b>PROJECT NAME:</b> TL23071 - Sycamore Canyon Substation To Penasquitos Substation - 230 KV Underground		<b>DATE:</b> 7/12/2017	
<b>AIRX JOB#:</b> X160218		<b>DESIGNED:</b> Clint Jones	
<b>MISC/POTHOLES#:</b>		<b>CHECKED BY:</b> Mark Webb	
<b>TYPE OF WORK:</b> TRENCHING / CONDUIT		<b>THOMAS GRID#:</b> 1208-E7	
<b>DRAWN FOR:</b> CALTRANS		<b>SHEET 2 OF 16</b>	

**AIRX** SURVEYORS, INC.  
 Gail McMoran  
 President  
 2534 EAST EL NORTE PARKWAY, SUITE C  
 ESCONDIDO, CA 92027  
 PHONE: (760) 485-2147  
 CELL: (760) 433-3238

**N/V/5**  
 15092 AVENUE OF SCIENCE, SUITE 200  
 SAN DIEGO, CA 92128  
 P: 858.385.0500 WWW.NV5.COM

**REGISTERED PROFESSIONAL ENGINEER**  
**MARK H. WEBB**  
 No. 46828  
 CIVIL  
 STATE OF CALIFORNIA



**APPROVED**  
TRAFFIC CONTROL PERMIT  
SEP 14 2017

SCALE 1"=60'  
CITY OF SAN DIEGO  
Development Services  
Engineering Division  
Traffic Safety Section

NOTE: W8-24 (STEEL PLATES AHEAD) SIGNS WILL REMAIN IN PLACE FOR DURATION OF WORK

**ORIGINAL PERMIT MUST BE KEPT ON JOB SITE ALL TIMES**

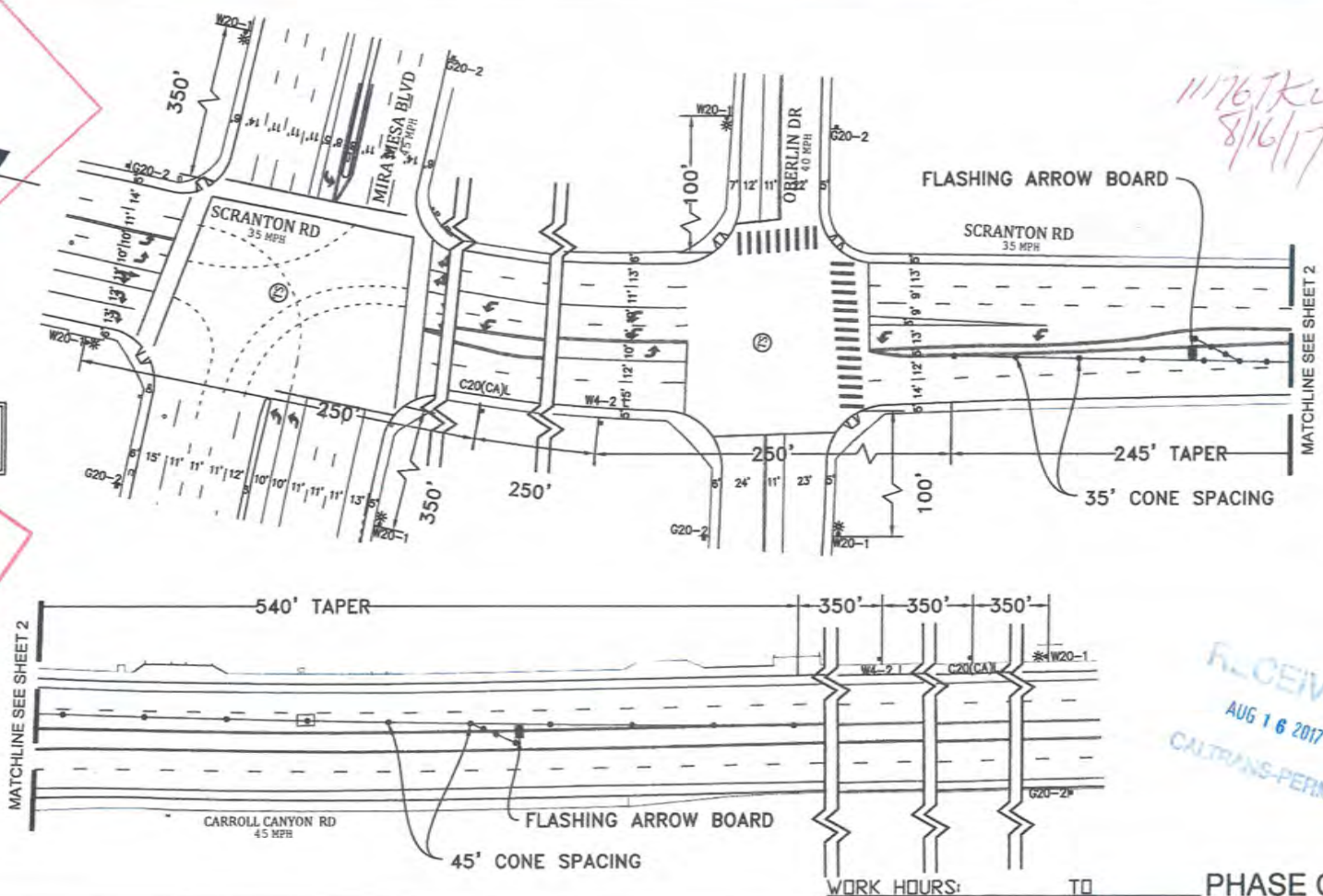

1176 JK 0457  
8/16/17

RECEIVED  
AUG 16 2017  
CALTRANS-PERMIT

WORK HOURS: TO PHASE C - 1

PROJECT NAME: TL23071 - Sycamore Canyon Substation To Penasquitos Substation - 230 KV Underground

DATE: 7/12/2017  
DESIGNED: Clint Jones  
CHECKED BY: Mark Webb

**AIRX** SURVEYORS, INC.  
Gail McMorran  
President  
2324 EAST EL NORTE PARKWAY SUITE C  
ESCONDIDO, CA 92027  
PHONE: (760) 485-2547  
CELL: (760) 419-3738

**N/V/5**  
15092 AVENUE OF SCIENCE, SUITE 200  
SAN DIEGO, CA 92128  
P: 858.385.0500 WWW.NV5.COM

AIRX JOB#: X160218  
MISC/POTHOLES#: \_\_\_\_\_  
TYPE OF WORK: TRENCHING / CONDUIT

THOMAS GRID#: 1208-E  
DRAWN FOR: CALTRANS



SHEET 3 OF 16



**APPROVED**  
TRAFFIC CONTROL PERMIT  
SEP 14 2017

CITY OF SAN DIEGO  
Department of Public Works  
Engineering & Construction Services  
Traffic Engineering

NOTE: W8-24 (STEEL PLATES AHEAD) SIGNS WILL REMAIN IN PLACE FOR DURATION OF WORK

**ORIGINAL PERMIT MUST BE KEPT ON JOB SITE ALL TIMES**

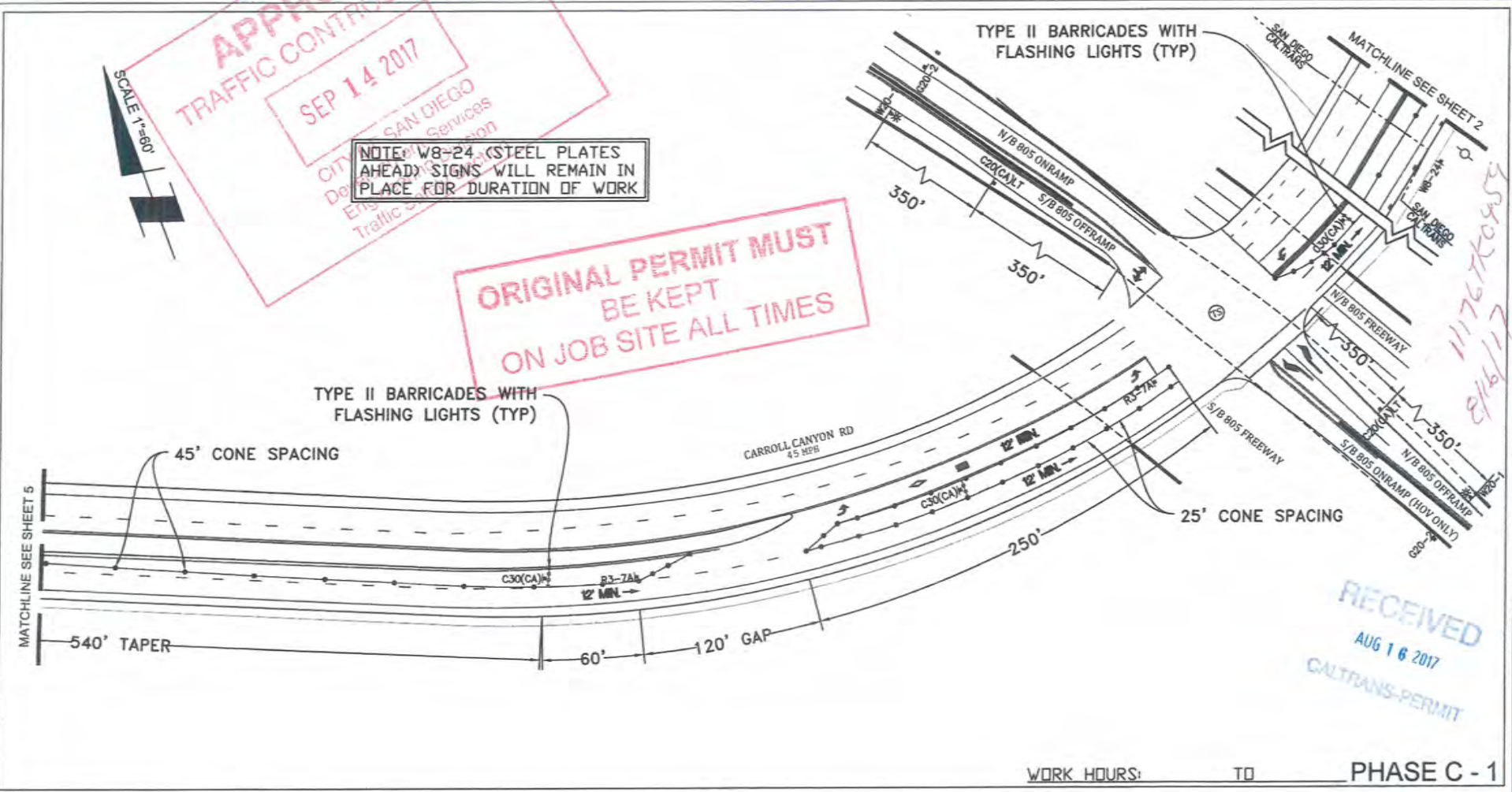

RECEIVED  
AUG 16 2017  
CALTRANS-PERMIT

11176170459  
9/16/17

WORK HOURS: \_\_\_\_\_ TO \_\_\_\_\_ PHASE C - 1

**PROJECT NAME:** TL23071 – Sycamore Canyon Substation To Penasquitos Substation – 230 KV Underground

DATE: 7/12/2017  
DESIGNED: Clint Jones  
CHECKED BY: Mark Webb

**AIRX** SURVEYORS, INC.  
Gail McMorrان  
President  
2534 EAST EL MONTE PARKWAY, SUITE C  
ESCONDIDO, CA 92027  
PHONE: (760) 489-2347  
CELL: (760) 419-3728

NIV5

15092 AVENUE OF SCIENCE, SUITE 200  
SAN DIEGO, CA 92128  
P: 858.385.0500 WWW.NIV5.COM

AIRX JOB#: X160218  
MISC/POTHLES#: \_\_\_\_\_  
TYPE OF WORK: TRENCHING / CONDUIT

THOMAS GRID#: 1208-E7  
DRAWN FOR: CALTRANS



SHEET 4 OF 16



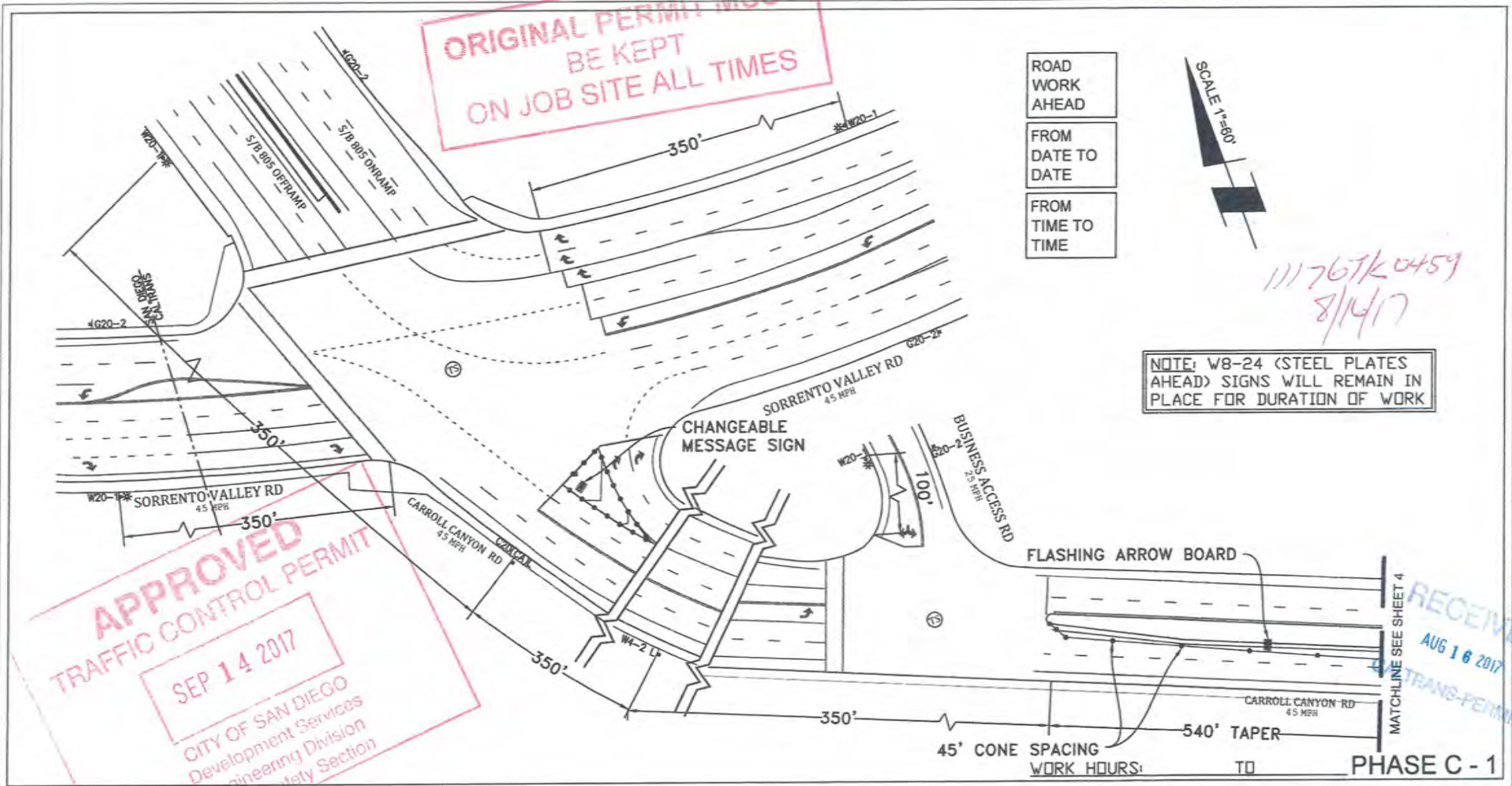

**ORIGINAL PERMIT MUST BE KEPT ON JOB SITE ALL TIMES**

ROAD WORK AHEAD  
FROM DATE TO DATE  
FROM TIME TO TIME



111767K 0459  
8/14/17

NOTE: W8-24 (STEEL PLATES AHEAD) SIGNS WILL REMAIN IN PLACE FOR DURATION OF WORK

**APPROVED**  
TRAFFIC CONTROL PERMIT  
SEP 14 2017  
CITY OF SAN DIEGO  
Development Services  
Engineering Division  
Traffic Safety Section

RECEIVED  
AUG 16 2017  
TRANS-PERMIT

PROJECT NAME: TL23071 - Sycamore Canyon Substation To Penasquitos Substation - 230 KV Underground

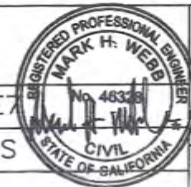

DATE: 7/12/2017  
DESIGNED: Clint Jones  
CHECKED BY: Mark Webb

**AIRX** SURVEYORS, INC.  
Gail McMorran  
President  
7934 EAST EL NORTE PARKWAY, SUITE C  
ESCONDIDO, CA 92027  
PHONE: (760) 489-0247  
CELL: (760) 419-3728

**NV5**  
15092 AVENUE OF SCIENCE, SUITE 200  
SAN DIEGO, CA 92128  
P. 858.385.0500 WWW.NV5.COM

AIRX JOB#: X160218  
MISC/POTHoles#: \_\_\_\_\_  
THOMAS GRID#: 1208-E7  
DRAWN FOR: CALTRANS  
TYPE OF WORK: TRENCHING / CONDUIT

SHEET 5 OF 16

PHASE C - 1



**ORIGINAL PERMIT MUST  
BE KEPT  
ON JOB SITE ALL TIMES**

**APPROVED**  
TRAFFIC CONTROL PERMIT  
**SEP 14 2017**  
CITY OF SAN DIEGO  
Development Services  
Engineering Division  
Traffic Safety Section

NOTE: W8-24 (STEEL PLATES  
AHEAD) SIGNS WILL REMAIN IN  
PLACE FOR DURATION OF WORK

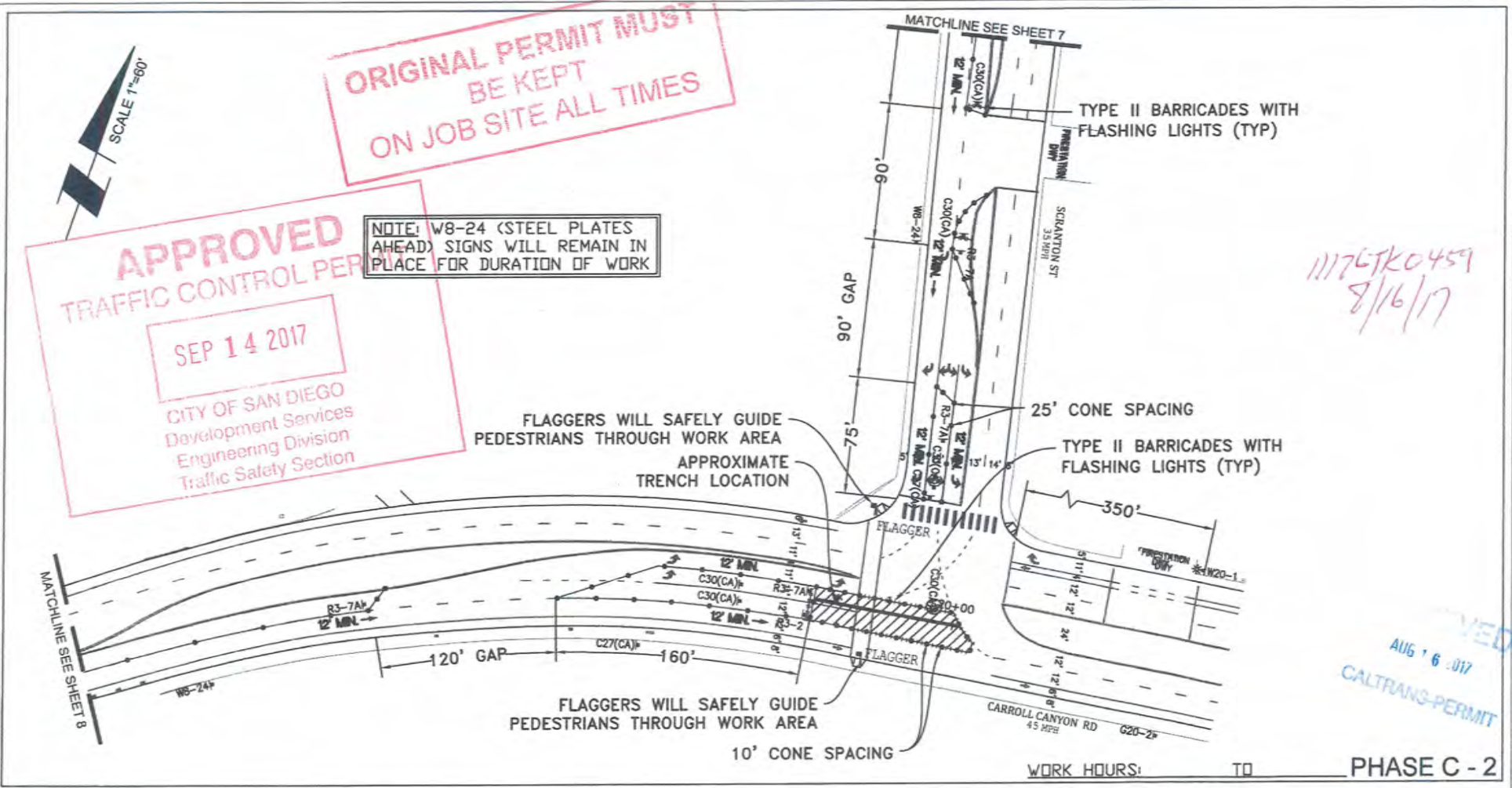

11176JK0459  
8/16/17

APPROVED  
AUG 16 2017  
CALTRANS-PERMIT

WORK HOURS: \_\_\_\_\_ TO \_\_\_\_\_ PHASE C - 2

PROJECT NAME: TL23071 - Sycamore Canyon Substation To  
Penasquitos Substation - 230 KV Underground

DATE: 7/12/2017  
DESIGNED: Clint Jones  
CHECKED BY: Mark Webb

**AIRX** SURVEYORS, INC.  
Gail McMorrin  
President  
2524 EAST EL MONTE PARKWAY, SUITE C  
ESCONDIDO, CA 92027  
PHONE: (760) 480-2347  
CELL: (760) 419-3728

**NIV5**  
15092 AVENUE OF SCIENCE, SUITE 200  
SAN DIEGO, CA 92128  
P: 858 385.0500 WWW.NIV5.COM

AIRX JOB#: X160218  
MISC/POTHoles#: \_\_\_\_\_  
TYPE OF WORK: TRENCHING / CONDUIT

THOMAS GRID#: 1208-E7  
DRAWN FOR: CALTRANS

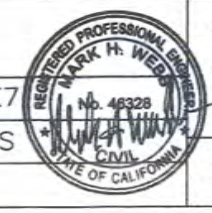

SHEET 6 OF 16



SCALE 1"=60'

11176TKL459  
8/16/17

**APPROVED**  
TRAFFIC CONTROL PERMIT  
SEP 14 2017  
CITY OF SAN DIEGO  
Development Services  
Engineering Division  
Traffic Safety Section

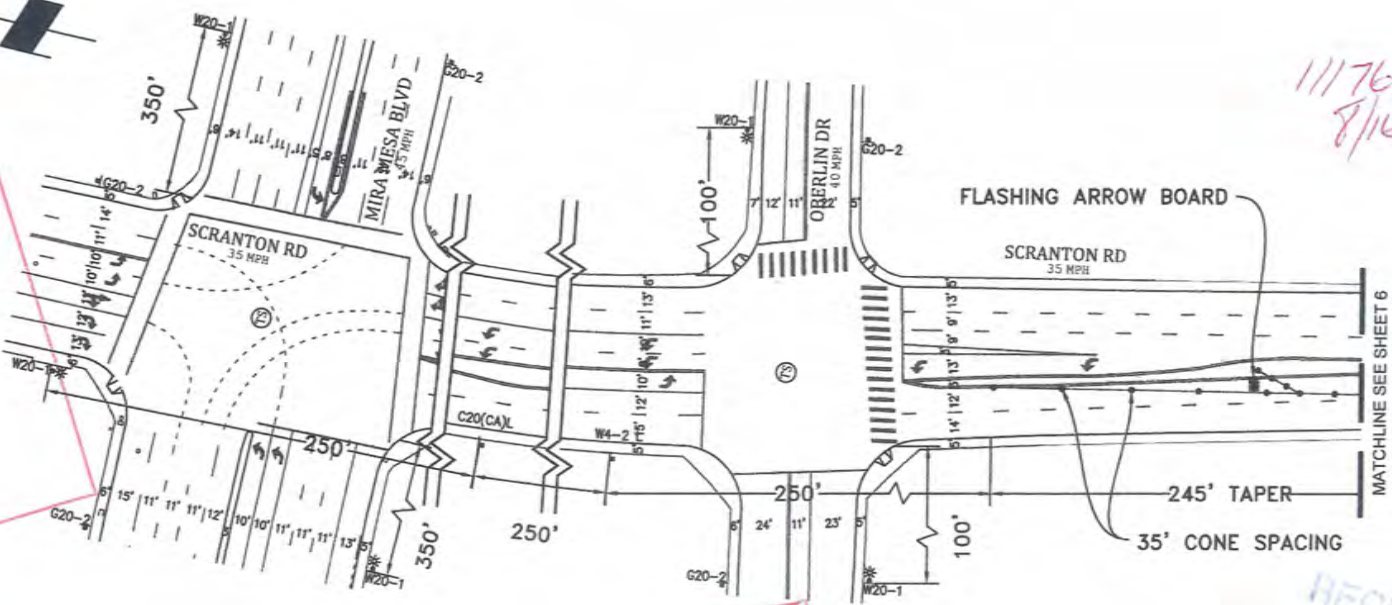

NOTE: W8-24 (STEEL PLATES AHEAD) SIGNS WILL REMAIN IN PLACE FOR DURATION OF WORK

**ORIGINAL PERMIT MUST BE KEPT ON JOB SITE ALL TIMES**

RECEIVED  
AUG 16 2017  
CALTRANS-PERMIT

WORK HOURS: \_\_\_\_\_ TO \_\_\_\_\_ PHASE C - 2

PROJECT NAME: TL23071 - Sycamore Canyon Substation To Penasquitos Substation - 230 KV Underground

DATE: 7/12/2017  
DESIGNED: Clint Jones  
CHECKED BY: Mark Webb

**AIRX** SURVEYORS, INC.  
Gail McMorrin  
President  
2524 EAST EL NORTE PARKWAY SUITE C  
ESCONDIDO, CA 92027  
PHONE: (760) 485-2347  
CELL: (760) 419-3728

**N|V|5**  
15092 AVENUE OF SCIENCE, SUITE 200  
SAN DIEGO, CA 92128  
P. 858.385.0500 WWW.NV5.COM

AIRX JOB#: X160218  
MISC/POTHOLE#: \_\_\_\_\_  
TYPE OF WORK: TRENCHING / CONDUIT

THOMAS GRID#: 1208-E7  
DRAWN FOR: CALTRANS



SHEET 7 OF 16

SCALE 1"=60'

11/16/17  
8/16/17

NOTE: W8-24 (STEEL PLATES AHEAD) SIGNS WILL REMAIN IN PLACE FOR DURATION OF WORK

**APPROVED**  
**TRAFFIC CONTROL PERMIT**  
**SEP 14 2017**  
CITY OF SAN DIEGO  
Development Services  
Engineering Division  
Traffic Safety Section

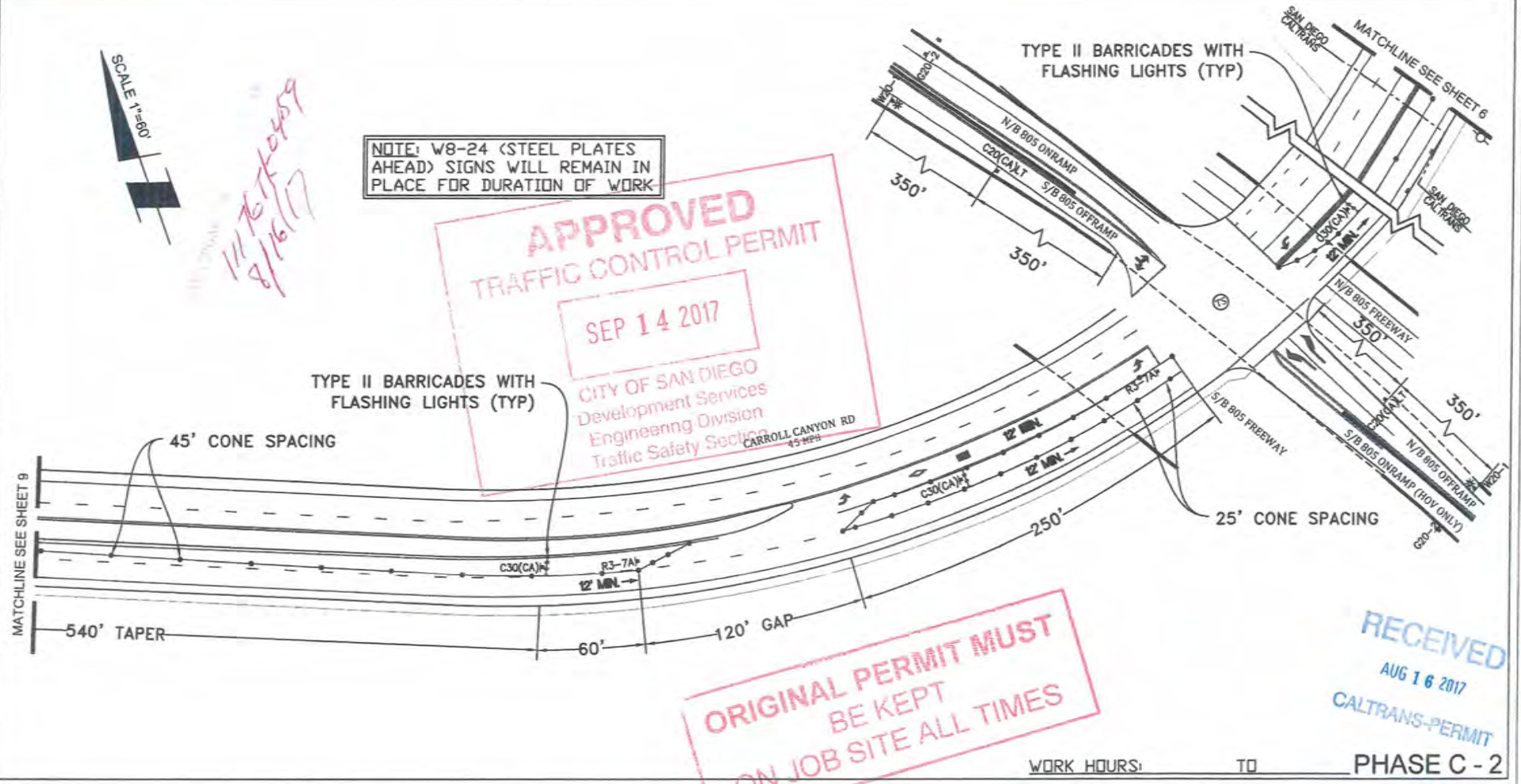

**ORIGINAL PERMIT MUST BE KEPT ON JOB SITE ALL TIMES**

RECEIVED  
AUG 16 2017  
CALTRANS-PERMIT

WORK HOURS: \_\_\_\_\_ TO \_\_\_\_\_ PHASE C - 2

PROJECT NAME: TL23071 - Sycamore Canyon Substation To Penasquitos Substation - 230 KV Underground

DATE: 7/12/2017  
DESIGNED: Clint Jones  
CHECKED BY: Mark Webb

**AIRX** SURVEYORS, INC.  
Gail McMorran  
President  
2524 EAST EL NORTE PARKWAY, SUITE C  
ESCONDIDO, CA 92027  
PHONE: (760) 430-2547  
CELL: (760) 419-3478

**N|V|5**  
15092 AVENUE OF SCIENCE, SUITE 200  
SAN DIEGO, CA 92128  
P. 858.385.0500 WWW.NV5.COM

AIRX JOB#: X160218  
MISC/POTHOLES#:

THOMAS GRID#: 1208-E7  
DRAWN FOR: CALTRANS



TYPE OF WORK: TRENCHING / CONDUIT

SHEET 8 OF 16



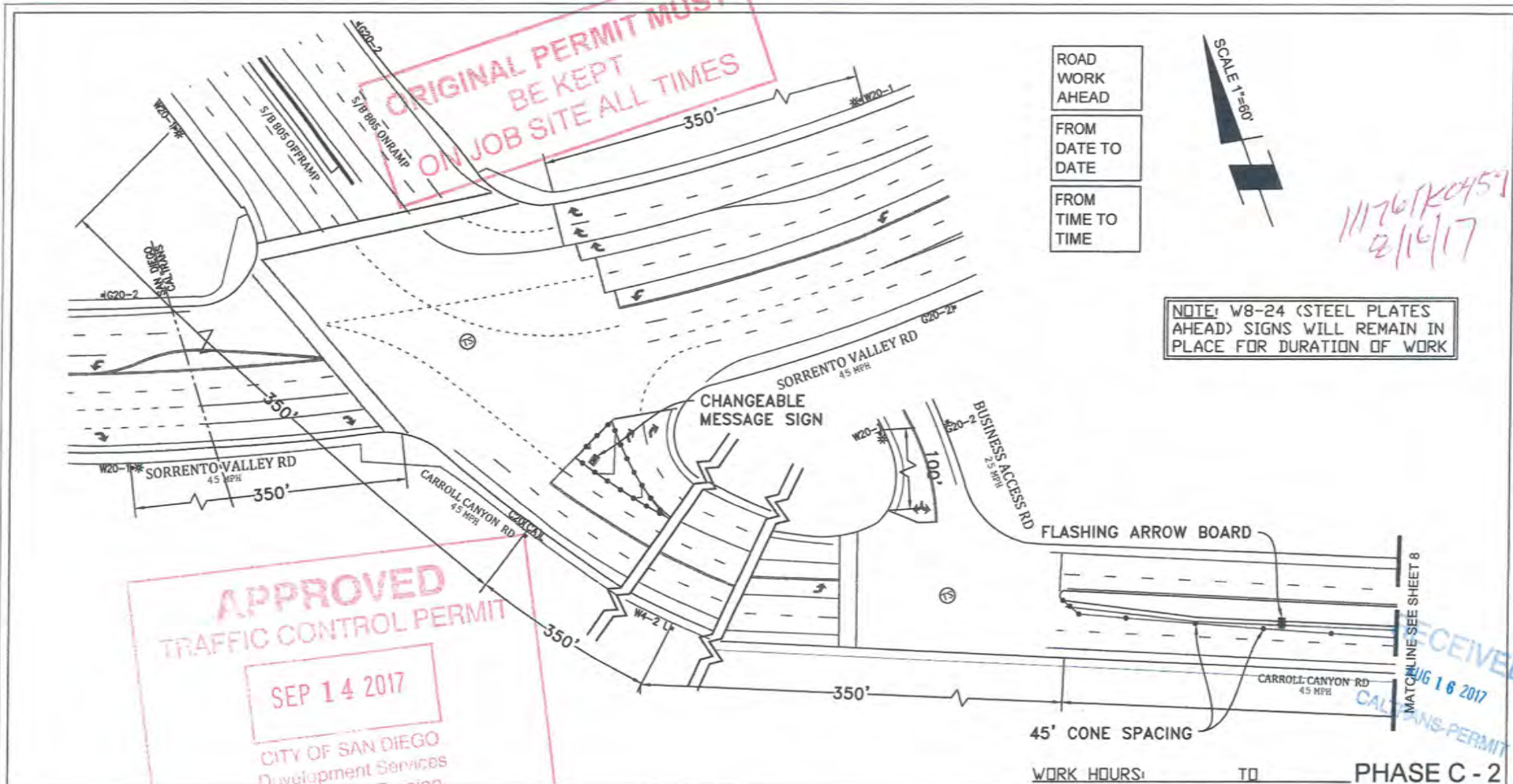

**ORIGINAL PERMIT MUST BE KEPT ON JOB SITE ALL TIMES**

**APPROVED TRAFFIC CONTROL PERMIT**  
**SEP 14 2017**  
 CITY OF SAN DIEGO  
 Development Services  
 Engineering Division  
 Traffic Safety Section

ROAD WORK AHEAD  
 FROM DATE TO DATE  
 FROM TIME TO TIME

NOTE: W8-24 (STEEL PLATES AHEAD) SIGNS WILL REMAIN IN PLACE FOR DURATION OF WORK

111761K0451  
 2/16/17

RECEIVED  
 CALTRANS PERMIT  
 MATCHLINE SEE SHEET 8

WORK HOURS: \_\_\_\_\_ TO \_\_\_\_\_ **PHASE C - 2**

**PROJECT NAME:** TL23071 Sycamore Canyon Substation To Penasquitos Substation - 230 KV Underground

**AIRX** SURVEYORS, INC.  
 Gail McMorran  
 President  
 2524 EAST EL NORTE PARKWAY, SUITE C  
 ESCONDIDO, CA 92027  
 PHONE: (760) 480-2547  
 CELL: (760) 419-3438

**N/V/5**  
 15092 AVENUE OF SCIENCE, SUITE 200  
 SAN DIEGO, CA 92128  
 P. 658.385.0500 WWW.NV5.COM

AIRX JOB#: X160218  
 MISC/POTHOLES#: \_\_\_\_\_  
 TYPE OF WORK: TRENCHING / CONDUIT

THOMAS GRID#: 1208-E7  
 DRAWN FOR: CALTRANS



DATE: 7/12/2017  
 DESIGNED: Clint Jones  
 CHECKED BY: Mark Webb  
**SHEET 9 OF 16**



**APPROVED**  
**TRAFFIC CONTROL PERMIT**  
**SEP 14 2017**  
CITY OF SAN DIEGO  
Development Services  
Engineering Division  
Traffic Safety Section

**ORIGINAL PERMIT MUST  
BE KEPT  
ON JOB SITE ALL TIMES**

11176TK0459  
8/16/17

NOTE: W8-24 (STEEL PLATES  
AHEAD) SIGNS WILL REMAIN IN  
PLACE FOR DURATION OF WORK

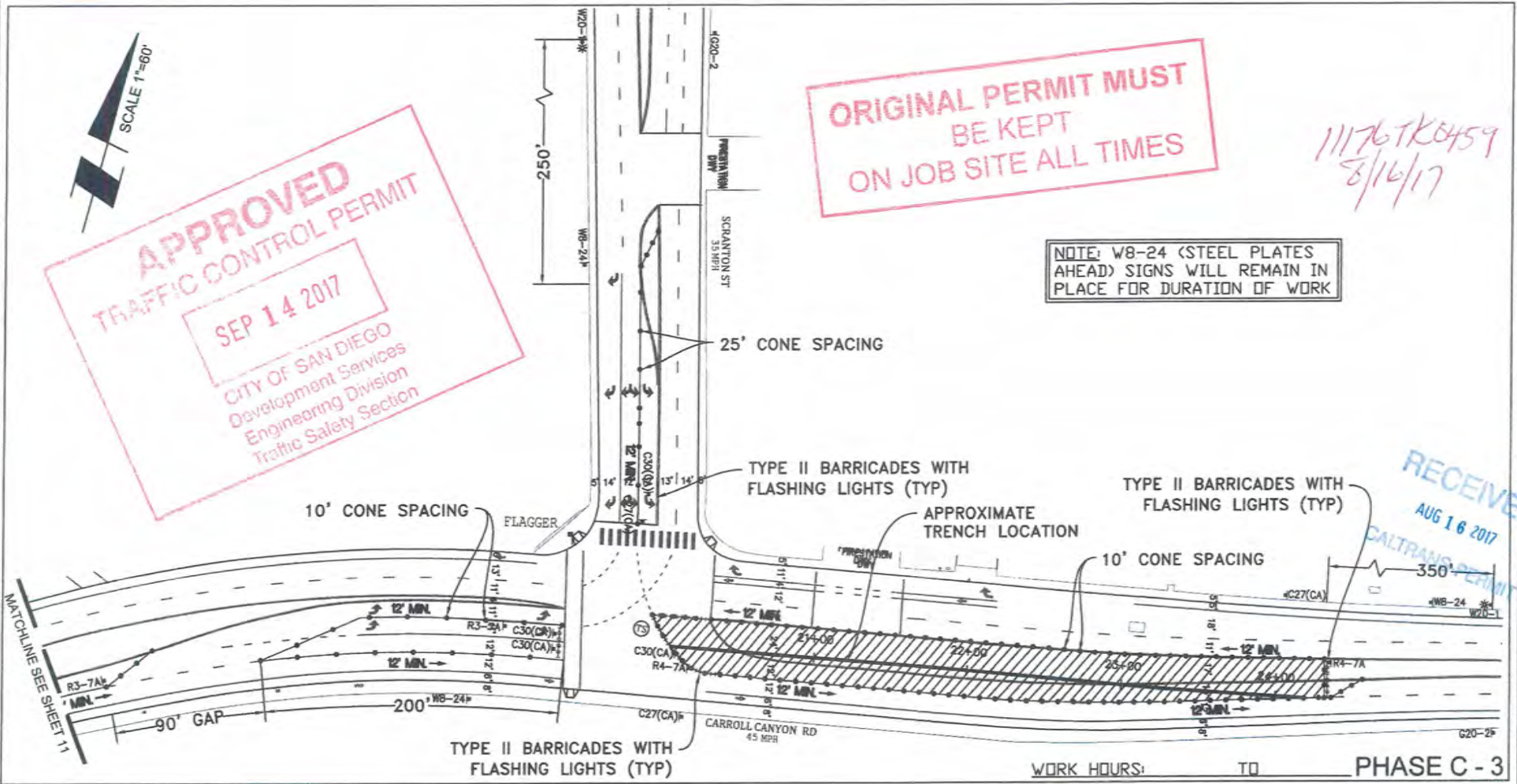

RECEIVED  
AUG 16 2017  
CALTRANS PERMIT

<b>PROJECT NAME:</b> TL23071 - Sycamore Canyon Substation To Penasquitos Substation - 230 KV Underground		<b>DATE:</b> 7/12/2017	
<b>AIRX JOB#:</b> X160218		<b>DESIGNED:</b> Clint Jones	
<b>MISC/POTHOLES#:</b>		<b>CHECKED BY:</b> Mark Webb	
<b>TYPE OF WORK:</b> TRENCHING / CONDUIT		<b>SHEET 10 OF 16</b>	

**REGISTERED PROFESSIONAL ENGINEER**  
**MARK H. WEBB**  
No. 46328  
CIVIL  
STATE OF CALIFORNIA

**AIRX** SURVEYORS, INC.  
Gail McMorrin  
President  
2524 EAST EL NORTE PARKWAY, SUITE C  
ESCONDIDO, CA 92027  
PHONE: (760) 480-2247  
CELL: (760) 419-3728

**N/V/5**  
15092 AVENUE OF SCIENCE, SUITE 200  
SAN DIEGO, CA 92128  
P: 858.385.0500 WWW.NV5.COM

**AIRX JOB#:** X160218  
**MISC/POTHOLES#:**  
**TYPE OF WORK:** TRENCHING / CONDUIT

**THOMAS GRID#:** 1208-E7  
**DRAWN FOR:** CALTRANS



SCALE 1"=60'  
 11/16/17  
 8/16/17

**APPROVED**  
**CONTROL PERMIT**  
 NOTE: W8-24 (STEEL PLATES AHEAD) SIGNS WILL REMAIN IN PLACE FOR DURATION OF WORK  
 SEP 14 2017  
 CITY OF SAN DIEGO  
 Development Services  
 Engineering Division  
 Traffic Safety Section

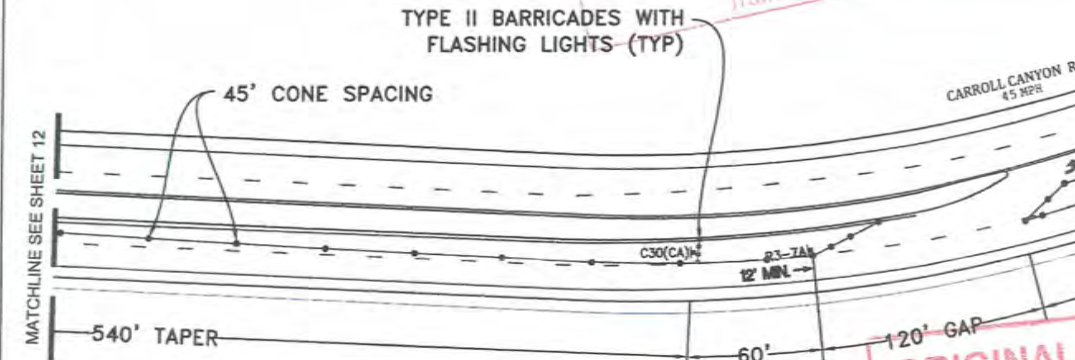
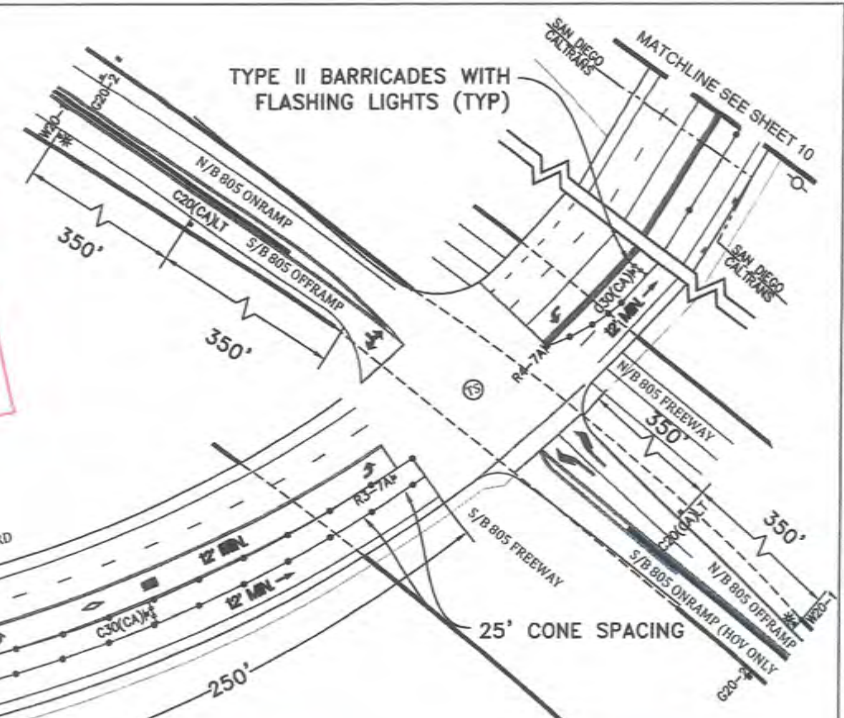

**ORIGINAL PERMIT MUST BE KEPT ON JOB SITE ALL TIMES**

**RECEIVED**  
 AUG 16 2017  
 CALTRANS-PERMIT

WORK HOURS: \_\_\_\_\_ TO \_\_\_\_\_ **PHASE C - 3**

**PROJECT NAME:** TL23071 - Sycamore Canyon Substation To Penasquitos Substation - 230 KV Underground

DATE: 7/12/2017  
 DESIGNED: Clint Jones  
 CHECKED BY: Mark Webb

**AIRX** SURVEYORS, INC.  
 Gail McMorran  
 President  
 2034 EAST EL NORTE PARKWAY, SUITE C  
 ESCOBEDO, CA 92027  
 PHONE: (760) 450-2417  
 CELL: (760) 439-3738

**N|V|5**  
 15092 AVENUE OF SCIENCE, SUITE 200  
 SAN DIEGO, CA 92128  
 P: 858.385.0500 WWW.NV5.COM

AIRX JOB#: X160218  
 MISC/POTHOLE#: \_\_\_\_\_  
 TYPE OF WORK: TRENCHING / CONDUIT

THOMAS GRID#: 1208-E7  
 DRAWN FOR: CALTRANS



**SHEET 11 OF 16**

**ORIGINAL PERMIT MUST  
BE KEPT  
ON JOB SITE ALL TIMES**

ROAD  
WORK  
AHEAD  
  
FROM  
DATE TO  
DATE  
  
FROM  
TIME TO  
TIME



11176 TK0459  
8/16/17

NOTE: W8-24 (STEEL PLATES  
AHEAD) SIGNS WILL REMAIN IN  
PLACE FOR DURATION OF WORK

RECEIVED  
AUG 16 2017  
CALTRANS-PERMIT

**APPROVED  
TRAFFIC CONTROL PERMIT**

**SEP 14 2017**

CITY OF SAN DIEGO  
Development Services  
Engineering Division

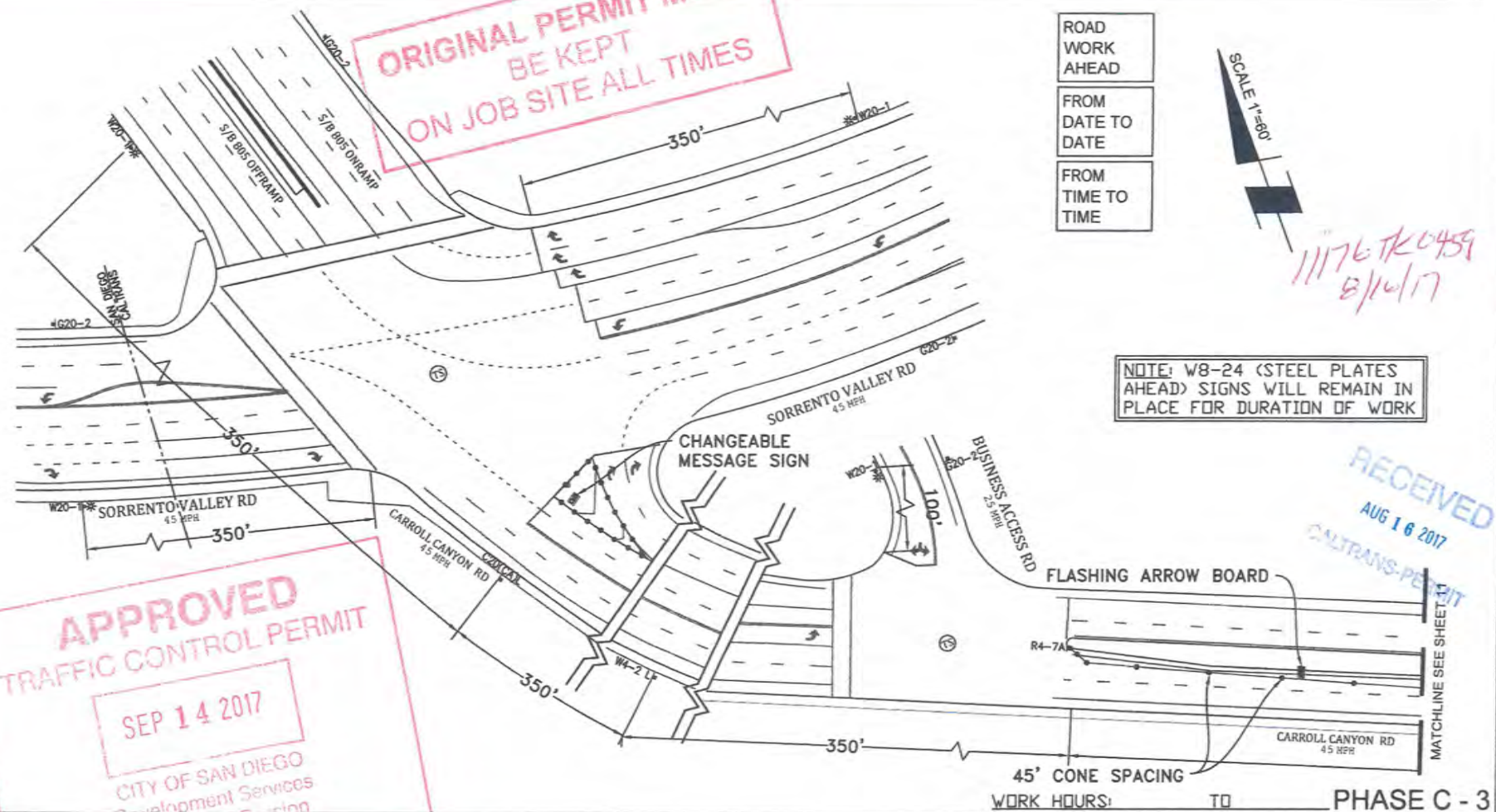

WORK HOURS: \_\_\_\_\_ TO \_\_\_\_\_ PHASE C - 3

PROJECT NAME: TL23071 - Sycamore Canyon Substation To  
Penasquitos Substation - 230 KV Underground

DATE: 7/12/2017  
DESIGNED: Clint Jones  
CHECKED BY: Mark Webb

**AIRX**  
SURVEYORS, INC.  
Gail McMorran  
President  
2504 EAST EL NORTE PARKWAY SUITE C  
ESCONDIDO, CA 92027  
PHONE: (761) 485-2947  
CELL: (761) 419-3738

**NV5**  
15092 AVENUE OF SCIENCE, SUITE 200  
SAN DIEGO, CA 92128  
P. 658.385.0500 WWW.NV5.COM

AIRX JOB#: X160218  
MISC/POTHOLES#:  
THOMAS GRID#: 1208-E7  
DRAWN FOR: CALTRANS  
TYPE OF WORK: TRENCHING / CONDUIT

REGISTERED PROFESSIONAL ENGINEER  
**MARK H. WEBB**  
No. 48928  
CIVIL  
STATE OF CALIFORNIA

SHEET 12 OF 16



**ORIGINAL PERMIT MUST BE KEPT IN JOB SITE ALL TIMES**

**APPROVED TRAFFIC CONTROL PERMIT**  
**SEP 14 2017**

CITY OF SAN DIEGO  
 Development Services  
 Engineering Division  
 Public Safety Section

NOTE: W8-24 (STEEL PLATES AHEAD) SIGNS WILL REMAIN IN PLACE FOR DURATION OF WORK

11176TK0459  
 8/14/17

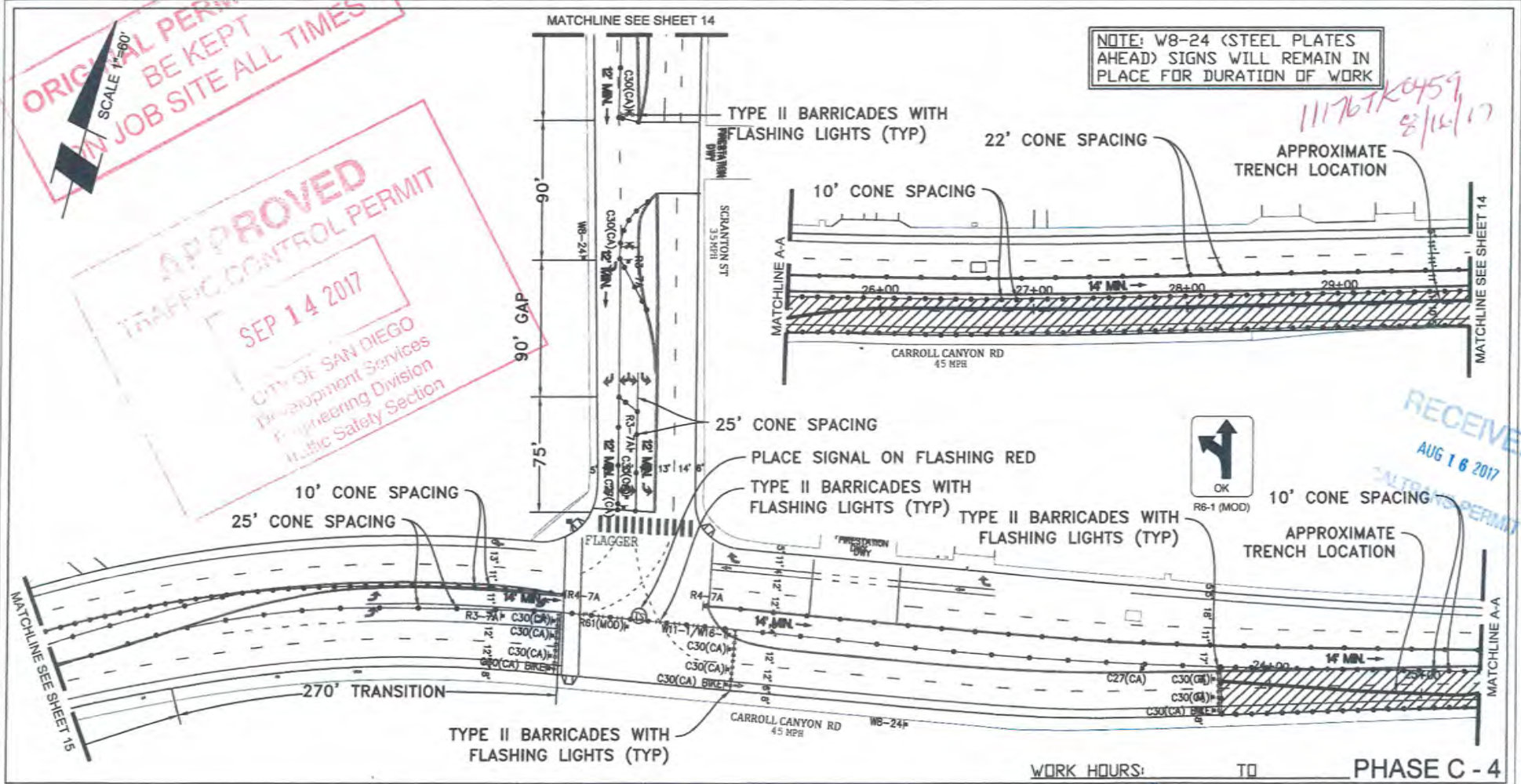

WORK HOURS: TO PHASE C - 4

PROJECT NAME: TL23071 - Sycamore Canyon Substation To Penasquitos Substation - 230 KV Underground

DATE: 7/12/2017  
 DESIGNED: Clint Jones  
 CHECKED BY: Mark Webb

**AIRX** SURVEYORS, INC.  
 Gail McMorran  
 President  
 2524 EAST EL NORTE PARKWAY, SUITE C  
 ESCONDIDO, CA 92027  
 PHONE: (760) 490-2347  
 CELL: (760) 419-3728

**N/V/5**  
 15092 AVENUE OF SCIENCE, SUITE 200  
 SAN DIEGO, CA 92128  
 P. 858.385.0500 WWW.NV5.COM

AIRX JOB#: X160218  
 MISC/POTHOLES#: \_\_\_\_\_  
 TYPE OF WORK: TRENCHING / CONDUIT

THOMAS GRID#: 1208-E7  
 DRAWN FOR: CALTRANS

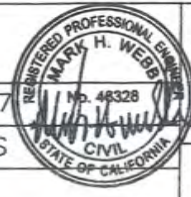

SHEET 13 OF 16

**ORIGINAL PERMIT MUST BE POSTED ON JOB SITE AT ALL TIMES**

**APPROVED TRAFFIC CONTROL PERMIT**  
 SEP 14 2017  
 SCALE 1"=60'  
 CITY OF SAN DIEGO  
 Development Services  
 Engineering Division  
 Traffic Safety Section

NOTE: W8-24 (STEEL PLATES AHEAD) SIGNS WILL REMAIN IN PLACE FOR DURATION OF WORK

11176TK0459  
 8/16/17

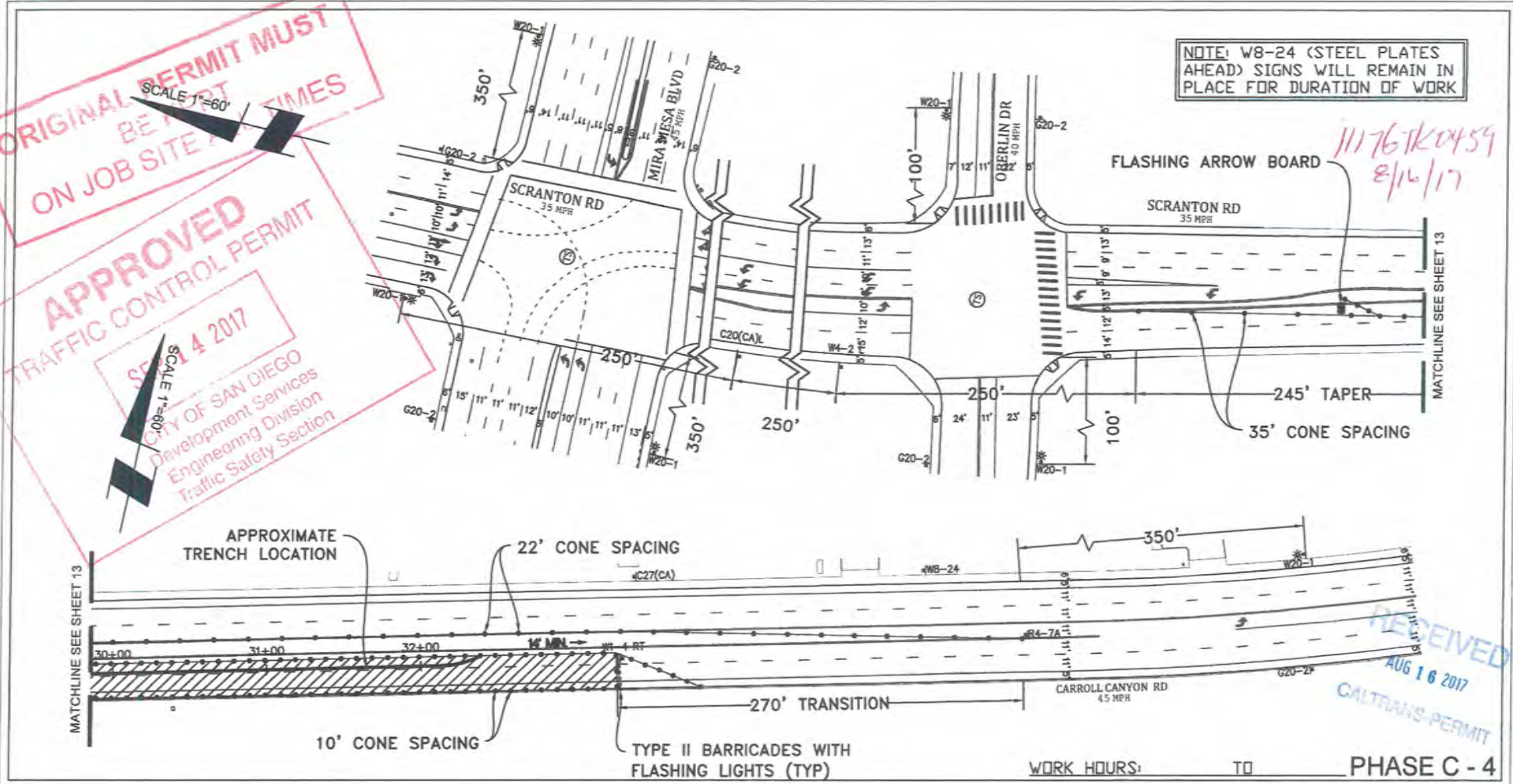

RECEIVED  
 AUG 16 2017  
 CALTRANS PERMIT

PROJECT NAME: TL23071 - Sycamore Canyon Substation To Penasquitos Substation - 230 KV Underground

DATE: 7/12/2017  
 DESIGNED: Clint Jones  
 CHECKED BY: Mark Webb

**AIRX** SURVEYORS, INC.  
 Gail McMorrin  
 President  
 2934 EAST EL NORTE PARKWAY, SUITE C  
 ESCONDIDO, CA 92027  
 PHONE: (761) 450-2207  
 CELL: (761) 419-3738

**NV5**  
 15092 AVENUE OF SCIENCE, SUITE 200  
 SAN DIEGO, CA 92126  
 P. 858.385.0500 WWW.NV5.COM

AIRX JOB#: X160218  
 MISC/POTHoles#: \_\_\_\_\_

THOMAS GRID#: 1208-E7  
 DRAWN FOR: CALTRANS

TYPE OF WORK: TRENCHING / CONDUIT



SHEET 14 OF 16



11176TK 0459  
8/16/17

**ORIGINAL PERMIT MUST BE KEPT IN JOB SITE ALL TIMES**

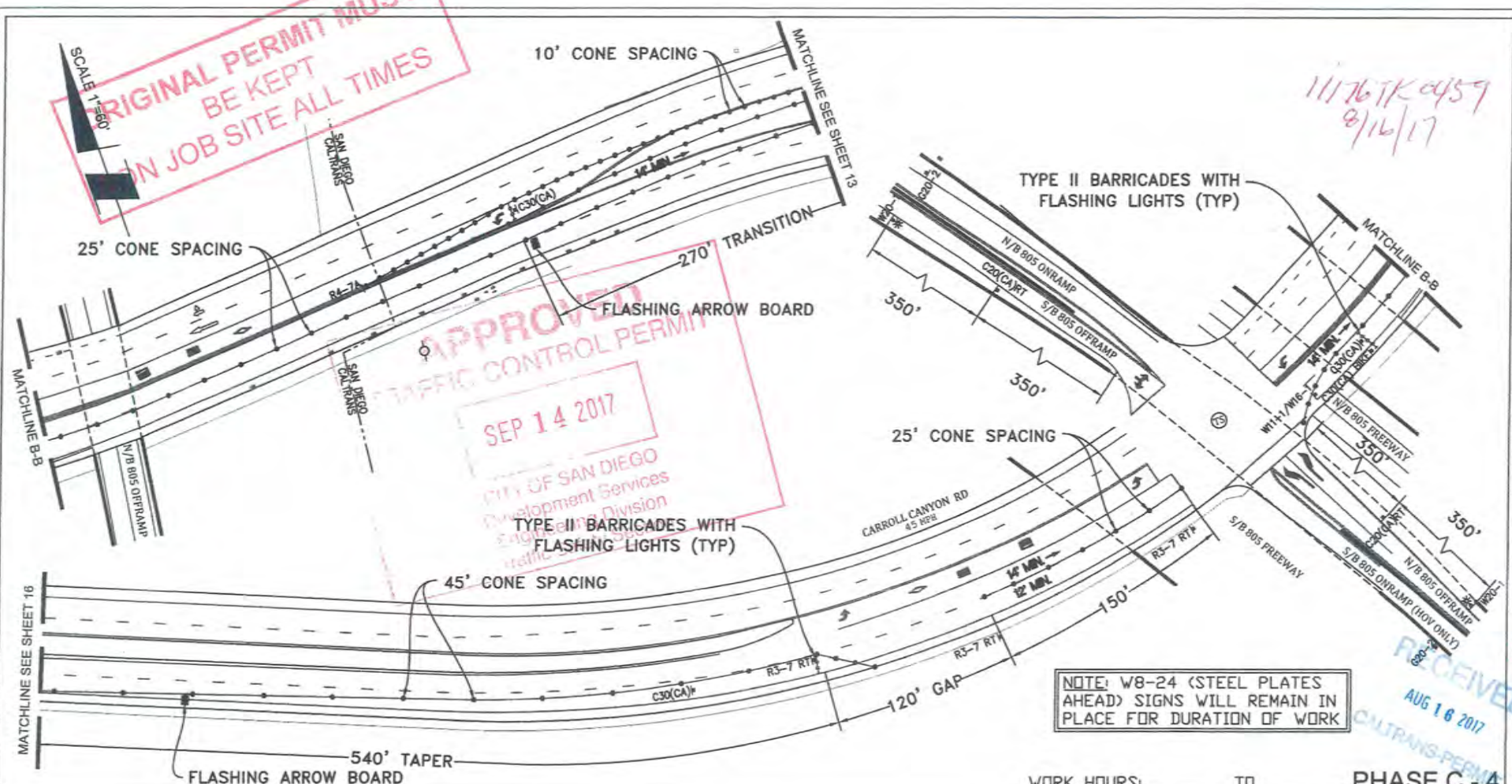

NOTE: W8-24 (STEEL PLATES AHEAD) SIGNS WILL REMAIN IN PLACE FOR DURATION OF WORK

RECEIVED  
AUG 16 2017  
CALTRANS PERMIT

WORK HOURS: \_\_\_\_\_ TO \_\_\_\_\_ PHASE C - 4

PROJECT NAME: TL23071 - Sycamore Canyon Substation To Penasquitos Substation - 230 KV Underground

DATE: 7/12/2017  
DESIGNED: Clint Jones  
CHECKED BY: Mark Webb

**AIRX** SURVEYORS, INC.  
Gail McMorrin  
President  
2524 EAST EL MONTE PARKWAY, SUITE C  
ESCONDIDO, CA 92027  
PHONE: (760) 480-2341  
CELL: (760) 419-3728

**N/V/5**  
15092 AVENUE OF SCIENCE, SUITE 200  
SAN DIEGO, CA 92126  
P: 858.365.0500 WWW.NV5.COM

AIRX JOB#: X160218  
MISC/POTHOLES#:

THOMAS GRID#: 1208-E7  
DRAWN FOR: CALTRANS



TYPE OF WORK: TRENCHING / CONDUIT

SHEET 15 OF 16

