

**APPROVED**  
**TRAFFIC CONTROL PERMIT**

OCT 11 2017

CITY OF SAN DIEGO  
 Development Services  
 Engineering Division  
 Traffic Safety Section

**ORIGINAL PERMIT MUST  
 BE KEPT  
 ON JOB SITE ALL TIMES**

NOTE: CONTRACTOR WILL COORDINATE ALL WORK WITH FIRE STATION PRIOR TO START OF WORK

NOTE: CONTRACTOR WILL COORDINATE ALL WORK WITH TRANSIT DEPARTMENT 5 DAYS PRIOR TO START OF WORK

NOTE: CONTRACTOR WILL COORDINATE ALL WORK WITH EXISTING PROJECTS AND NOT CONFLICT WITH EXISTING TRAFFIC CONTROLS

NOTE: CONTRACTOR WILL COORDINATE ALL WORK WITH RESIDENTS PRIOR TO START OF WORK

NOTE: CONTRACTOR WILL COORDINATE ALL WORK WITH BUSINESSES PRIOR TO START OF WORK

WORK HOURS: 9:00PM TO 5:00AM

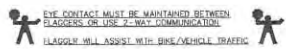

**NIGHT WORK ONLY  
 PHASE 57**

- LEGEND**
- SIGN
  - SIGNAL
  - TRAFFIC CONES / DELINEATOR
  - BARRICADE
  - FLAGGER
  - FLASHING ARROW SIGN
  - WORK ZONE
  - BUS STOP

NOTE: FLAGGERS WILL PROVIDE ACCESS TO DRIVEWAYS AT ALL TIMES

NOTE: FLAGGERS WILL SAFELY GUIDE PEDESTRIANS THROUGH WORK AREA

NOTE: CONTRACTOR WILL ALLOW FIRE STATION INGRESS AND EGRESS AT ALL TIMES

NOTE: W8-R4 (STEEL PLATES AHEAD) SIGNS WILL REMAIN IN PLACE FOR DURATION OF WORK

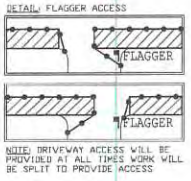

UTILITY SURVEYORS, INC.  
  
 Gail McMoran  
 President  
 2554 EAST EL NORTE PARKWAY, SUITE C  
 ESCONDIDO, CA 92027  
 PHONE: (760) 480-2547  
 CELL: (760) 419-3758

<b>PROJECT NAME:</b> TL23071 - SYCAMORE CANYON SUBSTATION TO PENASQUITOS - 230 KV UNDERGROUND	
AIRX JOB#: X160218	THOMAS GRID#: -
TYPE OF WORK: TRENCHING / CONDUIT	DRAWN FOR: CITY OF SAN DIEGO
MISC/POTHoles#:	

DATE: Mar. 29, 2017
DESIGNED BY: Clint Jones
SHEET 068 OF 148

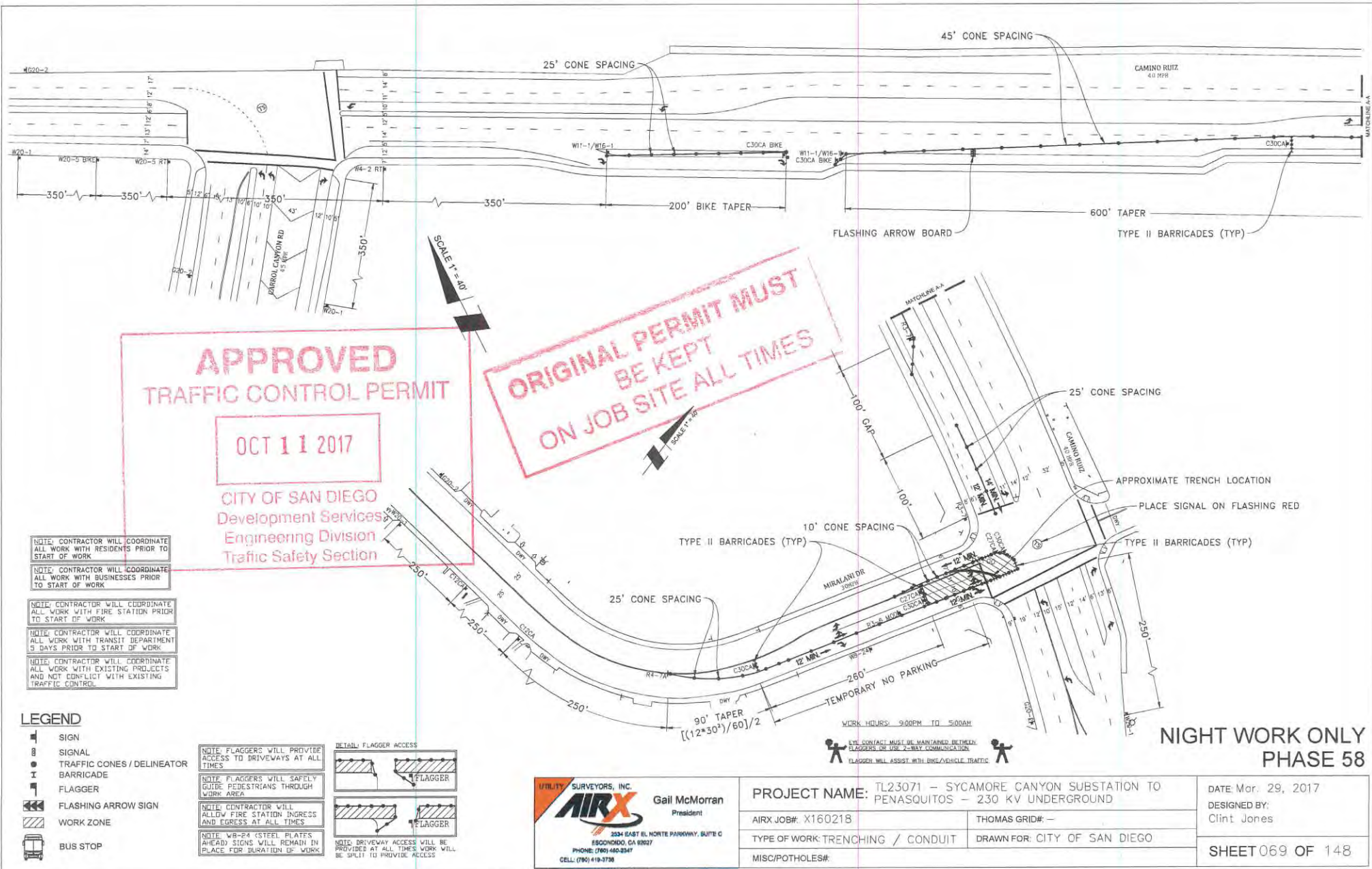

**APPROVED**  
TRAFFIC CONTROL PERMIT

OCT 11 2017

CITY OF SAN DIEGO  
Development Services  
Engineering Division  
Traffic Safety Section

ORIGINAL PERMIT MUST  
BE KEPT  
ON JOB SITE ALL TIMES

- NOTE: CONTRACTOR WILL COORDINATE ALL WORK WITH RESIDENTS PRIOR TO START OF WORK
- NOTE: CONTRACTOR WILL COORDINATE ALL WORK WITH BUSINESSES PRIOR TO START OF WORK
- NOTE: CONTRACTOR WILL COORDINATE ALL WORK WITH FIRE STATION PRIOR TO START OF WORK
- NOTE: CONTRACTOR WILL COORDINATE ALL WORK WITH TRANSIT DEPARTMENT 5 DAYS PRIOR TO START OF WORK
- NOTE: CONTRACTOR WILL COORDINATE ALL WORK WITH EXISTING PROJECTS AND NOT CONFLICT WITH EXISTING TRAFFIC CONTROL

- LEGEND**
- SIGN
  - SIGNAL
  - TRAFFIC CONES / DELINEATOR
  - BARRICADE
  - FLAGGER
  - FLASHING ARROW SIGN
  - WORK ZONE
  - BUS STOP

**NOTE: FLAGGERS WILL PROVIDE ACCESS TO DRIVEWAYS AT ALL TIMES**

**NOTE: FLAGGERS WILL SAFELY GUIDE PEDESTRIANS THROUGH WORK AREA**

**NOTE: CONTRACTOR WILL ALLOW FIRE STATION INGRESS AND EGRESS AT ALL TIMES**

**NOTE: W8-24 STEEL PLATES AHEAD SIGNS WILL REMAIN IN PLACE FOR DURATION OF WORK**

**NOTE: DRIVEWAY ACCESS WILL BE PROVIDED AT ALL TIMES WORK WILL BE SPLIT TO PROVIDE ACCESS**

UTILITY SURVEYORS, INC.

**AIRX**

Gail McMorran  
President

2331 EAST EL NORTE PARKWAY, SUITE C  
FREMONT, CA 94527  
PHONE: (760) 460-2347  
CELL: (760) 419-3738

<b>PROJECT NAME:</b> TL23071 - SYCAMORE CANYON SUBSTATION TO PENASQUITOS - 230 KV UNDERGROUND	
AIRX JOB#: X160218	THOMAS GRID#: -
TYPE OF WORK: TRENCHING / CONDUIT	DRAWN FOR: CITY OF SAN DIEGO
MISC/POTHLES#:	

DATE: Mar. 29, 2017
DESIGNED BY: Clint Jones
<b>SHEET 069 OF 148</b>

**NIGHT WORK ONLY**  
**PHASE 58**





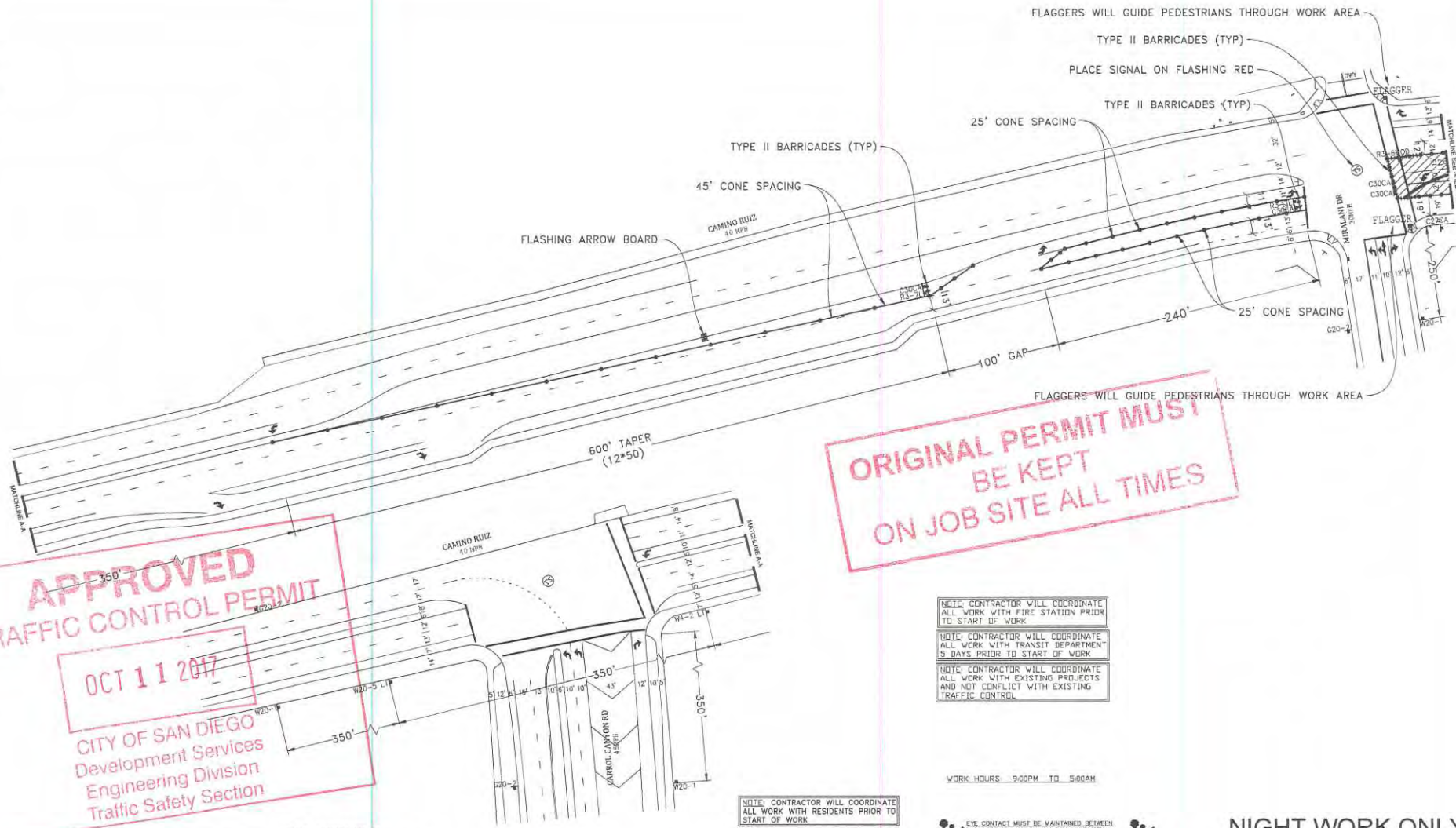

**APPROVED**  
**TRAFFIC CONTROL PERMIT**

**OCT 11 2017**

**CITY OF SAN DIEGO**  
Development Services  
Engineering Division  
Traffic Safety Section

**ORIGINAL PERMIT MUST  
BE KEPT  
ON JOB SITE ALL TIMES**

- LEGEND**
- SIGN
  - SIGNAL
  - TRAFFIC CONES / DELINEATOR
  - BARRICADE
  - FLAGGER
  - FLASHING ARROW SIGN
  - WORK ZONE
  - BUS STOP

NOTE: FLAGGERS WILL PROVIDE ACCESS TO DRIVEWAYS AT ALL TIMES.

NOTE: FLAGGERS WILL SAFELY GUIDE PEDESTRIANS THROUGH WORK AREA.

NOTE: CONTRACTOR WILL ALLOW FIRE STATION INGRESS AND EGRESS AT ALL TIMES.

NOTE: W8-24 (STEEL PLATES AHEAD) SIGNS WILL REMAIN IN PLACE FOR DURATION OF WORK.

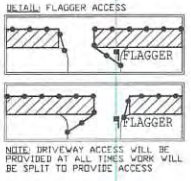

NOTE: CONTRACTOR WILL COORDINATE ALL WORK WITH FIRE STATION PRIOR TO START OF WORK.

NOTE: CONTRACTOR WILL COORDINATE ALL WORK WITH TRANSIT DEPARTMENT 5 DAYS PRIOR TO START OF WORK.

NOTE: CONTRACTOR WILL COORDINATE ALL WORK WITH EXISTING PROJECTS AND NOT CONFLICT WITH EXISTING TRAFFIC CONTROL.

WORK HOURS: 9:00PM TO 5:00AM

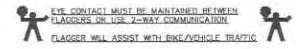

**NIGHT WORK ONLY**  
**PHASE 60**

**UTILITY SURVEYORS, INC.**  
**AIRX**  
Gail McMoran  
President  
2534 EAST EL NORTE PARKWAY, SUITE C  
ESCONDIDO, CA 92027  
PHONE: (760) 480-8347  
CELL: (760) 419-3738

<b>PROJECT NAME:</b> TL23071 - SYCAMORE CANYON SUBSTATION TO PENASQUITOS - 230 KV UNDERGROUND	
<b>AIRX JOB#:</b> X160218	<b>THOMAS GRID#:</b> -
<b>TYPE OF WORK:</b> TRENCHING / CONDUIT	<b>DRAWN FOR:</b> CITY OF SAN DIEGO
<b>MISC/POTHoles#:</b>	

<b>DATE:</b> Mar. 29, 2017
<b>DESIGNED BY:</b> Clint Jones
<b>SHEET 071 OF 148</b>



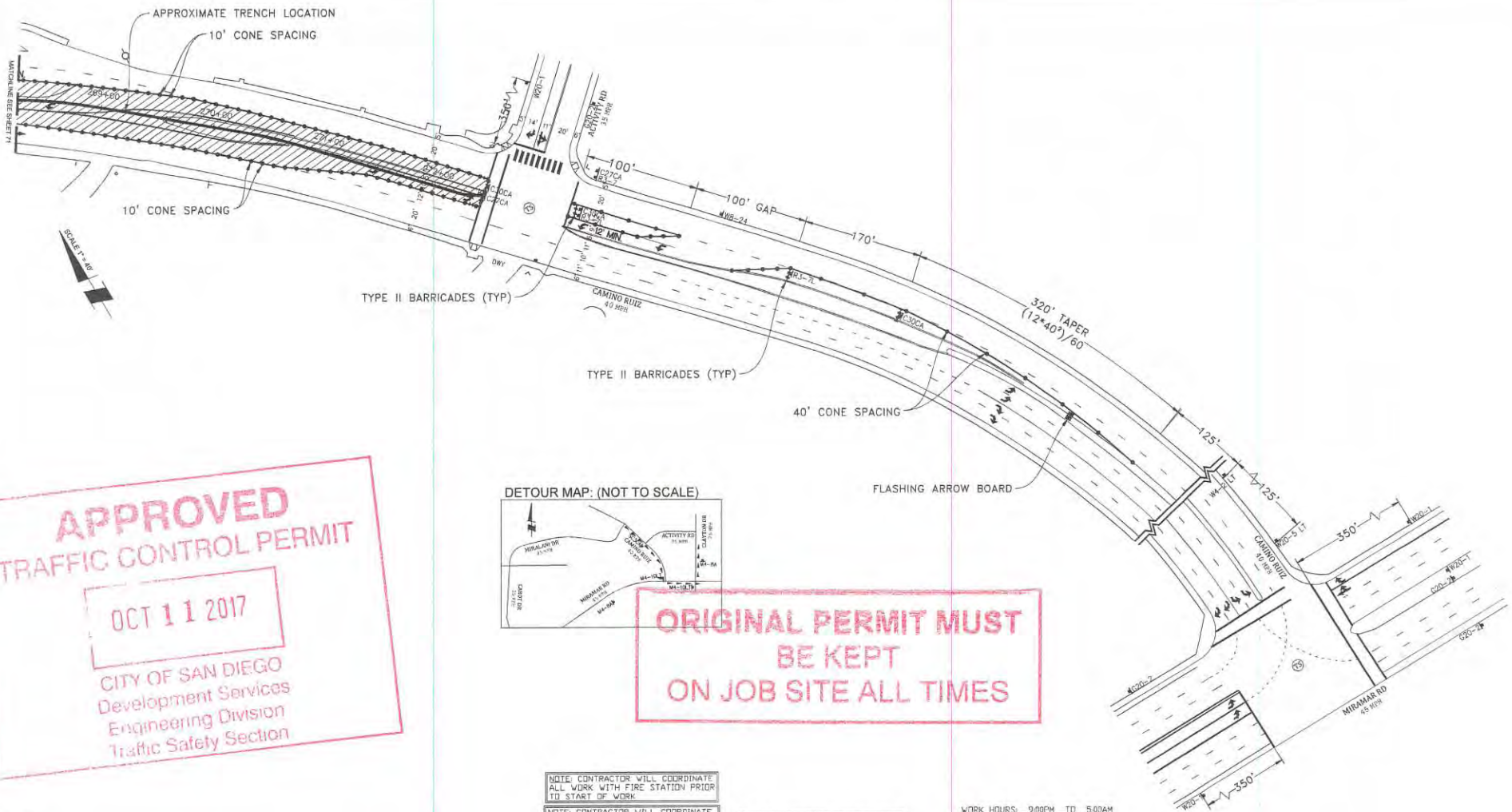

**APPROVED  
TRAFFIC CONTROL PERMIT**

**OCT 11 2017**

CITY OF SAN DIEGO  
Development Services  
Engineering Division  
Traffic Safety Section

**ORIGINAL PERMIT MUST  
BE KEPT  
ON JOB SITE ALL TIMES**

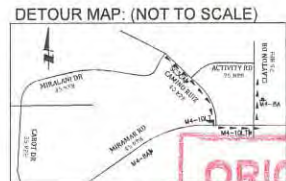

NOTE: CONTRACTOR WILL COORDINATE ALL WORK WITH FIRE STATION PRIOR TO START OF WORK.

NOTE: CONTRACTOR WILL COORDINATE ALL WORK WITH TRANSIT DEPARTMENT 5 DAYS PRIOR TO START OF WORK.

NOTE: CONTRACTOR WILL COORDINATE ALL WORK WITH EXISTING PROJECTS AND NOT CONFLICT WITH EXISTING TRAFFIC CONTROL.

NOTE: CONTRACTOR WILL COORDINATE ALL WORK WITH RESIDENTS PRIOR TO START OF WORK.

NOTE: CONTRACTOR WILL COORDINATE ALL WORK WITH BUSINESSES PRIOR TO START OF WORK.

WORK HOURS: 9:00PM TO 5:00AM

EYE CONTACT MUST BE MAINTAINED BETWEEN FLAGGERS OR USE 2-WAY COMMUNICATION. FLAGGER WILL ASSIST WITH BRK/VEHICLE TRAFFIC.

- LEGEND**
- SIGN
  - SIGNAL
  - TRAFFIC CONES / DELINEATOR
  - BARRICADE
  - FLAGGER
  - FLASHING ARROW SIGN
  - WORK ZONE
  - BUS STOP

NOTE: FLAGGERS WILL PROVIDE ACCESS TO DRIVEWAYS AT ALL TIMES.

NOTE: FLAGGERS WILL SAFELY GUIDE PEDESTRIANS THROUGH WORK AREA.

NOTE: CONTRACTOR WILL ALLOW FIRE STATION INGRESS AND EGRESS AT ALL TIMES.

NOTE: WB-24 (STEEL PLATES) AHEAD SIGNS WILL REMAIN IN PLACE FOR DURATION OF WORK.

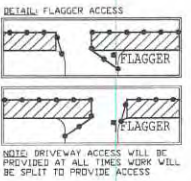

UTILITY SURVEYORS, INC. **AIRX** Gail McMorran President  
2834 EAST EL NORTE PARKWAY, SUITE C ESCONDIDO, CA 92027  
PHONE: (760) 460-2347 CELL: (760) 419-3728

PROJECT NAME: TL23071 - SYCAMORE CANYON SUBSTATION TO PENASQUITOS - 230 KV UNDERGROUND	
AIRX JOB#: X160218	THOMAS GRID#: -
TYPE OF WORK: TRENCHING / CONDUIT	DRAWN FOR: CITY OF SAN DIEGO
MISC/POTHoles#:	

**NIGHT WORK ONLY  
PHASE 60 (CONT)**

DATE: Mar. 29, 2017  
DESIGNED BY: Clint Jones  
SHEET 072 OF 148



DETOUR MAP: (NOT TO SCALE)

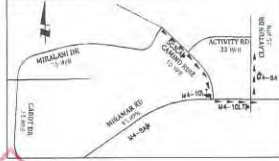

**APPROVED  
TRAFFIC CONTROL PERMIT**

**OCT 11 2017**

CITY OF SAN DIEGO  
Development Services  
Engineering Division  
Traffic Safety Section

**ORIGINAL PERMIT MUST  
BE KEPT  
ON JOB SITE ALL TIMES**

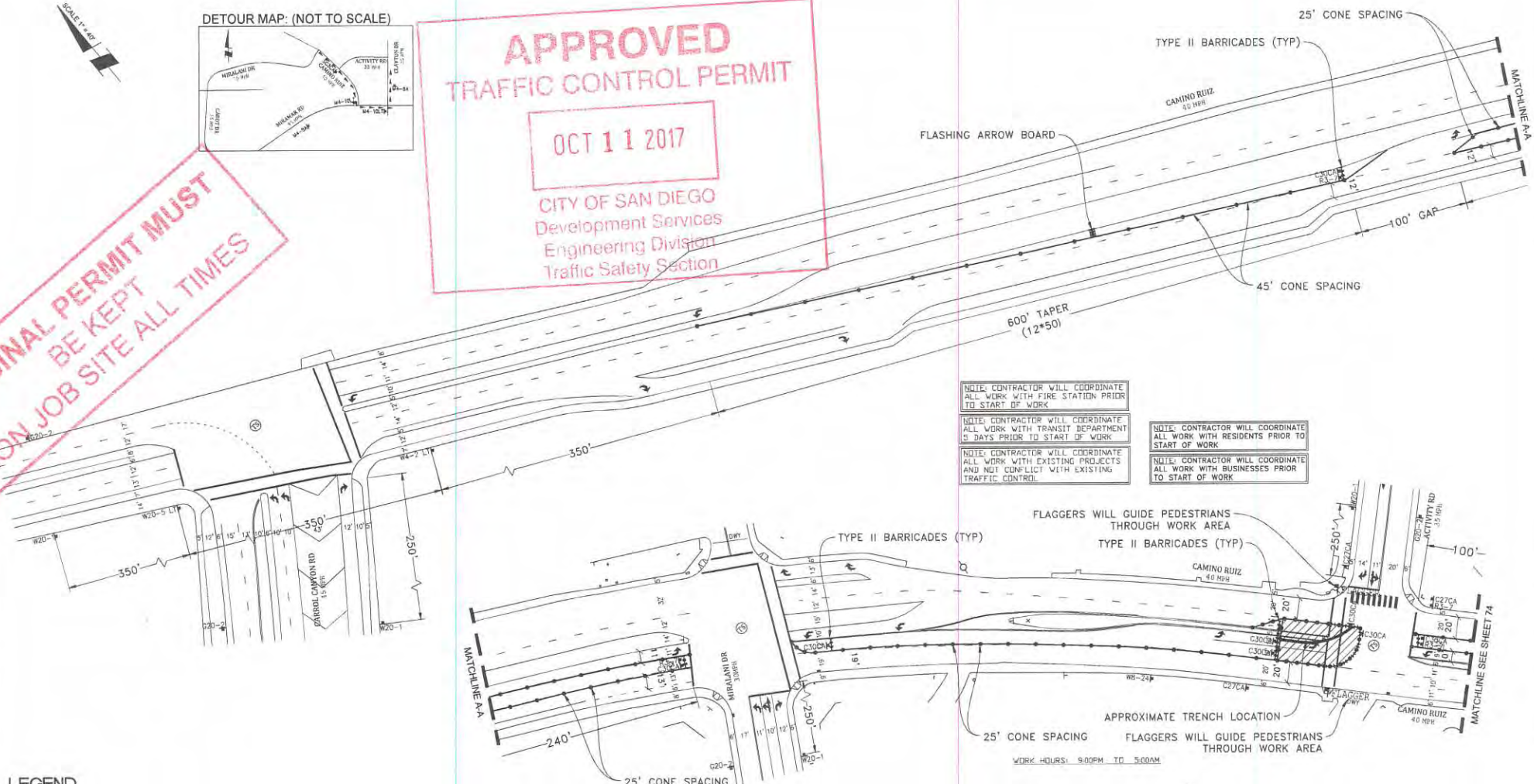

NOTE: CONTRACTOR WILL COORDINATE ALL WORK WITH FIRE STATION PRIOR TO START OF WORK.

NOTE: CONTRACTOR WILL COORDINATE ALL WORK WITH TRANSIT DEPARTMENT 5 DAYS PRIOR TO START OF WORK.

NOTE: CONTRACTOR WILL COORDINATE ALL WORK WITH EXISTING PROJECTS AND NOT CONFLICT WITH EXISTING TRAFFIC CONTROL.

NOTE: CONTRACTOR WILL COORDINATE ALL WORK WITH RESIDENTS PRIOR TO START OF WORK.

NOTE: CONTRACTOR WILL COORDINATE ALL WORK WITH BUSINESSES PRIOR TO START OF WORK.

FLAGGERS WILL GUIDE PEDESTRIANS THROUGH WORK AREA  
TYPE II BARRICADES (TYP)

APPROXIMATE TRENCH LOCATION  
25' CONE SPACING FLAGGERS WILL GUIDE PEDESTRIANS THROUGH WORK AREA

WORK HOURS: 9:00PM TO 3:00AM

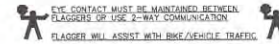

**NIGHT WORK ONLY  
PHASE 61**

**LEGEND**

- SIGN
- SIGNAL
- TRAFFIC CONES / DELINEATOR
- BARRICADE
- FLAGGER
- FLASHING ARROW SIGN
- WORK ZONE
- BUS STOP

NOTE: FLAGGERS WILL PROVIDE ACCESS TO DRIVEWAYS AT ALL TIMES

NOTE: FLAGGERS WILL SAFELY GUIDE PEDESTRIANS THROUGH WORK AREA

NOTE: CONTRACTOR WILL ALLOW FIRE STATION INGRESS AND EGRESS AT ALL TIMES

NOTE: WB-24 (STEEL PLATES) AHEAD SIGNS WILL REMAIN IN PLACE FOR DURATION OF WORK

**DETAIL: FLAGGER ACCESS**

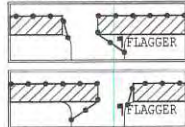

NOTE: DRIVEWAY ACCESS WILL BE PROVIDED AT ALL TIMES WORK WILL BE SPLIT TO PROVIDE ACCESS

UTILITY SURVEYORS, INC.  
**AIRX**  
Gail McMoran  
President  
234 EAST EL MONTE PARKWAY, SUITE C  
ESCONDIDO, CA 92027  
PHONE: (760) 440-2347  
CELL: (760) 419-3738

PROJECT NAME: TL23071 - SYCAMORE CANYON SUBSTATION TO PENASQUITOS - 230 KV UNDERGROUND	
AIRX JOB#: X160218	THOMAS GRID#: -
TYPE OF WORK: TRENCHING / CONDUIT	DRAWN FOR: CITY OF SAN DIEGO
MISC/POTHoles#:	

DATE: Mar. 29, 2017
DESIGNED BY: Clint Jones
<b>SHEET 073 OF 148</b>



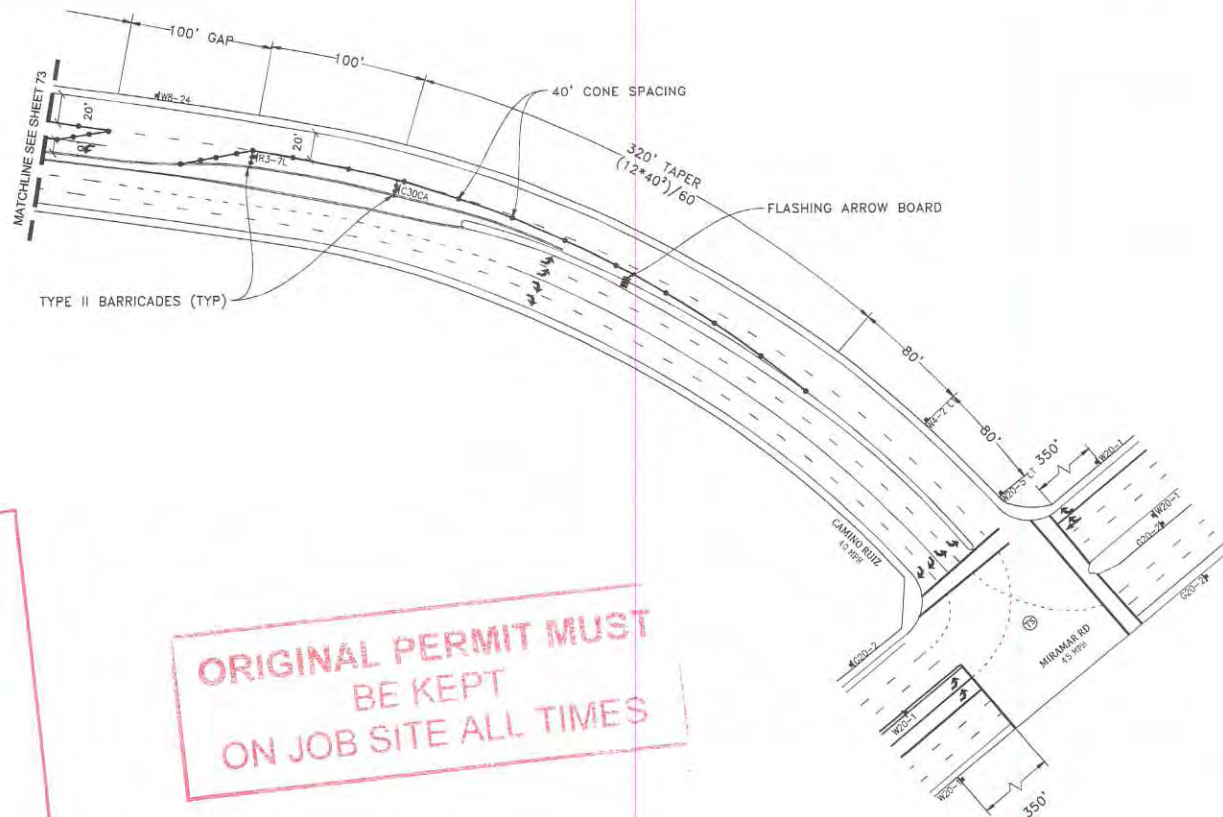

**APPROVED**  
**TRAFFIC CONTROL PERMIT**

OCT 11 2017

CITY OF SAN DIEGO  
 Development Services  
 Engineering Division  
 Traffic Safety Section

**ORIGINAL PERMIT MUST**  
**BE KEPT**  
**ON JOB SITE ALL TIMES**

NOTE: CONTRACTOR WILL COORDINATE ALL WORK WITH FIRE STATION PRIOR TO START OF WORK

NOTE: CONTRACTOR WILL COORDINATE ALL WORK WITH TRANSIT DEPARTMENT 5 DAYS PRIOR TO START OF WORK

NOTE: CONTRACTOR WILL COORDINATE ALL WORK WITH EXISTING PROJECTS AND NOT CONFLICT WITH EXISTING TRAFFIC CONTROL

NOTE: CONTRACTOR WILL COORDINATE ALL WORK WITH RESIDENTS PRIOR TO START OF WORK

NOTE: CONTRACTOR WILL COORDINATE ALL WORK WITH BUSINESSES PRIOR TO START OF WORK

WORK HOURS: \_\_\_\_\_ TO \_\_\_\_\_

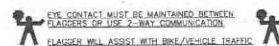

**NIGHT WORK ONLY**  
**PHASE 61 (CONT)**

**LEGEND**

- SIGN
- SIGNAL
- TRAFFIC CONES / DELINEATOR
- BARRICADE
- FLAGGER
- FLASHING ARROW SIGN
- WORK ZONE
- BUS STOP

NOTE: FLAGGERS WILL PROVIDE ACCESS TO DRIVEWAYS AT ALL TIMES

NOTE: FLAGGERS WILL SAFELY GUIDE PEDESTRIANS THROUGH WORK AREA

NOTE: CONTRACTOR WILL ALLOW FIRE STATION INGRESS AND EGRESS AT ALL TIMES

NOTE: W8-24 (STEEL PLATES AHEAD) SIGNS WILL REMAIN IN PLACE FOR DURATION OF WORK

**DETAIL: FLAGGER ACCESS**

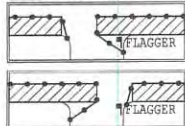

NOTE: DRIVEWAY ACCESS WILL BE PROVIDED AT ALL TIMES WORK WILL BE SPLIT TO PROVIDE ACCESS

**UTILITY SURVEYORS, INC.**  
**Gail McMorran**  
 President  
 2534 EAST EL NORTE PARKWAY, SUITE G  
 ESCONDIDO, CA 92027  
 PHONE: (760) 440-2347  
 CELL: (760) 419-3736

<b>PROJECT NAME:</b> TL23071 - SYCAMORE CANYON SUBSTATION TO PENASQUITOS - 230 KV UNDERGROUND	
AIRX JOB#: X160218	THOMAS GRID#: -
TYPE OF WORK: TRENCHING / CONDUIT	DRAWN FOR: CITY OF SAN DIEGO
MISC/POTHOLE#:	

DATE: Mar. 29, 2017
DESIGNED BY: Clint Jones
<b>SHEET 074 OF 148</b>

SCALE 1" = 40'

**APPROVED**  
**TRAFFIC CONTROL PERMIT**  
**OCT 11 2017**  
 CITY OF SAN DIEGO  
 Development Services  
 Engineering Division  
 Traffic Safety Section

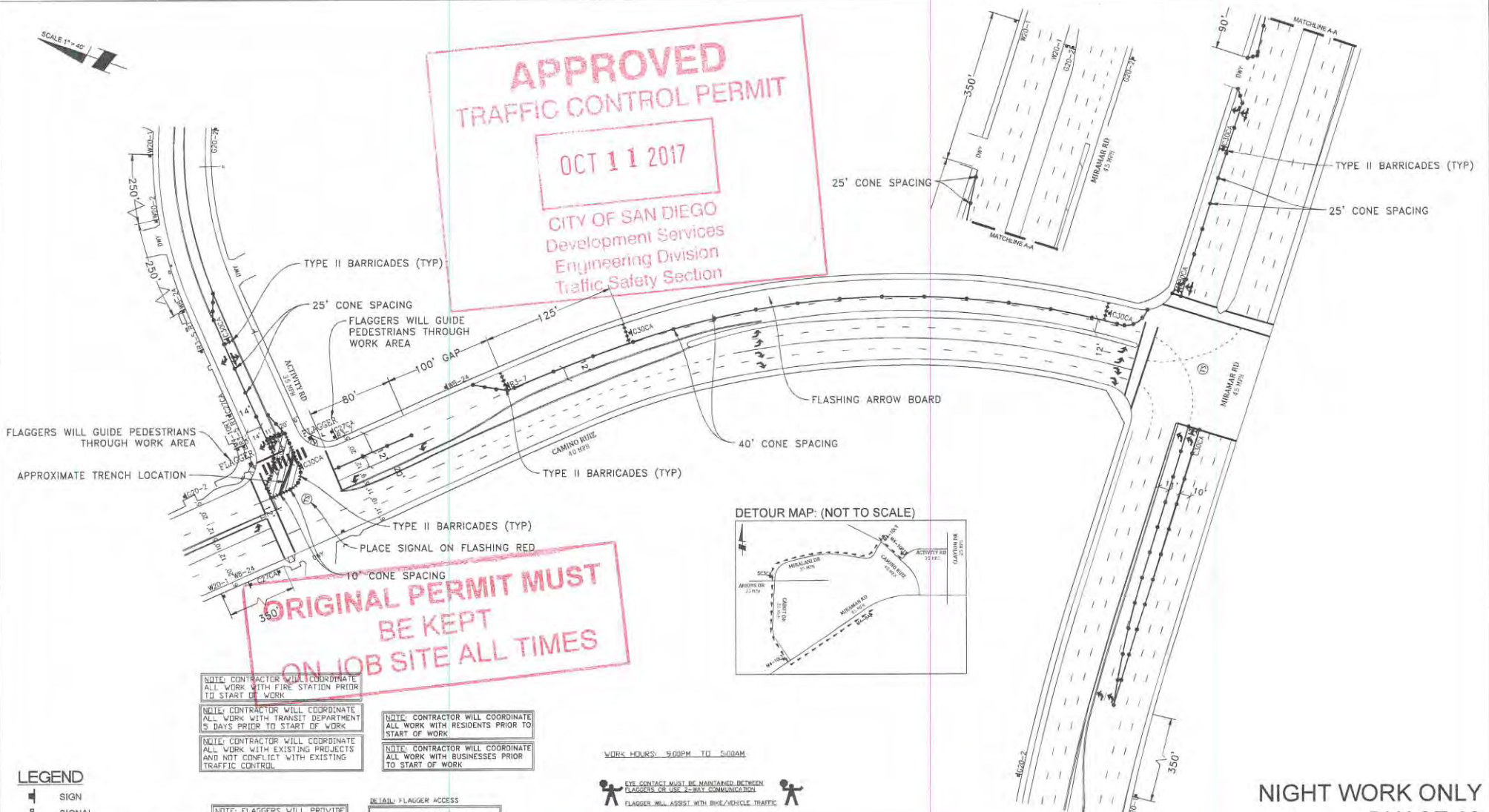

**ORIGINAL PERMIT MUST**  
**BE KEPT**  
**ON JOB SITE ALL TIMES**



- NOTE: CONTRACTOR WILL COORDINATE ALL WORK WITH FIRE STATION PRIOR TO START OF WORK
- NOTE: CONTRACTOR WILL COORDINATE ALL WORK WITH TRANSIT DEPARTMENT 5 DAYS PRIOR TO START OF WORK
- NOTE: CONTRACTOR WILL COORDINATE ALL WORK WITH EXISTING PROJECTS AND NOT CONFLICT WITH EXISTING TRAFFIC CONTROL
- NOTE: CONTRACTOR WILL COORDINATE ALL WORK WITH RESIDENTS PRIOR TO START OF WORK
- NOTE: CONTRACTOR WILL COORDINATE ALL WORK WITH BUSINESSES PRIOR TO START OF WORK

WORK HOURS: 9:00PM TO 5:00AM

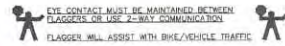

- LEGEND**
- SIGN
  - SIGNAL
  - TRAFFIC CONES / DELINEATOR
  - BARRICADE
  - ⚡ FLAGGER
  - ⚡ FLASHING ARROW SIGN
  - ▨ WORK ZONE
  - 🚌 BUS STOP

- NOTE: FLAGGERS WILL PROVIDE ACCESS TO DRIVEWAYS AT ALL TIMES
- NOTE: FLAGGERS WILL SAFELY GUIDE PEDESTRIANS THROUGH WORK AREA
- NOTE: CONTRACTOR WILL ALLOW FIRE STATION INGRESS AND EGRESS AT ALL TIMES
- NOTE: W8-P4 (STEEL) PLATES AHEAD SIGNS WILL REMAIN IN PLACE FOR DURATION OF WORK
- DETAIL: FLAGGER ACCESS
- 

UTILITY SURVEYORS, INC.  
**AIRX**  
 Gail McMoran  
 President  
 2534 EAST EL NORTE PARKWAY, SUITE C  
 ESCONDO, CA 92027  
 PHONE: (760) 460-8247  
 CELL: (760) 419-3728

<b>PROJECT NAME:</b> TL23071 - SYCAMORE CANYON SUBSTATION TO PENASQUITOS - 230 KV UNDERGROUND	
AIRX JOB#: X160218	THOMAS GRID#: —
TYPE OF WORK: TRENCHING / CONDUIT	DRAWN FOR: CITY OF SAN DIEGO
MISC/POTHOLE#:	

DATE: Mar. 29, 2017
DESIGNED BY: Clint Jones
<b>SHEET 075 OF 148</b>

**NIGHT WORK ONLY**  
**PHASE 62**



SCALE=1"=40'

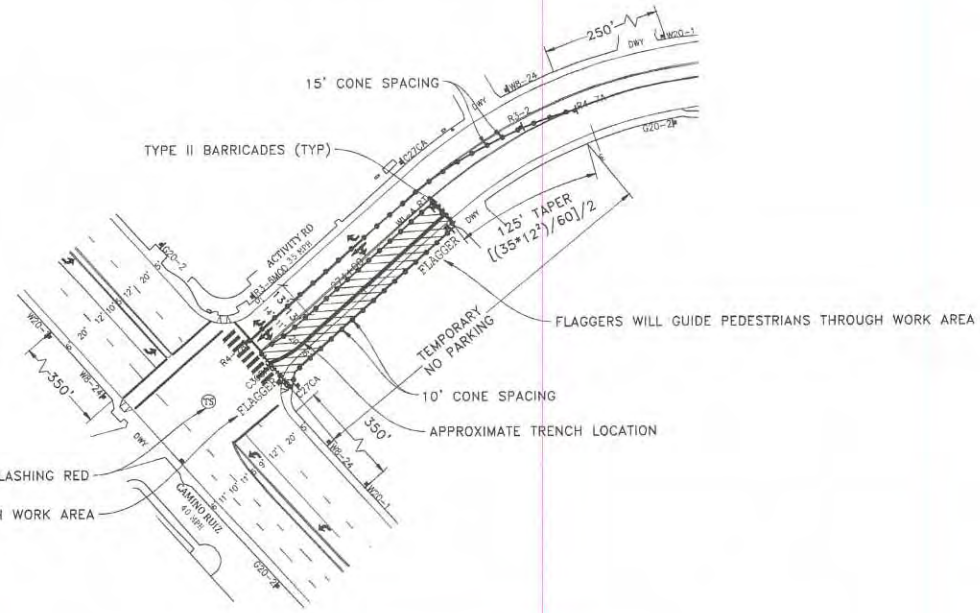

**APPROVED**  
**TRAFFIC CONTROL PERMIT**  
  

**OCT 11 2017**

  
 CITY OF SAN DIEGO  
 Development Services  
 Engineering Division  
 Traffic Safety Section

**ORIGINAL PERMIT MUST  
BE KEPT  
ON JOB SITE ALL TIMES**

NOTE: CONTRACTOR WILL COORDINATE ALL WORK WITH FIRE STATION PRIOR TO START OF WORK.

NOTE: CONTRACTOR WILL COORDINATE ALL WORK WITH TRANSIT DEPARTMENT 5 DAYS PRIOR TO START OF WORK.

NOTE: CONTRACTOR WILL COORDINATE ALL WORK WITH EXISTING PROJECTS AND NOT CONFLICT WITH EXISTING TRAFFIC CONTROL.

NOTE: CONTRACTOR WILL COORDINATE ALL WORK WITH RESIDENTS PRIOR TO START OF WORK.

NOTE: CONTRACTOR WILL COORDINATE ALL WORK WITH BUSINESSES PRIOR TO START OF WORK.

WORK HOURS: 9:00PM TO 5:00AM

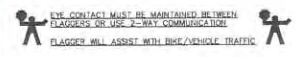

NIGHT WORK ONLY  
PHASE 63

- LEGEND**
- SIGN
  - SIGNAL
  - TRAFFIC CONES / DELINEATOR
  - BARRICADE
  - FLAGGER
  - FLASHING ARROW SIGN
  - WORK ZONE
  - BUS STOP

NOTE: FLAGGERS WILL PROVIDE ACCESS TO DRIVEWAYS AT ALL TIMES

NOTE: FLAGGERS WILL SAFELY GUIDE PEDESTRIANS THROUGH WORK AREA

NOTE: CONTRACTOR WILL ALLOW FIRE STATION INGRESS AND EGRESS AT ALL TIMES

NOTE: W8-24 (STEEL) PLATES AHEAD SIGNS WILL REMAIN IN PLACE FOR DURATION OF WORK

DETAIL FLAGGER ACCESS

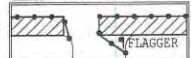

NOTE: DRIVEWAY ACCESS WILL BE PROVIDED AT ALL TIMES WORK WILL BE SPLIT TO PROVIDE ACCESS

**UTILITY SURVEYORS, INC.**

**AIRX**

Gail McMorran  
President

2534 EAST EL NORTE PARKWAY, SUITE C  
ESCONDIDO CA 92027  
PHONE: (760) 480-2347  
CELL: (760) 418-3728

<b>PROJECT NAME:</b> TL23071 - SYCAMORE CANYON SUBSTATION TO PENASQUITOS - 230 KV UNDERGROUND	
<b>AIRX JOB#:</b> X160218	<b>THOMAS GRID#:</b> -
<b>TYPE OF WORK:</b> TRENCHING / CONDUIT	<b>DRAWN FOR:</b> CITY OF SAN DIEGO
<b>MISC/POTHOLE#:</b>	

<b>DATE:</b> Mar. 29, 2017
<b>DESIGNED BY:</b> Clint Jones
<b>SHEET 076 OF 148</b>





SCALE 1" = 40'

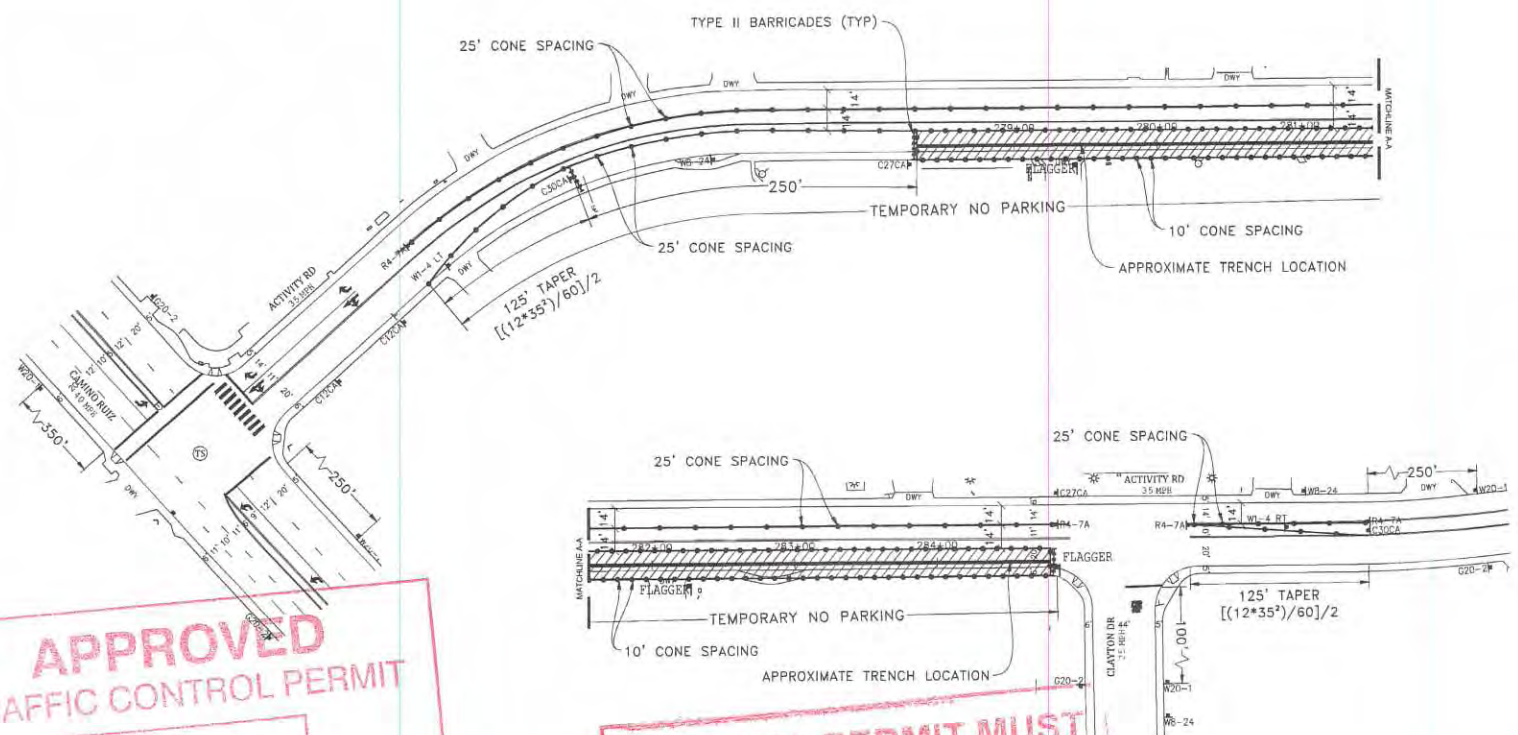

**APPROVED**  
**TRAFFIC CONTROL PERMIT**

OCT 11 2017

CITY OF SAN DIEGO  
 Development Services  
 Engineering Division  
 Traffic Safety Section

**ORIGINAL PERMIT MUST**  
**BE KEPT**  
**ON JOB SITE ALL TIMES**

NOTE: CONTRACTOR WILL COORDINATE ALL WORK WITH FIRE STATION PRIOR TO START OF WORK

NOTE: CONTRACTOR WILL COORDINATE ALL WORK WITH TRANSIT DEPARTMENT 5 DAYS PRIOR TO START OF WORK

NOTE: CONTRACTOR WILL COORDINATE ALL WORK WITH EXISTING PROJECTS AND NOT CONFLICT WITH EXISTING TRAFFIC CONTROL

NOTE: CONTRACTOR WILL COORDINATE ALL WORK WITH RESIDENTS PRIOR TO START OF WORK

NOTE: CONTRACTOR WILL COORDINATE ALL WORK WITH BUSINESSES PRIOR TO START OF WORK

WORK HOURS: 9:00PM TO 5:00AM

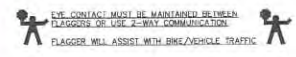

**NIGHT WORK ONLY**  
**PHASE 65**

- LEGEND**
- SIGN
  - SIGNAL
  - TRAFFIC CONES / DELINEATOR
  - BARRICADE
  - FLAGGER
  - FLASHING ARROW SIGN
  - WORK ZONE
  - BUS STOP

NOTE: FLAGGERS WILL PROVIDE ACCESS TO DRIVEWAYS AT ALL TIMES

NOTE: FLAGGERS WILL SAFELY GUIDE PEDESTRIANS THROUGH WORK AREA

NOTE: CONTRACTOR WILL ALLOW FIRE STATION INGRESS AND EGRESS AT ALL TIMES

NOTE: W8-P4 STEEL PLATES AHEAD SIGNS WILL REMAIN IN PLACE FOR DURATION OF WORK

DETAIL: FLAGGER ACCESS

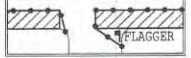

NOTE: DRIVEWAY ACCESS WILL BE PROVIDED AT ALL TIMES WORK WILL BE SPLIT TO PROVIDE ACCESS

**UTILITY SURVEYORS, INC.**  
**AIRX**  
 2334 EAST EL NORTE PARKWAY, SUITE C  
 ESCONDIDO, CA 92027  
 PHONE: (760) 440-2547  
 CELL: (760) 419-3738

**Gail McMorran**  
 President

<b>PROJECT NAME:</b> TL23071 - SYCAMORE CANYON SUBSTATION TO PENASQUITOS - 230 KV UNDERGROUND	
<b>AIRX JOB#:</b> X160218	<b>THOMAS GRID#:</b> -
<b>TYPE OF WORK:</b> TRENCHING / CONDUIT	<b>DRAWN FOR:</b> CITY OF SAN DIEGO
<b>MISC/POTHOLE#:</b>	

<b>DATE:</b> Mar. 29, 2017
<b>DESIGNED BY:</b> Clint Jones
<b>SHEET 078 OF 148</b>

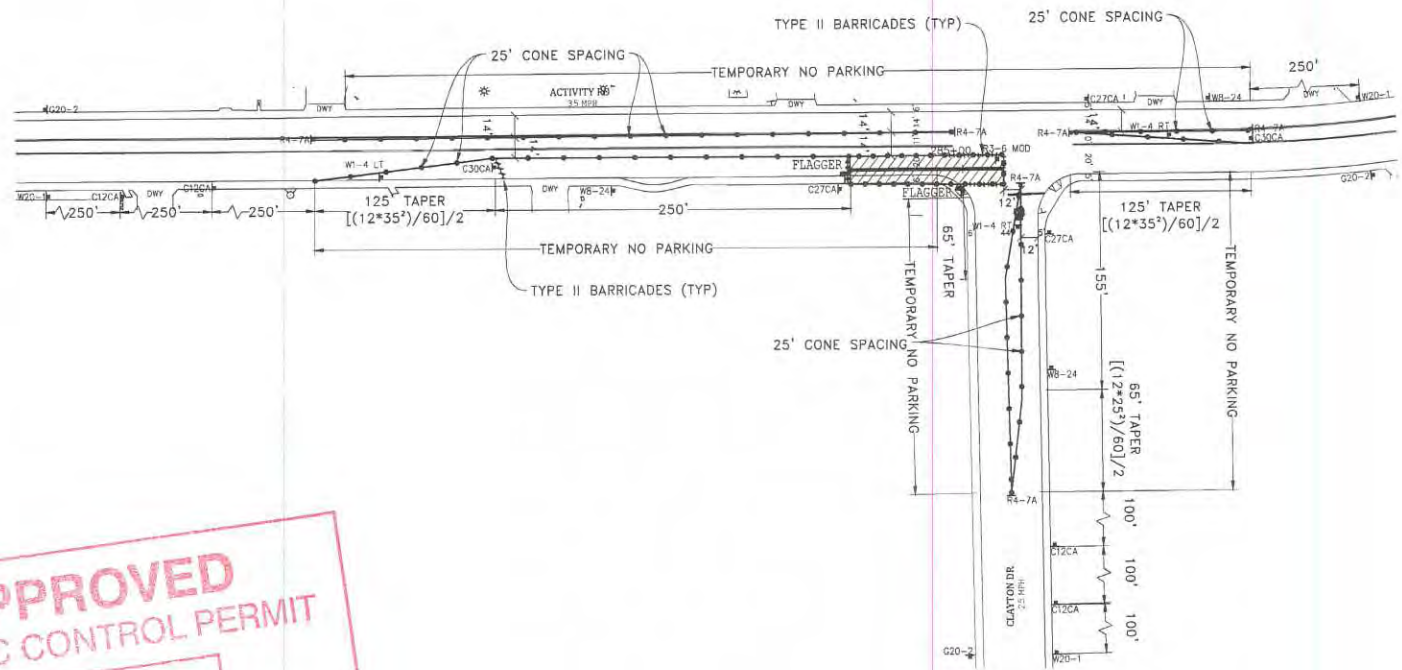

**APPROVED**  
**TRAFFIC CONTROL PERMIT**  
  

**OCT 11 2017**

  
 CITY OF SAN DIEGO  
 Development Services  
 Engineering Division  
 Traffic Safety Section

**ORIGINAL PERMIT MUST**  
**BE KEPT**  
**ON JOB SITE ALL TIMES**

- LEGEND**
- SIGN
  - SIGNAL
  - TRAFFIC CONES / DELINEATOR
  - BARRICADE
  - FLAGGER
  - FLASHING ARROW SIGN
  - WORK ZONE
  - BUS STOP

NOTE: FLAGGERS WILL PROVIDE ACCESS TO DRIVEWAYS AT ALL TIMES

NOTE: FLAGGERS WILL SAFELY GUIDE PEDESTRIANS THROUGH WORK AREA

NOTE: CONTRACTOR WILL ALLOW FIRE STATION INGRESS AND EGRESS AT ALL TIMES

NOTE: WB-P4 (STEEL PLATES) ALREADY SIGNS WILL REMAIN IN PLACE FOR DURATION OF WORK

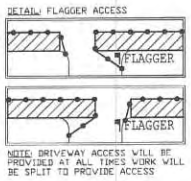

NOTE: CONTRACTOR WILL COORDINATE ALL WORK WITH FIRE STATION PRIOR TO START OF WORK

NOTE: CONTRACTOR WILL COORDINATE ALL WORK WITH TRANSIT DEPARTMENT 5 DAYS PRIOR TO START OF WORK

NOTE: CONTRACTOR WILL COORDINATE ALL WORK WITH EXISTING PROJECTS AND NOT CONFLICT WITH EXISTING TRAFFIC CONTROL

NOTE: CONTRACTOR WILL COORDINATE ALL WORK WITH RESIDENTS PRIOR TO START OF WORK

NOTE: CONTRACTOR WILL COORDINATE ALL WORK WITH BUSINESSES PRIOR TO START OF WORK

WORK HOURS: \_\_\_\_\_ TO \_\_\_\_\_

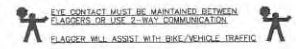

**NIGHT WORK ONLY**  
**PHASE 66**

**UTILITY SURVEYORS, INC.**  
  
**Gail McMoran**  
 President  
 2334 EAST EL MONTE PARKWAY, SUITE C  
 ESCONDO, CA 92027  
 PHONE: (760) 480-2347  
 CELL: (760) 418-3738

<b>PROJECT NAME:</b> TL23071 - SYCAMORE CANYON SUBSTATION TO PENASQUITOS - 230 KV UNDERGROUND	
<b>AIRX JOB#:</b> X160218	<b>THOMAS GRID#:</b> -
<b>TYPE OF WORK:</b> TRENCHING / CONDUIT	<b>DRAWN FOR:</b> CITY OF SAN DIEGO
<b>MISC/POTHOLE#:</b>	









<b>DATE:</b> Mar. 29, 2017
<b>DESIGNED BY:</b> Clint Jones
<b>SHEET 079 OF 148</b>





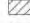

**LEGEND**

-  SIGN
-  SIGNAL
-  TRAFFIC CONES / DELINEATOR
-  BARRICADE
-  FLAGGER
-  FLASHING ARROW SIGN
-  WORK ZONE
-  BUS STOP

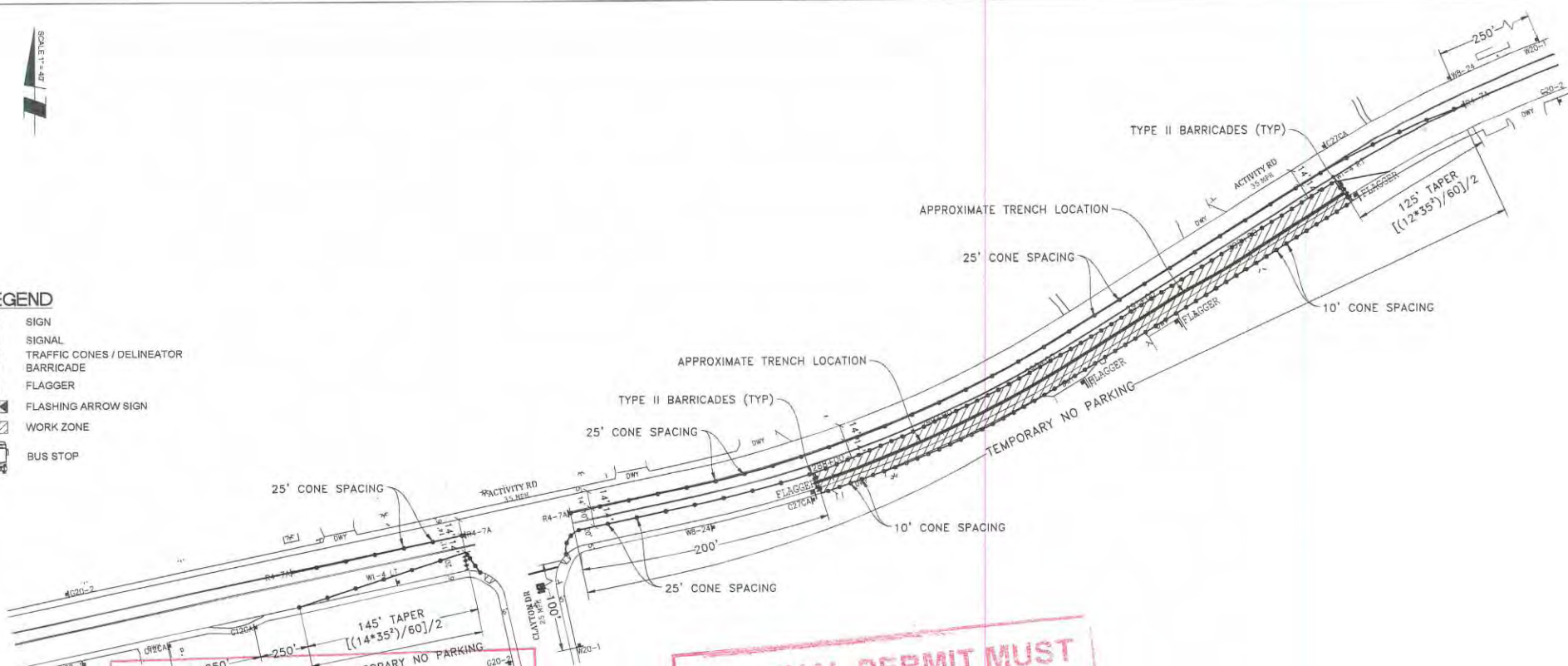

APPROVED  
TRAFFIC CONTROL PERMIT

OCT 11 2017

CITY OF SAN DIEGO  
Development Services  
Engineering Division  
Safety Section

ORIGINAL PERMIT MUST  
BE KEPT  
ON JOB SITE ALL TIMES

**NOTE:** FLAGGERS WILL PROVIDE ACCESS TO DRIVEWAYS AT ALL TIMES

**NOTE:** FLAGGERS WILL SAFELY GUIDE PEDESTRIANS THROUGH WORK AREA

**NOTE:** CONTRACTOR WILL ALLOW FIRE STATION INGRESS AND EGRESS AT ALL TIMES

**NOTE:** WB-24 STEEL PLATES AHEAD SIGNS WILL REMAIN IN PLACE FOR DURATION OF WORK

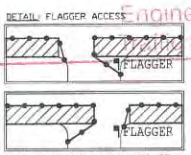

**NOTE:** CONTRACTOR WILL COORDINATE ALL WORK WITH FIRE STATION PRIOR TO START OF WORK

**NOTE:** CONTRACTOR WILL COORDINATE ALL WORK WITH TRANSIT DEPARTMENT 5 DAYS PRIOR TO START OF WORK

**NOTE:** CONTRACTOR WILL COORDINATE ALL WORK WITH EXISTING PROJECTS AND NOT CONFLICT WITH EXISTING TRAFFIC CONTROL

**NOTE:** CONTRACTOR WILL COORDINATE ALL WORK WITH RESIDENTS PRIOR TO START OF WORK

**NOTE:** CONTRACTOR WILL COORDINATE ALL WORK WITH BUSINESSES PRIOR TO START OF WORK

**WORK HOURS: 9:00PM TO 5:00AM**

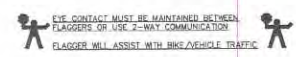

**UTILITY SURVEYORS, INC.**  
**AIRX**  
Gail McMorran  
President  
2534 EAST EL NORTE PARKWAY, SUITE C  
ESCONDIDO, CA 92027  
PHONE: (760) 440-5347  
CELL: (760) 418-3728

<b>PROJECT NAME:</b> TL23071 - SYCAMORE CANYON SUBSTATION TO PENASQUITOS - 230 KV UNDERGROUND	
<b>AIRX JOB#:</b> X160218	<b>THOMAS GRID#:</b> -
<b>TYPE OF WORK:</b> TRENCHING / CONDUIT	<b>DRAWN FOR:</b> CITY OF SAN DIEGO
<b>MISC/POTHOLE#:</b>	

**NIGHT WORK ONLY  
PHASE 68**

<b>DATE:</b> Mar. 29, 2017
<b>DESIGNED BY:</b> Clint Jones
<b>SHEET 081 OF 148</b>





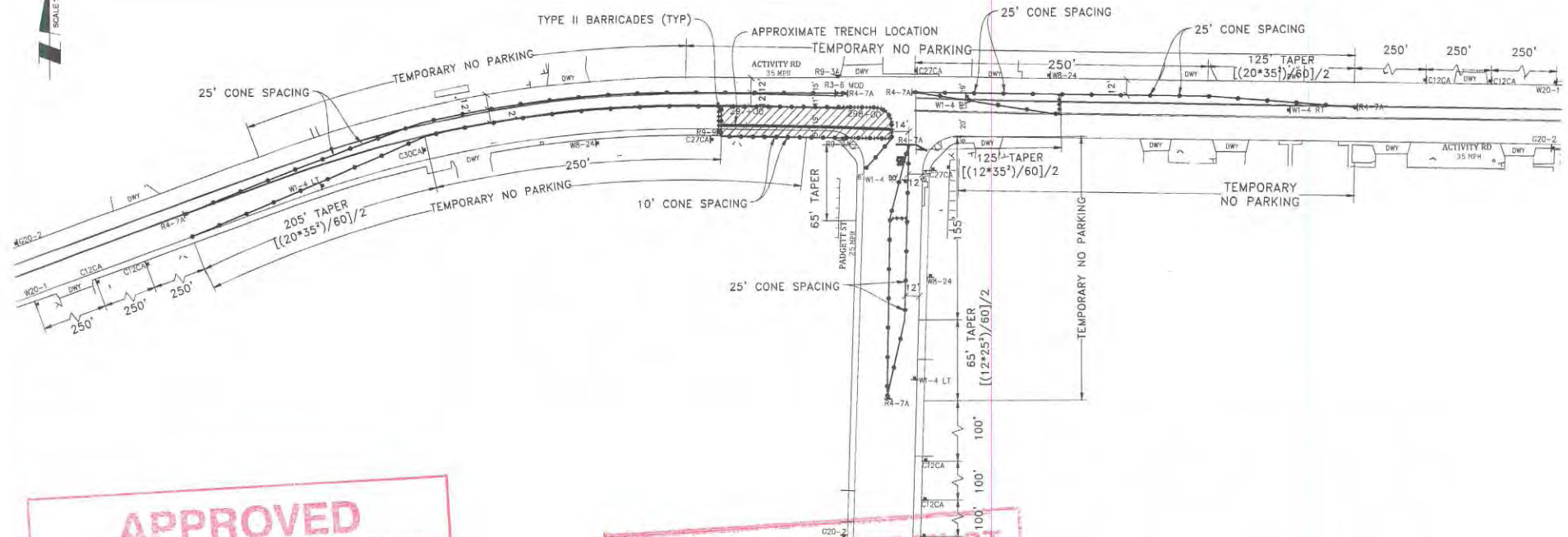

APPROVED  
TRAFFIC CONTROL PERMIT

OCT 11 2017

CITY OF SAN DIEGO  
Development Services  
Engineering Division  
Traffic Safety Section

ORIGINAL PERMIT MUST  
BE KEPT  
ON JOB SITE ALL TIMES

- LEGEND**
- SIGNAL
  - TRAFFIC CONES / DELINEATOR
  - BARRICADE
  - FLAGGER
  - FLASHING ARROW SIGN
  - WORK ZONE
  - BUS STOP

NOTE: FLAGGERS WILL PROVIDE ACCESS TO DRIVEWAYS AT ALL TIMES

NOTE: FLAGGERS WILL SAFELY GUIDE PEDESTRIANS THROUGH WORK AREA

NOTE: CONTRACTOR WILL ALLOW FIRE STATION INGRESS AND EGRESS AT ALL TIMES

NOTE: WR-24 (STEEL PLATES) AHEAD SIGNS WILL REMAIN IN PLACE FOR DURATION OF WORK

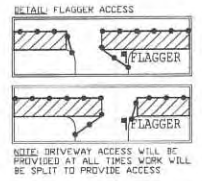

NOTE: CONTRACTOR WILL COORDINATE ALL WORK WITH FIRE STATION PRIOR TO START OF WORK

NOTE: CONTRACTOR WILL COORDINATE ALL WORK WITH TRANSIT DEPARTMENT 5 DAYS PRIOR TO START OF WORK

NOTE: CONTRACTOR WILL COORDINATE ALL WORK WITH EXISTING PROJECTS AND NOT CONFLICT WITH EXISTING TRAFFIC CONTROL

NOTE: CONTRACTOR WILL COORDINATE ALL WORK WITH RESIDENTS PRIOR TO START OF WORK

NOTE: CONTRACTOR WILL COORDINATE ALL WORK WITH BUSINESSES PRIOR TO START OF WORK

WORK HOURS: 9:00PM TO 5:00AM

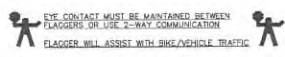

NIGHT WORK ONLY  
PHASE 70

**UTILITY SURVEYORS, INC.**  
**AIRX**  
234 EAST EL NORTE PARKWAY, SUITE C  
ESCONDIDO, CA 92027  
PHONE: (760) 460-2347  
CELL: (760) 419-3738

**Gail McMoran**  
President

<b>PROJECT NAME:</b> TL23071 - SYCAMORE CANYON SUBSTATION TO PENASQUITOS - 230 KV UNDERGROUND	
<b>AIRX JOB#:</b> X160218	<b>THOMAS GRID#:</b> -
<b>TYPE OF WORK:</b> TRENCHING / CONDUIT	<b>DRAWN FOR:</b> CITY OF SAN DIEGO
<b>MISC/POTHOLES#:</b>	

<b>DATE:</b> Mar. 29, 2017
<b>DESIGNED BY:</b> Clint Jones
SHEET 083 OF 148





SCALE 1" = 40'

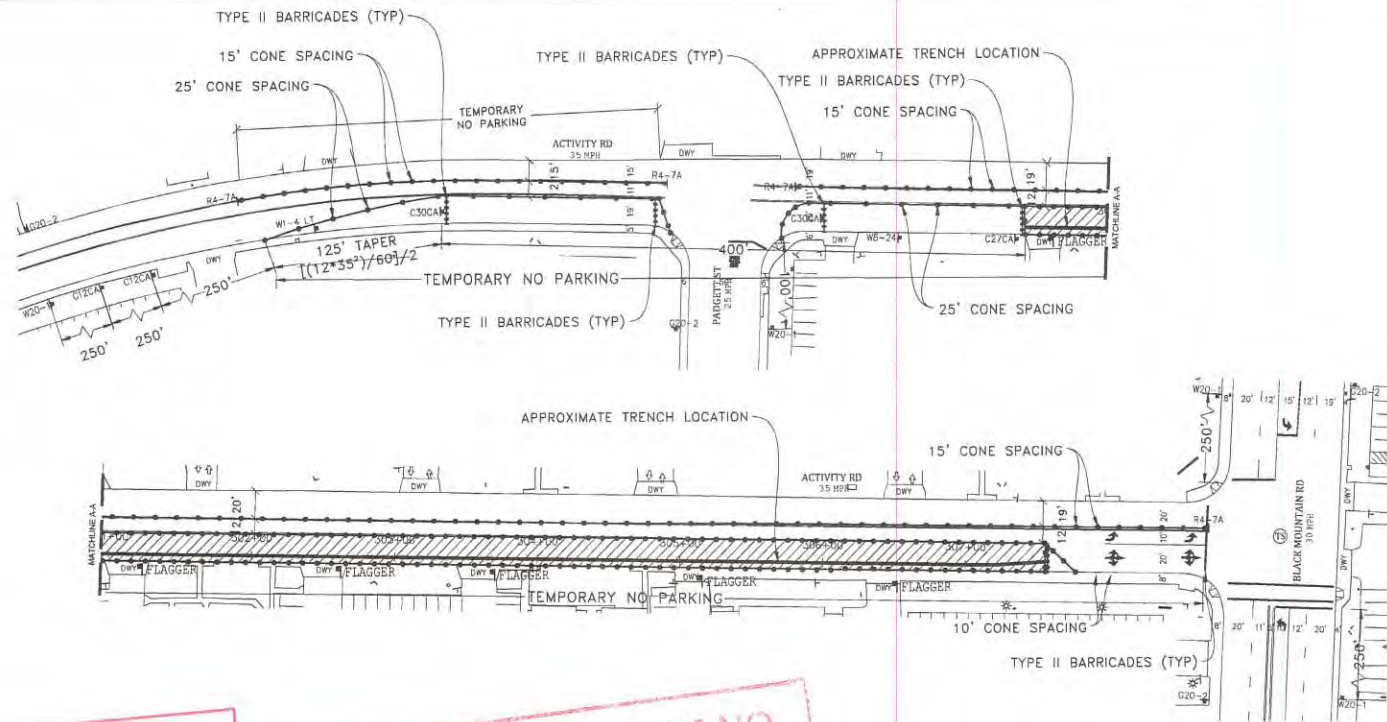

**APPROVED**  
TRAFFIC CONTROL PERMIT

OCT 11 2017

CITY OF SAN DIEGO  
Development Services  
Engineering Division  
Traffic Safety Section

ORIGINAL PERMIT MUST  
BE KEPT  
ON JOB SITE ALL TIMES

NOTE: CONTRACTOR WILL BREAK THIS  
PHASE INTO MULTIPLE STAGES EACH  
STAGE SHALL NOT BE LONGER THAN 250'

WORK HOURS: 5:00PM TO 5:00AM

**LEGEND**

- SIGN
- SIGNAL
- TRAFFIC CONES / DELINEATOR
- BARRICADE
- FLAGGER
- FLASHING ARROW SIGN
- WORK ZONE
- BUS STOP

NOTE: FLAGGERS WILL PROVIDE ACCESS TO DRIVEWAYS AT ALL TIMES

NOTE: FLAGGERS WILL SAFELY GUIDE PEDESTRIANS THROUGH WORK AREA

NOTE: CONTRACTOR WILL ALLOW FIRE STATION INGRESS AND EGRESS AT ALL TIMES

NOTE: W8-24 (STEEL PLATES AHEAD) SIGNS WILL REMAIN IN PLACE FOR DURATION OF WORK

**DETAIL: FLAGGER ACCESS**

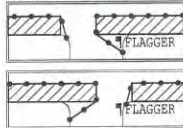

NOTE: DRIVEWAY ACCESS WILL BE PROVIDED AT ALL TIMES WORK WILL BE SPLIT TO PROVIDE ACCESS

NOTE: CONTRACTOR WILL COORDINATE ALL WORK WITH FIRE STATION PRIOR TO START OF WORK

NOTE: CONTRACTOR WILL COORDINATE ALL WORK WITH TRANSIT DEPARTMENT 5 DAYS PRIOR TO START OF WORK

NOTE: CONTRACTOR WILL COORDINATE ALL WORK WITH EXISTING PROJECTS AND NOT CONFLICT WITH EXISTING TRAFFIC CONTROL

NOTE: CONTRACTOR WILL COORDINATE ALL WORK WITH RESIDENTS PRIOR TO START OF WORK

NOTE: CONTRACTOR WILL COORDINATE ALL WORK WITH BUSINESSES PRIOR TO START OF WORK

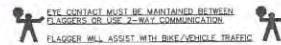

**NIGHT WORK ONLY**  
**PHASE 72**

UTILITY SURVEYORS, INC.  
**AIRX**  
Gail McMorran  
President  
234 EAST EL MONTE PARKWAY, SUITE C  
ESCONDIDO, CA 92027  
PHONE: (760) 460-2347  
CELL: (760) 410-3728

<b>PROJECT NAME:</b> TL23071 - SYCAMORE CANYON SUBSTATION TO PENASQUITOS - 230 KV UNDERGROUND	
AIRX JOB#: X160218	THOMAS GRID#: -
TYPE OF WORK: TRENCHING / CONDUIT	DRAWN FOR: CITY OF SAN DIEGO
MISC/POTHoles#:	

DATE: Mar. 29, 2017
DESIGNED BY: Clint Jones
<b>SHEET 085 OF 148</b>



ORIGINAL PERMIT MUST  
ON JOB SITE ALL TIMES

APPROVED  
TRAFFIC CONTROL PERMIT

OCT 11 2017

CITY OF SAN DIEGO  
Development Services  
Engineering Division  
Traffic Safety Section

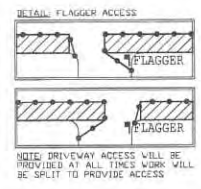
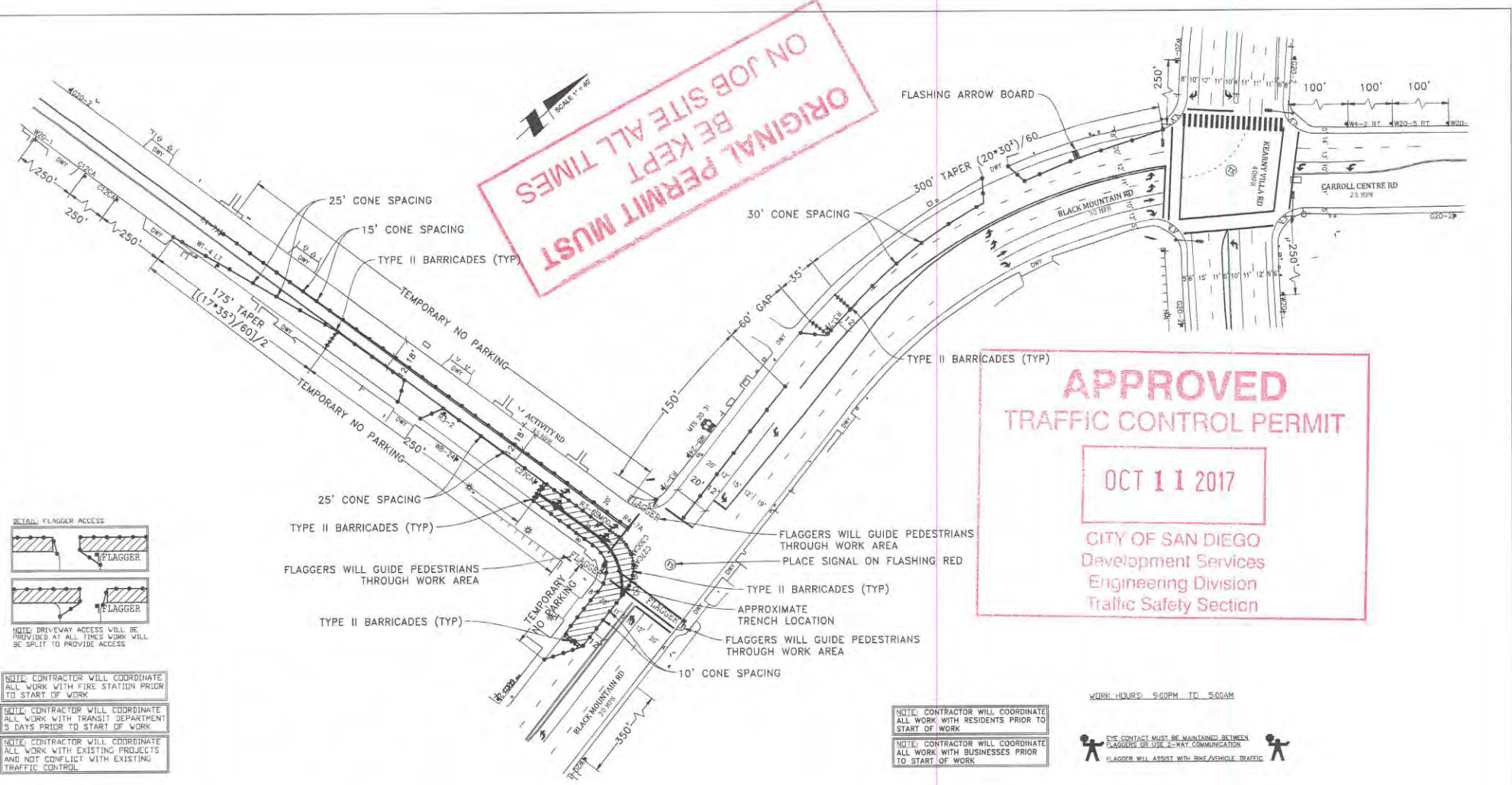

**NOTE:** CONTRACTOR WILL COORDINATE ALL WORK WITH FIRE STATION PRIOR TO START OF WORK

**NOTE:** CONTRACTOR WILL COORDINATE ALL WORK WITH TRANSIT DEPARTMENT 5 DAYS PRIOR TO START OF WORK

**NOTE:** CONTRACTOR WILL COORDINATE ALL WORK WITH EXISTING PROJECTS AND NOT CONFLICT WITH EXISTING TRAFFIC CONTROL

**NOTE:** CONTRACTOR WILL COORDINATE ALL WORK WITH RESIDENTS PRIOR TO START OF WORK

**NOTE:** CONTRACTOR WILL COORDINATE ALL WORK WITH BUSINESSES PRIOR TO START OF WORK

WORK HOURS: 9:00PM TO 5:00AM

EYE CONTACT MUST BE MAINTAINED BETWEEN FLAGGERS OR USE 2-WAY COMMUNICATION

FLAGGER WILL ASSIST WITH BIKE/VEHICLE TRAFFIC

- LEGEND**
- SIGN
  - SIGNAL
  - TRAFFIC CONES / DELINEATOR
  - BARRICADE
  - FLAGGER
  - FLASHING ARROW SIGN
  - WORK ZONE
  - BUS STOP

**NOTE:** FLAGGERS WILL PROVIDE ACCESS TO DRIVEWAYS AT ALL TIMES

**NOTE:** FLAGGERS WILL SAFELY GUIDE PEDESTRIANS THROUGH WORK AREA

**NOTE:** CONTRACTOR WILL ALLOW FIRE STATION INGRESS AND EGRESS AT ALL TIMES

**NOTE:** W8-24 STEEL PLATES AHEAD SIGNS WILL REMAIN IN PLACE FOR DURATION OF WORK

UTILITY SURVEYORS, INC.

**AIRX**

Gail McMoran  
President

2251 EAST EL NORTE PARKWAY, SUITE C  
ESCONDIDO, CA 92027  
PHONE: (760) 480-2547  
CELL: (760) 419-3728

<b>PROJECT NAME:</b> TL23071 - SYCAMORE CANYON SUBSTATION TO PENASQUITOS - 230 KV UNDERGROUND	
<b>AIRX JOB#:</b> X160218	<b>THOMAS GRID#:</b> -
<b>TYPE OF WORK:</b> TRENCHING / CONDUIT	<b>DRAWN FOR:</b> CITY OF SAN DIEGO
<b>MISC/POTHoles#:</b>	

**DATE:** Mar. 29, 2017

**DESIGNED BY:** Clint Jones

**SHEET 086 OF 148**

NIGHT WORK ONLY  
PHASE 73

SCALE 1" = 40'

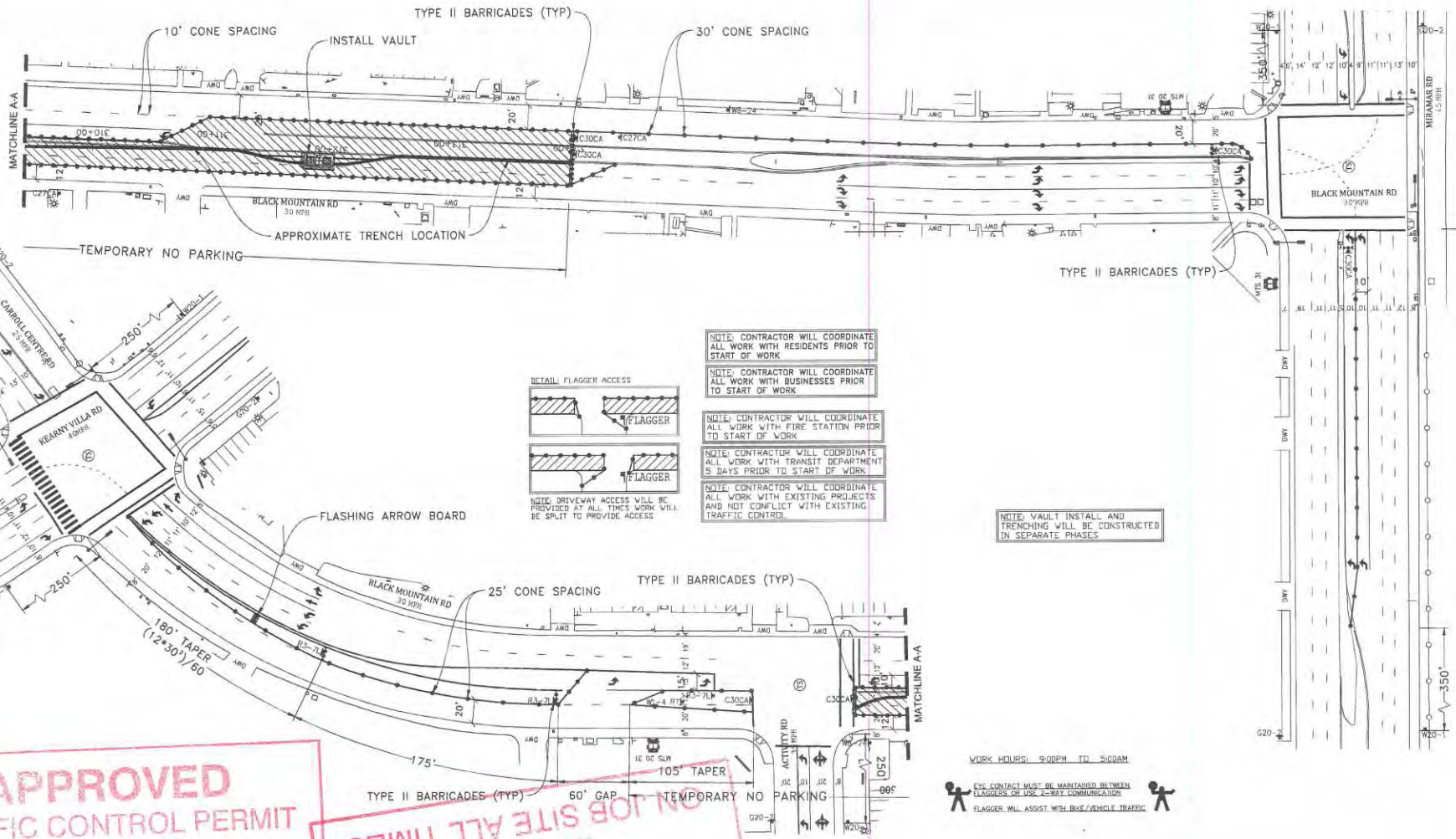

**APPROVED**  
**TRAFFIC CONTROL PERMIT**

OCT 11 2017

NOTE: FLAGGERS WILL PROVIDE ACCESS TO DRIVEWAYS AT ALL TIMES

NOTE: FLAGGERS WILL SAFELY GUIDE PEDESTRIANS THROUGH WORK AREA

NOTE: CONTRACTOR WILL ALLOW FIRE STATION INGRESS AND EGRESS AT ALL TIMES

NOTE: WR-20 (STEEL PLATES) ARE TO REMAIN IN PLACE FOR DURATION OF WORK

CITY OF SAN DIEGO  
Dev  
En  
Traffic Safety Section

**ON JOB SITE ALL TIMES**  
**ORIGINAL PERMIT MUST BE KEPT**

- LEGEND**
- SIGN
  - ⊞ SIGNAL
  - TRAFFIC CONES / DELINEATOR
  - BARRICADE
  - ⚡ FLAGGER
  - ⚡ FLASHING ARROW SIGN
  - ▨ WORK ZONE
  - 🚌 BUS STOP

UTILITY SURVEYORS, INC.

**AIRX**

Gail McMorran  
President

2534 EAST EL NORTE PARKWAY, SUITE C  
ESCONDIDO, CA 92027  
PHONE: (760) 480-2547  
CELL: (760) 419-3738

PROJECT NAME: TL23071 - SYCAMORE CANYON SUBSTATION TO PENASQUITOS - 230 KV UNDERGROUND	
AIRX JOB#: X160218	THOMAS GRID#: -
TYPE OF WORK: TRENCHING / CONDUIT	DRAWN FOR: CITY OF SAN DIEGO
MISC/POTHOLE#:	

DATE: Mar. 29, 2017
DESIGNED BY: Clint James
SHEET 087 OF 148

**NIGHT WORK ONLY**  
**PHASE 74**



SCALE 1" = 40'

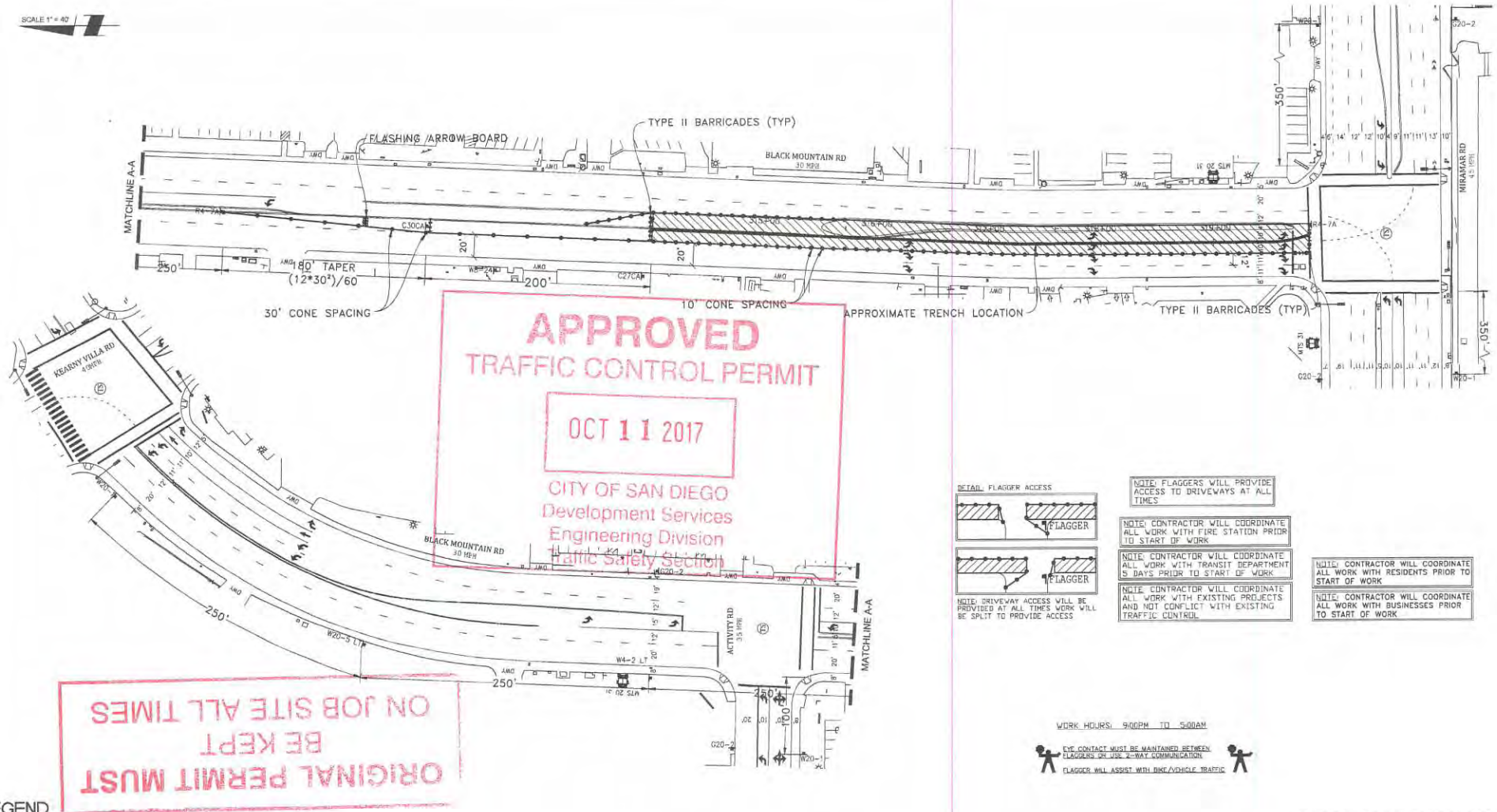

**APPROVED  
TRAFFIC CONTROL PERMIT**

**OCT 11 2017**

CITY OF SAN DIEGO  
Development Services  
Engineering Division  
Traffic Safety Section

**ORIGINAL PERMIT MUST  
BE KEPT  
ON JOB SITE ALL TIMES**

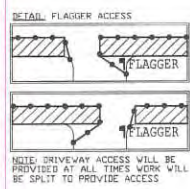

NOTE: FLAGGERS WILL PROVIDE ACCESS TO DRIVEWAYS AT ALL TIMES

NOTE: CONTRACTOR WILL COORDINATE ALL WORK WITH FIRE STATION PRIOR TO START OF WORK

NOTE: CONTRACTOR WILL COORDINATE ALL WORK WITH TRANSIT DEPARTMENT 5 DAYS PRIOR TO START OF WORK

NOTE: CONTRACTOR WILL COORDINATE ALL WORK WITH EXISTING PROJECTS AND NOT CONFLICT WITH EXISTING TRAFFIC CONTROL

NOTE: CONTRACTOR WILL COORDINATE ALL WORK WITH RESIDENTS PRIOR TO START OF WORK

NOTE: CONTRACTOR WILL COORDINATE ALL WORK WITH BUSINESSES PRIOR TO START OF WORK

WORK HOURS: 9:00PM TO 5:00AM

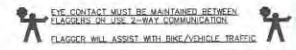

- LEGEND**
- SIGN
  - SIGNAL
  - TRAFFIC CONES / DELINEATOR
  - BARRICADE
  - FLAGGER
  - FLASHING ARROW SIGN
  - WORK ZONE
  - BUS STOP

NOTE: FLAGGERS WILL SAFELY GUIDE PEDESTRIANS THROUGH WORK AREA

NOTE: CONTRACTOR WILL ALLOW FIRE STATION INGRESS AND EGRESS AT ALL TIMES

NOTE: W8-24 (STEEL PLATES AHEAD) SIGNS WILL REMAIN IN PLACE FOR DURATION OF WORK

UTILITY SURVEYORS, INC.

**AIRX**

Gail McMorran  
President

2534 EAST EL NORTE PARKWAY, SUITE C  
ESCONDIDO, CA 92027  
PHONE: (760) 460-2547  
CELL: (760) 419-3738

<b>PROJECT NAME:</b> TL23071 - SYCAMORE CANYON SUBSTATION TO PENASQUITOS - 230 KV UNDERGROUND	
<b>AIRX JOB#:</b> X16Q218	<b>THOMAS GRID#:</b> -
<b>TYPE OF WORK:</b> TRENCHING / CONDUIT	<b>DRAWN FOR:</b> CITY OF SAN DIEGO
<b>MISC/POTHOLE#:</b>	

**DATE:** Mar. 29, 2017

**DESIGNED BY:** Clint Jones

**SHEET 088 OF 148**

**NIGHT WORK ONLY  
PHASE 75**

SCALE 1" = 40'

**LEGEND**

- SIGN
- SIGNAL
- TRAFFIC CONES / DELINEATOR
- BARRICADE
- FLAGGER
- FLASHING ARROW SIGN
- WORK ZONE
- BUS STOP

NOTE: FLAGGERS WILL PROVIDE ACCESS TO DRIVEWAYS AT ALL TIMES

NOTE: FLAGGERS WILL SAFELY GUIDE PEDESTRIANS THROUGH WORK AREA

NOTE: CONTRACTOR WILL ALLOW FIRE STATION INGRESS AND EGRESS AT ALL TIMES

NOTE: WB-24 (STEEL PLATES AHEAD) SIGNS WILL REMAIN IN PLACE FOR DURATION OF WORK

**DETAIL FLAGGER ACCESS**

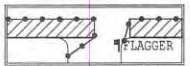
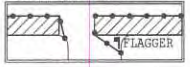

NOTE: DRIVEWAY ACCESS WILL BE PROVIDED AT ALL TIMES WORK WILL BE SPLIT TO PROVIDE ACCESS

NOTE: CONTRACTOR WILL COORDINATE ALL WORK WITH FIRE STATION PRIOR TO START OF WORK

NOTE: CONTRACTOR WILL COORDINATE ALL WORK WITH TRANSIT DEPARTMENT 5 DAYS PRIOR TO START OF WORK

NOTE: CONTRACTOR WILL COORDINATE ALL WORK WITH EXISTING PROJECTS AND NOT CONFLICT WITH EXISTING TRAFFIC CONTROL

NOTE: CONTRACTOR WILL COORDINATE ALL WORK WITH RESIDENTS PRIOR TO START OF WORK

NOTE: CONTRACTOR WILL COORDINATE ALL WORK WITH BUSINESSES PRIOR TO START OF WORK

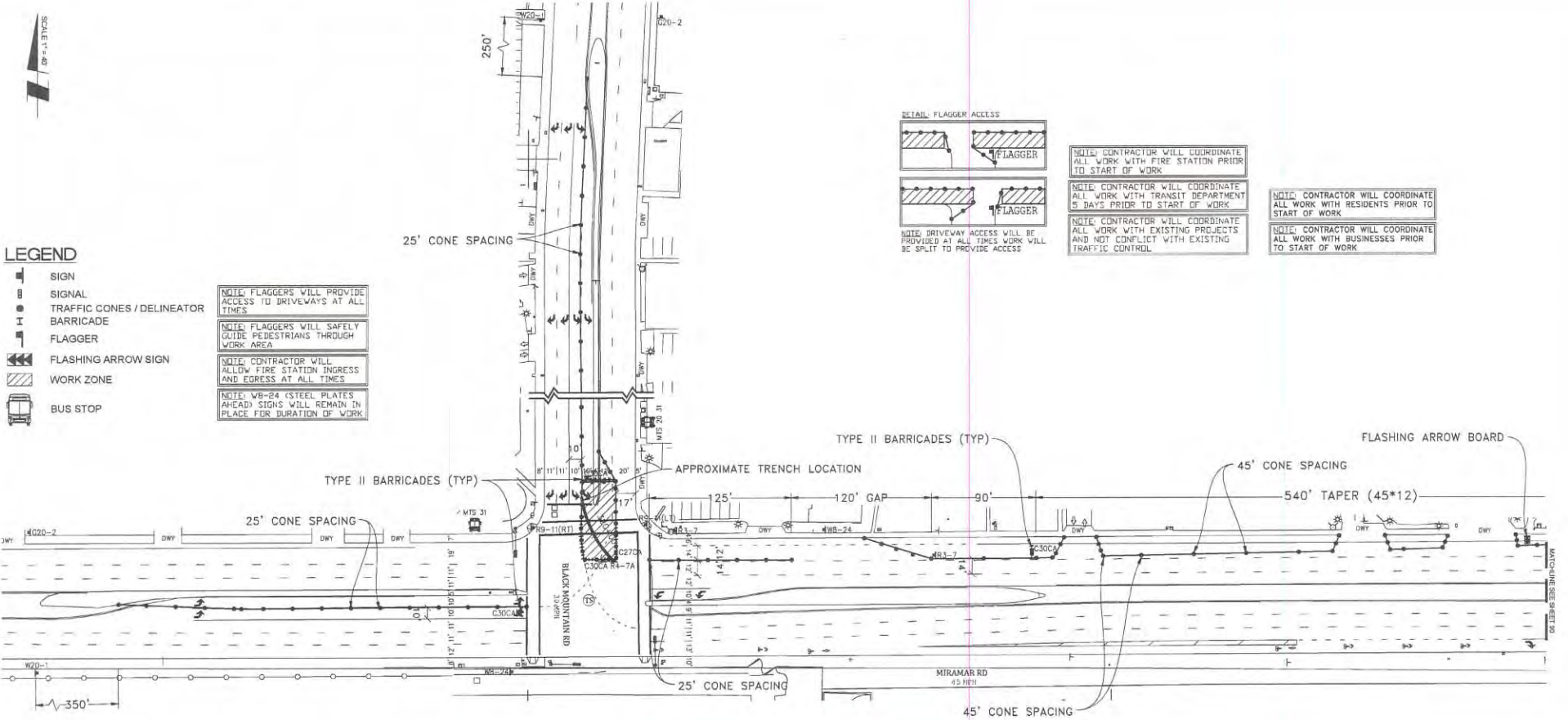

**APPROVED**  
TRAFFIC CONTROL PERMIT

OCT 11 2017

CITY OF SAN DIEGO  
Development Services  
Engineering Division  
Traffic Safety Section

**ORIGINAL PERMIT MUST BE KEPT ON JOB SITE ALL TIMES**

WORK HOURS: 9:00PM TO 5:00AM

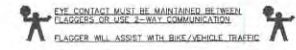

**NIGHT WORK ONLY  
PHASE 76**

UTILITY SURVEYORS, INC.

**AIRX**

Gail McMorran  
President

2534 EAST EL NORTE PARKWAY, SUITE C  
ESCONDIDO, CA 92027  
PHONE: (760) 480-2347  
CELL: (760) 419-3738

PROJECT NAME: TL23071 - SYCAMORE CANYON SUBSTATION TO PENASQUITOS - 230 KV UNDERGROUND	
AIRX JOB#: X160218	THOMAS GRID#: -
TYPE OF WORK: TRENCHING / CONDUIT	DRAWN FOR: CITY OF SAN DIEGO
MISC/POTHLES#:	

DATE: Mar. 29, 2017
DESIGNED BY: Clint Jones
SHEET 089 OF 148



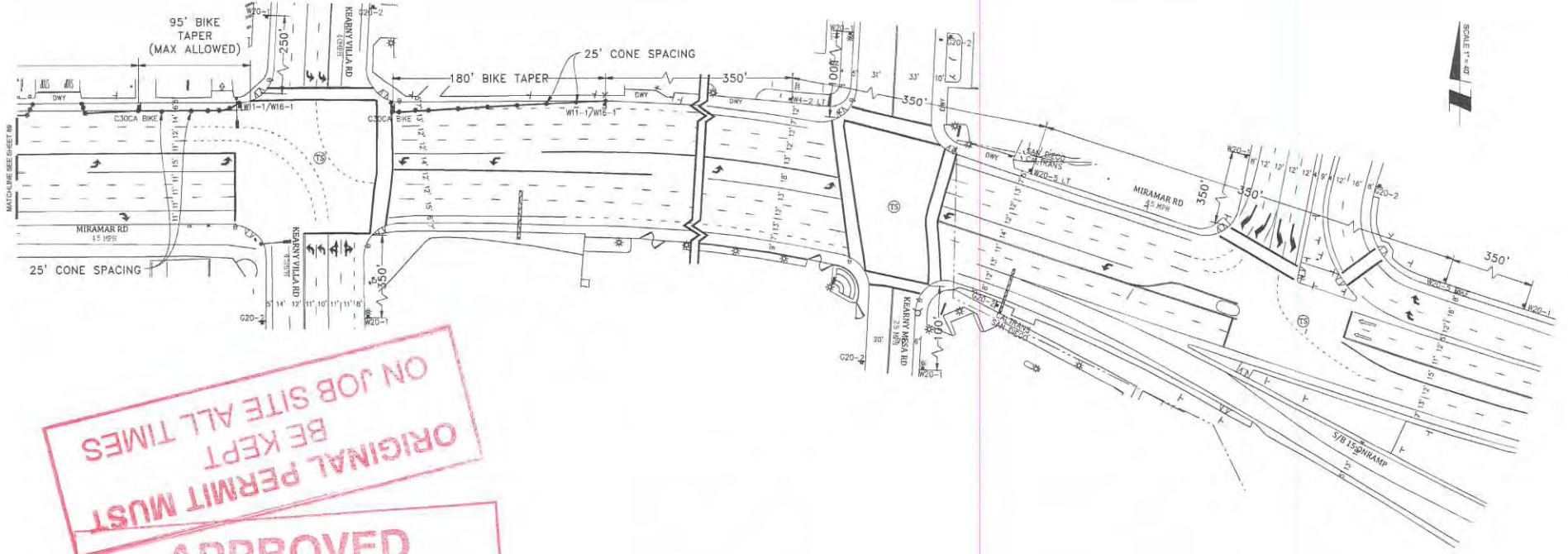

ON JOB SITE ALL TIMES  
ORIGINAL PERMIT MUST  
BE KEPT

**APPROVED**  
TRAFFIC CONTROL PERMIT

OCT 11 2017

CITY OF SAN DIEGO  
Development Services  
Engineering Division  
Traffic Safety Section

NOTE: CONTRACTOR WILL COORDINATE ALL WORK WITH FIRE STATION PRIOR TO START OF WORK

NOTE: CONTRACTOR WILL COORDINATE ALL WORK WITH TRANSIT DEPARTMENT 5 DAYS PRIOR TO START OF WORK

NOTE: CONTRACTOR WILL COORDINATE ALL WORK WITH EXISTING PROJECTS AND NOT CONFLICT WITH EXISTING TRAFFIC CONTROL

NOTE: CONTRACTOR WILL COORDINATE ALL WORK WITH RESIDENTS PRIOR TO START OF WORK

NOTE: CONTRACTOR WILL COORDINATE ALL WORK WITH BUSINESSES PRIOR TO START OF WORK

WORK HOURS: 9:00PM TO 5:00AM

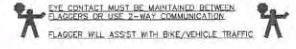

**NIGHT WORK ONLY  
PHASE 76 (CONT)**

- LEGEND**
- SIGN
  - SIGNAL
  - TRAFFIC CONES / DELINEATOR
  - BARRICADE
  - FLAGGER
  - FLASHING ARROW SIGN
  - WORK ZONE
  - BUS STOP

NOTE: FLAGGERS WILL PROVIDE ACCESS TO DRIVEWAYS AT ALL TIMES

NOTE: FLAGGERS WILL SAFELY GUIDE PEDESTRIANS THROUGH WORK AREA

NOTE: CONTRACTOR WILL ALLOW FIRE STATION INGRESS AND EGRESS AT ALL TIMES

NOTE: W8-P4 45" STEEL PLATES AHEAD SIGNS WILL REMAIN IN PLACE FOR DURATION OF WORK

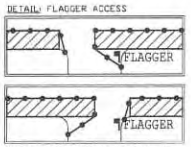

NOTE: DRIVEWAY ACCESS WILL BE PROVIDED AT ALL TIMES WORK WILL BE SPLIT TO PROVIDE ACCESS

**UTILITY SURVEYORS, INC.**  
**AIRX**  
Gail McMorran  
President  
2534 EAST EL NORTE PARKWAY, SUITE C  
ESCONDIDO, CA 92027  
PHONE: (760) 430-2347  
CELL: (760) 419-3738

<b>PROJECT NAME:</b> TL23071 - SYCAMORE CANYON SUBSTATION TO PENASQUITOS - 230 KV UNDERGROUND	
<b>AIRX JOB#:</b> X160218	<b>THOMAS GRID#:</b> -
<b>TYPE OF WORK:</b> TRENCHING / CONDUIT	<b>DRAWN FOR:</b> CITY OF SAN DIEGO
<b>MISC/POTHOLE#:</b>	

<b>DATE:</b> Mar. 29, 2017
<b>DESIGNED BY:</b> Clint Jones
<b>SHEET 090 OF 148</b>

SCALE: 1" = 40'

NOTE: FLAGGERS WILL PROVIDE ACCESS TO DRIVEWAYS AT ALL TIMES

NOTE: FLAGGERS WILL SAFELY GUIDE PEDESTRIANS THROUGH WORK AREA

NOTE: CONTRACTOR WILL ALLOW FIRE STATION INGRESS AND EGRESS AT ALL TIMES

NOTE: W8-24 STEEL PLATES AHEAD SIGNS WILL REMAIN IN PLACE FOR DURATION OF WORK

DETAIL: FLAGGER ACCESS

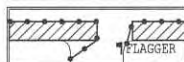
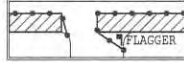

NOTE: DRIVEWAY ACCESS WILL BE PROVIDED AT ALL TIMES WORK WILL BE STOPPED TO PROVIDE ACCESS

NOTE: CONTRACTOR WILL COORDINATE ALL WORK WITH FIRE STATION PRIOR TO START OF WORK

NOTE: CONTRACTOR WILL COORDINATE ALL WORK WITH TRANSIT DEPARTMENT 5 DAYS PRIOR TO START OF WORK

NOTE: CONTRACTOR WILL COORDINATE ALL WORK WITH EXISTING PROJECTS AND NOT CONFLICT WITH EXISTING TRAFFIC CONTROL

NOTE: CONTRACTOR WILL COORDINATE ALL WORK WITH RESIDENTS PRIOR TO START OF WORK

NOTE: CONTRACTOR WILL COORDINATE ALL WORK WITH BUSINESSES PRIOR TO START OF WORK

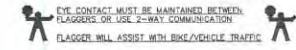

ORIGINAL PERMIT MUST BE KEPT ON JOB SITE ALL TIMES

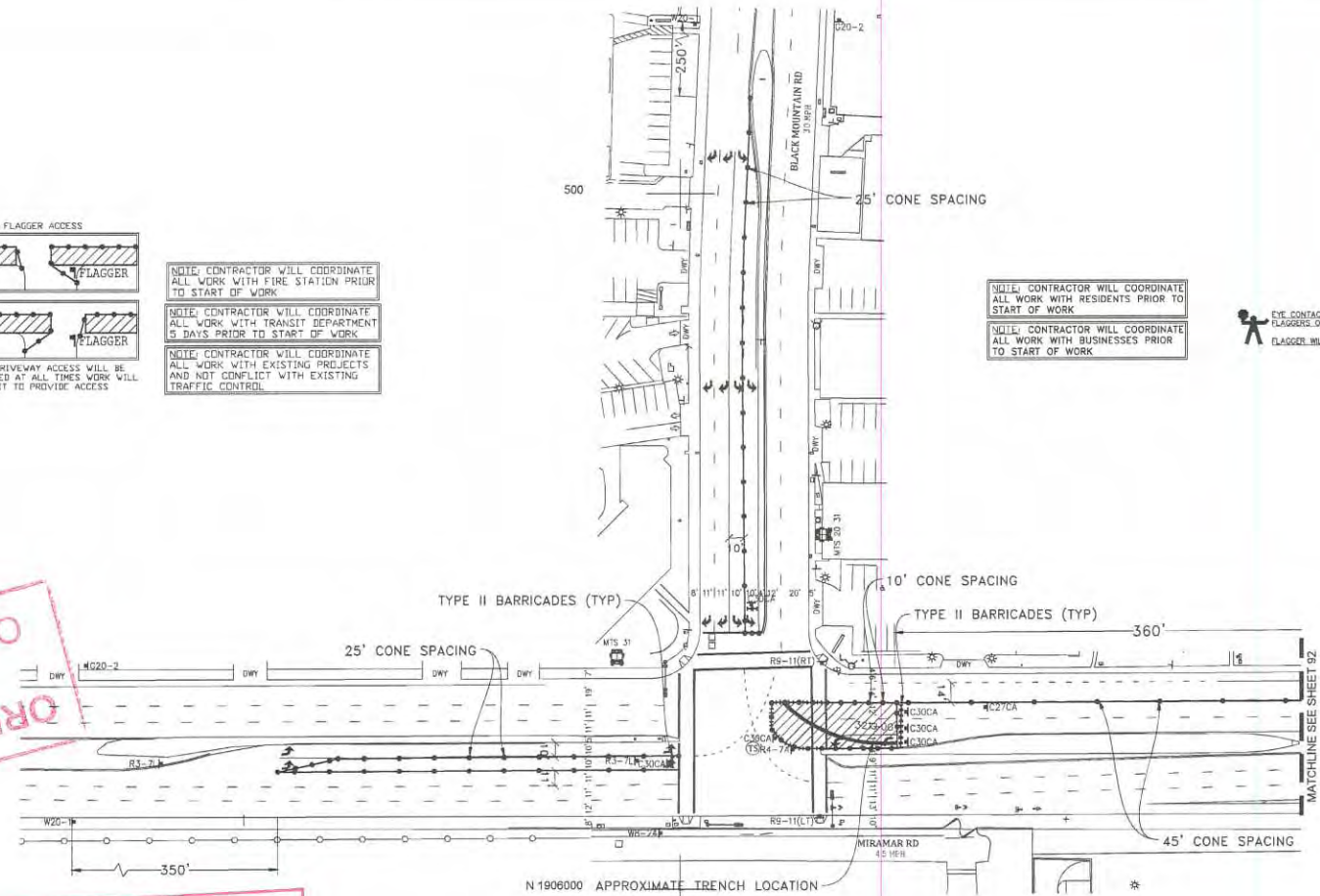

- LEGEND**
- SIGN
  - SIGNAL
  - TRAFFIC CONES / DELINEATOR
  - BARRICADE
  - FLAGGER
  - FLASHING ARROW SIGN
  - WORK ZONE
  - BUS STOP

**APPROVED**  
**TRAFFIC CONTROL PERMIT**  

OCT 11 2017

**CITY OF SAN DIEGO**  
 Development Services  
 Engineering Division  
 Traffic Safety Section

WORK HOURS: 5:00PM TO 5:00AM

**NIGHT WORK ONLY**  
**PHASE 77**

UTILITY SURVEYORS, INC.  
  
**AIRX**  
 Gail McMorrin  
 President  
 234 EAST EL NORTE PARKWAY, SUITE C  
 ESCONDO, CA 92027  
 PHONE: (760) 450-2347  
 CELL: (760) 419-3736

<b>PROJECT NAME:</b> TL23071 - SYCAMORE CANYON SUBSTATION TO PENASQUITOS - 230 KV UNDERGROUND	
<b>AIRX JOB#:</b> X160218	<b>THOMAS GRID#:</b> -
<b>TYPE OF WORK:</b> TRENCHING / CONDUIT	<b>DRAWN FOR:</b> CITY OF SAN DIEGO
<b>MISC/POTHoles#:</b>	

<b>DATE:</b> Mar. 29, 2017
<b>DESIGNED BY:</b> Clint Jones
<b>SHEET 091 OF 148</b>



SOUTH

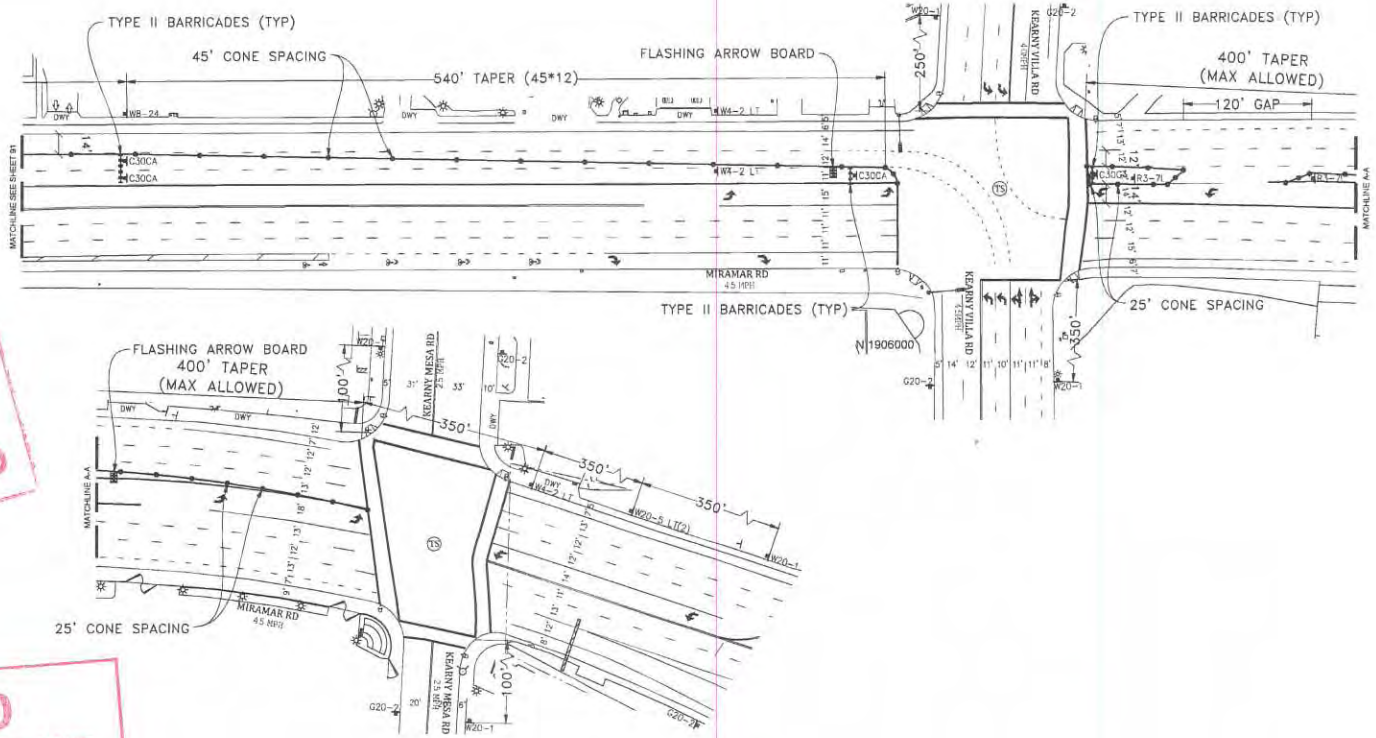

ORIGINAL PERMIT MUST  
BE KEPT  
ON JOB SITE ALL TIMES

APPROVED  
TRAFFIC CONTROL PERMIT

OCT 11 2017

CITY OF SAN DIEGO  
Development Services  
Engineering Division  
Traffic Safety Section

- LEGEND**
- SIGN
  - SIGNAL TRAFFIC CONES / DELINEATOR
  - BARRICADE
  - FLAGGER
  - FLASHING ARROW SIGN
  - WORK ZONE
  - BUS STOP

**NOTE:** FLAGGERS WILL PROVIDE ACCESS TO DRIVEWAYS AT ALL TIMES

**NOTE:** FLAGGERS WILL SAFELY GUIDE PEDESTRIANS THROUGH WORK AREA

**NOTE:** CONTRACTOR WILL ALLOW FIRE STATION INGRESS AND EGRESS AT ALL TIMES

**NOTE:** WR-24 (STEEL PLATES AHEAD) SIGNS WILL REMAIN IN PLACE FOR DURATION OF WORK

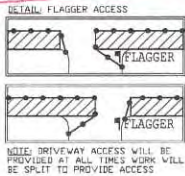

**NOTE:** CONTRACTOR WILL COORDINATE ALL WORK WITH FIRE STATION PRIOR TO START OF WORK

**NOTE:** CONTRACTOR WILL COORDINATE ALL WORK WITH TRANSIT DEPARTMENT 5 DAYS PRIOR TO START OF WORK

**NOTE:** CONTRACTOR WILL COORDINATE ALL WORK WITH EXISTING PROJECTS AND NOT CONFLICT WITH EXISTING TRAFFIC CONTROL.

**NOTE:** CONTRACTOR WILL COORDINATE ALL WORK WITH RESIDENTS PRIOR TO START OF WORK

**NOTE:** CONTRACTOR WILL COORDINATE ALL WORK WITH BUSINESSES PRIOR TO START OF WORK

WORK HOURS: 9:00PM TO 5:00AM

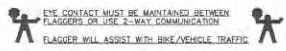

**UTILITY SURVEYORS, INC.**  
**AIRX**  
Gail McMorran  
President  
2554 EAST EL NORTE PARKWAY, SUITE C  
ESCONDIDO, CA 92027  
PHONE: (760) 450-2347  
CELL: (760) 419-3738

<b>PROJECT NAME:</b> TL23071 - SYCAMORE CANYON SUBSTATION TO PENASQUITOS - 230 KV UNDERGROUND	
AIRX JOB#: X160218	THOMAS GRID#: -
TYPE OF WORK: TRENCHING / CONDUIT	DRAWN FOR: CITY OF SAN DIEGO
MISC/POTHoles#:	

NIGHT WORK ONLY  
PHASE 77 (CONT)

DATE: Mar. 29, 2017
DESIGNED BY: Clint Jones
SHEET 092 OF 148

SCALE: 1" = 40'

NOTE: FLAGGERS WILL PROVIDE ACCESS TO DRIVEWAYS AT ALL TIMES

NOTE: FLAGGERS WILL SAFELY GUIDE PEDESTRIANS THROUGH WORK AREA

NOTE: CONTRACTOR WILL ALLOW FIRE STATION INGRESS AND EGRESS AT ALL TIMES

NOTE: W8-24 STEEL PLATES AHEAD SIGNS WILL REMAIN IN PLACE FOR DURATION OF WORK

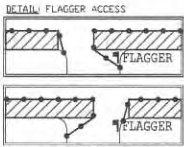

NOTE: CONTRACTOR WILL COORDINATE ALL WORK WITH FIRE STATION PRIOR TO START OF WORK

NOTE: CONTRACTOR WILL COORDINATE ALL WORK WITH TRANSIT DEPARTMENT 5 DAYS PRIOR TO START OF WORK

NOTE: CONTRACTOR WILL COORDINATE ALL WORK WITH EXISTING PROJECTS AND NOT CONFLICT WITH EXISTING TRAFFIC CONTROL

NOTE: CONTRACTOR WILL COORDINATE ALL WORK WITH RESIDENTS PRIOR TO START OF WORK

NOTE: CONTRACTOR WILL COORDINATE ALL WORK WITH BUSINESSES PRIOR TO START OF WORK

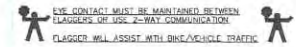

**ORIGINAL PERMIT MUST BE KEPT ON JOB SITE ALL TIMES**

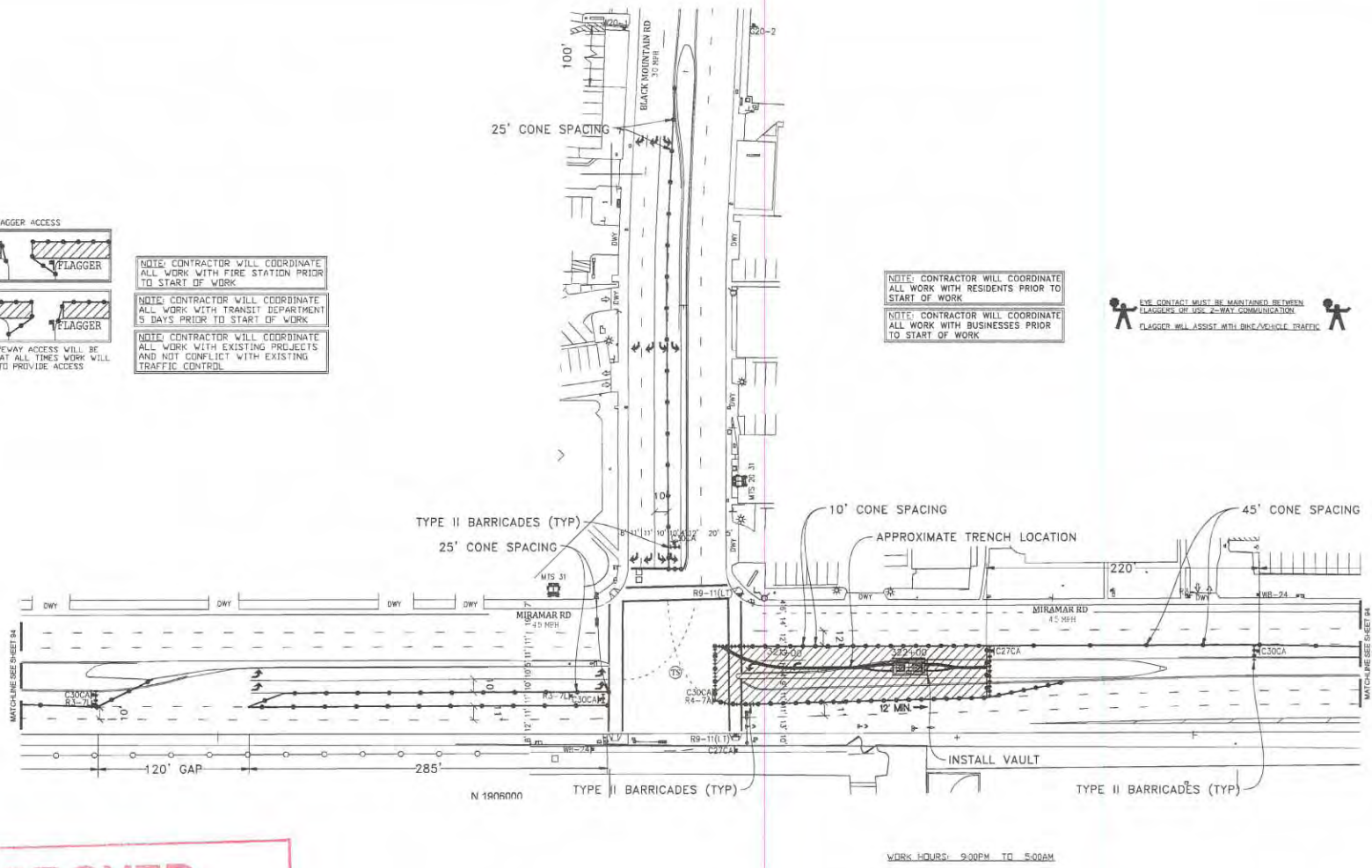

- LEGEND**
- [Symbol] SIGN
  - [Symbol] SIGNAL
  - [Symbol] TRAFFIC CONES / DELINEATOR
  - [Symbol] BARRICADE
  - [Symbol] FLAGGER
  - [Symbol] FLASHING ARROW SIGN
  - [Symbol] WORK ZONE
  - [Symbol] BUS STOP

**APPROVED**  
**TRAFFIC CONTROL PERMIT**

**OCT 11 2017**

CITY OF SAN DIEGO  
Development Services  
Engineering Division  
Traffic Safety Section

UTILITY SURVEYORS, INC.

**AIRX**

Gail McMorran  
President

2534 EAST EL NORTE PARKWAY, SUITE C  
ESCONDIDO, CA 92027  
PHONE: (760) 480-2347  
CELL: (760) 419-3736

<b>PROJECT NAME:</b> TL23071 - SYCAMORE CANYON SUBSTATION TO PENASQUITOS - 230 KV UNDERGROUND		<b>DATE:</b> Mar. 29, 2017
<b>AIRX JOB#:</b> X160218	<b>THOMAS GRID#:</b> -	<b>DESIGNED BY:</b> Clint Jones
<b>TYPE OF WORK:</b> TRENCHING / CONDUIT	<b>DRAWN FOR:</b> CITY OF SAN DIEGO	<b>SHEET 093 OF 148</b>
<b>MISC/POTHOLE#:</b>		



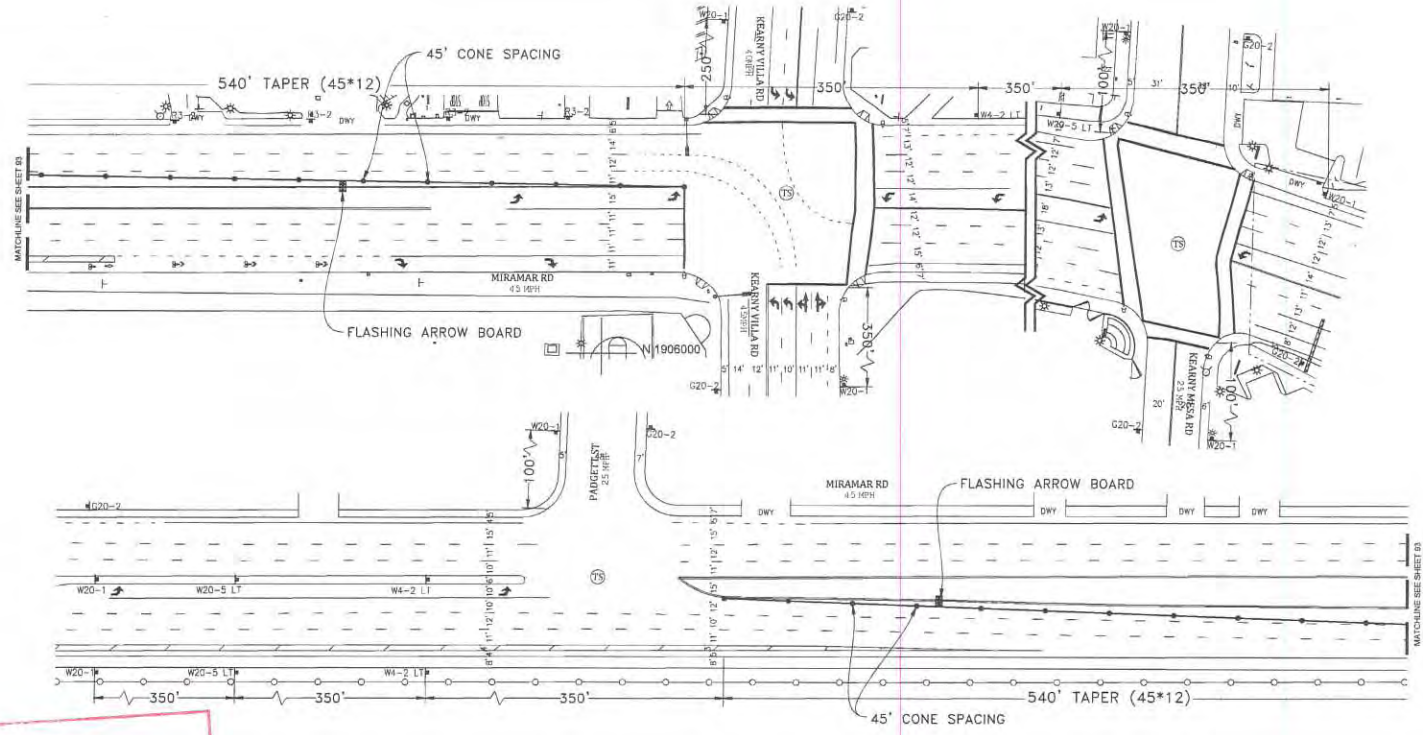

**ORIGINAL PERMIT MUST BE KEPT ON JOB SITE ALL TIMES**

**APPROVED**  
TRAFFIC CONTROL PERMIT

**OCT 11 2017**

CITY OF SAN DIEGO  
Development Services  
Engineering Division

- LEGEND**
- SIGN
  - SIGNAL
  - TRAFFIC CONES / DELINEATOR
  - BARRICADE
  - FLAGGER
  - FLASHING ARROW SIGN
  - WORK ZONE
  - BUS STOP

**NOTE:** FLAGGERS WILL PROVIDE ACCESS TO DRIVEWAYS AT ALL TIMES

**NOTE:** FLAGGERS WILL SAFELY GUIDE PEDESTRIANS THROUGH WORK AREA

**NOTE:** CONTRACTORS WILL ALLOW FIRE STATION INGRESS AND EGRESS AT ALL TIMES

**NOTE:** W8-24 (STEEL PLATES AHEAD) SIGNS WILL REMAIN IN PLACE FOR DURATION OF WORK

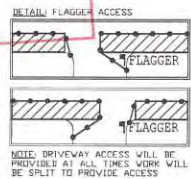

**NOTE:** CONTRACTOR WILL COORDINATE ALL WORK WITH FIRE STATION PRIOR TO START OF WORK

**NOTE:** CONTRACTOR WILL COORDINATE ALL WORK WITH TRANSIT DEPARTMENT 5 DAYS PRIOR TO START OF WORK

**NOTE:** CONTRACTOR WILL COORDINATE ALL WORK WITH EXISTING PROJECTS AND NOT CONFLICT WITH EXISTING TRAFFIC CONTROL

**NOTE:** CONTRACTOR WILL COORDINATE ALL WORK WITH RESIDENTS PRIOR TO START OF WORK

**NOTE:** CONTRACTOR WILL COORDINATE ALL WORK WITH BUSINESSES PRIOR TO START OF WORK

WORK HOURS 9:00PM TO 5:00AM

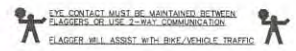

**UTILITY SURVEYORS, INC.**

**AIRX**

Gail McMorrin  
President

2534 EAST EL NORTE PARKWAY, SUITE C  
ESCONDIDO, CA 92027  
PHONE: (760) 480-2347  
CELL: (760) 419-3738

<b>PROJECT NAME:</b> TL23071 - SYCAMORE CANYON SUBSTATION TO PENASQUITOS - 230 KV UNDERGROUND	
AIRX JOB#: X160218	THOMAS GRID#: -
TYPE OF WORK: TRENCHING / CONDUIT	DRAWN FOR: CITY OF SAN DIEGO
MISC/POTHOLE#:	

**NIGHT WORK ONLY  
PHASE 78 (CONT)**

DATE: Mar. 29, 2017
DESIGNED BY: Clint Jones
SHEET 094 OF 148