



Traffic Control Permit (TCP) Multiple Location List

(Franchise Utility Company Only - May Not Be submitted By Contractor)

THE CITY OF SAN DIEGO

APPROVED
TRAFFIC CONTROL PERMIT
SEP 14 2017
CITY OF SAN DIEGO
Development Services
Engineering Division
Traffic Safety Section

To: City of San Diego, Traffic Permit Section

Date: 9/13/2017

From: (Company): SDG&E

Phone No.: 619-778-2405

Contact Person: Rod Nelson

Fax.: _____

W.O. or Account #: Permit # _____

TCP No. _____

City Use Only

Authorized # _____

By Felipe Avila

Yes No _____

Date Reviewed 9/14/17

TYPE OF WORK

- 1 = Lane Closure
- 2 = Street Closure
- 3 = Sidewalk Closure
- 4 = Alley Closure
- 5 = Parking Lane
- 6 = Detour
- 7 = Trenching
- 8 = Flagging

Location	From	To	Start Date *	End Date *	Work Hours **	Thomas Bros.	Type of Work
**Pomerado Road	2200' West of Willow Creek Road/Ave of Nations	Willow Creek Road/Ave of Nations	9/18/17	9/22/17	8:30AM - 3:30PM	1209-G6, H5, J5	1,7,8
Pomerado Road	Willow Creek Road/Ave of Nations	Semillon Blvd	9/18/17	9/22/17	8:30AM - 3:30PM	1209-G6, H5, J5, 1210-A-4, B4	1,7,8
Willow Creek Road	Pomerado Road	Caminito Covewood	9/18/17	9/22/17	8:30AM - 3:30PM	1209-G6, G5	8
Avenue of Nations	Pomerado Road	End of Street	9/18/17	9/22/17	8:30AM - 3:30PM	1209-G6, G5	8

>>> Place CMS on I-15 (NB and SB): "CONSTRUCTION ON POMERADO RD - EXPECT DELAYS" <<<<

Vault and Trench Crews - Phases 82-100 - Daytime work hours (M-F, 8:30AM - 3:30PM)

**Pomerado Road west of Willow Creek Road/Ave of Nations (County ROW hours agreed to 8:30AM - 3:30PM)

>>> Warning signs on approach to flagging operation will be doubled in east bound and west bound directions along Pomerado Road

>>> Flaggers to assist with potential back ups and provide better traffic circulation for all movements at signalized intersections that require flash.

Comments: (Minimum 4 flaggers at intersection)

Must be submitted a minimum of 2 working days prior to start of work. All columns must be filled out for proper authorization

Fax or mail to: City of San Diego • Traffic Control Permit Section • 1222 First Avenue, MS 501 • San Diego, CA 92101. Fax (619) 446-5489 Office (619) 446-5150

* Work Days: Monday Through Friday ** Work Hours : 8:30 AM - 3:30PM. Unless other hours are preapproved)

No Work on Saturdays, Sundays, or Holidays Unless Approved and Noted In Comments

Minimum of 5 working days required for construction work which affects traffic signal e-mail info to: JVaca@sanidiego.gov

ORIGINAL PERMIT MUST BE KEPT ON JOB SITE ALL TIMES



THE CITY OF SAN DIEGO

Traffic Control Permit (TCP) Multiple Location List

(Franchise Utility Company Only - May Not Be submitted By Contractor)

ORIGINAL PERMIT MUST
BE KEPT
ON JOB SITE ALL TIMES

City Use Only

Authorized # _____

By Feliza Ariza

Yes No

Date Reviewed 9/14/17

TYPE OF WORK

- 1 = Lane Closure
- 2 = Street Closure
- 3 = Sidewalk Closure
- 4 = Alley Closure
- 5 = Parking Lane
- 6 = Detour
- 7 = Trenching
- 8 = Flagging

To: City of San Diego, Traffic Permit Section Date: 9/13/2017
 From (Company): SDG&E Phone No.: 619-778-2405
 Contact Person: Rod Nelson Fax.: _____
 W.O. or Account #: Permit # _____ TCP No. _____

APPROVED
 TRAFFIC CONTROL PERMIT
 SEP 14 2017
 CITY OF SAN DIEGO
 Development Services
 Engineering Division
 Traffic Safety Section

Location	From	To	Start Date *	End Date *	Work Hours **	Thomas Bros.	Type of Work
Scripps Ranch Blvd	Pomerado Road	Ironwood Road	9/18/17	9/22/17	8:30AM - 3:30PM	1209-H5	8
Scripps Ranch Row	Pomerado Road	Espinosa Square	9/18/17	9/22/17	8:30AM - 3:30PM	1209-H5	8
Avenida Magnifica	Mesa Madera Dr	Caminito Calor	9/18/17	9/22/17	8:30AM - 3:30PM	1209-J4,J5 1210-A5	8
Fairbrook Road	Pomerado Road	Caminito Magnifico	9/18/17	9/22/17	8:30AM - 3:30PM	1210-A4, B4	8
>>> Place CMS on I-15 (NB and SB): "CONSTRUCTION ON POMERADO RD - EXPECT DELAYS" <<<<							

Vault and Trench Crews - Phases 82-100 - Daytime work hours (M-F, 8:30AM - 3:30PM)
****Pomerado Road west of Willow Creek Road/Ave of Nations (County ROW hours agreed to 8:30AM - 3:30PM)**

>>> Warning signs on approach to flagging operation will be doubled in east bound and west bound directions along Pomerado Road
 >>> Flaggers to assist with potential back ups and provide better traffic circulation for all movements at signalized intersections that require flash.

Comments: (Minimum 4 flaggers at intersection)

Must be submitted a minimum of 2 working days prior to start of work. All columns must be filled out for proper authorization
 Fax or mail to: City of San Diego • Traffic Control Permit Section • 1222 First Avenue, MS 501 • San Diego, CA 92101. Fax (619) 446-5489 Office (619) 446-5150
 * Work Days: Monday Through Friday ** Work Hours : 8:30 AM - 3:30PM. Unless other hours are preapproved)
 No Work on Saturdays, Sundays, or Holidays Unless Approved and Noted In Comments
 Minimum of 5 working days required for construction work which affects traffic signal e-mail info to: JVaca@sanidiego.gov

SIGN LEGEND

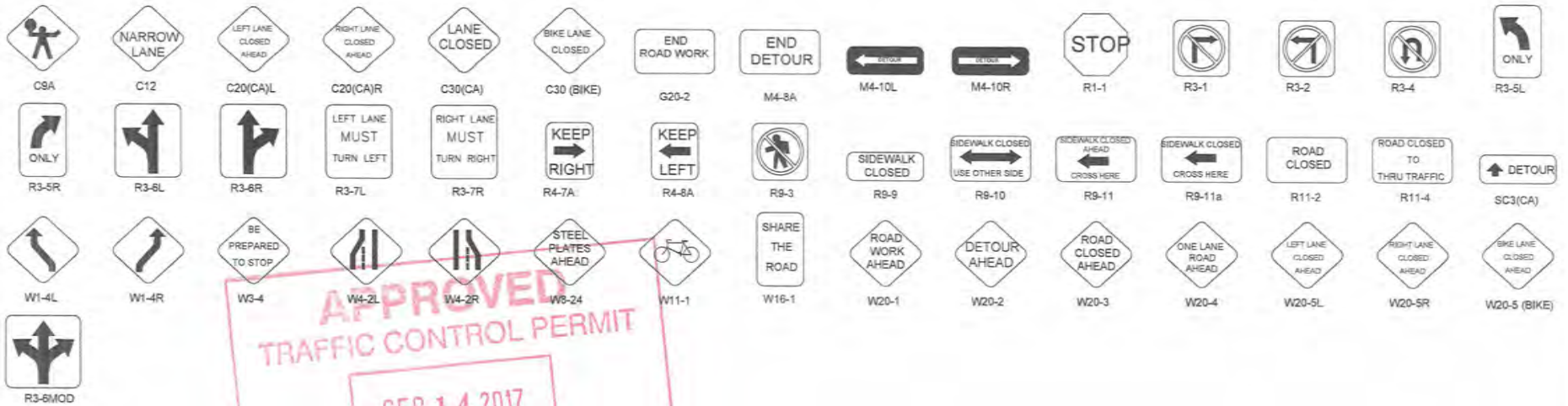

APPROACH SPEED (MPH)	MINIMUM DISTANCE (FEET) BETWEEN SIGNS AND FROM LAST SIGN TO TAPER
25	100
30	250
35	250
40	250
45	500
50	500
55+	500

MINIMUM TAPER LENGTHS (L) (FEET) FOR 12-FOOT LANE	MINIMUM TAPER LENGTHS (L) (FEET) FOR 12-FOOT LANE		
	L	1/2L	1/3L
25	125	65	45
30	180	90	60
35	245	125	85
40	320	160	110
45	540	270	180
50	600	300	200
55+	660	330	220

BUFFER LENGTH (FEET)
155
200
250
305
360
425
495

MAX CONE SPACING		
TAPER	TANGENT	CONFLICT
25	50	12
30	60	15
35	70	17
40	80	20
45	90	22
50	100	25
55	110	27

LEGEND

- APPROXIMATE POTHOLE LOCATION
- SIGN
- TRAFFIC CONES / DELINEATOR
- BARRICADE
- FLAGGER
- FLASHING ARROW SIGN
- WORK ZONE
- CONSTRUCTION VEHICLE
- BUS STOP

APPROVED
TRAFFIC CONTROL PERMIT

SEP 14 2017

CITY OF SAN DIEGO
Development Services
Engineering Division
Traffic Safety Section

ORIGINAL PERMIT MUST
BE KEPT
ON JOB SITE ALL TIMES

UTILITY SURVEYORS, INC.

Gail McMorran
President

2534 EAST EL NORTE PARKWAY, SUITE C
ESCONDIDO, CA 92027
PHONE: (760) 480-2347
CELL: (760) 419-3738

PROJECT NAME: TL23071 – Sycamore Canyon Substation To Penasquitos Substation – 230 KV Underground		DATE: Mar 2, 2017
AIRX JOB#: X160218	THOMAS GRID#: –	DESIGNED BY: Clint Jones
TYPE OF WORK: TRENCHING / CONDUIT		DRAWN FOR: SAN DIEGO COUNTY
MISC/POTHoles#:		SHEET 1 OF 4



NOTE: W8-24 (STEEL PLATES AHEAD) SIGNS WILL REMAIN IN PLACE FOR DURATION OF WORK

NOTE: W8-24 (STEEL PLATES AHEAD) SIGNS WILL REMAIN IN PLACE FOR DURATION OF WORK

NOTE: STEEL PLATE BRIDGING SHALL NOT EXCEED 24 HR AND 50 FEET IN LENGTH IN THE WORK ZONE

ORIGINAL PERMIT MUST BE KEPT ON JOB SITE ALL TIMES

APPROVED
TRAFFIC CONTROL PLAN
 SEP 14 2017
 CITY OF SAN DIEGO
 Development Services
 Engineering Division
 Traffic Safety Section

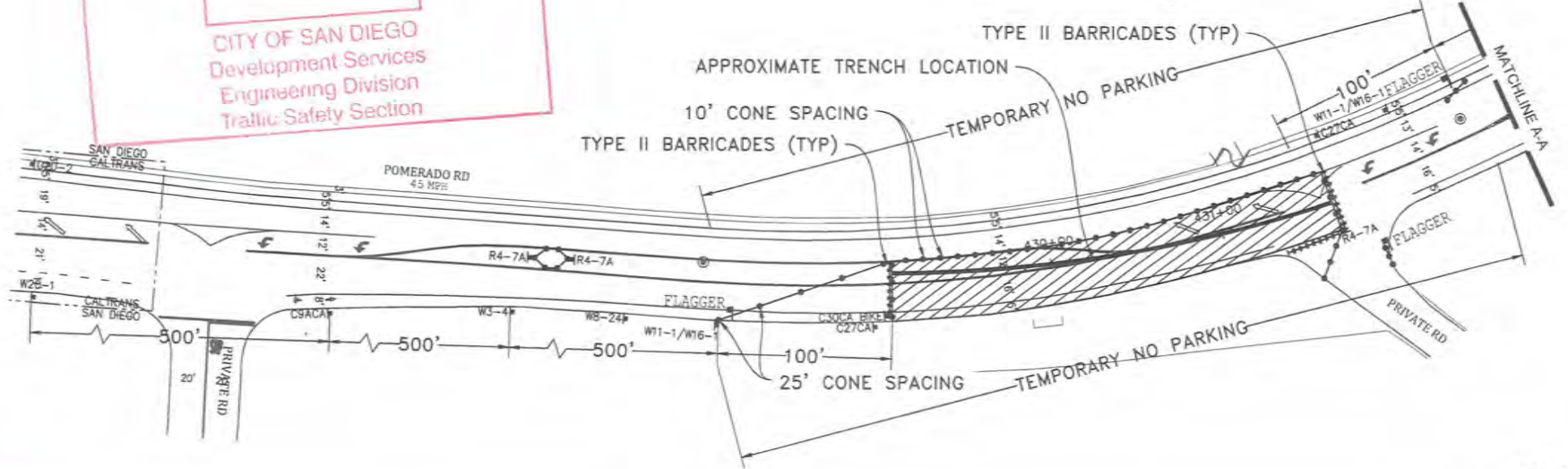
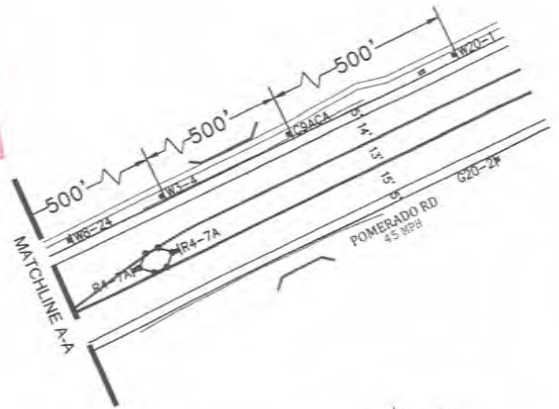

PHASE 01

UTILITY SURVEYORS, INC.
AIRX
 2534 EAST EL NORTE PARKWAY, SUITE C
 ESCONDIDO, CA 92027
 PHONE: (760) 480-2347
 CELL: (760) 419-3738

Gail McMorran
 President

PROJECT NAME: TL23071 - Sycamore Canyon Substation To Penasquitos Substation - 230 KV Underground	
AIRX JOB#: X160218	THOMAS GRID#: -
TYPE OF WORK: TRENCHING / CONDUIT	DRAWN FOR: SAN DIEGO COUNTY
MISC/POTHOLE#:	

DATE: Mar 2, 2017
DESIGNED BY: Clint Jones
SHEET 2 OF 4



**ORIGINAL PERMIT MUST
BE KEPT
ON JOB SITE ALL TIMES**

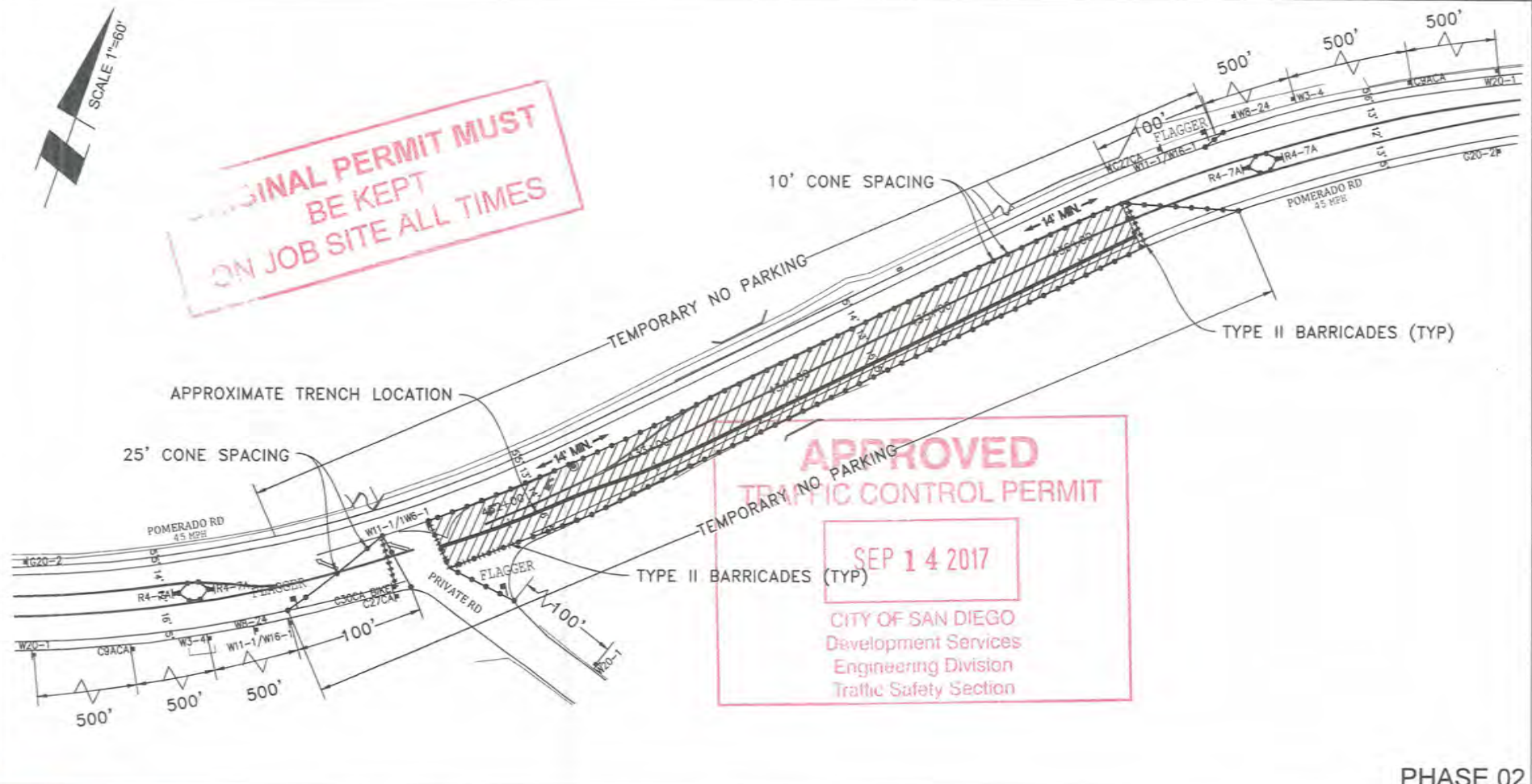

**APPROVED
TRAFFIC CONTROL PERMIT**

SEP 14 2017

CITY OF SAN DIEGO
Development Services
Engineering Division
Traffic Safety Section

PHASE 02

UTILITY SURVEYORS, INC.

AIRX

2634 EAST EL NORTE PARKWAY, SUITE C
ESCONDIDO, CA 92027
PHONE: (760) 480-2347
CELL: (760) 419-3738

Gail McMorran
President

PROJECT NAME: TL23071 – Sycamore Canyon Substation To Penasquitos Substation – 230 KV Underground	
AIRX JOB#: X160218	THOMAS GRID#: –
TYPE OF WORK: TRENCHING / CONDUIT	DRAWN FOR: SAN DIEGO COUNTY
MISC/POTHLES#:	

DATE: Mar 2, 2017
DESIGNED BY: Clint Jones
SHEET 3 OF 4



APPROVED
TRAFFIC CONTROL PERMIT

SEP 14 2017

CITY OF SAN DIEGO
 Development Services
 Engineering Division
 Traffic Safety Section

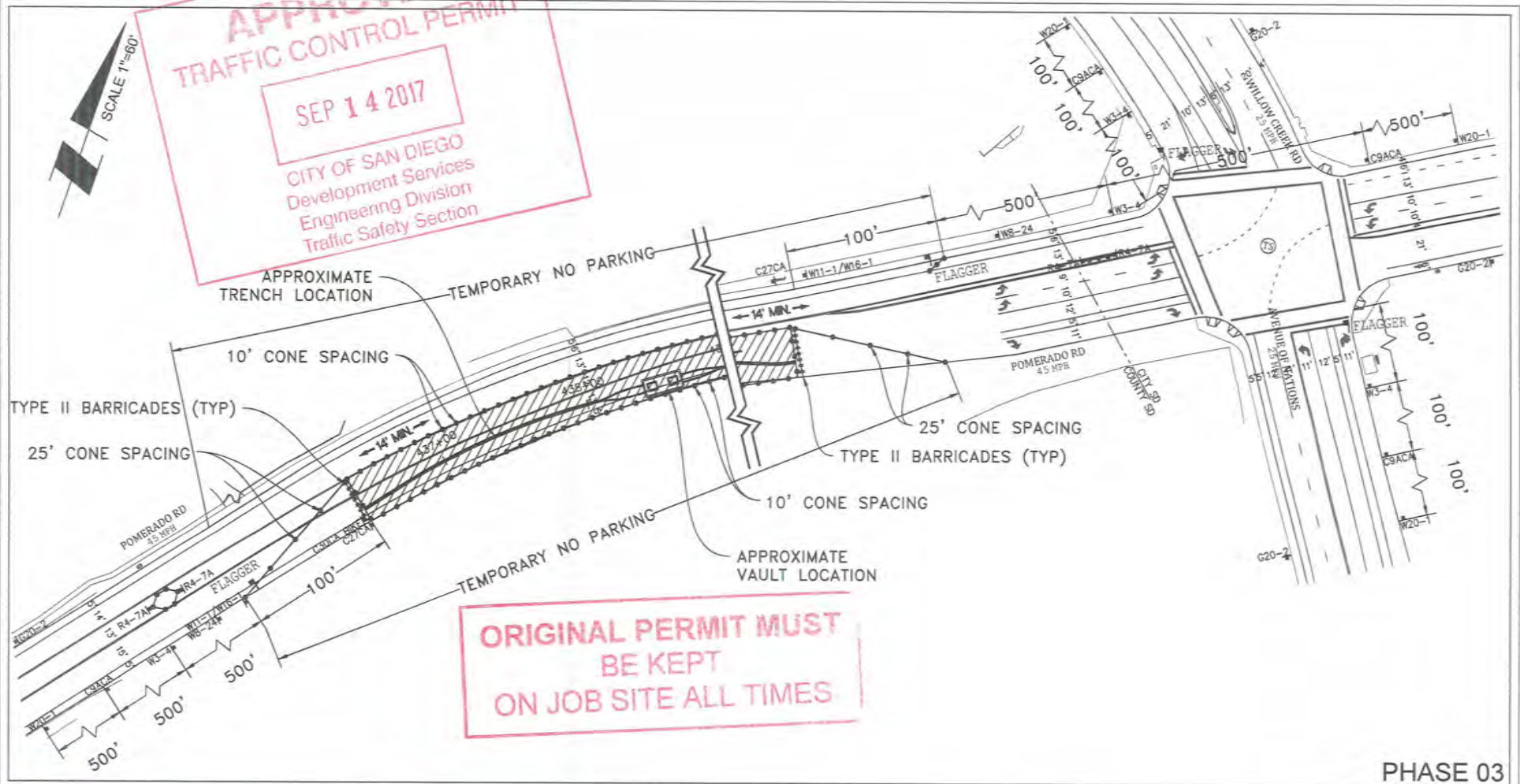

ORIGINAL PERMIT MUST
BE KEPT
ON JOB SITE ALL TIMES

PHASE 03

UTILITY SURVEYORS, INC.



AIRX

Gail McMorran
 President

2534 EAST EL NORTE PARKWAY, SUITE C
 ESCONDIDO, CA 92027
 PHONE: (760) 480-2347
 CELL: (760) 419-3738

PROJECT NAME: TL23071 - Sycamore Canyon Substation To Penasquitos Substation - 230 KV Underground	
AIRX JOB#: X160218	THOMAS GRID#: -
TYPE OF WORK: TRENCHING / CONDUIT	DRAWN FOR: SAN DIEGO COUNTY
MISC/POTHoles#:	

DATE: Mar 2, 2017
DESIGNED BY: Clint Jones
SHEET 4 OF 4

SIGN LEGEND

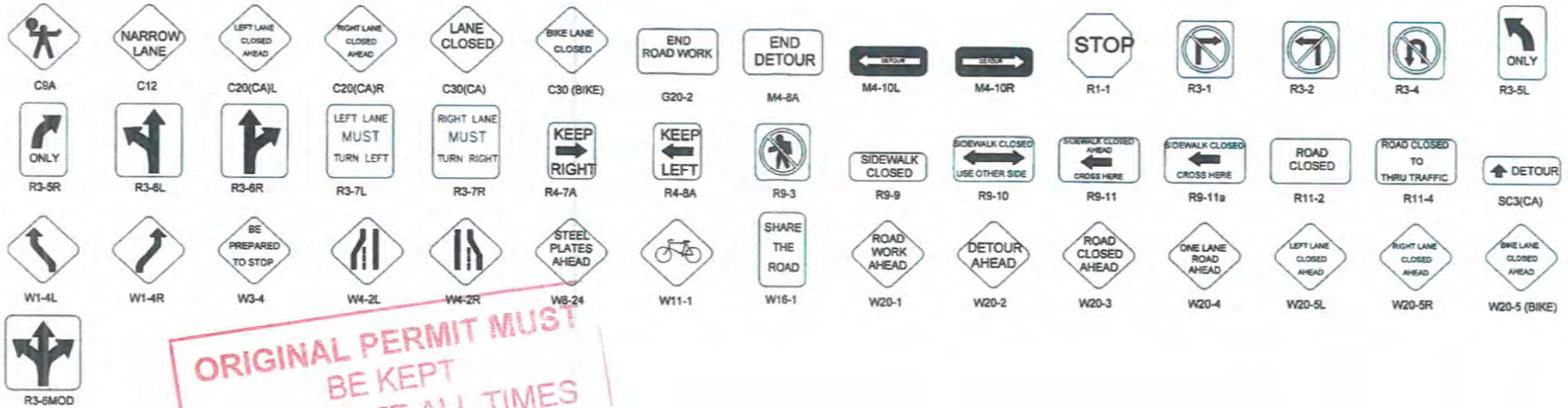

**ORIGINAL PERMIT MUST
BE KEPT
ON JOB SITE ALL TIMES**

APPROACH SPEED (MPH)	MINIMUM DISTANCE (FEET) BETWEEN SIGNS AND FROM LAST SIGN TO TAPER	MINIMUM TAPER LENGTHS (L) (FEET) FOR 12-FOOT LANE			BUFFER LENGTH (FEET)	MAX CONE SPACING		
		L	1/2L	1/3L		TAPER	TANGENT	CONFLICT
25	100	125	65	45	155	25	50	12
30	250	180	90	60	200	30	60	15
35	250	245	125	85	250	35	70	17
40	250	320	160	110	305	40	80	20
45	350	540	270	180	360	45	90	22
50	350	600	300	200	425	50	100	25
55+	350	660	330	220	495	55	110	27

**APPROVED
TRAFFIC CONTROL PERMIT
SEP 14 2017**
 CITY OF SAN DIEGO
 Development Services
 Engineering Division
 Traffic Safety Section

LEGEND

- APPROXIMATE POTHOLE LOCATION
- SIGN
- TRAFFIC CONES / DELINEATOR
- BARRICADE
- FLAGGER
- FLASHING ARROW SIGN
- WORK ZONE
- CONSTRUCTION VEHICLE
- BUS STOP

UTILITY SURVEYORS, INC.

AIRX
 2534 EAST EL NORTE PARKWAY, SUITE C
 ESCONDIDO, CA 92027
 PHONE: (760) 480-2347
 CELL: (760) 419-3738

Gail McMorrin
 President

PROJECT NAME: TL23071 – Sycamore Canyon Substation To Penasquitos Substation – 230 KV Underground		DATE: Mar 2, 2017
AIRX JOB#: X160218	THOMAS GRID#: —	DESIGNED BY: Clint Jones
TYPE OF WORK: TRENCHING / CONDUIT		DRAWN FOR: SAN DIEGO COUNTY
MISC/POTHOLE#:		SHEET 1 OF 4



APPROVED
TRAFFIC CONTROL PERMIT

SEP 14 2017

CITY OF SAN DIEGO
Development Services
Engineering Division
Traffic Safety Section

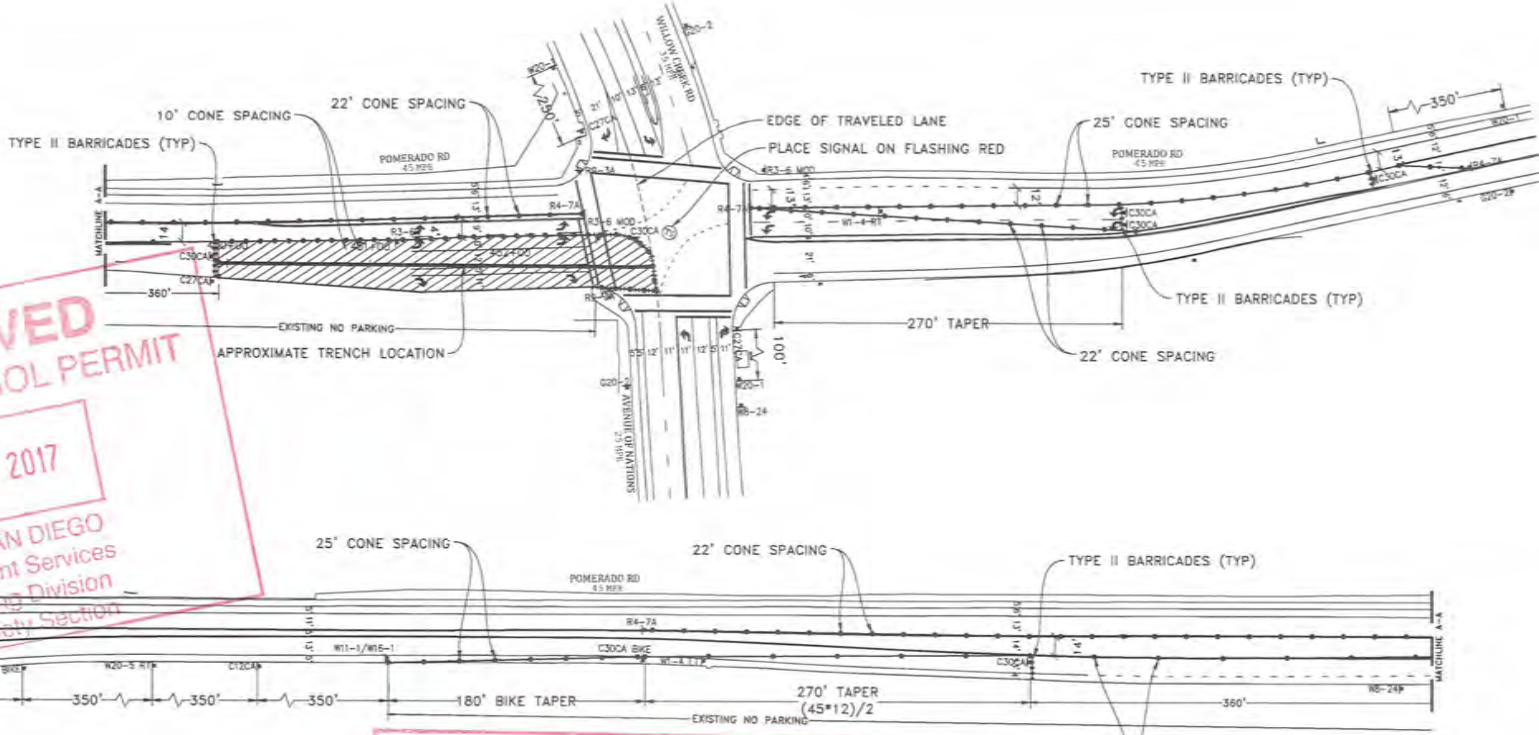

ORIGINAL PERMIT MUST
BE KEPT
ON JOB SITE ALL TIMES

- NOTE: CONTRACTOR WILL COORDINATE ALL WORK WITH FIRE STATION PRIOR TO START OF WORK
- NOTE: CONTRACTOR WILL COORDINATE ALL WORK WITH TRANSIT DEPARTMENT 5 DAYS PRIOR TO START OF WORK
- NOTE: CONTRACTOR WILL COORDINATE ALL WORK WITH EXISTING PROJECTS AND NOT CONFLICT WITH EXISTING TRAFFIC CONTROL
- NOTE: CONTRACTOR WILL COORDINATE ALL WORK WITH RESIDENTS PRIOR TO START OF WORK
- NOTE: CONTRACTOR WILL COORDINATE ALL WORK WITH BUSINESSES PRIOR TO START OF WORK

WORK HOURS: _____ TO _____

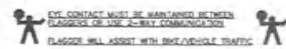

- LEGEND**
- SIGN
 - TRAFFIC CONES / DELINEATOR
 - ⊥ BARRICADE
 - ⚑ FLAGGER
 - ⚡ FLASHING ARROW SIGN
 - ▨ WORK ZONE
 - 🚌 BUS STOP

- NOTE: FLAGGERS WILL PROVIDE ACCESS TO DRIVEWAYS AT ALL TIMES
- NOTE: FLAGGERS WILL SAFELY GUIDE PEDESTRIANS THROUGH WORK AREA
- NOTE: CONTRACTOR WILL ALLOW FIRE STATION INGRESS AND EGRESS AT ALL TIMES
- NOTE: WB-24 (STEEL PLATES AHEAD) SIGNS WILL REMAIN IN PLACE FOR DURATION OF WORK

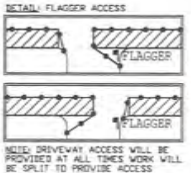

AIRX SURVEYORS, INC.
Gail McMorran
President
204 EAST B. MONTE PARNASSY, SUITE C
SUNNYVALE, CA 94087
PHONE: (760) 480-2947
CELL: (760) 418-3728

PROJECT NAME: TL23071 - SYCAMORE CANYON SUBSTATION TO PENASQUITOS - 230 KV UNDERGROUND

AIRX JOB#: X160218 THOMAS GRID#:-

TYPE OF WORK: TRENCHING / CONDUIT DRAWN FOR: CALTRANS

MISC./POTHOLE#:

PHASE 82

DATE: Mar. 21, 2017
DESIGNED BY: Clint Jones
SHEET 098 OF 148



ORIGINAL PERMIT MUST BE KEPT ON JOB SITE ALL TIMES

APPROVED TRAFFIC CONTROL PERMIT

SEP 14 2017

**CITY OF SAN DIEGO
Development Services
Engineering Division
Traffic Safety Section**

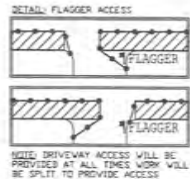
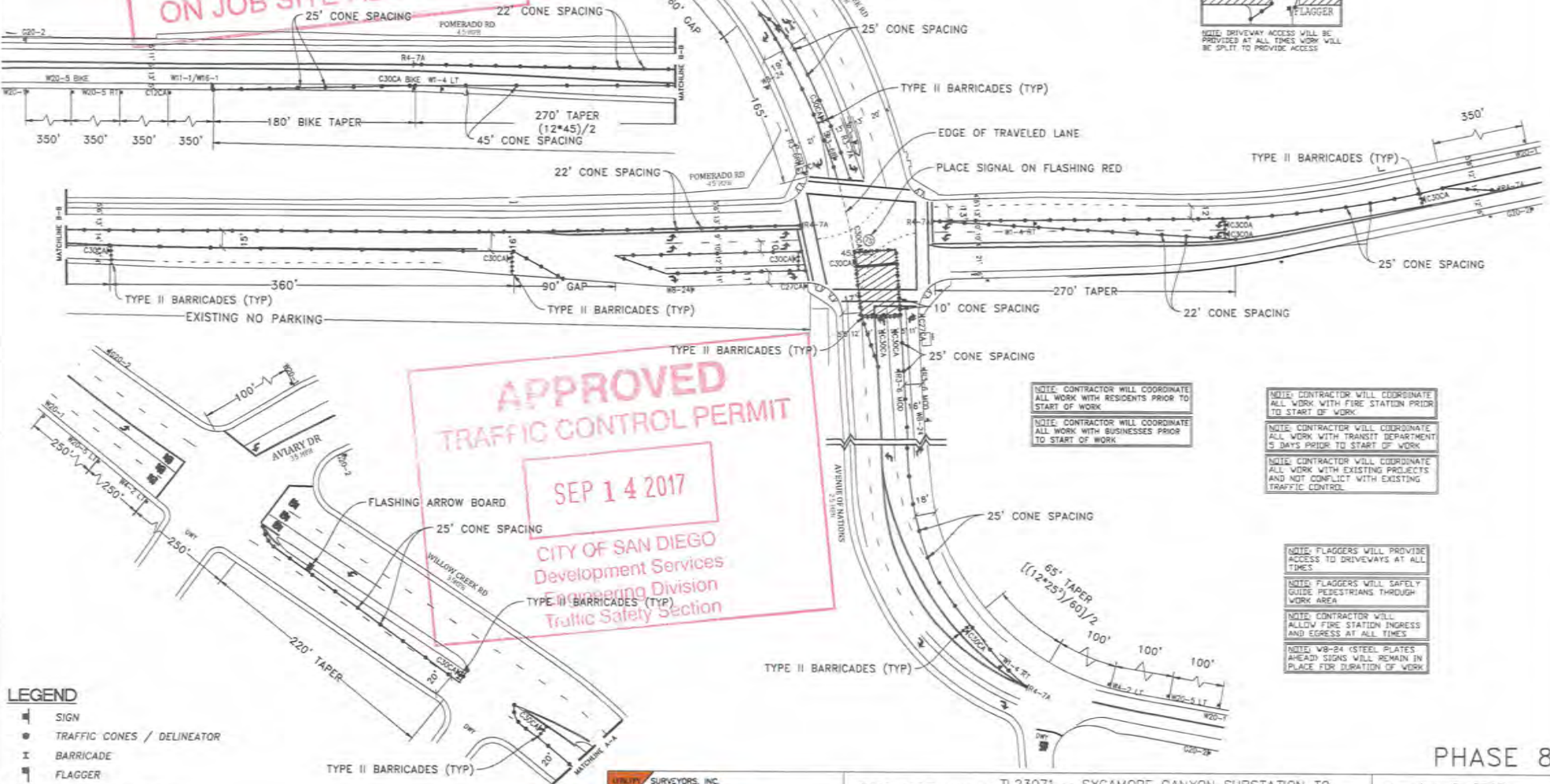

NOTE: DRIVEWAY ACCESS WILL BE PROVIDED AT ALL TIMES WORK WILL BE SPLIT TO PROVIDE ACCESS

NOTE: CONTRACTOR WILL COORDINATE ALL WORK WITH RESIDENTS PRIOR TO START OF WORK
NOTE: CONTRACTOR WILL COORDINATE ALL WORK WITH BUSINESSES PRIOR TO START OF WORK

NOTE: CONTRACTOR WILL COORDINATE ALL WORK WITH FIRE STATION PRIOR TO START OF WORK
NOTE: CONTRACTOR WILL COORDINATE ALL WORK WITH TRANSIT DEPARTMENT 5 DAYS PRIOR TO START OF WORK
NOTE: CONTRACTOR WILL COORDINATE ALL WORK WITH EXISTING PROJECTS AND NOT CONFLICT WITH EXISTING TRAFFIC CONTROL

NOTE: FLAGGERS WILL PROVIDE ACCESS TO DRIVEWAYS AT ALL TIMES
NOTE: FLAGGERS WILL SAFELY GUIDE PEDESTRIANS THROUGH WORK AREA
NOTE: CONTRACTOR WILL ALLOW FIRE STATION INGRESS AND EGRESS AT ALL TIMES
NOTE: W8-24 (STEEL PLATES AHEAD) SIGNS WILL REMAIN IN PLACE FOR DURATION OF WORK

- LEGEND**
- SIGN
- TRAFFIC CONES / DELINEATOR
- BARRICADE
- FLAGGER
- FLASHING ARROW SIGN
- WORK ZONE
- BUS STOP

WORK HOURS: TO
NOTE: CONTACT MUST BE MAINTAINED BETWEEN FLAGGERS OR USE 2-WAY COMMUNICATION
FLAGGER WILL ASSIST WITH BUS/VEHICLE TRAFFIC

AIRX SURVEYORS, INC.
Gail McMorran
President
2504 EAST EL MONTE PARKWAY, SUITE C
SACRAMENTO, CA 95827
PHONE: (916) 450-2547
CELL: (916) 419-3728

PROJECT NAME: TL23071 - SYCAMORE CANYON SUBSTATION TO PENASQUITOS - 230 KV UNDERGROUND		DATE: Apr. 6, 2017
AIRX JOB#: X160218	THOMAS GRID#:	DESIGNED BY: Clint Jones
TYPE OF WORK: RENCHING / CONDUIT	DRAWN FOR: CALTRANS	
MISC./POTHOLES#:		SHEET 099 OF 148

PHASE 83

**ORIGINAL PERMIT MUST
BE KEPT
ON JOB SITE ALL TIMES**

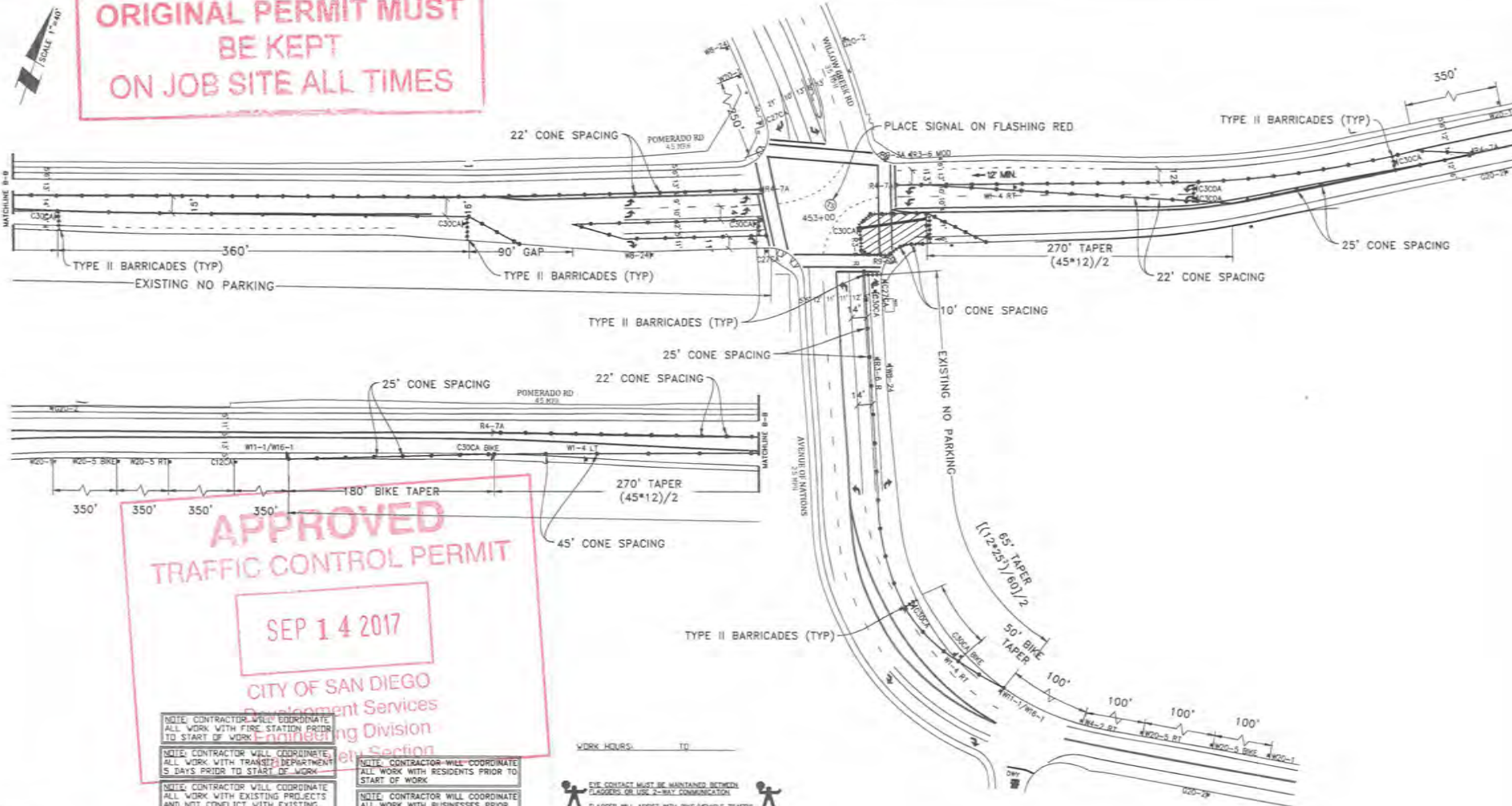

**APPROVED
TRAFFIC CONTROL PERMIT**

SEP 14 2017

CITY OF SAN DIEGO
Development Services
Engineering Division
Utility Section

NOTE: CONTRACTOR WILL COORDINATE ALL WORK WITH FIRE STATION PRIOR TO START OF WORK

NOTE: CONTRACTOR WILL COORDINATE ALL WORK WITH TRANSIT DEPARTMENT 5 DAYS PRIOR TO START OF WORK

NOTE: CONTRACTOR WILL COORDINATE ALL WORK WITH EXISTING PROJECTS AND NOT CONFLICT WITH EXISTING TRAFFIC CONTROL

NOTE: CONTRACTOR WILL COORDINATE ALL WORK WITH RESIDENTS PRIOR TO START OF WORK

NOTE: CONTRACTOR WILL COORDINATE ALL WORK WITH BUSINESSES PRIOR TO START OF WORK

WORK HOURS: _____ TO _____

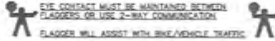

- LEGEND**
- SIGN
 - TRAFFIC CONES / DELINEATOR
 - BARRICADE
 - FLAGGER
 - FLASHING ARROW SIGN
 - WORK ZONE
 - BUS STOP

NOTE: FLAGGERS WILL PROVIDE ACCESS TO DRIVEWAYS AT ALL TIMES

NOTE: FLAGGERS WILL SAFELY GUIDE PEDESTRIANS THROUGH WORK AREA

NOTE: CONTRACTOR WILL ALLOW FIRE STATION INGRESS AND EGRESS AT ALL TIMES

NOTE: WB-24 (STEEL PLATES AHEAD) SIGNS WILL REMAIN IN PLACE FOR DURATION OF WORK

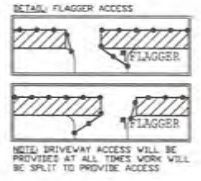

AIRX SURVEYORS, INC.
Gail McMorrin
President
2324 EAST EL NORTE PARKWAY, SUITE C
ESCONDIDO, CA 92027
PHONE: (760) 480-2347
CELL: (760) 419-5726

PROJECT NAME: TL23071 - SYCAMORE CANYON SUBSTATION TO PENASQUITOS - 230 KV UNDERGROUND

AIRX JOB#: X160218

TYPE OF WORK: TRENCHING / CONDUIT

MISC./POTHOLES#: _____

PHASE 84

DATE: Mar. 21, 2017
DESIGNED BY: Clint Jones
SHEET 100 OF 148

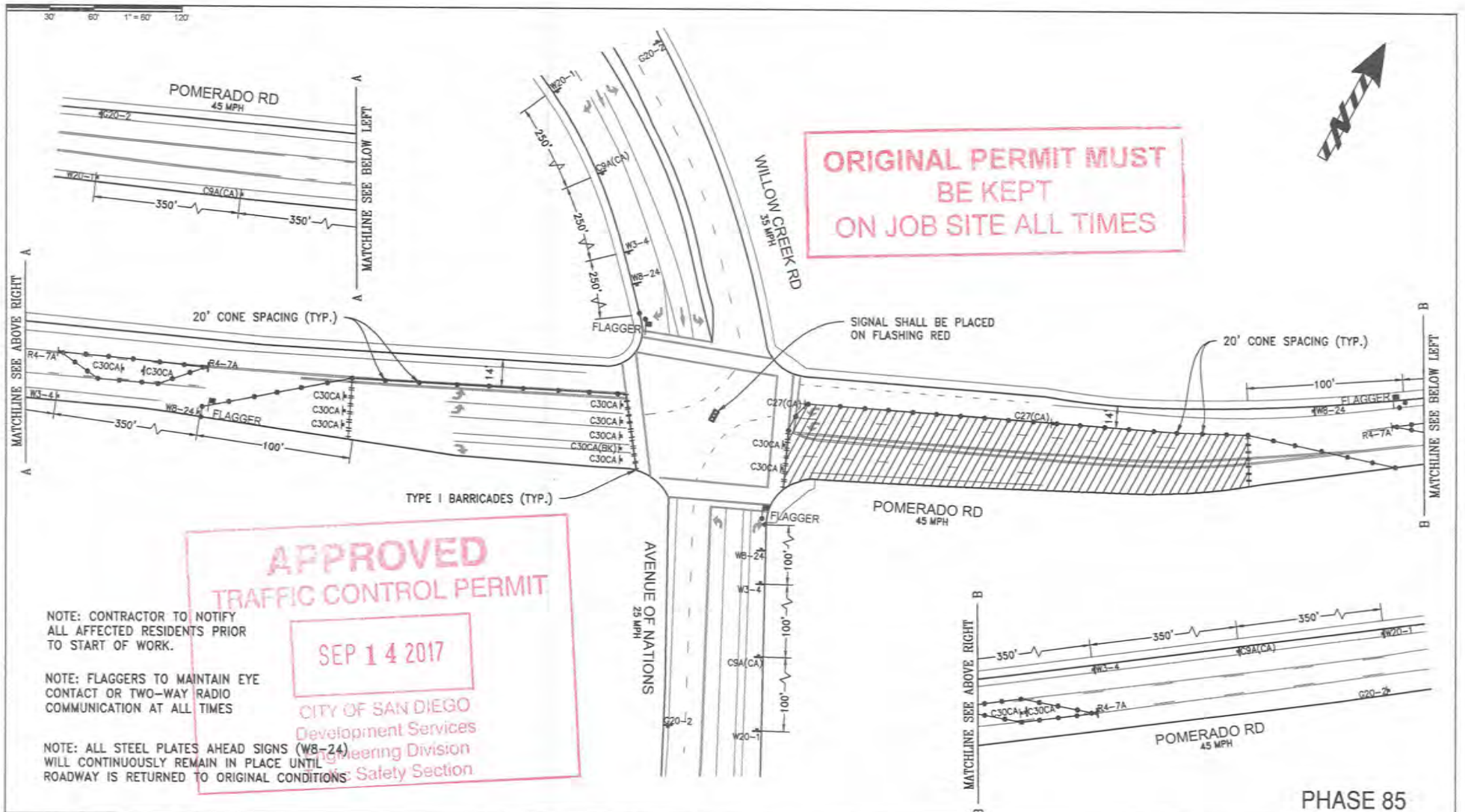

ORIGINAL PERMIT MUST BE KEPT ON JOB SITE ALL TIMES

APPROVED TRAFFIC CONTROL PERMIT

SEP 14 2017

CITY OF SAN DIEGO
Development Services
Traffic Meaning Division
Safety Section

NOTE: CONTRACTOR TO NOTIFY ALL AFFECTED RESIDENTS PRIOR TO START OF WORK.

NOTE: FLAGGERS TO MAINTAIN EYE CONTACT OR TWO-WAY RADIO COMMUNICATION AT ALL TIMES

NOTE: ALL STEEL PLATES AHEAD SIGNS (WB-24) WILL CONTINUOUSLY REMAIN IN PLACE UNTIL ROADWAY IS RETURNED TO ORIGINAL CONDITIONS.



1221 S. 26TH ST
SAN DIEGO, CA 92113
OFFICE: (858) 259-0300
FAX: (858) 259-0357

POSTED SPEED LIMIT (MPH)	SEE PLAN	MIGUEL URESTI
SIGN SPACING (FEET)	SEE PLAN	DRAWN BY:
TAPER LENGTH (FEET)	SEE PLAN	PROJECT NUMBER:
CONE SPACING (FEET)	SEE PLAN	DATE: July 6, 2017

SXPO EAST SIDE POMERADO	
PROJECT INFORMATION	
ARB	COMPANY
ROD NELSON	619.295.2754
PROJECT CONTACT	PHONE

TRAFFIC CONTROL PLANS	
CITY OF SAN DIEGO	
SHEET 101 OF 148	

PHASE 85



ORIGINAL PERMIT MUST
BE KEPT
ON JOB SITE ALL TIMES

APPROVED
TRAFFIC CONTROL PERMIT

SEP 14 2017

CITY OF SAN DIEGO
Development Services
Engineering Division
Traffic Section

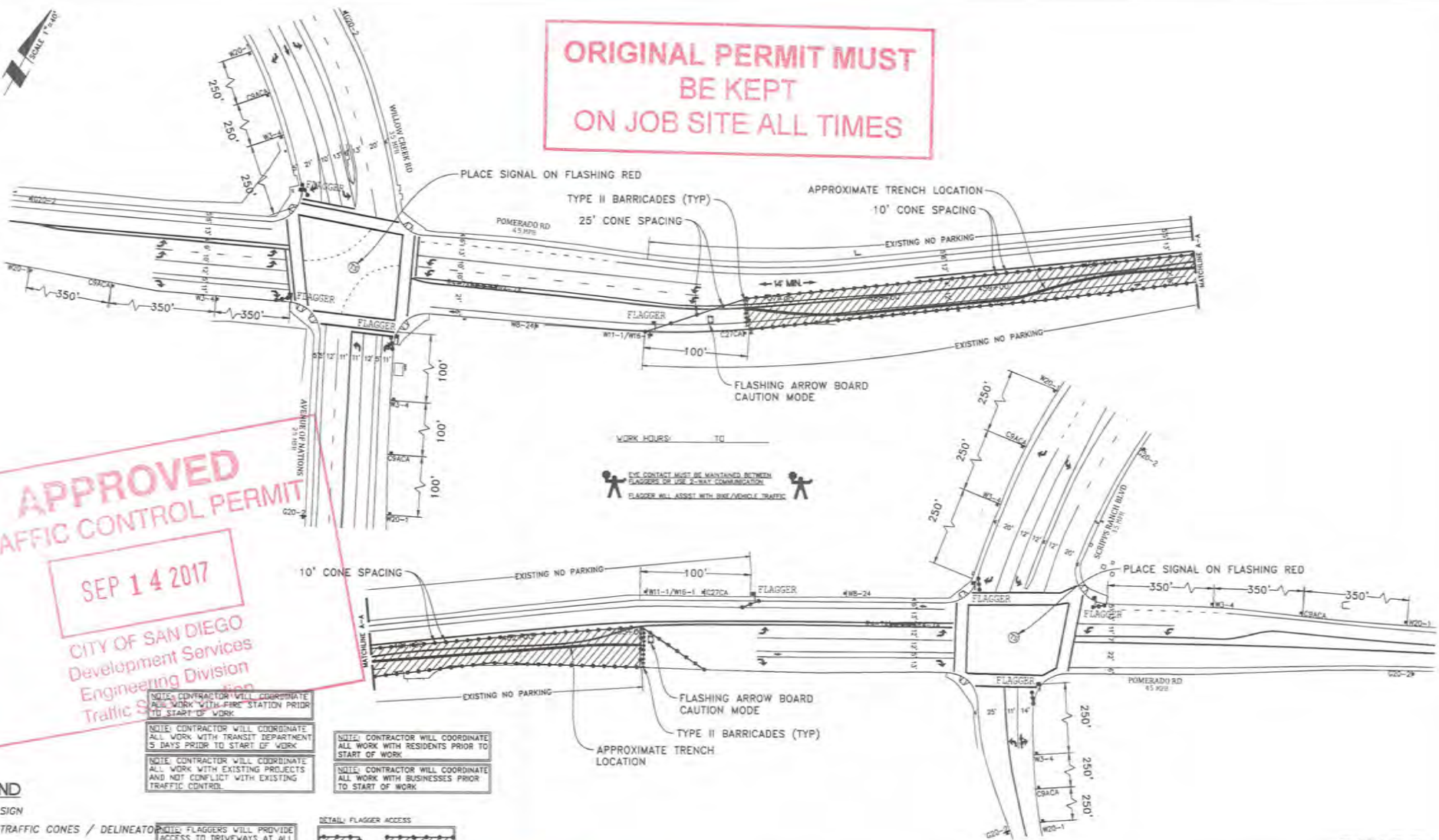

- NOTE: CONTRACTOR WILL COORDINATE ALL WORK WITH TRANSIT DEPARTMENT 5 DAYS PRIOR TO START OF WORK
- NOTE: CONTRACTOR WILL COORDINATE ALL WORK WITH RESIDENTS PRIOR TO START OF WORK
- NOTE: CONTRACTOR WILL COORDINATE ALL WORK WITH EXISTING PROJECTS AND NOT CONFLICT WITH EXISTING TRAFFIC CONTROL
- NOTE: CONTRACTOR WILL COORDINATE ALL WORK WITH BUSINESSES PRIOR TO START OF WORK

- LEGEND**
- SIGN
 - TRAFFIC CONES / DELINEATOR
 - BARRICADE
 - FLAGGER
 - FLASHING ARROW SIGN
 - WORK ZONE
 - BUS STOP

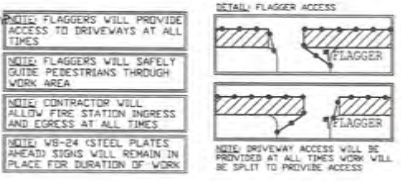

AIRX SURVEYORS, INC.
Gail McMorran
President
2524 EAST EL NORTE PARKWAY, SUITE C
ESCONDIDO, CA 92027
PHONE: (760) 480-2547
CELL: (760) 418-3728

PROJECT NAME: TL23071 - SYCAMORE CANYON SUBSTATION TO PENASQUITOS - 230 KV UNDERGROUND		DATE: Mar. 21, 2017
AIRX JOB#: X160218	THOMAS GRID#:	DESIGNED BY: Clint Jones
TYPE OF WORK: TRENCHING / CONDUIT	DRAWN FOR: CALTRANS	SHEET: 102 OF 148
MISC./POTHOLES#:		

PHASE 86

APPROVED TRAFFIC CONTROL PERMIT

SEP 14 2017

CITY OF SAN DIEGO
Development Services
Engineering Division
Traffic Safety Section

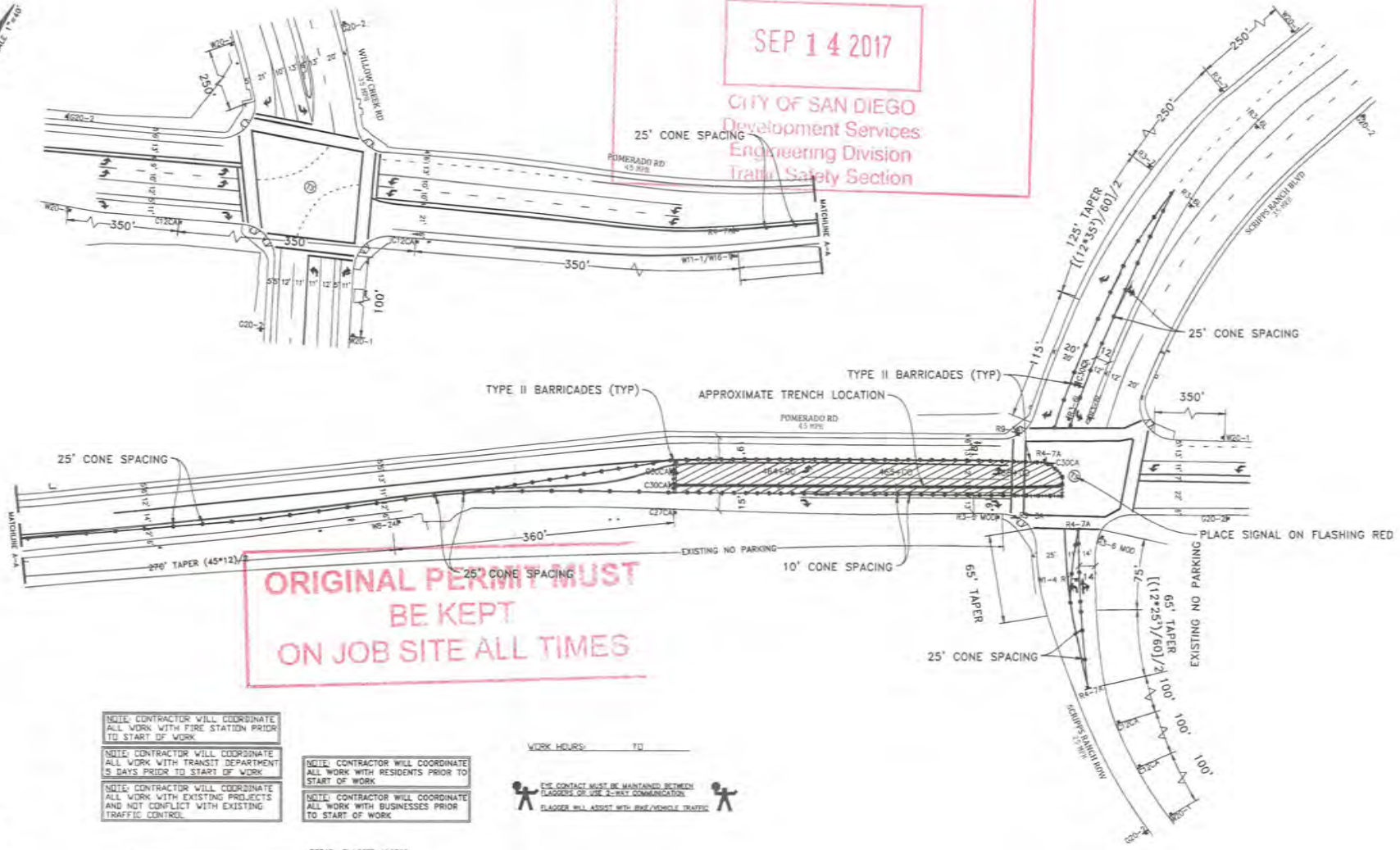

**ORIGINAL PERMIT MUST
BE KEPT
ON JOB SITE ALL TIMES**

NOTE: CONTRACTOR WILL COORDINATE ALL WORK WITH FIRE STATION PRIOR TO START OF WORK.

NOTE: CONTRACTOR WILL COORDINATE ALL WORK WITH TRANSIT DEPARTMENT 5 DAYS PRIOR TO START OF WORK.

NOTE: CONTRACTOR WILL COORDINATE ALL WORK WITH EXISTING PROJECTS AND NOT CONFLICT WITH EXISTING TRAFFIC CONTROL.







NOTE: CONTRACTOR WILL COORDINATE ALL WORK WITH RESIDENTS PRIOR TO START OF WORK.

NOTE: CONTRACTOR WILL COORDINATE ALL WORK WITH BUSINESSES PRIOR TO START OF WORK.

WORK HOURS: _____ TO _____

THE CONTACT MUST BE MAINTAINED BETWEEN FLAGGERS OR USE 2-WAY COMMUNICATION.
FLAGGER WILL ASSIST WITH BUREAU (VEHICLE TRAFFIC)

LEGEND

-  SIGN
-  TRAFFIC CONES / DELINEATOR
-  BARRICADE
-  FLAGGER
-  FLASHING ARROW SIGN
-  WORK ZONE
-  BUS STOP

NOTE: FLAGGERS WILL PROVIDE ACCESS TO DRIVEWAYS AT ALL TIMES.

NOTE: FLAGGERS WILL SAFELY GUIDE PEDESTRIANS THROUGH WORK AREA.

NOTE: CONTRACTOR WILL ALLOW FIRE STATION INGRESS AND EGRESS AT ALL TIMES.

NOTE: W8-24 STEEL PLATES (SHIELD STICKS) WILL REMAIN IN PLACE FOR DURATION OF WORK.

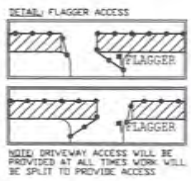

AIRX SURVEYORS, INC.
Gail McMorran
President
2504 EAST EL NORTE PARKWAY, SUITE C
ESCONDIDO, CA 92027
PHONE: (760) 480-2447
CELL: (760) 418-3728

PROJECT NAME TL23071 - SYCAMORE CANYON SUBSTATION TO PENASQUITOS - 230 KV UNDERGROUND		DATE: Mar. 21, 2017
AIRX JOB#X160218	THOMAS GRID#:-	DESIGNED BY: Clint Jones
TYPE OF WORK: RENCHING / CONDUIT	DRAWN FOR: CALTRANS	
MISC./POTHOLES#:		SHEET 103 OF 148

PHASE 87

APPROVED TRAFFIC CONTROL PERMIT

SEP 14 2017

CITY OF SAN DIEGO
Development Services
Engineering Division
Traffic Safety Section

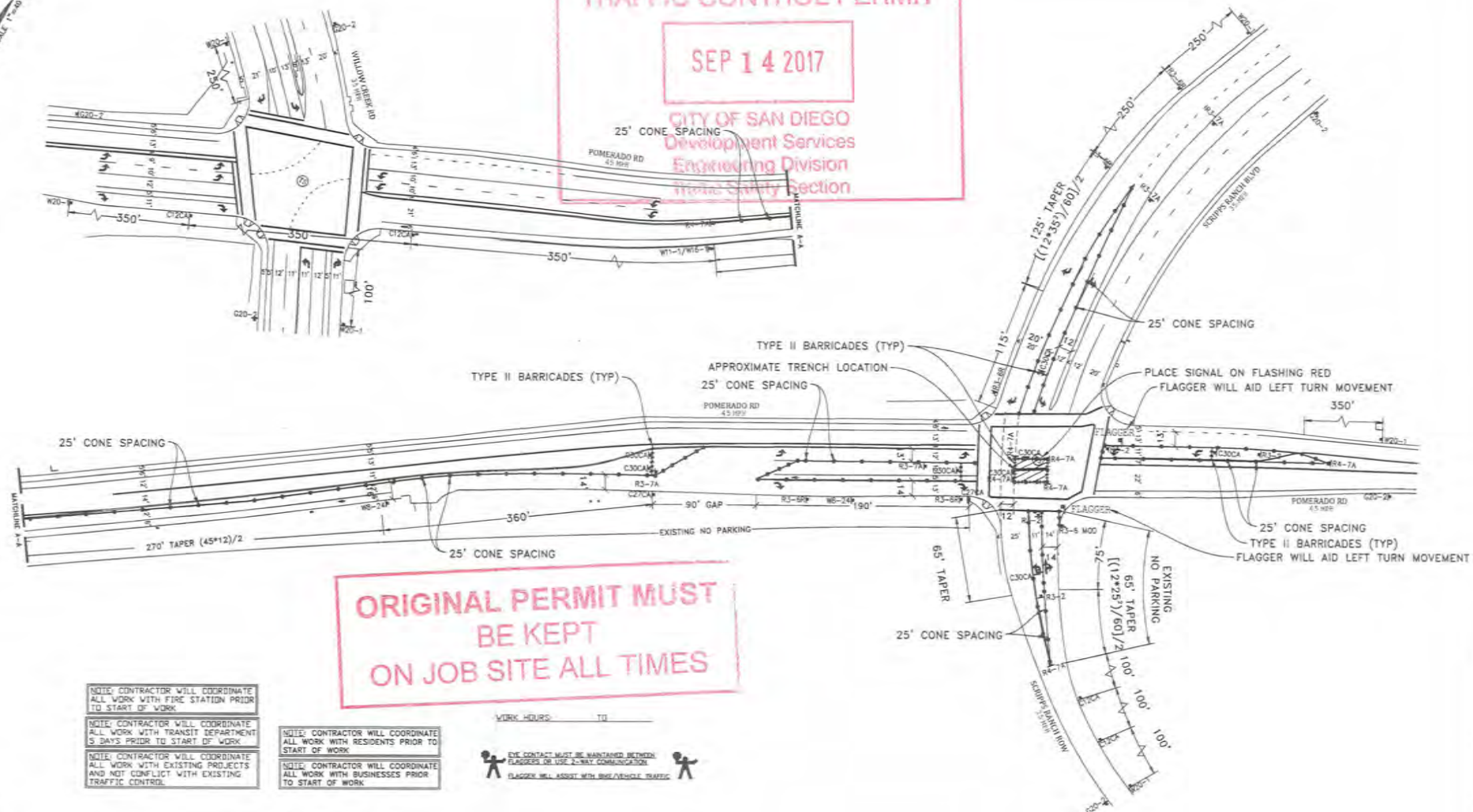

**ORIGINAL PERMIT MUST
BE KEPT
ON JOB SITE ALL TIMES**

- NOTE: CONTRACTOR WILL COORDINATE ALL WORK WITH FIRE STATION PRIOR TO START OF WORK.
- NOTE: CONTRACTOR WILL COORDINATE ALL WORK WITH TRANSIT DEPARTMENT 5 DAYS PRIOR TO START OF WORK.
- NOTE: CONTRACTOR WILL COORDINATE ALL WORK WITH EXISTING PROJECTS AND NOT CONFLICT WITH EXISTING TRAFFIC CONTROL.
- NOTE: CONTRACTOR WILL COORDINATE ALL WORK WITH RESIDENTS PRIOR TO START OF WORK.
- NOTE: CONTRACTOR WILL COORDINATE ALL WORK WITH BUSINESSES PRIOR TO START OF WORK.

WORK HOURS: _____ TO _____

EYE CONTACT MUST BE MAINTAINED BETWEEN FLAGGER OR USE 2-WAY COMMUNICATION.
FLAGGER WILL ASSIST WITH BUS/VEHICLE TRAFFIC

- LEGEND**
- SIGN
 - TRAFFIC CONES / DELINEATOR
 - I BARRICADE
 - ⚑ FLAGGER
 - ⇨ FLASHING ARROW SIGN
 - ▨ WORK ZONE
 - 🚌 BUS STOP

- DETAIL: FLAGGER ACCESS**
- NOTE: FLAGGERS WILL PROVIDE ACCESS TO DRIVEWAYS AT ALL TIMES.
 - NOTE: FLAGGERS WILL SAFELY GUIDE PEDESTRIANS THROUGH WORK AREA.
 - NOTE: CONTRACTOR WILL ALLOW FIRE STATION INGRESS AND EGRESS AT ALL TIMES.
 - NOTE: V8-24 STEEL PLATES AHEAD SIGNS WILL REMAIN IN PLACE FOR DURATION OF WORK.
 - NOTE: DRIVEWAY ACCESS WILL BE PROVIDED AT ALL TIMES WORK WILL BE SPLIT TO PROVIDE ACCESS.

AIRX SURVEYORS, INC.
Gail McMoran
President
2534 EAST EL NORTE PARWAY, SUITE C
ESCONDIDO, CA 92027
PHONE: (760) 480-2547
CELL: (760) 419-3728

PHASE 88	
PROJECT NAME: TL23071 - SYCAMORE CANYON SUBSTATION TO PENASQUITOS - 230 KV UNDERGROUND	
AIRX JOB#: X160218	THOMAS GRID#:-
TYPE OF WORK: TRENCHING / CONDUIT	DRAWN FOR: CALTRANS
MISC./POTHOLE#:	
DATE: Mar. 21, 2017 DESIGNED BY: Clint Jones SHEET 104 OF 148	

APPROVED TRAFFIC CONTROL PERMIT

SEP 14 2017

CITY OF SAN DIEGO
Development Services
Engineering Division
Traffic Safety Section

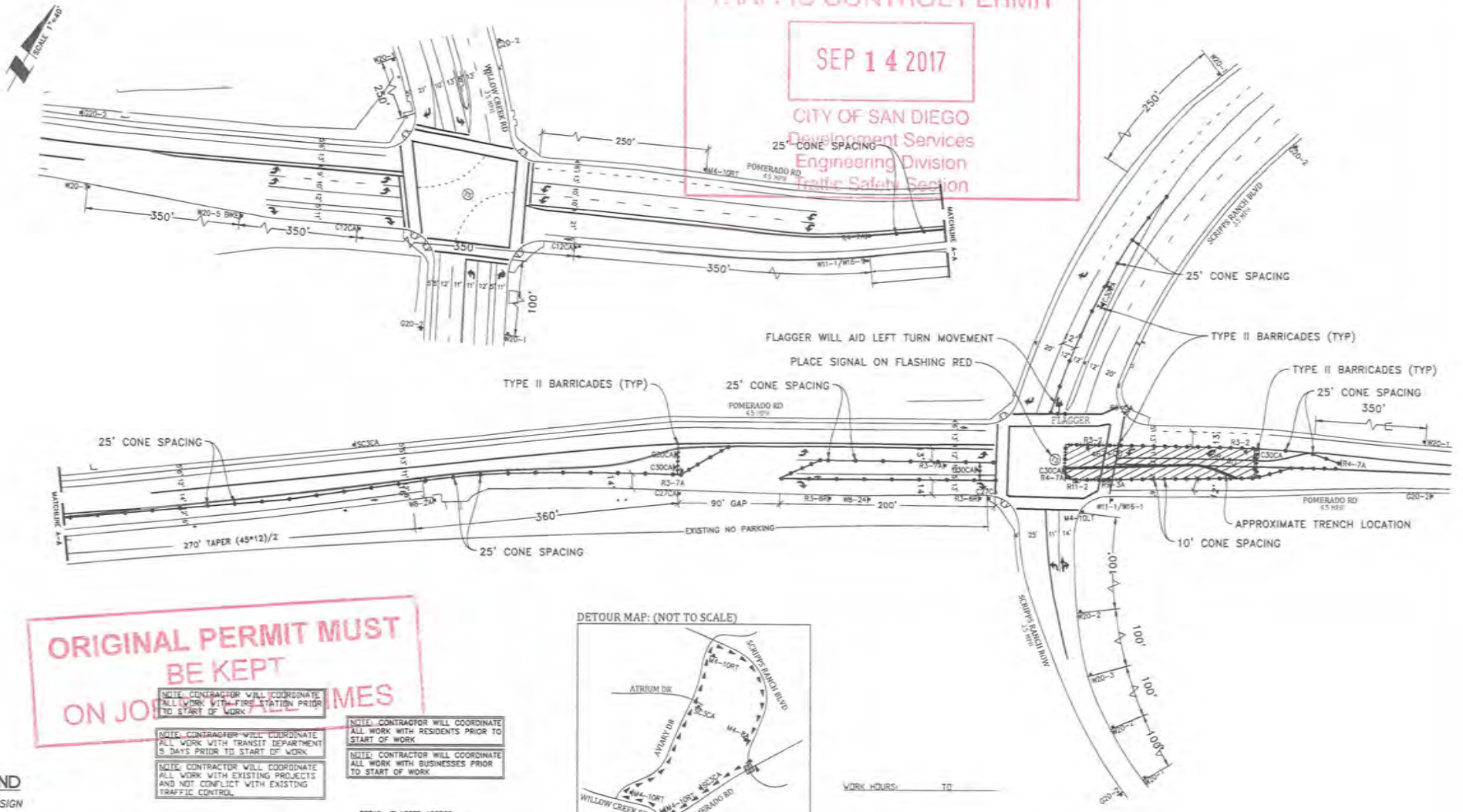

ORIGINAL PERMIT MUST BE KEPT ON JOB ALL TIMES

NOTE: CONTRACTOR WILL COORDINATE ALL WORK WITH FIRE STATION PRIOR TO START OF WORK

NOTE: CONTRACTOR WILL COORDINATE ALL WORK WITH TRANSIT DEPARTMENT 5 DAYS PRIOR TO START OF WORK

NOTE: CONTRACTOR WILL COORDINATE ALL WORK WITH EXISTING PROJECTS AND NOT CONFLICT WITH EXISTING TRAFFIC CONTROL

NOTE: CONTRACTOR WILL COORDINATE ALL WORK WITH RESIDENTS PRIOR TO START OF WORK

NOTE: CONTRACTOR WILL COORDINATE ALL WORK WITH BUSINESSES PRIOR TO START OF WORK

NOTE: FLAGGERS WILL PROVIDE ACCESS TO DRIVEWAYS AT ALL TIMES

NOTE: FLAGGERS WILL SAFELY GUIDE PEDESTRIANS THROUGH WORK AREA

NOTE: CONTRACTOR WILL ALLOW FIRE STATION INGRESS AND EGRESS AT ALL TIMES

NOTE: W8-24 STEEL PLATES AHEAD SIGNS WILL REMAIN IN PLACE FOR DURATION OF WORK

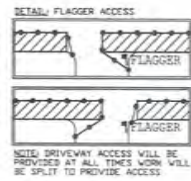

DETOUR MAP: (NOT TO SCALE)

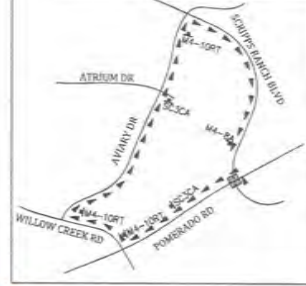

WORK HOURS: _____ TO _____



- LEGEND**
- SIGN
 - TRAFFIC CONES / DELINEATOR
 - BARRICADE
 - FLAGGER
 - FLASHING ARROW SIGN
 - WORK ZONE
 - BUS STOP

UTILITY SURVEYORS, INC.

Gail McMoran
President

2004 EAST EL NORTE PARKWAY, SUITE C
ESCONDIDO, CA 92027
PHONE: (760) 460-2347
CELL: (760) 418-3728

PROJECT NAME: TL23071 - SYCAMORE CANYON SUBSTATION TO PENASQUITOS - 230 KV UNDERGROUND	
AIRX JOB#: X160218	THOMAS GRID#:
TYPE OF WORK: RENCHING / CONDUIT	DRAWN FOR: CALTRANS
MISC./POTHOLE#:	

PHASE 89

DATE: Mar. 21, 2017
DESIGNED BY: Clint Jones
SHEET 105 OF 148

APPROVED TRAFFIC CONTROL PERMIT

SEP 14 2017

CITY OF SAN DIEGO
Development Services
Permitting Division
Traffic Safety Section

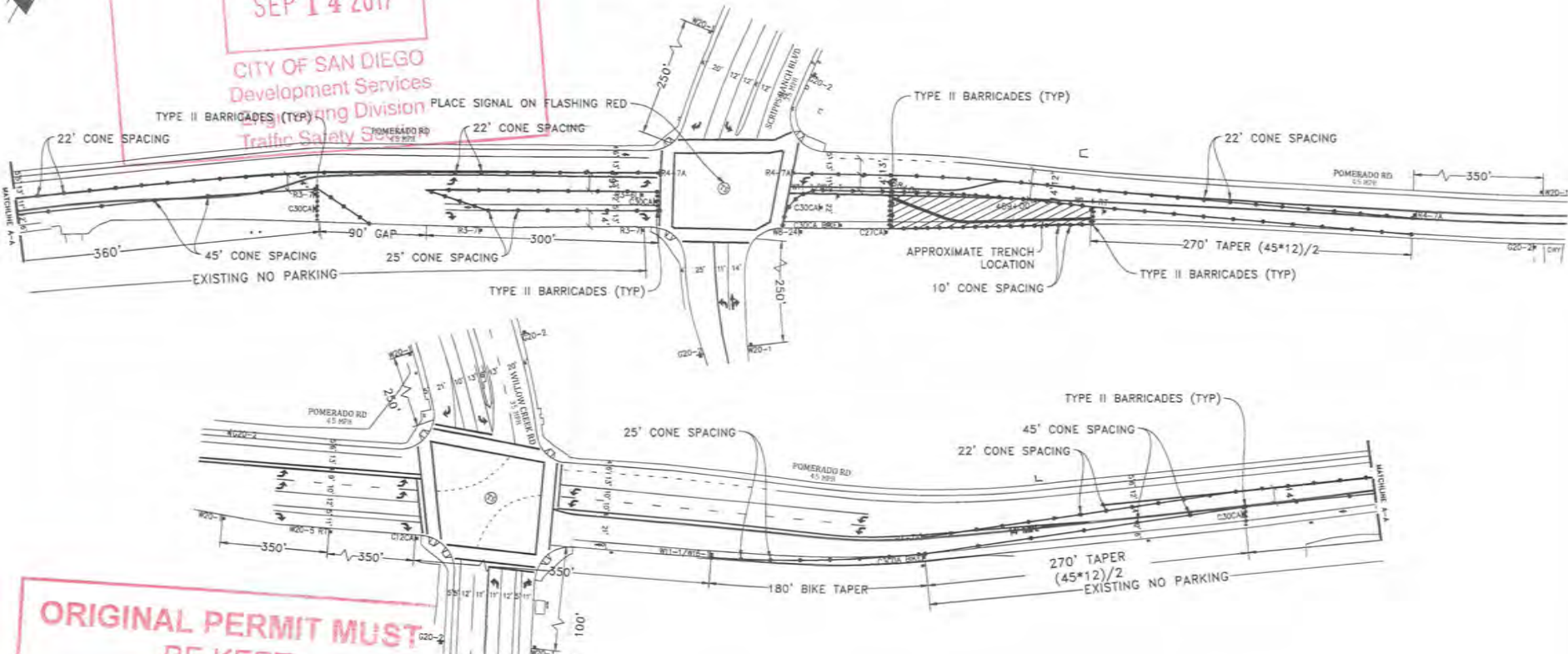

ORIGINAL PERMIT MUST BE KEPT ON JOB SITE ALL TIMES

- LEGEND**
- SIGN
 - TRAFFIC CONES / DELINEATOR
 - BARRICADE
 - FLAGGER
 - FLASHING ARROW SIGN
 - WORK ZONE
 - BUS STOP

NOTE: FLAGGERS WILL PROVIDE ACCESS TO DRIVEWAYS AT ALL TIMES

NOTE: FLAGGERS WILL SAFELY GUIDE PEDESTRIANS THROUGH WORK AREA

NOTE: CONTRACTOR WILL ALLOW FIRE STATION INGRESS AND EGRESS AT ALL TIMES

NOTE: W8-24 STEEL PLATES AHEAD SIGNS WILL REMAIN IN PLACE FOR DURATION OF WORK

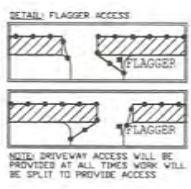

NOTE: CONTRACTOR WILL COORDINATE ALL WORK WITH FIRE STATION PRIOR TO START OF WORK

NOTE: CONTRACTOR WILL COORDINATE ALL WORK WITH TRANSIT DEPARTMENT 5 DAYS PRIOR TO START OF WORK

NOTE: CONTRACTOR WILL COORDINATE ALL WORK WITH EXISTING PROJECTS AND NOT CONFLICT WITH EXISTING TRAFFIC CONTROL

NOTE: CONTRACTOR WILL COORDINATE ALL WORK WITH RESIDENTS PRIOR TO START OF WORK

NOTE: CONTRACTOR WILL COORDINATE ALL WORK WITH BUSINESSES PRIOR TO START OF WORK

WORK HOURS: _____ TO _____



AIRX SURVEYORS, INC.
Gail McMorran
President
2204 EAST EL NORTE PARKWAY, SUITE C
ESCONDIDO, CA 92027
PHONE: (760) 480-2547
CELL: (760) 418-9728

PROJECT NAME: TL23071 - SYCAMORE CANYON SUBSTATION TO PENASQUITOS - 230 KV UNDERGROUND	
AIRX JOB#: X160218	THOMAS GRID#:-
TYPE OF WORK: TRENCHING / CONDUIT	DRAWN FOR: CALTRANS
MISC./POTHOLE#:	

PHASE 90

DATE: Mar. 21, 2017
DESIGNED BY: Clint Jones

SHEET 106 OF 148



APPROVED
TRAFFIC CONTROL PERMIT

SEP 14 2017

CITY OF SAN DIEGO
 Development Services
 Engineering Division
 Traffic Safety Section

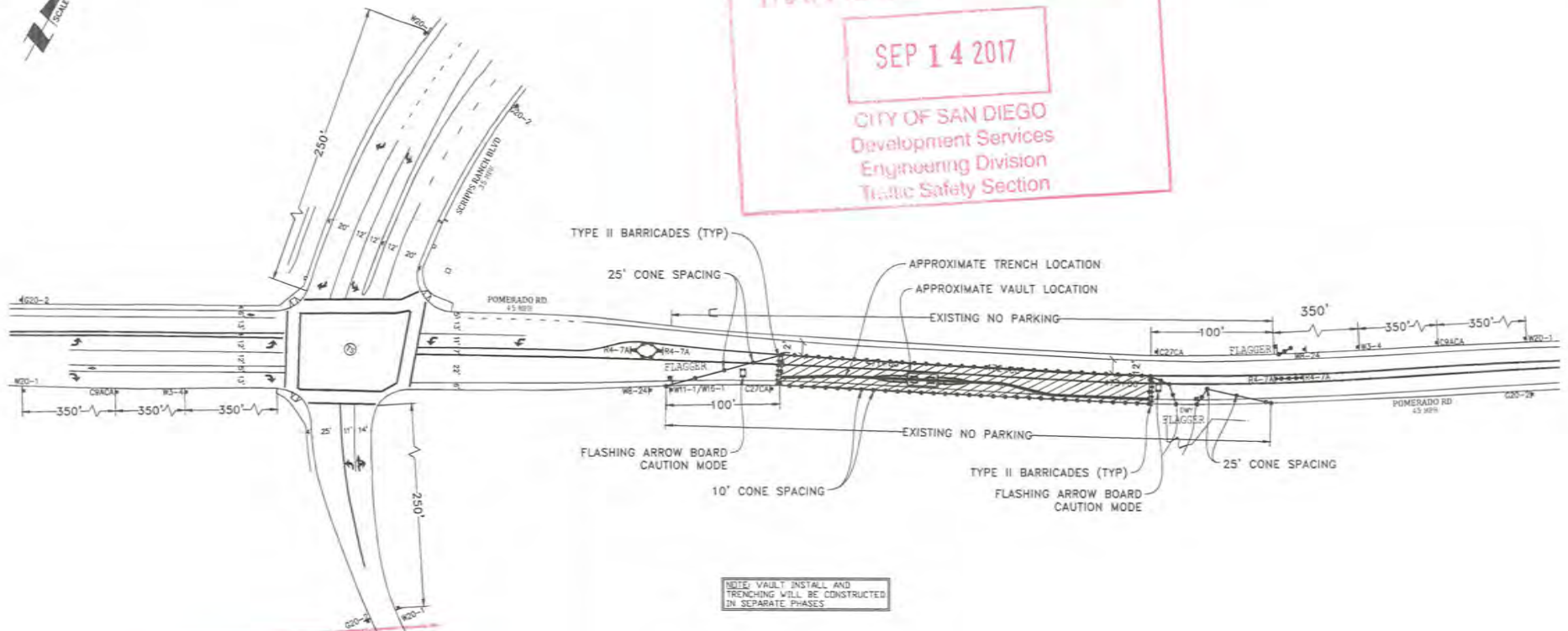

NOTE: VAULT INSTALL AND TRENCHING WILL BE CONSTRUCTED IN SEPARATE PHASES

NOTE: CONTRACTOR WILL COORDINATE ALL WORK WITH FIRE STATION PRIOR TO START OF WORK

NOTE: CONTRACTOR WILL COORDINATE ALL WORK WITH TRANSIT DEPARTMENT 5 DAYS PRIOR TO START OF WORK

NOTE: CONTRACTOR WILL COORDINATE ALL WORK WITH EXISTING PROJECTS AND NOT CONFLICT WITH EXISTING TRAFFIC CONTROL

NOTE: CONTRACTOR WILL COORDINATE ALL WORK WITH RESIDENTS PRIOR TO START OF WORK

NOTE: CONTRACTOR WILL COORDINATE ALL WORK WITH BUSINESSES PRIOR TO START OF WORK

WORK HOURS: _____ TO _____

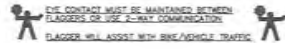

LEGEND

- SIGN
- TRAFFIC CONES / DELINEATOR
- BARRICADE
- FLAGGER
- FLASHING ARROW SIGN
- WORK ZONE
- BUS STOP

NOTE: FLAGGERS WILL PROVIDE ACCESS TO DRIVEWAYS AT ALL TIMES

NOTE: FLAGGERS WILL SAFELY GUIDE PEDESTRIANS THROUGH WORK AREA

NOTE: CONTRACTOR WILL ALLOW FIRE STATION INGRESS AND EGRESS AT ALL TIMES

NOTE: WB-24 STEEL PLATES AHEAD SIGNS WILL REMAIN IN PLACE FOR DURATION OF WORK

DETAIL: FLAGGER ACCESS



NOTE: DRIVEWAY ACCESS WILL BE PROVIDED AT ALL TIMES WORK WILL BE SPLIT TO PROVIDE ACCESS

AIRX SURVEYORS, INC.
 Gail McMorran
 President
 2004 EAST EL NORTE PARKWAY, SUITE C
 ESCONDIDO, CA 92027
 PHONE: (760) 450-2347
 CELL: (760) 419-3738

PROJECT NAME: TL23071 - SYCAMORE CANYON SUBSTATION TO PENASQUITOS - 230 KV UNDERGROUND	
AIRX JOB#: X160218	THOMAS GRID#:
TYPE OF WORK: TRENCHING / CONDUIT	DRAWN FOR: CALTRANS
MISC./POTHOLES#:	

PHASE 91

DATE: Mar. 21, 2017
DESIGNED BY: Clint Jones
SHEET 107 OF 148

APPROVED
TRAFFIC CONTROL PERMIT

SEP 14 2017

CITY OF SAN DIEGO
Development Services
Engineering Division
Traffic Safety Section

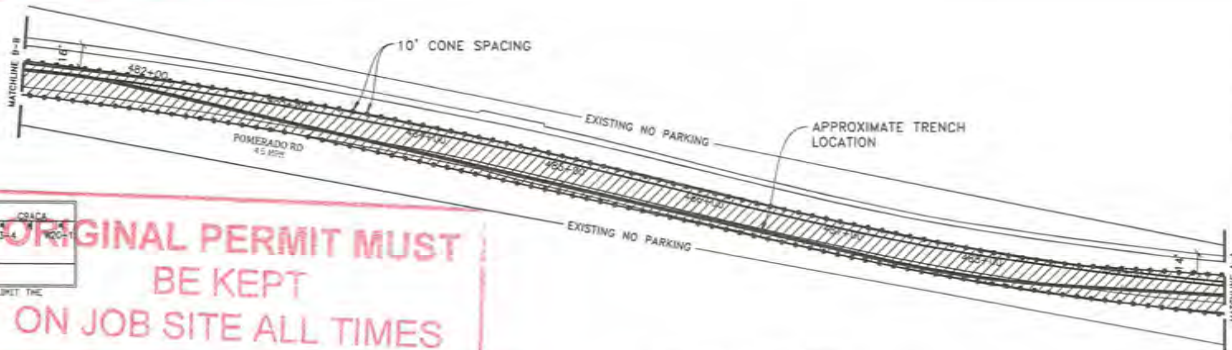
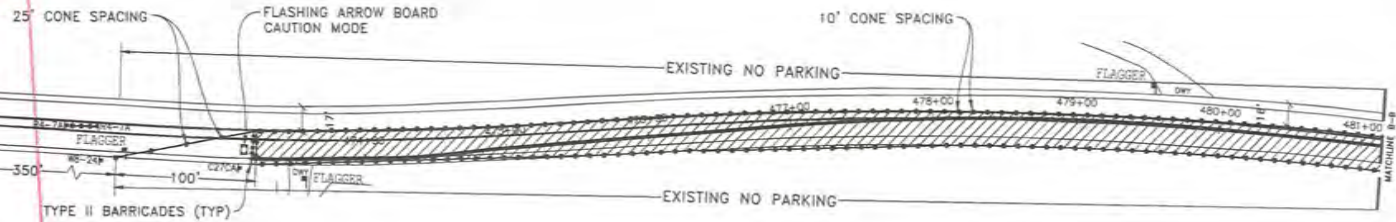

NOTE: VAULT INSTALL AND TRENCHING WILL BE CONSTRUCTED IN SEPARATE PHASES

DETAIL: 250' WORK AREA (NOT TO SCALE)

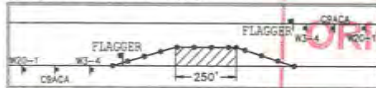

NOTE: CONTRACTOR WILL WORK IN 250' STAGES THEY WILL LIMIT THE LENGTH OF THE WORK AREA TO 250' PER WORKDAY

ORIGINAL PERMIT MUST BE KEPT ON JOB SITE ALL TIMES

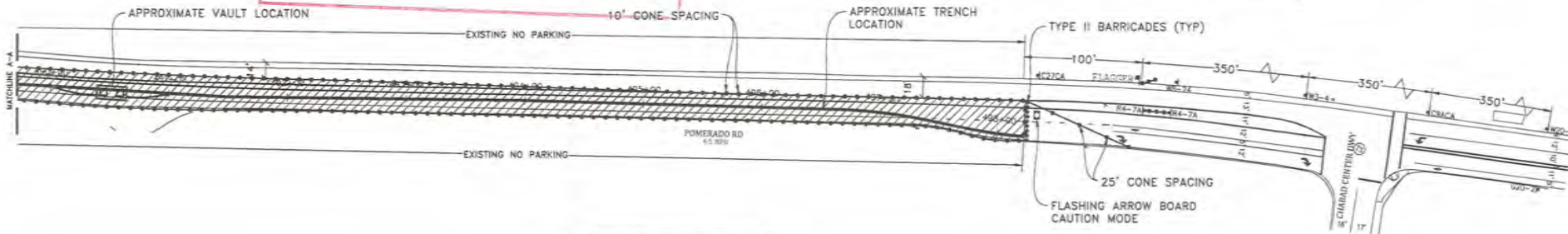

NOTE: CONTRACTOR WILL COORDINATE ALL WORK WITH FIRE STATION PRIOR TO START OF WORK

NOTE: CONTRACTOR WILL COORDINATE ALL WORK WITH TRANSIT DEPARTMENT 3 DAYS PRIOR TO START OF WORK

NOTE: CONTRACTOR WILL COORDINATE ALL WORK WITH EXISTING PROJECTS AND NOT CONFLICT WITH EXISTING TRAFFIC CONTROL

NOTE: CONTRACTOR WILL COORDINATE ALL WORK WITH RESIDENTS PRIOR TO START OF WORK

NOTE: CONTRACTOR WILL COORDINATE ALL WORK WITH BUSINESSES PRIOR TO START OF WORK

WORK HOURS: _____ TO _____

EYE CONTACT MUST BE MAINTAINED BETWEEN FLAGGERS OR USE 2-WAY COMMUNICATION
FLAGGER WILL ASSIST WITH ONE-WAY TRAFFIC

LEGEND

- SIGN
- TRAFFIC CONES / DELINEATOR
- BARRICADE
- FLAGGER
- FLASHING ARROW SIGN
- WORK ZONE
- BUS STOP

NOTE: FLAGGERS WILL PROVIDE ACCESS TO DRIVEWAYS AT ALL TIMES

NOTE: FLAGGERS WILL SAFELY GUIDE PEDESTRIANS THROUGH WORK AREA

NOTE: CONTRACTOR WILL ALLOW FIRE STATION INGRESS AND EGRESS AT ALL TIMES

NOTE: WB-24 STEEL PLATES AHEAD SIGNS WILL REMAIN IN PLACE FOR DURATION OF WORK

DETAIL: FLAGGER ACCESS

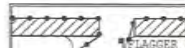
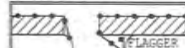

NOTE: DRIVEWAY ACCESS WILL BE PROVIDED AT ALL TIMES WORK WILL BE SPLIT TO PROVIDE ACCESS

AIRX SURVEYORS, INC.
Gail McMorrin
President
25th 5457 EL MONTE PARKWAY, SUITE C
ESCONDIDO, CA 92027
PHONE: (760) 440-2347
CELL: (760) 419-3738

PROJECT NAME: TL23071 - SYCAMORE CANYON SUBSTATION TO PENASQUITOS - 230 KV UNDERGROUND
AIRX JOB#: X160218
TYPE OF WORK: TRENCHING / CONDUIT
MISC./POTHOLE#: _____

DATE: Mar. 21, 2017
DESIGNED BY: Clint Jones

SHEET 108 OF 148

PHASE 92

THOMAS GRID#-

DRAWN FOR: CALTRANS



**ORIGINAL PERMIT MUST
BE KEPT
ON JOB SITE ALL TIMES**

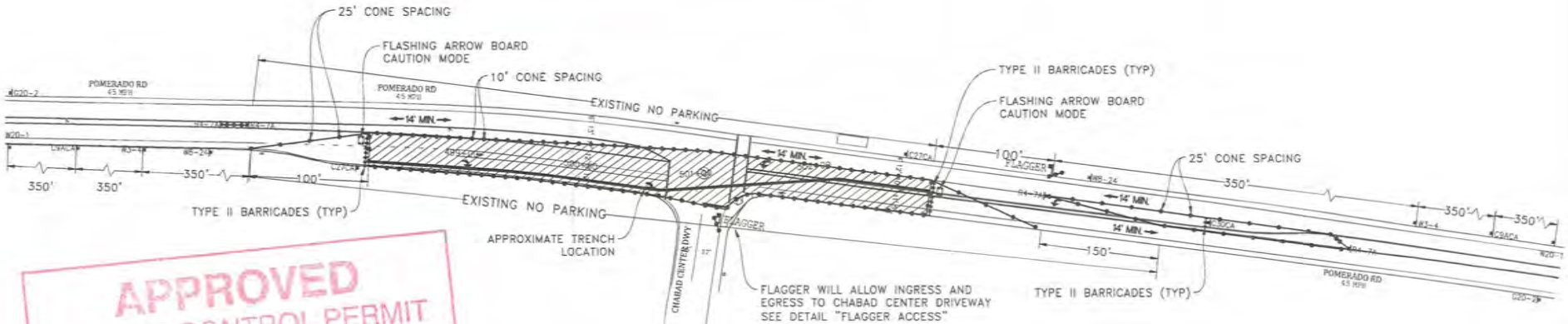

**APPROVED
TRAFFIC CONTROL PERMIT**

SEP 14 2017

**CITY OF SAN DIEGO
Development Services
Engineering Division
Traffic Safety Section**

FLAGGER WILL ALLOW INGRESS AND EGRESS TO CHABAD CENTER DRIVEWAY SEE DETAIL "FLAGGER ACCESS"

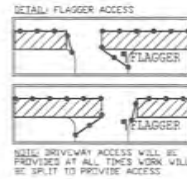

NOTE: CONTRACTOR WILL COORDINATE ALL WORK WITH FIRE STATION PRIOR TO START OF WORK

NOTE: CONTRACTOR WILL COORDINATE ALL WORK WITH TRANSIT DEPARTMENT 5 DAYS PRIOR TO START OF WORK

NOTE: CONTRACTOR WILL COORDINATE ALL WORK WITH EXISTING PROJECTS AND NOT CONFLICT WITH EXISTING TRAFFIC CONTROL

NOTE: CONTRACTOR WILL COORDINATE ALL WORK WITH RESIDENTS PRIOR TO START OF WORK

NOTE: CONTRACTOR WILL COORDINATE ALL WORK WITH BUSINESSES PRIOR TO START OF WORK

WORK HOURS: TT

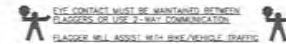

LEGEND

- SIGN
- TRAFFIC CONES / DELINEATOR
- BARRICADE
- FLAGGER
- FLASHING ARROW SIGN
- WORK ZONE
- BUS STOP

NOTE: FLAGGERS WILL PROVIDE ACCESS TO DRIVEWAYS AT ALL TIMES

NOTE: FLAGGERS WILL SAFELY GUIDE PEDESTRIANS THROUGH WORK AREA

NOTE: CONTRACTOR WILL ALLOW FIRE STATION INGRESS AND EGRESS AT ALL TIMES

NOTE: V8-24 STEEL PLATES AHEAD! SIGNS WILL REMAIN IN PLACE FOR DURATION OF WORK

AIRX SURVEYORS, INC.
Gail McMorrin
President
2034 EAST EL NORTE PARKWAY, SUITE C
ESCONDIDO, CA 92027
PHONE: (760) 480-2347
CELL: (760) 419-3738

PROJECT NAME: TL23071 - SYCAMORE CANYON SUBSTATION TO PENASQUITOS - 230 KV UNDERGROUND	
AIRX JOB#: X160218	THOMAS GRID#:-
TYPE OF WORK: RENCHING / CONDUIT	DRAWN FOR: CALTRANS
MISC./POTHOLES#:	

PHASE 93

DATE: Mar. 15, 2017
DESIGNED BY: Clint Jones
SHEET 109 OF 148



**ORIGINAL PERMIT MUST
BE KEPT
ON JOB SITE ALL TIMES**

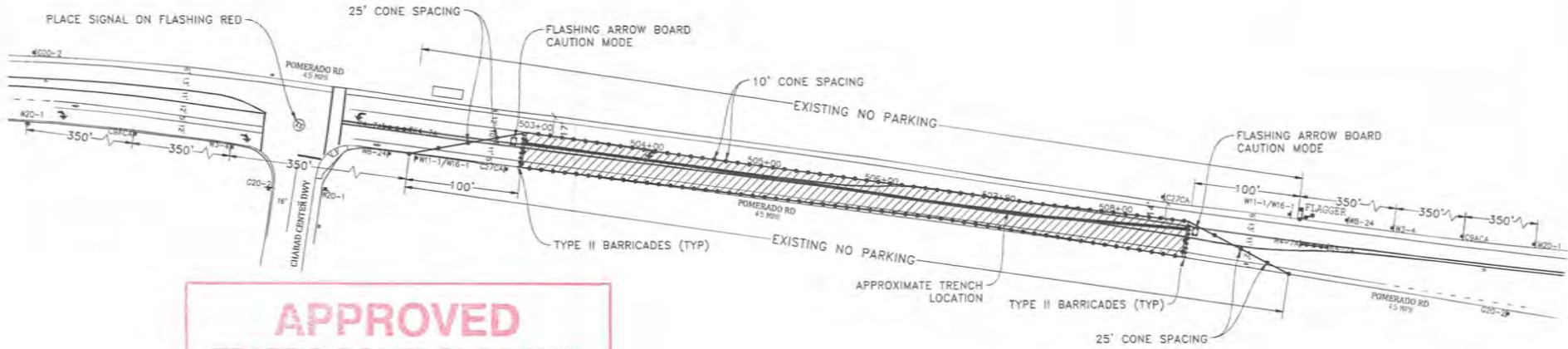

**APPROVED
TRAFFIC CONTROL PERMIT**

SEP 14 2017

CITY OF SAN DIEGO
Development Services
Engineering Division
Traffic Safety Section

- LEGEND**
- SIGN
 - TRAFFIC CONES / DELINEATOR
 - BARRICADE
 - FLAGGER
 - FLASHING ARROW SIGN
 - WORK ZONE
 - BUS STOP

NOTE: FLAGGERS WILL PROVIDE ACCESS TO DRIVEWAYS AT ALL TIMES

NOTE: FLAGGERS WILL SAFELY GUIDE PEDESTRIANS THROUGH WORK AREA

NOTE: CONTRACTOR WILL ALLOW FIRE STATION INGRESS AND EGRESS AT ALL TIMES

NOTE: WB-24 (STEEL PLATES) AHEAD SIGNS WILL REMAIN IN PLACE FOR DURATION OF WORK

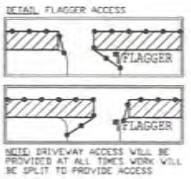

NOTE: CONTRACTOR WILL COORDINATE ALL WORK WITH FIRE STATION PRIOR TO START OF WORK

NOTE: CONTRACTOR WILL COORDINATE ALL WORK WITH TRANSIT DEPARTMENT 5 DAYS PRIOR TO START OF WORK

NOTE: CONTRACTOR WILL COORDINATE ALL WORK WITH EXISTING PROJECTS AND NOT CONFLICT WITH EXISTING TRAFFIC CONTROL

NOTE: CONTRACTOR WILL COORDINATE ALL WORK WITH RESIDENTS PRIOR TO START OF WORK

NOTE: CONTRACTOR WILL COORDINATE ALL WORK WITH BUSINESSES PRIOR TO START OF WORK

WORK HOURS: _____ TO _____

EYE CONTACT MUST BE MAINTAINED BETWEEN FLAGGERS OR USE 2-WAY COMMUNICATION

FLAGGER WILL ASSIST WITH SINGLE-VEHICLE TRAFFIC

UTILITY SURVEYORS, INC.

AIRX

Gail McMoran
President

304 EAST EL NORTE PARKWAY, SUITE C
ESCONDIDO, CA 92027
PHONE: (760) 480-2347
CELL: (760) 418-3728

PROJECT NAME: TL23071 - SYCAMORE CANYON SUBSTATION TO PENASQUITOS - 230 KV UNDERGROUND	
AIRX JOB# X160218	THOMAS GRID#-
TYPE OF WORK: RENCHING / CONDUIT	DRAWN FOR: CALTRANS
MISC./POTHOLES#:	

PHASE 94

DATE: Mar. 15, 2017
DESIGNED BY: Clint Jones

SHEET 110 OF 148



**ORIGINAL PERMIT MUST
BE KEPT
ON JOB SITE ALL TIMES**

NOTE: VAULT INSTALL AND TRENCHING WILL BE CONSTRUCTED IN SEPARATE PHASES

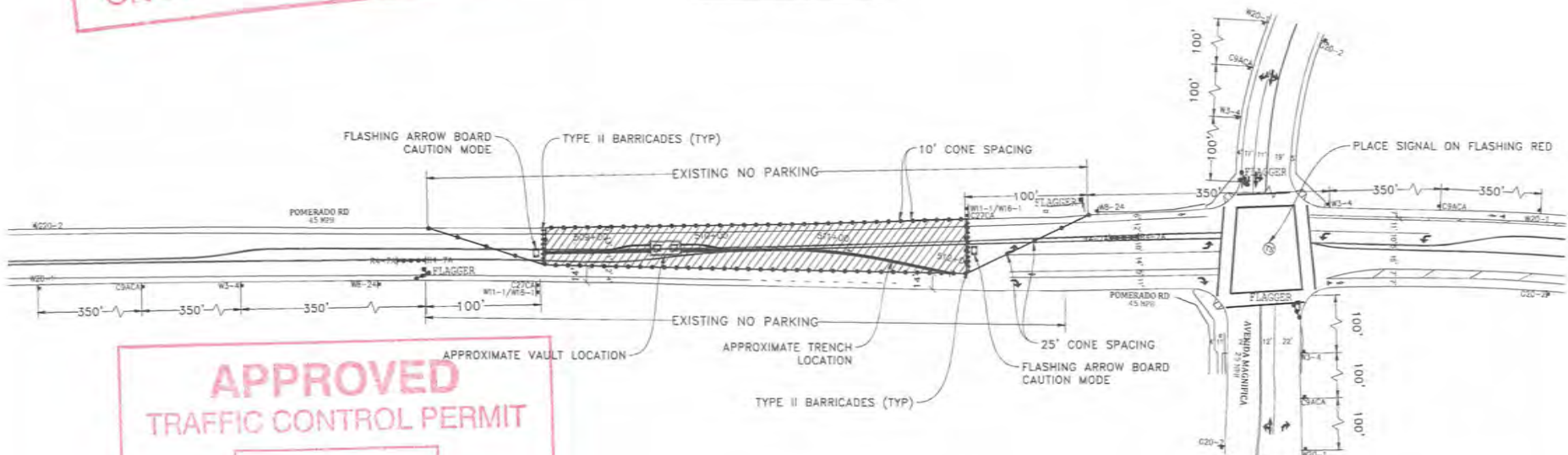

**APPROVED
TRAFFIC CONTROL PERMIT**

SEP 14 2017

CITY OF SAN DIEGO
Development Services
Engineering Division
Traffic Safety Section

LEGEND

- SIGN
- TRAFFIC CONES / DELINEATOR
- BARRICADE
- FLAGGER
- FLASHING ARROW SIGN
- WORK ZONE
- BUS STOP

NOTE: FLAGGERS WILL PROVIDE ACCESS TO DRIVEWAYS AT ALL TIMES.

NOTE: FLAGGERS WILL SAFELY GUIDE PEDESTRIANS THROUGH WORK AREA.

NOTE: CONTRACTOR WILL ALLOW FIRE STATION INGRESS AND EGRESS AT ALL TIMES.

NOTE: V8-24 STEEL PLATES AHEAD! SIGNS WILL REMAIN IN PLACE FOR DURATION OF WORK.

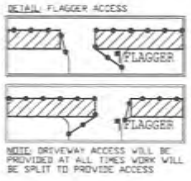

NOTE: CONTRACTOR WILL COORDINATE ALL WORK WITH FIRE STATION PRIOR TO START OF WORK.

NOTE: CONTRACTOR WILL COORDINATE ALL WORK WITH TRANSIT DEPARTMENT 5 DAYS PRIOR TO START OF WORK.

NOTE: CONTRACTOR WILL COORDINATE ALL WORK WITH EXISTING PROJECTS AND NOT CONFLICT WITH EXISTING TRAFFIC CONTROL.

NOTE: CONTRACTOR WILL COORDINATE ALL WORK WITH RESIDENTS PRIOR TO START OF WORK.

NOTE: CONTRACTOR WILL COORDINATE ALL WORK WITH BUSINESSES PRIOR TO START OF WORK.

WORK HOURS _____ TO _____

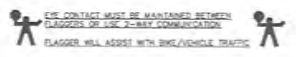

AIRX SURVEYORS, INC.
25th EAST EL MONTE PARKWAY, SUITE C
ESCONDIDO, CA 92027
PHONE: (760) 495-2347
CELL: (760) 419-3728

Gail McMorran
President

PROJECT NAME: TL23071 - SYCAMORE CANYON SUBSTATION TO PENASQUITOS - 230 KV UNDERGROUND	
AIRX JOB#: X160218	THOMAS GRID#:-
TYPE OF WORK: TRENCHING / CONDUIT	DRAWN FOR: CALTRANS
MISC./POTHOLES#:	

PHASE 95

DATE: Mar. 21, 2017
DESIGNED BY: Clint Jones
SHEET 111 OF 148

ORIGINAL PERMIT MUST BE KEPT ON JOB SITE ALL TIMES

SCALE 1"=40'

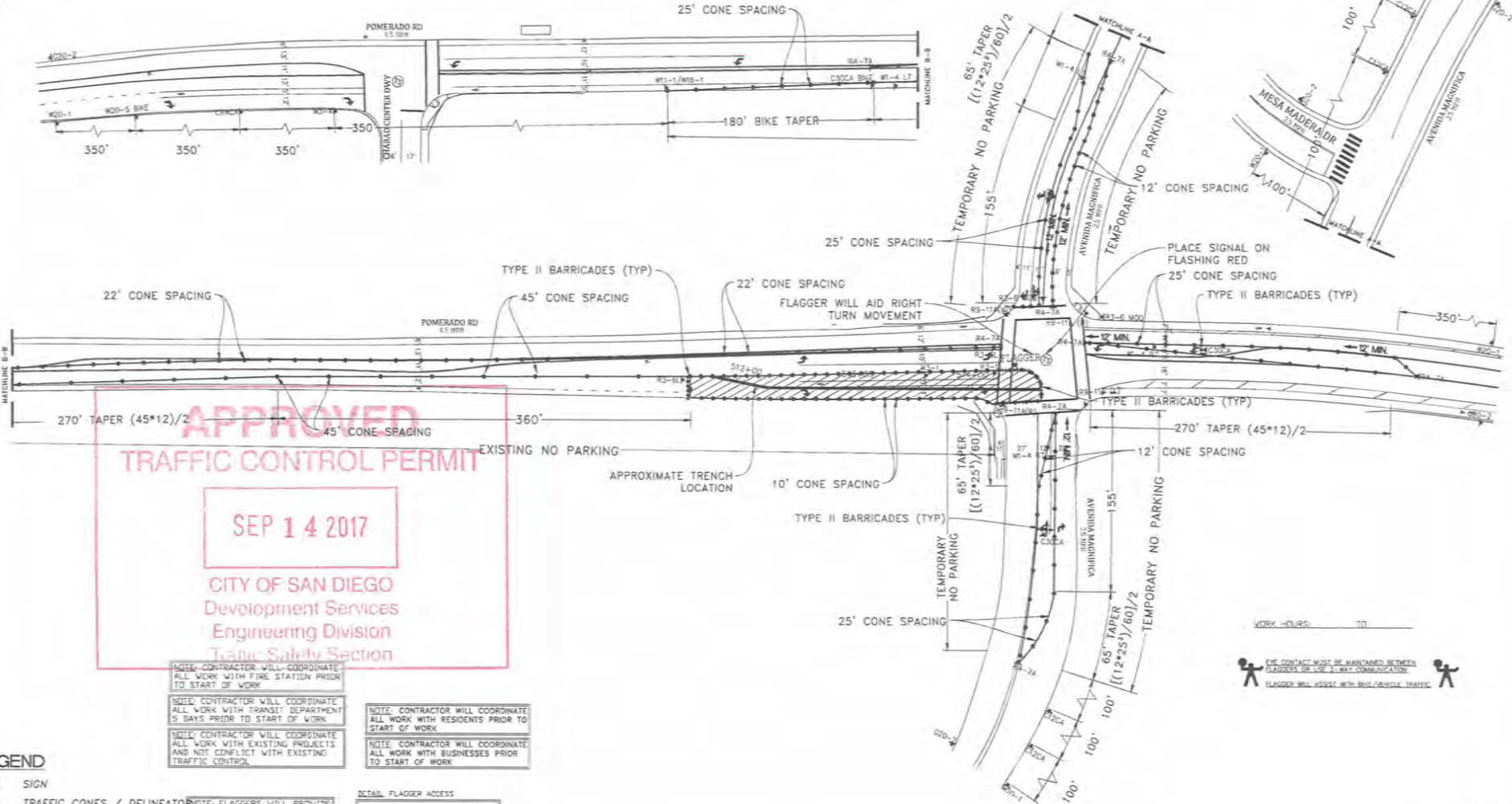

APPROVED
TRAFFIC CONTROL PERMIT
 SEP 14 2017
 CITY OF SAN DIEGO
 Development Services
 Engineering Division
 Traffic Safety Section

- NOTE: CONTRACTOR WILL COORDINATE ALL WORK WITH FIRE STATION PRIOR TO START OF WORK
- NOTE: CONTRACTOR WILL COORDINATE ALL WORK WITH TRANSIT DEPARTMENT 5 DAYS PRIOR TO START OF WORK
- NOTE: CONTRACTOR WILL COORDINATE ALL WORK WITH EXISTING PROJECTS AND NOT CONFLICT WITH EXISTING TRAFFIC CONTROL
- NOTE: CONTRACTOR WILL COORDINATE ALL WORK WITH RESIDENTS PRIOR TO START OF WORK
- NOTE: CONTRACTOR WILL COORDINATE ALL WORK WITH BUSINESSES PRIOR TO START OF WORK

- LEGEND**
- SIGN
 - TRAFFIC CONES / DELINEATOR
 - BARRICADE
 - FLAGGER
 - FLASHING ARROW SIGN
 - WORK ZONE
 - BUS STOP

- DETAIL FLAGGER ACCESS**
- NOTE: FLAGGERS WILL PROVIDE ACCESS TO DRIVEWAYS AT ALL TIMES
 - NOTE: FLAGGERS WILL SAFELY GUIDE PEDESTRIANS THROUGH WORK AREA
 - NOTE: CONTRACTOR WILL ALLOW FIRE STATION INGRESS AND EGRESS AT ALL TIMES
 - NOTE: W8-24 STEEL PLATES (WEAR STRIPS) WILL REMAIN IN PLACE FOR DURATION OF WORK
 - NOTE: DRIVEWAY ACCESS WILL BE PROVIDED AT ALL TIMES WORK WILL BE STOPPED TO PROVIDE ACCESS



AIRX SURVEYORS, INC.
 Gail McMoran
 President
 2024 EAST EL MONTE PARKWAY, SUITE C
 ESCONDIDO, CA 92027
 PHONE: (760) 490-2547
 CELL: (760) 418-3728

PROJECT NAME: TL23071 - SYCAMORE CANYON SUBSTATION TO PENASQUITOS - 230 KV UNDERGROUND	
AIRX JOB#: X160218	THOMAS GRID#:-
TYPE OF WORK: TRENCHING / CONDUIT	DRAWN FOR: CALTRANS
MISC./POTHOLES#:	

PHASE 96

DATE: Mar. 15, 2017
 DESIGNED BY: Clint Jones
 SHEET 112 OF 148

**ORIGINAL PERMIT MUST
BE KEPT
ON JOB SITE ALL TIMES**

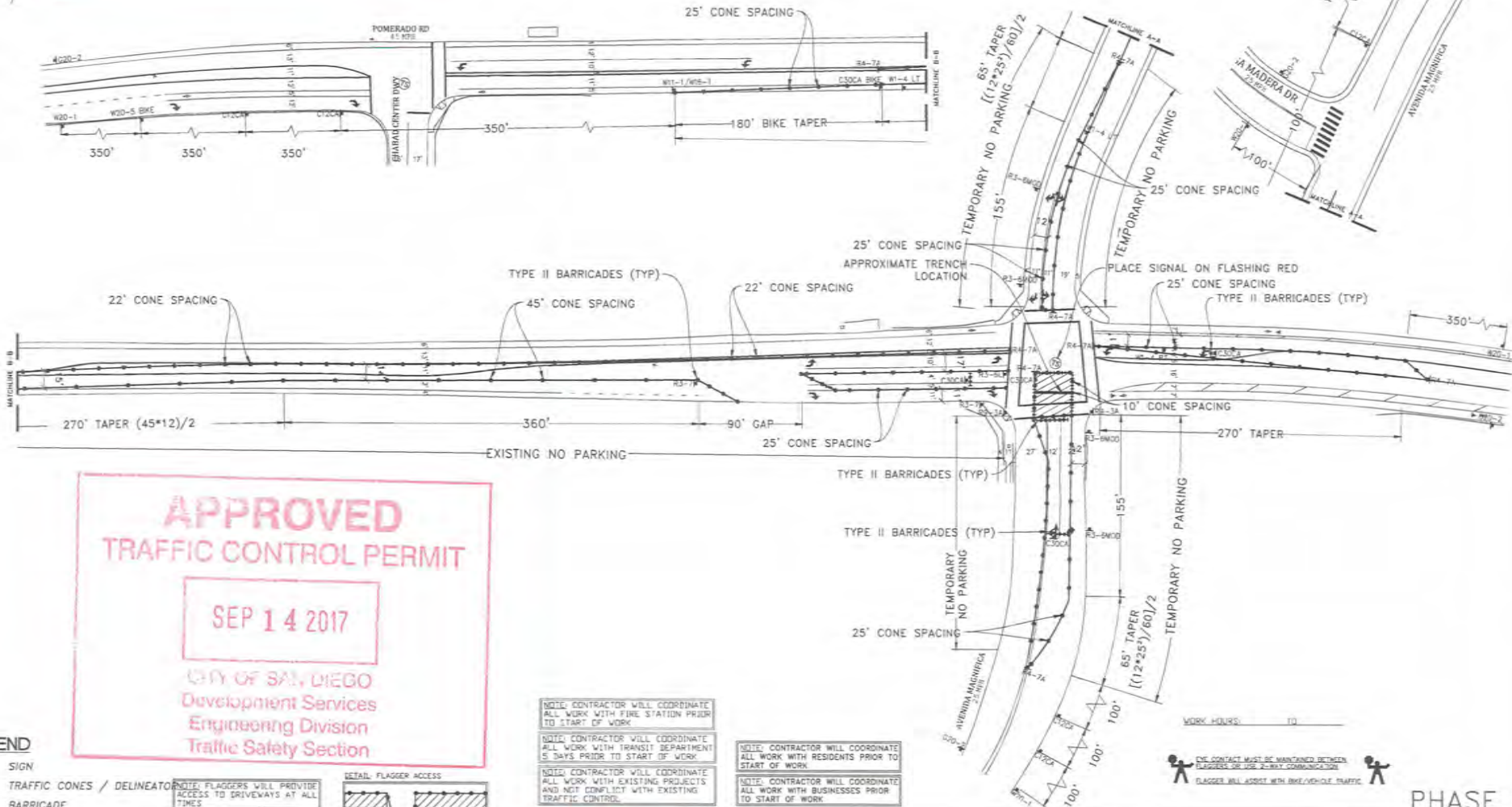

**APPROVED
TRAFFIC CONTROL PERMIT**

SEP 14 2017

**CITY OF SAN DIEGO
Development Services
Engineering Division
Traffic Safety Section**

LEGEND

- SIGN
- TRAFFIC CONES / DELINEATOR
- ⊥ BARRICADE
- ⚑ FLAGGER
- ⚡ FLASHING ARROW SIGN
- ▨ WORK ZONE
- 🚌 BUS STOP

NOTE: FLAGGERS WILL PROVIDE ACCESS TO DRIVEWAYS AT ALL TIMES

NOTE: FLAGGERS WILL SAFELY GUIDE PEDESTRIANS THROUGH WORK AREA

NOTE: CONTRACTOR WILL ALLOW FIRE STATION INGRESS AND EGRESS AT ALL TIMES

NOTE: WB-24 (STEEL PLATES AHEAD) SIGNS WILL REMAIN IN PLACE FOR DURATION OF WORK

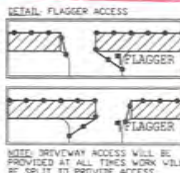

NOTE: CONTRACTOR WILL COORDINATE ALL WORK WITH FIRE STATION PRIOR TO START OF WORK

NOTE: CONTRACTOR WILL COORDINATE ALL WORK WITH TRANSIT DEPARTMENT 5 DAYS PRIOR TO START OF WORK

NOTE: CONTRACTOR WILL COORDINATE ALL WORK WITH EXISTING PROJECTS AND NOT CONFLICT WITH EXISTING TRAFFIC CONTROL

NOTE: CONTRACTOR WILL COORDINATE ALL WORK WITH RESIDENTS PRIOR TO START OF WORK

NOTE: CONTRACTOR WILL COORDINATE ALL WORK WITH BUSINESSES PRIOR TO START OF WORK

WORK HOURS: 10

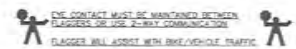

AIRX SURVEYORS, INC.
Gail McMorran
President
2504 EAST EL MONTE PARKWAY, SUITE C
ESCONDIDO, CA 92027
PHONE: (760) 480-2347
CELL: (760) 419-3728

PROJECT NAME: TL23071 - SYCAMORE CANYON SUBSTATION TO PENASQUITOS - 230 KV UNDERGROUND		DATE: Mar. 15, 2017
AIRX JOB#: X160218	THOMAS GRID#:	DESIGNED BY: Clint Jones
TYPE OF WORK: TRENCHING / CONDUIT	DRAWN FOR: CALTRANS	SHEET 113 OF 148
MISC./POTHOLE#:		

PHASE 97



ORIGINAL PERMIT MUST BE KEPT ON JOB SITE ALL TIMES

APPROVED TRAFFIC CONTROL PERMIT
SEP 14 2017
CITY OF SAN DIEGO
Development Services
Engineering Division
Traffic Safety Section

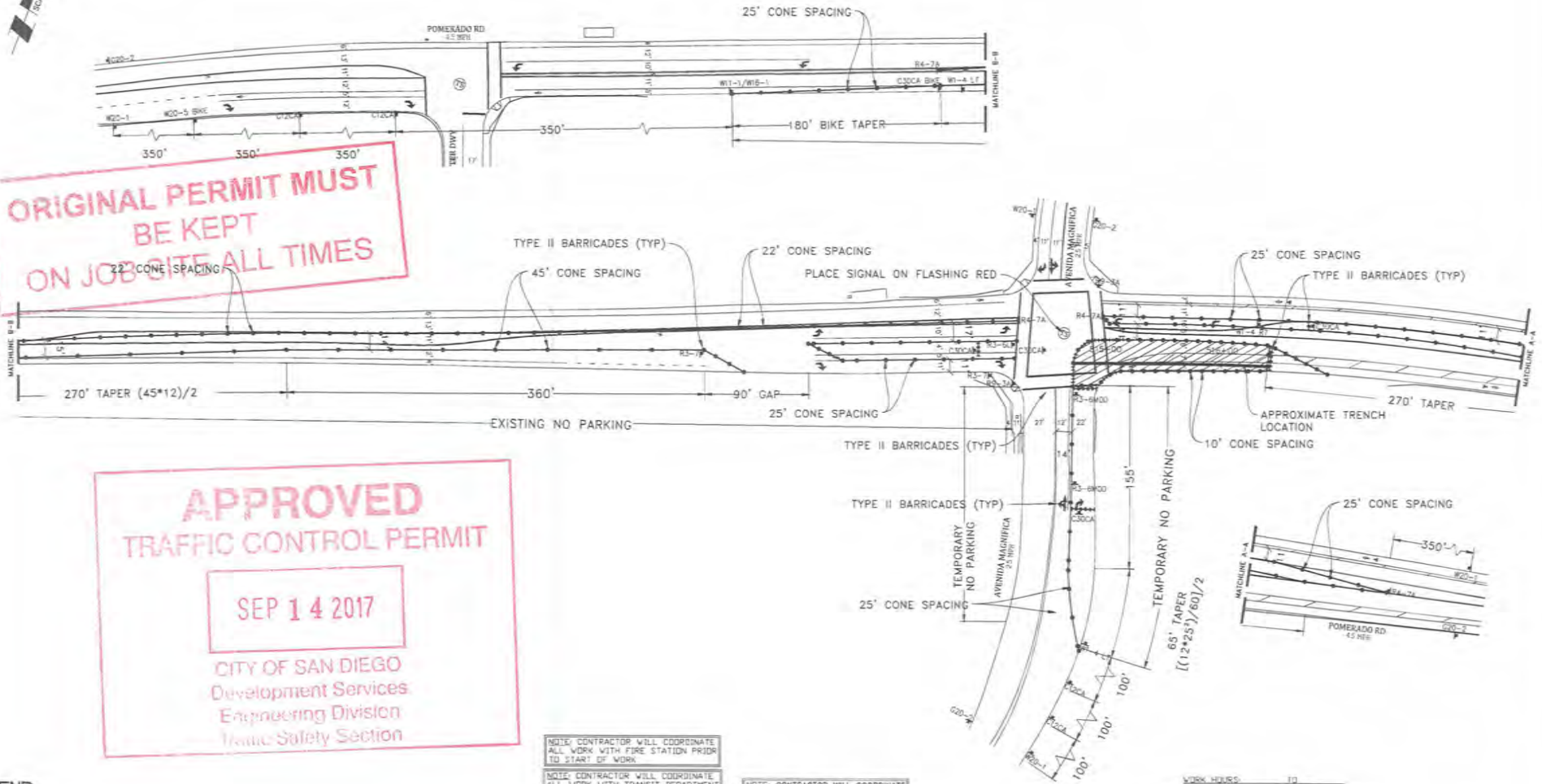

NOTE: CONTRACTOR WILL COORDINATE ALL WORK WITH FIRE STATION PRIOR TO START OF WORK

NOTE: CONTRACTOR WILL COORDINATE ALL WORK WITH TRANSIT DEPARTMENT 5 DAYS PRIOR TO START OF WORK

NOTE: CONTRACTOR WILL COORDINATE ALL WORK WITH EXISTING PROJECTS AND NOT CONFLICT WITH EXISTING TRAFFIC CONTROL.

NOTE: CONTRACTOR WILL COORDINATE ALL WORK WITH RESIDENTS PRIOR TO START OF WORK

NOTE: CONTRACTOR WILL COORDINATE ALL WORK WITH BUSINESSES PRIOR TO START OF WORK

WORK HOURS: TD

ENCLOSURE MUST BE MAINTAINED BETWEEN FLAGGERS OR USE 2-WAY COMMUNICATION
FLAGGER WILL ASSIST WITH BIKE/VEHICLE TRAFFIC

LEGEND

- SIGN
- TRAFFIC CONES / DELINEATOR
- BARRICADE
- FLAGGER
- FLASHING ARROW SIGN
- WORK ZONE
- BUS STOP

NOTE: FLAGGERS WILL PROVIDE ACCESS TO DRIVEWAYS AT ALL TIMES

NOTE: FLAGGERS WILL SAFELY GUIDE PEDESTRIANS THROUGH WORK AREA

NOTE: CONTRACTOR WILL ALLOW FIRE STATION INGRESS AND EGRESS AT ALL TIMES

NOTE: W8-24 (STEEL PLATES AHEAD) SIGNS WILL REMAIN IN PLACE FOR DURATION OF WORK

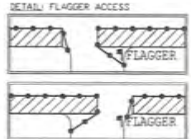

NOTE: DRIVEWAY ACCESS WILL BE PROVIDED AT ALL TIMES WORK WILL BE SPLIT TO PROVIDE ACCESS

UTILITY SURVEYORS, INC.
AIRX
Gail McMoran
President
2204 EAST EL NORTE PARKWAY, SUITE C
ESCONDIDO, CA 92027
PHONE: (760) 480-2347
CELL: (760) 419-3728

PROJECT NAME: TL23071 - SYCAMORE CANYON SUBSTATION TO PENASQUITOS - 230 KV UNDERGROUND		DATE: Apr. 6, 2017	
AIRX JOB#: X160218	THOMAS GRID#:	DESIGNED BY: Clint Jones	
TYPE OF WORK: RENCHING / CONDUIT	DRAWN FOR: CALTRANS	SHEET 114 OF 148	
MISC./POTHOLE#:			

PHASE 98



ORIGINAL PERMIT MUST BE KEPT ON JOB SITE ALL TIMES

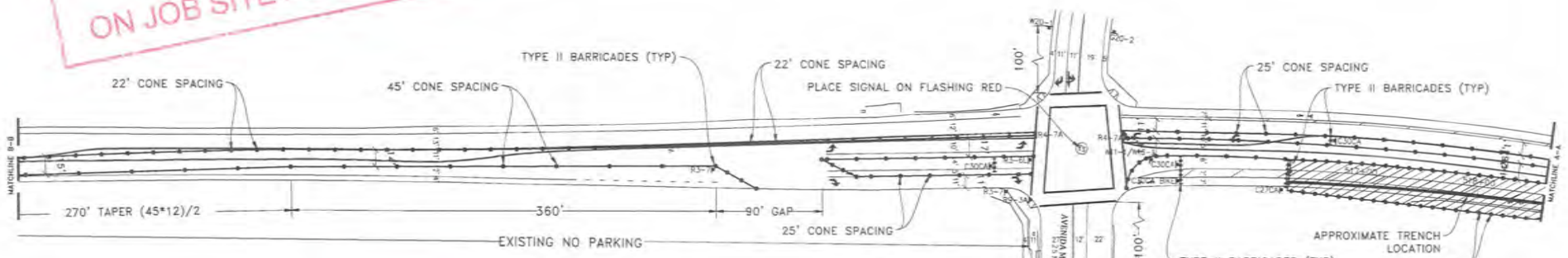
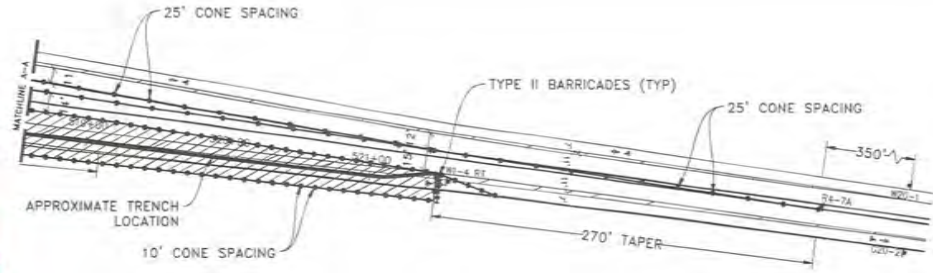

APPROVED TRAFFIC CONTROL PERMIT
SEP 14 2017
 CITY OF SAN DIEGO
 Development Services
 Engineering Division
 Traffic Safety Section



NOTE: CONTRACTOR WILL COORDINATE ALL WORK WITH FIRE STATION PRIOR TO START OF WORK

NOTE: CONTRACTOR WILL COORDINATE ALL WORK WITH TRANSIT DEPARTMENT 5 DAYS PRIOR TO START OF WORK

NOTE: CONTRACTOR WILL COORDINATE ALL WORK WITH EXISTING PROJECTS AND NOT CONFLICT WITH EXISTING TRAFFIC CONTROL

NOTE: CONTRACTOR WILL COORDINATE ALL WORK WITH RESIDENTS PRIOR TO START OF WORK

NOTE: CONTRACTOR WILL COORDINATE ALL WORK WITH BUSINESSES PRIOR TO START OF WORK

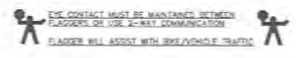

- LEGEND**
- SIGN
 - TRAFFIC CONES / DELINEATOR
 - ▬ BARRICADE
 - ⚡ FLAGGER
 - ➡ FLASHING ARROW SIGN
 - ▨ WORK ZONE
 - ⊞ BUS STOP

NOTE: FLAGGERS WILL PROVIDE ACCESS TO DRIVEWAYS AT ALL TIMES

NOTE: FLAGGERS WILL SAFELY GUIDE PEDESTRIANS THROUGH WORK AREA

NOTE: CONTRACTOR WILL ALLOW FIRE STATION INGRESS AND EGRESS AT ALL TIMES

NOTE: W8-24 STEEL PLATES AHEAD SIGNS WILL REMAIN IN PLACE FOR DURATION OF WORK

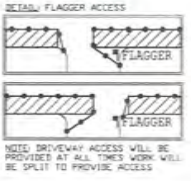

NOTE: DRIVEWAY ACCESS WILL BE PROVIDED AT ALL TIMES WORK WILL BE SPLIT TO PROVIDE ACCESS

AIRX SURVEYORS, INC.
 Gail McMoran
 President
 2304 EAST EL NORTE PARKWAY, SUITE C
 ESCOBEDO, CA 92027
 PHONE: (760) 460-2547
 CELL: (760) 418-1728

PROJECT NAME: TL23071 - SYCAMORE CANYON SUBSTATION TO PENASQUITOS - 230 KV UNDERGROUND	
AIRX JOB#: X160218	THOMAS GRID#:
TYPE OF WORK: RENCHING / CONDUIT	DRAWN FOR: CALTRANS
MISC/POTHOLE#:	

PHASE 99
 DATE: Mar. 15, 2017
 DESIGNED BY: Clint Jones
 SHEET 115 OF 148

ORIGINAL PERMIT MUST BE KEPT ON JOB SITE ALL TIMES

APPROVED TRAFFIC CONTROL PERMIT

SEP 14 2017

WORK HOURS: TO

THE CONTRACTOR MUST MAINTAIN CONTACT WITH FLAGGERS AT ALL TIMES. FLAGGERS WILL ASSIST WITH SAFE AND EFFICIENT TRAFFIC FLOW.

SAN DIEGO
Development Services
Engineering Division
Traffic Safety Section

NOTE: CONTRACTOR WILL COORDINATE ALL WORK WITH FIRE STATION PRIOR TO START OF WORK.

NOTE: CONTRACTOR WILL COORDINATE ALL WORK WITH TRANSIT DEPARTMENT 5 DAYS PRIOR TO START OF WORK.

NOTE: CONTRACTOR WILL COORDINATE ALL WORK WITH EXISTING PROJECTS AND NOT CONFLICT WITH EXISTING TRAFFIC CONTROL.

NOTE: CONTRACTOR WILL COORDINATE ALL WORK WITH RESIDENTS PRIOR TO START OF WORK.

NOTE: CONTRACTOR WILL COORDINATE ALL WORK WITH BUSINESSES PRIOR TO START OF WORK.

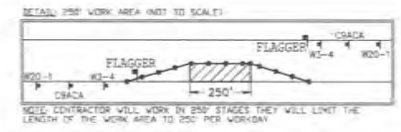
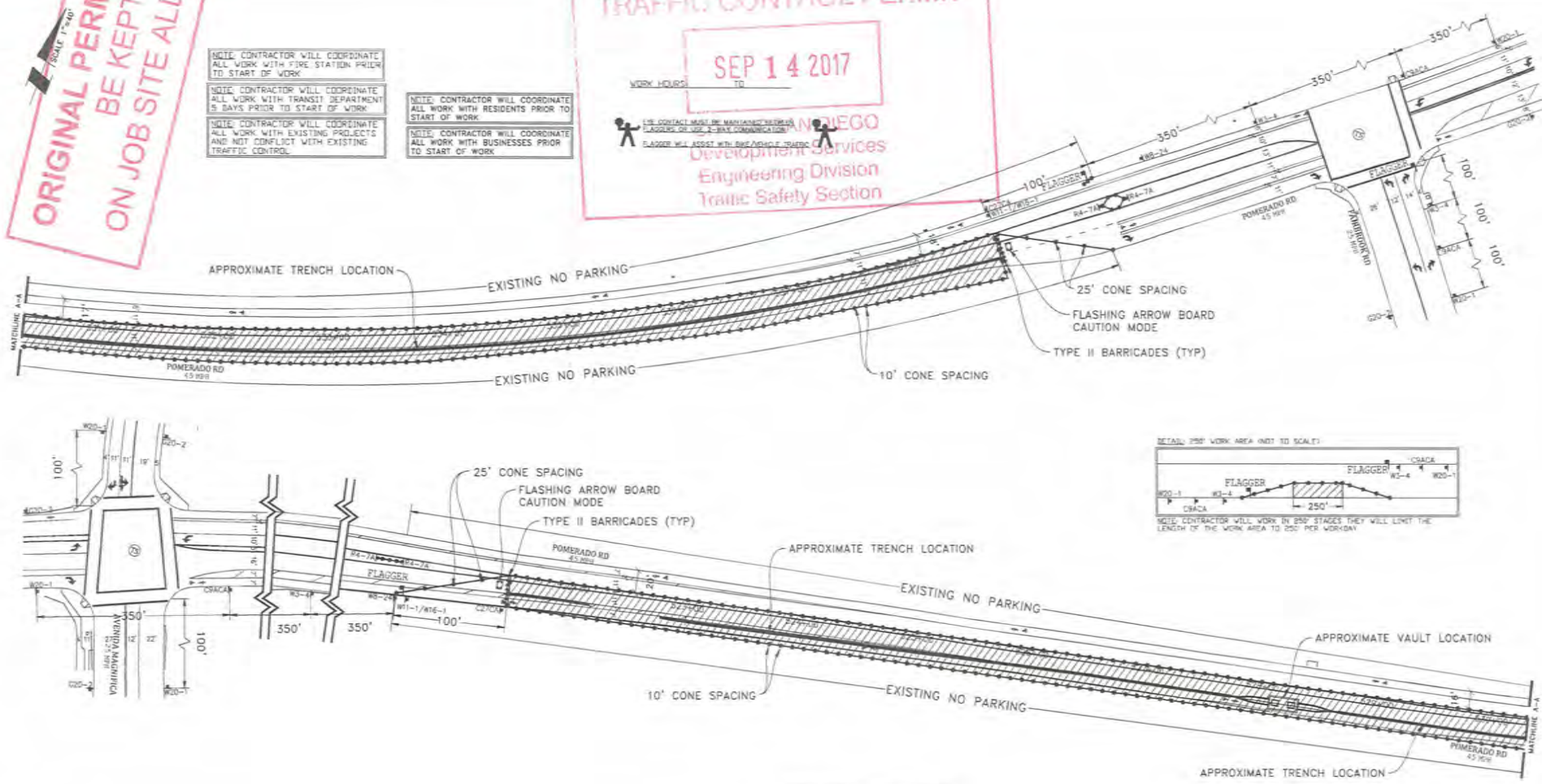

NOTE: VAULT INSTALL AND TRENCHING WILL BE CONSTRUCTED IN SEPARATE PHASES

LEGEND

- SIGN
 - TRAFFIC CONES / DELINEATOR
 - BARRICADE
 - FLAGGER
 - FLASHING ARROW SIGN
 - WORK ZONE
 - BUS STOP
- NOTE: FLAGGERS WILL PROVIDE ACCESS TO DRIVEWAYS AT ALL TIMES.
- NOTE: FLAGGERS WILL SAFELY GUIDE PEDESTRIANS THROUGH WORK AREA.
- NOTE: CONTRACTOR WILL ALLOW FIRE STATION INGRESS AND EGRESS AT ALL TIMES.
- NOTE: 18" x 24" STEEL PLATES (BREAD) SIGNS WILL REMAIN IN PLACE FOR DURATION OF WORK.

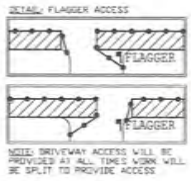

AIRX UTILITY SURVEYORS, INC.
Gail McMoran, President
2024 EAST EL NORTE PARKWAY, SUITE C
ESCONDIDO, CA 92027
PHONE: (760) 480-2547
CELL: (760) 418-3728

PROJECT NAME: TL23071 - SYCAMORE CANYON SUBSTATION TO PENASQUITOS - 230 KV UNDERGROUND	
AIRX JOB#: X160218	THOMAS GRID#:-
TYPE OF WORK: TRENCHING / CONDUIT	DRAWN FOR: CALTRANS
MISC./POTHOLES#:	

PHASE 100

DATE: Mar. 21, 2017
DESIGNED BY: Clint Jones
SHEET 116 OF 148