



Traffic Control Permit (TCP) Multiple Location List

(Franchise Utility Company Only - May Not Be submitted By Contractor)

APPROVED
TRAFFIC CONTROL PERMIT
JUN 08 2017
CITY OF SAN DIEGO
Development Services
Engineering Division
Traffic Safety Section

To: City of San Diego, Traffic Permit Section

Date: 6/7/2017

From: (Company): SDG&E

Phone No.: 619-778-2405

Contact Person: Rod Nelson

Fax.: _____

W.O. or Account #: Permit # _____

TCP No. _____

City Use Only

Authorized # _____

By SDG RUBY

Yes _____ No _____

Date Reviewed 08JUN17

TYPE OF WORK

- 1 = Lane Closure
- 2 = Street Closure
- 3 = Sidewalk Closure
- 4 = Alley Closure
- 5 = Parking Lane
- 6 = Detour
- 7 = Trenching
- 8 = Flagging

Location	From	To	Start Date *	End Date *	Work Hours **	Thomas Bros.	Type of Work
Pomerado Road	2200' West of Willow Creek Road/Ave of Nations	Chabad Center Driveway	6/12/17	6/16/17	8:30AM - 3:30PM	1209-G6, H5, J5	1,7,8
Willow Creek Road	Pomerado Road	Caminito Covewood	6/12/17	6/16/17	8:30AM - 3:30PM	1209-G6, G5	8
Avenue of Nations	Pomerado Road	End of Street	6/12/17	6/16/17	8:30AM - 3:30PM	1209-G6, G5	8
Scripps Ranch Blvd	Pomerado Road	Ironwood Road	6/12/17	6/16/17	8:30AM - 3:30PM	1209-H5	8
Scripps Ranch Row	Pomerado Road	Espinosa Square	6/12/17	6/16/17	8:30AM - 3:30PM	1209-H5	8

ORIGINAL PERMIT MUST BE KEPT ON JOB SITE ALL TIMES

Comments: Vault Crew - Phases 80-91 - Daytime work hours (M-F, 8:30AM - 3:30PM)

Must be submitted a minimum of 2 working days prior to start of work. All columns must be filled out for proper authorization

Fax or mail to: City of San Diego • Traffic Control Permit Section • 1222 First Avenue, MS 501 • San Diego, CA 92101. Fax (619) 446-5489 Office (619) 446-5150

* Work Days: Monday Through Friday ** Work Hours : 8:30 AM - 3:30PM. Unless other hours are preapproved)

No Work on Saturdays, Sundays, or Holidays Unless Approved and Noted In Comments

Minimum of 5 working days required for construction work which affects traffic signal e-mail info to: jvaca@sandiego.gov



**ORIGINAL PERMIT MUST
BE KEPT
ON JOB SITE ALL TIMES**

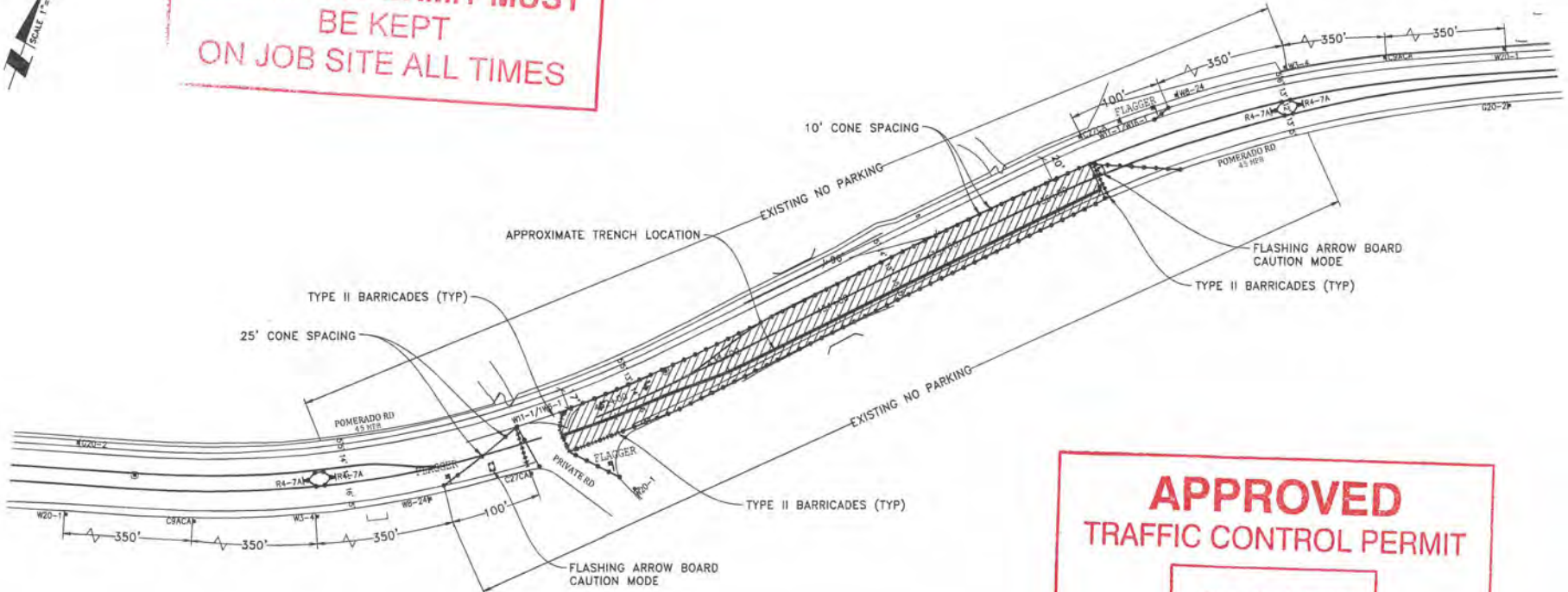

**APPROVED
TRAFFIC CONTROL PERMIT**

JUN 08 2017

CITY OF SAN DIEGO
Development Services
Engineering Division
Traffic Safety Section

NOTE: CONTRACTOR WILL COORDINATE ALL WORK WITH FIRE STATION PRIOR TO START OF WORK

NOTE: CONTRACTOR WILL COORDINATE ALL WORK WITH TRANSIT DEPARTMENT 5 DAYS PRIOR TO START OF WORK

NOTE: CONTRACTOR WILL COORDINATE ALL WORK WITH EXISTING PROJECTS AND NOT CONFLICT WITH EXISTING TRAFFIC CONTROL

NOTE: CONTRACTOR WILL COORDINATE ALL WORK WITH RESIDENTS PRIOR TO START OF WORK

NOTE: CONTRACTOR WILL COORDINATE ALL WORK WITH BUSINESSES PRIOR TO START OF WORK

WORK HOURS: _____ TO _____



LEGEND

- SIGN
- TRAFFIC CONES / DELINEATOR
- BARRICADE
- FLAGGER
- FLASHING ARROW SIGN
- WORK ZONE
- BUS STOP

NOTE: FLAGGERS WILL PROVIDE ACCESS TO DRIVEWAYS AT ALL TIMES

NOTE: FLAGGERS WILL SAFELY GUIDE PEDESTRIANS THROUGH WORK AREA

NOTE: CONTRACTOR WILL ALLOW FIRE STATION INGRESS AND EGRESS AT ALL TIMES

NOTE: W8-24 STEEL PLATES AHEAD SIGNS WILL REMAIN IN PLACE FOR DURATION OF WORK

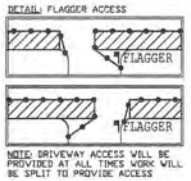

UTILITY SURVEYORS, INC.
AIRX
Gail McMorran
President
204 EAST EL NORTE PARKWAY, SUITE C
ESCONDIDO, CA 92027
PHONE: (760) 480-2347
CELL: (760) 418-3738

PROJECT NAME: TL23071 - SYCAMORE CANYON SUBSTATION TO PENASQUITOS - 230 KV UNDERGROUND	
AIRX JOB# X160218	THOMAS GRID#-
TYPE OF WORK: TRENCHING / CONDUIT	DRAWN FOR: CALTRANS
MISC/POTHOLE#:	

DATE: Apr. 5, 2017
DESIGNED BY: Clint Jones
SHEET 096 OF 148

PHASE 80

APPROVED TRAFFIC CONTROL PERMIT

JUN 08 2017

CITY OF SAN DIEGO
Development Services
Engineering Division
Traffic Safety Section

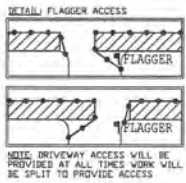

FLASHING ARROW BOARD
CAUTION MODE

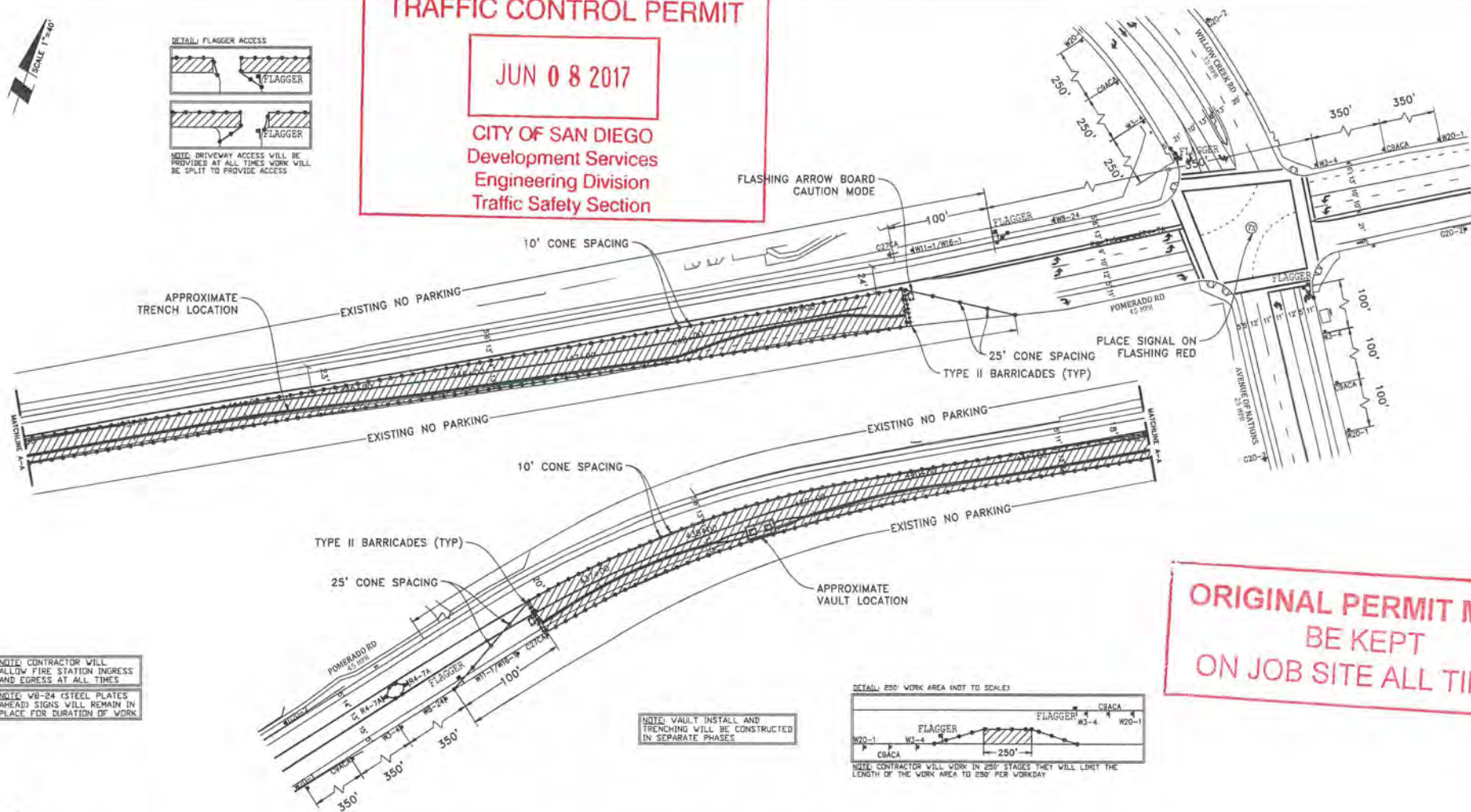



ORIGINAL PERMIT MUST
BE KEPT
ON JOB SITE ALL TIMES

NOTE: CONTRACTOR WILL ALLOW FIRE STATION INGRESS AND EGRESS AT ALL TIMES

NOTE: W8-24 STEEL PLATES AHEAD SIGNS WILL REMAIN IN PLACE FOR DURATION OF WORK

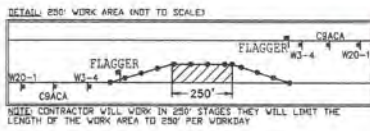
NOTE: VAULT INSTALL AND TRENCHING WILL BE CONSTRUCTED IN SEPARATE PHASES



- LEGEND**
-  SIGN
 -  TRAFFIC CONES / DELINEATOR
 -  BARRICADE
 -  FLAGGER
 -  FLASHING ARROW SIGN
 -  WORK ZONE
 -  BUS STOP

NOTE: CONTRACTOR WILL COORDINATE ALL WORK WITH FIRE STATION PRIOR TO START OF WORK

NOTE: CONTRACTOR WILL COORDINATE ALL WORK WITH TRANSIT DEPARTMENT 5 DAYS PRIOR TO START OF WORK

NOTE: CONTRACTOR WILL COORDINATE ALL WORK WITH EXISTING PROJECTS AND NOT CONFLICT WITH EXISTING TRAFFIC CONTROL

NOTE: FLAGGERS WILL PROVIDE ACCESS TO DRIVEWAYS AT ALL TIMES

NOTE: FLAGGERS WILL SAFELY GUIDE PEDESTRIANS THROUGH WORK AREA

NOTE: CONTRACTOR WILL COORDINATE ALL WORK WITH RESIDENTS PRIOR TO START OF WORK

NOTE: CONTRACTOR WILL COORDINATE ALL WORK WITH BUSINESSES PRIOR TO START OF WORK

EYE CONTACT MUST BE MAINTAINED BETWEEN FLAGGERS OR USE 2-WAY COMMUNICATION
FLAGGER WILL ASSIST WITH BIKE/VEHICLE TRAFFIC

WORK HOURS: _____ TO _____

AIRX SURVEYORS, INC.
Gail McMorran
President
2524 EAST EL NORTE PARKWAY, SUITE C
ESCONDIDO, CA 92027
PHONE: (760) 480-2347
CELL: (760) 418-3728

PROJECT NAME: TL23071 - SYCAMORE CANYON SUBSTATION TO PENASQUITOS - 230 KV UNDERGROUND	
AIRX JOB# X160218	THOMAS GRID#:
TYPE OF WORK: TRENCHING / CONDUIT	DRAWN FOR: CALTRANS
MISC/POTHoles#:	

PHASE 81

DATE: Mar. 24, 2017
DESIGNED BY: Clint Jones
SHEET 097 OF 148

**ORIGINAL PERMIT MUST
BE KEPT
ON JOB SITE ALL TIMES**

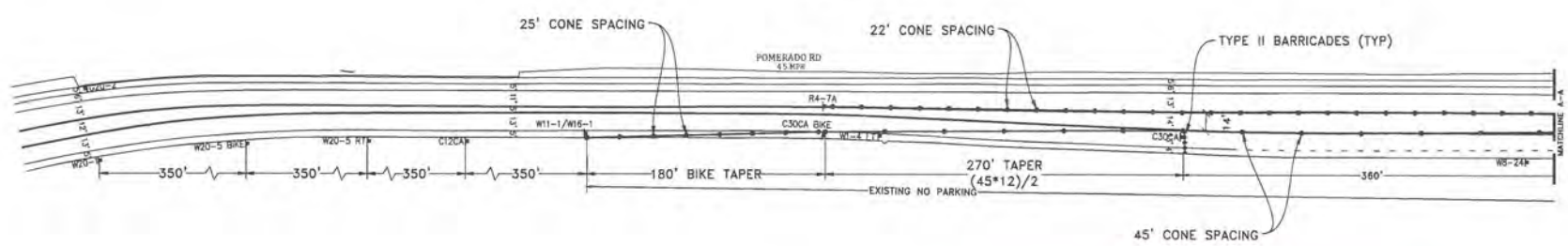
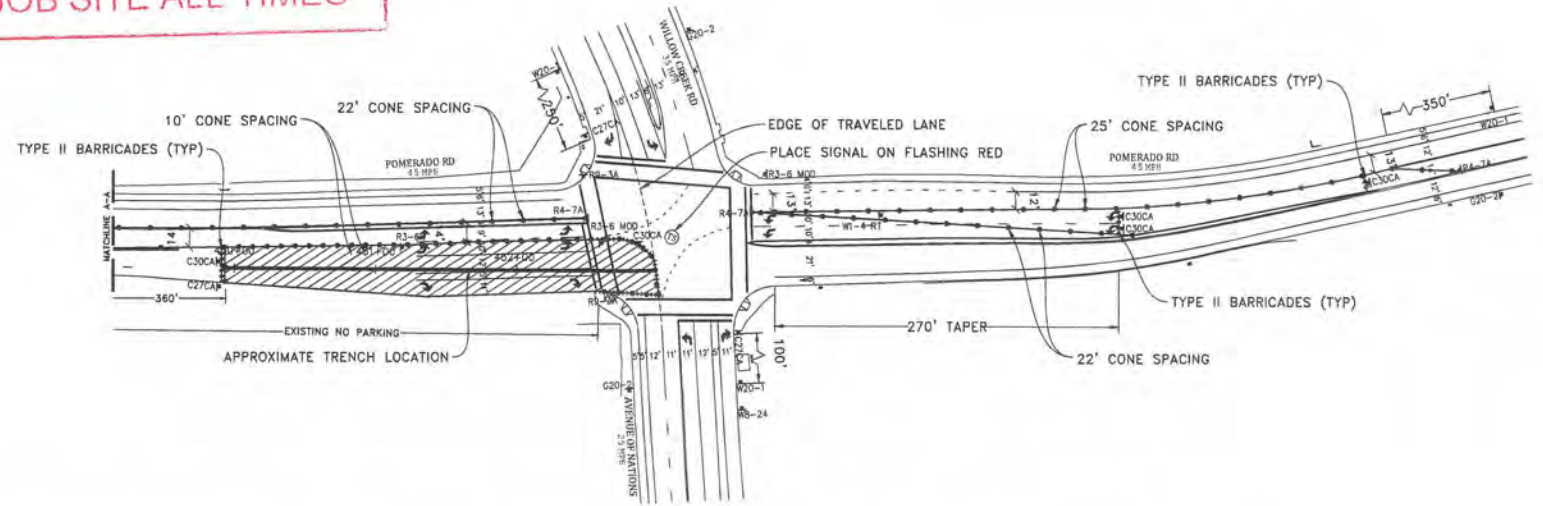

NOTE: CONTRACTOR WILL COORDINATE ALL WORK WITH FIRE STATION PRIOR TO START OF WORK

NOTE: CONTRACTOR WILL COORDINATE ALL WORK WITH TRANSIT DEPARTMENT 5 DAYS PRIOR TO START OF WORK

NOTE: CONTRACTOR WILL COORDINATE ALL WORK WITH EXISTING PROJECTS AND NOT CONFLICT WITH EXISTING TRAFFIC CONTROL.

NOTE: CONTRACTOR WILL COORDINATE ALL WORK WITH RESIDENTS PRIOR TO START OF WORK

NOTE: CONTRACTOR WILL COORDINATE ALL WORK WITH BUSINESSES PRIOR TO START OF WORK

WORK HOURS: _____ TO _____

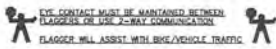

- LEGEND**
- SIGN
 - TRAFFIC CONES / DELINEATOR
 - ⊥ BARRICADE
 - ⚑ FLAGGER
 - ⚡ FLASHING ARROW SIGN
 - ▨ WORK ZONE
 - 🚌 BUS STOP

NOTE: FLAGGERS WILL PROVIDE ACCESS TO DRIVEWAYS AT ALL TIMES

NOTE: FLAGGERS WILL SAFELY GUIDE PEDESTRIANS THROUGH WORK AREA

NOTE: CONTRACTOR WILL ALLOW FIRE STATION INGRESS AND EGRESS AT ALL TIMES

NOTE: W8-24 (STEEL PLATES) AHEAD SIGNS WILL REMAIN IN PLACE FOR DURATION OF WORK

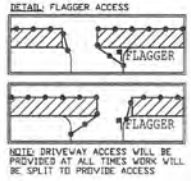

AIRX SURVEYORS, INC.
Gail McMoran
 President
 2504 EAST EL NORTE PARKWAY, SUITE C
 ESCONDIDO, CA 92027
 PHONE: (760) 460-2347
 CELL: (760) 419-3738

**APPROVED
TRAFFIC CONTROL PERMIT**

JUN 08 2017

CITY OF SAN DIEGO
 Development Services
 Engineering Division
 Traffic Safety Section

PROJECT NAME: TL23071 - SYCAMORE CANYON SUBSTATION TO UNDERGROUND
AIRX JOB # X160218
TYPE OF WORK: FENCING (CONCRETE) AND CLOSURE OF CALTRANS
MISC./POTHOLE #:

PHASE 82

DATE: Mar. 21, 2017
DESIGNED BY: Clint Jones
SHEET 098 OF 148

**ORIGINAL PERMIT MUST
BE KEPT
ON JOB SITE ALL TIMES**

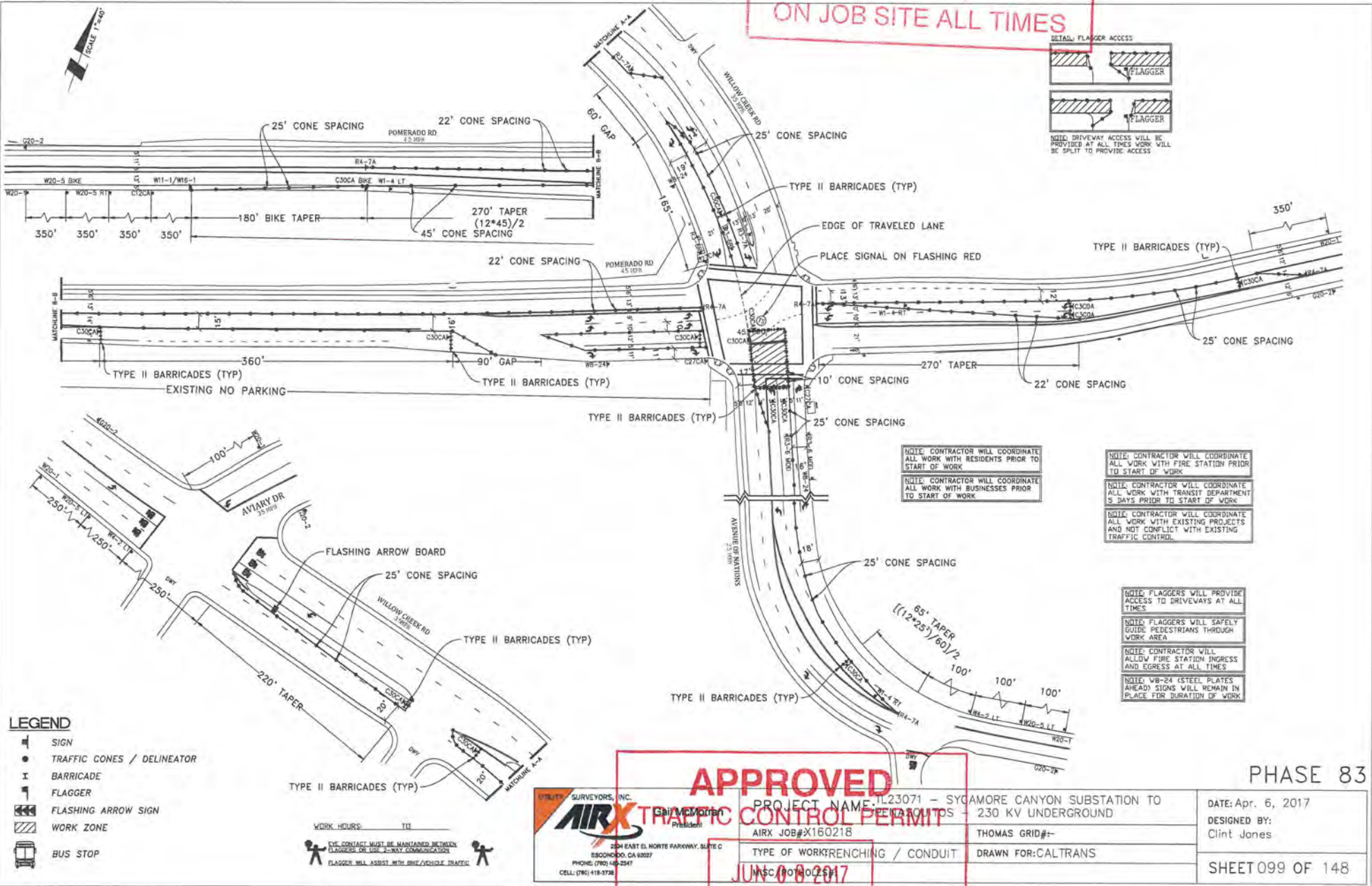

UTILITY SURVEYORS, INC.
AIRX
 2504 EAST EL NORTE PARKWAY, SUITE C
 ESCOBEDO, CA 92027
 PHONE: (760) 488-2547
 CELL: (760) 418-3738

PROJECT NAME: IL23071 - SYCAMORE CANYON SUBSTATION TO
 ESCOBEDO, CA - 230 KV UNDERGROUND
 AIRX JOB# X160218
 TYPE OF WORK: TRENCHING / CONDUIT
 THOMAS GRID#-
 DRAWN FOR: CALTRANS

DATE: Apr. 6, 2017
 DESIGNED BY: Clint Jones
 SHEET 099 OF 148

**ORIGINAL PERMIT MUST
BE KEPT
ON JOB SITE ALL TIMES**

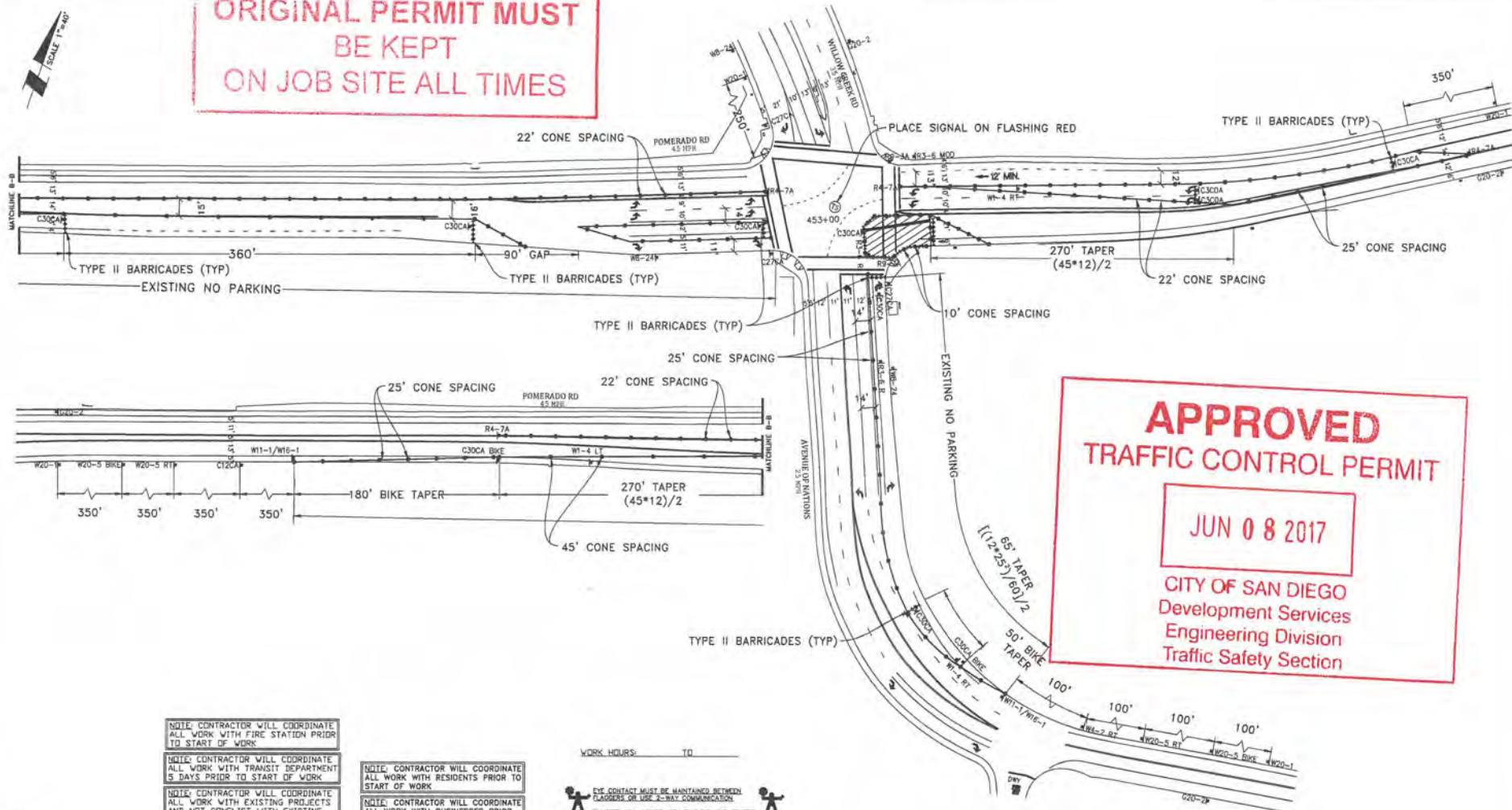

APPROVED
TRAFFIC CONTROL PERMIT

JUN 08 2017

CITY OF SAN DIEGO
Development Services
Engineering Division
Traffic Safety Section

NOTE: CONTRACTOR WILL COORDINATE ALL WORK WITH FIRE STATION PRIOR TO START OF WORK

NOTE: CONTRACTOR WILL COORDINATE ALL WORK WITH TRANSIT DEPARTMENT 5 DAYS PRIOR TO START OF WORK

NOTE: CONTRACTOR WILL COORDINATE ALL WORK WITH EXISTING PROJECTS AND NOT CONFLICT WITH EXISTING TRAFFIC CONTROL

NOTE: CONTRACTOR WILL COORDINATE ALL WORK WITH RESIDENTS PRIOR TO START OF WORK

NOTE: CONTRACTOR WILL COORDINATE ALL WORK WITH BUSINESSES PRIOR TO START OF WORK

WORK HOURS: _____ TO _____

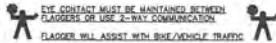

LEGEND

- SIGN
- TRAFFIC CONES / DELINEATOR
- BARRICADE
- FLAGGER
- FLASHING ARROW SIGN
- WORK ZONE
- BUS STOP

NOTE: FLAGGERS WILL PROVIDE ACCESS TO DRIVEWAYS AT ALL TIMES

NOTE: FLAGGERS WILL SAFELY GUIDE PEDESTRIANS THROUGH WORK AREA

NOTE: CONTRACTOR WILL ALLOW FIRE STATION INGRESS AND EGRESS AT ALL TIMES

NOTE: V8-24 (STEEL PLATES AHEAD) SIGNS WILL REMAIN IN PLACE FOR DURATION OF WORK

DETAIL: FLAGGER ACCESS

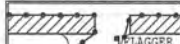
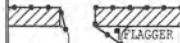

NOTE: DRIVEWAY ACCESS WILL BE PROVIDED AT ALL TIMES WORK WILL BE SPLIT TO PROVIDE ACCESS

AIRX SURVEYORS, INC.
Gail McMoran
President
2534 EAST EL NORTE PARKWAY, SUITE C
ESCONDIDO, CA 92027
PHONE: (760) 450-2547
CELL: (760) 419-3738

PROJECT NAME: TL23071 - SYCAMORE CANYON SUBSTATION TO PENASQUITOS - 230 KV UNDERGROUND	
AIRX JOB#: X160218	THOMAS GRID#:-
TYPE OF WORK: TRENCHING / CONDUIT	DRAWN FOR: CALTRANS
MISC./POTHOLE#:	

PHASE 84

DATE: Mar. 21, 2017
DESIGNED BY: Clint Jones
SHEET 100 OF 148

**ORIGINAL PERMIT MUST
BE KEPT
ON JOB SITE ALL TIMES**

**APPROVED
TRAFFIC CONTROL PERMIT**

JUN 08 2017

**CITY OF SAN DIEGO
Development Services
Engineering Division
Traffic Safety Section**

NOTE: VAULT INSTALL AND
TRENCHING WILL BE CONSTRUCTED
IN SEPARATE PHASES

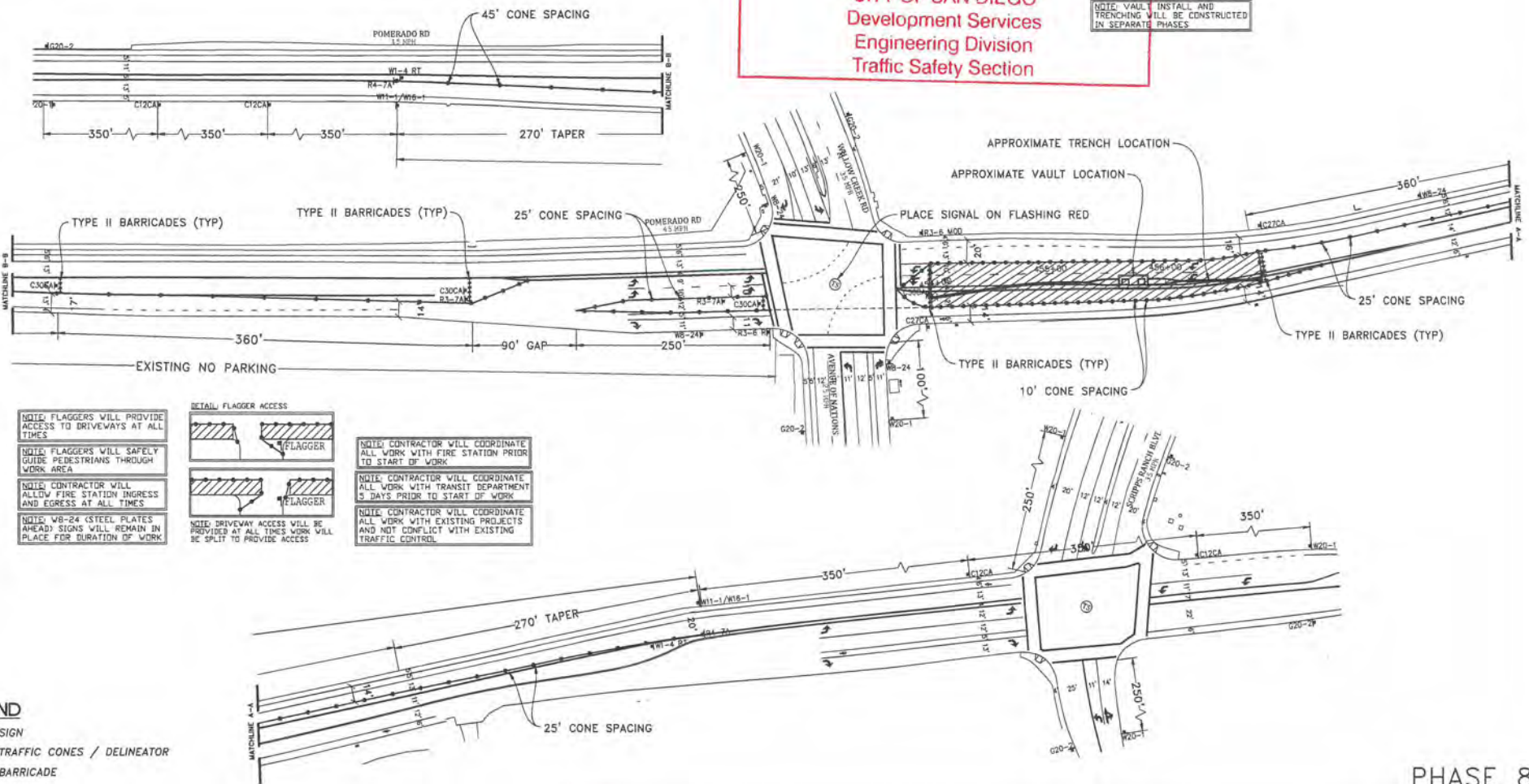

- NOTE: FLAGGERS WILL PROVIDE ACCESS TO DRIVEWAYS AT ALL TIMES
- NOTE: FLAGGERS WILL SAFELY GUIDE PEDESTRIANS THROUGH WORK AREA
- NOTE: CONTRACTOR WILL ALLOW FIRE STATION INGRESS AND EGRESS AT ALL TIMES
- NOTE: W8-24 (STEEL PLATES AHEAD) SIGNS WILL REMAIN IN PLACE FOR DURATION OF WORK

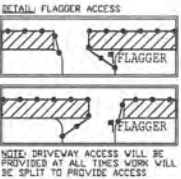

- NOTE: CONTRACTOR WILL COORDINATE ALL WORK WITH FIRE STATION PRIOR TO START OF WORK
- NOTE: CONTRACTOR WILL COORDINATE ALL WORK WITH TRANSIT DEPARTMENT 5 DAYS PRIOR TO START OF WORK
- NOTE: CONTRACTOR WILL COORDINATE ALL WORK WITH EXISTING PROJECTS AND NOT CONFLICT WITH EXISTING TRAFFIC CONTROL

- LEGEND**
- SIGN
 - TRAFFIC CONES / DELINEATOR
 - BARRICADE
 - FLAGGER
 - FLASHING ARROW SIGN
 - WORK ZONE
 - BUS STOP

NOTE: CONTRACTOR WILL COORDINATE ALL WORK WITH RESIDENTS PRIOR TO START OF WORK

NOTE: CONTRACTOR WILL COORDINATE ALL WORK WITH BUSINESSES PRIOR TO START OF WORK

WORK HOURS: _____ TO _____

NOTE: EYE CONTACT MUST BE MAINTAINED BETWEEN FLAGGERS OR USE 2-WAY COMMUNICATION

FLAGGER WILL ASSIST WITH BIKE/VEHICLE TRAFFIC

AIRX SURVEYORS, INC.
Gail McMoran
President
2534 EAST EL NORTE PARKWAY, SUITE C
ESCONDIDO, CA 92027
PHONE: (760) 450-2347
CELL: (760) 419-3738

PROJECT NAME: TL23071 - SYCAMORE CANYON SUBSTATION TO PENASQUITOS - 230 KV UNDERGROUND	
AIRX JOB# X160218	THOMAS GRID# 1-
TYPE OF WORK: TRENCHING / CONDUIT	DRAWN FOR: CALTRANS
MISC./POTHOLE#:	

PHASE 85

DATE: Mar. 21, 2017
DESIGNED BY: Clint Jones

SHEET 101 OF 148

APPROVED TRAFFIC CONTROL PERMIT

JUN 08 2017

CITY OF SAN DIEGO
Development Services
Engineering Division
Traffic Safety Section

ORIGINAL PERMIT MUST
BE KEPT
ON JOB SITE ALL TIMES

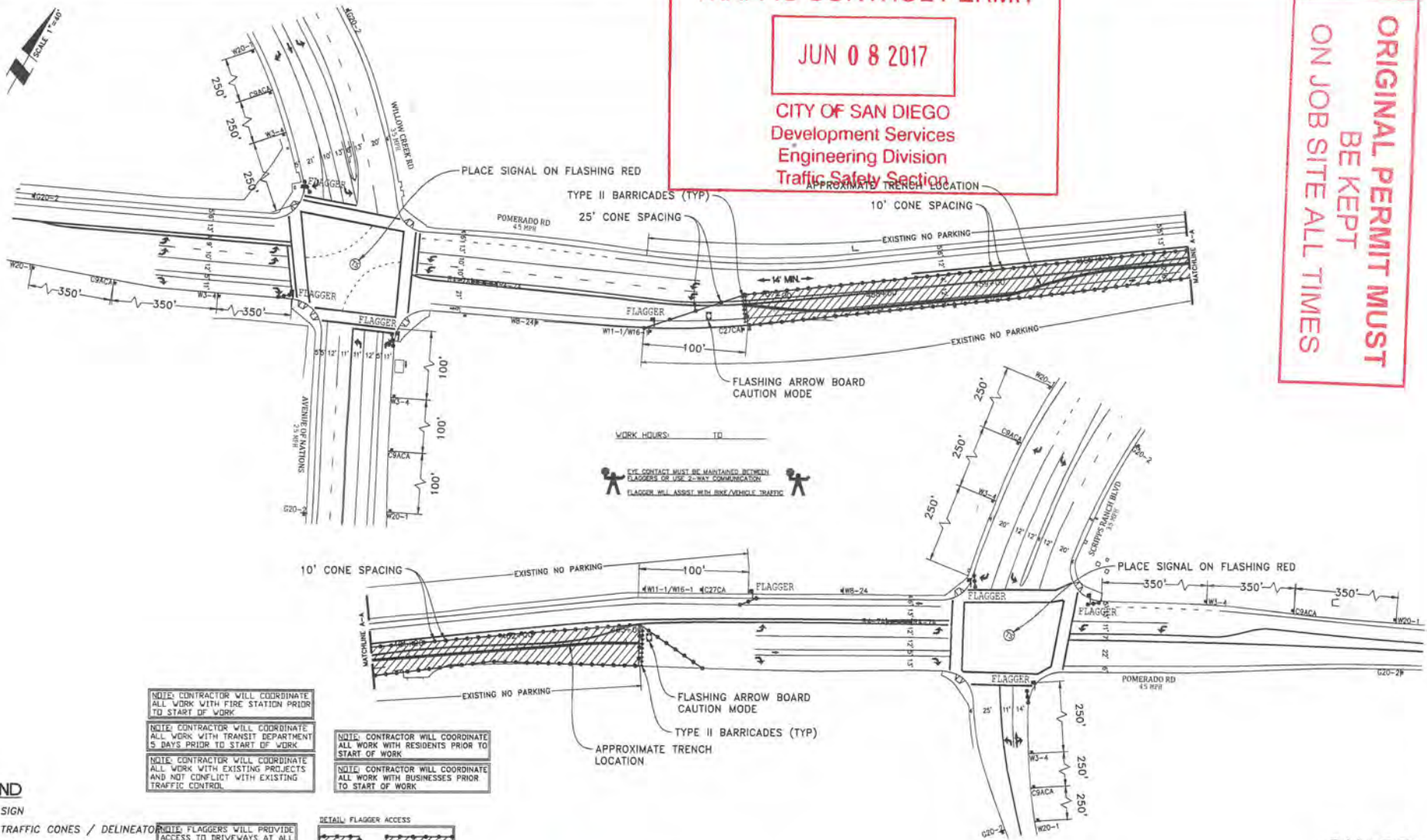

NOTE: CONTRACTOR WILL COORDINATE ALL WORK WITH FIRE STATION PRIOR TO START OF WORK

NOTE: CONTRACTOR WILL COORDINATE ALL WORK WITH TRANSIT DEPARTMENT 5 DAYS PRIOR TO START OF WORK

NOTE: CONTRACTOR WILL COORDINATE ALL WORK WITH EXISTING PROJECTS AND NOT CONFLICT WITH EXISTING TRAFFIC CONTROL

NOTE: CONTRACTOR WILL COORDINATE ALL WORK WITH RESIDENTS PRIOR TO START OF WORK

NOTE: CONTRACTOR WILL COORDINATE ALL WORK WITH BUSINESSES PRIOR TO START OF WORK

LEGEND

- SIGN
- TRAFFIC CONES / DELINEATOR
- BARRICADE
- FLAGGER
- FLASHING ARROW SIGN
- WORK ZONE
- BUS STOP

NOTE: FLAGGERS WILL PROVIDE ACCESS TO DRIVEWAYS AT ALL TIMES

NOTE: FLAGGERS WILL SAFELY GUIDE PEDESTRIANS THROUGH WORK AREA

NOTE: CONTRACTOR WILL ALLOW FIRE STATION INGRESS AND EGRESS AT ALL TIMES

NOTE: WB-24 (STEEL PLATES AHEAD) SIGNS WILL REMAIN IN PLACE FOR DURATION OF WORK

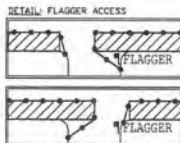

NOTE: DRIVEWAY ACCESS WILL BE PROVIDED AT ALL TIMES WORK WILL BE SPLIT TO PROVIDE ACCESS

ENERGY SURVEYORS, INC.

Gail McMorran
President

2534 EAST EL NORTE PARKWAY, SUITE C
ESCONDIDO, CA 92027
PHONE: (760) 450-2247
CELL: (760) 418-5739

PROJECT NAME: TL23071 - SYCAMORE CANYON SUBSTATION TO PENASQUITOS - 230 KV UNDERGROUND	
AIRX JOB# X160218	THOMAS GRID#-
TYPE OF WORK: TRENCHING / CONDUIT	DRAWN FOR: CALTRANS
MISC./POTHOLE#:	

PHASE 86

DATE: Mar. 21, 2017
DESIGNED BY: Clint Jones
SHEET 102 OF 148

**ORIGINAL PERMIT MUST
BE KEPT
ON JOB SITE ALL TIMES**

**APPROVED
TRAFFIC CONTROL PERMIT**

JUN 08 2017

**CITY OF SAN DIEGO
Development Services
Engineering Division
Traffic Safety Section**

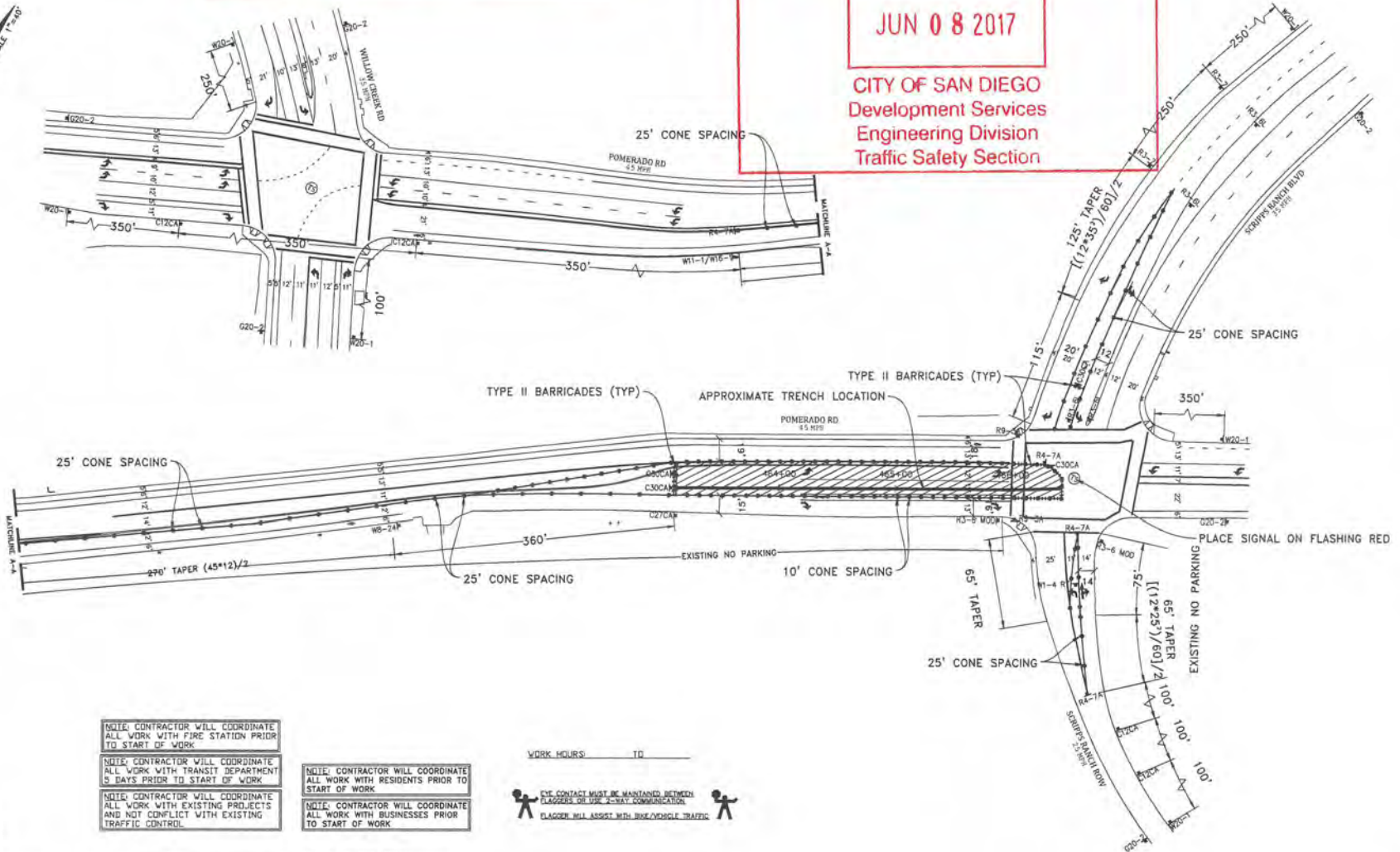

NOTE: CONTRACTOR WILL COORDINATE ALL WORK WITH FIRE STATION PRIOR TO START OF WORK.

NOTE: CONTRACTOR WILL COORDINATE ALL WORK WITH TRANSIT DEPARTMENT 5 DAYS PRIOR TO START OF WORK.

NOTE: CONTRACTOR WILL COORDINATE ALL WORK WITH EXISTING PROJECTS AND NOT CONFLICT WITH EXISTING TRAFFIC CONTROL.

NOTE: CONTRACTOR WILL COORDINATE ALL WORK WITH RESIDENTS PRIOR TO START OF WORK.

NOTE: CONTRACTOR WILL COORDINATE ALL WORK WITH BUSINESSES PRIOR TO START OF WORK.

WORK HOURS: _____ TO _____

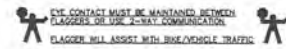

LEGEND

-  SIGN
-  TRAFFIC CONES / DELINEATOR
-  BARRICADE
-  FLAGGER
-  FLASHING ARROW SIGN
-  WORK ZONE
-  BUS STOP

NOTE: FLAGGERS WILL PROVIDE ACCESS TO DRIVEWAYS AT ALL TIMES.

NOTE: FLAGGERS WILL SAFELY GUIDE PEDESTRIANS THROUGH WORK AREA.

NOTE: CONTRACTOR WILL ALLOW FIRE STATION INGRESS AND EGRESS AT ALL TIMES.

NOTE: V8-24 (STEEL PLATES AHEAD) SIGNS WILL REMAIN IN PLACE FOR DURATION OF WORK.

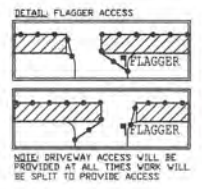

AIRX SURVEYORS, INC.
Gail McMorran
President
2534 EAST EL NORTE PARKWAY, SUITE C
ESCONDIDO, CA 92027
PHONE: (760) 450-2547
CELL: (760) 419-3738

PROJECT NAME: TL23071 - SYCAMORE CANYON SUBSTATION TO PENASQUITOS - 230 KV UNDERGROUND	
AIRX JOB#: X160218	THOMAS GRID#:-
TYPE OF WORK: TRENCHING / CONDUIT	DRAWN FOR: CALTRANS
MISC./POTHOLE#:	

PHASE 87

DATE: Mar. 21, 2017
DESIGNED BY: Clint Jones
SHEET 103 OF 148

APPROVED TRAFFIC CONTROL PERMIT

JUN 08 2017

CITY OF SAN DIEGO
Development Services
Engineering Division
Traffic Safety Section

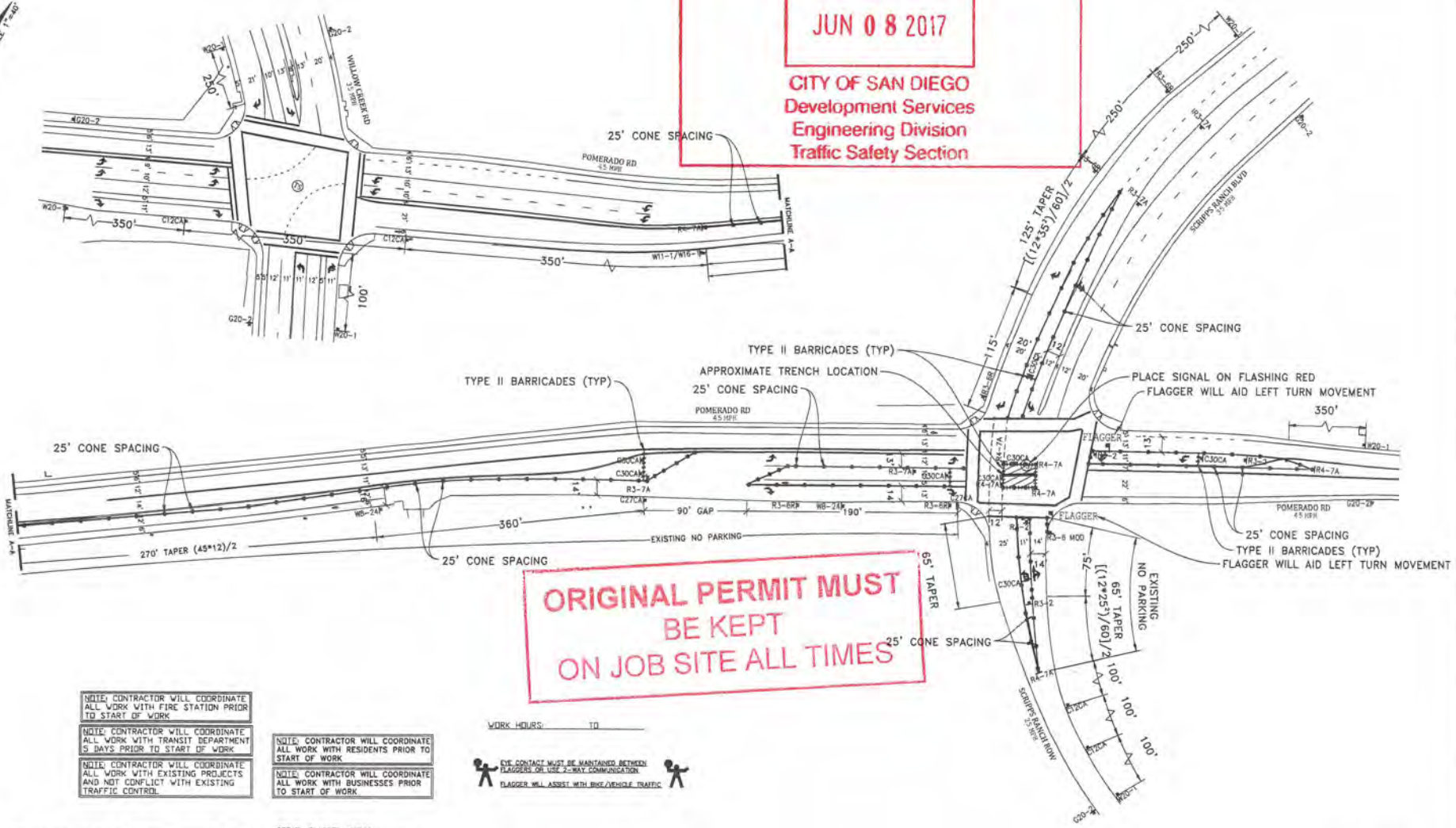

ORIGINAL PERMIT MUST
BE KEPT
ON JOB SITE ALL TIMES

- NOTE: CONTRACTOR WILL COORDINATE ALL WORK WITH FIRE STATION PRIOR TO START OF WORK
- NOTE: CONTRACTOR WILL COORDINATE ALL WORK WITH TRANSIT DEPARTMENT 5 DAYS PRIOR TO START OF WORK
- NOTE: CONTRACTOR WILL COORDINATE ALL WORK WITH RESIDENTS PRIOR TO START OF WORK
- NOTE: CONTRACTOR WILL COORDINATE ALL WORK WITH EXISTING PROJECTS AND NOT CONFLICT WITH EXISTING TRAFFIC CONTROL
- NOTE: CONTRACTOR WILL COORDINATE ALL WORK WITH BUSINESSES PRIOR TO START OF WORK

WORK HOURS: _____ TO _____

EYE CONTACT MUST BE MAINTAINED BETWEEN
FLAGGERS ON USE 2-WAY COMMUNICATION
FLAGGER WILL ASSIST WITH BIG/VEHICLE TRAFFIC

- LEGEND**
- SIGN
 - TRAFFIC CONES / DELINEATOR
 - BARRICADE
 - FLAGGER
 - FLASHING ARROW SIGN
 - WORK ZONE
 - BUS STOP

- NOTE: FLAGGERS WILL PROVIDE ACCESS TO DRIVEWAYS AT ALL TIMES
- NOTE: FLAGGERS WILL SAFELY GUIDE PEDESTRIANS THROUGH WORK AREA
- NOTE: CONTRACTOR WILL ALLOW FIRE STATION INGRESS AND EGRESS AT ALL TIMES
- NOTE: WB-24 (STEEL PLATES AHEAD) SIGNS WILL REMAIN IN PLACE FOR DURATION OF WORK
- DETAIL: FLAGGER ACCESS
-
- NOTE: DRIVEWAY ACCESS WILL BE PROVIDED AT ALL TIMES WORK WILL BE SPLIT TO PROVIDE ACCESS

UTILITY SURVEYORS, INC.

Gail McMorran
President

2534 EAST EL NORTE PARKWAY, SUITE C
ESCONDIDO, CA 92027
PHONE: (760) 465-2247
CELL: (760) 419-3738

PROJECT NAME: TL23071 - SYCAMORE CANYON SUBSTATION TO PENASQUITOS - 230 KV UNDERGROUND	
AIRX JOB#: X160218	THOMAS GRID#:-
TYPE OF WORK: TRENCHING / CONDUIT	DRAWN FOR: CALTRANS
MISC./POTHOLE#:	

PHASE 88

DATE: Mar. 21, 2017
DESIGNED BY: Clint Jones
SHEET 104 OF 148

**ORIGINAL PERMIT MUST
BE KEPT
ON JOB SITE ALL TIMES**

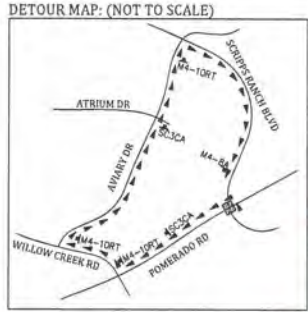
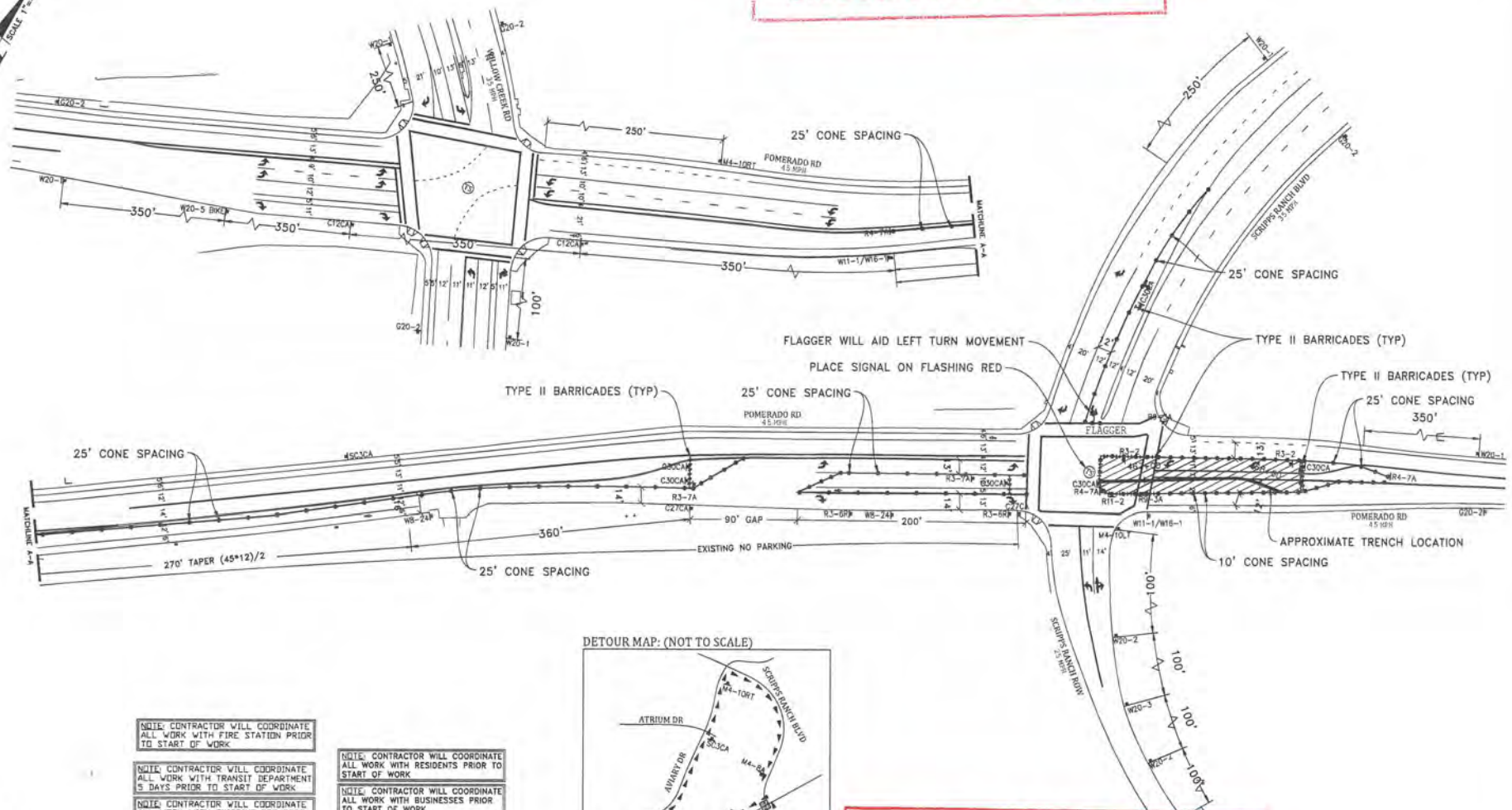

NOTE: CONTRACTOR WILL COORDINATE ALL WORK WITH FIRE STATION PRIOR TO START OF WORK

NOTE: CONTRACTOR WILL COORDINATE ALL WORK WITH TRANSIT DEPARTMENT 5 DAYS PRIOR TO START OF WORK

NOTE: CONTRACTOR WILL COORDINATE ALL WORK WITH EXISTING PROJECTS AND NOT CONFLICT WITH EXISTING TRAFFIC CONTROL

NOTE: CONTRACTOR WILL COORDINATE ALL WORK WITH RESIDENTS PRIOR TO START OF WORK

NOTE: CONTRACTOR WILL COORDINATE ALL WORK WITH BUSINESSES PRIOR TO START OF WORK

NOTE: FLAGGERS WILL PROVIDE ACCESS TO DRIVEWAYS AT ALL TIMES

NOTE: FLAGGERS WILL SAFELY GUIDE PEDESTRIANS THROUGH WORK AREA

NOTE: CONTRACTOR WILL ALLOW FIRE STATION INGRESS AND EGRESS AT ALL TIMES

NOTE: W8-24 (STEEL PLATES AHEAD) SIGNS WILL REMAIN IN PLACE FOR DURATION OF WORK

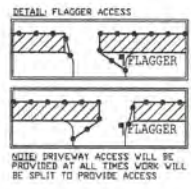

- LEGEND**
- SIGN
 - TRAFFIC CONES / DELINEATOR
 - BARRICADE
 - FLAGGER
 - FLASHING ARROW SIGN
 - WORK ZONE
 - BUS STOP

UTILITY SURVEYORS, INC.

AIRX

Gail McMorran
President

2534 EAST EL NORTE PARKWAY, SUITE C
ESCONDIDO, CA 92027
PHONE: (760) 450-2247
CELL: (760) 419-3730

WORK HOURS: _____ TO _____

APPROVED

TRAFFIC CONTROL PERMIT

PROJECT NAME: 123971 - SYCAMORE CANYON SUBSTATION TO PENASQUITOS - 230 KV UNDERGROUND

AIRX JOB#: X160218

TYPE OF WORK: TRENCHING / CONDUIT

MISC./POTHOLES#: _____

THOMAS GRID#-
DRAWN FOR: CALTRANS

PHASE 89

DATE: Mar. 21, 2017

DESIGNED BY: Clint Jones

SHEET 105 OF 148

CITY OF SAN DIEGO
Development Services
Engineering Division
Traffic Safety Section

**ORIGINAL PERMIT MUST
BE KEPT
ON JOB SITE ALL TIMES**

**APPROVED
TRAFFIC CONTROL PERMIT**

JUN 08 2017

CITY OF SAN DIEGO
Development Services
Engineering Division
Traffic Safety Section

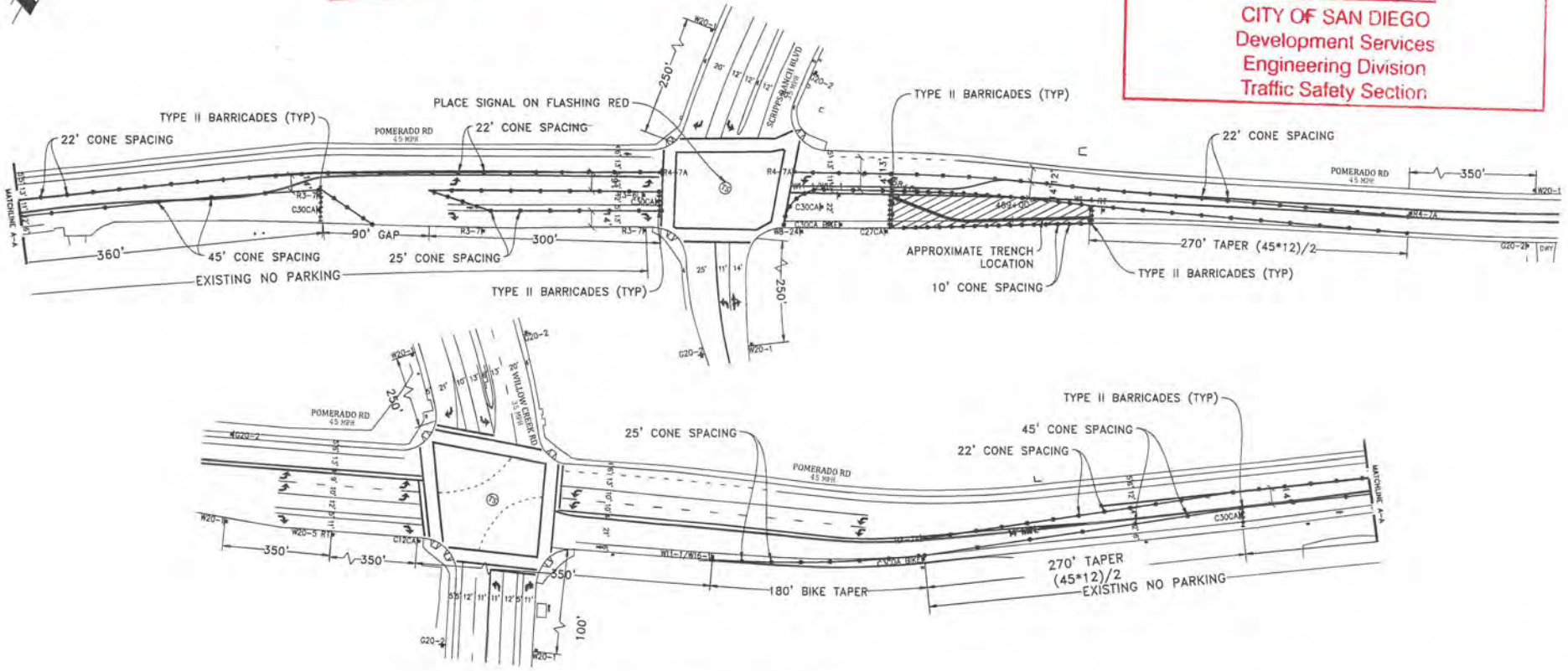

NOTE: CONTRACTOR WILL COORDINATE ALL WORK WITH FIRE STATION PRIOR TO START OF WORK

NOTE: CONTRACTOR WILL COORDINATE ALL WORK WITH TRANSIT DEPARTMENT 5 DAYS PRIOR TO START OF WORK

NOTE: CONTRACTOR WILL COORDINATE ALL WORK WITH EXISTING PROJECTS AND NOT CONFLICT WITH EXISTING TRAFFIC CONTROL





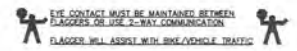

NOTE: CONTRACTOR WILL COORDINATE ALL WORK WITH RESIDENTS PRIOR TO START OF WORK

NOTE: CONTRACTOR WILL COORDINATE ALL WORK WITH BUSINESSES PRIOR TO START OF WORK

WORK HOURS: _____ TO _____



LEGEND

-  SIGN
-  TRAFFIC CONES / DELINEATOR
-  BARRICADE
-  FLAGGER
-  FLASHING ARROW SIGN
-  WORK ZONE
-  BUS STOP

NOTE: FLAGGERS WILL PROVIDE ACCESS TO DRIVEWAYS AT ALL TIMES

NOTE: FLAGGERS WILL SAFELY GUIDE PEDESTRIANS THROUGH WORK AREA

NOTE: CONTRACTOR WILL ALLOW FIRE STATION INGRESS AND EGRESS AT ALL TIMES

NOTE: W8-24 (STEEL PLATES) AHEAD SIGNS WILL REMAIN IN PLACE FOR DURATION OF WORK

DETAIL: FLAGGER ACCESS

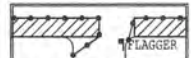
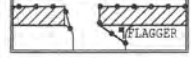

NOTE: DRIVEWAY ACCESS WILL BE PROVIDED AT ALL TIMES WORK WILL BE SPLIT TO PROVIDE ACCESS

AIRX SURVEYORS, INC.

Gail McMorran
 President
 2824 EAST EL NORTE PARKWAY, SUITE C
 ESCOBEDO, CA 92027
 PHONE: (951) 480-2347
 CELL: (760) 419-3728

PROJECT NAME: TL23071 - SYCAMORE CANYON SUBSTATION TO PENASQUITOS - 230 KV UNDERGROUND	
AIRX JOB#: X160218	THOMAS GRID#:-
TYPE OF WORK: FRENCHING / CONDUIT	DRAWN FOR: CALTRANS
MISC./POTHOLE#:	

PHASE 90

DATE: Mar. 21, 2017
DESIGNED BY: Clint Jones
SHEET 106 OF 148



**ORIGINAL PERMIT MUST
BE KEPT
ON JOB SITE ALL TIMES**

**APPROVED
TRAFFIC CONTROL PERMIT**

JUN 08 2017

**CITY OF SAN DIEGO
Development Services
Engineering Division
Traffic Safety Section**

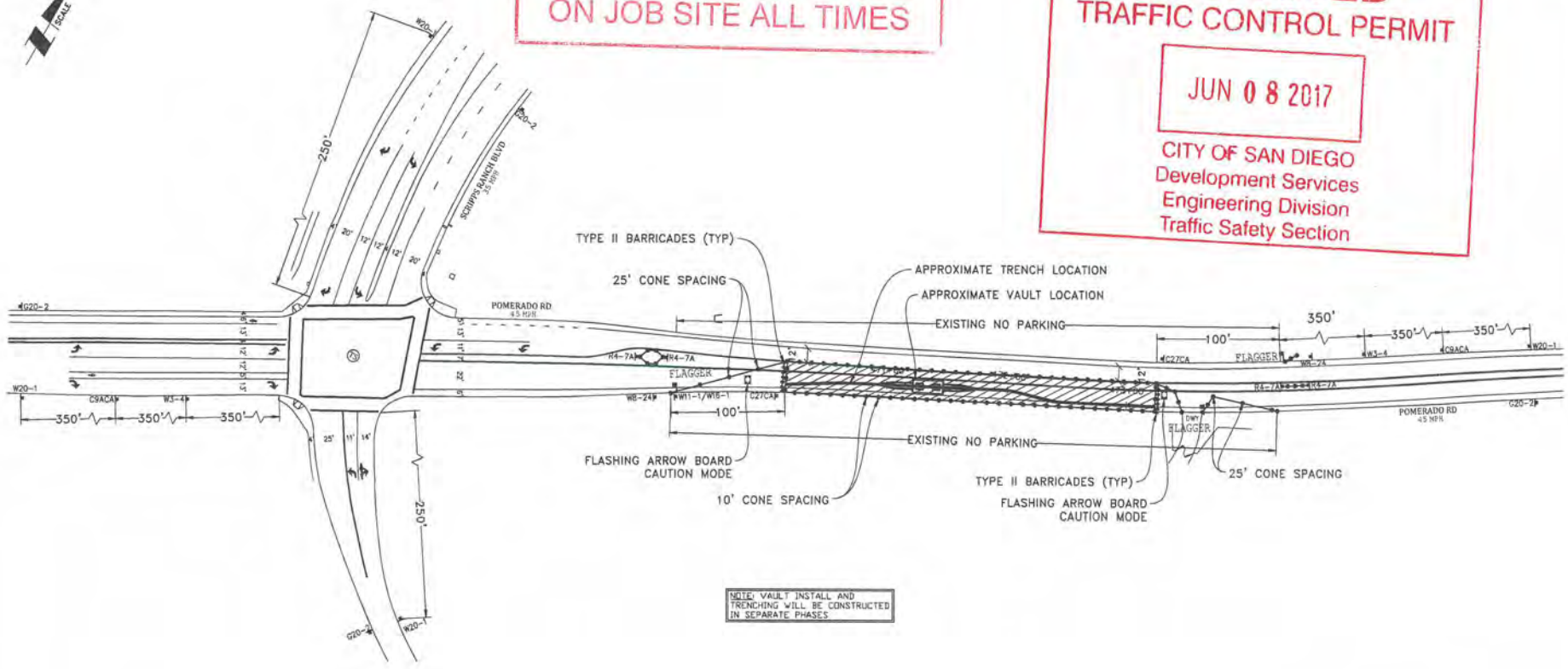

NOTE: VAULT INSTALL AND TRENCHING WILL BE CONSTRUCTED IN SEPARATE PHASES.

NOTE: CONTRACTOR WILL COORDINATE ALL WORK WITH FIRE STATION PRIOR TO START OF WORK

NOTE: CONTRACTOR WILL COORDINATE ALL WORK WITH TRANSIT DEPARTMENT 5 DAYS PRIOR TO START OF WORK

NOTE: CONTRACTOR WILL COORDINATE ALL WORK WITH EXISTING PROJECTS AND NOT CONFLICT WITH EXISTING TRAFFIC CONTROL

NOTE: CONTRACTOR WILL COORDINATE ALL WORK WITH RESIDENTS PRIOR TO START OF WORK

NOTE: CONTRACTOR WILL COORDINATE ALL WORK WITH BUSINESSES PRIOR TO START OF WORK

WORK HOURS: _____ TO _____

EYE CONTACT MUST BE MAINTAINED BETWEEN FLAGGERS OR USE 2-WAY COMMUNICATION
FLAGGERS WILL ASSIST WITH BIKE/VEHICLE TRAFFIC

LEGEND

- SIGN
- TRAFFIC CONES / DELINEATOR
- BARRICADE
- FLAGGER
- FLASHING ARROW SIGN
- WORK ZONE
- BUS STOP

NOTE: FLAGGERS WILL PROVIDE ACCESS TO DRIVEWAYS AT ALL TIMES

NOTE: FLAGGERS WILL SAFELY GUIDE PEDESTRIANS THROUGH WORK AREA

NOTE: CONTRACTOR WILL ALLOW FIRE STATION INGRESS AND EGRESS AT ALL TIMES

NOTE: WB-24 (STEEL PLATES AHEAD SIGNS WILL REMAIN IN PLACE FOR DURATION OF WORK

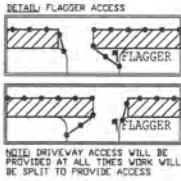

AIRX SURVEYORS, INC.
Gail McMoran
President
2594 EAST EL NORTE PARKWAY, SUITE C
ESCONDIDO, CA 92027
PHONE: (760) 480-2547
CELL: (760) 419-3738

PROJECT NAME: TL23071 - SYCAMORE CANYON SUBSTATION TO PENASQUITOS - 230 KV UNDERGROUND	
AIRX JOB#: X160218	THOMAS GRID#:
TYPE OF WORK: TRENCHING / CONDUIT	DRAWN FOR: CALTRANS
MISC./POTHOLE#:	

PHASE 91

DATE: Mar. 21, 2017
DESIGNED BY: Clint Jones
SHEET 107 OF 148