



**EDR**® Environmental  
Data Resources Inc

## **The EDR Radius Map with GeoCheck®**

**Warner Substation  
Hwy 79/SR 2  
WARNER SPRINGS, CA 92086**

**Inquiry Number: 2051958.2s**

**October 12, 2007**

## **The Standard in Environmental Risk Information**

440 Wheelers Farms Road  
Milford, Connecticut 06461

### **Nationwide Customer Service**

Telephone: 1-800-352-0050  
Fax: 1-800-231-6802  
Internet: [www.edrnet.com](http://www.edrnet.com)

# TABLE OF CONTENTS

<u>SECTION</u>	<u>PAGE</u>
Executive Summary .....	ES1
Overview Map .....	2
Detail Map .....	3
Map Findings Summary .....	4
Map Findings .....	6
Orphan Summary .....	7
Government Records Searched/Data Currency Tracking .....	GR-1
 <b><u>GEOCHECK ADDENDUM</u></b>	
Physical Setting Source Addendum .....	A-1
Physical Setting Source Summary .....	A-2
Physical Setting Source Map .....	A-7
Physical Setting Source Map Findings .....	A-8
Physical Setting Source Records Searched .....	A-19

*Thank you for your business.*  
Please contact EDR at 1-800-352-0050  
with any questions or comments.

#### Disclaimer - Copyright and Trademark Notice

This Report contains certain information obtained from a variety of public and other sources reasonably available to Environmental Data Resources, Inc. It cannot be concluded from this Report that coverage information for the target and surrounding properties does not exist from other sources. **NO WARRANTY EXPRESSED OR IMPLIED, IS MADE WHATSOEVER IN CONNECTION WITH THIS REPORT. ENVIRONMENTAL DATA RESOURCES, INC. SPECIFICALLY DISCLAIMS THE MAKING OF ANY SUCH WARRANTIES, INCLUDING WITHOUT LIMITATION, MERCHANTABILITY OR FITNESS FOR A PARTICULAR USE OR PURPOSE. ALL RISK IS ASSUMED BY THE USER. IN NO EVENT SHALL ENVIRONMENTAL DATA RESOURCES, INC. BE LIABLE TO ANYONE, WHETHER ARISING OUT OF ERRORS OR OMISSIONS, NEGLIGENCE, ACCIDENT OR ANY OTHER CAUSE, FOR ANY LOSS OF DAMAGE, INCLUDING, WITHOUT LIMITATION, SPECIAL, INCIDENTAL, CONSEQUENTIAL, OR EXEMPLARY DAMAGES. ANY LIABILITY ON THE PART OF ENVIRONMENTAL DATA RESOURCES, INC. IS STRICTLY LIMITED TO A REFUND OF THE AMOUNT PAID FOR THIS REPORT.** Purchaser accepts this Report "AS IS". Any analyses, estimates, ratings, environmental risk levels or risk codes provided in this Report are provided for illustrative purposes only, and are not intended to provide, nor should they be interpreted as providing any facts regarding, or prediction or forecast of, any environmental risk for any property. Only a Phase I Environmental Site Assessment performed by an environmental professional can provide information regarding the environmental risk for any property. Additionally, the information provided in this Report is not to be construed as legal advice.

Copyright 2007 by Environmental Data Resources, Inc. All rights reserved. Reproduction in any media or format, in whole or in part, of any report or map of Environmental Data Resources, Inc., or its affiliates, is prohibited without prior written permission.

EDR and its logos (including Sanborn and Sanborn Map) are trademarks of Environmental Data Resources, Inc. or its affiliates. All other trademarks used herein are the property of their respective owners.

## EXECUTIVE SUMMARY

A search of available environmental records was conducted by Environmental Data Resources, Inc (EDR). The report was designed to assist parties seeking to meet the search requirements of EPA's Standards and Practices for All Appropriate Inquiries (40 CFR Part 312), the ASTM Standard Practice for Environmental Site Assessments (E 1527-05) or custom requirements developed for the evaluation of environmental risk associated with a parcel of real estate.

### TARGET PROPERTY INFORMATION

#### ADDRESS

HWY 79/SR 2  
WARNER SPRINGS, CA 92086

#### COORDINATES

Latitude (North): 33.247600 - 33° 14' 51.4"  
Longitude (West): 116.675100 - 116° 40' 30.4"  
Universal Transverse Mercator: Zone 11  
UTM X (Meters): 530266.5  
UTM Y (Meters): 3678591.5  
Elevation: 2836 ft. above sea level

### USGS TOPOGRAPHIC MAP ASSOCIATED WITH TARGET PROPERTY

Target Property Map: 33116-B6 WARNERS RANCH, CA  
Most Recent Revision: 1975  
  
North Map: 33116-C6 WARNER SPRINGS, CA  
Most Recent Revision: 1975

### TARGET PROPERTY SEARCH RESULTS

The target property was not listed in any of the databases searched by EDR.

### DATABASES WITH NO MAPPED SITES

No mapped sites were found in EDR's search of available ("reasonably ascertainable ") government records either on the target property or within the search radius around the target property for the following databases:

#### FEDERAL RECORDS

**NPL**..... National Priority List  
**Proposed NPL**..... Proposed National Priority List Sites  
**Delisted NPL**..... National Priority List Deletions  
**NPL LIENS**..... Federal Superfund Liens  
**CERCLIS**..... Comprehensive Environmental Response, Compensation, and Liability Information System  
**CERC-NFRAP**..... CERCLIS No Further Remedial Action Planned  
**CORRACTS**..... Corrective Action Report

## EXECUTIVE SUMMARY

<b>RCRA-TSDF</b> .....	Resource Conservation and Recovery Act Information
<b>RCRA-LQG</b> .....	Resource Conservation and Recovery Act Information
<b>RCRA-SQG</b> .....	Resource Conservation and Recovery Act Information
<b>ERNS</b> .....	Emergency Response Notification System
<b>HMIRS</b> .....	Hazardous Materials Information Reporting System
<b>US ENG CONTROLS</b> .....	Engineering Controls Sites List
<b>US INST CONTROL</b> .....	Sites with Institutional Controls
<b>DOD</b> .....	Department of Defense Sites
<b>FUDS</b> .....	Formerly Used Defense Sites
<b>US BROWNFIELDS</b> .....	A Listing of Brownfields Sites
<b>CONSENT</b> .....	Superfund (CERCLA) Consent Decrees
<b>ROD</b> .....	Records Of Decision
<b>UMTRA</b> .....	Uranium Mill Tailings Sites
<b>ODI</b> .....	Open Dump Inventory
<b>TRIS</b> .....	Toxic Chemical Release Inventory System
<b>TSCA</b> .....	Toxic Substances Control Act
<b>FTTS</b> .....	FIFRA/ TSCA Tracking System - FIFRA (Federal Insecticide, Fungicide, & Rodenticide Act)/TSCA (Toxic Substances Control Act)
<b>SSTS</b> .....	Section 7 Tracking Systems
<b>DOT OPS</b> .....	Incident and Accident Data
<b>DEBRIS REGION 9</b> .....	Torres Martinez Reservation Illegal Dump Site Locations
<b>ICIS</b> .....	Integrated Compliance Information System
<b>LUCIS</b> .....	Land Use Control Information System
<b>US CDL</b> .....	Clandestine Drug Labs
<b>RADINFO</b> .....	Radiation Information Database
<b>LIENS 2</b> .....	CERCLA Lien Information
<b>HIFRA FTTS</b> .....	FIFRA/TSCA Tracking System Administrative Case Listing
<b>PADS</b> .....	PCB Activity Database System
<b>MLTS</b> .....	Material Licensing Tracking System
<b>MINES</b> .....	Mines Master Index File
<b>FINDS</b> .....	Facility Index System/Facility Registry System
<b>RAATS</b> .....	RCRA Administrative Action Tracking System

### STATE AND LOCAL RECORDS

<b>HIST Cal-Sites</b> .....	Historical Calsites Database
<b>CA BOND EXP. PLAN</b> .....	Bond Expenditure Plan
<b>SCH</b> .....	School Property Evaluation Program
<b>Toxic Pits</b> .....	Toxic Pits Cleanup Act Sites
<b>SWF/LF</b> .....	Solid Waste Information System
<b>CA WDS</b> .....	Waste Discharge System
<b>WMUDS/SWAT</b> .....	Waste Management Unit Database
<b>Cortese</b> .....	"Cortese" Hazardous Waste & Substances Sites List
<b>SWRCY</b> .....	Recycler Database
<b>LUST</b> .....	Geotracker's Leaking Underground Fuel Tank Report
<b>CA FID UST</b> .....	Facility Inventory Database
<b>SLIC</b> .....	Statewide SLIC Cases
<b>UST</b> .....	Active UST Facilities
<b>HIST UST</b> .....	Hazardous Substance Storage Container Database
<b>AST</b> .....	Aboveground Petroleum Storage Tank Facilities
<b>LIENS</b> .....	Environmental Liens Listing
<b>SWEEPS UST</b> .....	SWEEPS UST Listing
<b>CHMIRS</b> .....	California Hazardous Material Incident Report System
<b>Notify 65</b> .....	Proposition 65 Records
<b>DEED</b> .....	Deed Restriction Listing

## EXECUTIVE SUMMARY

<b>VCP</b> .....	Voluntary Cleanup Program Properties
<b>CLEANERS</b> .....	Cleaner Facilities
<b>WIP</b> .....	Well Investigation Program Case List
<b>CDL</b> .....	Clandestine Drug Labs
<b>San Diego Co. HMMD</b> .....	Hazardous Materials Management Division Database
<b>RESPONSE</b> .....	State Response Sites
<b>HAZNET</b> .....	Facility and Manifest Data
<b>EMI</b> .....	Emissions Inventory Data
<b>SAN DIEGO CO. SAM</b> .....	Environmental Case Listing
<b>HAULERS</b> .....	Registered Waste Tire Haulers Listing
<b>ENVIROSTOR</b> .....	EnviroStor Database

### TRIBAL RECORDS

<b>INDIAN RESERV</b> .....	Indian Reservations
<b>INDIAN LUST</b> .....	Leaking Underground Storage Tanks on Indian Land
<b>INDIAN UST</b> .....	Underground Storage Tanks on Indian Land

### EDR PROPRIETARY RECORDS

<b>Manufactured Gas Plants</b> ...	EDR Proprietary Manufactured Gas Plants
------------------------------------	---

### SURROUNDING SITES: SEARCH RESULTS

Surrounding sites were not identified.

Unmappable (orphan) sites are not considered in the foregoing analysis.

## EXECUTIVE SUMMARY

Due to poor or inadequate address information, the following sites were not mapped:

<u>Site Name</u>	<u>Database(s)</u>
USN-NAS NI/FASO	SWEEPS UST
WARNER SPRINGS	SWEEPS UST
WESTFORK HONOR CAMP - STATION	SWEEPS UST
WARNER SPRINGS RADIO RELAY	SWEEPS UST
SUMMET CENTER	SWEEPS UST
PACIFIC BELL WNSPCA12/DB186	SWEEPS UST
PACIFIC BELL AT WARNER SPRINGS	LUST, Cortese
SERE CAMP, WARNER SPRINGS	Cortese
SURVIVAL, EVASION, RESISTANCE, AND ESCAPE CAMP, WARNER SPRING	CERCLIS
SERE CAMP	SWF/LF
SUNSHINE SUMMIT BURN SITE	SWF/LF
LAKE HENSHAW RESORT	SWF/LF, WMUDS/SWAT
WARNER SPRINGS RANCH	LUST, San Diego Co. HMMD, EMI, SAN DIEGO CO. SAM
WARNER UNION SCHOOL DISTRICT	LUST, SAN DIEGO CO. SAM
WARNER SPRINGS	HIST UST
WESTFORK HONOR CAMP - STATION	HIST UST
SURVIVAL EVASION RESISTANCE & OAK GROVE STATION	HIST UST
S.E.R.E CAMP LANDFILL (SITE 1)	AST
MAY BE WARNER SPRINGS	WMUDS/SWAT
OAK GROVE-WARNER SPRINGS DISPO	WMUDS/SWAT
WARNER UNIFIED SCHOOL DISTRICT	WMUDS/SWAT
PACIFIC BELL	HAZNET
WARNER HIGH	RCRA-SQG, FINDS, HAZNET
WARNER ELEMENTARY	FINDS
OAK GROVE / WARNER SPRINGS	FINDS
WARNER SPRINGS RANCH	FINDS
SURVIVAL, EVASION, RESISTANCE, AND ESCAPE CAMP, WARNER SPRING	FINDS
VERIZON WIRELESS - WARNER HOT	San Diego Co. HMMD
WARNER SPRINGS RANCH	San Diego Co. HMMD
WARNER SPRINGS AIRPORT	San Diego Co. HMMD
WARNER SPRINGS	San Diego Co. HMMD
WARNER UNION SCHOOL DISTRICT	San Diego Co. HMMD
WARNER SPRINGS RANCH SERV STN	San Diego Co. HMMD
S.E.R.E. CAMP WARNER SPRINGS	San Diego Co. HMMD
SERE CAMP, WARNER SPRINGS	CA WDS
PACIFIC BELL WNSPCA12/DB186	ENVIROSTOR
	SAN DIEGO CO. SAM

# OVERVIEW MAP - 2051958.2s

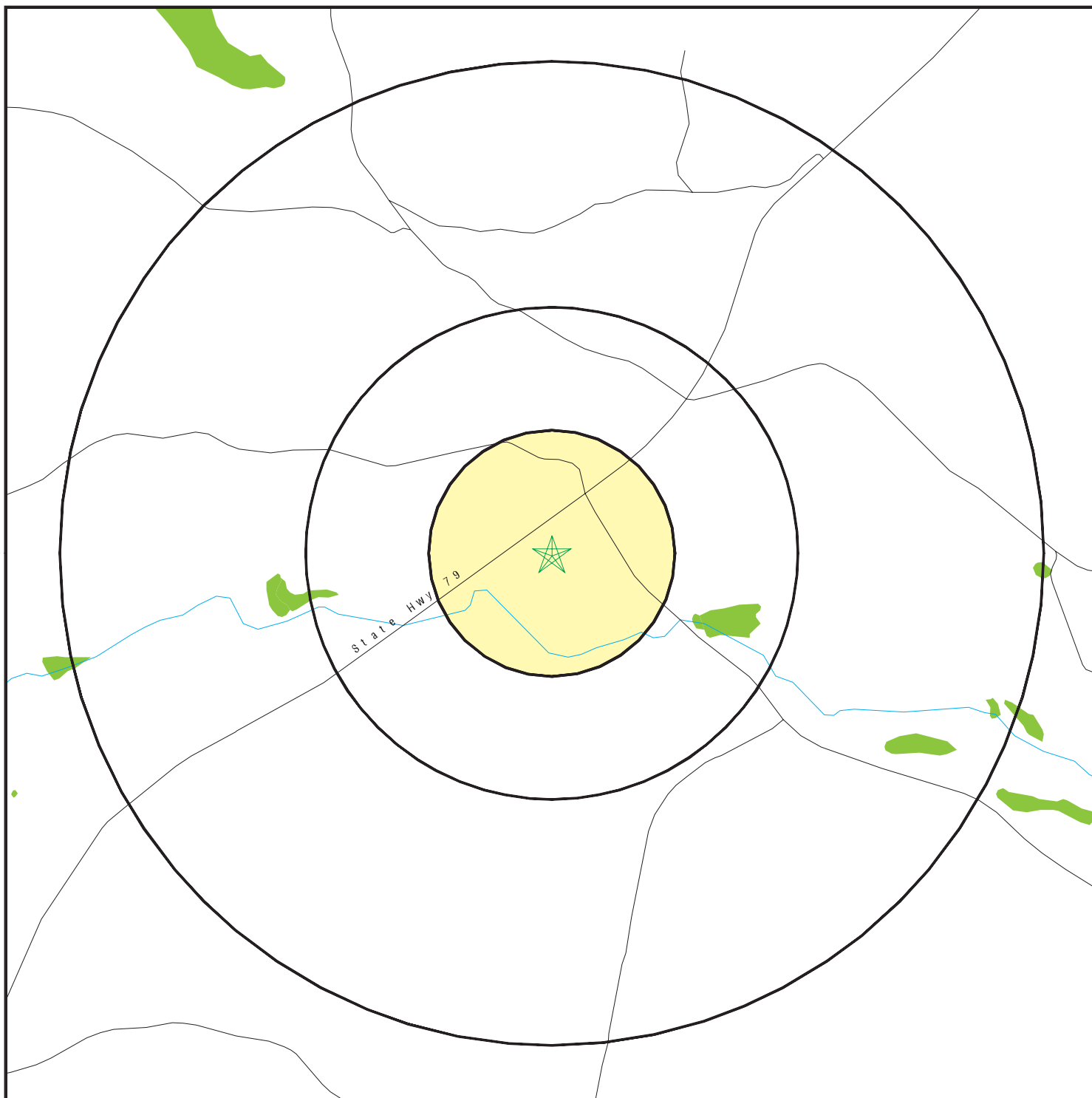

- ★ Target Property
- ▲ Sites at elevations higher than or equal to the target property
- ◆ Sites at elevations lower than the target property
- ⚡ Manufactured Gas Plants
- ☒ National Priority List Sites
- ☒ Dept. Defense Sites

0                      1/4                      1/2                      1 Miles

- ☒ Indian Reservations BIA
- ☒ Areas of Concern
- ⚡ Oil & Gas pipelines
- National Wetland Inventory



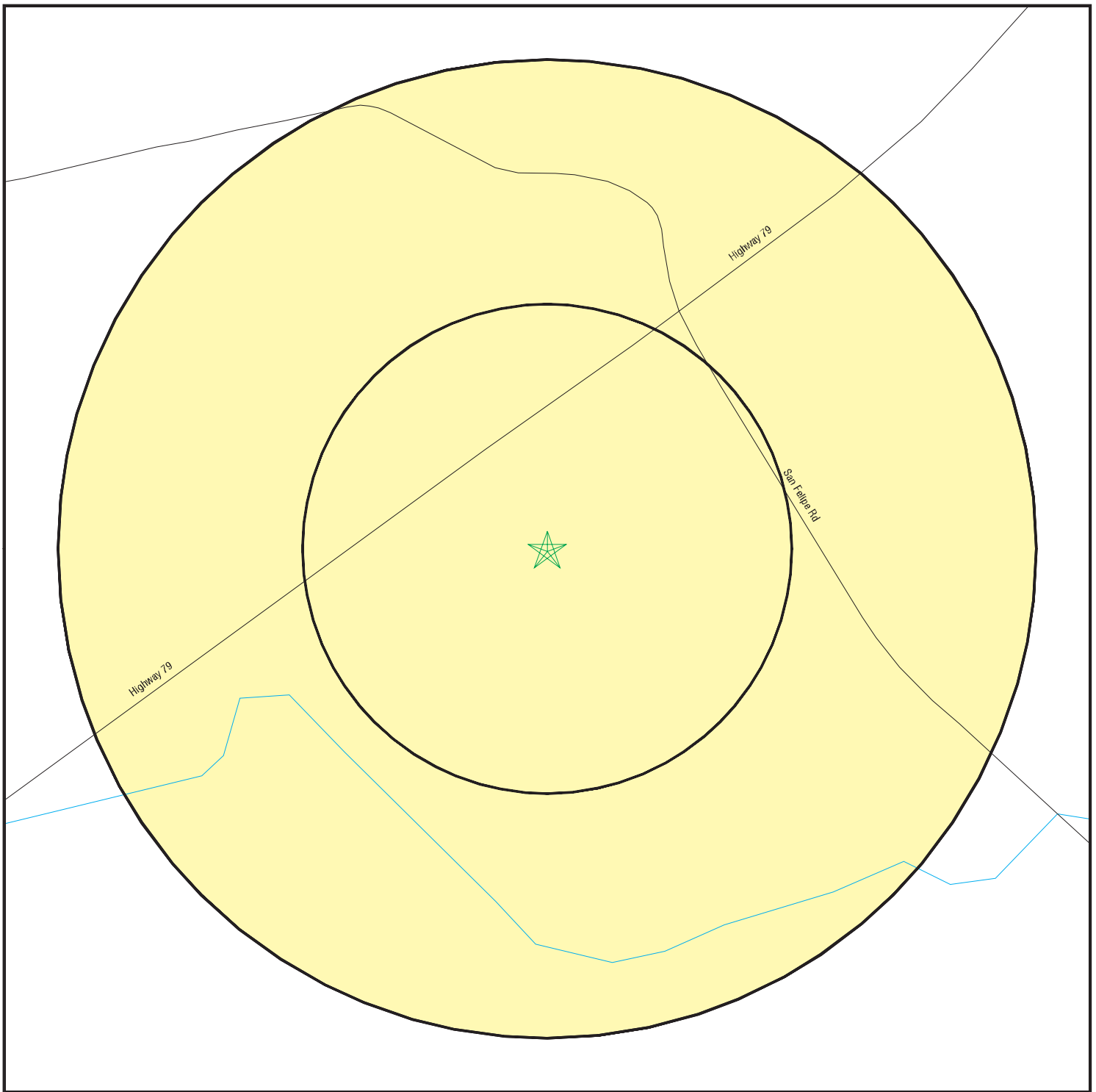

<p>SITE NAME: Warner Substation          ADDRESS: Hwy 79/SR 2          WARNER SPRINGS CA 92086          LAT/LONG: 33.2476 / 116.6751</p>	<p>CLIENT: Geotechnical Const. Inc.          CONTACT: Aurie Patterson          INQUIRY #: 2051958.2s          DATE: October 12, 2007 3:37 pm</p>
--	--

# DETAIL MAP - 2051958.2s



- ★ Target Property
- ▲ Sites at elevations higher than or equal to the target property
- ◆ Sites at elevations lower than the target property
- ⚡ Manufactured Gas Plants
- ⚠ Sensitive Receptors
- 🚧 National Priority List Sites
- 🏠 Dept. Defense Sites



-  Indian Reservations BIA
-  Oil & Gas pipelines

-  Areas of Concern



SITE NAME: Warner Substation  
 ADDRESS: Hwy 79/SR 2  
 WARNER SPRINGS CA 92086  
 LAT/LONG: 33.2476 / 116.6751

CLIENT: Geotechnical Const. Inc.  
 CONTACT: Aurie Patterson  
 INQUIRY #: 2051958.2s  
 DATE: October 12, 2007 3:37 pm



## MAP FINDINGS SUMMARY

Database	Target Property	Search Distance (Miles)	< 1/8	1/8 - 1/4	1/4 - 1/2	1/2 - 1	> 1	Total Plotted
<b><u>FEDERAL RECORDS</u></b>								
NPL		1.000	0	0	0	0	NR	0
Proposed NPL		1.000	0	0	0	0	NR	0
Delisted NPL		1.000	0	0	0	0	NR	0
NPL LIENS	TP		NR	NR	NR	NR	NR	0
CERCLIS		0.500	0	0	0	NR	NR	0
CERC-NFRAP		0.500	0	0	0	NR	NR	0
CORRACTS		1.000	0	0	0	0	NR	0
RCRA TSD		0.500	0	0	0	NR	NR	0
RCRA Lg. Quan. Gen.		0.250	0	0	NR	NR	NR	0
RCRA Sm. Quan. Gen.		0.250	0	0	NR	NR	NR	0
ERNS	TP		NR	NR	NR	NR	NR	0
HMIRS	TP		NR	NR	NR	NR	NR	0
US ENG CONTROLS		0.500	0	0	0	NR	NR	0
US INST CONTROL		0.500	0	0	0	NR	NR	0
DOD		1.000	0	0	0	0	NR	0
FUDS		1.000	0	0	0	0	NR	0
US BROWNFIELDS		0.500	0	0	0	NR	NR	0
CONSENT		1.000	0	0	0	0	NR	0
ROD		1.000	0	0	0	0	NR	0
UMTRA		0.500	0	0	0	NR	NR	0
ODI		0.500	0	0	0	NR	NR	0
TRIS	TP		NR	NR	NR	NR	NR	0
TSCA	TP		NR	NR	NR	NR	NR	0
FTTS	TP		NR	NR	NR	NR	NR	0
SSTS	TP		NR	NR	NR	NR	NR	0
DOT OPS	TP		NR	NR	NR	NR	NR	0
DEBRIS REGION 9		0.500	0	0	0	NR	NR	0
ICIS	TP		NR	NR	NR	NR	NR	0
LUCIS		0.500	0	0	0	NR	NR	0
CDL	TP		NR	NR	NR	NR	NR	0
RADINFO	TP		NR	NR	NR	NR	NR	0
LIENS 2	TP		NR	NR	NR	NR	NR	0
HIST FTTS	TP		NR	NR	NR	NR	NR	0
PADS	TP		NR	NR	NR	NR	NR	0
MLTS	TP		NR	NR	NR	NR	NR	0
MINES		0.250	0	0	NR	NR	NR	0
FINDS	TP		NR	NR	NR	NR	NR	0
RAATS	TP		NR	NR	NR	NR	NR	0
<b><u>STATE AND LOCAL RECORDS</u></b>								
Hist Cal-Sites		1.000	0	0	0	0	NR	0
CA Bond Exp. Plan		1.000	0	0	0	0	NR	0
SCH		0.250	0	0	NR	NR	NR	0
Toxic Pits		1.000	0	0	0	0	NR	0
State Landfill		0.500	0	0	0	NR	NR	0
CA WDS	TP		NR	NR	NR	NR	NR	0
WMUDS/SWAT		0.500	0	0	0	NR	NR	0

## MAP FINDINGS SUMMARY

Database	Target Property	Search Distance (Miles)	< 1/8	1/8 - 1/4	1/4 - 1/2	1/2 - 1	> 1	Total Plotted
Cortese		0.500	0	0	0	NR	NR	0
SWRCY		0.500	0	0	0	NR	NR	0
LUST		0.500	0	0	0	NR	NR	0
CA FID UST		0.250	0	0	NR	NR	NR	0
SLIC		0.500	0	0	0	NR	NR	0
UST		0.250	0	0	NR	NR	NR	0
HIST UST		0.250	0	0	NR	NR	NR	0
AST		0.250	0	0	NR	NR	NR	0
LIENS		TP	NR	NR	NR	NR	NR	0
SWEEPS UST		0.250	0	0	NR	NR	NR	0
CHMIRS		TP	NR	NR	NR	NR	NR	0
Notify 65		1.000	0	0	0	0	NR	0
DEED		0.500	0	0	0	NR	NR	0
VCP		0.500	0	0	0	NR	NR	0
DRYCLEANERS		0.250	0	0	NR	NR	NR	0
WIP		0.250	0	0	NR	NR	NR	0
CDL		TP	NR	NR	NR	NR	NR	0
San Diego Co. HMMD		TP	NR	NR	NR	NR	NR	0
RESPONSE		1.000	0	0	0	0	NR	0
HAZNET		TP	NR	NR	NR	NR	NR	0
EMI		TP	NR	NR	NR	NR	NR	0
SAN DIEGO CO. SAM		0.500	0	0	0	NR	NR	0
HAULERS		TP	NR	NR	NR	NR	NR	0
ENVIROSTOR		1.000	0	0	0	0	NR	0
<b><u>TRIBAL RECORDS</u></b>								
INDIAN RESERV		1.000	0	0	0	0	NR	0
INDIAN LUST		0.500	0	0	0	NR	NR	0
INDIAN UST		0.250	0	0	NR	NR	NR	0
<b><u>EDR PROPRIETARY RECORDS</u></b>								
Manufactured Gas Plants		1.000	0	0	0	0	NR	0

**NOTES:**

TP = Target Property

NR = Not Requested at this Search Distance

Sites may be listed in more than one database

Map ID  
Direction  
Distance  
Distance (ft.)  
Elevation

MAP FINDINGS

Site

Database(s)

EDR ID Number  
EPA ID Number

NO SITES FOUND

ORPHAN SUMMARY

City	EDR ID	Site Name	Site Address	Zip	Database(s)
COUNTY	S104746077	WARNER SPRINGS RANCH	31652 HY 79	92086	LUST, San Diego Co. HMMD, EMI, SAN DIEGO CO. SAM
SAN DIEGO	S106933917	USN-NAS NI/FASO	SERE WARNER SPRINGS	92086	SWEEPS UST
SAN DIEGO CA	S103866786	S.E.R.E CAMP LANDFILL (SITE 1)	S.E.R.E. CAMP, WARNER SPRINGS	92086	WMUDS/SWAT
WARNER SPRING	S106071113	VERIZON WIRELESS - WARNER HOT	31652 SR-79	92086	San Diego Co. HMMD
WARNER SPRINGS	U001572518	WARNER SPRINGS	HIGHWAY 79 38 N/O WARNER SPRIN	92086	HIST UST
WARNER SPRINGS	S108224806	WARNER UNIFIED SCHOOL DISTRICT	30951 HIGHWAY 79	92086	HAZNET
WARNER SPRINGS	S106934229	WARNER SPRINGS	HIGHWAY 79	92086	SWEEPS UST
WARNER SPRINGS	S106915974	WARNER UNION SCHOOL DISTRICT	30951 HY 79	92086	LUST, SAN DIEGO CO. SAM
WARNER SPRINGS	S106063491	WARNER SPRINGS RANCH	31425 HWY 79	92086	San Diego Co. HMMD
WARNER SPRINGS	S106063070	WARNER SPRINGS AIRPORT	31930 HWY 79	92086	San Diego Co. HMMD
WARNER SPRINGS	S106061860	WARNER SPRINGS	HWY 79	92086	San Diego Co. HMMD
WARNER SPRINGS	S106060549	WARNER UNION SCHOOL DISTRICT	30951 HWY 79	92086	San Diego Co. HMMD
WARNER SPRINGS	S106060458	WARNER SPRINGS RANCH SERV STN	31652 HWY 79	92086	San Diego Co. HMMD
WARNER SPRINGS	S102434866	PACIFIC BELL AT WARNER SPRINGS	HWY 79	92086	LUST, Cortese
WARNER SPRINGS	1008290276	WARNER HIGH	30951 HWY. 79	92086	FINDS
WARNER SPRINGS	1008263729	WARNER ELEMENTARY	30951 HWY. 79	92086	FINDS
WARNER SPRINGS	S105155648	SERE CAMP	HWY 79		SWF/LF
WARNER SPRINGS	S108407169	PACIFIC BELL WNSPCA12/DB186	HY 79	92086	SAN DIEGO CO. SAM
WARNER SPRINGS	S106934398	WESTFORK HONOR CAMP - STATION	HWY 79 5 MI NORH WAR	92086	SWEEPS UST
WARNER SPRINGS	A100176447	OAK GROVE STATION	37560 HWY. 79	92086	AST
WARNER SPRINGS	U001572521	WESTFORK HONOR CAMP - STATION	HIGHWAY 79, 5 MILE NORTH - WAR	92086	HIST UST
WARNER SPRINGS	S108657809	SUNSHINE SUMMIT BURN SITE	35000 BLOCK OF HWY 79, S.SUNSHINE SUMMIT		SWF/LF
WARNER SPRINGS	S106934230	WARNER SPRINGS RADIO RELAY	CHIHUAHUA VALLEY RD	92086	SWEEPS UST
WARNER SPRINGS	S101613497	MAY BE WARNER SPRINGS	1 MILE S SUNSHINE SUMMIT, SW O		WMUDS/SWAT
WARNER SPRINGS	S105255794	S.E.R.E. CAMP WARNER SPRINGS	7 MILES NW OF WARNER SPRINGS		CA WDS
WARNER SPRINGS	U001572516	SURVIVAL EVASION RESISTANCE &	U.S. NAVY	92086	HIST UST
WARNER SPRINGS	S103442745	OAK GROVE-WARNER SPRINGS DISPO	NEAR HWY 79, 7 ML N OF WARNER		WMUDS/SWAT
WARNER SPRINGS	S103442746	LAKE HENSHAW RESORT	1/2 MI NORTH OF RESORT		SWF/LF, WMUDS/SWAT
WARNER SPRINGS	S105027299	SERE CAMP, WARNER SPRINGS	N. OF RTE. 79 ON LOST VAL	92086	Cortese
WARNER SPRINGS	S101272850	SERE CAMP, WARNER SPRINGS	NORTH OF RTE. 79 ON LOST VALLEY RD.	92086	ENVIROSTOR
WARNER SPRINGS	1007469380	OAK GROVE / WARNER SPRINGS	OFF HWY 79	92086	FINDS
WARNER SPRINGS	1007469379	WARNER SPRINGS RANCH	OFF HWY 79	92086	FINDS
WARNER SPRINGS	S106932667	SUMMET CENTER	SMT CT HWY 79	92086	SWEEPS UST
WARNER SPRINGS	1010082281	SURVIVAL, EVASION, RESISTANCE, AND ESCAPE CAMP, WARNER SPRIN	WARNER SPRINGS	92086	CERCLIS
WARNER SPRINGS	1010014592	SURVIVAL, EVASION, RESISTANCE, AND ESCAPE CAMP, WARNER SPRIN	WARNER SPRINGS	92086	FINDS
WARNER SPRINGS	S106930386	PACIFIC BELL WNSPCA12/DB186	WARNER SPRINGS RESOR	92086	SWEEPS UST
WARNER SPRINGS	1000250515	PACIFIC BELL	WARNER SPRINGS RESORT	92086	RCRA-SQG, FINDS, HAZNET

# GOVERNMENT RECORDS SEARCHED / DATA CURRENCY TRACKING

To maintain currency of the following federal and state databases, EDR contacts the appropriate governmental agency on a monthly or quarterly basis, as required.

**Number of Days to Update:** Provides confirmation that EDR is reporting records that have been updated within 90 days from the date the government agency made the information available to the public.

## **FEDERAL RECORDS**

### **NPL: National Priority List**

National Priorities List (Superfund). The NPL is a subset of CERCLIS and identifies over 1,200 sites for priority cleanup under the Superfund Program. NPL sites may encompass relatively large areas. As such, EDR provides polygon coverage for over 1,000 NPL site boundaries produced by EPA's Environmental Photographic Interpretation Center (EPIC) and regional EPA offices.

Date of Government Version: 07/18/2007	Source: EPA
Date Data Arrived at EDR: 08/03/2007	Telephone: N/A
Date Made Active in Reports: 08/29/2007	Last EDR Contact: 07/31/2007
Number of Days to Update: 26	Next Scheduled EDR Contact: 10/29/2007
	Data Release Frequency: Quarterly

### **NPL Site Boundaries**

Sources:

EPA's Environmental Photographic Interpretation Center (EPIC)  
Telephone: 202-564-7333

EPA Region 1  
Telephone 617-918-1143

EPA Region 6  
Telephone: 214-655-6659

EPA Region 3  
Telephone 215-814-5418

EPA Region 7  
Telephone: 913-551-7247

EPA Region 4  
Telephone 404-562-8033

EPA Region 8  
Telephone: 303-312-6774

EPA Region 5  
Telephone 312-886-6686

EPA Region 9  
Telephone: 415-947-4246

EPA Region 10  
Telephone 206-553-8665

### **Proposed NPL: Proposed National Priority List Sites**

A site that has been proposed for listing on the National Priorities List through the issuance of a proposed rule in the Federal Register. EPA then accepts public comments on the site, responds to the comments, and places on the NPL those sites that continue to meet the requirements for listing.

Date of Government Version: 08/09/2007	Source: EPA
Date Data Arrived at EDR: 09/05/2007	Telephone: N/A
Date Made Active in Reports: 10/11/2007	Last EDR Contact: 08/31/2007
Number of Days to Update: 36	Next Scheduled EDR Contact: 10/29/2007
	Data Release Frequency: Quarterly

### **DELISTED NPL: National Priority List Deletions**

The National Oil and Hazardous Substances Pollution Contingency Plan (NCP) establishes the criteria that the EPA uses to delete sites from the NPL. In accordance with 40 CFR 300.425.(e), sites may be deleted from the NPL where no further response is appropriate.

Date of Government Version: 08/27/2007	Source: EPA
Date Data Arrived at EDR: 08/29/2007	Telephone: N/A
Date Made Active in Reports: 10/11/2007	Last EDR Contact: 08/29/2007
Number of Days to Update: 43	Next Scheduled EDR Contact: 10/29/2007
	Data Release Frequency: Quarterly

# GOVERNMENT RECORDS SEARCHED / DATA CURRENCY TRACKING

## **NPL LIENS:** Federal Superfund Liens

Federal Superfund Liens. Under the authority granted the USEPA by CERCLA of 1980, the USEPA has the authority to file liens against real property in order to recover remedial action expenditures or when the property owner received notification of potential liability. USEPA compiles a listing of filed notices of Superfund Liens.

Date of Government Version: 10/15/1991	Source: EPA
Date Data Arrived at EDR: 02/02/1994	Telephone: 202-564-4267
Date Made Active in Reports: 03/30/1994	Last EDR Contact: 08/20/2007
Number of Days to Update: 56	Next Scheduled EDR Contact: 11/19/2007
	Data Release Frequency: No Update Planned

## **CERCLIS:** Comprehensive Environmental Response, Compensation, and Liability Information System

CERCLIS contains data on potentially hazardous waste sites that have been reported to the USEPA by states, municipalities, private companies and private persons, pursuant to Section 103 of the Comprehensive Environmental Response, Compensation, and Liability Act (CERCLA). CERCLIS contains sites which are either proposed to or on the National Priorities List (NPL) and sites which are in the screening and assessment phase for possible inclusion on the NPL.

Date of Government Version: 04/23/2007	Source: EPA
Date Data Arrived at EDR: 06/20/2007	Telephone: 703-412-9810
Date Made Active in Reports: 08/29/2007	Last EDR Contact: 09/19/2007
Number of Days to Update: 70	Next Scheduled EDR Contact: 12/17/2007
	Data Release Frequency: Quarterly

## **CERCLIS-NFRAP:** CERCLIS No Further Remedial Action Planned

Archived sites are sites that have been removed and archived from the inventory of CERCLIS sites. Archived status indicates that, to the best of EPA's knowledge, assessment at a site has been completed and that EPA has determined no further steps will be taken to list this site on the National Priorities List (NPL), unless information indicates this decision was not appropriate or other considerations require a recommendation for listing at a later time. This decision does not necessarily mean that there is no hazard associated with a given site; it only means that, based upon available information, the location is not judged to be a potential NPL site.

Date of Government Version: 06/21/2007	Source: EPA
Date Data Arrived at EDR: 07/23/2007	Telephone: 703-412-9810
Date Made Active in Reports: 08/29/2007	Last EDR Contact: 09/17/2007
Number of Days to Update: 37	Next Scheduled EDR Contact: 12/17/2007
	Data Release Frequency: Quarterly

## **CORRACTS:** Corrective Action Report

CORRACTS identifies hazardous waste handlers with RCRA corrective action activity.

Date of Government Version: 06/26/2007	Source: EPA
Date Data Arrived at EDR: 08/08/2007	Telephone: 800-424-9346
Date Made Active in Reports: 08/29/2007	Last EDR Contact: 09/04/2007
Number of Days to Update: 21	Next Scheduled EDR Contact: 12/03/2007
	Data Release Frequency: Quarterly

## **RCRA:** Resource Conservation and Recovery Act Information

## GOVERNMENT RECORDS SEARCHED / DATA CURRENCY TRACKING

RCRAInfo is EPA's comprehensive information system, providing access to data supporting the Resource Conservation and Recovery Act (RCRA) of 1976 and the Hazardous and Solid Waste Amendments (HSWA) of 1984. RCRAInfo replaces the data recording and reporting abilities of the Resource Conservation and Recovery Information System (RCRIS). The database includes selective information on sites which generate, transport, store, treat and/or dispose of hazardous waste as defined by the Resource Conservation and Recovery Act (RCRA). Conditionally exempt small quantity generators (CESQGs) generate less than 100 kg of hazardous waste, or less than 1 kg of acutely hazardous waste per month. Small quantity generators (SQGs) generate between 100 kg and 1,000 kg of hazardous waste per month. Large quantity generators (LQGs) generate over 1,000 kilograms (kg) of hazardous waste, or over 1 kg of acutely hazardous waste per month. Transporters are individuals or entities that move hazardous waste from the generator off-site to a facility that can recycle, treat, store, or dispose of the waste. TSDFs treat, store, or dispose of the waste.

Date of Government Version: 06/13/2006	Source: EPA
Date Data Arrived at EDR: 06/28/2006	Telephone: (415) 495-8895
Date Made Active in Reports: 08/23/2006	Last EDR Contact: 09/04/2007
Number of Days to Update: 56	Next Scheduled EDR Contact: 10/15/2007
	Data Release Frequency: Quarterly

### **ERNS:** Emergency Response Notification System

Emergency Response Notification System. ERNS records and stores information on reported releases of oil and hazardous substances.

Date of Government Version: 12/31/2006	Source: National Response Center, United States Coast Guard
Date Data Arrived at EDR: 01/24/2007	Telephone: 202-267-2180
Date Made Active in Reports: 03/12/2007	Last EDR Contact: 07/23/2007
Number of Days to Update: 47	Next Scheduled EDR Contact: 10/22/2007
	Data Release Frequency: Annually

### **HMIRS:** Hazardous Materials Information Reporting System

Hazardous Materials Incident Report System. HMIRS contains hazardous material spill incidents reported to DOT.

Date of Government Version: 07/02/2007	Source: U.S. Department of Transportation
Date Data Arrived at EDR: 07/18/2007	Telephone: 202-366-4555
Date Made Active in Reports: 09/18/2007	Last EDR Contact: 07/18/2007
Number of Days to Update: 62	Next Scheduled EDR Contact: 10/15/2007
	Data Release Frequency: Annually

### **US ENG CONTROLS:** Engineering Controls Sites List

A listing of sites with engineering controls in place. Engineering controls include various forms of caps, building foundations, liners, and treatment methods to create pathway elimination for regulated substances to enter environmental media or effect human health.

Date of Government Version: 07/16/2007	Source: Environmental Protection Agency
Date Data Arrived at EDR: 08/03/2007	Telephone: 703-603-8905
Date Made Active in Reports: 10/11/2007	Last EDR Contact: 10/01/2007
Number of Days to Update: 69	Next Scheduled EDR Contact: 12/31/2007
	Data Release Frequency: Varies

### **US INST CONTROL:** Sites with Institutional Controls

A listing of sites with institutional controls in place. Institutional controls include administrative measures, such as groundwater use restrictions, construction restrictions, property use restrictions, and post remediation care requirements intended to prevent exposure to contaminants remaining on site. Deed restrictions are generally required as part of the institutional controls.

Date of Government Version: 07/16/2007	Source: Environmental Protection Agency
Date Data Arrived at EDR: 08/03/2007	Telephone: 703-603-8905
Date Made Active in Reports: 10/11/2007	Last EDR Contact: 10/01/2007
Number of Days to Update: 69	Next Scheduled EDR Contact: 12/31/2007
	Data Release Frequency: Varies

# GOVERNMENT RECORDS SEARCHED / DATA CURRENCY TRACKING

## **DOD:** Department of Defense Sites

This data set consists of federally owned or administered lands, administered by the Department of Defense, that have any area equal to or greater than 640 acres of the United States, Puerto Rico, and the U.S. Virgin Islands.

Date of Government Version: 12/31/2005	Source: USGS
Date Data Arrived at EDR: 11/10/2006	Telephone: 703-692-8801
Date Made Active in Reports: 01/11/2007	Last EDR Contact: 08/09/2007
Number of Days to Update: 62	Next Scheduled EDR Contact: 11/05/2007
	Data Release Frequency: Semi-Annually

## **FUDS:** Formerly Used Defense Sites

The listing includes locations of Formerly Used Defense Sites properties where the US Army Corps of Engineers is actively working or will take necessary cleanup actions.

Date of Government Version: 12/31/2006	Source: U.S. Army Corps of Engineers
Date Data Arrived at EDR: 08/31/2007	Telephone: 202-528-4285
Date Made Active in Reports: 10/11/2007	Last EDR Contact: 10/01/2007
Number of Days to Update: 41	Next Scheduled EDR Contact: 12/31/2007
	Data Release Frequency: Varies

## **US BROWNFIELDS:** A Listing of Brownfields Sites

Included in the listing are brownfields properties addresses by Cooperative Agreement Recipients and brownfields properties addressed by Targeted Brownfields Assessments. Targeted Brownfields Assessments-EPA's Targeted Brownfields Assessments (TBA) program is designed to help states, tribes, and municipalities--especially those without EPA Brownfields Assessment Demonstration Pilots--minimize the uncertainties of contamination often associated with brownfields. Under the TBA program, EPA provides funding and/or technical assistance for environmental assessments at brownfields sites throughout the country. Targeted Brownfields Assessments supplement and work with other efforts under EPA's Brownfields Initiative to promote cleanup and redevelopment of brownfields. Cooperative Agreement Recipients--States, political subdivisions, territories, and Indian tribes become Brownfields Cleanup Revolving Loan Fund (BCRLF) cooperative agreement recipients when they enter into BCRLF cooperative agreements with the U.S. EPA. EPA selects BCRLF cooperative agreement recipients based on a proposal and application process. BCRLF cooperative agreement recipients must use EPA funds provided through BCRLF cooperative agreement for specified brownfields-related cleanup activities.

Date of Government Version: 06/20/2007	Source: Environmental Protection Agency
Date Data Arrived at EDR: 07/09/2007	Telephone: 202-566-2777
Date Made Active in Reports: 08/29/2007	Last EDR Contact: 09/10/2007
Number of Days to Update: 51	Next Scheduled EDR Contact: 12/10/2007
	Data Release Frequency: Semi-Annually

## **CONSENT:** Superfund (CERCLA) Consent Decrees

Major legal settlements that establish responsibility and standards for cleanup at NPL (Superfund) sites. Released periodically by United States District Courts after settlement by parties to litigation matters.

Date of Government Version: 04/13/2007	Source: Department of Justice, Consent Decree Library
Date Data Arrived at EDR: 07/16/2007	Telephone: Varies
Date Made Active in Reports: 08/29/2007	Last EDR Contact: 08/23/2007
Number of Days to Update: 44	Next Scheduled EDR Contact: 10/22/2007
	Data Release Frequency: Varies

## **ROD:** Records Of Decision

Record of Decision. ROD documents mandate a permanent remedy at an NPL (Superfund) site containing technical and health information to aid in the cleanup.

Date of Government Version: 06/08/2007	Source: EPA
Date Data Arrived at EDR: 07/03/2007	Telephone: 703-416-0223
Date Made Active in Reports: 08/29/2007	Last EDR Contact: 10/01/2007
Number of Days to Update: 57	Next Scheduled EDR Contact: 12/31/2007
	Data Release Frequency: Annually



# GOVERNMENT RECORDS SEARCHED / DATA CURRENCY TRACKING

## **UMTRA:** Uranium Mill Tailings Sites

Uranium ore was mined by private companies for federal government use in national defense programs. When the mills shut down, large piles of the sand-like material (mill tailings) remain after uranium has been extracted from the ore. Levels of human exposure to radioactive materials from the piles are low; however, in some cases tailings were used as construction materials before the potential health hazards of the tailings were recognized.

Date of Government Version: 12/31/2005	Source: Department of Energy
Date Data Arrived at EDR: 11/08/2006	Telephone: 505-845-0011
Date Made Active in Reports: 01/29/2007	Last EDR Contact: 09/19/2007
Number of Days to Update: 82	Next Scheduled EDR Contact: 12/17/2007
	Data Release Frequency: Varies

## **ODI:** Open Dump Inventory

An open dump is defined as a disposal facility that does not comply with one or more of the Part 257 or Part 258 Subtitle D Criteria.

Date of Government Version: 06/30/1985	Source: Environmental Protection Agency
Date Data Arrived at EDR: 08/09/2004	Telephone: 800-424-9346
Date Made Active in Reports: 09/17/2004	Last EDR Contact: 06/09/2004
Number of Days to Update: 39	Next Scheduled EDR Contact: N/A
	Data Release Frequency: No Update Planned

## **TRIS:** Toxic Chemical Release Inventory System

Toxic Release Inventory System. TRIS identifies facilities which release toxic chemicals to the air, water and land in reportable quantities under SARA Title III Section 313.

Date of Government Version: 12/31/2005	Source: EPA
Date Data Arrived at EDR: 04/27/2007	Telephone: 202-566-0250
Date Made Active in Reports: 07/05/2007	Last EDR Contact: 09/18/2007
Number of Days to Update: 69	Next Scheduled EDR Contact: 12/17/2007
	Data Release Frequency: Annually

## **TSCA:** Toxic Substances Control Act

Toxic Substances Control Act. TSCA identifies manufacturers and importers of chemical substances included on the TSCA Chemical Substance Inventory list. It includes data on the production volume of these substances by plant site.

Date of Government Version: 12/31/2002	Source: EPA
Date Data Arrived at EDR: 04/14/2006	Telephone: 202-260-5521
Date Made Active in Reports: 05/30/2006	Last EDR Contact: 07/30/2007
Number of Days to Update: 46	Next Scheduled EDR Contact: 10/15/2007
	Data Release Frequency: Every 4 Years

## **FTTS:** FIFRA/ TSCA Tracking System - FIFRA (Federal Insecticide, Fungicide, & Rodenticide Act)/TSCA (Toxic Substances Control Act)

FTTS tracks administrative cases and pesticide enforcement actions and compliance activities related to FIFRA, TSCA and EPCRA (Emergency Planning and Community Right-to-Know Act). To maintain currency, EDR contacts the Agency on a quarterly basis.

Date of Government Version: 07/06/2007	Source: EPA/Office of Prevention, Pesticides and Toxic Substances
Date Data Arrived at EDR: 07/20/2007	Telephone: 202-566-1667
Date Made Active in Reports: 09/18/2007	Last EDR Contact: 09/17/2007
Number of Days to Update: 60	Next Scheduled EDR Contact: 12/17/2007
	Data Release Frequency: Quarterly

## **FTTS INSP:** FIFRA/ TSCA Tracking System - FIFRA (Federal Insecticide, Fungicide, & Rodenticide Act)/TSCA (Toxic Substances Control Act) A listing of FIFRA/TSCA Tracking System (FTTS) inspections and enforcements.

Date of Government Version: 07/06/2007	Source: EPA
Date Data Arrived at EDR: 07/20/2007	Telephone: 202-566-1667
Date Made Active in Reports: 09/18/2007	Last EDR Contact: 09/17/2007
Number of Days to Update: 60	Next Scheduled EDR Contact: 12/17/2007
	Data Release Frequency: Quarterly

# GOVERNMENT RECORDS SEARCHED / DATA CURRENCY TRACKING

## **SSTS:** Section 7 Tracking Systems

Section 7 of the Federal Insecticide, Fungicide and Rodenticide Act, as amended (92 Stat. 829) requires all registered pesticide-producing establishments to submit a report to the Environmental Protection Agency by March 1st each year. Each establishment must report the types and amounts of pesticides, active ingredients and devices being produced, and those having been produced and sold or distributed in the past year.

Date of Government Version: 12/31/2005	Source: EPA
Date Data Arrived at EDR: 03/13/2007	Telephone: 202-564-4203
Date Made Active in Reports: 04/27/2007	Last EDR Contact: 07/16/2007
Number of Days to Update: 45	Next Scheduled EDR Contact: 10/15/2007
	Data Release Frequency: Annually

## **LUCIS:** Land Use Control Information System

LUCIS contains records of land use control information pertaining to the former Navy Base Realignment and Closure properties.

Date of Government Version: 12/09/2005	Source: Department of the Navy
Date Data Arrived at EDR: 12/11/2006	Telephone: 843-820-7326
Date Made Active in Reports: 01/11/2007	Last EDR Contact: 09/12/2007
Number of Days to Update: 31	Next Scheduled EDR Contact: 12/10/2007
	Data Release Frequency: Varies

## **DOT OPS:** Incident and Accident Data

Department of Transportation, Office of Pipeline Safety Incident and Accident data.

Date of Government Version: 08/14/2007	Source: Department of Transportation, Office of Pipeline Safety
Date Data Arrived at EDR: 08/29/2007	Telephone: 202-366-4595
Date Made Active in Reports: 10/11/2007	Last EDR Contact: 08/29/2007
Number of Days to Update: 43	Next Scheduled EDR Contact: 11/26/2007
	Data Release Frequency: Varies

## **ICIS:** Integrated Compliance Information System

The Integrated Compliance Information System (ICIS) supports the information needs of the national enforcement and compliance program as well as the unique needs of the National Pollutant Discharge Elimination System (NPDES) program.

Date of Government Version: 07/27/2007	Source: Environmental Protection Agency
Date Data Arrived at EDR: 08/13/2007	Telephone: 202-564-5088
Date Made Active in Reports: 10/11/2007	Last EDR Contact: 06/22/2007
Number of Days to Update: 59	Next Scheduled EDR Contact: 07/16/2007
	Data Release Frequency: Quarterly

## **DEBRIS REGION 9:** Torres Martinez Reservation Illegal Dump Site Locations

A listing of illegal dump sites location on the Torres Martinez Indian Reservation located in eastern Riverside County and northern Imperial County, California.

Date of Government Version: 07/25/2007	Source: EPA, Region 9
Date Data Arrived at EDR: 07/31/2007	Telephone: 415-972-3336
Date Made Active in Reports: 10/11/2007	Last EDR Contact: 09/24/2007
Number of Days to Update: 72	Next Scheduled EDR Contact: 12/24/2007
	Data Release Frequency: Varies

## **HIST FTTS:** FIFRA/TSCA Tracking System Administrative Case Listing

A complete administrative case listing from the FIFRA/TSCA Tracking System (FTTS) for all ten EPA regions. The information was obtained from the National Compliance Database (NCDB). NCDB supports the implementation of FIFRA (Federal Insecticide, Fungicide, and Rodenticide Act) and TSCA (Toxic Substances Control Act). Some EPA regions are now closing out records. Because of that, and the fact that some EPA regions are not providing EPA Headquarters with updated records, it was decided to create a HIST FTTS database. It included records that may not be included in the newer FTTS database updates. This database is no longer updated.

# GOVERNMENT RECORDS SEARCHED / DATA CURRENCY TRACKING

Date of Government Version: 10/19/2006  
Date Data Arrived at EDR: 03/01/2007  
Date Made Active in Reports: 04/10/2007  
Number of Days to Update: 40

Source: Environmental Protection Agency  
Telephone: 202-564-2501  
Last EDR Contact: 09/17/2007  
Next Scheduled EDR Contact: 12/17/2007  
Data Release Frequency: No Update Planned

## **CDL:** Clandestine Drug Labs

A listing of clandestine drug lab locations. The U.S. Department of Justice ("the Department") provides this web site as a public service. It contains addresses of some locations where law enforcement agencies reported they found chemicals or other items that indicated the presence of either clandestine drug laboratories or dumpsites. In most cases, the source of the entries is not the Department, and the Department has not verified the entry and does not guarantee its accuracy. Members of the public must verify the accuracy of all entries by, for example, contacting local law enforcement and local health departments.

Date of Government Version: 12/01/2006  
Date Data Arrived at EDR: 01/08/2007  
Date Made Active in Reports: 01/11/2007  
Number of Days to Update: 3

Source: Drug Enforcement Administration  
Telephone: 202-307-1000  
Last EDR Contact: 10/02/2007  
Next Scheduled EDR Contact: 12/24/2007  
Data Release Frequency: Quarterly

## **RADINFO:** Radiation Information Database

The Radiation Information Database (RADINFO) contains information about facilities that are regulated by U.S. Environmental Protection Agency (EPA) regulations for radiation and radioactivity.

Date of Government Version: 07/31/2007  
Date Data Arrived at EDR: 08/01/2007  
Date Made Active in Reports: 08/29/2007  
Number of Days to Update: 28

Source: Environmental Protection Agency  
Telephone: 202-343-9775  
Last EDR Contact: 08/01/2007  
Next Scheduled EDR Contact: 10/29/2007  
Data Release Frequency: Quarterly

## **LIENS 2:** CERCLA Lien Information

A Federal CERCLA ('Superfund') lien can exist by operation of law at any site or property at which EPA has spent Superfund monies. These monies are spent to investigate and address releases and threatened releases of contamination. CERCLIS provides information as to the identity of these sites and properties.

Date of Government Version: 03/08/2007  
Date Data Arrived at EDR: 04/12/2007  
Date Made Active in Reports: 05/14/2007  
Number of Days to Update: 32

Source: Environmental Protection Agency  
Telephone: 202-564-6023  
Last EDR Contact: 08/20/2007  
Next Scheduled EDR Contact: 11/19/2007  
Data Release Frequency: Varies

## **PADS:** PCB Activity Database System

PCB Activity Database. PADS Identifies generators, transporters, commercial storers and/or brokers and disposers of PCB's who are required to notify the EPA of such activities.

Date of Government Version: 04/12/2007  
Date Data Arrived at EDR: 06/08/2007  
Date Made Active in Reports: 08/29/2007  
Number of Days to Update: 32

Source: EPA  
Telephone: 202-566-0500  
Last EDR Contact: 08/09/2007  
Next Scheduled EDR Contact: 11/05/2007  
Data Release Frequency: Annually

## **MLTS:** Material Licensing Tracking System

MLTS is maintained by the Nuclear Regulatory Commission and contains a list of approximately 8,100 sites which possess or use radioactive materials and which are subject to NRC licensing requirements. To maintain currency, EDR contacts the Agency on a quarterly basis.

Date of Government Version: 07/09/2007  
Date Data Arrived at EDR: 07/24/2007  
Date Made Active in Reports: 09/18/2007  
Number of Days to Update: 56

Source: Nuclear Regulatory Commission  
Telephone: 301-415-7169  
Last EDR Contact: 10/01/2007  
Next Scheduled EDR Contact: 12/31/2007  
Data Release Frequency: Quarterly

# GOVERNMENT RECORDS SEARCHED / DATA CURRENCY TRACKING

## **MINES:** Mines Master Index File

Contains all mine identification numbers issued for mines active or opened since 1971. The data also includes violation information.

Date of Government Version: 05/09/2007  
Date Data Arrived at EDR: 06/28/2007  
Date Made Active in Reports: 08/29/2007  
Number of Days to Update: 62

Source: Department of Labor, Mine Safety and Health Administration  
Telephone: 303-231-5959  
Last EDR Contact: 09/26/2007  
Next Scheduled EDR Contact: 12/24/2007  
Data Release Frequency: Semi-Annually

## **FINDS:** Facility Index System/Facility Registry System

Facility Index System. FINDS contains both facility information and 'pointers' to other sources that contain more detail. EDR includes the following FINDS databases in this report: PCS (Permit Compliance System), AIRS (Aerometric Information Retrieval System), DOCKET (Enforcement Docket used to manage and track information on civil judicial enforcement cases for all environmental statutes), FURS (Federal Underground Injection Control), C-DOCKET (Criminal Docket System used to track criminal enforcement actions for all environmental statutes), FFIS (Federal Facilities Information System), STATE (State Environmental Laws and Statutes), and PADS (PCB Activity Data System).

Date of Government Version: 07/19/2007  
Date Data Arrived at EDR: 07/25/2007  
Date Made Active in Reports: 09/18/2007  
Number of Days to Update: 55

Source: EPA  
Telephone: (415) 947-8000  
Last EDR Contact: 10/01/2007  
Next Scheduled EDR Contact: 12/31/2007  
Data Release Frequency: Quarterly

## **RAATS:** RCRA Administrative Action Tracking System

RCRA Administration Action Tracking System. RAATS contains records based on enforcement actions issued under RCRA pertaining to major violators and includes administrative and civil actions brought by the EPA. For administration actions after September 30, 1995, data entry in the RAATS database was discontinued. EPA will retain a copy of the database for historical records. It was necessary to terminate RAATS because a decrease in agency resources made it impossible to continue to update the information contained in the database.

Date of Government Version: 04/17/1995  
Date Data Arrived at EDR: 07/03/1995  
Date Made Active in Reports: 08/07/1995  
Number of Days to Update: 35

Source: EPA  
Telephone: 202-564-4104  
Last EDR Contact: 08/31/2007  
Next Scheduled EDR Contact: 12/03/2007  
Data Release Frequency: No Update Planned

## **BRS:** Biennial Reporting System

The Biennial Reporting System is a national system administered by the EPA that collects data on the generation and management of hazardous waste. BRS captures detailed data from two groups: Large Quantity Generators (LQG) and Treatment, Storage, and Disposal Facilities.

Date of Government Version: 12/31/2005  
Date Data Arrived at EDR: 03/06/2007  
Date Made Active in Reports: 04/13/2007  
Number of Days to Update: 38

Source: EPA/NTIS  
Telephone: 800-424-9346  
Last EDR Contact: 09/12/2007  
Next Scheduled EDR Contact: 12/10/2007  
Data Release Frequency: Biennially

## **USGS WATER WELLS:** National Water Information System (NWIS)

This database consists of well records in the United States. Available site descriptive information includes well location information (latitude and longitude, well depth, site use, water use, and aquifer).

Date of Government Version: 03/25/2005  
Date Data Arrived at EDR: 03/25/2005  
Date Made Active in Reports: N/A  
Number of Days to Update: 0

Source: USGS  
Telephone: N/A  
Last EDR Contact: 03/25/2005  
Next Scheduled EDR Contact: N/A  
Data Release Frequency: N/A

## **PWS:** Public Water System Data

This Safe Drinking Water Information System (SDWIS) file contains public water systems name and address, population served and the primary source of water

# GOVERNMENT RECORDS SEARCHED / DATA CURRENCY TRACKING

Date of Government Version: 02/24/2000  
Date Data Arrived at EDR: 04/27/2005  
Date Made Active in Reports: N/A  
Number of Days to Update: 0

Source: EPA  
Telephone: N/A  
Last EDR Contact: 08/20/2007  
Next Scheduled EDR Contact: 11/19/2007  
Data Release Frequency: N/A

## STATE AND LOCAL RECORDS

### **HIST CAL-SITES:** Calsites Database

The Calsites database contains potential or confirmed hazardous substance release properties. In 1996, California EPA reevaluated and significantly reduced the number of sites in the Calsites database. No longer updated by the state agency. It has been replaced by ENVIROSTOR.

Date of Government Version: 08/08/2005  
Date Data Arrived at EDR: 08/03/2006  
Date Made Active in Reports: 08/24/2006  
Number of Days to Update: 21

Source: Department of Toxic Substance Control  
Telephone: 916-323-3400  
Last EDR Contact: 08/27/2007  
Next Scheduled EDR Contact: 11/26/2007  
Data Release Frequency: No Update Planned

### **CA BOND EXP. PLAN:** Bond Expenditure Plan

Department of Health Services developed a site-specific expenditure plan as the basis for an appropriation of Hazardous Substance Cleanup Bond Act funds. It is not updated.

Date of Government Version: 01/01/1989  
Date Data Arrived at EDR: 07/27/1994  
Date Made Active in Reports: 08/02/1994  
Number of Days to Update: 6

Source: Department of Health Services  
Telephone: 916-255-2118  
Last EDR Contact: 05/31/1994  
Next Scheduled EDR Contact: N/A  
Data Release Frequency: No Update Planned

### **SCH:** School Property Evaluation Program

This category contains proposed and existing school sites that are being evaluated by DTSC for possible hazardous materials contamination. In some cases, these properties may be listed in the CalSites category depending on the level of threat to public health and safety or the environment they pose.

Date of Government Version: 08/28/2007  
Date Data Arrived at EDR: 08/29/2007  
Date Made Active in Reports: 09/26/2007  
Number of Days to Update: 28

Source: Department of Toxic Substances Control  
Telephone: 916-323-3400  
Last EDR Contact: 08/29/2007  
Next Scheduled EDR Contact: 11/26/2007  
Data Release Frequency: Quarterly

### **TOXIC PITS:** Toxic Pits Cleanup Act Sites

Toxic PITS Cleanup Act Sites. TOXIC PITS identifies sites suspected of containing hazardous substances where cleanup has not yet been completed.

Date of Government Version: 07/01/1995  
Date Data Arrived at EDR: 08/30/1995  
Date Made Active in Reports: 09/26/1995  
Number of Days to Update: 27

Source: State Water Resources Control Board  
Telephone: 916-227-4364  
Last EDR Contact: 07/30/2007  
Next Scheduled EDR Contact: 10/29/2007  
Data Release Frequency: No Update Planned

### **SWF/LF (SWIS):** Solid Waste Information System

Active, Closed and Inactive Landfills. SWF/LF records typically contain an inventory of solid waste disposal facilities or landfills. These may be active or inactive facilities or open dumps that failed to meet RCRA Section 4004 criteria for solid waste landfills or disposal sites.

Date of Government Version: 09/10/2007  
Date Data Arrived at EDR: 09/12/2007  
Date Made Active in Reports: 09/28/2007  
Number of Days to Update: 16

Source: Integrated Waste Management Board  
Telephone: 916-341-6320  
Last EDR Contact: 09/12/2007  
Next Scheduled EDR Contact: 12/10/2007  
Data Release Frequency: Quarterly

# GOVERNMENT RECORDS SEARCHED / DATA CURRENCY TRACKING

## **WMUDS/SWAT:** Waste Management Unit Database

Waste Management Unit Database System. WMUDS is used by the State Water Resources Control Board staff and the Regional Water Quality Control Boards for program tracking and inventory of waste management units. WMUDS is composed of the following databases: Facility Information, Scheduled Inspections Information, Waste Management Unit Information, SWAT Program Information, SWAT Report Summary Information, SWAT Report Summary Data, Chapter 15 (formerly Subchapter 15) Information, Chapter 15 Monitoring Parameters, TPCA Program Information, RCRA Program Information, Closure Information, and Interested Parties Information.

Date of Government Version: 04/01/2000	Source: State Water Resources Control Board
Date Data Arrived at EDR: 04/10/2000	Telephone: 916-227-4448
Date Made Active in Reports: 05/10/2000	Last EDR Contact: 09/04/2007
Number of Days to Update: 30	Next Scheduled EDR Contact: 12/03/2007
	Data Release Frequency: Quarterly

## **CA WDS:** Waste Discharge System

Sites which have been issued waste discharge requirements.

Date of Government Version: 06/19/2007	Source: State Water Resources Control Board
Date Data Arrived at EDR: 06/20/2007	Telephone: 916-341-5227
Date Made Active in Reports: 06/29/2007	Last EDR Contact: 09/17/2007
Number of Days to Update: 9	Next Scheduled EDR Contact: 12/17/2007
	Data Release Frequency: Quarterly

## **CORTESE:** "Cortese" Hazardous Waste & Substances Sites List

The sites for the list are designated by the State Water Resource Control Board (LUST), the Integrated Waste Board (SWF/LS), and the Department of Toxic Substances Control (Cal-Sites). This listing is no longer updated by the state agency.

Date of Government Version: 04/01/2001	Source: CAL EPA/Office of Emergency Information
Date Data Arrived at EDR: 05/29/2001	Telephone: 916-323-3400
Date Made Active in Reports: 07/26/2001	Last EDR Contact: 07/23/2007
Number of Days to Update: 58	Next Scheduled EDR Contact: 10/22/2007
	Data Release Frequency: No Update Planned

## **SWRCY:** Recycler Database

A listing of recycling facilities in California.

Date of Government Version: 07/09/2007	Source: Department of Conservation
Date Data Arrived at EDR: 07/11/2007	Telephone: 916-323-3836
Date Made Active in Reports: 08/09/2007	Last EDR Contact: 10/11/2007
Number of Days to Update: 29	Next Scheduled EDR Contact: 01/07/2008
	Data Release Frequency: Quarterly

## **LUST REG 9:** Leaking Underground Storage Tank Report

Orange, Riverside, San Diego counties. For more current information, please refer to the State Water Resources Control Board's LUST database.

Date of Government Version: 03/01/2001	Source: California Regional Water Quality Control Board San Diego Region (9)
Date Data Arrived at EDR: 04/23/2001	Telephone: 858-637-5595
Date Made Active in Reports: 05/21/2001	Last EDR Contact: 07/16/2007
Number of Days to Update: 28	Next Scheduled EDR Contact: 10/15/2007
	Data Release Frequency: No Update Planned

## **LUST REG 8:** Leaking Underground Storage Tanks

California Regional Water Quality Control Board Santa Ana Region (8). For more current information, please refer to the State Water Resources Control Board's LUST database.

Date of Government Version: 02/14/2005	Source: California Regional Water Quality Control Board Santa Ana Region (8)
Date Data Arrived at EDR: 02/15/2005	Telephone: 909-782-4496
Date Made Active in Reports: 03/28/2005	Last EDR Contact: 08/06/2007
Number of Days to Update: 41	Next Scheduled EDR Contact: 11/05/2007
	Data Release Frequency: Varies

# GOVERNMENT RECORDS SEARCHED / DATA CURRENCY TRACKING

## **LUST REG 6V:** Leaking Underground Storage Tank Case Listing

Leaking Underground Storage Tank locations. Inyo, Kern, Los Angeles, Mono, San Bernardino counties.

Date of Government Version: 06/07/2005  
Date Data Arrived at EDR: 06/07/2005  
Date Made Active in Reports: 06/29/2005  
Number of Days to Update: 22

Source: California Regional Water Quality Control Board Victorville Branch Office (6)  
Telephone: 760-241-7365  
Last EDR Contact: 10/01/2007  
Next Scheduled EDR Contact: 12/31/2007  
Data Release Frequency: No Update Planned

## **LUST REG 6L:** Leaking Underground Storage Tank Case Listing

For more current information, please refer to the State Water Resources Control Board's LUST database.

Date of Government Version: 09/09/2003  
Date Data Arrived at EDR: 09/10/2003  
Date Made Active in Reports: 10/07/2003  
Number of Days to Update: 27

Source: California Regional Water Quality Control Board Lahontan Region (6)  
Telephone: 530-542-5572  
Last EDR Contact: 09/04/2007  
Next Scheduled EDR Contact: 12/03/2007  
Data Release Frequency: No Update Planned

## **LUST REG 5:** Leaking Underground Storage Tank Database

Leaking Underground Storage Tank locations. Alameda, Alpine, Amador, Butte, Colusa, Contra Costa, Calveras, El Dorado, Fresno, Glenn, Kern, Kings, Lake, Lassen, Madera, Mariposa, Merced, Modoc, Napa, Nevada, Placer, Plumas, Sacramento, San Joaquin, Shasta, Solano, Stanislaus, Sutter, Tehama, Tulare, Tuolumne, Yolo, Yuba counties.

Date of Government Version: 07/01/2007  
Date Data Arrived at EDR: 08/01/2007  
Date Made Active in Reports: 08/09/2007  
Number of Days to Update: 8

Source: California Regional Water Quality Control Board Central Valley Region (5)  
Telephone: 916-464-4834  
Last EDR Contact: 10/03/2007  
Next Scheduled EDR Contact: 12/31/2007  
Data Release Frequency: Quarterly

## **LUST REG 4:** Underground Storage Tank Leak List

Los Angeles, Ventura counties. For more current information, please refer to the State Water Resources Control Board's LUST database.

Date of Government Version: 09/07/2004  
Date Data Arrived at EDR: 09/07/2004  
Date Made Active in Reports: 10/12/2004  
Number of Days to Update: 35

Source: California Regional Water Quality Control Board Los Angeles Region (4)  
Telephone: 213-576-6710  
Last EDR Contact: 09/24/2007  
Next Scheduled EDR Contact: 12/24/2007  
Data Release Frequency: No Update Planned

## **LUST REG 3:** Leaking Underground Storage Tank Database

Leaking Underground Storage Tank locations. Monterey, San Benito, San Luis Obispo, Santa Barbara, Santa Cruz counties.

Date of Government Version: 05/19/2003  
Date Data Arrived at EDR: 05/19/2003  
Date Made Active in Reports: 06/02/2003  
Number of Days to Update: 14

Source: California Regional Water Quality Control Board Central Coast Region (3)  
Telephone: 805-542-4786  
Last EDR Contact: 08/13/2007  
Next Scheduled EDR Contact: 11/12/2007  
Data Release Frequency: No Update Planned

## **LUST REG 2:** Fuel Leak List

Leaking Underground Storage Tank locations. Alameda, Contra Costa, Marin, Napa, San Francisco, San Mateo, Santa Clara, Solano, Sonoma counties.

Date of Government Version: 09/30/2004  
Date Data Arrived at EDR: 10/20/2004  
Date Made Active in Reports: 11/19/2004  
Number of Days to Update: 30

Source: California Regional Water Quality Control Board San Francisco Bay Region (2)  
Telephone: 510-622-2433  
Last EDR Contact: 10/09/2007  
Next Scheduled EDR Contact: 01/07/2008  
Data Release Frequency: Quarterly

## **LUST REG 1:** Active Toxic Site Investigation

Del Norte, Humboldt, Lake, Mendocino, Modoc, Siskiyou, Sonoma, Trinity counties. For more current information, please refer to the State Water Resources Control Board's LUST database.

# GOVERNMENT RECORDS SEARCHED / DATA CURRENCY TRACKING

Date of Government Version: 02/01/2001  
Date Data Arrived at EDR: 02/28/2001  
Date Made Active in Reports: 03/29/2001  
Number of Days to Update: 29

Source: California Regional Water Quality Control Board North Coast (1)  
Telephone: 707-570-3769  
Last EDR Contact: 08/20/2007  
Next Scheduled EDR Contact: 11/19/2007  
Data Release Frequency: No Update Planned

## **LUST:** Geotracker's Leaking Underground Fuel Tank Report

Leaking Underground Storage Tank Incident Reports. LUST records contain an inventory of reported leaking underground storage tank incidents. Not all states maintain these records, and the information stored varies by state. For more information on a particular leaking underground storage tank sites, please contact the appropriate regulatory agency.

Date of Government Version: 07/10/2007  
Date Data Arrived at EDR: 07/11/2007  
Date Made Active in Reports: 08/09/2007  
Number of Days to Update: 29

Source: State Water Resources Control Board  
Telephone: see region list  
Last EDR Contact: 10/11/2007  
Next Scheduled EDR Contact: 01/07/2008  
Data Release Frequency: Quarterly

## **LUST REG 7:** Leaking Underground Storage Tank Case Listing

Leaking Underground Storage Tank locations. Imperial, Riverside, San Diego, Santa Barbara counties.

Date of Government Version: 02/26/2004  
Date Data Arrived at EDR: 02/26/2004  
Date Made Active in Reports: 03/24/2004  
Number of Days to Update: 27

Source: California Regional Water Quality Control Board Colorado River Basin Region (7)  
Telephone: 760-776-8943  
Last EDR Contact: 08/20/2007  
Next Scheduled EDR Contact: 11/19/2007  
Data Release Frequency: No Update Planned

## **CA FID UST:** Facility Inventory Database

The Facility Inventory Database (FID) contains a historical listing of active and inactive underground storage tank locations from the State Water Resource Control Board. Refer to local/county source for current data.

Date of Government Version: 10/31/1994  
Date Data Arrived at EDR: 09/05/1995  
Date Made Active in Reports: 09/29/1995  
Number of Days to Update: 24

Source: California Environmental Protection Agency  
Telephone: 916-341-5851  
Last EDR Contact: 12/28/1998  
Next Scheduled EDR Contact: N/A  
Data Release Frequency: No Update Planned

## **SLIC:** Statewide SLIC Cases

The SLIC (Spills, Leaks, Investigations and Cleanup) program is designed to protect and restore water quality from spills, leaks, and similar discharges.

Date of Government Version: 08/03/2007  
Date Data Arrived at EDR: 08/03/2007  
Date Made Active in Reports: 08/09/2007  
Number of Days to Update: 6

Source: State Water Resources Control Board  
Telephone: 866-480-1028  
Last EDR Contact: 10/11/2007  
Next Scheduled EDR Contact: 01/07/2008  
Data Release Frequency: Varies

## **SLIC REG 1:** Active Toxic Site Investigations

The SLIC (Spills, Leaks, Investigations and Cleanup) program is designed to protect and restore water quality from spills, leaks, and similar discharges.

Date of Government Version: 04/03/2003  
Date Data Arrived at EDR: 04/07/2003  
Date Made Active in Reports: 04/25/2003  
Number of Days to Update: 18

Source: California Regional Water Quality Control Board, North Coast Region (1)  
Telephone: 707-576-2220  
Last EDR Contact: 08/20/2007  
Next Scheduled EDR Contact: 11/19/2007  
Data Release Frequency: No Update Planned

## **SLIC REG 2:** Spills, Leaks, Investigation & Cleanup Cost Recovery Listing

The SLIC (Spills, Leaks, Investigations and Cleanup) program is designed to protect and restore water quality from spills, leaks, and similar discharges.



# GOVERNMENT RECORDS SEARCHED / DATA CURRENCY TRACKING

Date of Government Version: 09/30/2004  
Date Data Arrived at EDR: 10/20/2004  
Date Made Active in Reports: 11/19/2004  
Number of Days to Update: 30

Source: Regional Water Quality Control Board San Francisco Bay Region (2)  
Telephone: 510-286-0457  
Last EDR Contact: 10/09/2007  
Next Scheduled EDR Contact: 01/07/2008  
Data Release Frequency: Quarterly

## **SLIC REG 3:** Spills, Leaks, Investigation & Cleanup Cost Recovery Listing

The SLIC (Spills, Leaks, Investigations and Cleanup) program is designed to protect and restore water quality from spills, leaks, and similar discharges.

Date of Government Version: 05/18/2006  
Date Data Arrived at EDR: 05/18/2006  
Date Made Active in Reports: 06/15/2006  
Number of Days to Update: 28

Source: California Regional Water Quality Control Board Central Coast Region (3)  
Telephone: 805-549-3147  
Last EDR Contact: 08/13/2007  
Next Scheduled EDR Contact: 11/12/2007  
Data Release Frequency: Semi-Annually

## **SLIC REG 4:** Spills, Leaks, Investigation & Cleanup Cost Recovery Listing

The SLIC (Spills, Leaks, Investigations and Cleanup) program is designed to protect and restore water quality from spills, leaks, and similar discharges.

Date of Government Version: 11/17/2004  
Date Data Arrived at EDR: 11/18/2004  
Date Made Active in Reports: 01/04/2005  
Number of Days to Update: 47

Source: Region Water Quality Control Board Los Angeles Region (4)  
Telephone: 213-576-6600  
Last EDR Contact: 07/23/2007  
Next Scheduled EDR Contact: 10/22/2007  
Data Release Frequency: Varies

## **SLIC REG 5:** Spills, Leaks, Investigation & Cleanup Cost Recovery Listing

The SLIC (Spills, Leaks, Investigations and Cleanup) program is designed to protect and restore water quality from spills, leaks, and similar discharges.

Date of Government Version: 04/01/2005  
Date Data Arrived at EDR: 04/05/2005  
Date Made Active in Reports: 04/21/2005  
Number of Days to Update: 16

Source: Regional Water Quality Control Board Central Valley Region (5)  
Telephone: 916-464-3291  
Last EDR Contact: 10/01/2007  
Next Scheduled EDR Contact: 12/31/2007  
Data Release Frequency: Semi-Annually

## **SLIC REG 6V:** Spills, Leaks, Investigation & Cleanup Cost Recovery Listing

The SLIC (Spills, Leaks, Investigations and Cleanup) program is designed to protect and restore water quality from spills, leaks, and similar discharges.

Date of Government Version: 05/24/2005  
Date Data Arrived at EDR: 05/25/2005  
Date Made Active in Reports: 06/16/2005  
Number of Days to Update: 22

Source: Regional Water Quality Control Board, Victorville Branch  
Telephone: 619-241-6583  
Last EDR Contact: 10/01/2007  
Next Scheduled EDR Contact: 12/31/2007  
Data Release Frequency: Semi-Annually

## **SLIC REG 6L:** SLIC Sites

The SLIC (Spills, Leaks, Investigations and Cleanup) program is designed to protect and restore water quality from spills, leaks, and similar discharges.

Date of Government Version: 09/07/2004  
Date Data Arrived at EDR: 09/07/2004  
Date Made Active in Reports: 10/12/2004  
Number of Days to Update: 35

Source: California Regional Water Quality Control Board, Lahontan Region  
Telephone: 530-542-5574  
Last EDR Contact: 09/04/2007  
Next Scheduled EDR Contact: 12/03/2007  
Data Release Frequency: No Update Planned

## **SLIC REG 7:** SLIC List

The SLIC (Spills, Leaks, Investigations and Cleanup) program is designed to protect and restore water quality from spills, leaks, and similar discharges.

# GOVERNMENT RECORDS SEARCHED / DATA CURRENCY TRACKING

Date of Government Version: 11/24/2004  
Date Data Arrived at EDR: 11/29/2004  
Date Made Active in Reports: 01/04/2005  
Number of Days to Update: 36

Source: California Regional Quality Control Board, Colorado River Basin Region  
Telephone: 760-346-7491  
Last EDR Contact: 08/20/2007  
Next Scheduled EDR Contact: 11/19/2007  
Data Release Frequency: No Update Planned

## **SLIC REG 8:** Spills, Leaks, Investigation & Cleanup Cost Recovery Listing

The SLIC (Spills, Leaks, Investigations and Cleanup) program is designed to protect and restore water quality from spills, leaks, and similar discharges.

Date of Government Version: 07/17/2007  
Date Data Arrived at EDR: 07/18/2007  
Date Made Active in Reports: 08/09/2007  
Number of Days to Update: 22

Source: California Region Water Quality Control Board Santa Ana Region (8)  
Telephone: 951-782-3298  
Last EDR Contact: 10/01/2007  
Next Scheduled EDR Contact: 12/31/2007  
Data Release Frequency: Semi-Annually

## **SLIC REG 9:** Spills, Leaks, Investigation & Cleanup Cost Recovery Listing

The SLIC (Spills, Leaks, Investigations and Cleanup) program is designed to protect and restore water quality from spills, leaks, and similar discharges.

Date of Government Version: 09/10/2007  
Date Data Arrived at EDR: 09/11/2007  
Date Made Active in Reports: 09/28/2007  
Number of Days to Update: 17

Source: California Regional Water Quality Control Board San Diego Region (9)  
Telephone: 858-467-2980  
Last EDR Contact: 09/10/2007  
Next Scheduled EDR Contact: 11/26/2007  
Data Release Frequency: Annually

## **UST:** Active UST Facilities

Active UST facilities gathered from the local regulatory agencies

Date of Government Version: 07/10/2007  
Date Data Arrived at EDR: 07/11/2007  
Date Made Active in Reports: 07/25/2007  
Number of Days to Update: 14

Source: SWRCB  
Telephone: 916-480-1028  
Last EDR Contact: 10/11/2007  
Next Scheduled EDR Contact: 01/07/2008  
Data Release Frequency: Semi-Annually

## **UST MENDOCINO:** Mendocino County UST Database

A listing of underground storage tank locations in Mendocino County.

Date of Government Version: 06/25/2007  
Date Data Arrived at EDR: 06/26/2007  
Date Made Active in Reports: 07/25/2007  
Number of Days to Update: 29

Source: Department of Public Health  
Telephone: 707-463-4466  
Last EDR Contact: 09/24/2007  
Next Scheduled EDR Contact: 12/24/2007  
Data Release Frequency: Varies

## **HIST UST:** Hazardous Substance Storage Container Database

The Hazardous Substance Storage Container Database is a historical listing of UST sites. Refer to local/county source for current data.

Date of Government Version: 10/15/1990  
Date Data Arrived at EDR: 01/25/1991  
Date Made Active in Reports: 02/12/1991  
Number of Days to Update: 18

Source: State Water Resources Control Board  
Telephone: 916-341-5851  
Last EDR Contact: 07/26/2001  
Next Scheduled EDR Contact: N/A  
Data Release Frequency: No Update Planned

## **LIENS:** Environmental Liens Listing

A listing of property locations with environmental liens for California where DTSC is a lien holder.

Date of Government Version: 08/27/2007  
Date Data Arrived at EDR: 08/28/2007  
Date Made Active in Reports: 09/26/2007  
Number of Days to Update: 29

Source: Department of Toxic Substances Control  
Telephone: 916-323-3400  
Last EDR Contact: 08/20/2007  
Next Scheduled EDR Contact: 11/05/2007  
Data Release Frequency: Varies

# GOVERNMENT RECORDS SEARCHED / DATA CURRENCY TRACKING

**AST:** Aboveground Petroleum Storage Tank Facilities  
Registered Aboveground Storage Tanks.

Date of Government Version: 05/01/2007	Source: State Water Resources Control Board
Date Data Arrived at EDR: 05/01/2007	Telephone: 916-341-5712
Date Made Active in Reports: 05/25/2007	Last EDR Contact: 07/30/2007
Number of Days to Update: 24	Next Scheduled EDR Contact: 10/29/2007
	Data Release Frequency: Quarterly

**SWEEPS UST:** SWEEPS UST Listing

Statewide Environmental Evaluation and Planning System. This underground storage tank listing was updated and maintained by a company contacted by the SWRCB in the early 1980's. The listing is no longer updated or maintained. The local agency is the contact for more information on a site on the SWEEPS list.

Date of Government Version: 06/01/1994	Source: State Water Resources Control Board
Date Data Arrived at EDR: 07/07/2005	Telephone: N/A
Date Made Active in Reports: 08/11/2005	Last EDR Contact: 06/03/2005
Number of Days to Update: 35	Next Scheduled EDR Contact: N/A
	Data Release Frequency: No Update Planned

**CHMIRS:** California Hazardous Material Incident Report System

California Hazardous Material Incident Reporting System. CHMIRS contains information on reported hazardous material incidents (accidental releases or spills).

Date of Government Version: 12/31/2005	Source: Office of Emergency Services
Date Data Arrived at EDR: 02/23/2007	Telephone: 916-845-8400
Date Made Active in Reports: 04/06/2007	Last EDR Contact: 08/20/2007
Number of Days to Update: 42	Next Scheduled EDR Contact: 11/19/2007
	Data Release Frequency: Varies

**NOTIFY 65:** Proposition 65 Records

Proposition 65 Notification Records. NOTIFY 65 contains facility notifications about any release which could impact drinking water and thereby expose the public to a potential health risk.

Date of Government Version: 10/21/1993	Source: State Water Resources Control Board
Date Data Arrived at EDR: 11/01/1993	Telephone: 916-445-3846
Date Made Active in Reports: 11/19/1993	Last EDR Contact: 07/16/2007
Number of Days to Update: 18	Next Scheduled EDR Contact: 10/15/2007
	Data Release Frequency: No Update Planned

**DEED:** Deed Restriction Listing

Site Mitigation and Brownfields Reuse Program Facility Sites with Deed Restrictions & Hazardous Waste Management Program Facility Sites with Deed / Land Use Restriction. The DTSC Site Mitigation and Brownfields Reuse Program (SMBRP) list includes sites cleaned up under the program's oversight and generally does not include current or former hazardous waste facilities that required a hazardous waste facility permit. The list represents deed restrictions that are active. Some sites have multiple deed restrictions. The DTSC Hazardous Waste Management Program (HWMP) has developed a list of current or former hazardous waste facilities that have a recorded land use restriction at the local county recorder's office. The land use restrictions on this list were required by the DTSC HWMP as a result of the presence of hazardous substances that remain on site after the facility (or part of the facility) has been closed or cleaned up. The types of land use restriction include deed notice, deed restriction, or a land use restriction that binds current and future owners.

Date of Government Version: 07/02/2007	Source: Department of Toxic Substances Control
Date Data Arrived at EDR: 07/03/2007	Telephone: 916-323-3400
Date Made Active in Reports: 08/09/2007	Last EDR Contact: 10/03/2007
Number of Days to Update: 37	Next Scheduled EDR Contact: 12/31/2007
	Data Release Frequency: Semi-Annually

**VCP:** Voluntary Cleanup Program Properties

Contains low threat level properties with either confirmed or unconfirmed releases and the project proponents have request that DTSC oversee investigation and/or cleanup activities and have agreed to provide coverage for DTSC's costs.

# GOVERNMENT RECORDS SEARCHED / DATA CURRENCY TRACKING

Date of Government Version: 08/28/2007  
Date Data Arrived at EDR: 08/29/2007  
Date Made Active in Reports: 09/26/2007  
Number of Days to Update: 28

Source: Department of Toxic Substances Control  
Telephone: 916-323-3400  
Last EDR Contact: 08/29/2007  
Next Scheduled EDR Contact: 11/26/2007  
Data Release Frequency: Quarterly

## **DRYCLEANERS:** Cleaner Facilities

A list of drycleaner related facilities that have EPA ID numbers. These are facilities with certain SIC codes: power laundries, family and commercial; garment pressing and cleaner's agents; linen supply; coin-operated laundries and cleaning; drycleaning plants, except rugs; carpet and upholster cleaning; industrial launderers; laundry and garment services.

Date of Government Version: 07/31/2007  
Date Data Arrived at EDR: 07/31/2007  
Date Made Active in Reports: 08/09/2007  
Number of Days to Update: 9

Source: Department of Toxic Substance Control  
Telephone: 916-327-4498  
Last EDR Contact: 10/01/2007  
Next Scheduled EDR Contact: 12/31/2007  
Data Release Frequency: Annually

## **WIP:** Well Investigation Program Case List

Well Investigation Program case in the San Gabriel and San Fernando Valley area.

Date of Government Version: 03/01/2007  
Date Data Arrived at EDR: 03/13/2007  
Date Made Active in Reports: 04/06/2007  
Number of Days to Update: 24

Source: Los Angeles Water Quality Control Board  
Telephone: 213-576-6726  
Last EDR Contact: 07/27/2007  
Next Scheduled EDR Contact: 10/22/2007  
Data Release Frequency: Varies

## **CDL:** Clandestine Drug Labs

A listing of drug lab locations. Listing of a location in this database does not indicate that any illegal drug lab materials were or were not present there, and does not constitute a determination that the location either requires or does not require additional cleanup work.

Date of Government Version: 12/31/2006  
Date Data Arrived at EDR: 03/07/2007  
Date Made Active in Reports: 04/06/2007  
Number of Days to Update: 30

Source: Department of Toxic Substances Control  
Telephone: 916-255-6504  
Last EDR Contact: 09/04/2007  
Next Scheduled EDR Contact: 10/22/2007  
Data Release Frequency: Varies

## **RESPONSE:** State Response Sites

Identifies confirmed release sites where DTSC is involved in remediation, either in a lead or oversight capacity. These confirmed release sites are generally high-priority and high potential risk.

Date of Government Version: 08/28/2007  
Date Data Arrived at EDR: 08/29/2007  
Date Made Active in Reports: 09/26/2007  
Number of Days to Update: 28

Source: Department of Toxic Substances Control  
Telephone: 916-323-3400  
Last EDR Contact: 08/29/2007  
Next Scheduled EDR Contact: 11/26/2007  
Data Release Frequency: Quarterly

## **HAZNET:** Facility and Manifest Data

Facility and Manifest Data. The data is extracted from the copies of hazardous waste manifests received each year by the DTSC. The annual volume of manifests is typically 700,000 - 1,000,000 annually, representing approximately 350,000 - 500,000 shipments. Data are from the manifests submitted without correction, and therefore many contain some invalid values for data elements such as generator ID, TSD ID, waste category, and disposal method.

Date of Government Version: 12/31/2005  
Date Data Arrived at EDR: 11/20/2006  
Date Made Active in Reports: 01/03/2007  
Number of Days to Update: 44

Source: California Environmental Protection Agency  
Telephone: 916-255-1136  
Last EDR Contact: 10/04/2007  
Next Scheduled EDR Contact: 11/05/2007  
Data Release Frequency: Annually

# GOVERNMENT RECORDS SEARCHED / DATA CURRENCY TRACKING

## **EMI:** Emissions Inventory Data

Toxics and criteria pollutant emissions data collected by the ARB and local air pollution agencies.

Date of Government Version: 12/31/2005	Source: California Air Resources Board
Date Data Arrived at EDR: 04/17/2007	Telephone: 916-322-2990
Date Made Active in Reports: 05/10/2007	Last EDR Contact: 07/20/2007
Number of Days to Update: 23	Next Scheduled EDR Contact: 10/15/2007
	Data Release Frequency: Varies

## **HAULERS:** Registered Waste Tire Haulers Listing

A listing of registered waste tire haulers.

Date of Government Version: 09/17/2007	Source: Integrated Waste Management Board
Date Data Arrived at EDR: 09/18/2007	Telephone: 916-341-6422
Date Made Active in Reports: 09/28/2007	Last EDR Contact: 09/10/2007
Number of Days to Update: 10	Next Scheduled EDR Contact: 12/10/2007
	Data Release Frequency: Varies

## **ENVIROSTOR:** EnviroStor Database

The Department of Toxic Substances Control's (DTSC's) Site Mitigation and Brownfields Reuse Program's (SMBRP's) EnviroStor database identifies sites that have known contamination or sites for which there may be reasons to investigate further. The database includes the following site types: Federal Superfund sites (National Priorities List (NPL)); State Response, including Military Facilities and State Superfund; Voluntary Cleanup; and School sites. EnviroStor provides similar information to the information that was available in CalSites, and provides additional site information, including, but not limited to, identification of formerly-contaminated properties that have been released for reuse, properties where environmental deed restrictions have been recorded to prevent inappropriate land uses, and risk characterization information that is used to assess potential impacts to public health and the environment at contaminated sites.

Date of Government Version: 08/28/2007	Source: Department of Toxic Substances Control
Date Data Arrived at EDR: 08/29/2007	Telephone: 916-323-3400
Date Made Active in Reports: 09/26/2007	Last EDR Contact: 08/29/2007
Number of Days to Update: 28	Next Scheduled EDR Contact: 11/26/2007
	Data Release Frequency: Quarterly

## **TRIBAL RECORDS**

### **INDIAN RESERV:** Indian Reservations

This map layer portrays Indian administered lands of the United States that have any area equal to or greater than 640 acres.

Date of Government Version: 12/31/2005	Source: USGS
Date Data Arrived at EDR: 12/08/2006	Telephone: 202-208-3710
Date Made Active in Reports: 01/11/2007	Last EDR Contact: 08/09/2007
Number of Days to Update: 34	Next Scheduled EDR Contact: 11/05/2007
	Data Release Frequency: Semi-Annually

### **INDIAN LUST R7:** Leaking Underground Storage Tanks on Indian Land

LUSTs on Indian land in Iowa, Kansas, and Nebraska

Date of Government Version: 06/01/2007	Source: EPA Region 7
Date Data Arrived at EDR: 06/14/2007	Telephone: 913-551-7003
Date Made Active in Reports: 07/05/2007	Last EDR Contact: 08/20/2007
Number of Days to Update: 21	Next Scheduled EDR Contact: 11/19/2007
	Data Release Frequency: Varies

### **INDIAN LUST R6:** Leaking Underground Storage Tanks on Indian Land

LUSTs on Indian land in New Mexico and Oklahoma.

Date of Government Version: 01/04/2005	Source: EPA Region 6
Date Data Arrived at EDR: 01/21/2005	Telephone: 214-665-6597
Date Made Active in Reports: 02/28/2005	Last EDR Contact: 08/20/2007
Number of Days to Update: 38	Next Scheduled EDR Contact: 11/19/2007
	Data Release Frequency: Varies

# GOVERNMENT RECORDS SEARCHED / DATA CURRENCY TRACKING

## **INDIAN LUST R8:** Leaking Underground Storage Tanks on Indian Land

LUSTs on Indian land in Colorado, Montana, North Dakota, South Dakota, Utah and Wyoming.

Date of Government Version: 08/27/2007	Source: EPA Region 8
Date Data Arrived at EDR: 09/07/2007	Telephone: 303-312-6271
Date Made Active in Reports: 10/11/2007	Last EDR Contact: 08/20/2007
Number of Days to Update: 34	Next Scheduled EDR Contact: 11/19/2007
	Data Release Frequency: Quarterly

## **INDIAN LUST R4:** Leaking Underground Storage Tanks on Indian Land

LUSTs on Indian land in Florida, Mississippi and North Carolina.

Date of Government Version: 09/05/2007	Source: EPA Region 4
Date Data Arrived at EDR: 10/02/2007	Telephone: 404-562-8677
Date Made Active in Reports: 10/11/2007	Last EDR Contact: 08/20/2007
Number of Days to Update: 9	Next Scheduled EDR Contact: 11/19/2007
	Data Release Frequency: Semi-Annually

## **INDIAN LUST R1:** Leaking Underground Storage Tanks on Indian Land

A listing of leaking underground storage tank locations on Indian Land.

Date of Government Version: 12/01/2006	Source: EPA Region 1
Date Data Arrived at EDR: 12/01/2006	Telephone: 617-918-1313
Date Made Active in Reports: 01/29/2007	Last EDR Contact: 08/20/2007
Number of Days to Update: 59	Next Scheduled EDR Contact: 11/19/2007
	Data Release Frequency: Varies

## **INDIAN LUST R10:** Leaking Underground Storage Tanks on Indian Land

LUSTs on Indian land in Alaska, Idaho, Oregon and Washington.

Date of Government Version: 09/12/2007	Source: EPA Region 10
Date Data Arrived at EDR: 09/14/2007	Telephone: 206-553-2857
Date Made Active in Reports: 10/11/2007	Last EDR Contact: 08/20/2007
Number of Days to Update: 27	Next Scheduled EDR Contact: 11/19/2007
	Data Release Frequency: Quarterly

## **INDIAN LUST R9:** Leaking Underground Storage Tanks on Indian Land

LUSTs on Indian land in Arizona, California, New Mexico and Nevada

Date of Government Version: 09/11/2007	Source: Environmental Protection Agency
Date Data Arrived at EDR: 09/14/2007	Telephone: 415-972-3372
Date Made Active in Reports: 10/11/2007	Last EDR Contact: 08/20/2007
Number of Days to Update: 27	Next Scheduled EDR Contact: 11/19/2007
	Data Release Frequency: Quarterly

## **INDIAN UST R7:** Underground Storage Tanks on Indian Land

Date of Government Version: 06/01/2007	Source: EPA Region 7
Date Data Arrived at EDR: 06/14/2007	Telephone: 913-551-7003
Date Made Active in Reports: 07/05/2007	Last EDR Contact: 08/20/2007
Number of Days to Update: 21	Next Scheduled EDR Contact: 11/19/2007
	Data Release Frequency: Varies

## **INDIAN UST R6:** Underground Storage Tanks on Indian Land

Date of Government Version: 08/31/2007	Source: EPA Region 6
Date Data Arrived at EDR: 08/31/2007	Telephone: 214-665-7591
Date Made Active in Reports: 10/11/2007	Last EDR Contact: 08/20/2007
Number of Days to Update: 41	Next Scheduled EDR Contact: 11/19/2007
	Data Release Frequency: Semi-Annually

# GOVERNMENT RECORDS SEARCHED / DATA CURRENCY TRACKING

## INDIAN UST R9: Underground Storage Tanks on Indian Land

Date of Government Version: 09/11/2007	Source: EPA Region 9
Date Data Arrived at EDR: 09/14/2007	Telephone: 415-972-3368
Date Made Active in Reports: 10/11/2007	Last EDR Contact: 08/20/2007
Number of Days to Update: 27	Next Scheduled EDR Contact: 11/19/2007
	Data Release Frequency: Quarterly

## INDIAN UST R1: Underground Storage Tanks on Indian Land

A listing of underground storage tank locations on Indian Land.

Date of Government Version: 12/01/2006	Source: EPA, Region 1
Date Data Arrived at EDR: 12/01/2006	Telephone: 617-918-1313
Date Made Active in Reports: 01/29/2007	Last EDR Contact: 08/20/2007
Number of Days to Update: 59	Next Scheduled EDR Contact: 11/19/2007
	Data Release Frequency: Varies

## INDIAN UST R8: Underground Storage Tanks on Indian Land

Date of Government Version: 08/27/2007	Source: EPA Region 8
Date Data Arrived at EDR: 09/07/2007	Telephone: 303-312-6137
Date Made Active in Reports: 10/11/2007	Last EDR Contact: 08/20/2007
Number of Days to Update: 34	Next Scheduled EDR Contact: 11/19/2007
	Data Release Frequency: Quarterly

## INDIAN UST R4: Underground Storage Tanks on Indian Land

Date of Government Version: 09/05/2007	Source: EPA Region 4
Date Data Arrived at EDR: 10/02/2007	Telephone: 404-562-9424
Date Made Active in Reports: 10/11/2007	Last EDR Contact: 08/20/2007
Number of Days to Update: 9	Next Scheduled EDR Contact: 11/19/2007
	Data Release Frequency: Semi-Annually

## INDIAN UST R10: Underground Storage Tanks on Indian Land

Date of Government Version: 09/12/2007	Source: EPA Region 10
Date Data Arrived at EDR: 09/14/2007	Telephone: 206-553-2857
Date Made Active in Reports: 10/11/2007	Last EDR Contact: 08/20/2007
Number of Days to Update: 27	Next Scheduled EDR Contact: 11/19/2007
	Data Release Frequency: Quarterly

## INDIAN UST R5: Underground Storage Tanks on Indian Land

Date of Government Version: 12/02/2004	Source: EPA Region 5
Date Data Arrived at EDR: 12/29/2004	Telephone: 312-886-6136
Date Made Active in Reports: 02/04/2005	Last EDR Contact: 08/20/2007
Number of Days to Update: 37	Next Scheduled EDR Contact: 11/19/2007
	Data Release Frequency: Varies

## EDR PROPRIETARY RECORDS

### **Manufactured Gas Plants:** EDR Proprietary Manufactured Gas Plants

The EDR Proprietary Manufactured Gas Plant Database includes records of coal gas plants (manufactured gas plants) compiled by EDR's researchers. Manufactured gas sites were used in the United States from the 1800's to 1950's to produce a gas that could be distributed and used as fuel. These plants used whale oil, rosin, coal, or a mixture of coal, oil, and water that also produced a significant amount of waste. Many of the byproducts of the gas production, such as coal tar (oily waste containing volatile and non-volatile chemicals), sludges, oils and other compounds are potentially hazardous to human health and the environment. The byproduct from this process was frequently disposed of directly at the plant site and can remain or spread slowly, serving as a continuous source of soil and groundwater contamination.

# GOVERNMENT RECORDS SEARCHED / DATA CURRENCY TRACKING

Date of Government Version: N/A  
Date Data Arrived at EDR: N/A  
Date Made Active in Reports: N/A  
Number of Days to Update: N/A

Source: EDR, Inc.  
Telephone: N/A  
Last EDR Contact: N/A  
Next Scheduled EDR Contact: N/A  
Data Release Frequency: No Update Planned

## **FEDERAL RECORDS**

### **COLLEGES:** Integrated Postsecondary Education Data

The National Center for Education Statistics' primary database on integrated postsecondary education in the United States.

Date of Government Version: N/A  
Date Data Arrived at EDR: 10/12/2005  
Date Made Active in Reports: N/A  
Number of Days to Update: 0

Source: National Center for Education Statistics  
Telephone: 202-502-7300  
Last EDR Contact: 09/22/2006  
Next Scheduled EDR Contact: N/A  
Data Release Frequency: N/A

### **PUBLIC SCHOOLS:** Public Schools

The National Center for Education Statistics' primary database on elementary and secondary public education in the United States. It is a comprehensive, annual, national statistical database of all public elementary and secondary schools and school districts, which contains data that are comparable across all states.

Date of Government Version: N/A  
Date Data Arrived at EDR: 07/13/2004  
Date Made Active in Reports: N/A  
Number of Days to Update: 0

Source: National Center for Education statistics  
Telephone: 202-502-7300  
Last EDR Contact: 10/10/2007  
Next Scheduled EDR Contact: 01/07/2008  
Data Release Frequency: N/A

### **PRIVATE SCHOOLS:** Private Schools of the United States

The National Center for Education Statistics' primary database on private school locations in the United States.

Date of Government Version: N/A  
Date Data Arrived at EDR: 10/07/2005  
Date Made Active in Reports: N/A  
Number of Days to Update: 0

Source: National Center for Education Statistics  
Telephone: 202-502-7300  
Last EDR Contact: 09/22/2006  
Next Scheduled EDR Contact: N/A  
Data Release Frequency: N/A

### **NURSING HOMES:** Directory of Nursing Homes

Information on Medicare and Medicaid certified nursing homes in the United States.

Date of Government Version: N/A  
Date Data Arrived at EDR: 10/11/2005  
Date Made Active in Reports: N/A  
Number of Days to Update: 0

Source: N/A  
Telephone: 800-568-3282  
Last EDR Contact: 09/22/2006  
Next Scheduled EDR Contact: N/A  
Data Release Frequency: N/A

### **MEDICAL CENTERS:** Provider of Services Listing

A listing of hospitals with Medicare provider number, produced by Centers of Medicare & Medicaid Services, a federal agency within the U.S. Department of Health & Human Services.

Date of Government Version: 06/01/1998  
Date Data Arrived at EDR: 11/10/2005  
Date Made Active in Reports: N/A  
Number of Days to Update: 0

Source: Centers for Medicare & Medicaid Services  
Telephone: 410-786-3000  
Last EDR Contact: 01/12/2007  
Next Scheduled EDR Contact: N/A  
Data Release Frequency: N/A

### **HOSPITALS:** AHA Hospital Guide

The database includes a listing of hospitals based on the American Hospital Association's annual survey of hospitals.



# GOVERNMENT RECORDS SEARCHED / DATA CURRENCY TRACKING

Date of Government Version: N/A  
Date Data Arrived at EDR: 10/19/1994  
Date Made Active in Reports: N/A  
Number of Days to Update: 0

Source: American Hospital Association  
Telephone: 800-242-2626  
Last EDR Contact: 09/22/2006  
Next Scheduled EDR Contact: N/A  
Data Release Frequency: N/A

## COUNTY RECORDS

### ALAMEDA COUNTY:

#### Contaminated Sites

A listing of contaminated sites overseen by the Toxic Release Program (oil and groundwater contamination from chemical releases and spills) and the Leaking Underground Storage Tank Program (soil and ground water contamination from leaking petroleum USTs).

Date of Government Version: 08/03/2007  
Date Data Arrived at EDR: 08/07/2007  
Date Made Active in Reports: 09/26/2007  
Number of Days to Update: 50

Source: Alameda County Environmental Health Services  
Telephone: 510-567-6700  
Last EDR Contact: 07/23/2007  
Next Scheduled EDR Contact: 10/22/2007  
Data Release Frequency: Semi-Annually

#### Underground Tanks

Underground storage tank sites located in Alameda county.

Date of Government Version: 08/03/2007  
Date Data Arrived at EDR: 08/07/2007  
Date Made Active in Reports: 09/24/2007  
Number of Days to Update: 48

Source: Alameda County Environmental Health Services  
Telephone: 510-567-6700  
Last EDR Contact: 07/23/2007  
Next Scheduled EDR Contact: 10/22/2007  
Data Release Frequency: Semi-Annually

### CONTRA COSTA COUNTY:

#### Site List

List includes sites from the underground tank, hazardous waste generator and business plan/2185 programs.

Date of Government Version: 09/11/2007  
Date Data Arrived at EDR: 09/14/2007  
Date Made Active in Reports: 09/28/2007  
Number of Days to Update: 14

Source: Contra Costa Health Services Department  
Telephone: 925-646-2286  
Last EDR Contact: 09/10/2007  
Next Scheduled EDR Contact: 11/26/2007  
Data Release Frequency: Semi-Annually

### FRESNO COUNTY:

#### CUPA Resources List

Certified Unified Program Agency. CUPA's are responsible for implementing a unified hazardous materials and hazardous waste management regulatory program. The agency provides oversight of businesses that deal with hazardous materials, operate underground storage tanks or aboveground storage tanks.

Date of Government Version: 07/16/2007  
Date Data Arrived at EDR: 07/17/2007  
Date Made Active in Reports: 08/09/2007  
Number of Days to Update: 23

Source: Dept. of Community Health  
Telephone: 559-445-3271  
Last EDR Contact: 08/06/2007  
Next Scheduled EDR Contact: 11/05/2007  
Data Release Frequency: Semi-Annually

### KERN COUNTY:

# GOVERNMENT RECORDS SEARCHED / DATA CURRENCY TRACKING

## Underground Storage Tank Sites & Tank Listing

Kern County Sites and Tanks Listing.

Date of Government Version: 06/20/2007  
Date Data Arrived at EDR: 06/21/2007  
Date Made Active in Reports: 07/25/2007  
Number of Days to Update: 34

Source: Kern County Environment Health Services Department  
Telephone: 661-862-8700  
Last EDR Contact: 09/17/2007  
Next Scheduled EDR Contact: 12/03/2007  
Data Release Frequency: Quarterly

## LOS ANGELES COUNTY:

### San Gabriel Valley Areas of Concern

San Gabriel Valley areas where VOC contamination is at or above the MCL as designated by region 9 EPA office.

Date of Government Version: 12/31/1998  
Date Data Arrived at EDR: 07/07/1999  
Date Made Active in Reports: N/A  
Number of Days to Update: 0

Source: EPA Region 9  
Telephone: 415-972-3178  
Last EDR Contact: 07/16/2007  
Next Scheduled EDR Contact: 10/15/2007  
Data Release Frequency: No Update Planned

### HMS: Street Number List

Industrial Waste and Underground Storage Tank Sites.

Date of Government Version: 05/31/2007  
Date Data Arrived at EDR: 08/27/2007  
Date Made Active in Reports: 09/26/2007  
Number of Days to Update: 30

Source: Department of Public Works  
Telephone: 626-458-3517  
Last EDR Contact: 08/13/2007  
Next Scheduled EDR Contact: 11/12/2007  
Data Release Frequency: Semi-Annually

### List of Solid Waste Facilities

Solid Waste Facilities in Los Angeles County.

Date of Government Version: 08/17/2007  
Date Data Arrived at EDR: 09/24/2007  
Date Made Active in Reports: 09/28/2007  
Number of Days to Update: 4

Source: La County Department of Public Works  
Telephone: 818-458-5185  
Last EDR Contact: 08/17/2007  
Next Scheduled EDR Contact: 11/12/2007  
Data Release Frequency: Varies

### City of Los Angeles Landfills

Landfills owned and maintained by the City of Los Angeles.

Date of Government Version: 03/01/2007  
Date Data Arrived at EDR: 03/27/2007  
Date Made Active in Reports: 04/27/2007  
Number of Days to Update: 31

Source: Engineering & Construction Division  
Telephone: 213-473-7869  
Last EDR Contact: 09/10/2007  
Next Scheduled EDR Contact: 12/10/2007  
Data Release Frequency: Varies

### Site Mitigation List

Industrial sites that have had some sort of spill or complaint.

Date of Government Version: 05/30/2007  
Date Data Arrived at EDR: 07/11/2007  
Date Made Active in Reports: 08/09/2007  
Number of Days to Update: 29

Source: Community Health Services  
Telephone: 323-890-7806  
Last EDR Contact: 09/20/2007  
Next Scheduled EDR Contact: 11/12/2007  
Data Release Frequency: Annually

### City of El Segundo Underground Storage Tank

Underground storage tank sites located in El Segundo city.

# GOVERNMENT RECORDS SEARCHED / DATA CURRENCY TRACKING

Date of Government Version: 05/14/2007  
Date Data Arrived at EDR: 05/15/2007  
Date Made Active in Reports: 06/25/2007  
Number of Days to Update: 41

Source: City of El Segundo Fire Department  
Telephone: 310-524-2236  
Last EDR Contact: 08/13/2007  
Next Scheduled EDR Contact: 11/12/2007  
Data Release Frequency: Semi-Annually

## City of Long Beach Underground Storage Tank

Underground storage tank sites located in the city of Long Beach.

Date of Government Version: 03/28/2003  
Date Data Arrived at EDR: 10/23/2003  
Date Made Active in Reports: 11/26/2003  
Number of Days to Update: 34

Source: City of Long Beach Fire Department  
Telephone: 562-570-2563  
Last EDR Contact: 08/23/2007  
Next Scheduled EDR Contact: 11/19/2007  
Data Release Frequency: Annually

## City of Torrance Underground Storage Tank

Underground storage tank sites located in the city of Torrance.

Date of Government Version: 05/29/2007  
Date Data Arrived at EDR: 05/29/2007  
Date Made Active in Reports: 06/25/2007  
Number of Days to Update: 27

Source: City of Torrance Fire Department  
Telephone: 310-618-2973  
Last EDR Contact: 09/24/2007  
Next Scheduled EDR Contact: 11/12/2007  
Data Release Frequency: Semi-Annually

## MARIN COUNTY:

### Underground Storage Tank Sites

Currently permitted USTs in Marin County.

Date of Government Version: 05/08/2007  
Date Data Arrived at EDR: 06/08/2007  
Date Made Active in Reports: 07/25/2007  
Number of Days to Update: 47

Source: Public Works Department Waste Management  
Telephone: 415-499-6647  
Last EDR Contact: 07/30/2007  
Next Scheduled EDR Contact: 10/29/2007  
Data Release Frequency: Semi-Annually

## NAPA COUNTY:

### Sites With Reported Contamination

A listing of leaking underground storage tank sites located in Napa county.

Date of Government Version: 09/24/2007  
Date Data Arrived at EDR: 09/25/2007  
Date Made Active in Reports: 09/28/2007  
Number of Days to Update: 3

Source: Napa County Department of Environmental Management  
Telephone: 707-253-4269  
Last EDR Contact: 09/24/2007  
Next Scheduled EDR Contact: 12/24/2007  
Data Release Frequency: Semi-Annually

### Closed and Operating Underground Storage Tank Sites

Underground storage tank sites located in Napa county.

Date of Government Version: 07/24/2007  
Date Data Arrived at EDR: 07/27/2007  
Date Made Active in Reports: 09/07/2007  
Number of Days to Update: 42

Source: Napa County Department of Environmental Management  
Telephone: 707-253-4269  
Last EDR Contact: 09/24/2007  
Next Scheduled EDR Contact: 12/24/2007  
Data Release Frequency: Annually

## ORANGE COUNTY:

# GOVERNMENT RECORDS SEARCHED / DATA CURRENCY TRACKING

## List of Industrial Site Cleanups

Petroleum and non-petroleum spills.

Date of Government Version: 06/01/2007  
Date Data Arrived at EDR: 06/19/2007  
Date Made Active in Reports: 06/29/2007  
Number of Days to Update: 10

Source: Health Care Agency  
Telephone: 714-834-3446  
Last EDR Contact: 08/31/2007  
Next Scheduled EDR Contact: 12/03/2007  
Data Release Frequency: Annually

## List of Underground Storage Tank Cleanups

Orange County Underground Storage Tank Cleanups (LUST).

Date of Government Version: 06/01/2007  
Date Data Arrived at EDR: 06/19/2007  
Date Made Active in Reports: 06/29/2007  
Number of Days to Update: 10

Source: Health Care Agency  
Telephone: 714-834-3446  
Last EDR Contact: 08/31/2007  
Next Scheduled EDR Contact: 12/03/2007  
Data Release Frequency: Quarterly

## List of Underground Storage Tank Facilities

Orange County Underground Storage Tank Facilities (UST).

Date of Government Version: 06/01/2007  
Date Data Arrived at EDR: 06/19/2007  
Date Made Active in Reports: 07/25/2007  
Number of Days to Update: 36

Source: Health Care Agency  
Telephone: 714-834-3446  
Last EDR Contact: 08/31/2007  
Next Scheduled EDR Contact: 12/03/2007  
Data Release Frequency: Quarterly

## PLACER COUNTY:

### Master List of Facilities

List includes aboveground tanks, underground tanks and cleanup sites.

Date of Government Version: 07/23/2007  
Date Data Arrived at EDR: 07/23/2007  
Date Made Active in Reports: 08/09/2007  
Number of Days to Update: 17

Source: Placer County Health and Human Services  
Telephone: 530-889-7312  
Last EDR Contact: 09/17/2007  
Next Scheduled EDR Contact: 12/17/2007  
Data Release Frequency: Semi-Annually

## RIVERSIDE COUNTY:

### Listing of Underground Tank Cleanup Sites

Riverside County Underground Storage Tank Cleanup Sites (LUST).

Date of Government Version: 08/06/2007  
Date Data Arrived at EDR: 08/07/2007  
Date Made Active in Reports: 09/26/2007  
Number of Days to Update: 50

Source: Department of Public Health  
Telephone: 951-358-5055  
Last EDR Contact: 07/16/2007  
Next Scheduled EDR Contact: 10/15/2007  
Data Release Frequency: Quarterly

### Underground Storage Tank Tank List

Underground storage tank sites located in Riverside county.

Date of Government Version: 08/06/2007  
Date Data Arrived at EDR: 08/07/2007  
Date Made Active in Reports: 09/24/2007  
Number of Days to Update: 48

Source: Health Services Agency  
Telephone: 951-358-5055  
Last EDR Contact: 07/16/2007  
Next Scheduled EDR Contact: 10/15/2007  
Data Release Frequency: Quarterly

## SACRAMENTO COUNTY:

# GOVERNMENT RECORDS SEARCHED / DATA CURRENCY TRACKING

## Contaminated Sites

List of sites where unauthorized releases of potentially hazardous materials have occurred.

Date of Government Version: 08/07/2007  
Date Data Arrived at EDR: 08/08/2007  
Date Made Active in Reports: 09/26/2007  
Number of Days to Update: 49

Source: Sacramento County Environmental Management  
Telephone: 916-875-8406  
Last EDR Contact: 07/31/2007  
Next Scheduled EDR Contact: 10/29/2007  
Data Release Frequency: Quarterly

## ML - Regulatory Compliance Master List

Any business that has hazardous materials on site - hazardous material storage sites, underground storage tanks, waste generators.

Date of Government Version: 08/07/2007  
Date Data Arrived at EDR: 08/08/2007  
Date Made Active in Reports: 09/26/2007  
Number of Days to Update: 49

Source: Sacramento County Environmental Management  
Telephone: 916-875-8406  
Last EDR Contact: 07/31/2007  
Next Scheduled EDR Contact: 10/29/2007  
Data Release Frequency: Quarterly

## SAN BERNARDINO COUNTY:

### Hazardous Material Permits

This listing includes underground storage tanks, medical waste handlers/generators, hazardous materials handlers, hazardous waste generators, and waste oil generators/handlers.

Date of Government Version: 06/27/2007  
Date Data Arrived at EDR: 06/29/2007  
Date Made Active in Reports: 08/09/2007  
Number of Days to Update: 41

Source: San Bernardino County Fire Department Hazardous Materials Division  
Telephone: 909-387-3041  
Last EDR Contact: 09/04/2007  
Next Scheduled EDR Contact: 12/03/2007  
Data Release Frequency: Quarterly

## SAN DIEGO COUNTY:

### Hazardous Materials Management Division Database

The database includes: HE58 - This report contains the business name, site address, business phone number, establishment 'H' permit number, type of permit, and the business status. HE17 - In addition to providing the same information provided in the HE58 listing, HE17 provides inspection dates, violations received by the establishment, hazardous waste generated, the quantity, method of storage, treatment/disposal of waste and the hauler, and information on underground storage tanks. Unauthorized Release List - Includes a summary of environmental contamination cases in San Diego County (underground tank cases, non-tank cases, groundwater contamination, and soil contamination are included.)

Date of Government Version: 05/16/2005  
Date Data Arrived at EDR: 05/18/2005  
Date Made Active in Reports: 06/16/2005  
Number of Days to Update: 29

Source: Hazardous Materials Management Division  
Telephone: 619-338-2268  
Last EDR Contact: 10/05/2007  
Next Scheduled EDR Contact: 12/31/2007  
Data Release Frequency: Quarterly

### Solid Waste Facilities

San Diego County Solid Waste Facilities.

Date of Government Version: 11/01/2006  
Date Data Arrived at EDR: 01/03/2007  
Date Made Active in Reports: 01/24/2007  
Number of Days to Update: 21

Source: Department of Health Services  
Telephone: 619-338-2209  
Last EDR Contact: 09/04/2007  
Next Scheduled EDR Contact: 11/19/2007  
Data Release Frequency: Varies

# GOVERNMENT RECORDS SEARCHED / DATA CURRENCY TRACKING

## Environmental Case Listing

The listing contains all underground tank release cases and projects pertaining to properties contaminated with hazardous substances that are actively under review by the Site Assessment and Mitigation Program.

Date of Government Version: 06/27/2007	Source: San Diego County Department of Environmental Health
Date Data Arrived at EDR: 07/20/2007	Telephone: 619-338-2371
Date Made Active in Reports: 08/09/2007	Last EDR Contact: 10/03/2007
Number of Days to Update: 20	Next Scheduled EDR Contact: 12/31/2007
	Data Release Frequency: Varies

## SAN FRANCISCO COUNTY:

### Local Oversight Facilities

A listing of leaking underground storage tank sites located in San Francisco county.

Date of Government Version: 09/07/2007	Source: Department Of Public Health San Francisco County
Date Data Arrived at EDR: 09/07/2007	Telephone: 415-252-3920
Date Made Active in Reports: 09/28/2007	Last EDR Contact: 09/04/2007
Number of Days to Update: 21	Next Scheduled EDR Contact: 12/03/2007
	Data Release Frequency: Quarterly

### Underground Storage Tank Information

Underground storage tank sites located in San Francisco county.

Date of Government Version: 09/07/2007	Source: Department of Public Health
Date Data Arrived at EDR: 09/07/2007	Telephone: 415-252-3920
Date Made Active in Reports: 09/24/2007	Last EDR Contact: 09/04/2007
Number of Days to Update: 17	Next Scheduled EDR Contact: 12/03/2007
	Data Release Frequency: Quarterly

## SAN JOAQUIN COUNTY:

### San Joaquin Co. UST

A listing of underground storage tank locations in San Joaquin county.

Date of Government Version: 08/21/2007	Source: Environmental Health Department
Date Data Arrived at EDR: 08/22/2007	Telephone: N/A
Date Made Active in Reports: 09/24/2007	Last EDR Contact: 07/30/2007
Number of Days to Update: 33	Next Scheduled EDR Contact: 10/15/2007
	Data Release Frequency: Semi-Annually

## SAN MATEO COUNTY:

### Business Inventory

List includes Hazardous Materials Business Plan, hazardous waste generators, and underground storage tanks.

Date of Government Version: 07/30/2007	Source: San Mateo County Environmental Health Services Division
Date Data Arrived at EDR: 07/30/2007	Telephone: 650-363-1921
Date Made Active in Reports: 08/09/2007	Last EDR Contact: 10/09/2007
Number of Days to Update: 10	Next Scheduled EDR Contact: 01/07/2008
	Data Release Frequency: Annually

### Fuel Leak List

A listing of leaking underground storage tank sites located in San Mateo county.

Date of Government Version: 07/09/2007	Source: San Mateo County Environmental Health Services Division
Date Data Arrived at EDR: 07/10/2007	Telephone: 650-363-1921
Date Made Active in Reports: 08/09/2007	Last EDR Contact: 10/09/2007
Number of Days to Update: 30	Next Scheduled EDR Contact: 01/07/2008
	Data Release Frequency: Semi-Annually

## SANTA CLARA COUNTY:

# GOVERNMENT RECORDS SEARCHED / DATA CURRENCY TRACKING

## HIST LUST - Fuel Leak Site Activity Report

A listing of open and closed leaking underground storage tanks. This listing is no longer updated by the county. Leaking underground storage tanks are now handled by the Department of Environmental Health.

Date of Government Version: 03/29/2005  
Date Data Arrived at EDR: 03/30/2005  
Date Made Active in Reports: 04/21/2005  
Number of Days to Update: 22

Source: Santa Clara Valley Water District  
Telephone: 408-265-2600  
Last EDR Contact: 09/24/2007  
Next Scheduled EDR Contact: 12/24/2007  
Data Release Frequency: No Update Planned

## LOP Listing

A listing of leaking underground storage tanks located in Santa Clara county.

Date of Government Version: 03/26/2007  
Date Data Arrived at EDR: 03/27/2007  
Date Made Active in Reports: 04/27/2007  
Number of Days to Update: 31

Source: Department of Environmental Health  
Telephone: 408-918-3417  
Last EDR Contact: 09/24/2007  
Next Scheduled EDR Contact: 12/24/2007  
Data Release Frequency: Varies

## Hazardous Material Facilities

Hazardous material facilities, including underground storage tank sites.

Date of Government Version: 09/17/2007  
Date Data Arrived at EDR: 09/17/2007  
Date Made Active in Reports: 09/28/2007  
Number of Days to Update: 11

Source: City of San Jose Fire Department  
Telephone: 408-277-4659  
Last EDR Contact: 09/17/2007  
Next Scheduled EDR Contact: 12/03/2007  
Data Release Frequency: Annually

## SOLANO COUNTY:

### Leaking Underground Storage Tanks

A listing of leaking underground storage tank sites located in Solano county.

Date of Government Version: 07/09/2007  
Date Data Arrived at EDR: 08/03/2007  
Date Made Active in Reports: 08/09/2007  
Number of Days to Update: 6

Source: Solano County Department of Environmental Management  
Telephone: 707-784-6770  
Last EDR Contact: 09/24/2007  
Next Scheduled EDR Contact: 12/24/2007  
Data Release Frequency: Quarterly

### Underground Storage Tanks

Underground storage tank sites located in Solano county.

Date of Government Version: 07/09/2007  
Date Data Arrived at EDR: 08/03/2007  
Date Made Active in Reports: 09/24/2007  
Number of Days to Update: 52

Source: Solano County Department of Environmental Management  
Telephone: 707-784-6770  
Last EDR Contact: 09/24/2007  
Next Scheduled EDR Contact: 12/24/2007  
Data Release Frequency: Quarterly

## SONOMA COUNTY:

### Leaking Underground Storage Tank Sites

A listing of leaking underground storage tank sites located in Sonoma county.

Date of Government Version: 07/09/2007  
Date Data Arrived at EDR: 07/09/2007  
Date Made Active in Reports: 08/09/2007  
Number of Days to Update: 31

Source: Department of Health Services  
Telephone: 707-565-6565  
Last EDR Contact: 07/09/2007  
Next Scheduled EDR Contact: 10/22/2007  
Data Release Frequency: Quarterly

## SUTTER COUNTY:

# GOVERNMENT RECORDS SEARCHED / DATA CURRENCY TRACKING

## Underground Storage Tanks

Underground storage tank sites located in Sutter county.

Date of Government Version: 05/04/2007	Source: Sutter County Department of Agriculture
Date Data Arrived at EDR: 05/04/2007	Telephone: 530-822-7500
Date Made Active in Reports: 05/24/2007	Last EDR Contact: 10/01/2007
Number of Days to Update: 20	Next Scheduled EDR Contact: 12/31/2007
	Data Release Frequency: Semi-Annually

## VENTURA COUNTY:

### Business Plan, Hazardous Waste Producers, and Operating Underground Tanks

The BWT list indicates by site address whether the Environmental Health Division has Business Plan (B), Waste Producer (W), and/or Underground Tank (T) information.

Date of Government Version: 05/30/2007	Source: Ventura County Environmental Health Division
Date Data Arrived at EDR: 06/22/2007	Telephone: 805-654-2813
Date Made Active in Reports: 06/29/2007	Last EDR Contact: 09/12/2007
Number of Days to Update: 7	Next Scheduled EDR Contact: 12/10/2007
	Data Release Frequency: Quarterly

### Inventory of Illegal Abandoned and Inactive Sites

Ventura County Inventory of Closed, Illegal Abandoned, and Inactive Sites.

Date of Government Version: 08/01/2007	Source: Environmental Health Division
Date Data Arrived at EDR: 08/29/2007	Telephone: 805-654-2813
Date Made Active in Reports: 09/26/2007	Last EDR Contact: 08/21/2007
Number of Days to Update: 28	Next Scheduled EDR Contact: 11/19/2007
	Data Release Frequency: Annually

### Listing of Underground Tank Cleanup Sites

Ventura County Underground Storage Tank Cleanup Sites (LUST).

Date of Government Version: 06/05/2007	Source: Environmental Health Division
Date Data Arrived at EDR: 06/21/2007	Telephone: 805-654-2813
Date Made Active in Reports: 06/29/2007	Last EDR Contact: 09/12/2007
Number of Days to Update: 8	Next Scheduled EDR Contact: 12/10/2007
	Data Release Frequency: Quarterly

### Underground Tank Closed Sites List

Ventura County Operating Underground Storage Tank Sites (UST)/Underground Tank Closed Sites List.

Date of Government Version: 06/26/2007	Source: Environmental Health Division
Date Data Arrived at EDR: 07/27/2007	Telephone: 805-654-2813
Date Made Active in Reports: 09/07/2007	Last EDR Contact: 10/11/2007
Number of Days to Update: 42	Next Scheduled EDR Contact: 01/07/2008
	Data Release Frequency: Quarterly

## YOLO COUNTY:

### Underground Storage Tank Comprehensive Facility Report

Underground storage tank sites located in Yolo county.

Date of Government Version: 07/30/2007	Source: Yolo County Department of Health
Date Data Arrived at EDR: 09/04/2007	Telephone: 530-666-8646
Date Made Active in Reports: 09/24/2007	Last EDR Contact: 07/30/2007
Number of Days to Update: 20	Next Scheduled EDR Contact: 10/15/2007
	Data Release Frequency: Annually



# GOVERNMENT RECORDS SEARCHED / DATA CURRENCY TRACKING

## OTHER DATABASE(S)

Depending on the geographic area covered by this report, the data provided in these specialty databases may or may not be complete. For example, the existence of wetlands information data in a specific report does not mean that all wetlands in the area covered by the report are included. Moreover, the absence of any reported wetlands information does not necessarily mean that wetlands do not exist in the area covered by the report.

### **CT MANIFEST:** Hazardous Waste Manifest Data

Facility and manifest data. Manifest is a document that lists and tracks hazardous waste from the generator through transporters to a tsd facility.

Date of Government Version: 12/31/2005	Source: Department of Environmental Protection
Date Data Arrived at EDR: 06/15/2007	Telephone: 860-424-3375
Date Made Active in Reports: 08/20/2007	Last EDR Contact: 09/12/2007
Number of Days to Update: 66	Next Scheduled EDR Contact: 12/10/2007
	Data Release Frequency: Annually

### **NJ MANIFEST:** Manifest Information

Hazardous waste manifest information.

Date of Government Version: 04/01/2007	Source: Department of Environmental Protection
Date Data Arrived at EDR: 04/05/2007	Telephone: N/A
Date Made Active in Reports: 05/08/2007	Last EDR Contact: 10/02/2007
Number of Days to Update: 33	Next Scheduled EDR Contact: 12/31/2007
	Data Release Frequency: Annually

### **NY MANIFEST:** Facility and Manifest Data

Manifest is a document that lists and tracks hazardous waste from the generator through transporters to a TSD facility.

Date of Government Version: 08/27/2007	Source: Department of Environmental Conservation
Date Data Arrived at EDR: 08/30/2007	Telephone: 518-402-8651
Date Made Active in Reports: 09/21/2007	Last EDR Contact: 08/30/2007
Number of Days to Update: 22	Next Scheduled EDR Contact: 11/26/2007
	Data Release Frequency: Annually

### **PA MANIFEST:** Manifest Information

Hazardous waste manifest information.

Date of Government Version: 12/31/2006	Source: Department of Environmental Protection
Date Data Arrived at EDR: 08/23/2007	Telephone: N/A
Date Made Active in Reports: 09/27/2007	Last EDR Contact: 09/10/2007
Number of Days to Update: 35	Next Scheduled EDR Contact: 12/10/2007
	Data Release Frequency: Annually

### **RI MANIFEST:** Manifest information

Hazardous waste manifest information

Date of Government Version: 04/09/2007	Source: Department of Environmental Management
Date Data Arrived at EDR: 04/12/2007	Telephone: 401-222-2797
Date Made Active in Reports: 04/27/2007	Last EDR Contact: 09/17/2007
Number of Days to Update: 15	Next Scheduled EDR Contact: 12/17/2007
	Data Release Frequency: Annually

### **WI MANIFEST:** Manifest Information

Hazardous waste manifest information.

Date of Government Version: 12/31/2006	Source: Department of Natural Resources
Date Data Arrived at EDR: 04/27/2007	Telephone: N/A
Date Made Active in Reports: 06/08/2007	Last EDR Contact: 10/09/2007
Number of Days to Update: 42	Next Scheduled EDR Contact: 01/07/2008
	Data Release Frequency: Annually

# GOVERNMENT RECORDS SEARCHED / DATA CURRENCY TRACKING

**Oil/Gas Pipelines:** This data was obtained by EDR from the USGS in 1994. It is referred to by USGS as GeoData Digital Line Graphs from 1:100,000-Scale Maps. It was extracted from the transportation category including some oil, but primarily gas pipelines.

## **Electric Power Transmission Line Data**

Source: PennWell Corporation

Telephone: (800) 823-6277

This map includes information copyrighted by PennWell Corporation. This information is provided on a best effort basis and PennWell Corporation does not guarantee its accuracy nor warrant its fitness for any particular purpose. Such information has been reprinted with the permission of PennWell.

**Sensitive Receptors:** There are individuals deemed sensitive receptors due to their fragile immune systems and special sensitivity to environmental discharges. These sensitive receptors typically include the elderly, the sick, and children. While the location of all sensitive receptors cannot be determined, EDR indicates those buildings and facilities - schools, daycares, hospitals, medical centers, and nursing homes - where individuals who are sensitive receptors are likely to be located.

## **AHA Hospitals:**

Source: American Hospital Association, Inc.

Telephone: 312-280-5991

The database includes a listing of hospitals based on the American Hospital Association's annual survey of hospitals.

## **Medical Centers: Provider of Services Listing**

Source: Centers for Medicare & Medicaid Services

Telephone: 410-786-3000

A listing of hospitals with Medicare provider number, produced by Centers of Medicare & Medicaid Services, a federal agency within the U.S. Department of Health and Human Services.

## **Nursing Homes**

Source: National Institutes of Health

Telephone: 301-594-6248

Information on Medicare and Medicaid certified nursing homes in the United States.

## **Public Schools**

Source: National Center for Education Statistics

Telephone: 202-502-7300

The National Center for Education Statistics' primary database on elementary and secondary public education in the United States. It is a comprehensive, annual, national statistical database of all public elementary and secondary schools and school districts, which contains data that are comparable across all states.

## **Private Schools**

Source: National Center for Education Statistics

Telephone: 202-502-7300

The National Center for Education Statistics' primary database on private school locations in the United States.

## **Daycare Centers: Licensed Facilities**

Source: Department of Social Services

Telephone: 916-657-4041

**Flood Zone Data:** This data, available in select counties across the country, was obtained by EDR in 1999 from the Federal Emergency Management Agency (FEMA). Data depicts 100-year and 500-year flood zones as defined by FEMA.

**NWI:** National Wetlands Inventory. This data, available in select counties across the country, was obtained by EDR in 2002 and 2005 from the U.S. Fish and Wildlife Service.

## **STREET AND ADDRESS INFORMATION**

© 2007 Tele Atlas North America, Inc. All rights reserved. This material is proprietary and the subject of copyright protection and other intellectual property rights owned by or licensed to Tele Atlas North America, Inc. The use of this material is subject to the terms of a license agreement. You will be held liable for any unauthorized copying or disclosure of this material.

## GEOCHECK<sup>®</sup> - PHYSICAL SETTING SOURCE ADDENDUM

### TARGET PROPERTY ADDRESS

WARNER SUBSTATION  
HWY 79/SR 2  
WARNER SPRINGS, CA 92086

### TARGET PROPERTY COORDINATES

Latitude (North): 33.24760 - 33° 14' 51.4"  
Longitude (West): 116.6751 - 116° 40' 30.4"  
Universal Tranverse Mercator: Zone 11  
UTM X (Meters): 530266.5  
UTM Y (Meters): 3678591.5  
Elevation: 2836 ft. above sea level

### USGS TOPOGRAPHIC MAP

Target Property Map: 33116-B6 WARNERS RANCH, CA  
Most Recent Revision: 1975  
  
North Map: 33116-C6 WARNER SPRINGS, CA  
Most Recent Revision: 1975

EDR's GeoCheck Physical Setting Source Addendum is provided to assist the environmental professional in forming an opinion about the impact of potential contaminant migration.

Assessment of the impact of contaminant migration generally has two principle investigative components:

1. Groundwater flow direction, and
2. Groundwater flow velocity.

Groundwater flow direction may be impacted by surface topography, hydrology, hydrogeology, characteristics of the soil, and nearby wells. Groundwater flow velocity is generally impacted by the nature of the geologic strata.

# GEOCHECK® - PHYSICAL SETTING SOURCE SUMMARY

## GROUNDWATER FLOW DIRECTION INFORMATION

Groundwater flow direction for a particular site is best determined by a qualified environmental professional using site-specific well data. If such data is not reasonably ascertainable, it may be necessary to rely on other sources of information, such as surface topographic information, hydrologic information, hydrogeologic data collected on nearby properties, and regional groundwater flow information (from deep aquifers).

## TOPOGRAPHIC INFORMATION

Surface topography may be indicative of the direction of surficial groundwater flow. This information can be used to assist the environmental professional in forming an opinion about the impact of nearby contaminated properties or, should contamination exist on the target property, what downgradient sites might be impacted.

## TARGET PROPERTY TOPOGRAPHY

General Topographic Gradient: General West

## SURROUNDING TOPOGRAPHY: ELEVATION PROFILES

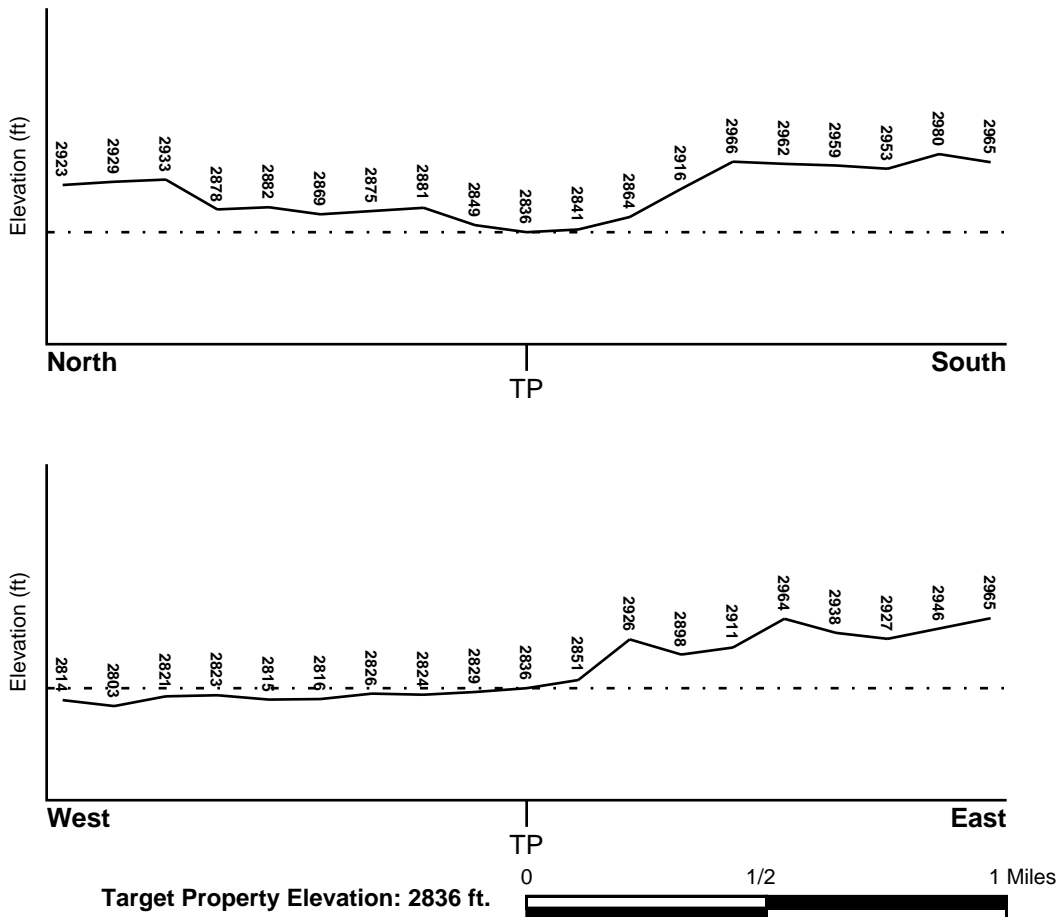

Source: Topography has been determined from the USGS 7.5' Digital Elevation Model and should be evaluated on a relative (not an absolute) basis. Relative elevation information between sites of close proximity should be field verified.

# GEOCHECK® - PHYSICAL SETTING SOURCE SUMMARY

## HYDROLOGIC INFORMATION

Surface water can act as a hydrologic barrier to groundwater flow. Such hydrologic information can be used to assist the environmental professional in forming an opinion about the impact of nearby contaminated properties or, should contamination exist on the target property, what downgradient sites might be impacted.

Refer to the Physical Setting Source Map following this summary for hydrologic information (major waterways and bodies of water).

## FEMA FLOOD ZONE

<u>Target Property County</u>	<u>FEMA Flood Electronic Data</u>
SAN DIEGO, CA	Not Available

Flood Plain Panel at Target Property: Not Reported

Additional Panels in search area: Not Reported

## NATIONAL WETLAND INVENTORY

<u>NWI Quad at Target Property</u>	<u>NWI Electronic Data Coverage</u>
WARNERS RANCH	YES - refer to the Overview Map and Detail Map

## HYDROGEOLOGIC INFORMATION

Hydrogeologic information obtained by installation of wells on a specific site can often be an indicator of groundwater flow direction in the immediate area. Such hydrogeologic information can be used to assist the environmental professional in forming an opinion about the impact of nearby contaminated properties or, should contamination exist on the target property, what downgradient sites might be impacted.

### *Site-Specific Hydrogeological Data\*:*

Search Radius:	1.25 miles
Status:	Not found

## AQUIFLOW®

Search Radius: 1.000 Mile.

EDR has developed the AQUIFLOW Information System to provide data on the general direction of groundwater flow at specific points. EDR has reviewed reports submitted by environmental professionals to regulatory authorities at select sites and has extracted the date of the report, groundwater flow direction as determined hydrogeologically, and the depth to water table.

<u>MAP ID</u>	<u>LOCATION FROM TP</u>	<u>GENERAL DIRECTION GROUNDWATER FLOW</u>
Not Reported		

\* ©1996 Site-specific hydrogeological data gathered by CERCLIS Alerts, Inc., Bainbridge Island, WA. All rights reserved. All of the information and opinions presented are those of the cited EPA report(s), which were completed under a Comprehensive Environmental Response Compensation and Liability Information System (CERCLIS) investigation.

# GEOCHECK® - PHYSICAL SETTING SOURCE SUMMARY

## GROUNDWATER FLOW VELOCITY INFORMATION

Groundwater flow velocity information for a particular site is best determined by a qualified environmental professional using site specific geologic and soil strata data. If such data are not reasonably ascertainable, it may be necessary to rely on other sources of information, including geologic age identification, rock stratigraphic unit and soil characteristics data collected on nearby properties and regional soil information. In general, contaminant plumes move more quickly through sandy-gravelly types of soils than silty-clayey types of soils.

## GEOLOGIC INFORMATION IN GENERAL AREA OF TARGET PROPERTY

Geologic information can be used by the environmental professional in forming an opinion about the relative speed at which contaminant migration may be occurring.

### ROCK STRATIGRAPHIC UNIT

Era: Mesozoic  
System: Lower Jurassic and Upper Triassic  
Series: Lower Mesozoic  
Code: IMze (*decoded above as Era, System & Series*)

### GEOLOGIC AGE IDENTIFICATION

Category: Eugeosynclinal Deposits

Geologic Age and Rock Stratigraphic Unit Source: P.G. Schruben, R.E. Arndt and W.J. Bawiec, Geology of the Conterminous U.S. at 1:2,500,000 Scale - a digital representation of the 1974 P.B. King and H.M. Beikman Map, USGS Digital Data Series DDS - 11 (1994).

## DOMINANT SOIL COMPOSITION IN GENERAL AREA OF TARGET PROPERTY

The U.S. Department of Agriculture's (USDA) Soil Conservation Service (SCS) leads the National Cooperative Soil Survey (NCSS) and is responsible for collecting, storing, maintaining and distributing soil survey information for privately owned lands in the United States. A soil map in a soil survey is a representation of soil patterns in a landscape. Soil maps for STATSGO are compiled by generalizing more detailed (SSURGO) soil survey maps. The following information is based on Soil Conservation Service STATSGO data.

Soil Component Name: MOTTSVILLE VARIANT

Soil Surface Texture: loamy sand

Hydrologic Group: Class A - High infiltration rates. Soils are deep, well drained to excessively drained sands and gravels.

Soil Drainage Class: Excessively. Soils have very high and high hydraulic conductivity and low water holding capacity. Depth to water table is more than 6 feet.

Hydric Status: Soil does not meet the requirements for a hydric soil.

Corrosion Potential - Uncoated Steel: MODERATE

Depth to Bedrock Min: > 60 inches

Depth to Bedrock Max: > 60 inches

## GEOCHECK® - PHYSICAL SETTING SOURCE SUMMARY

Soil Layer Information							
Layer	Boundary		Soil Texture Class	Classification		Permeability Rate (in/hr)	Soil Reaction (pH)
	Upper	Lower		AASHTO Group	Unified Soil		
1	0 inches	30 inches	loamy sand	Granular materials (35 pct. or less passing No. 200), Stone Fragments, Gravel and Sand.	COARSE-GRAINED SOILS, Sands, Sands with fines, Silty Sand.	Max: 20.00 Min: 6.00	Max: 6.50 Min: 5.60
2	30 inches	60 inches	stratified	Granular materials (35 pct. or less passing No. 200), Stone Fragments, Gravel and Sand.	COARSE-GRAINED SOILS, Sands, Clean Sands, Poorly graded sand. COARSE-GRAINED SOILS, Sands, Sands with fines, Silty Sand.	Max: 20.00 Min: 6.00	Max: 7.30 Min: 6.10

### OTHER SOIL TYPES IN AREA

Based on Soil Conservation Service STATSGO data, the following additional subordinant soil types may appear within the general area of target property.

Soil Surface Textures: sandy loam  
 gravelly - sandy loam  
 fine sandy loam  
 loam  
 very gravelly - coarse sand

Surficial Soil Types: sandy loam  
 gravelly - sandy loam  
 fine sandy loam  
 loam  
 very gravelly - coarse sand

Shallow Soil Types: No Other Soil Types

Deeper Soil Types: gravelly - fine sandy loam  
 fine sandy loam

### LOCAL / REGIONAL WATER AGENCY RECORDS

EDR Local/Regional Water Agency records provide water well information to assist the environmental professional in assessing sources that may impact ground water flow direction, and in forming an opinion about the impact of contaminant migration on nearby drinking water wells.

# GEOCHECK® - PHYSICAL SETTING SOURCE SUMMARY

## WELL SEARCH DISTANCE INFORMATION

<u>DATABASE</u>	<u>SEARCH DISTANCE (miles)</u>
Federal USGS	1.000
Federal FRDS PWS	Nearest PWS within 1 mile
State Database	1.000

## **FEDERAL USGS WELL INFORMATION**

<u>MAP ID</u>	<u>WELL ID</u>	<u>LOCATION FROM TP</u>
1	USGS3105917	1/4 - 1/2 Mile WSW
A3	USGS3105935	1/4 - 1/2 Mile NNE
9	USGS3105898	1/2 - 1 Mile SE
E11	USGS3105943	1/2 - 1 Mile North
D13	USGS3105931	1/2 - 1 Mile ENE
F15	USGS3105947	1/2 - 1 Mile NNE
16	USGS3105948	1/2 - 1 Mile NNW
G17	USGS3105953	1/2 - 1 Mile NNW
H20	USGS3105950	1/2 - 1 Mile NNE

## **FEDERAL FRDS PUBLIC WATER SUPPLY SYSTEM INFORMATION**

<u>MAP ID</u>	<u>WELL ID</u>	<u>LOCATION FROM TP</u>
No PWS System Found		

Note: PWS System location is not always the same as well location.

## **STATE DATABASE WELL INFORMATION**

<u>MAP ID</u>	<u>WELL ID</u>	<u>LOCATION FROM TP</u>
A2	CADW10000001609	1/4 - 1/2 Mile NNE
B4	10171	1/4 - 1/2 Mile ENE
B5	10172	1/4 - 1/2 Mile ENE
B6	10588	1/4 - 1/2 Mile ENE
C7	10168	1/2 - 1 Mile WNW
C8	10169	1/2 - 1 Mile WNW
D10	CADW10000001581	1/2 - 1 Mile ENE
E12	CADW10000001651	1/2 - 1 Mile NNW
F14	CADW10000001668	1/2 - 1 Mile North
H18	CADW10000001672	1/2 - 1 Mile NNE
G19	CADW10000001690	1/2 - 1 Mile NNW



# PHYSICAL SETTING SOURCE MAP - 2051958.2s

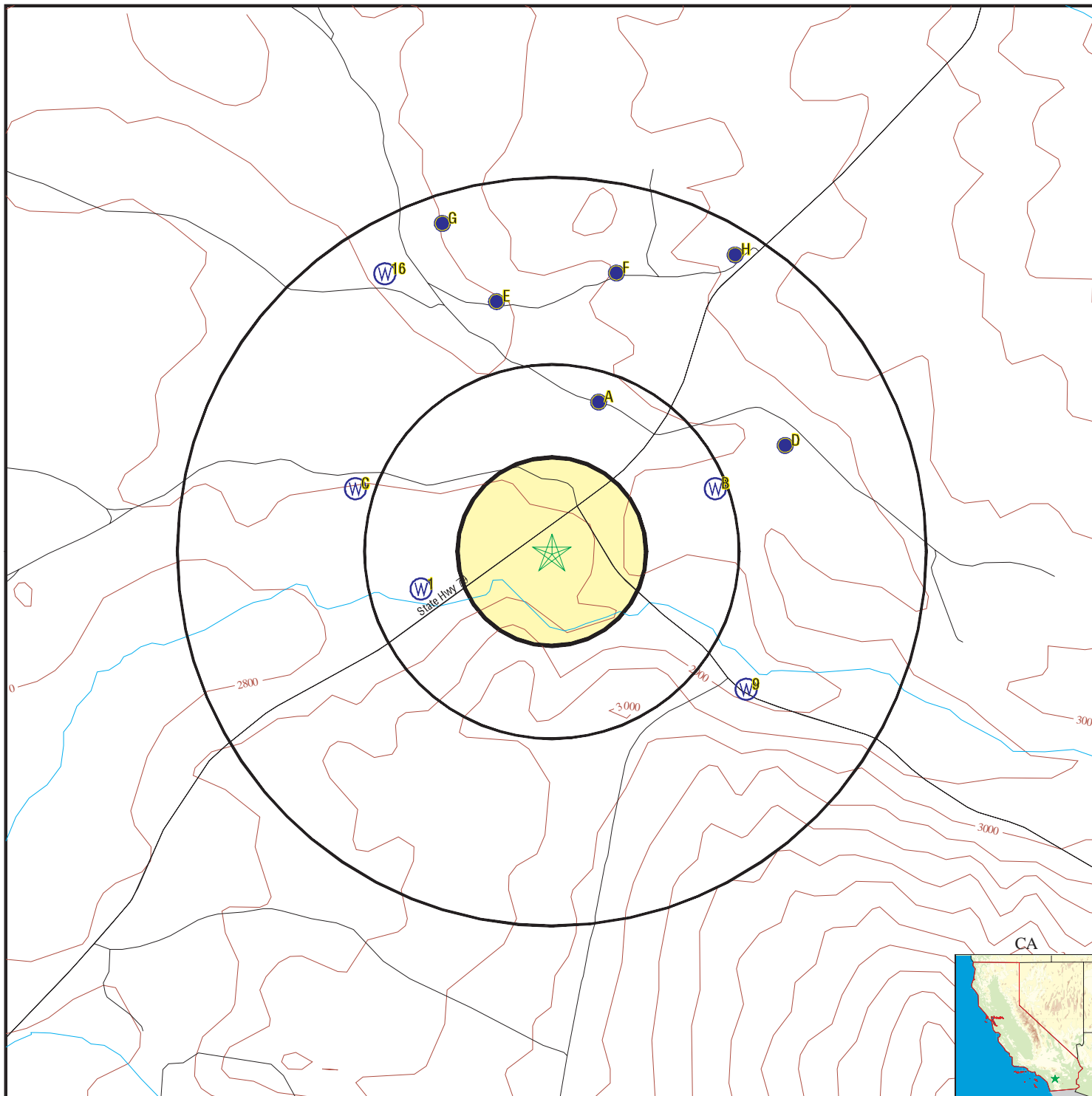

- County Boundary
- Major Roads
- Contour Lines
- Earthquake Fault Lines
- Earthquake epicenter, Richter 5 or greater
- Water Wells
- Public Water Supply Wells
- Cluster of Multiple Icons

- Groundwater Flow Direction
- Indeterminate Groundwater Flow at Location
- Groundwater Flow Varies at Location
- Closest Hydrogeological Data
- Oil, gas or related wells



SITE NAME: Warner Substation  
 ADDRESS: Hwy 79/SR 2  
 WARNER SPRINGS CA 92086  
 LAT/LONG: 33.2476 / 116.6751

CLIENT: Geotechnical Const. Inc.  
 CONTACT: Aurie Patterson  
 INQUIRY #: 2051958.2s  
 DATE: October 12, 2007 3:37 pm

# GEOCHECK® - PHYSICAL SETTING SOURCE MAP FINDINGS

Map ID  
 Direction  
 Distance  
 Elevation

Database      EDR ID Number

**1**  
**WSW**  
**1/4 - 1/2 Mile**  
**Lower**

**FED USGS      USGS3105917**

Agency cd:	USGS	Site no:	331446116404901
Site name:	011S003E04Z001S		
Latitude:	331446		
Longitude:	1164049	Dec lat:	33.24614978
Dec lon:	-116.68113139	Coor meth:	M
Coor accr:	U	Latlong datum:	NAD27
Dec latlong datum:	NAD83	District:	06
State:	06	County:	073
Country:	US	Land net:	Not Reported
Location map:	Not Reported	Map scale:	Not Reported
Altitude:	2798.00		
Altitude method:	Interpolated from topographic map		
Altitude accuracy:	20		
Altitude datum:	National Geodetic Vertical Datum of 1929		
Hydrologic:	San Luis ReyEscondido. California. Area = 766 sq.mi.		
Topographic:	Undulating		
Site type:	Ground-water other than Spring	Date construction:	Not Reported
Date inventoried:	Not Reported	Mean greenwich time offset:	PST
Local standard time flag:	Y		
Type of ground water site:	Single well, other than collector or Ranney type		
Aquifer Type:	Not Reported		
Aquifer:	Not Reported		
Well depth:	Not Reported	Hole depth:	Not Reported
Source of depth data:	Not Reported		
Project number:	Not Reported		
Real time data flag:	Not Reported	Daily flow data begin date:	Not Reported
Daily flow data end date:	Not Reported	Daily flow data count:	Not Reported
Peak flow data begin date:	Not Reported	Peak flow data end date:	Not Reported
Peak flow data count:	Not Reported	Water quality data begin date:	Not Reported
Water quality data end date:	Not Reported	Water quality data count:	Not Reported
Ground water data begin date:	Not Reported	Ground water data end date:	Not Reported
Ground water data count:	Not Reported		

Ground-water levels, Number of Measurements: 0

**A2**  
**NNE**  
**1/4 - 1/2 Mile**  
**Higher**

**CA WELLS      CADW1000001609**

Longn:	-116.6725
Latn:	33.2534
Stwellno:	11S03E04A001S
Districtco:	3
Wellusecod:	Z
Countycode:	37
Gwcode:	900800
Site id:	CADW1000001609

# GEOCHECK® - PHYSICAL SETTING SOURCE MAP FINDINGS

Map ID  
Direction  
Distance  
Elevation

Database      EDR ID Number

**A3**  
**NNE**  
**1/4 - 1/2 Mile**  
**Higher**

**FED USGS      USGS3105935**

Agency cd:	USGS	Site no:	331512116401801
Site name:	011S003E04A001S		
Latitude:	331512		
Longitude:	1164018	Dec lat:	33.25337176
Dec lon:	-116.67252006	Coor meth:	M
Coor accr:	U	Latlong datum:	NAD27
Dec latlong datum:	NAD83	District:	06
State:	06	County:	073
Country:	US	Land net:	Not Reported
Location map:	Not Reported	Map scale:	Not Reported
Altitude:	2856.00		
Altitude method:	Level or other surveying method		
Altitude accuracy:	20		
Altitude datum:	National Geodetic Vertical Datum of 1929		
Hydrologic:	San Luis ReyEscondido. California. Area = 766 sq.mi.		
Topographic:	Undulating		
Site type:	Ground-water other than Spring	Date construction:	1951
Date inventoried:	Not Reported	Mean greenwich time offset:	PST
Local standard time flag:	Y		
Type of ground water site:	Single well, other than collector or Ranney type		
Aquifer Type:	Not Reported		
Aquifer:	Not Reported		
Well depth:	411	Hole depth:	455
Source of depth data:	Not Reported		
Project number:	Not Reported		
Real time data flag:	0	Daily flow data begin date:	0000-00-00
Daily flow data end date:	0000-00-00	Daily flow data count:	0
Peak flow data begin date:	0000-00-00	Peak flow data end date:	0000-00-00
Peak flow data count:	0	Water quality data begin date:	0000-00-00
Water quality data end date:	0000-00-00	Water quality data count:	0
Ground water data begin date:	1967-05-01	Ground water data end date:	1967-05-01
Ground water data count:	1		

Ground-water levels, Number of Measurements: 1

Date	Feet below Surface	Feet to Sealevel
-----		
1967-05-01	138.00	

**B4**  
**ENE**  
**1/4 - 1/2 Mile**  
**Higher**

**CA WELLS      10171**

**Water System Information:**

Prime Station Code:	10S/03E-33Q01 S	User ID:	WAT
FRDS Number:	3710027015	County:	San Diego
District Number:	14	Station Type:	WELL/AMBNT/MUN/INTAKE/SUPPLY
Water Type:	Well/Groundwater	Well Status:	Inactive Untreated
Source Lat/Long:	331500.0 1164000.0	Precision:	Undefined
Source Name:	WELL 50 - INACTIVE		

## GEOCHECK® - PHYSICAL SETTING SOURCE MAP FINDINGS

System Number: 3710027  
 System Name: Vista Irrigation District  
 Organization That Operates System:  
 202 W. Connecticut Ave.  
 Vista, CA 92083  
 Pop Served: 90100  
 Area Served: VISTA  
 Connections: 23794

**B5**  
**ENE**  
 1/4 - 1/2 Mile  
 Higher

**CA WELLS 10172**

**Water System Information:**

Prime Station Code: 10S/03E-34N01 S	User ID: WAT
FRDS Number: 3710027017	County: San Diego
District Number: 14	Station Type: WELL/AMBNT/MUN/INTAKE/SUPPLY
Water Type: Well/Groundwater	Well Status: Inactive Untreated
Source Lat/Long: 331500.0 1164000.0	Precision: Undefined
Source Name: WELL 59 - INACTIVE	
System Number: 3710027	
System Name: Vista Irrigation District	
Organization That Operates System: 202 W. Connecticut Ave. Vista, CA 92083	
Pop Served: 90100	Connections: 23794
Area Served: VISTA	

**B6**  
**ENE**  
 1/4 - 1/2 Mile  
 Higher

**CA WELLS 10588**

**Water System Information:**

Prime Station Code: 11S/03E-03D01 S	User ID: WAT
FRDS Number: 3710027024	County: San Diego
District Number: 14	Station Type: WELL/AMBNT/MUN/INTAKE/SUPPLY
Water Type: Well/Groundwater	Well Status: Inactive Untreated
Source Lat/Long: 331500.0 1164000.0	Precision: Undefined
Source Name: WELL 80 - INACTIVE	
System Number: 3710027	
System Name: Vista Irrigation District	
Organization That Operates System: 202 W. Connecticut Ave. Vista, CA 92083	
Pop Served: 90100	Connections: 23794
Area Served: VISTA	

**C7**  
**WNW**  
 1/2 - 1 Mile  
 Higher

**CA WELLS 10168**

**Water System Information:**

Prime Station Code: 10S/03E-33P02 S	User ID: WAT
FRDS Number: 3710027013	County: San Diego
District Number: 14	Station Type: WELL/AMBNT/MUN/INTAKE/SUPPLY
Water Type: Well/Groundwater	Well Status: Inactive Untreated
Source Lat/Long: 331500.0 1164100.0	Precision: Undefined
Source Name: WELL 48 - INACTIVE	

## GEOCHECK® - PHYSICAL SETTING SOURCE MAP FINDINGS

System Number: 3710027  
 System Name: Vista Irrigation District  
 Organization That Operates System:  
 202 W. Connecticut Ave.  
 Vista, CA 92083  
 Pop Served: 90100  
 Area Served: VISTA  
 Connections: 23794

**C8**  
**WNW**  
**1/2 - 1 Mile**  
**Higher**

**CA WELLS 10169**

**Water System Information:**

Prime Station Code: 10S/03E-33P03 S	User ID: WAT
FRDS Number: 3710027014	County: San Diego
District Number: 14	Station Type: WELL/AMBNT/MUN/INTAKE/SUPPLY
Water Type: Well/Groundwater	Well Status: Inactive Untreated
Source Lat/Long: 331500.0 1164100.0	Precision: Undefined
Source Name: WELL 49 - INACTIVE	
System Number: 3710027	
System Name: Vista Irrigation District	
Organization That Operates System: 202 W. Connecticut Ave. Vista, CA 92083	
Pop Served: 90100	Connections: 23794
Area Served: VISTA	

**9**  
**SE**  
**1/2 - 1 Mile**  
**Higher**

**FED USGS USGS3105898**

Agency cd: USGS	Site no: 331432116395501
Site name: 011S003E03N001S	
Latitude: 331432	
Longitude: 1163955	Dec lat: 33.24226101
Dec lon: -116.66613109	Coor meth: M
Coor accr: U	Latlong datum: NAD27
Dec latlong datum: NAD83	District: 06
State: 06	County: 073
Country: US	Land net: Not Reported
Location map: Not Reported	Map scale: Not Reported
Altitude: 2890.00	
Altitude method: Interpolated from topographic map	
Altitude accuracy: 20	
Altitude datum: National Geodetic Vertical Datum of 1929	
Hydrologic: San Luis ReyEscondido. California. Area = 766 sq.mi.	
Topographic: Valley flat	
Site type: Ground-water other than Spring	Date construction: Not Reported
Date inventoried: Not Reported	Mean greenwich time offset: PST
Local standard time flag: Y	
Type of ground water site: Single well, other than collector or Ranney type	
Aquifer Type: Not Reported	
Aquifer: Not Reported	
Well depth: Not Reported	Hole depth: Not Reported
Source of depth data: Not Reported	
Project number: Not Reported	
Real time data flag: 0	Daily flow data begin date: 0000-00-00
Daily flow data end date: 0000-00-00	Daily flow data count: 0
Peak flow data begin date: 0000-00-00	Peak flow data end date: 0000-00-00

## GEOCHECK® - PHYSICAL SETTING SOURCE MAP FINDINGS

Peak flow data count: 0	Water quality data begin date: 1971-10-04
Water quality data end date: 1972-09-18	Water quality data count: 2
Ground water data begin date: 0000-00-00	Ground water data end date: 0000-00-00
Ground water data count: 0	

Ground-water levels, Number of Measurements: 0

**D10  
ENE  
1/2 - 1 Mile  
Higher**

**CA WELLS      CADW10000001581**

Longn:	-116.6639
Latn:	33.2517
Stwellno:	11S03E03F001S
Districtco:	3
Wellusecod:	Z
Countycode:	37
Gwcode:	900800
Site id:	CADW10000001581

**E11  
North  
1/2 - 1 Mile  
Higher**

**FED USGS      USGS3105943**

Agency cd:	USGS	Site no:	331526116403501
Site name:	010S003E33P001S		
Latitude:	331526		
Longitude:	1164035	Dec lat:	33.25726052
Dec lon:	-116.67724237	Coor meth:	M
Coor accr:	U	Latlong datum:	NAD27
Dec latlong datum:	NAD83	District:	06
State:	06	County:	073
Country:	US	Land net:	Not Reported
Location map:	Not Reported	Map scale:	Not Reported
Altitude:	2839.00		
Altitude method:	Level or other surveying method		
Altitude accuracy:	20		
Altitude datum:	National Geodetic Vertical Datum of 1929		
Hydrologic:	San Luis ReyEscondido. California. Area = 766 sq.mi.		
Topographic:	Undulating		
Site type:	Ground-water other than Spring	Date construction:	1951
Date inventoried:	Not Reported	Mean greenwich time offset:	PST
Local standard time flag:	Y		
Type of ground water site:	Single well, other than collector or Ranney type		
Aquifer Type:	Not Reported		
Aquifer:	Not Reported		
Well depth:	430	Hole depth:	455
Source of depth data:	Not Reported		
Project number:	Not Reported		
Real time data flag:	0	Daily flow data begin date:	0000-00-00
Daily flow data end date:	0000-00-00	Daily flow data count:	0
Peak flow data begin date:	0000-00-00	Peak flow data end date:	0000-00-00
Peak flow data count:	0	Water quality data begin date:	1953-07-09
Water quality data end date:	1970-05-04	Water quality data count:	6
Ground water data begin date:	1967-05-01	Ground water data end date:	1967-05-01
Ground water data count:	1		

# GEOCHECK® - PHYSICAL SETTING SOURCE MAP FINDINGS

Ground-water levels, Number of Measurements: 1

Date	Feet below Surface	Feet to Sealevel
1967-05-01	116.00	

**E12  
NNW  
1/2 - 1 Mile  
Higher**

**CA WELLS      CADW10000001651**

Longn: -116.6772  
 Latn: 33.2573  
 Stwellno: 10S03E33P001S  
 Districtco: 3  
 Wellusecod: Z  
 Countycode: 37  
 Gwcode: 900800  
 Site id: CADW10000001651

**D13  
ENE  
1/2 - 1 Mile  
Higher**

**FED USGS      USGS3105931**

Agency cd:	USGS	Site no:	331506116394701
Site name:	011S003E03F001S		
Latitude:	331506		
Longitude:	1163947	Dec lat:	33.25170514
Dec lon:	-116.66390877	Coor meth:	M
Coor accr:	U	Latlong datum:	NAD27
Dec latlong datum:	NAD83	District:	06
State:	06	County:	073
Country:	US	Land net:	Not Reported
Location map:	Not Reported	Map scale:	Not Reported
Altitude:	2910.00		
Altitude method:	Interpolated from topographic map		
Altitude accuracy:	20		
Altitude datum:	National Geodetic Vertical Datum of 1929		
Hydrologic:	San Luis ReyEscondido. California. Area = 766 sq.mi.		
Topographic:	Undulating		
Site type:	Ground-water other than Spring	Date construction:	1957
Date inventoried:	Not Reported	Mean greenwich time offset:	PST
Local standard time flag:	Y		
Type of ground water site:	Single well, other than collector or Ranney type		
Aquifer Type:	Not Reported		
Aquifer:	Not Reported		
Well depth:	898	Hole depth:	898
Source of depth data:	Not Reported		
Project number:	Not Reported		
Real time data flag:	0	Daily flow data begin date:	0000-00-00
Daily flow data end date:	0000-00-00	Daily flow data count:	0
Peak flow data begin date:	0000-00-00	Peak flow data end date:	0000-00-00
Peak flow data count:	0	Water quality data begin date:	1968-09-25
Water quality data end date:	1970-12-24	Water quality data count:	2
Ground water data begin date:	1967-05-01	Ground water data end date:	1967-05-01
Ground water data count:	1		

# GEOCHECK® - PHYSICAL SETTING SOURCE MAP FINDINGS

Ground-water levels, Number of Measurements: 1

Date	Feet below Surface	Feet to Sealevel
1967-05-01	93.00	

**F14  
North  
1/2 - 1 Mile  
Higher**

**CA WELLS      CADW10000001668**

Longn: -116.6717  
 Latn: 33.2584  
 Stwellno: 10S03E33R001S  
 Districtco: 3  
 Wellusecod: Z  
 Countycode: 37  
 Gwcode: 900800  
 Site id: CADW10000001668

**F15  
NNE  
1/2 - 1 Mile  
Higher**

**FED USGS      USGS3105947**

Agency cd:	USGS	Site no:	331530116401501
Site name:	010S003E33R001S		
Latitude:	331530		
Longitude:	1164015	Dec lat:	33.25837159
Dec lon:	-116.67168669	Coord meth:	M
Coord accr:	U	Latlong datum:	NAD27
Dec latlong datum:	NAD83	District:	06
State:	06	County:	073
Country:	US	Land net:	Not Reported
Location map:	Not Reported	Map scale:	Not Reported
Altitude:	2890.00		
Altitude method:	Interpolated from topographic map		
Altitude accuracy:	20		
Altitude datum:	National Geodetic Vertical Datum of 1929		
Hydrologic:	San Luis ReyEscondido. California. Area = 766 sq.mi.		
Topographic:	Undulating		
Site type:	Ground-water other than Spring	Date construction:	1951
Date inventoried:	Not Reported	Mean greenwich time offset:	PST
Local standard time flag:	Y		
Type of ground water site:	Single well, other than collector or Ranney type		
Aquifer Type:	Not Reported		
Aquifer:	Not Reported		
Well depth:	456	Hole depth:	465
Source of depth data:	Not Reported		
Project number:	Not Reported		
Real time data flag:	0	Daily flow data begin date:	0000-00-00
Daily flow data end date:	0000-00-00	Daily flow data count:	0
Peak flow data begin date:	0000-00-00	Peak flow data end date:	0000-00-00
Peak flow data count:	0	Water quality data begin date:	1968-09-25
Water quality data end date:	1970-05-04	Water quality data count:	2
Ground water data begin date:	1967-05-01	Ground water data end date:	1967-05-01
Ground water data count:	1		



## GEOCHECK® - PHYSICAL SETTING SOURCE MAP FINDINGS

Ground-water levels, Number of Measurements: 1

Date	Feet below Surface	Feet to Sealevel
-----		
1967-05-01	144.00	

**16  
NNW  
1/2 - 1 Mile  
Higher**

**FED USGS      USGS3105948**

Agency cd:	USGS	Site no:	331530116405501
Site name:	010S003E33M001S		
Latitude:	331530		
Longitude:	1164055	Dec lat:	33.2583716
Dec lon:	-116.68279804	Coor meth:	M
Coor accr:	U	Latlong datum:	NAD27
Dec latlong datum:	NAD83	District:	06
State:	06	County:	073
Country:	US	Land net:	Not Reported
Location map:	Not Reported	Map scale:	Not Reported
Altitude:	2840.00		
Altitude method:	Interpolated from topographic map		
Altitude accuracy:	20		
Altitude datum:	National Geodetic Vertical Datum of 1929		
Hydrologic:	San Luis ReyEscondido. California. Area = 766 sq.mi.		
Topographic:	Not Reported		
Site type:	Ground-water other than Spring	Date construction:	Not Reported
Date inventoried:	Not Reported	Mean greenwich time offset:	PST
Local standard time flag:	Y		
Type of ground water site:	Single well, other than collector or Ranney type		
Aquifer Type:	Not Reported		
Aquifer:	Not Reported		
Well depth:	Not Reported	Hole depth:	Not Reported
Source of depth data:	Not Reported		
Project number:	Not Reported		
Real time data flag:	Not Reported	Daily flow data begin date:	Not Reported
Daily flow data end date:	Not Reported	Daily flow data count:	Not Reported
Peak flow data begin date:	Not Reported	Peak flow data end date:	Not Reported
Peak flow data count:	Not Reported	Water quality data begin date:	Not Reported
Water quality data end date:	Not Reported	Water quality data count:	Not Reported
Ground water data begin date:	Not Reported		
Ground water data count:	Not Reported		

Ground-water levels, Number of Measurements: 0

**G17  
NNW  
1/2 - 1 Mile  
Higher**

**FED USGS      USGS3105953**

# GEOCHECK® - PHYSICAL SETTING SOURCE MAP FINDINGS

Agency cd:	USGS	Site no:	331537116404401
Site name:	010S003E33L001S		
Latitude:	331537		
Longitude:	1164044	Dec lat:	33.26031598
Dec lon:	-116.67974241	Coor meth:	M
Coor accr:	U	Latlong datum:	NAD27
Dec latlong datum:	NAD83	District:	06
State:	06	County:	073
Country:	US	Land net:	Not Reported
Location map:	Not Reported	Map scale:	Not Reported
Altitude:	2855.00		
Altitude method:	Interpolated from topographic map		
Altitude accuracy:	20		
Altitude datum:	National Geodetic Vertical Datum of 1929		
Hydrologic:	San Luis ReyEscondido. California. Area = 766 sq.mi.		
Topographic:	Undulating		
Site type:	Ground-water other than Spring	Date construction:	1951
Date inventoried:	Not Reported	Mean greenwich time offset:	PST
Local standard time flag:	Y		
Type of ground water site:	Single well, other than collector or Ranney type		
Aquifer Type:	Not Reported		
Aquifer:	Not Reported		
Well depth:	410	Hole depth:	455
Source of depth data:	Not Reported		
Project number:	Not Reported		
Real time data flag:	0	Daily flow data begin date:	0000-00-00
Daily flow data end date:	0000-00-00	Daily flow data count:	0
Peak flow data begin date:	0000-00-00	Peak flow data end date:	0000-00-00
Peak flow data count:	0	Water quality data begin date:	1954-09-02
Water quality data end date:	1970-12-24	Water quality data count:	2
Ground water data begin date:	1967-05-01	Ground water data end date:	1967-05-01
Ground water data count:	1		

Ground-water levels, Number of Measurements: 1

Date	Feet below Surface	Feet to Sealevel
-----		
1967-05-01	117.00	

**H18  
NNE  
1/2 - 1 Mile  
Higher**

**CA WELLS      CADW10000001672**

Longn:	-116.6662
Latn:	33.2591
Stwellno:	10S03E34M001S
Districtco:	3
Wellusecod:	Z
Countycode:	37
Gwcode:	900800
Site id:	CADW10000001672

**G19  
NNW  
1/2 - 1 Mile  
Higher**

**CA WELLS      CADW10000001690**

# GEOCHECK® - PHYSICAL SETTING SOURCE MAP FINDINGS

Longn: -116.6797  
 Latn: 33.2603  
 Stwellno: 10S03E33L001S  
 Districtco: 3  
 Wellusecod: Z  
 Countycode: 37  
 Gwcode: 900800  
 Site id: CADW10000001690

**H2O**  
**NNE**  
**1/2 - 1 Mile**  
**Higher**

**FED USGS      USGS3105950**

Agency cd:	USGS	Site no:	331533116395601
Site name:	010S003E34M001S		
Latitude:	331532.7		
Longitude:	1163958.4	Dec lat:	33.25908333
Dec lon:	-116.66622222	Coor meth:	G
Coor accr:	5	Latlong datum:	NAD83
Dec latlong datum:	NAD83	District:	06
State:	06	County:	073
Country:	US	Land net:	Not Reported
Location map:	WARNER SPRINGS	Map scale:	24000
Altitude:	2958.00		
Altitude method:	Interpolated from topographic map		
Altitude accuracy:	20		
Altitude datum:	National Geodetic Vertical Datum of 1929		
Hydrologic:	San Luis ReyEscondido. California. Area = 766 sq.mi.		
Topographic:	Undulating		
Site type:	Ground-water other than Spring	Date construction:	19570111
Date inventoried:	20040629	Mean greenwich time offset:	PST
Local standard time flag:	Y		
Type of ground water site:	Single well, other than collector or Ranney type		
Aquifer Type:	Not Reported		
Aquifer:	Not Reported		
Well depth:	730	Hole depth:	892
Source of depth data:	driller		
Project number:	9677BHM22		
Real time data flag:	0		
Daily flow data end date:	0000-00-00	Daily flow data begin date:	0000-00-00
Daily flow data count:	0		
Peak flow data begin date:	0000-00-00	Peak flow data end date:	0000-00-00
Peak flow data count:	0		
Water quality data end date:	1970-12-24	Water quality data begin date:	1957-02-07
Water quality data count:	10		
Ground water data begin date:	1967-05-01	Ground water data end date:	1967-05-01
Ground water data count:	1		

Ground-water levels, Number of Measurements: 1

Date	Feet below Surface	Feet to Sealevel
----- 1967-05-01	128.00	

# GEOCHECK® - PHYSICAL SETTING SOURCE MAP FINDINGS RADON

## AREA RADON INFORMATION

Federal EPA Radon Zone for SAN DIEGO County: 3

- Note: Zone 1 indoor average level > 4 pCi/L.  
 : Zone 2 indoor average level  $\geq$  2 pCi/L and  $\leq$  4 pCi/L.  
 : Zone 3 indoor average level < 2 pCi/L.

---

Federal Area Radon Information for SAN DIEGO COUNTY, CA

Number of sites tested: 30

Area	Average Activity	% <4 pCi/L	% 4-20 pCi/L	% >20 pCi/L
Living Area - 1st Floor	0.677 pCi/L	100%	0%	0%
Living Area - 2nd Floor	0.400 pCi/L	100%	0%	0%
Basement	Not Reported	Not Reported	Not Reported	Not Reported

# PHYSICAL SETTING SOURCE RECORDS SEARCHED

## TOPOGRAPHIC INFORMATION

### **USGS 7.5' Digital Elevation Model (DEM)**

Source: United States Geologic Survey

EDR acquired the USGS 7.5' Digital Elevation Model in 2002 and updated it in 2006. The 7.5 minute DEM corresponds to the USGS 1:24,000- and 1:25,000-scale topographic quadrangle maps. The DEM provides elevation data with consistent elevation units and projection.

## HYDROLOGIC INFORMATION

**Flood Zone Data:** This data, available in select counties across the country, was obtained by EDR in 1999 from the Federal Emergency Management Agency (FEMA). Data depicts 100-year and 500-year flood zones as defined by FEMA.

**NWI:** National Wetlands Inventory. This data, available in select counties across the country, was obtained by EDR in 2002 and 2005 from the U.S. Fish and Wildlife Service.

## HYDROGEOLOGIC INFORMATION

### **AQUIFLOW<sup>R</sup> Information System**

Source: EDR proprietary database of groundwater flow information

EDR has developed the AQUIFLOW Information System (AIS) to provide data on the general direction of groundwater flow at specific points. EDR has reviewed reports submitted to regulatory authorities at select sites and has extracted the date of the report, hydrogeologically determined groundwater flow direction and depth to water table information.

## GEOLOGIC INFORMATION

### **Geologic Age and Rock Stratigraphic Unit**

Source: P.G. Schruben, R.E. Arndt and W.J. Bawiec, Geology of the Conterminous U.S. at 1:2,500,000 Scale - A digital representation of the 1974 P.B. King and H.M. Beikman Map, USGS Digital Data Series DDS - 11 (1994).

### **STATSGO: State Soil Geographic Database**

Source: Department of Agriculture, Natural Resources Conservation Services

The U.S. Department of Agriculture's (USDA) Natural Resources Conservation Service (NRCS) leads the national Conservation Soil Survey (NCSS) and is responsible for collecting, storing, maintaining and distributing soil survey information for privately owned lands in the United States. A soil map in a soil survey is a representation of soil patterns in a landscape. Soil maps for STATSGO are compiled by generalizing more detailed (SSURGO) soil survey maps.

### **SSURGO: Soil Survey Geographic Database**

Source: Department of Agriculture, Natural Resources Conservation Services (NRCS)

Telephone: 800-672-5559

SSURGO is the most detailed level of mapping done by the Natural Resources Conservation Services, mapping scales generally range from 1:12,000 to 1:63,360. Field mapping methods using national standards are used to construct the soil maps in the Soil Survey Geographic (SSURGO) database. SSURGO digitizing duplicates the original soil survey maps. This level of mapping is designed for use by landowners, townships and county natural resource planning and management.

## LOCAL / REGIONAL WATER AGENCY RECORDS

### **FEDERAL WATER WELLS**

#### **PWS: Public Water Systems**

Source: EPA/Office of Drinking Water

Telephone: 202-564-3750

Public Water System data from the Federal Reporting Data System. A PWS is any water system which provides water to at least 25 people for at least 60 days annually. PWSs provide water from wells, rivers and other sources.

# PHYSICAL SETTING SOURCE RECORDS SEARCHED

## **PWS ENF:** Public Water Systems Violation and Enforcement Data

Source: EPA/Office of Drinking Water

Telephone: 202-564-3750

Violation and Enforcement data for Public Water Systems from the Safe Drinking Water Information System (SDWIS) after August 1995. Prior to August 1995, the data came from the Federal Reporting Data System (FRDS).

## **USGS Water Wells:** USGS National Water Inventory System (NWIS)

This database contains descriptive information on sites where the USGS collects or has collected data on surface water and/or groundwater. The groundwater data includes information on wells, springs, and other sources of groundwater.

## **STATE RECORDS**

### **Water Well Database**

Source: Department of Water Resources

Telephone: 916-651-9648

### **California Drinking Water Quality Database**

Source: Department of Health Services

Telephone: 916-324-2319

The database includes all drinking water compliance and special studies monitoring for the state of California since 1984. It consists of over 3,200,000 individual analyses along with well and water system information.

## **OTHER STATE DATABASE INFORMATION**

### **California Oil and Gas Well Locations**

Source: Department of Conservation

Telephone: 916-323-1779

## **RADON**

### **State Database: CA Radon**

Source: Department of Health Services

Telephone: 916-324-2208

Radon Database for California

### **Area Radon Information**

Source: USGS

Telephone: 703-356-4020

The National Radon Database has been developed by the U.S. Environmental Protection Agency (USEPA) and is a compilation of the EPA/State Residential Radon Survey and the National Residential Radon Survey. The study covers the years 1986 - 1992. Where necessary data has been supplemented by information collected at private sources such as universities and research institutions.

### **EPA Radon Zones**

Source: EPA

Telephone: 703-356-4020

Sections 307 & 309 of IRAA directed EPA to list and identify areas of U.S. with the potential for elevated indoor radon levels.

## **OTHER**

### **Airport Landing Facilities:** Private and public use landing facilities

Source: Federal Aviation Administration, 800-457-6656

### **Epicenters:** World earthquake epicenters, Richter 5 or greater

Source: Department of Commerce, National Oceanic and Atmospheric Administration

**California Earthquake Fault Lines:** The fault lines displayed on EDR's Topographic map are digitized quaternary fault lines, prepared in 1975 by the United State Geological Survey. Additional information (also from 1975) regarding activity at specific fault lines comes from California's Preliminary Fault Activity Map prepared by the California Division of Mines and Geology.

# PHYSICAL SETTING SOURCE RECORDS SEARCHED

## STREET AND ADDRESS INFORMATION

© 2007 Tele Atlas North America, Inc. All rights reserved. This material is proprietary and the subject of copyright protection and other intellectual property rights owned by or licensed to Tele Atlas North America, Inc. The use of this material is subject to the terms of a license agreement. You will be held liable for any unauthorized copying or disclosure of this material.