

SEE SHEET 7

MATCH LINE SEE SHEET 6

× POINT DATA TABLE

POINT #	NORTHING	EASTING	REMARKS
603	1873221.6849	6428084.9600	SD CL
610	1873122.9833	6427781.7315	SD CL
700	1873439.9051	6428415.8111	TOP SLOPE
701	1873439.9051	6428165.6700	TOP SLOPE
702	1873450.3812	6428129.8067	TOP SLOPE
704	1873374.5282	6428415.8111	TOP SLOPE
705	1873369.3171	6428165.6700	TOP SLOPE
706	1873393.8644	6428087.1781	TOP SLOPE
708	1873302.8457	6428165.6700	TOP SLOPE
709	1873341.4836	6428047.6692	TOP SLOPE
710	1873433.5139	6427966.0646	TOP SLOPE
711	1873240.6596	6428107.5569	TOP SLOPE
712	1873279.3330	6428016.0640	TOP SLOPE
713	1873349.0233	6427945.3251	TOP SLOPE
714	1873218.0808	6428100.3112	TOE SLOPE
715	1873258.2770	6428001.9979	TOE SLOPE
716	1873332.4475	6427925.7945	TOE SLOPE
717	1873192.1974	6428095.6443	TOE SLOPE
718	1873223.7815	6427983.6477	TOE SLOPE
719	1873301.5604	6427892.6311	TOE SLOPE
720	1873158.1519	6428092.2365	TOP SLOPE
721	1873201.6651	6427970.8773	TOP SLOPE
722	1873285.2088	6427872.7541	TOP SLOPE
723	1873200.7033	6428121.2601	TOP SLOPE
724	1873354.1848	6427898.7864	TOP SLOPE
725	1873329.1604	6427903.2032	TOE SLOPE
726	1873205.1391	6428097.9778	TOE SLOPE

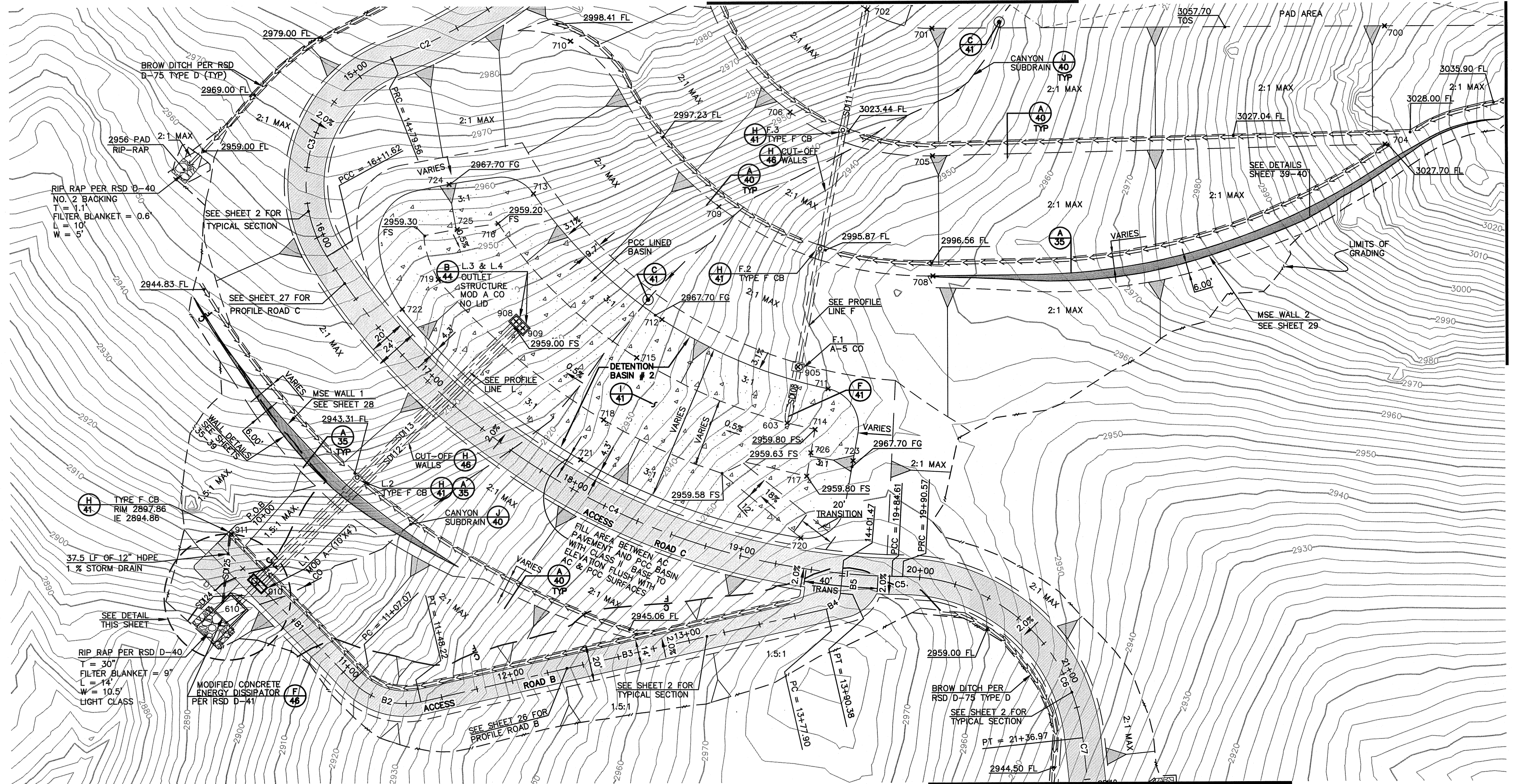

MATCH LINE SEE SHEET 6

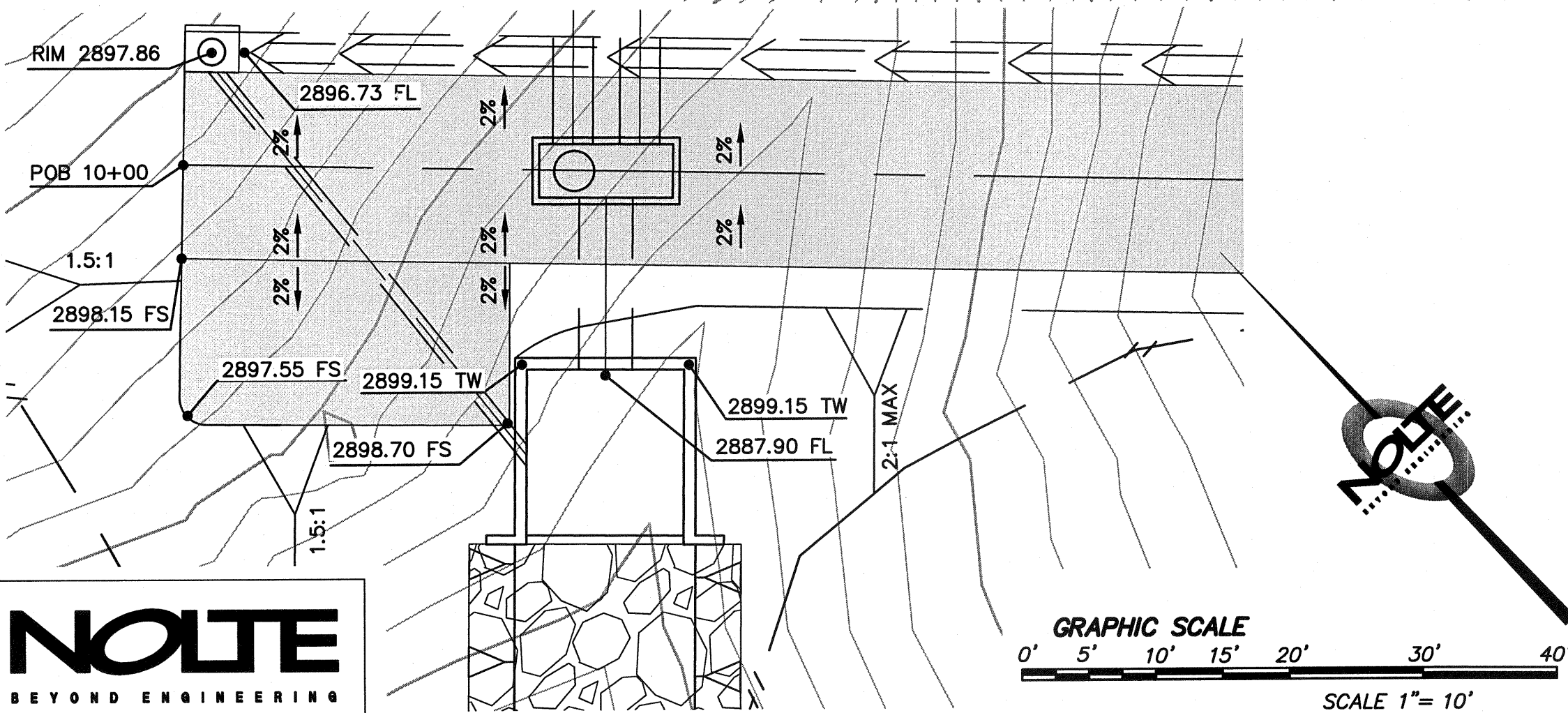

ROAD B CENTERLINE DATA TABLE

SYMBOL	DELTA/BEARING	RADIUS	LENGTH	REMARKS
B1	N43°52'31"W	...	107.07'	...
B2	S8°56'53"E	40.00'	41.15'	...
B3	N77°10'36"E	...	229.68'	...
B4	71°31'57"	10.00'	12.48'	...
B5	N5°38'40"E	...	11.09'	...

ROAD C CENTERLINE DATA TABLE

SYMBOL	DELTA/BEARING	RADIUS	LENGTH	REMARKS
C1	S1°19'01"	285.00'	255.26'	...
C2	S8°56'53"E	75.00'	132.06'	...
C3	100°53'32"E
C4	S6°23'13"	379.00'	372.99'	...
C5	N88°29'59"W	...	5.96'	...
C6	S3°52'45"	100.00'	146.40'	...
C7	N06°00'00"W	...	54.92'	...

STORMDRAIN DATA TABLE

SYMBOL	DELTA/BEARING	RADIUS	LENGTH	REMARKS
SD08	N10°57'32"E	...	29.68'	48" RCP
SD11	N10°57'32"E	...	207.41'	42" HDPE
SD12	N45°22'49"E	...	199.60'	36" HDPE
SD13	N45°22'49"E	...	199.60'	36" HDPE
SD14	N45°22'49"E	...	12.82'	48" RCP
SD25	N06°15'53"E	...	37.48'	12" HDPE

× CENTER POINT STORM DRAIN BOX DATA TABLE

POINT #	NORTHING	EASTING	REMARKS
905	1873252.7866	6428090.9825	CP SD BOX
908	1873278.4126	6427935.5602	CP SD BOX
909	1873274.7351	6427939.1893	CP SD BOX
910	1873133.3926	6427792.2798	CP SD BOX
911	1873160.8054	6427778.0494	CP SD BOX

NOTE: ALL STORM DRAIN LENGTHS ARE MEASURED ALONG PIPE CENTERLINE FROM INSIDE FACE TO INSIDE FACE ON CONCRETE STRUCTURE OR TO TERMINATION POINT AT CONCRETE HEADWALL. TABLE LENGTHS REPRESENT TOTAL PIPE LENGTH WHERE PIPES ARE SHOWN ON TWO PLAN SHEETS.

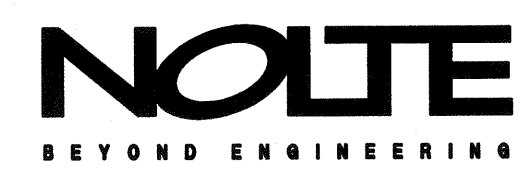
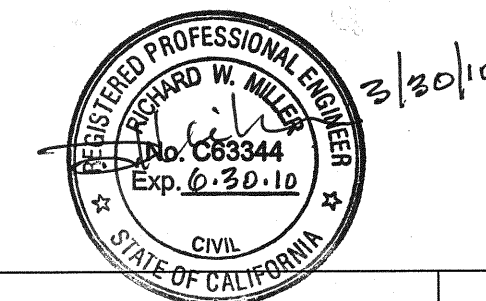
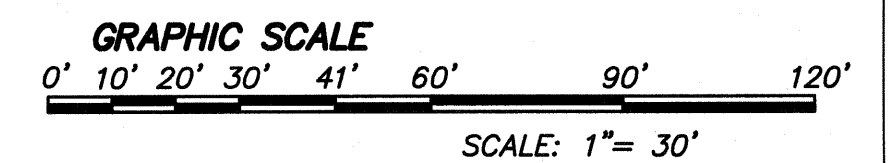

REVISIONS

NO.	WORK DONE	DATE:	BY:	APP'D:	NO.	WORK DONE	DATE:	BY:	APP'D:	NO.	WORK DONE	DATE:	BY:	APP'D:	NO.

SAN DIEGO GAS & ELECTRIC COMPANY
SAN DIEGO, CALIFORNIA

SUNCREST SUBSTATION

GRADING PLAN

DRAWN BY: MJ DATE: 3/24/10 SCALE: 1"=30' W.O.: - REV.: 0

CHECKED BY: RWM DATE: - SHEET 5 OF 66

APPROVED BY: CR DATE: -

CAD NO.: GPO5 PLOT SCALE: 1=1

SCR-C-005

N:\Projects\39600\CADD\USFS\Civil\GPO5.XREFS