



**COUNTY OF SAN MATEO  
DEPARTMENT OF PUBLIC WORKS**

555 County Center, 5th Floor  
Redwood City, CA 94063  
(650) 363-4100

Permit Number: DPW2016-00025  
Issued: 07/08/2016  
Inspection Request: (650) 599-7273 (Bayside) ✓  
(650) 599-7296 (Coast)

Do not begin construction without confirming date and time of inspection. Minimum notice is 48 hours to start. ✓

APPLICANT NAME: KAROLINA CHANGSEK  
SITE ADDRESS: 0 NEW YEARS CREEK RD

AREA: PESCADERO WEST

APPLICANT INFORMATION

CONTRACTOR INFORMATION

KAROLINA CHANGSEK  
K & B ENGINEERING  
290 Corporate Terrace Circle Suite 200  
Corona, CA 92879  
PHONE #1: 9518089501  
PHONE #2:

,  
PHONE #1:  
PHONE #2:

PROJECT NAME: UTILITY TRENCH FOR MAIN LINE

PROJECT DESCRIPTION: K & B Engineering and CROWN CASTEL USA, INC to excavate and install 194 linear feet of fiber optic cable and conduit along New years Creek Road. Also placement of a Crown Castle pull box as shown in attached plans. CALTRANS permit # 0416-6UL0177 issued on July 1, 2016. CDP per BLD2014-00194. Backfill per County Trenching Detail. Use Traffic Control per CA MUTCD/Caltrans ✓

TYPE OF PERMIT: Utility Trench

UNDERGROUND SERVICE ALERT (USE) NO.:

DATE OF USA INQUIRY:

SEWER DISTRICT:

COUNTY SIP REQ'D?: N

PERMIT EXPIRATION DATE: 10/31/2016

Utility Trench - for main line

\$1,638.00

FEE AMOUNT PAID:

\$1,638.00

The work authorized by this Permit shall be subject to all the terms, conditions, and restrictions set forth herein. This permit consists of the Special Provisions and Standard Details of San Mateo County as applicable, attached and made a part hereof. The project, as specifically described, is to be strictly construed and no other activity shall be permitted. **Notify County Road Inspector 48 hrs prior to starting work.**

The Permittee and/or his contractor shall indemnify and save harmless the County, its officers, agents, employees and servants from all claims, suits or actions of every name, kind and description, brought for, or on account of, injuries to or death of any person or damage to property resulting from the performance of any work authorized or required by this Permit of Permittee and/or his contractor, their officers, agents, employees and/or servants.

**INSURANCE**

Permittee is required to maintain property damage and liability insurance in amounts equivalent to or exceeding the legal minimums as a condition of this permit.

**APPROVAL BY DEPARTMENT OF PUBLIC WORKS**

This permit was issued by me on:

Date: 07/08/2016

Reviewed by: Adolfo Orellana

Signed:

**\*\* FOR OFFICE USE ONLY \*\***

Date Completed: \_\_\_\_\_

By: \_\_\_\_\_

DEPARTMENT OF PUBLIC WORKS



Road Operations - Permits
455 County Center, 2/FI.
Redwood City, CA 94063
(650) 363-1822

JAMES C. PORTER
Director of Public Works

DPW2016 - 00025

Date: \_\_\_\_\_
Plan Check #: \_\_\_\_\_
APN: \_\_\_\_\_

ENCROACHMENT PERMIT APPLICATION

To Whom It May Concern:

The undersigned hereby applied for permission to excavate, construct and/or otherwise encroach upon the Right-of-Way of the County of San Mateo road(s) listed:

DESCRIBED LOCATION OF PROPOSED ACTIVITY

Cabrillo HWY (CA-1) & New Years Creek Rd.

DESCRIBED PROPOSED ACTIVITY: <Attach site plan and sketch or scaled drawing>

Excavation for the installation of fiber optic cable in conduit; placement of Crown Castle pullbox, as shown on attached plans (976-DVNPT-B01-SMC). \*\*for all questions, redlines, fees and please contact Ken Gaunt (951) 970-5279\*\*

NOTE: State of California Government Code Sections 4216 through 4216.9 require an INQUIRY IDENTIFICATION NUMBER be assigned to every person planning to conduct an excavation in a Public Right-of-Way or Private Easement. If applicable, the applicant shall call the "USA" Regional Notification Center at 800-642-2444 a minimum of two (2) days prior to commencing that excavation. NO PERMIT TO EXCAVATE ISSUED BY SAN MATEO COUNTY SHALL BE VALID UNLESS THE APPLICANT HAS OBTAINED AN INQUIRY ID NUMBER FROM "USA."

PROPOSED ENCROACHMENT DATE(S): START 2/29/16 FINISH 3/11/16

Applicant agrees to accomplish the described activity in accordance with applicable County of San Mateo codes, regulations, restrictions and specifications and to be subject to inspection and approval by the Dept. of Public Works.

Applicant shall indemnify and save harmless the County, its officers, agents, employees and servants from all claims, suits or actions on every name, kind and description, brought for, or on account of, injuries to or death of any person or damage to property resulting from the performance of any work authorized or required by the County in conjunction with this request.

Applicant is required to maintain property damage and liability insurance in amounts equivalent to or exceeding the legal minimums as a condition of this permit.

APPLICANT COMPLETE

"USA" Inquiry

Date

USA Inquiry ID Number

PLEASE PRINT

Crown Castle

Applicant Name

222 E. Cabrillo St, Suite 107

Mailing Address

Santa Barbara, CA 93101

City, State Zip

(805) 704-4909

Area Code & Phone and email

Applicant Signature

kgaunt@kbgeng.net







PARK  
ENTRANCE  
0.5 MILE













**COUNTY OF SAN MATEO  
DEPARTMENT OF PUBLIC WORKS**

555 County Center, 5th Floor  
Redwood City, CA 94063  
(650) 363-4100

Permit Number: DPW2016-00784  
Issued: 07/06/2016  
Inspection Request: (650) 599-7273 (Bayside)   
(650) 599-7296 (Coast)

Do not begin construction without confirming date and time of inspection. Minimum notice is 48 hours to start.

APPLICANT NAME: KEN GAUNT

SITE ADDRESS: 6 Bean Hollow RD

AREA: PESCADERO

APPLICANT INFORMATION

CONTRACTOR INFORMATION

KEN GAUNT  
CROWN CASTLE USA INC.  
222 E. CABRILLO STREET SUITE 107  
SANTA BARBARA, CA 93101  
PHONE #1: 7244162000  
PHONE #2: 8057044909

PHONE #1:  
PHONE #2:

PROJECT NAME: TRAFFIC CONTROL

PROJECT DESCRIPTION: CROWN CASTLE USA INC. to traffic control for the attachment of fiber optic cable to existing utility poles along Bean Hollow Road. See attached plans, (976-DVNPT-E04-SMC) Use Traffic Control per CA MUTCD/Caltrans.

TYPE OF PERMIT: Other

**UNDERGROUND SERVICE ALERT (USE) NO.:**

**DATE OF USA INQUIRY:**

SEWER DISTRICT: undefined

COUNTY SIP REQ'D?: N

**PERMIT EXPIRATION DATE: 08/31/2016**

Road Encroachment Fee

\$106.00

**FEE AMOUNT PAID:**

**\$106.00**

The work authorized by this Permit shall be subject to all the terms, conditions, and restrictions set forth herein. This permit consists of the Special Provisions and Standard Details of San Mateo County as applicable, attached and made a part hereof. The project, as specifically described, is to be strictly construed and no other activity shall be permitted. **Notify County Road Inspector 48 hrs prior to starting work.**

The Permittee and/or his contractor shall indemnify and save harmless the County, its officers, agents, employees and servants from all claims, suits or actions of every name, kind and description, brought for, or on account of, injuries to or death of any person or damage to property resulting from the performance of any work authorized or required by this Permit of Permittee and/or his contractor, their officers, agents, employees and/or servants.

**INSURANCE**

Permittee is required to maintain property damage and liability insurance in amounts equivalent to or exceeding the legal minimums as a condition of this permit.

**APPROVAL BY DEPARTMENT OF PUBLIC WORKS**

This permit was issued by me on:

Date: 07/06/2016

Reviewed by: Adolfo Orellana

Signed:

**\*\* FOR OFFICE USE ONLY \*\***  
Date Completed: \_\_\_\_\_  
By: \_\_\_\_\_

DEPARTMENT OF PUBLIC WORKS



Road Operations - Permits  
455 County Center, 2/FI.  
Redwood City, CA 94063  
(650) 363-1822

JAMES C. PORTER  
Director of Public Works

DPW2014-00784

Date: \_\_\_\_\_  
Plan Check #: \_\_\_\_\_  
APN: \_\_\_\_\_

**ENCROACHMENT PERMIT APPLICATION**

To Whom It May Concern:

The undersigned hereby applied for permission to excavate, construct and/or otherwise encroach upon the Right-of-Way of the County of San Mateo road(s) listed:

**DESCRIBED LOCATION OF PROPOSED ACTIVITY**

Pigeon Point Rd.

**DESCRIBED PROPOSED ACTIVITY:** <Attach site plan and sketch or scaled drawing>

Attachment of fiber optic cable to existing utility poles, shown on attached plans (976-DVNPT-E04-SMC).

**\*\*for all questions, redlines, fees and please contact Ken Gaunt (951) 970-5279\*\***

NOTE: State of California Government Code Sections 4216 through 4216.9 require an INQUIRY IDENTIFICATION NUMBER be assigned to every person planning to conduct an excavation in a Public Right-of-Way or Private Easement. If applicable, the applicant shall call the "USA" Regional Notification Center at 800-642-2444 a minimum of two (2) days prior to commencing that excavation. **NO PERMIT TO EXCAVATE ISSUED BY SAN MATEO COUNTY SHALL BE VALID UNLESS THE APPLICANT HAS OBTAINED AN INQUIRY ID NUMBER FROM "USA."**

PROPOSED ENCROACHMENT DATE(S): START 08/01/16 FINISH 08/05/16

Applicant agrees to accomplish the described activity in accordance with applicable County of San Mateo codes, regulations, restrictions and specifications and to be subject to inspection and approval by the Dept. of Public Works.

\_\_\_\_\_ Applicant shall indemnify and save harmless the County, its officers, agents, employees and servants from all  
initials claims, suits or actions on every name, kind and description, brought for, or on account of, injuries to or death of  
any person or damage to property resulting from the performance of any work authorized or required by the County  
in conjunction with this request.

\_\_\_\_\_ Applicant is required to maintain property damage and liability insurance in amounts equivalent to or exceeding the  
initials legal minimums as a condition of this permit.

**APPLICANT COMPLETE**

**PLEASE PRINT**

"USA" Inquiry

Crown Castle

\_\_\_\_\_  
Date

Applicant Name

222 E. Cabrillo St, Suite 107

Mailing Address

Santa Barbara, CA 93101

City, State Zip

(805) 704-4909

Area Code & Phone and email

\_\_\_\_\_  
USA Inquiry ID Number

\_\_\_\_\_  
Applicant Signature







MATCH LINE "C" - "C"  
SEE BELOW LEFT

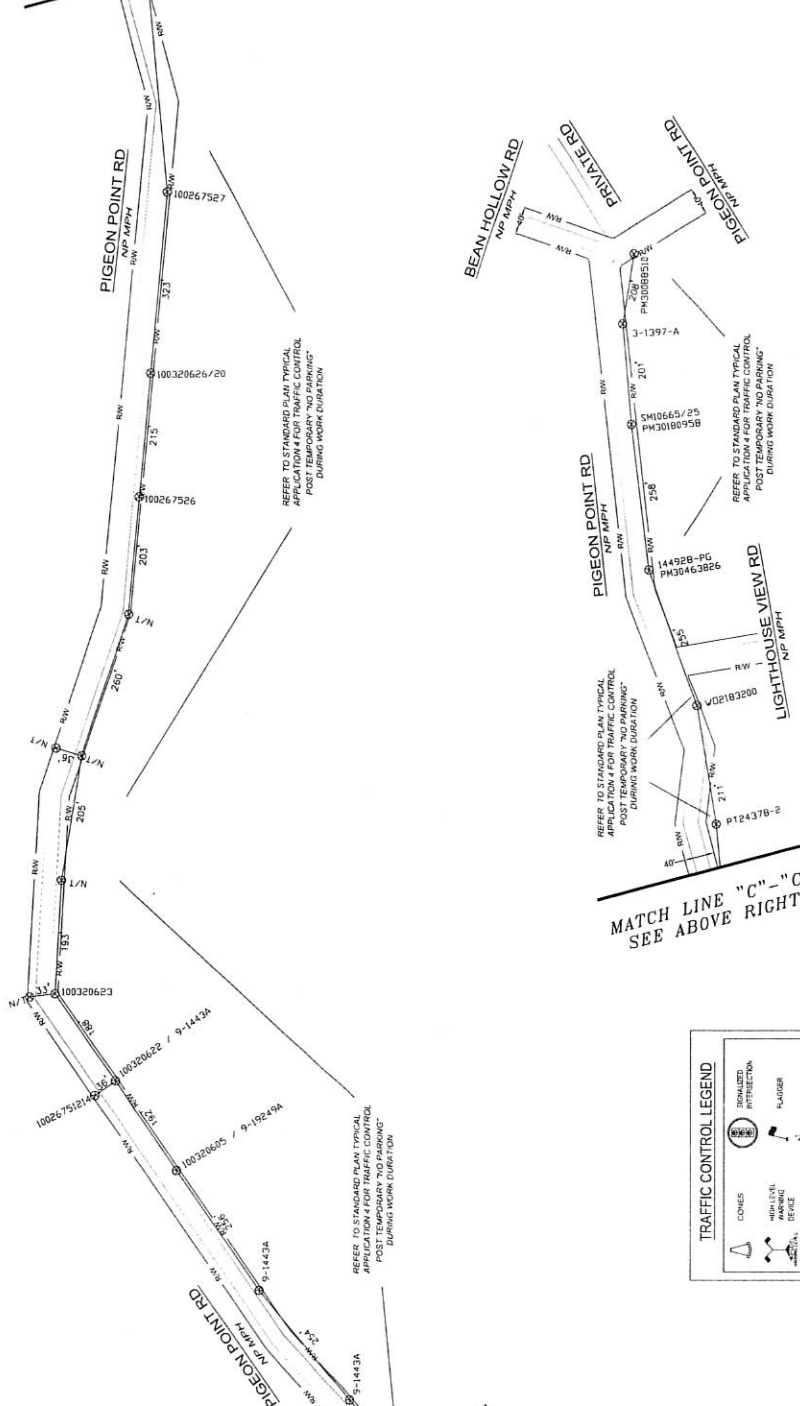

MATCH LINE "C" - "C"  
SEE ABOVE RIGHT

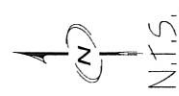
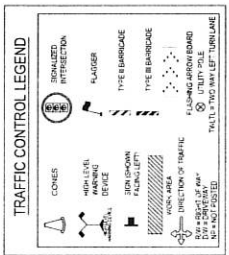

SCOPE OF WORK  
ATTACHMENT OF FIBER OPTIC  
CABLE TO EXISTING UTILITY POLES

**CROWN CASTLE #**  
VZ200796CADAVAFK05

TEMPORARY TRAFFIC CONTROL PLAN

DESIGNED BY: **KB ENGINEERING**  
280 CORPORATE TERRACE CIRCLE  
S.E. 200, BOCA RATON, FL 33433  
WWW.KBENG.NET  
TEL: 954-888-9501  
FAX: 954-888-9518

REVISIONS:

NO.	DATE	DESCRIPTION
1		

APPROVED BY: **DIGALERT**  
COUNTY OF SANYATEL  
PHONE: 954-271-1111  
PHONE NO. 911

TEMPORARY "NO PARKING" SIGNS SHALL BE INSTALLED  
AT LEAST 72 HOURS BEFORE ENFORCEMENT.

TEMPORARY TRAFFIC CONTROL PLAN

PROJECT: VZ200796CADAVAFK05  
DRAWN: [Name]  
CHECKED: [Name]  
DATE: [Date]

SCALE: AS SHOWN

DATE: 11/11/11

PROJECT: VZ200796CADAVAFK05

SCALE: AS SHOWN

DATE: 11/11/11

PROJECT: VZ200796CADAVAFK05

SCALE: AS SHOWN

DATE: 11/11/11

PROJECT: VZ200796CADAVAFK05

SCALE: AS SHOWN

DATE: 11/11/11

PROJECT: VZ200796CADAVAFK05

SCALE: AS SHOWN

DATE: 11/11/11

PROJECT: VZ200796CADAVAFK05

SCALE: AS SHOWN

DATE: 11/11/11

PROJECT: VZ200796CADAVAFK05

SCALE: AS SHOWN

DATE: 11/11/11

PROJECT: VZ200796CADAVAFK05

SCALE: AS SHOWN

DATE: 11/11/11

PROJECT: VZ200796CADAVAFK05

SCALE: AS SHOWN

DATE: 11/11/11

PROJECT: VZ200796CADAVAFK05

SCALE: AS SHOWN

DATE: 11/11/11

PROJECT: VZ200796CADAVAFK05

SCALE: AS SHOWN

DATE: 11/11/11

PROJECT: VZ200796CADAVAFK05

SCALE: AS SHOWN

DATE: 11/11/11

PROJECT: VZ200796CADAVAFK05

SCALE: AS SHOWN

DATE: 11/11/11

PROJECT: VZ200796CADAVAFK05

SCALE: AS SHOWN

DATE: 11/11/11

PROJECT: VZ200796CADAVAFK05

SCALE: AS SHOWN

DATE: 11/11/11

PROJECT: VZ200796CADAVAFK05

SCALE: AS SHOWN

DATE: 11/11/11

PROJECT: VZ200796CADAVAFK05

SCALE: AS SHOWN

DATE: 11/11/11

PROJECT: VZ200796CADAVAFK05

SCALE: AS SHOWN

DATE: 11/11/11

PROJECT: VZ200796CADAVAFK05

SCALE: AS SHOWN

DATE: 11/11/11

PROJECT: VZ200796CADAVAFK05

SCALE: AS SHOWN

DATE: 11/11/11

PROJECT: VZ200796CADAVAFK05

SCALE: AS SHOWN

DATE: 11/11/11

PROJECT: VZ200796CADAVAFK05

SCALE: AS SHOWN

DATE: 11/11/11

PROJECT: VZ200796CADAVAFK05

SCALE: AS SHOWN

DATE: 11/11/11

PROJECT: VZ200796CADAVAFK05

SCALE: AS SHOWN

DATE: 11/11/11

PROJECT: VZ200796CADAVAFK05

SCALE: AS SHOWN

DATE: 11/11/11

PROJECT: VZ200796CADAVAFK05

SCALE: AS SHOWN

DATE: 11/11/11

PROJECT: VZ200796CADAVAFK05

SCALE: AS SHOWN

DATE: 11/11/11

PROJECT: VZ200796CADAVAFK05

SCALE: AS SHOWN

DATE: 11/11/11

PROJECT: VZ200796CADAVAFK05

SCALE: AS SHOWN

DATE: 11/11/11

PROJECT: VZ200796CADAVAFK05

SCALE: AS SHOWN

DATE: 11/11/11

PROJECT: VZ200796CADAVAFK05

SCALE: AS SHOWN

DATE: 11/11/11

PROJECT: VZ200796CADAVAFK05

SCALE: AS SHOWN

DATE: 11/11/11

PROJECT: VZ200796CADAVAFK05

SCALE: AS SHOWN

DATE: 11/11/11

PROJECT: VZ200796CADAVAFK05

SCALE: AS SHOWN

DATE: 11/11/11

PROJECT: VZ200796CADAVAFK05

SCALE: AS SHOWN

DATE: 11/11/11

PROJECT: VZ200796CADAVAFK05

SCALE: AS SHOWN

DATE: 11/11/11

PROJECT: VZ200796CADAVAFK05

SCALE: AS SHOWN

DATE: 11/11/11

PROJECT: VZ200796CADAVAFK05

SCALE: AS SHOWN

DATE: 11/11/11

PROJECT: VZ200796CADAVAFK05

SCALE: AS SHOWN

DATE: 11/11/11

PROJECT: VZ200796CADAVAFK05

SCALE: AS SHOWN

DATE: 11/11/11

PROJECT: VZ200796CADAVAFK05

SCALE: AS SHOWN

DATE: 11/11/11

PROJECT: VZ200796CADAVAFK05

SCALE: AS SHOWN

DATE: 11/11/11

PROJECT: VZ200796CADAVAFK05

SCALE: AS SHOWN

DATE: 11/11/11

PROJECT: VZ200796CADAVAFK05

SCALE: AS SHOWN

DATE: 11/11/11

PROJECT: VZ200796CADAVAFK05

SCALE: AS SHOWN

DATE: 11/11/11

PROJECT: VZ200796CADAVAFK05

SCALE: AS SHOWN

DATE: 11/11/11

PROJECT: VZ200796CADAVAFK05

SCALE: AS SHOWN

DATE: 11/11/11

PROJECT: VZ200796CADAVAFK05

SCALE: AS SHOWN

DATE: 11/11/11

PROJECT: VZ200796CADAVAFK05

SCALE: AS SHOWN

DATE: 11/11/11

PROJECT: VZ200796CADAVAFK05

SCALE: AS SHOWN

DATE: 11/11/11

PROJECT: VZ200796CADAVAFK05

SCALE: AS SHOWN

DATE: 11/11/11

PROJECT: VZ200796CADAVAFK05

SCALE: AS SHOWN

DATE: 11/11/11

PROJECT: VZ200796CADAVAFK05

SCALE: AS SHOWN

DATE: 11/11/11

PROJECT: VZ200796CADAVAFK05

SCALE: AS SHOWN

DATE: 11/11/11

PROJECT: VZ200796CADAVAFK05

SCALE: AS SHOWN

DATE: 11/11/11

PROJECT: VZ200796CADAVAFK05

SCALE: AS SHOWN

DATE: 11/11/11

PROJECT: VZ200796CADAVAFK05

SCALE: AS SHOWN

DATE: 11/11/11

PROJECT: VZ200796CADAVAFK05

SCALE: AS SHOWN

DATE: 11/11/11

PROJECT: VZ200796CADAVAFK05

SCALE: AS SHOWN

DATE: 11/11/11

PROJECT: VZ200796CADAVAFK05

SCALE: AS SHOWN

DATE: 11/11/11

PROJECT: VZ200796CADAVAFK05

SCALE: AS SHOWN

DATE: 11/11/11

PROJECT: VZ200796CADAVAFK05

SCALE: AS SHOWN

DATE: 11/11/11

PROJECT: VZ200796CADAVAFK05

SCALE: AS SHOWN

DATE: 11/11/11

PROJECT: VZ200796CADAVAFK05

SCALE: AS SHOWN

DATE: 11/11/11

PROJECT: VZ200796CADAVAFK05

SCALE: AS SHOWN

DATE: 11/11/11

PROJECT: VZ200796CADAVAFK05

SCALE: AS SHOWN

DATE: 11/11/11

PROJECT: VZ200796CADAVAFK05

SCALE: AS SHOWN

DATE: 11/11/11

PROJECT: VZ200796CADAVAFK05

SCALE: AS SHOWN

DATE: 11/11/11

PROJECT: VZ200796CADAVAFK05

SCALE: AS SHOWN

DATE: 11/11/11

PROJECT: VZ200796CADAVAFK05

SCALE: AS SHOWN









COMMERCIAL GENERAL LIABILITY  
CG 20 37 04 13

THIS ENDORSEMENT CHANGES THE POLICY. PLEASE READ IT CAREFULLY.

**ADDITIONAL INSURED – OWNERS, LESSEES OR  
CONTRACTORS – COMPLETED OPERATIONS**

This endorsement modifies insurance provided under the following:

COMMERCIAL GENERAL LIABILITY COVERAGE PART  
PRODUCTS/COMPLETED OPERATIONS LIABILITY COVERAGE PART

SCHEDULE

Name Of Additional Insured Person(s) Or Organization(s):	Location And Description Of Completed Operations
Where Required By Written Contract	Where Required By Written Contract
Information required to complete this Schedule, if not shown above, will be shown in the Declarations.	

**A. Section II – Who Is An Insured** is amended to include as an additional insured the person(s) or organization(s) shown in the Schedule, but only with respect to liability for "bodily injury" or "property damage" caused, in whole or in part, by "your work" at the location designated and described in the Schedule of this endorsement performed for that additional insured and included in the "products-completed operations hazard".

However:

1. The insurance afforded to such additional insured only applies to the extent permitted by law; and
2. If coverage provided to the additional insured is required by a contract or agreement, the insurance afforded to such additional insured will not be broader than that which you are

required by the contract or agreement to provide for such additional insured.

**B.** With respect to the insurance afforded to these additional insureds, the following is added to **Section III – Limits Of Insurance:**

If coverage provided to the additional insured is required by a contract or agreement, the most we will pay on behalf of the additional insured is the amount of insurance:

1. Required by the contract or agreement; or
  2. Available under the applicable Limits of Insurance shown in the Declarations;
- whichever is less.

This endorsement shall not increase the applicable Limits of Insurance shown in the Declarations.



b. That portion of "your work" out of which the injury or damage arises has been put to its intended use by any person or organization other than another contractor or subcontractor engaged in performing operations for a principal as a part of the same project.

C. With respect to the insurance afforded to these additional insureds, the following is added to **Section III – Limits Of Insurance:**

The most we will pay on behalf of the additional insured is the amount of insurance:

1. Required by the contract or agreement described in Paragraph **A.1.**; or

2. Available under the applicable Limits of Insurance shown in the Declarations;  
whichever is less.

This endorsement shall not increase the applicable Limits of Insurance shown in the Declarations.

2.

General Aggregate Limit	\$ 2,000,000
Each Occurrence Limit	\$ 1,000,000
Products-Completed Operations Aggregate Limit	\$ 2,000,000
Personal & Advertising Injury Limit	\$ 1,000,000
Damage to Premises Rented to You	\$ 100,000
Medical Expense Limit	\$ 5,000

II. **SECTION III – LIMITS OF INSURANCE** is deleted in its entirety and replaced by the following:

1. The Limits of Insurance and the rules below fix the most we will pay regardless of the number of:
  - a. Insureds;
  - b. Claims made or "suits" brought; or
  - c. Persons or organizations making claims or bringing "suits".
2. The General Aggregate Limit is the most we will pay under Coverages **A**, **B**, and **C** combined for the sum of:
  - a. Medical expenses under Coverage **C**;
  - b. Damages under Coverage **A**, except damages because of "bodily injury" or "property damage" included in the products-completed operations hazard"; and
  - c. Damages under Coverage **B**.

regardless of the number of projects or "locations."

3. The Products-Completed Operations Aggregate Limit is the most we will pay under Coverage **A** for damages because of "bodily injury" and "property damage" included in the "products-completed operations hazard".
4. Subject to Paragraph **2** above, the Personal and Advertising Injury Limit is the most we will pay under Coverage **B** for the sum of all damages because of all "personal and advertising injury" sustained by any one person or organization.
5. Subject to Paragraph **2** or **3** above, whichever applies, the Each Occurrence Limit is the most we will pay for the sum of:
  - a. Damages under Coverage **A**; and
  - b. Medical expenses under Coverage **C**

because of all "bodily injury" and "property damage" arising out of any one "occurrence".

6. Subject to Paragraph **5** above, the Damage to Premises Rented to You Limit is the most

Manuscript

Page 2 of 4



All other terms and conditions of this policy remain the same.

Signed for STARR INDEMNITY & LIABILITY COMPANY

  
\_\_\_\_\_  
Charles H. Dangelo, President

  
\_\_\_\_\_  
Nehemiah E. Ginsburg, General Counsel

Manuscript

Page 4 of 4

Copyright © C. V. Starr & Company and Starr Indemnity & Liability Company. All rights reserved.  
Includes copyrighted material of ISO Properties, Inc., used with its permission.

INSURED: HP Communications Inc.

POLICY #: SISIPCA08337215

POLICY PERIOD: 07/15/2015

TO 07/15/2016



## Starr Indemnity & Liability Company

Dallas, TX 1-866-519-2522

**THIS ENDORSEMENT CHANGES THE POLICY. PLEASE READ IT CAREFULLY.**

### **ADDITIONAL INSURED – WHERE REQUIRED UNDER CONTRACT OR AGREEMENT**

This policy is amended as follows:

#### **BUSINESS AUTO COVERAGE FORM**

#### **SCHEDULE**

#### **ADDITIONAL INSURED**

ANY PERSON OR ORGANIZATION FOR WHOM YOU ARE CONTRACTUALLY BOUND TO PROVIDE ADDITIONAL INSURED STATUS BUT ONLY TO THE EXTENT OF SUCH PERSON OR ORGANIZATIONS LIABILITY ARISING OUT OF THE USE OF A COVERED "AUTO"

- I. SECTION II – LIABILITY COVERAGE A. Coverage, 1. Who is Insured, is amended to add:
  - d. Any person or organization, shown in the schedule above, to whom you become obligated to include as an additional insured under this policy, as a result of any contract or agreement you enter into which requires you to furnish insurance to that person or organization of the type provided by this policy, but only with respect to liability arising out of use of a covered "auto". However, the insurance provided will not exceed the lesser of:
    - (1) The coverage and/or limits of this policy, or
    - (2) The coverage and/or limits required by said contract or agreement.





**COUNTY OF SAN MATEO  
DEPARTMENT OF PUBLIC WORKS**

555 County Center, 5th Floor  
Redwood City, CA 94063  
(650) 363-4100

Permit Number: DPW2016-00785  
Issued: 07/06/2016  
Inspection Request: (650) 599-7273 (Bayside) ✓  
(650) 599-7296 (Coast)

Do not begin construction without confirming date and time of inspection. Minimum notice is 48 hours to start. ✓

APPLICANT NAME: KEN GAUNT

SITE ADDRESS: 460 PIGEON POINT RD

AREA: PESCADERO

APPLICANT INFORMATION

CONTRACTOR INFORMATION

KEN GAUNT  
CROWN CASTLE USA INC.  
222 E. CABRILLO STREET SUITE 107  
SANTA BARBARA, CA 93101  
PHONE #1: 7244162000  
PHONE #2: 8057044909

PHONE #1:  
PHONE #2:

PROJECT NAME: TRAFFIC CONTROL

PROJECT DESCRIPTION: CROWN CASTLE USA INC. to traffic control for the attachment of fiber optic cable to existing utility poles along a second segment of Pigeon Point Road. See attached plans, (976-DVNPT-E05-SMC) Use Traffic Control per CA MUTCD/Caltrans. ✓

TYPE OF PERMIT: Other

**UNDERGROUND SERVICE ALERT (USE) NO.:**

**DATE OF USA INQUIRY:**

SEWER DISTRICT: undefined

COUNTY SIP REQ'D?: N

**PERMIT EXPIRATION DATE: 09/09/2016**

Road Encroachment Fee

\$106.00

**FEE AMOUNT PAID:**

**\$106.00**

The work authorized by this Permit shall be subject to all the terms, conditions, and restrictions set forth herein. This permit consists of the Special Provisions and Standard Details of San Mateo County as applicable, attached and made a part hereof. The project, as specifically described, is to be strictly construed and no other activity shall be permitted. **Notify County Road Inspector 48 hrs prior to starting work.**

The Permittee and/or his contractor shall indemnify and save harmless the County, its officers, agents, employees and servants from all claims, suits or actions of every name, kind and description, brought for, or on account of, injuries to or death of any person or damage to property resulting from the performance of any work authorized or required by this Permit of Permittee and/or his contractor, their officers, agents, employees and/or servants.

**INSURANCE**

Permittee is required to maintain property damage and liability insurance in amounts equivalent to or exceeding the legal minimums as a condition of this permit.

**APPROVAL BY DEPARTMENT OF PUBLIC WORKS**

This permit was issued by me on:

Date: 07/06/2016

Reviewed by: Adolfo Orellana

Signed: 

**\*\* FOR OFFICE USE ONLY \*\***

Date Completed: \_\_\_\_\_

By: \_\_\_\_\_

DEPARTMENT OF PUBLIC WORKS



Road Operations - Permits  
455 County Center, 2/FI.  
Redwood City, CA 94063  
(650) 363-1822

JAMES C. PORTER  
Director of Public Works

DPW2014-00785

Date: \_\_\_\_\_

Plan Check #: \_\_\_\_\_

APN: \_\_\_\_\_

**ENCROACHMENT PERMIT APPLICATION**

To Whom It May Concern:

The undersigned hereby applied for permission to excavate, construct and/or otherwise encroach upon the Right-of-Way of the County of San Mateo road(s) listed:

**DESCRIBED LOCATION OF PROPOSED ACTIVITY**

Pigeon Point Rd.

**DESCRIBED PROPOSED ACTIVITY: <Attach site plan and sketch or scaled drawing>**

Attachment of fiber optic cable to existing utility poles, shown on attached plans (976-DVNPT-E05-SMC).

**\*\* for all questions, redlines, fees and please contact Ken Gaunt (951) 970-5279\*\***

NOTE: State of California Government Code Sections 4216 through 4216.9 require an INQUIRY IDENTIFICATION NUMBER be assigned to every person planning to conduct an excavation in a Public Right-of-Way or Private Easement. If applicable, the applicant shall call the "USA" Regional Notification Center at 800-642-2444 a minimum of two (2) days prior to commencing that excavation. **NO PERMIT TO EXCAVATE ISSUED BY SAN MATEO COUNTY SHALL BE VALID UNLESS THE APPLICANT HAS OBTAINED AN INQUIRY ID NUMBER FROM "USA."**

PROPOSED ENCROACHMENT DATE(S): START 08/08/16 FINISH 08/12/16

Applicant agrees to accomplish the described activity in accordance with applicable County of San Mateo codes, regulations, restrictions and specifications and to be subject to inspection and approval by the Dept. of Public Works.

\_\_\_\_\_ Applicant shall indemnify and save harmless the County, its officers, agents, employees and servants from all  
initials claims, suits or actions on every name, kind and description, brought for, or on account of, injuries to or death of  
any person or damage to property resulting from the performance of any work authorized or required by the County  
in conjunction with this request.

\_\_\_\_\_ Applicant is required to maintain property damage and liability insurance in amounts equivalent to or exceeding the  
initials legal minimums as a condition of this permit.

**APPLICANT COMPLETE**

"USA" Inquiry

\_\_\_\_\_  
Date

\_\_\_\_\_  
USA Inquiry ID Number

**PLEASE PRINT**

Crown Castle

\_\_\_\_\_  
Applicant Name

222 E. Cabrillo St, Suite 107

\_\_\_\_\_  
Mailing Address

Santa Barbara, CA 93101

\_\_\_\_\_  
City, State Zip

(805) 704-4909

\_\_\_\_\_  
Area Code & Phone and email

  
\_\_\_\_\_  
Applicant Signature











**COUNTY OF SAN MATEO  
DEPARTMENT OF PUBLIC WORKS**

555 County Center, 5th Floor  
Redwood City, CA 94063  
(650) 363-4100

**Payment Receipt**

Check #: 2109858  
Receipt #: 489752  
Money Received By: DPWPERMITS  
Name: KEN GAUNT  
Address: 460 PIGEON POINT RD, PESCADERO, CA 94060  
Parcel #:

<b>Case Number</b>	<b>Account Number</b>	<b>Description</b>	<b>Date Paid</b>	<b>Amount Due</b>	<b>Amount Paid</b>
<b>Public Works Department</b>					
DPW2016-00785	45240-1251	Road Encroachment Fee	7/6/16	\$106.00	\$106.00
				Total Paid:	\$106.00
				<b>Grand Total:</b>	<b>\$106.00</b>
				<b>Balance Due:</b>	<b>\$0.00</b>