

**A. 10-06-007 South Bay Substation Relocation Project PTC**  
**Energy Division Data Request 4, Dated February 1, 2011**  
**SDGE-ED-004: Q 1-3**  
**SDG&E 2/8/11 Response**

**Question #1**

Revised Site Plan – A revised site plan of the Bay Boulevard Substation was received by CPUC staff on January 27, 2011. The revised site plan includes modifications to the proposed detention basins located along the eastern limits of the Bay Boulevard Substation. The revised site plan provided by SDG&E will require revisions to information presented in the Proponent's Environmental Assessment (PEA) Project Description and associated environmental review being completed by the CPUC. Please confirm whether secondary access to the Bay Boulevard substation from the north via Bay Boulevard is still considered and the material composition of the unpaved access road from the central substation gate north to Bay Boulevard. Please also confirm that the feature identified as "pavement" on the revised site plan will be asphalt-paved.

**SDG&E Response:**

Secondary access to the Bay Boulevard Substation from the north via Bay Boulevard remains as originally proposed. This road, from immediately north of the central substation gate access drive north to the existing paved access drive from Bay Boulevard, will be unpaved, consisting of a compacted Class 2 gravel surface.

The shaded feature identified as "pavement" on the revised Figure 7 Grading Plan will be asphalt-paved.

**A. 10-06-007 South Bay Substation Relocation Project PTC**  
**Energy Division Data Request 4, Dated February 1, 2011**  
**SDGE-ED-004: Q 1-3**  
**SDG&E 2/8/11 Response**

**Question #2**

Revised Grading Plan – Please provide verification that the plan meets all applicable drainage requirements including that the reduction in retention basins will be adequate to accommodate site drainage during operations including the ability to accommodate the peak-100 year flow rate. Please describe how the removal of water quality basins B and C will affect drainage of the site and if the construction of just one basin (basin A) would increase the likelihood of surface runoff (and offsite erosion and flooding) during operations.

**SDG&E Response:**

The revised grading plan meets all drainage and water quality requirements as specified by the City of Chula Vista. Water Quality Basins B and C in the original grading plan were intended to handle a large portion of the substation site runoff. The revised grading plan directs nearly all of the site runoff to the westerly basin (Basin A), resulting in approximately 10.5 acres of tributary area. A small portion of the substation site discharges from the southeast corner to a point above the proposed wetland. The site 100-year discharge to Basin A is approximately 35.3 cubic-feet-per-second. The 100-year discharge from Basin A to the existing southwest outfall is approximately three cubic feet per second (in compliance with the City of Chula Vista requirements). The proposed 100-year discharge at the southwest outfall, including all drainage from Basin A and from the proposed wetland is in compliance with the requirements of the City of Chula Vista.

**A. 10-06-007 South Bay Substation Relocation Project PTC**  
**Energy Division Data Request 4, Dated February 1, 2011**  
**SDGE-ED-004: Q 1-3**  
**SDG&E 2/8/11 Response**

**Question # 3**

PEA Figures – Please incorporate the revised site plan on the following figures from the PEA and provide:

- a. Figure 3-7: Bay Boulevard Substation Temporary and Permanent Impact Area (please provide the ARC GIS files associated with this updated figure)
- b. Figure 4.1-6: Preliminary Landscape Concept
- c. Figure 4.10-3: Bay Boulevard Substation Operational Noise Contours

**SDG&E Response:**

- a. Figure 3-7: Bay Boulevard Substation Temporary and Permanent Impact Area has been revised to reflect SDG&E's new grading plan for the Proposed Project and has been uploaded to Dudek's FTP site.
- b. Figure 4.1-6: Preliminary Landscape Concept has been revised to reflect SDG&E's new grading plan for the Proposed Project and has been uploaded to Dudek's FTP site.
- c. Figure 4.10-3: Bay Boulevard Substation Operational Noise Contours has been revised to reflect SDG&E's new grading plan for the Proposed Project and has been uploaded to Dudek's FTP site.



Figure 4.10-3: Bay Boulevard Substation Operational Noise Contours



LANDSCAPE CONCEPT:

The preliminary landscape concept includes informal tree and shrub groupings located outside of the perimeter wall west of the substation. Small trees would also line the entry drive. The suggested plant palette includes all drought-tolerant species and some California natives. Proposed landscaping would partially screen the substation site and new utility poles from Bay Boulevard and locations further east. The planting would also partially screen views from the office park to the south.

NOTES:

1. The final landscape layout would be determined in consultation with the City of Chula Vista and in conjunction with survey and final engineering design data.
2. For a minimum two-year period while new plant material becomes established, regular watering would be provided using irrigation with a reclaimed/non-potable water source or truck-watering.
3. Owner would provide periodic landscape maintenance including removal and replacement of dead plant material.
4. Plant material proposed for installation below existing/future overhead conductors and easements would be low growing to allow for clearance. All planting would be consistent with SDG&E's operational requirements for landscaping in proximity to electric transmission facilities.
5. Base drawing and grading incorporates information from SDG&E/Note Figure 7: Grading Plan (received 1/3/2011).

**PRELIMINARY CONCEPT**  
**Subject to change based on**  
**additional information and**  
**final engineering design.**

PLANT PALETTE LEGEND

SYMBOL	TYPE OF PLANT	APPROXIMATE QUANTITY	SUGGESTED SPECIES	CONTAINER SIZE	MAXIMUM HEIGHT/SPREAD
	Entry drive tree	14	Enrobrya defera (Bronze Loquat) Geijera Parvifolia (Australian Willow)	15 Gallon	25/25' 35/25'
	Small, broad leaf evergreen tree	15	Heteromeles arbutifolia (Toyon) Rhamnus alaternus (Coffeeberry)	15 Gallon	25/25' 25/15'
	Calif. native shrub mixture	22	Ceanothus "Julia Phelps" (California Lilac) Eriogonum fasciculatum (California Buckwheat) Rhus integrifolia (Lemonade Berry) Artemesia californica (California Sagebrush)	10 Gallon	4-7'/equal ** 3' /4' ** 3-10'/equal ** 5' /6' **

\* Size estimates based on information contained in:  
Reimer, Jeffrey L. and W. Mark. "SelectTree: A Tree Selection Guide." <http://selecttree.calpoly.edu/>

\*\* Brenzel, Kathleen N., editor. 2001. Sunset Western Garden Book.

ENVIRONMENTAL VISION

2-9-2011

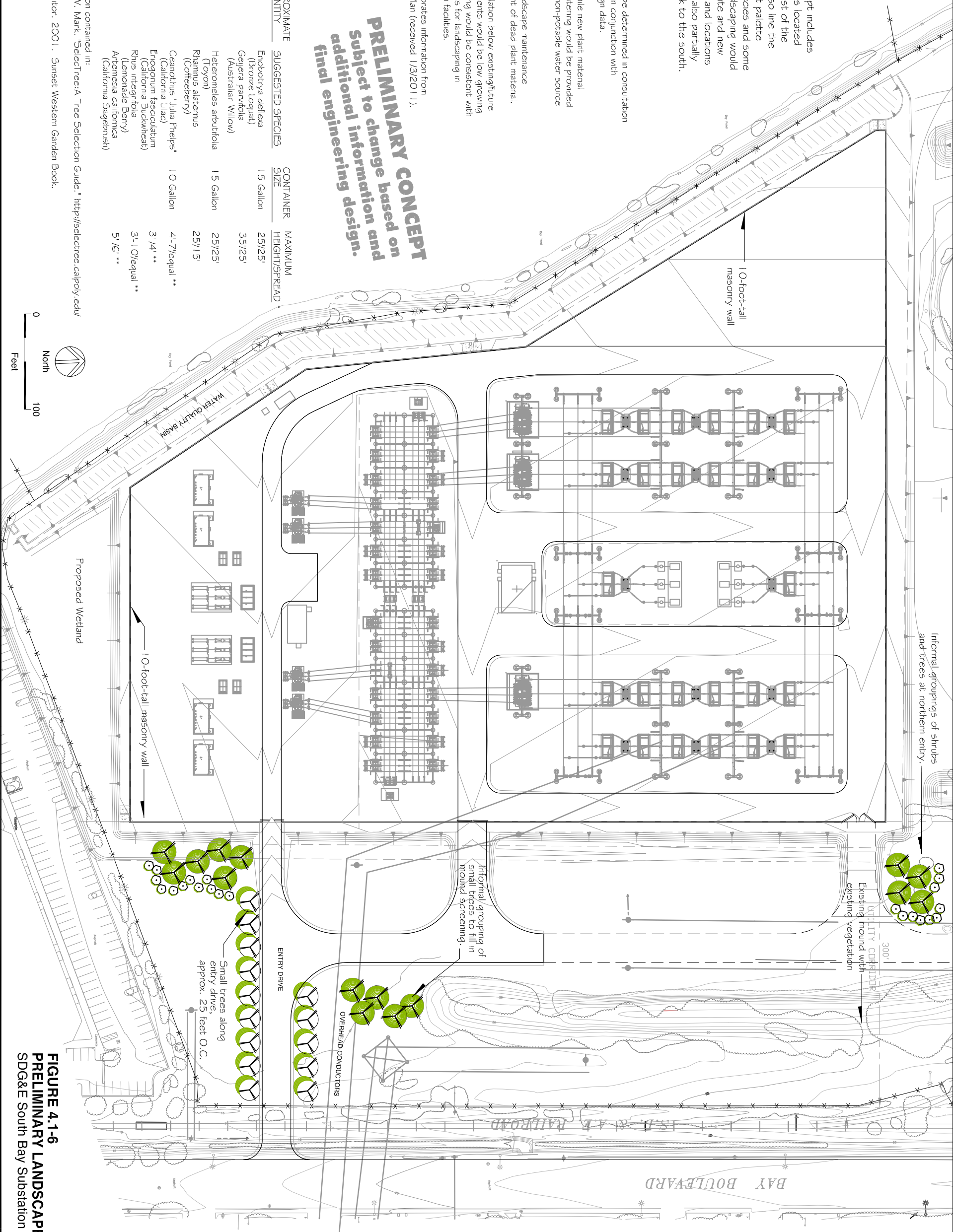

**FIGURE 4.1-6**  
**PRELIMINARY LANDSCAPE CONCEPT**  
**SDG&E South Bay Substation Relocation**





**Figure 3-7: Bay Boulevard Substation  
Temporary and Permanent Impact Areas**

**South Bay Substation  
Relocation Project**

- |                            |                                    |
|----------------------------|------------------------------------|
| Substation Wall            | Permanent Substation and Driveways |
| 12.42-Acre Parcel Boundary | Permanent Cut and Fill             |
| SDG&E Easement             | Limits of Temporary Disturbance    |

