



STREET/SIDEWALK BLOCKAGE FORM

FOR USE BY FRANCHISE UTILITY COMPANIES ONLY - MAY NOT BE SUBMITTED BY CONTRACTOR

E-mail to: TrafficControlPermit@sandiego.gov | Questions? Call 619-446-5150

City Use Only

City Comments: No work 7/4/2018 City Holiday	APPROVED <input checked="" type="checkbox"/> DENIED <input type="checkbox"/>	Date Reviewed	06/20/2018
	Reviewer's Name		Felipe Avila
	Reviewer's Phone Number		(619) 446-5207

Information Below must be TYPED and Completed by Franchise Utility Company Only

Date Submitted	6/20/2018				Type of Work					
Utility Company	SDG&E	Contractor	ARB		Lane Closure	1	Street Closure	2	Sidewalk Closure	3
Contact Name	Chuck Eck	Contact Name	Rod Nelson		Alley Closure	4	Parking Lane	5	Detour	6
Phone Number	(860) 759-3364	Phone Number	(619) 778-2405		Trenching	7	Flagging	8	Bike Lane	9
Email Address	ceck@burnsmcd.com	Email Address	melson@prim.com							

Street Name	From	To	Thomas Bros.	Start Date	End Date	Work Hours	Type of Work
Sample Street	Sample Road	Sample Avenue	1200-A1	xx/xx/xxxx	xx/xx/xxxx	8:30AM - 3:30PM	1,2,3,4,5,6,7,8,9
Carroll Canyon Road	Scranton Street	Youngstown Way	1208-D7	06/24/2018	07/13/2018	9:00 PM - 5:00 AM	1,5,8
Scranton Road	Carroll Canyon Road	Mira Mesa Blvd	1208-E7	06/24/2018	07/13/2018	9:00 PM - 5:00 AM	8
Youngstown Way	Carroll Canyon Road	Oberlin Drive	1208-F7	06/24/2018	07/13/2018	9:00 PM - 5:00 AM	8

ORIGINAL PERMIT MUST
 BE KEPT
 ON JOB SITE ALL TIMES

ATTENTION
 The night work hours listed on this Permit may be revised by Noise Permit intake of the Code Enforcement Section.

Applicant Comments: Paving/Restoration work ONLY - Phases 1 and Caltrans Phases C-1 through C-4, Sunday - Thursday night work, 9pm-5am	Is this an Extension? <input checked="" type="radio"/> YES <input type="radio"/> NO	Date of previous approval: 05/22/2018
---	--	--

- Completed **TYPED** form must be submitted a minimum of 2 working days prior to start of work.
 - All plans shall be original, legible, and submitted in PDF format.
 - No work on Saturdays, Sundays, and City-Observed Holidays unless authorized by City staff.
- Work affecting traffic signals requires a minimum of 5 working days advance notice - Contact Field Services at: jvaca@sandiego.gov

SIGN LEGEND

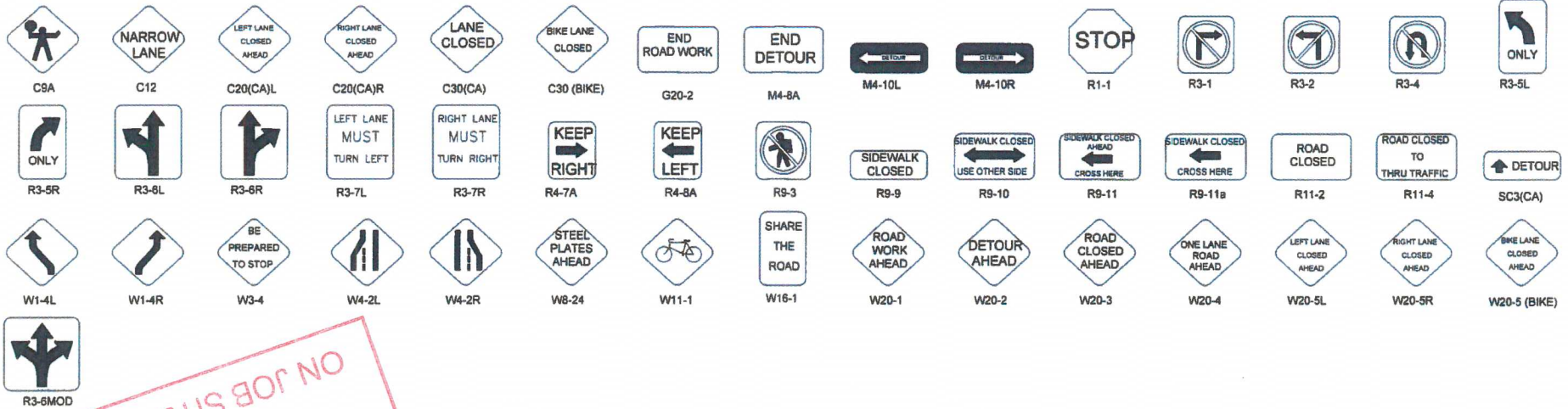

- LEGEND**
- APPROXIMATE POTHOLE LOCATION
 - SIGN
 - TRAFFIC CONES / DELINEATOR
 - BARRICADE
 - FLAGGER
 - FLASHING ARROW SIGN
 - WORK ZONE
 - CONSTRUCTION VEHICLE
 - BUS STOP

APPROACH SPEED (MPH)	MINIMUM DISTANCE (FEET) BETWEEN SIGNS AND FROM LAST SIGN TO TAPER	MINIMUM TAPER LENGTHS (L) (FEET) FOR 12-FOOT LANE			BUFFER LENGTH (FEET)	MAX CONE SPACING		
		L	1/2L	1/3L		TAPER	TANGENT	CONFLICT
25	100	125	65	45	155	25	50	12
30	250	180	90	60	200	30	60	15
35	250	245	125	85	250	35	70	17
40	250	320	160	110	305	40	80	20
45	350	540	270	180	360	45	90	22
50	350	600	300	200	425	50	100	25
55+	350	660	330	220	495	55	110	27

AIRX SURVEYORS, INC.
 2534 EAST EL NORTE PARKWAY, SUITE C
 ESCONDIDO, CA 92027
 PHONE: (760) 480-2347
 CELL: (760) 419-3738

Gail McMorran
 President

PROJECT NAME: TL23071 – Sycamore Canyon Substation To Penasquitos Substation – 230 KV Underground

AIRX JOB#: X160218	THOMAS GRID#: –
TYPE OF WORK: TRENCHING / CONDUIT	DRAWN FOR: SAN DIEGO COUNTY
MISC/POTHOLE#:	

DATE: Mar 2, 2017
 DESIGNED BY:
 Clint Jones

SHEET 1 OF 4

ORIGINAL TRAFFIC CONTROL PLAN
 ON JOB SITE ALL TIMES
 BE KEPT IN TRUCK MUST
 APPROVED
 CITY OF SAN DIEGO
 Development Services
 Engineering Division
 Traffic Safety Section
 JUN 20 2018

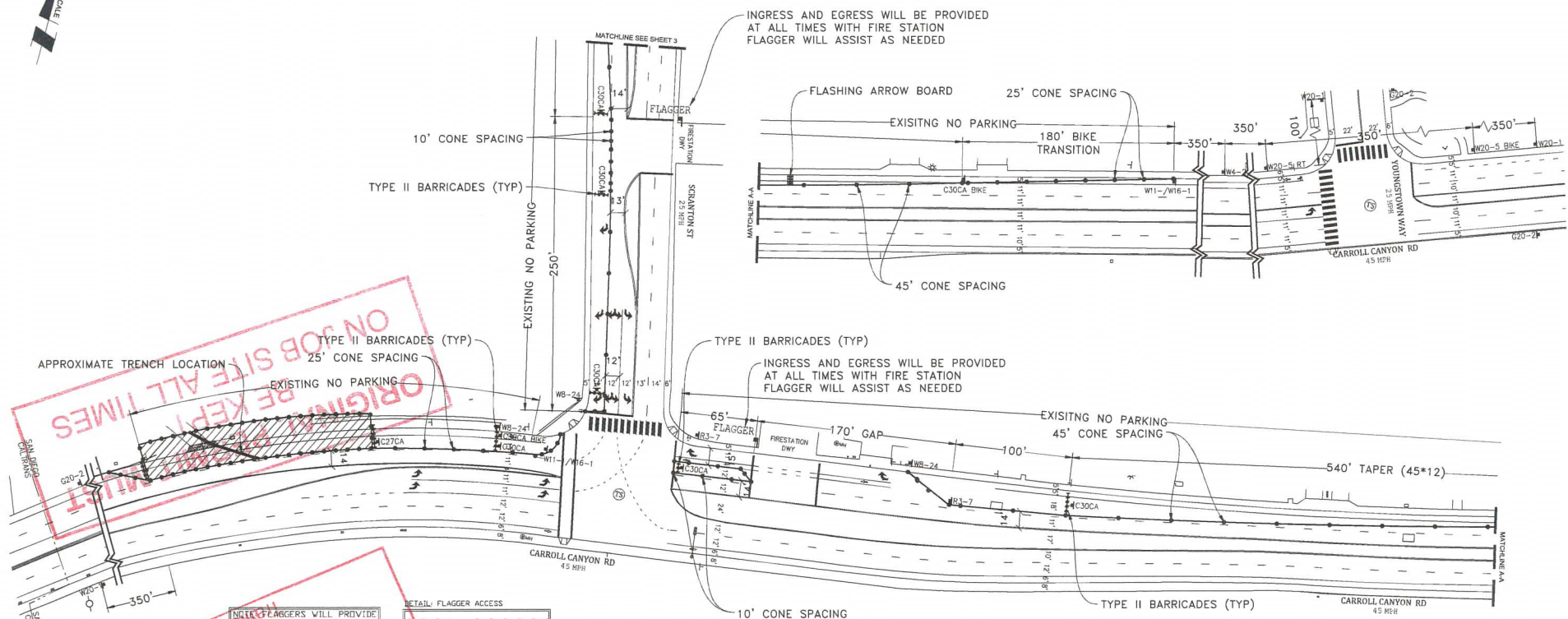

ON JOB SITE ALL TIMES
 ORIGINAL PERMIT
 APPROVED
 TRAFFIC CONTROL PERMIT
 JUN 20 2018
 City of San Diego
 Department Services
 Safety Section

NOTE: FLAGGERS WILL PROVIDE ACCESS TO DRIVEWAYS AT ALL TIMES

NOTE: FLAGGERS WILL SAFELY GUIDE PEDESTRIANS THROUGH WORK AREA

NOTE: CONTRACTOR WILL ALLOW FIRE STATION INGRESS AND EGRESS AT ALL TIMES

NOTE: WB-24 (STEEL PLATES) AHEAD SIGNS WILL REMAIN IN PLACE FOR DURATION OF WORK

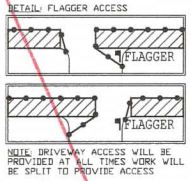

NOTE: CONTRACTOR WILL COORDINATE ALL WORK WITH FIRE STATION PRIOR TO START OF WORK

NOTE: CONTRACTOR WILL COORDINATE ALL WORK WITH TRANSIT DEPARTMENT 5 DAYS PRIOR TO START OF WORK

NOTE: CONTRACTOR WILL COORDINATE ALL WORK WITH EXISTING PROJECTS AND NOT CONFLICT WITH EXISTING TRAFFIC CONTROL

NOTE: CONTRACTOR WILL COORDINATE ALL WORK WITH RESIDENTS PRIOR TO START OF WORK

NOTE: CONTRACTOR WILL COORDINATE ALL WORK WITH BUSINESSES PRIOR TO START OF WORK

WORK HOURS: _____ TO _____

EYE CONTACT MUST BE MAINTAINED BETWEEN FLAGGERS OR USE 2-WAY COMMUNICATION
 FLAGGER WILL ASSIST WITH BIKE/VEHICLE TRAFFIC

- LEGEND**
- SIGN
 - SIGNAL
 - TRAFFIC CONES / DELINEATOR
 - BARRICADE
 - FLAGGER
 - FLASHING ARROW SIGN
 - WORK ZONE
 - BUS STOP

UTILITY SURVEYORS, INC.

AIRX

Gail McMorrان
 President

2534 EAST EL NORTE PARKWAY, SUITE C
 ESCONDIDO, CA 92027
 PHONE: (951) 480-3347
 CELL: (951) 418-3728

PROJECT NAME: TL23071 - SYCAMORE CANYON SUBSTATION TO PENASQUITOS - 230 KV UNDERGROUND	
AIRX JOB#: X160218	THOMAS GRID#: --
TYPE OF WORK: TRENCHING / CONDUIT	DRAWN FOR: CITY OF SAN DIEGO
MISC./POTHOLES#:	

DATE: Mar. 6, 2017
DESIGNED BY: Clint Jones
SHEET 002 OF 148

PHASE 1



ORIGINAL PERMIT MUST BE KEPT ON JOB SITE ALL TIMES

APPROVED TRAFFIC CONTROL PERMIT
 JUN 20 2018
 CITY OF SAN DIEGO
 Development Services
 Engineering Section
 Traffic Safety Section

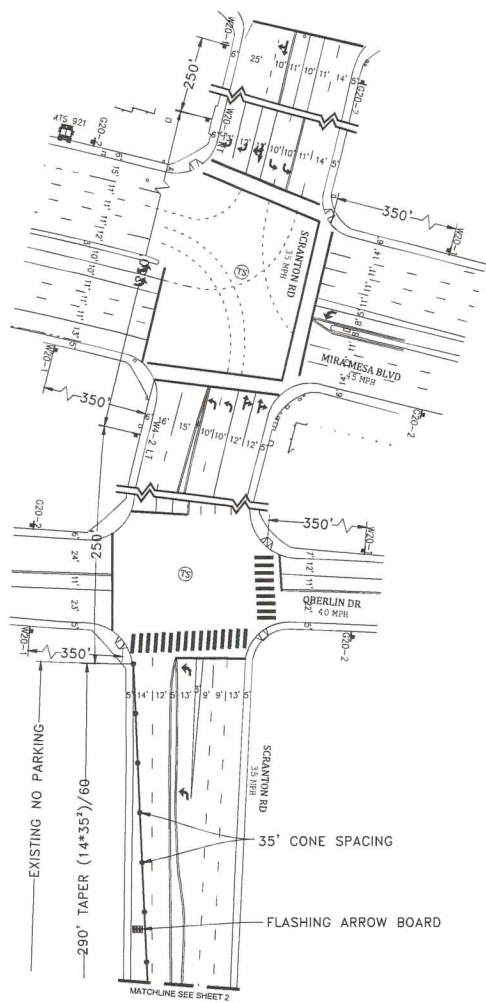

LEGEND

- SIGN
- SIGNAL
- TRAFFIC CONES / DELINEATOR
- BARRICADE
- FLAGGER
- FLASHING ARROW SIGN
- WORK ZONE
- BUS STOP

NOTE: CONTRACTOR WILL COORDINATE ALL WORK WITH RESIDENTS PRIOR TO START OF WORK

NOTE: CONTRACTOR WILL COORDINATE ALL WORK WITH BUSINESSES PRIOR TO START OF WORK

DETAIL: FLAGGER ACCESS

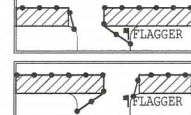

NOTE: FLAGGERS WILL PROVIDE ACCESS TO DRIVEWAYS AT ALL TIMES

NOTE: FLAGGERS WILL SAFELY GUIDE PEDESTRIANS THROUGH WORK AREA

NOTE: CONTRACTOR WILL ALLOW FIRE STATION INGRESS AND EGRESS AT ALL TIMES

NOTE: W8-24 (STEEL PLATES AHEAD) SIGNS WILL REMAIN IN PLACE FOR DURATION OF WORK

NOTE: DRIVEWAY ACCESS WILL BE PROVIDED AT ALL TIMES WORK WILL BE SPLIT TO PROVIDE ACCESS

EYE CONTACT MUST BE MAINTAINED BETWEEN FLAGGERS OR USE 2-WAY COMMUNICATION
 FLAGGER WILL ASSIST WITH BIKE/VEHICLE TRAFFIC

NOTE: CONTRACTOR WILL COORDINATE ALL WORK WITH FIRE STATION PRIOR TO START OF WORK

NOTE: CONTRACTOR WILL COORDINATE ALL WORK WITH TRANSIT DEPARTMENT 5 DAYS PRIOR TO START OF WORK

NOTE: CONTRACTOR WILL COORDINATE ALL WORK WITH EXISTING PROJECTS AND NOT CONFLICT WITH EXISTING TRAFFIC CONTROL

UTILITY SURVEYORS, INC.

Gail McMoran
 President
 254 EAST EL NORTE PARKWAY, SUITE C
 ESCONDIDO, CA 92027
 PHONE: (760) 490-2347
 CELL: (760) 419-3728

WORK HOURS: _____ TO _____		PHASE 1 (CONT)
PROJECT NAME: TL23071 - SYCAMORE CANYON SUBSTATION TO PENASQUITOS - 230 KV UNDERGROUND		DATE: Mar. 6, 2017
AIRX JOB#: X160218	THOMAS GRID# -	DESIGNED BY: Clint Jones
TYPE OF WORK: TRENCHING / CONDUIT	DRAWN FOR: CITY OF SAN DIEGO	SHEET 003 OF 148
MISC/POTHOLE#:		

SIGN LEGEND

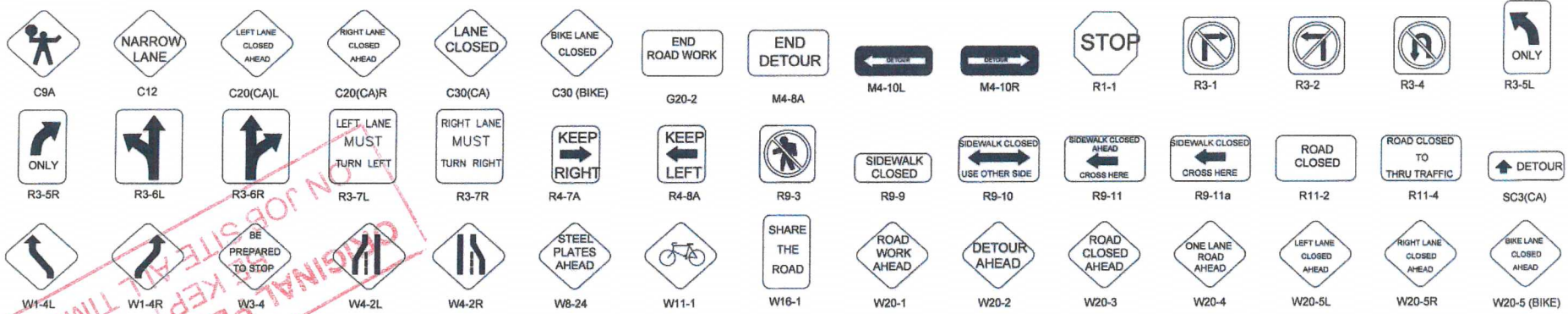

TABLE 1

TAPER LENGTH CRITERIA AND CHANNELIZING DEVICE SPACING

SPEED (S)	MINIMUM TAPER LENGTH * FOR WIDTH OF OFFSET 12 FEET (W)					MAXIMUM CHANNELIZING DEVICE SPACING		
	TANGENT 2L	MERGING L	SHIFTING L/2	SHOULDER L/3	TAPER	X		Z **
						TANGENT	CONFLICT	
20	160	80	40	27	20	40	10	
25	250	125	63	42	25	50	12	
30	350	180	90	60	30	60	15	
35	490	245	123	82	35	70	17	
40	640	320	160	107	40	80	20	
45	1080	540	270	180	45	90	22	
50	1200	600	300	200	50	100	25	
55	1320	660	330	220	55	110	25	
60	1440	720	360	240	60	120	25	
65	1560	780	390	260	65	130	25	
70	1680	840	420	280	70	140	25	
75	1800	900	450	300	75	150	25	

* - For other offsets, use the following merging taper length formula for L:
 For speed of 40 mph or less, $L = WS^3/60$
 For speed of 45 mph or more, $L = WS$
 Where: L = Taper length in feet
 W = Width of offset in feet
 S = Posted speed limit, off-peak 85th-percentile speed prior to work starting, or the anticipated operating speed in mph

** - Use for taper and tangent sections where there are no pavement markings or where there is a conflict between existing pavement markings and channelizers (CA).

TABLE 2

LONGITUDINAL BUFFER SPACE AND FLAGGER STATION SPACING

SPEED *	Min D **	DOWNGRADE Min D ***		
		-3%	-6%	-9%
20	115	116	120	126
25	155	156	165	173
30	200	205	215	227
35	250	257	271	287
40	305	315	333	354
45	360	378	400	427
50	425	446	474	507
55	495	520	553	593
60	570	598	638	686
65	645	682	728	795
70	730	771	825	891
75	820	868	927	1003

* - Speed is posted speed limit, off-peak 85th-percentile speed prior to work starting, or the anticipated operating speed in mph
 ** - Longitudinal buffer space or flagger station spacing
 *** - Use on sustained downgrade steeper than -3 percent and longer than 1 mile.

TABLE 3

ADVANCE WARNING SIGN SPACING

ROAD TYPE	DISTANCE BETWEEN SIGNS *		
	A	B	C
URBAN - 25 mph OR LESS	100	100	100
URBAN - MORE THAN 25 mph TO 40 mph	250	250	250
URBAN - MORE THAN 40 mph	350	350	350
RURAL	500	500	500
EXPRESSWAY / FREEWAY	1000	1500	2640

* - The distances are approximate, are intended for guidance purposes only, and should be applied with engineering judgment. These distances should be adjusted by the Engineer for field conditions, if necessary, by increasing or decreasing the recommended distances.

LEGEND

- APPROXIMATE TRENCH LOCATION
- SIGN
- TRAFFIC CONES / DELINEATOR
- I BARRICADE
- ↑ FLAGGER
- ◀▶ FLASHING ARROW SIGN
- ▨ WORK ZONE

111767K 0459
8/16/17

RECEIVED
AUG 16 2017
CALTRANS-PERMIT

PROJECT NAME: L23071 - Sycamore Canyon Substation To Penasquitos Substation - 230 KV Underground

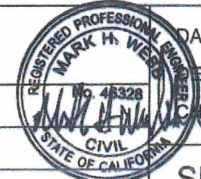

DATE: 7/12/2017
DESIGNED: Clint Jones
CHECKED BY: Mark Webb

AIRX SURVEYORS, INC.
Gail McMoran
President
2534 EAST EL NORTE PARKWAY, SUITE C
ESCONDIDO, CA 92027
PHONE: (760) 480-2417
CELL: (760) 419-3738

NV5
15092 AVENUE OF SCIENCE, SUITE 200
SAN DIEGO, CA 92128
P: 858.385.0500 WWW.NV5.COM

AIRX JOB#: X160218
MISC/POTHOLE#: _____
TYPE OF WORK: TRENCHING / CONDUIT

THOMAS GRID#: 1208-E7
DRAWN FOR: CALTRANS



MATCHLINE SEE SHEET 3

DETOUR MAP (NOT TO SCALE)

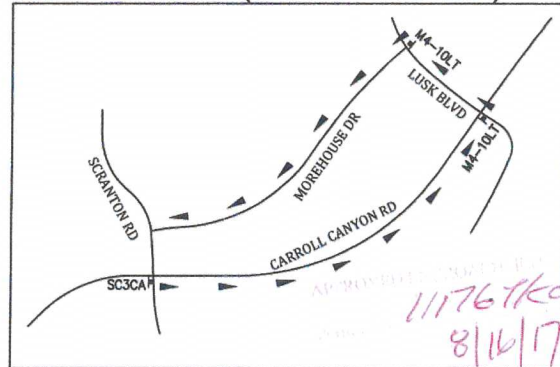

NOTE: W8-24 (STEEL PLATES AHEAD) SIGNS WILL REMAIN IN PLACE FOR DURATION OF WORK

TYPE II BARRICADES WITH FLASHING LIGHTS (TYP)

90' GAP

25' CONE SPACING

TYPE II BARRICADES WITH FLASHING LIGHTS (TYP)

TYPE II BARRICADES WITH FLASHING LIGHTS (TYP)

45' CONE SPACING

APPROXIMATE TRENCH LOCATION
10' CONE SPACING

CROSSWALK WILL BE CLEAR OF ALL EQUIPMENT IN THIS PHASE

CARROLL CANYON RD
45 MPH

WORK HOURS: _____ TO _____ PHASE C - 1

PROJECT NAME: TL23071 - Sycamore Canyon Substation To Penasquitos Substation - 230 KV Underground

DATE: 7/12/2017
DESIGNED: Clint Jones
CHECKED BY: Mark Webb

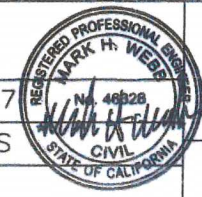

AIRX SURVEYORS, INC.
Gail McMorran
President
2534 EAST EL NORTE PARKWAY, SUITE C
ESCONDIDO, CA 92027
PHONE: (760) 465-2347
CELL: (760) 419-3738

NV5
15092 AVENUE OF SCIENCE, SUITE 200
SAN DIEGO, CA 92128
P: 858.385.0500 WWW.NV5.COM

AIRX JOB#: X160218
MISC/POTHOLE#: _____
THOMAS GRID#: 1208-E7
DRAWN FOR: CALTRANS
TYPE OF WORK: TRENCHING / CONDUIT

SHEET 2 OF 16

ORIGINAL PERMIT MUST BE KEPT AT ALL TIMES

CITY OF SAN DIEGO Development Services JUN 20 2018

TRAFFIC CONTROL PERMIT APPROVED

RECEIVED AUG 16 2017 CALTRANS-PERMIT

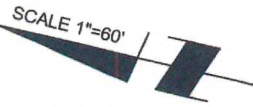

11767K0459
8/16/17

NOTE: W8-24 (STEEL PLATES AHEAD) SIGNS WILL REMAIN IN PLACE FOR DURATION OF WORK

ORIGINAL PERMIT MUST BE KEPT ALL TIMES

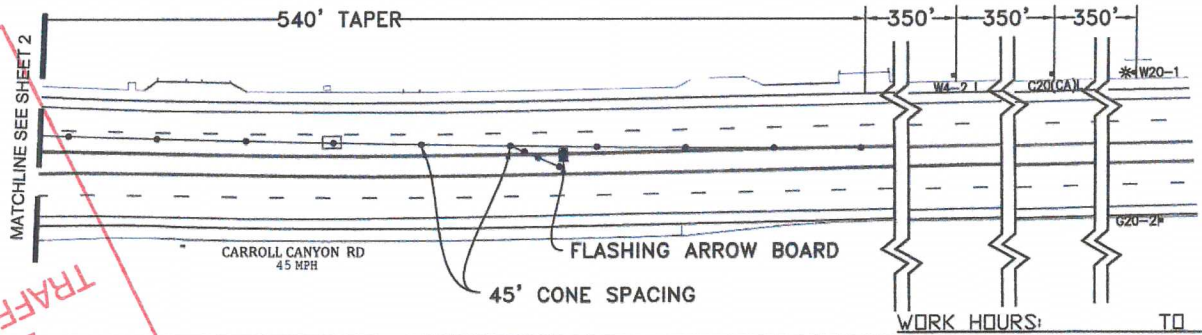
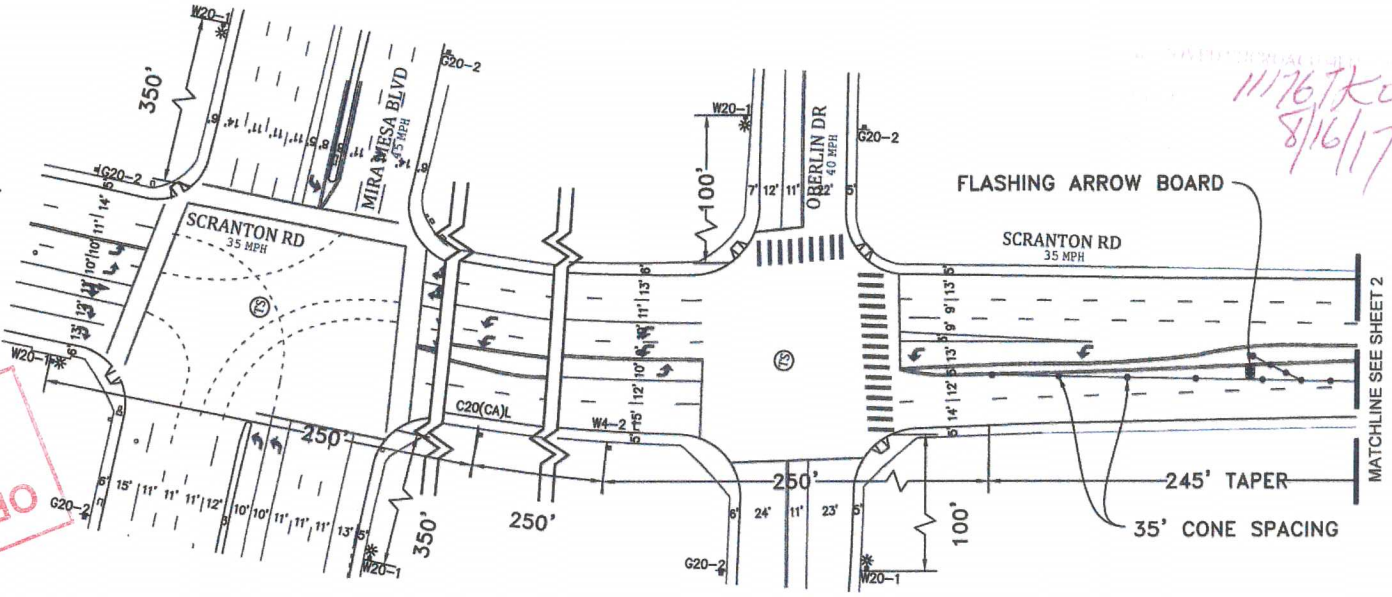

RECEIVED
AUG 16 2017
CALTRANS-PERMIT

WORK HOURS: TO PHASE C - 1

PROJECT NAME: TL23071 - Sycamore Canyon Substation To Penasquitos Substation - 230 KV Underground

DATE: 7/12/2017
DESIGNED: Clint Jones
CHECKED BY: Mark Webb

AIR SURVEYORS, INC.
Gail McMoran
President
2534 EAST EL NORTE PARKWAY, SUITE C
ESCONDIDO, CA 92027
PHONE: (760) 483-2347
CELL: (760) 418-3738

N/V/5
15092 AVENUE OF SCIENCE, SUITE 200
SAN DIEGO, CA 92128
P: 858.385.0500 WWW.NV5.COM

AIRX JOB#: X160218
MISC/POTHOLES#: _____
TYPE OF WORK: TRENCHING / CONDUIT

THOMAS GRID#: 1208-E
DRAWN FOR: CALTRANS



SHEET 3 OF 16

SCALE 1"=50'

NOTE: W8-24 (STEEL PLATES AHEAD) SIGNS WILL REMAIN IN PLACE FOR DURATION OF WORK

ORIGINAL PERMIT MUST BE KEPT ON JOB SITE ALL TIMES

TYPE II BARRICADES WITH FLASHING LIGHTS (TYP)

45' CONE SPACING

MATCHLINE SEE SHEET 5

540' TAPER

C30(CA)

R3-7A

12' MIN

120' GAP

CARROLL CANYON RD
45 MPH

TYPE II BARRICADES WITH FLASHING LIGHTS (TYP)

350'

350'

250'

25' CONE SPACING

RECEIVED
AUG 16 2017

CALTRANS-PERMIT

WORK HOURS: _____ TO _____ PHASE C - 1

PROJECT NAME: TL23071 - Sycamore Canyon Substation To Penasquitos Substation - 230 KV Underground

DATE: 7/12/2017
DESIGNED: Clint Jones
CHECKED BY: Mark Webb

AIRX SURVEYORS, INC.
2534 EAST EL NORTE PARKWAY, SUITE C
ESCONDIDO, CA 92027
PHONE: (760) 480-2347
CELL: (760) 419-3738

Gail McMorrin
President

15092 AVENUE OF SCIENCE, SUITE 200
SAN DIEGO, CA 92128
P: 858.385.0500 WWW.NV5.COM

AIRX JOB#: X160218

THOMAS GRID#: 1208-E7

MISC/POTHOLE#: _____

DRAWN FOR: CALTRANS

TYPE OF WORK: TRENCHING / CONDUIT

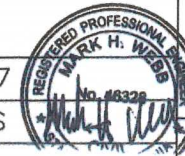

SHEET 4 OF 16

APPROVED
TRAFFIC CONTROL PERMIT
JUN 20 2018
CITY OF SAN DIEGO
Development Services
Engineering Division
Traffic Safety Section

111767K0957
8/16/17

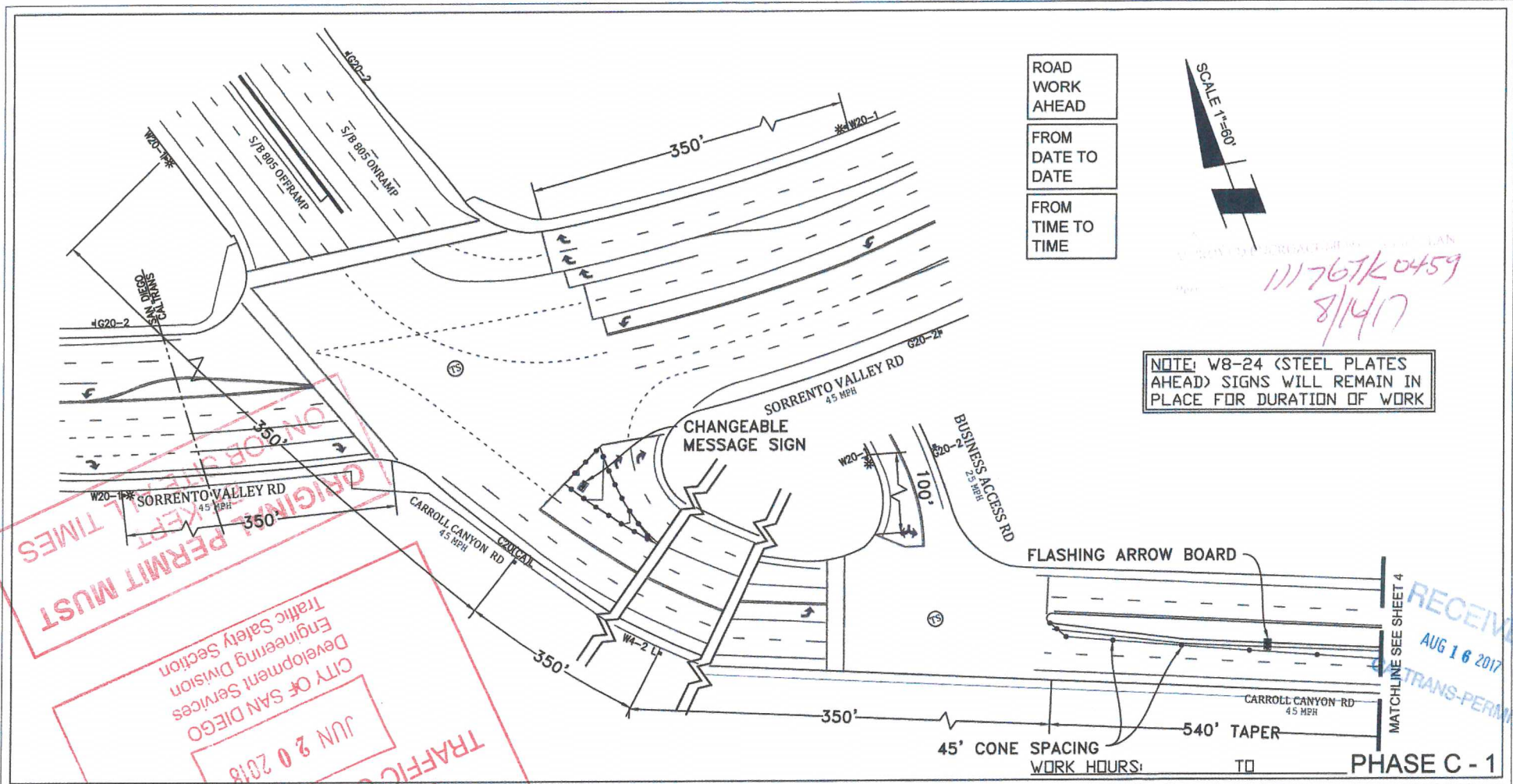

ROAD WORK AHEAD
 FROM DATE TO DATE
 FROM TIME TO TIME

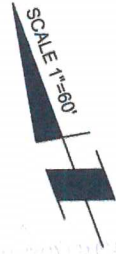

111767K0459
 8/14/17

NOTE: W8-24 (STEEL PLATES AHEAD) SIGNS WILL REMAIN IN PLACE FOR DURATION OF WORK

ORIGINAL PERMIT MUST BE KEPT ON SITE AT ALL TIMES

CITY OF SAN DIEGO
 Engineering Services
 Development Division
 Traffic Safety Section
 JUN 20 2018
 APPROVED FOR PERMIT

RECEIVED
 AUG 16 2017
 TRANS-PERMIT

PROJECT NAME: TL23071 - Sycamore Canyon Substation To Penasquitos Substation - 230 KV Underground

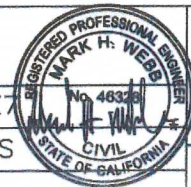

DATE: 7/12/2017
 DESIGNED: Clint Jones
 CHECKED BY: Mark Webb

AIRX SURVEYORS, INC.
 Gail McMorran
 President
 2504 EAST EL MONTE PARKWAY, SUITE C
 ESCONDIDO, CA 92027
 PHONE: (760) 460-2347
 CELL: (760) 419-3728

NV5
 15092 AVENUE OF SCIENCE, SUITE 200
 SAN DIEGO, CA 92128
 P: 858.385.0500 WWW.NV5.COM

AIRX JOB#: X160218
 THOMAS GRID#: 1208-E7
 MISC/POTHOLE#: _____
 DRAWN FOR: CALTRANS

TYPE OF WORK: TRENCHING / CONDUIT

SHEET 5 OF 16



NOTE: W8-24 (STEEL PLATES AHEAD) SIGNS WILL REMAIN IN PLACE FOR DURATION OF WORK

ORIGINAL PERMIT MUST BE KEPT ON JOB SITE ALL TIMES

11176TK0459
8/16/17

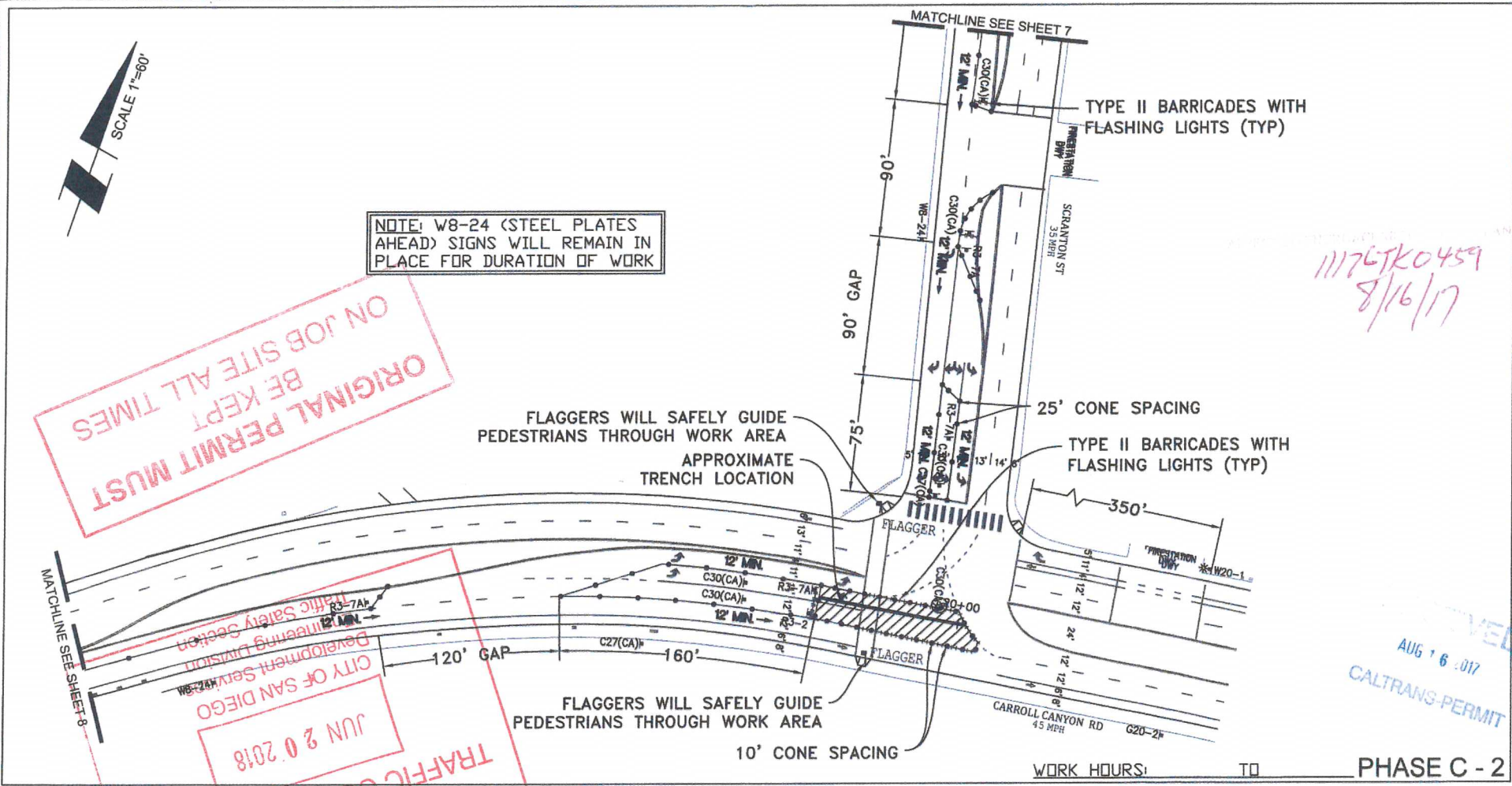

APPROVED
AUG 16 2017
CALTRANS-PERMIT

WORK HOURS: _____ TO _____ PHASE C - 2

PROJECT NAME: TL23071 - Sycamore Canyon Substation To
Penasquitos Substation - 230 KV Underground

DATE: 7/12/2017
DESIGNED: Clint Jones
CHECKED BY: Mark Webb

AIRX SURVEYORS, INC.
2804 EAST EL NORTE PARKWAY, SUITE C
ESCONDIDO, CA 92027
PHONE: (760) 450-2347
CELL: (760) 419-3738

Gail McMorran
President

NV5

15092 AVENUE OF SCIENCE, SUITE 200
SAN DIEGO, CA 92128
P: 858 385 0500 WWW.NV5.COM

AIRX JOB#: X160218
MISC/POTHoles#: _____
TYPE OF WORK: TRENCHING / CONDUIT

THOMAS GRID#: 1208-E7
DRAWN FOR: CALTRANS

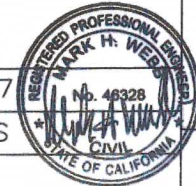

SHEET 6 OF 16

SCALE 1"=60'

11176JKL459
8/16/17

APPROVED
TRAFFIC CONTROL PERMIT
JUN 20 2018
CITY OF SAN DIEGO
Development Services
Engineering Division
Traffic Safety Section
ORIGINAL PERMIT MUST
BE KEPT ALL TIMES
ON JOB SITE

NOTE: W8-24 (STEEL PLATES
AHEAD) SIGNS WILL REMAIN IN
PLACE FOR DURATION OF WORK

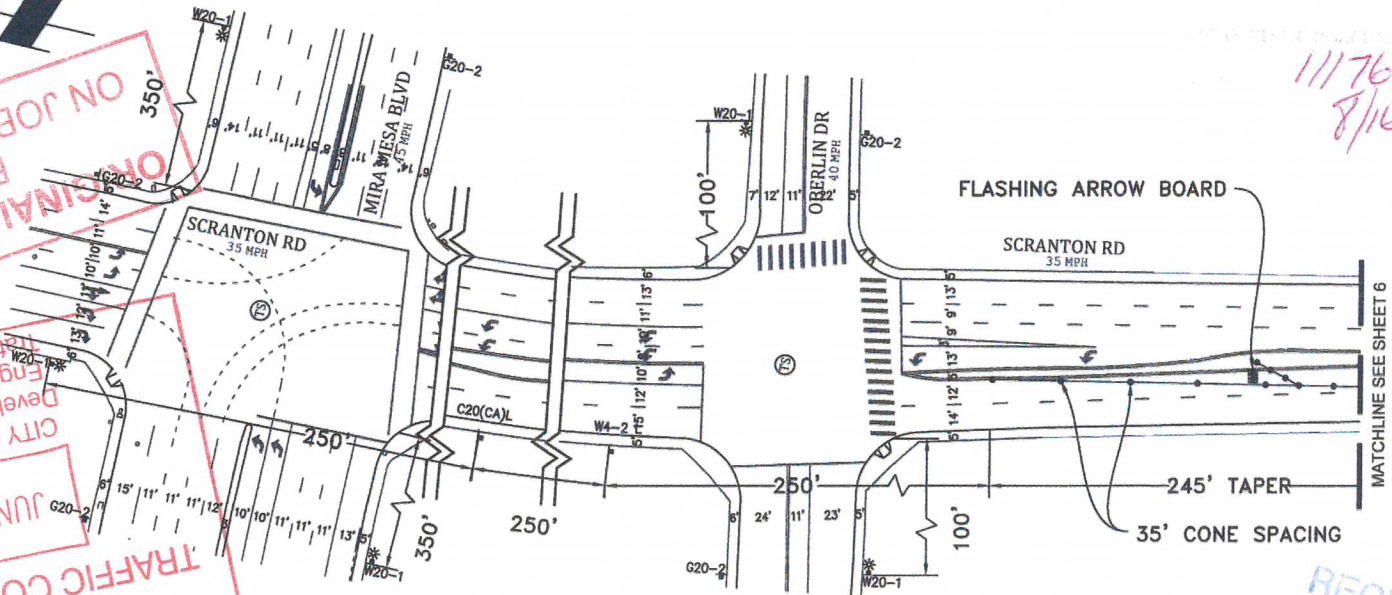

RECEIVED
AUG 16 2017
CALTRANS-PERMIT

WORK HOURS: _____ TO _____ PHASE C - 2

PROJECT NAME: TL23071 - Sycamore Canyon Substation To
Penasquitos Substation - 230 KV Underground

DATE: 7/12/2017
DESIGNED: Clint Jones
CHECKED BY: Mark Webb

AIRX SURVEYORS, INC.
Gail McMorran
President
2534 EAST EL NORTE PARKWAY, SUITE C
ESCONDIDO, CA 92027
PHONE: (760) 485-3347
CELL: (760) 419-3728

NV5
15092 AVENUE OF SCIENCE, SUITE 200
SAN DIEGO, CA 92128
P. 858.385.0500 WWW.NV5.COM

AIRX JOB#: X160218
MISC/POTHoles#: _____
TYPE OF WORK: TRENCHING / CONDUIT

THOMAS GRID#: 1208-E7
DRAWN FOR: CALTRANS



SHEET 7 OF 16

SCALE 1"=60'

NOTE: W8-24 (STEEL PLATES AHEAD) SIGNS WILL REMAIN IN PLACE FOR DURATION OF WORK

ON JOB SITE ALL TIMES
BE KEPT
ORIGINAL PERMIT MUST

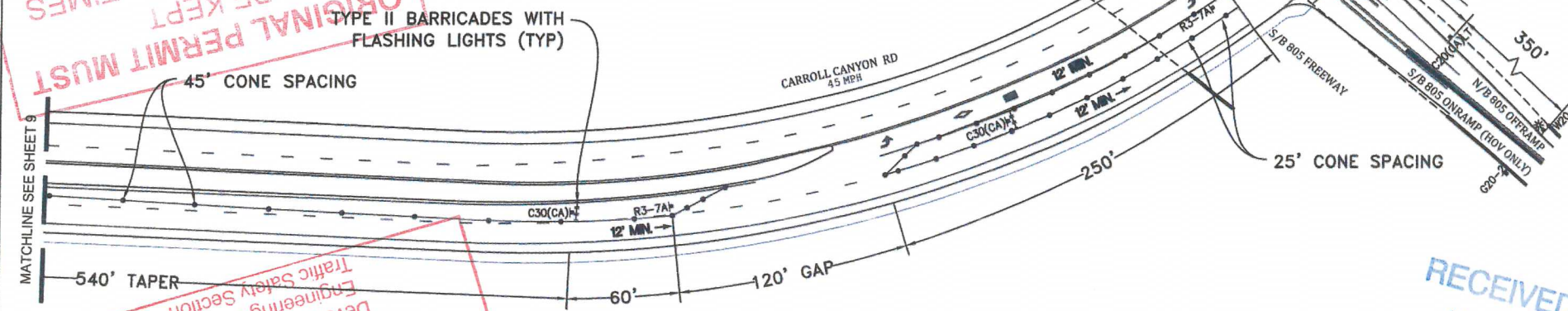

RECEIVED
AUG 16 2017
CALTRANS-PERMIT

WORK HOURS: _____ TO _____ PHASE C - 2

PROJECT NAME: TL23071 - Sycamore Canyon Substation To Penasquitos Substation - 230 KV Underground

DATE: 7/12/2017
DESIGNED: Clint Jones
CHECKED BY: Mark Webb

AIRX SURVEYORS, INC.
Gail McMorran
President
2534 EAST EL NORTE PARKWAY, SUITE C
ESCONDIDO, CA 92027
PHONE: (760) 480-2347
CELL: (760) 419-3738

NV5
15092 AVENUE OF SCIENCE, SUITE 200
SAN DIEGO, CA 92128
P: 858.385.0500 WWW.NV5.COM

AIRX JOB#: X160218
MISC/POTHOLES#: _____
TYPE OF WORK: TRENCHING / CONDUIT

THOMAS GRID#: 1208-E7
DRAWN FOR: CALTRANS



SHEET 8 OF 16

APPROVED
TRAFFIC CONTROL PERMIT
JUN 20 2018
CITY OF SAN DIEGO
Development Services
Engineering Division
Traffic Safety Section

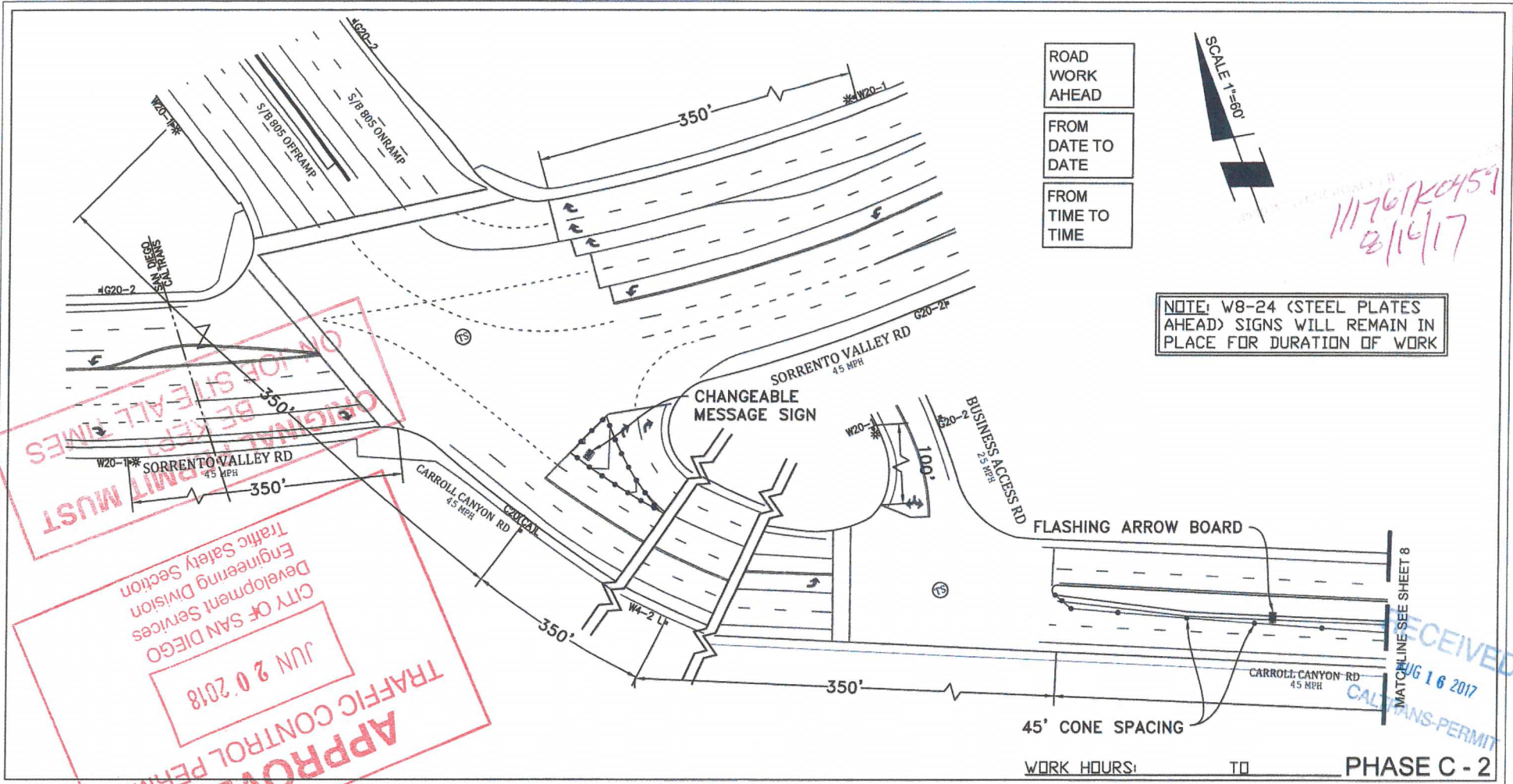

ROAD
WORK
AHEAD

FROM
DATE TO
DATE

FROM
TIME TO
TIME

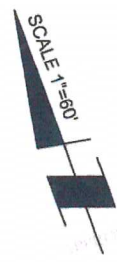

111761K0459
8/16/17

NOTE: W8-24 (STEEL PLATES AHEAD) SIGNS WILL REMAIN IN PLACE FOR DURATION OF WORK

ORIGINAL PERMIT MUST BE KEPT ON SITE ALL TIMES

APPROVED TRAFFIC CONTROL PERMIT

JUN 20 2018

CITY OF SAN DIEGO
Development Services
Engineering Division
Traffic Safety Section

RECEIVED

AUG 16 2017

CALTRANS-PERMIT

MATCHLINE SEE SHEET 8

WORK HOURS: _____ TO _____ PHASE C - 2

PROJECT NAME: TL23071 – Sycamore Canyon Substation To Penasquitos Substation – 230 KV Underground		DATE: 7/12/2017	
AIRX JOB#: X160218		DESIGNED: Clint Jones	
MISC/POTHOLES#:		CHECKED BY: Mark Webb	
TYPE OF WORK: TRENCHING / CONDUIT		SHEET 9 OF 16	
SURVEYORS, INC. Gail McMorrان President 2534 EAST EL NORTE PARKWAY, SUITE C ESCONDIDO, CA 92027 PHONE: (760) 480-2547 CELL: (760) 419-3728	N/V/5 15092 AVENUE OF SCIENCE, SUITE 200 SAN DIEGO, CA 92128 P: 858.365.0500 WWW.NV5.COM	THOMAS GRID#: 1208-E7 DRAWN FOR: CALTRANS	 REGISTERED PROFESSIONAL ENGINEER MARK H. WEBB No. 46328 CIVIL STATE OF CALIFORNIA



11176TK0459
8/16/17

NOTE: W8-24 (STEEL PLATES AHEAD) SIGNS WILL REMAIN IN PLACE FOR DURATION OF WORK

ORIGINAL PERMIT MUST BE KEPT ON JOB SITE ALL TIMES

RECEIVED
AUG 16 2017
CALTRANS PERMIT

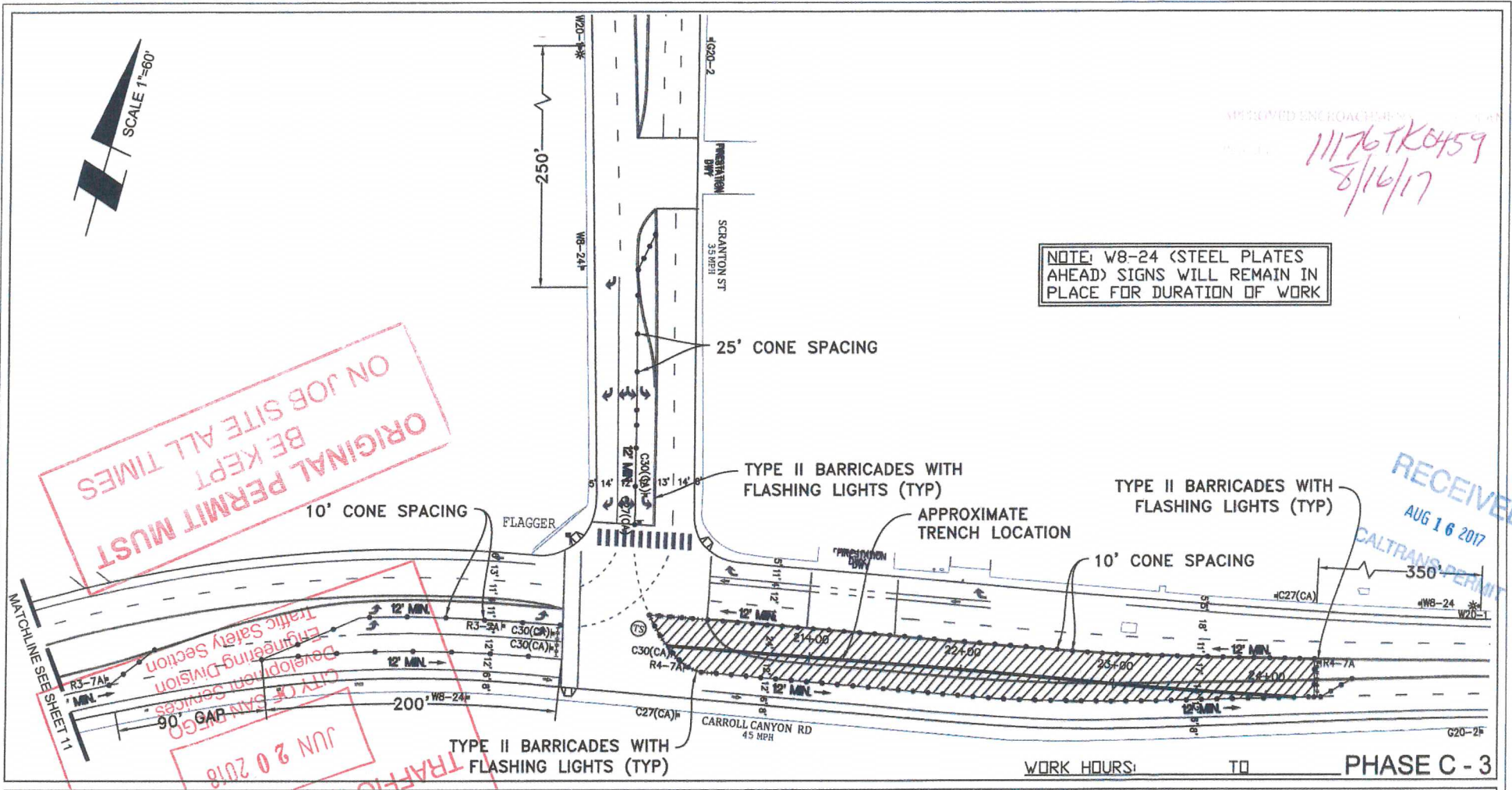

PROJECT NAME: TL23071 - Sycamore Canyon Substation To Penasquitos Substation - 230 KV Underground

WORK HOURS: TO PHASE C - 3

AIRX SURVEYORS, INC.
Gail McMormann
President
2524 EAST EL NORTE PARKWAY, SUITE C
ESCONDIDO, CA 92027
PHONE: (760) 480-2247
CELL: (760) 419-3736

N/V/5
15092 AVENUE OF SCIENCE, SUITE 200
SAN DIEGO, CA 92128
P: 858.385.0500 WWW.NV5.COM

AIRX JOB#: X160218
MISC/POTHOLES#:
TYPE OF WORK: TRENCHING / CONDUIT

THOMAS GRID#: 1208-E7
DRAWN FOR: CALTRANS

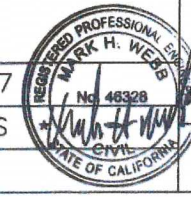

DATE: 7/12/2017
DESIGNED: Clint Jones
CHECKED BY: Mark Webb
SHEET 10 OF 16

SCALE 1"=60'

11/17/16
8/16/17

NOTE: W8-24 (STEEL PLATES AHEAD) SIGNS WILL REMAIN IN PLACE FOR DURATION OF WORK

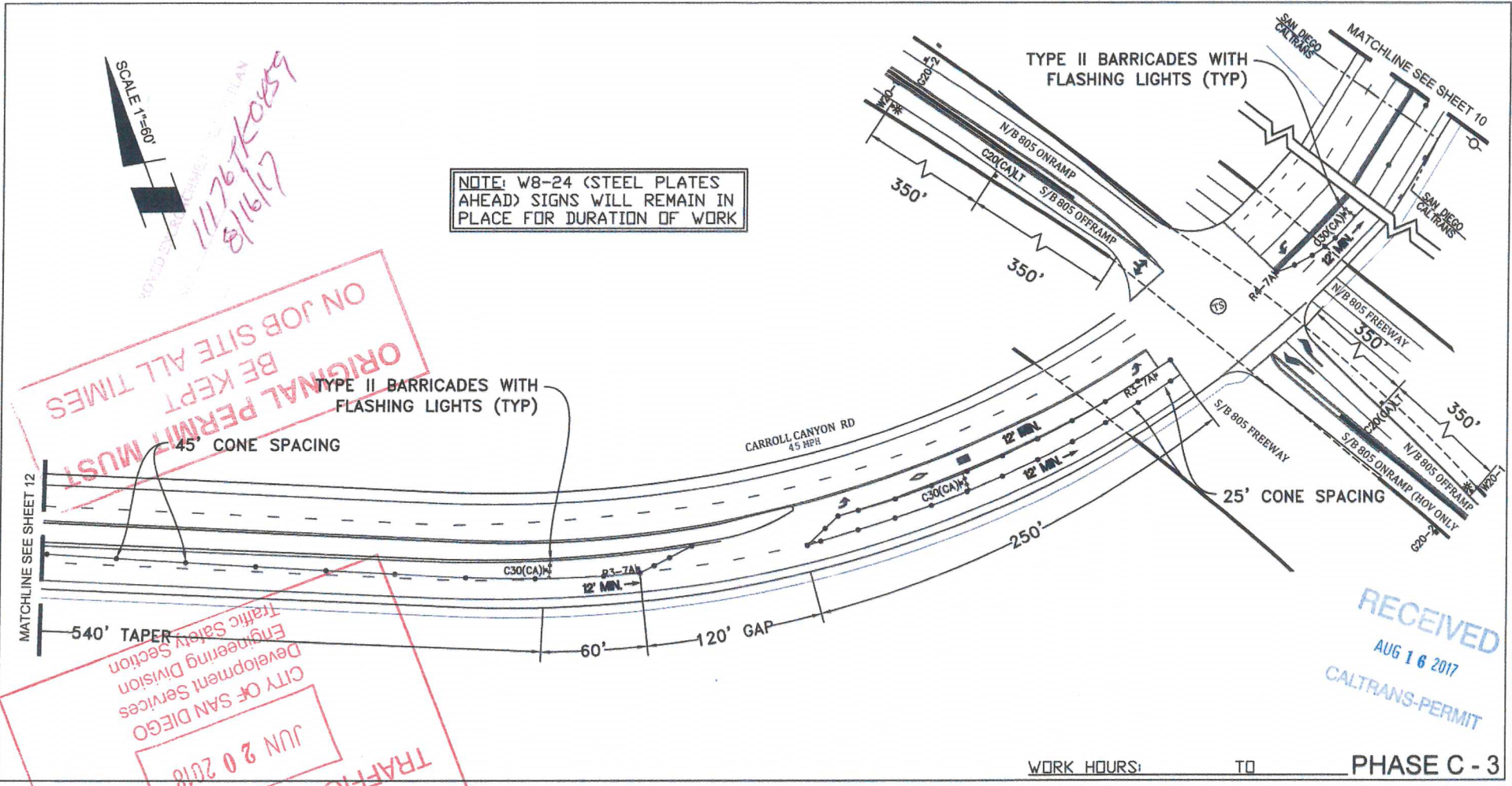

ORIGINAL PERMIT MUST BE KEPT ALL TIMES ON JOB SITE
 JUN 20 2018
 CITY OF SAN DIEGO
 Development Services
 Engineering Section
 Traffic Safety Section
 APPROVED FOR PERMIT

RECEIVED
AUG 16 2017
CALTRANS-PERMIT

WORK HOURS: _____ TO _____ PHASE C - 3

PROJECT NAME: TL23071 - Sycamore Canyon Substation To Penasquitos Substation - 230 KV Underground

DATE: 7/12/2017
DESIGNED: Clint Jones
CHECKED BY: Mark Webb

AIRX SURVEYORS, INC.
Gail McMoran
President
1954 EAST EL NORTE PARKWAY, SUITE C
ESCONDIDO, CA 92027
PHONE: (760) 438-2247
CELL: (760) 419-3728

N/V/5
15092 AVENUE OF SCIENCE, SUITE 200
SAN DIEGO, CA 92128
P: 858.385.0500 WWW.NV5.COM

AIRX JOB#: X160218
MISC/POTHOLES#: _____
TYPE OF WORK: TRENCHING / CONDUIT

THOMAS GRID#: 1208-E7
DRAWN FOR: CALTRANS



SHEET 11 OF 16

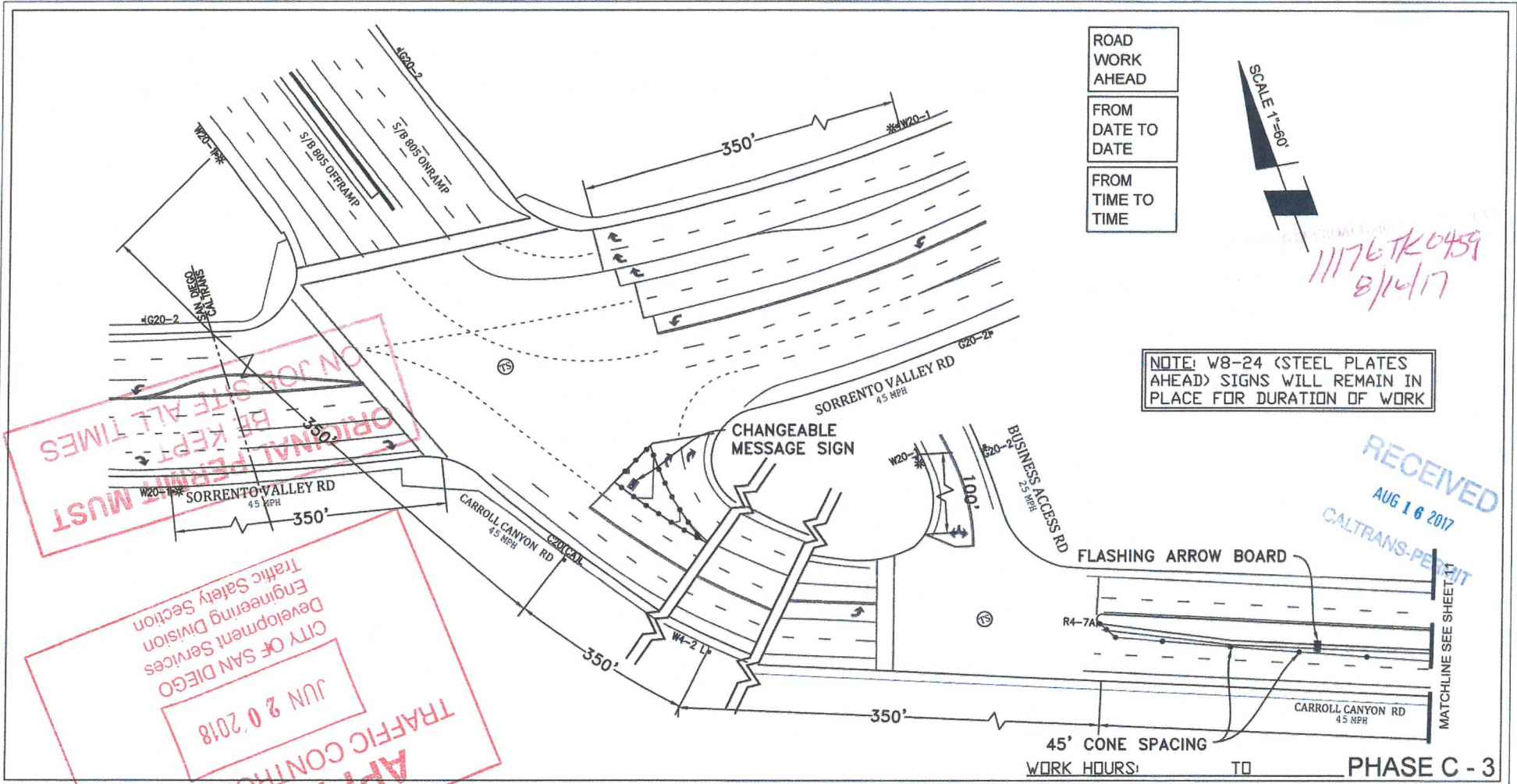

ROAD WORK AHEAD
 FROM DATE TO DATE
 FROM TIME TO TIME

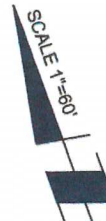

11176 TK 0459
 8/16/17

NOTE: W8-24 (STEEL PLATES AHEAD) SIGNS WILL REMAIN IN PLACE FOR DURATION OF WORK

RECEIVED
 AUG 16 2017
 CALTRANS-PERMIT

ORIGINAL PERMIT MUST BE KEPT AT ALL TIMES ON JOB SITE
 CITY OF SAN DIEGO
 Development Services
 Engineering Section
 Traffic Safety Section
 JUN 20 2018
 TRAFFIC CONTROL PERMIT APPROVED

45' CONE SPACING WORK HOURS: TO PHASE C - 3

PROJECT NAME: TL23071 - Sycamore Canyon Substation To
 Penasquitos Substation - 230 KV Underground

DATE: 7/12/2017
 DESIGNED: Clint Jones
 CHECKED BY: Mark Webb

AIRX SURVEYORS, INC.
 Gail McMorran
 President
 2394 EAST EL NORTE PARKWAY, SUITE C
 ESCONDIDO, CA 92027
 PHONE: (760) 485-2347
 CELL: (760) 419-3738

NV5
 15092 AVENUE OF SCIENCE, SUITE 200
 SAN DIEGO, CA 92128
 P: 858.385.0500 WWW.NV5.COM

AIRX JOB#: X160218
 THOMAS GRID#: 1208-E7
 MISC/POTHoles#: DRAWN FOR: CALTRANS



TYPE OF WORK: TRENCHING / CONDUIT

SHEET 12 OF 16



MATCHLINE SEE SHEET 14

NOTE: W8-24 (STEEL PLATES AHEAD) SIGNS WILL REMAIN IN PLACE FOR DURATION OF WORK

11176TK0459
8/16/17

ON JOB SITE ALL TIMES
BE KEPT
ORIGINAL PERMIT MUST

TRAFFIC CONTROL PERMIT
JUN 20 2018
CITY OF SAN DIEGO
Development Services
Engineering Division
Traffic Safety Section

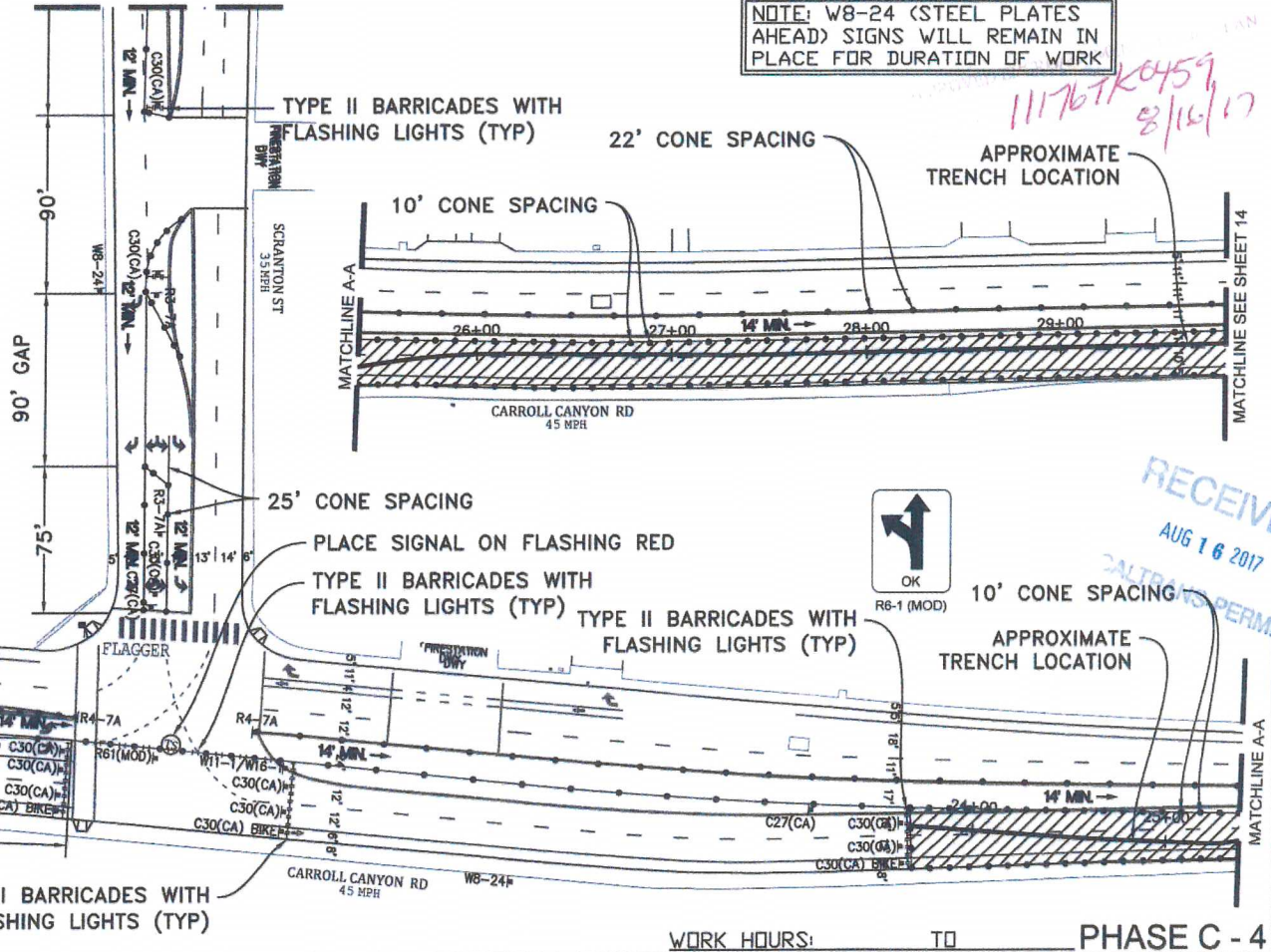

RECEIVED
AUG 16 2017
CALTRANS PERMIT

WORK HOURS: _____ TO _____ PHASE C - 4

PROJECT NAME: TL23071 Sycamore Canyon Substation To Penasquitos Substation - 230 KV Underground

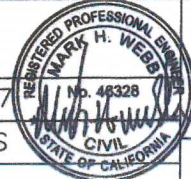

DATE: 7/12/2017
DESIGNED: Clint Jones
CHECKED BY: Mark Webb

AIRX SURVEYORS, INC.
Gail McMorran
President
2534 EAST EL NORTE PARKWAY, SUITE C
ESCONDIDO, CA 92027
PHONE: (760) 480-2247
CELL: (760) 419-3738

NV5
15092 AVENUE OF SCIENCE, SUITE 200
SAN DIEGO, CA 92128
P: 858.385.0500 WWW.NV5.COM

AIRX JOB#: X160218
MISC/POTHOLES#: _____
THOMAS GRID#: 1208-E7
DRAWN FOR: CALTRANS
TYPE OF WORK: TRENCHING / CONDUIT

SHEET 13 OF 16

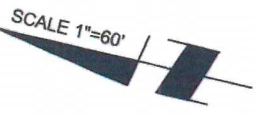

NOTE: W8-24 (STEEL PLATES AHEAD) SIGNS WILL REMAIN IN PLACE FOR DURATION OF WORK

11176TK0459
8/16/17

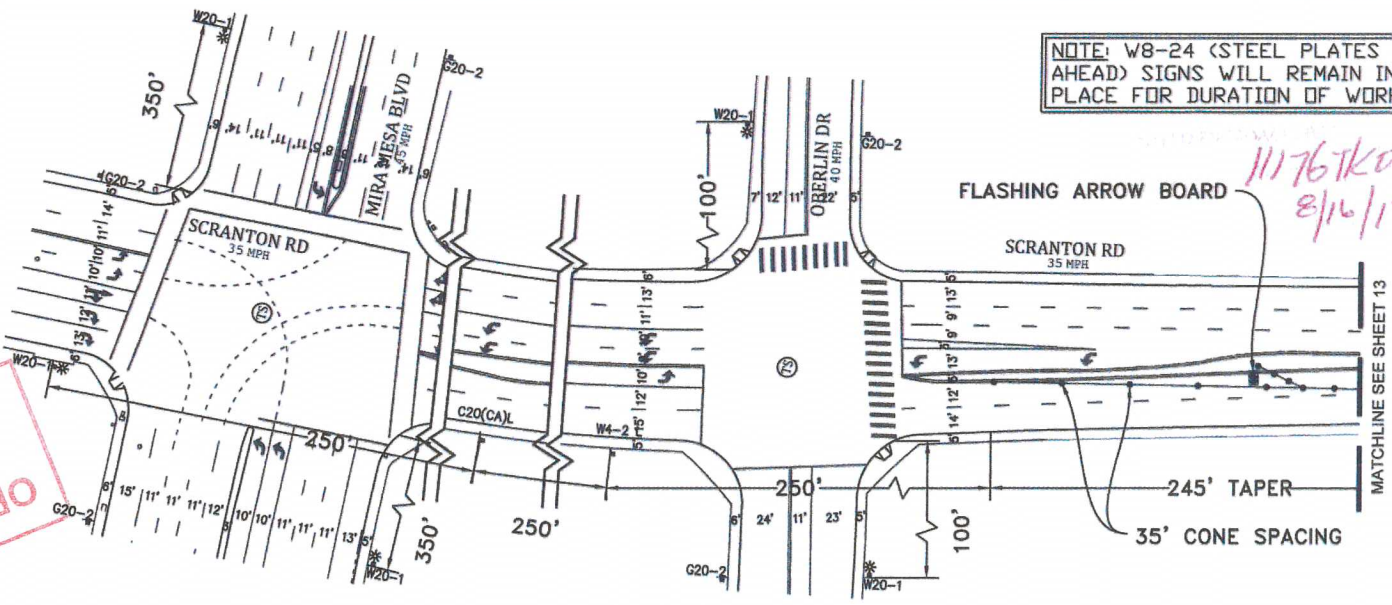

ORIGINAL PERMIT MUST BE KEPT ON JOB SITE AT ALL TIMES

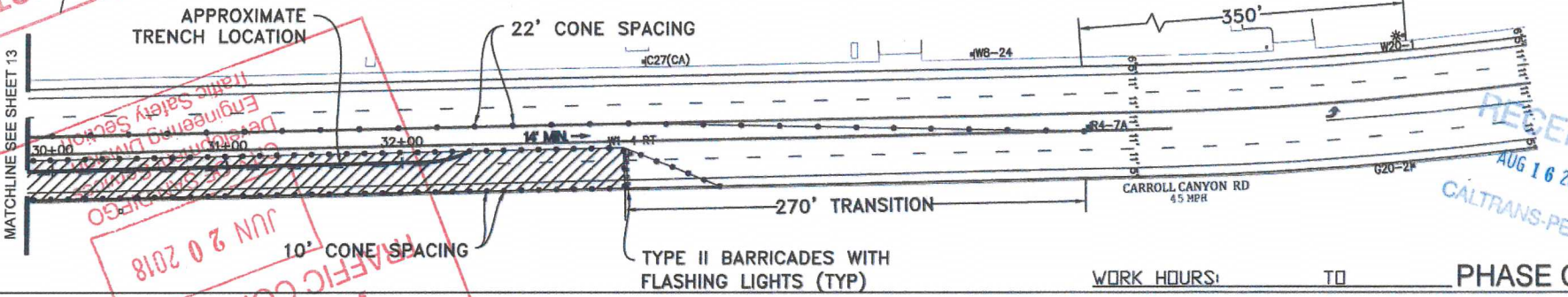

RECEIVED
AUG 16 2017
CALTRANS-PERMIT

WORK HOURS: _____ TO _____ PHASE C - 4

PROJECT NAME: TL23071 Sycamore Canyon Substation To Penasquitos Substation - 230 KV Underground

DATE: 7/12/2017
DESIGNED: Clint Jones
CHECKED BY: Mark Webb

AIRX SURVEYORS, INC.
Gail McMoran
President
274 EAST EL NORTE PARKWAY, SUITE C
ESCONDIDO, CA 92027
PHONE: (760) 438-2342
CELL: (760) 418-3738

N/V/5
15092 AVENUE OF SCIENCE, SUITE 200
SAN DIEGO, CA 92128
P. 658.385.0500 WWW.NV5.COM

AIRX JOB#: X160218
MISC/POTHOLES#:

THOMAS GRID#: 1208-E7
DRAWN FOR: CALTRANS

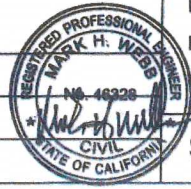

TYPE OF WORK: TRENCHING / CONDUIT

SHEET 14 OF 16

11176TK 0459
8/16/17

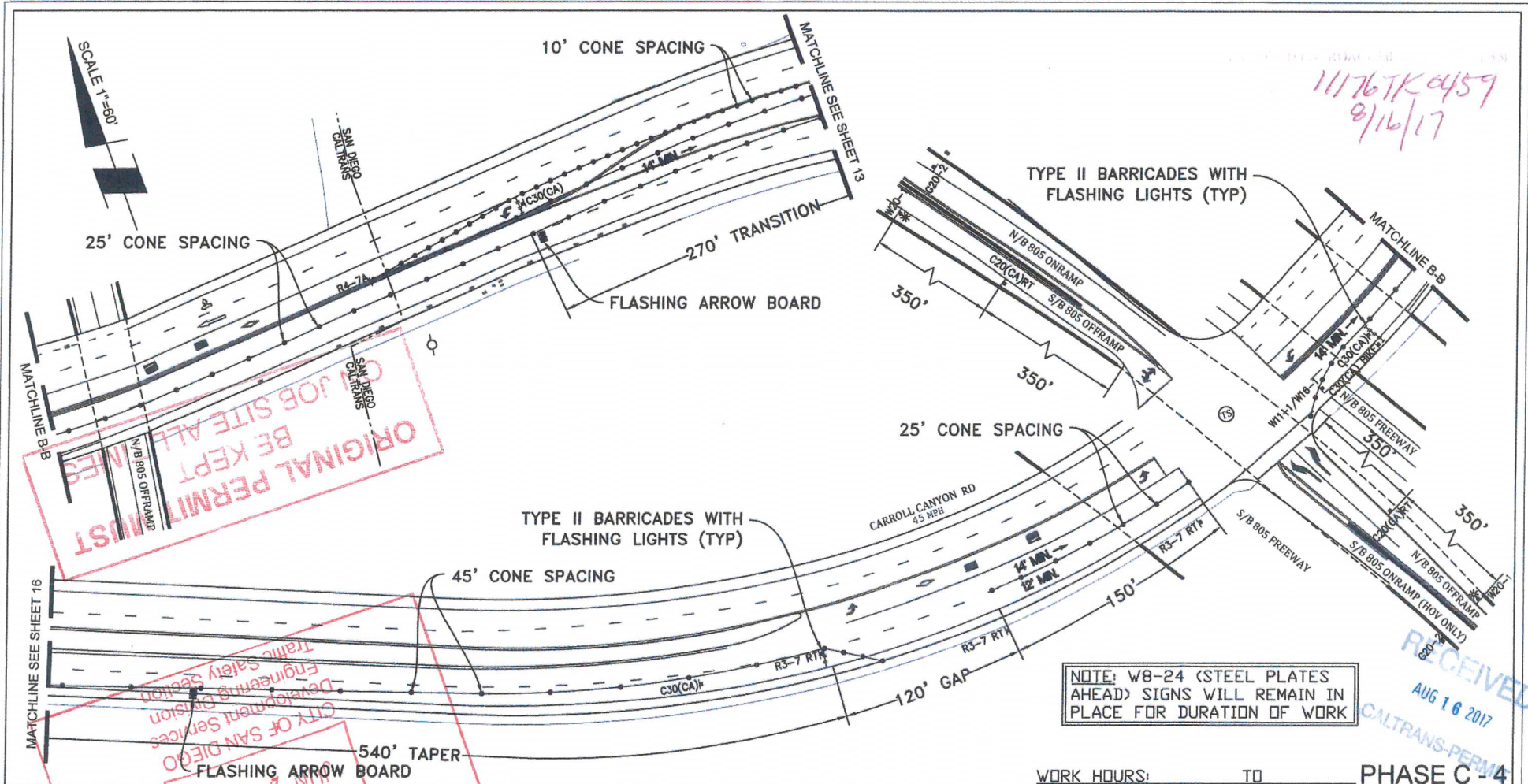

NOTE: W8-24 (STEEL PLATES AHEAD) SIGNS WILL REMAIN IN PLACE FOR DURATION OF WORK

WORK HOURS: _____ TO _____ PHASE C-4

RECEIVED
AUG 16 2017
CALTRANS-PERMA

PROJECT NAME: TL23071 - Sycamore Canyon Substation To
Penasquitos Substation - 230 KV Underground

AIRX SURVEYORS, INC.
Gail McMoran
President
2224 EAST EL NORTE PARWAY, SUITE 200
ESCONDIDO, CA 92027
PHONE: (760) 480-2847
CELL: (760) 419-3728

NV5
15092 AVENUE OF SCIENCE, SUITE 200
SAN DIEGO, CA 92128
P: 858.385.0500 WWW.NV5.COM

AIR JOB#: X160218
MISC/POTHOLES#: _____
TYPE OF WORK: TRENCHING / CONDUIT

THOMAS GRID#: 1208-E7
DRAWN FOR: CALTRANS



DATE: 7/12/2017
DESIGNED: Clint Jones
CHECKED BY: Mark Webb

SHEET 15 OF 16

ORIGINAL PERMIT MUST BE KEPT AT JOB SITE ALL TIMES

CITY OF SAN DIEGO
Department Services
Engineering Division
Traffic Safety Section
AUG 20 2017

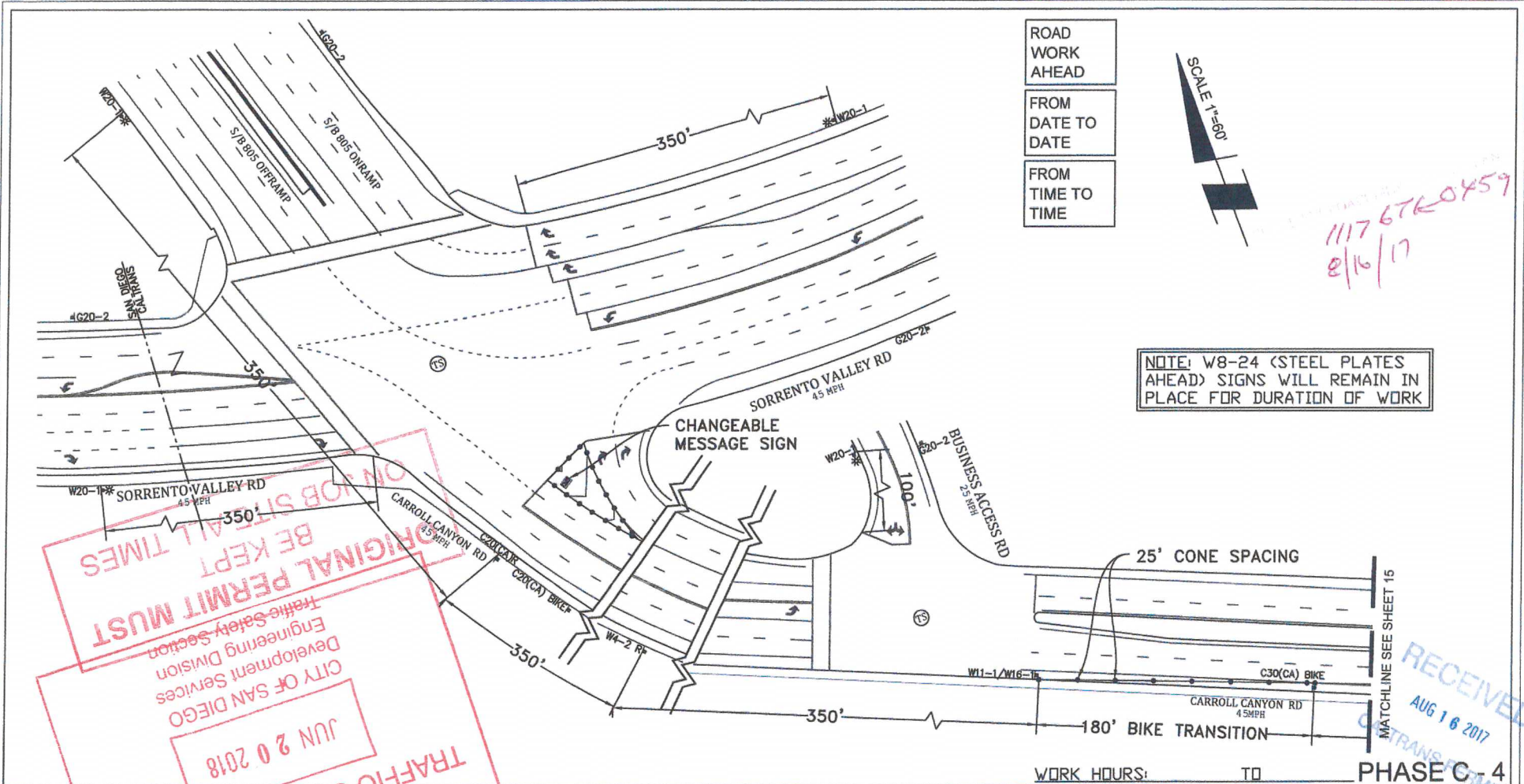

ROAD WORK AHEAD
FROM DATE TO DATE
FROM TIME TO TIME

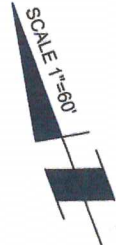

1117 676-0459
8/16/17

NOTE: W8-24 (STEEL PLATES AHEAD) SIGNS WILL REMAIN IN PLACE FOR DURATION OF WORK

ON JOB SITE ALL TIMES
BE KEPT
ORIGINAL PERMIT MUST
Traffic Safety Section
Engineering Division
Development Services
CITY OF SAN DIEGO
JUN 20 2018

RECEIVED
AUG 16 2017
CALTRANS PERMIT

WORK HOURS: TO PHASE C-4

PROJECT NAME: TL23071 - Sycamore Canyon Substation To Penasquitos Substation - 230 KV Underground

AIRX SURVEYORS, INC.
Gail McMoran
President
2524 EAST EL NORTE PARKWAY, SUITE C
ESCONDIDO, CA 92027
PHONE: (760) 458-0347
CELL: (760) 418-3738

NV5
15092 AVENUE OF SCIENCE, SUITE 200
SAN DIEGO, CA 92128
P: 858.385.0500 WWW.NV5.COM

AIRX JOB#: X160218
MISC/POTHOLE#:
TYPE OF WORK: TRENCHING / CONDUIT

THOMAS GRID#: 1208-E7
DRAWN FOR: CALTRANS

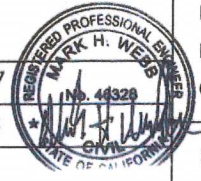

DATE: 7/12/2017
DESIGNED: Clint Jones
CHECKED BY: Mark Webb

SHEET 16 OF 16