



# Traffic Control Permit (TCP) Multiple Location List

( Franchise Utility Company Only - May Not Be submitted By Contractor)

THE CITY OF SAN DIEGO

APPROVED  
 TRAFFIC CONTROL PERMIT  
 DEC 06 2017  
 CITY OF SAN DIEGO  
 Development Services  
 Engineering Division  
 Traffic Safety Section

To: City of San Diego, Traffic Permit Section

Date: 12/05/2017

From: (Company): SDG&E

Phone No.: 619-778-2405

Contact Person: Rod Nelson

Fax.: \_\_\_\_\_

W.O. or Account #: Permit # \_\_\_\_\_

TCP No. \_\_\_\_\_

**City Use Only**

Authorized # \_\_\_\_\_

By Felipe Anla

Yes X No \_\_\_\_\_

Date Reviewed 12/6/17

**TYPE OF WORK**

- 1 = Lane Closure
- 2 = Street Closure
- 3 = Sidewalk Closure
- 4 = Alley Closure
- 5 = Parking Lane
- 6 = Detour
- 7 = Trenching
- 8 = Flagging

Location	From	To	Start Date *	End Date *	Work Hours **	Thomas Bros.	Type of Work
Carroll Canyon Road	Scranton Street	Youngstown Way	12/10/17	12/29/17	9:00PM - 5:00AM	1208-D7, E7, F7	1,5,7,8
Scranton Road	Carroll Canyon Road	Mira Mesa Blvd	12/10/17	12/29/17	9:00PM - 5:00AM	1208-E7	8
Younstown Way	Carroll Canyon Road	Oberlin Drive	12/10/17	12/29/17	9:00PM - 5:00AM	1208-F7	8
<b>ATTENTION UTILITY COMPANY</b>							
Special Inspection Fees May Be Applied By City of San Diego For Any Night or Weekend Work.							

ORIGINAL PERMIT MUST  
 BE KEPT  
 ON JOB SITE ALL TIMES

**Comments:** Trenching crew - Phases 1 and Caltrans Phases C-1 through C-4 - Sunday through Thursday night work, 9pm - 5am **\*NO WORK 12/24-12/25\***

Must be submitted a minimum of 2 working days prior to start of work. All columns must be filled out for proper authorization

Fax or mail to: City of San Diego • Traffic Control Permit Section • 1222 First Avenue, MS 501 • San Diego, CA 92101. Fax (619) 446-5489 Office (619) 446-5150

\* Work Days: Monday Through Friday \*\* Work Hours : 8:30 AM - 3:30PM. Unless other hours are preapproved)

No Work on Saturdays, Sundays, or Holidays Unless Approved and Noted In Comments

Minimum of 5 working days required for construction work which affects traffic signal e-mail info to: [dciafre@sandiego.gov](mailto:dciafre@sandiego.gov)

**ATTENTION**

The night work hours listed on this Permit may be revised by Noise Permit intake of the Code Enforcement Section.

**SIGN LEGEND**

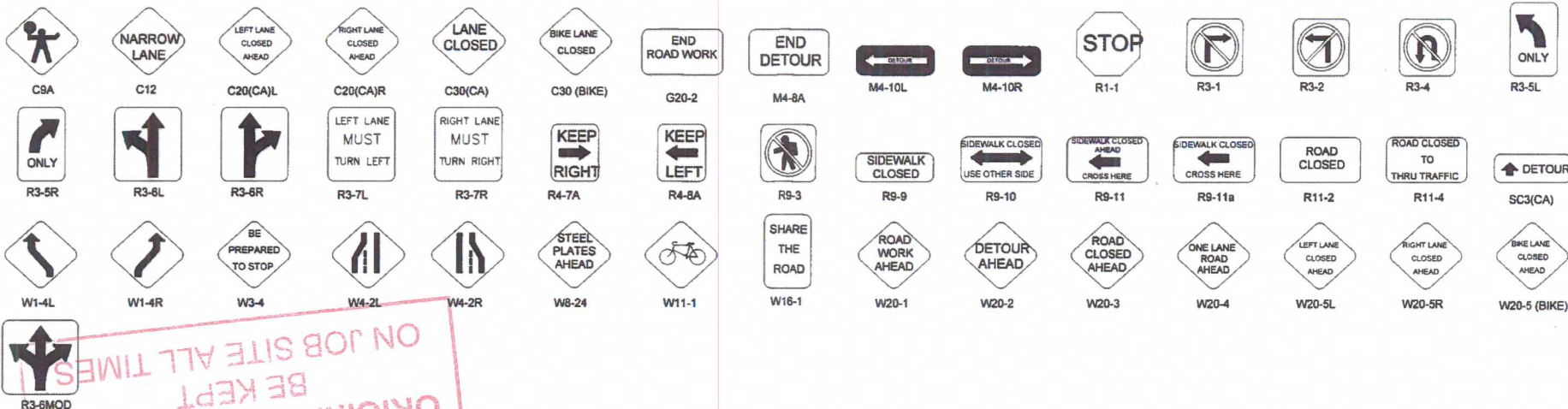

ORIGINAL PERMIT MUST BE KEPT ON JOB SITE ALL TIMES

APPROACH SPEED (MPH)	MINIMUM DISTANCE (FEET) BETWEEN SIGNS AND FROM LAST SIGN TO TAPER	MINIMUM TAPER LENGTHS (L) (FEET) FOR 12-FOOT LANE			BUFFER LENGTH (FEET)	MAX CONE SPACING		
		L	1/2L	1/3L		TAPER	TANGENT	CONFLICT
25	100	125	65	45	155	25	50	12
30	250	180	90	60	200	30	60	15
35	250	245	125	85	250	35	70	17
40	250	320	160	110	305	40	80	20
45	350	540	270	180	360	45	90	22
50	350	600	300	200	425	50	100	25
55+	350	660	330	220	495	55	110	27

**LEGEND**

- APPROXIMATE POTHOLE LOCATION
- SIGN
- TRAFFIC CONES / DELINEATOR
- BARRICADE
- FLAGGER
- FLASHING ARROW SIGN
- WORK ZONE
- CONSTRUCTION VEHICLE
- BUS STOP

APPROVED

TRAFFIC CONTROL PERMIT

DEC 06 2017

CITY OF SAN DIEGO

UTILITY SURVEYORS, INC. Development Services  
**AIRX** Engineering Division  
 Gail McMorran President  
 2534 EAST EL NORTE PARKWAY, SUITE C  
 ESCONDIDO, CA 92027  
 PHONE: (760) 480-2347  
 CELL: (760) 419-3738

**PROJECT NAME:** TL23071 - Sycamore Canyon Substation To Penasquitos Substation - 230 KV Underground

**AIRX JOB#:** X160218

**THOMAS GRID#:** -

**TYPE OF WORK:** TRENCHING / CONDUIT

**DRAWN FOR:** SAN DIEGO COUNTY

**MISC/POTHOLES#:**

**DATE:** Mar 2, 2017

**DESIGNED BY:**  
Clint Jones

**SHEET 1 OF 4**



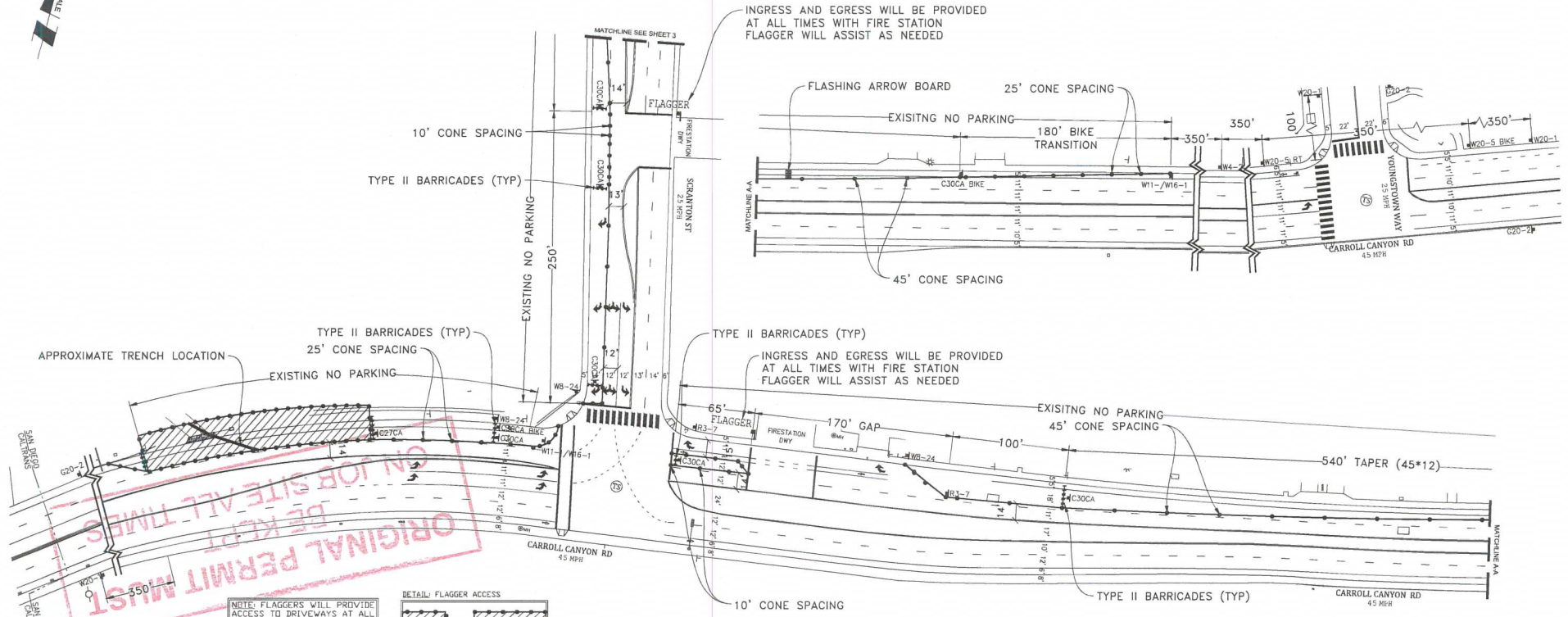

ORIGINAL PERMIT MUST BE KEPT ON JOB SITE ALL TIMES

- NOTE: FLAGGERS WILL PROVIDE ACCESS TO DRIVEWAYS AT ALL TIMES
- NOTE: FLAGGERS WILL SAFELY GUIDE PEDESTRIANS THROUGH WORK AREA
- NOTE: CONTRACTOR WILL ALLOW FIRE STATION INGRESS AND EGRESS AT ALL TIMES
- NOTE: WB-24 STEEL PLATES AHEAD SIGNS WILL REMAIN IN PLACE FOR DURATION OF WORK

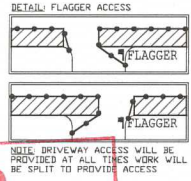

- NOTE: CONTRACTOR WILL COORDINATE ALL WORK WITH FIRE STATION PRIOR TO START OF WORK
- NOTE: CONTRACTOR WILL COORDINATE ALL WORK WITH TRANSIT DEPARTMENT 9 DAYS PRIOR TO START OF WORK
- NOTE: CONTRACTOR WILL COORDINATE ALL WORK WITH RESIDENTS PRIOR TO START OF WORK
- NOTE: CONTRACTOR WILL COORDINATE ALL WORK WITH BUSINESSES PRIOR TO START OF WORK

WORK HOURS: \_\_\_\_\_ TO \_\_\_\_\_

EYE CONTACT MUST BE MAINTAINED BETWEEN FLAGGERS OR USE 2-WAY COMMUNICATION  
 FLAGGER WILL ASSIST WITH BIKE/VEHICLE TRAFFIC

- LEGEND**
- SIGN
  - SIGNAL
  - TRAFFIC CONES / DELINEATOR
  - BARRICADE
  - FLAGGER
  - FLASHING ARROW SIGN
  - WORK ZONE
  - BUS STOP

**APPROVED TRAFFIC CONTROL PERMIT**

DEC 06 2017

**CITY OF SAN DIEGO**  
 Development Services  
 Engineering Division  
 Traffic Safety Section

UTILITY SURVEYORS, INC.

**Gail McMorran**  
President

234 EAST EL NORTE PARKWAY, SUITE C  
ESCONDIDO, CA 92027  
PHONE: (760) 480-2347  
CELL: (760) 418-3738

<b>PROJECT NAME:</b> TL23071 - SYCAMORE CANYON SUBSTATION TO PENASQUITOS - 230 KV UNDERGROUND		<b>DATE:</b> Mar. 6, 2017
<b>AIRX JOB#:</b> X160218	<b>THOMAS GRID#:</b> -	<b>DESIGNED BY:</b> Clint Jones
<b>TYPE OF WORK:</b> TRENCHING / CONDUIT	<b>DRAWN FOR:</b> CITY OF SAN DIEGO	<b>SHEET 002 OF 148</b>
<b>MISCPOTHOLSES#:</b>		

**PHASE 1**



ORIGINAL PERMIT MUST  
BE KEPT  
ON JOB SITE ALL TIMES

APPROVED  
TRAFFIC CONTROL PERMIT

DEC 06 2017

CITY OF SAN DIEGO  
Development Services  
Engineering Division  
#16 Safety Section

NOTE: CONTRACTOR WILL COORDINATE ALL WORK WITH RESIDENTS PRIOR TO START OF WORK

NOTE: CONTRACTOR WILL COORDINATE ALL WORK WITH BUSINESSES PRIOR TO START OF WORK









EYE CONTACT MUST BE MAINTAINED BETWEEN FLAGGERS OR USE 2-WAY COMMUNICATION  
FLAGGER WILL ASSIST WITH BIKE/VEHICLE TRAFFIC

NOTE: CONTRACTOR WILL COORDINATE ALL WORK WITH FIRE STATION PRIOR TO START OF WORK

NOTE: CONTRACTOR WILL COORDINATE ALL WORK WITH TRANSIT DEPARTMENT 5 DAYS PRIOR TO START OF WORK

NOTE: CONTRACTOR WILL COORDINATE ALL WORK WITH EXISTING PROJECTS AND NOT CONFLICT WITH EXISTING TRAFFIC CONTROL

**LEGEND**

-  SIGN
-  SIGNAL
-  TRAFFIC CONES / DELINEATOR
-  BARRICADE
-  FLAGGER
-  FLASHING ARROW SIGN
-  WORK ZONE
-  BUS STOP

NOTE: FLAGGERS WILL PROVIDE ACCESS TO DRIVEWAYS AT ALL TIMES

NOTE: FLAGGERS WILL SAFELY GUIDE PEDESTRIANS THROUGH WORK AREA

NOTE: CONTRACTOR WILL ALLOW FIRE STATION INGRESS AND EGRESS AT ALL TIMES

NOTE: W8-24 STEEL PLATES AHEAD SIGNS WILL REMAIN IN PLACE FOR DURATION OF WORK

**DETAIL: FLAGGER ACCESS**



NOTE: DRIVEWAY ACCESS WILL BE PROVIDED AT ALL TIMES WORK WILL BE SPLIT TO PROVIDE ACCESS

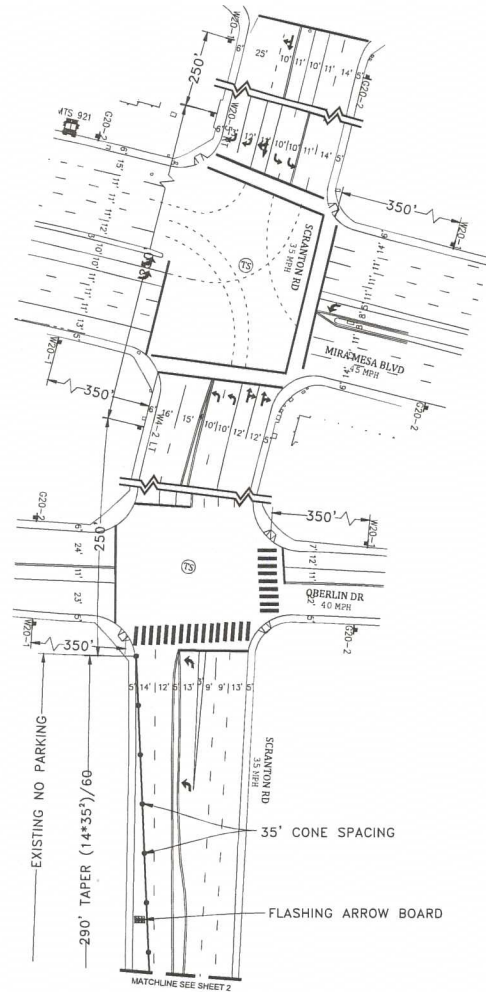

WORK HOURS: \_\_\_\_\_ TO \_\_\_\_\_

**PHASE 1 (CONT)**

**UTILITY SURVEYORS, INC.**  
**AIRX**  
2534 EAST EL NORTE PARKWAY, SUITE C  
ESCONDIDO, CA 92027  
PHONE: (760) 460-2347  
CELL: (760) 419-3738

**Gail McMorran**  
President

<b>PROJECT NAME:</b> TL23071 - SYCAMORE CANYON SUBSTATION TO PENASQUITOS - 230 KV UNDERGROUND	
<b>AIRX JOB#:</b> X160218	<b>THOMAS GRID#:</b> -
<b>TYPE OF WORK:</b> TRENCHING / CONDUIT	<b>DRAWN FOR:</b> CITY OF SAN DIEGO
<b>MISC/POTHOLE#:</b>	

**DATE:** Mar. 6, 2017  
**DESIGNED BY:**  
Clint Jones

**SHEET 003 OF 148**



**SIGN LEGEND**

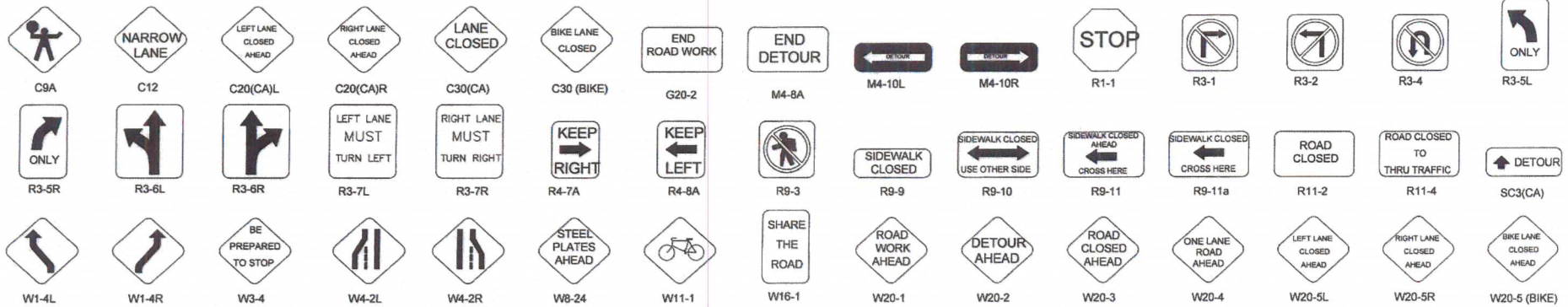

**TABLE 1**

SPEED (S)	MINIMUM TAPER LENGTH FOR WIDTH OF OFFSET 12 FEET (W)					MAXIMUM CHANNELIZING DEVICE SPACING		
	TANGENT 2L	MERCING L	SHIFTING L/2	SHOULDER L/3	TAPER	TANGENT		CONFLICT
						X	Y	
mph	ft	ft	ft	ft	ft	ft	ft	ft
20	160	80	40	27	20	40	10	
25	250	125	63	42	25	50	12	
30	360	180	90	60	30	60	15	
35	490	245	123	82	35	70	17	
40	640	320	160	107	40	80	20	
45	1080	540	270	180	45	90	22	
50	1290	645	320	200	50	100	25	
55	1320	660	330	205	55	100	25	
60	1440	720	360	240	60	100	25	
65	1560	780	390	260	60	100	25	
70	1680	840	420	280	60	100	25	
75	1800	900	450	300	60	100	25	

\* - For other offsets, use the following taper length formula for L:  
 For speed of 40 mph or less, L = WSA/60  
 For speed of 45 mph or more, L = WS  
 Where: L = Taper length in feet  
 W = Width of offset in feet  
 S = Posted speed limit, off-peak 85th-percentile speed prior to work starting, or the anticipated operating speed in mph

\*\* - Use for taper and tangent sections where there are no pavement markings or where there is a conflict between existing pavement markings and channelizers (CA).

**TABLE 2**

SPEED *	LONGITUDINAL BUFFER SPACE AND FLAGGER STATION SPACING			
	Min D **	DOWNGRADE Min D ***		
		-3%	-6%	-9%
mph	ft	ft	ft	ft
20	115	116	120	126
25	155	156	165	173
30	200	205	215	227
35	250	257	271	287
40	305	315	333	354
45	360	378	400	427
50	425	446	474	507
55	495	520	553	593
60	570	598	638	686
65	645	682	728	785
70	730	771	825	891
75	820	866	927	1003

\* - Speed is posted speed limit, off-peak 85th-percentile speed prior to work starting, or the anticipated operating speed in mph  
 \*\* - Longitudinal buffer space or flagger station spacing  
 \*\*\* - Use on sustained downgrade steeper than -3 percent and longer than 1 mile.

**TABLE 3**

ROAD TYPE	ADVANCE WARNING SIGN SPACING		
	DISTANCE BETWEEN SIGNS *		
	A	B	C
URBAN - 25 mph OR LESS	100	100	100
URBAN - MORE THAN 25 mph TO 40 mph	250	250	250
RURAL - MORE THAN 40 mph	350	350	350
EXPRESSWAY / FREEWAY	500	500	500
	1000	1500	2640

\* - The distances are approximate, are intended for guidance purposes only, and should be applied with engineering judgment. These distances should be adjusted by the Engineer for field conditions, if necessary, by increasing or decreasing the recommended distances.

APPROVED ENCROACHMENT PERMIT PLAN

111267K 0989  
8/16/17

**LEGEND**

- APPROXIMATE TRENCH LOCATION
- SIGN
- TRAFFIC CONES / DELINEATOR
- BARRICADE
- ⚡ FLAGGER
- ⚡ FLASHING ARROW SIGN
- ▨ WORK ZONE

RECEIVED  
AUG 16 2017  
CALTRANS-PERMIT

PROJECT NAME: Sycamore Canyon Substation To Penasquitos Substation - 230 KV Underground

DATE: 7/12/2017  
DESIGNED: Clint Jones  
CHECKED BY: Mark Webb

**AIRX** SURVEYORS, INC.  
Gail McMorrin  
President  
2934 EAST EL NORTE PARKWAY, SUITE C  
ESCONDIDO, CA 92027  
PHONE: (760) 480-2347  
CELL: (760) 419-3738

**NIV5**  
15092 AVENUE OF SCIENCE, SUITE 200  
SAN DIEGO, CA 92128  
P: 858.385.0500 WWW.NIV5.COM

AIRX JOB#: X160218  
MISC/POTHOLE#: \_\_\_\_\_  
TYPE OF WORK: TRENCHING / CONDUIT

THOMAS GRID#: 1208-E7  
DRAWN FOR: CALTRANS





ORIGINAL PERMIT MUST BE KEPT ON JOB SITE ALL TIMES

NOTE: W8-24 (STEEL PLATES AHEAD) SIGNS WILL REMAIN IN PLACE FOR DURATION OF WORK

DETOUR MAP (NOT TO SCALE)

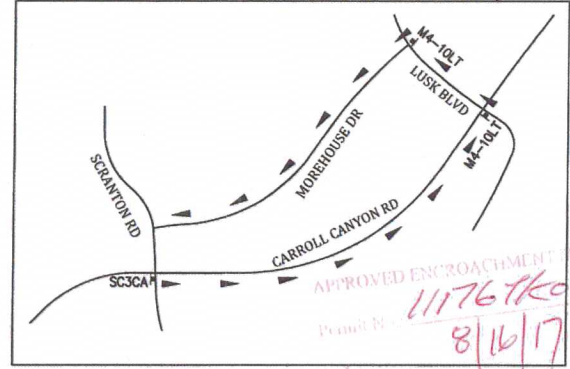

RECEIVED  
AUG 16 2017  
CALTRANS-PERMIT

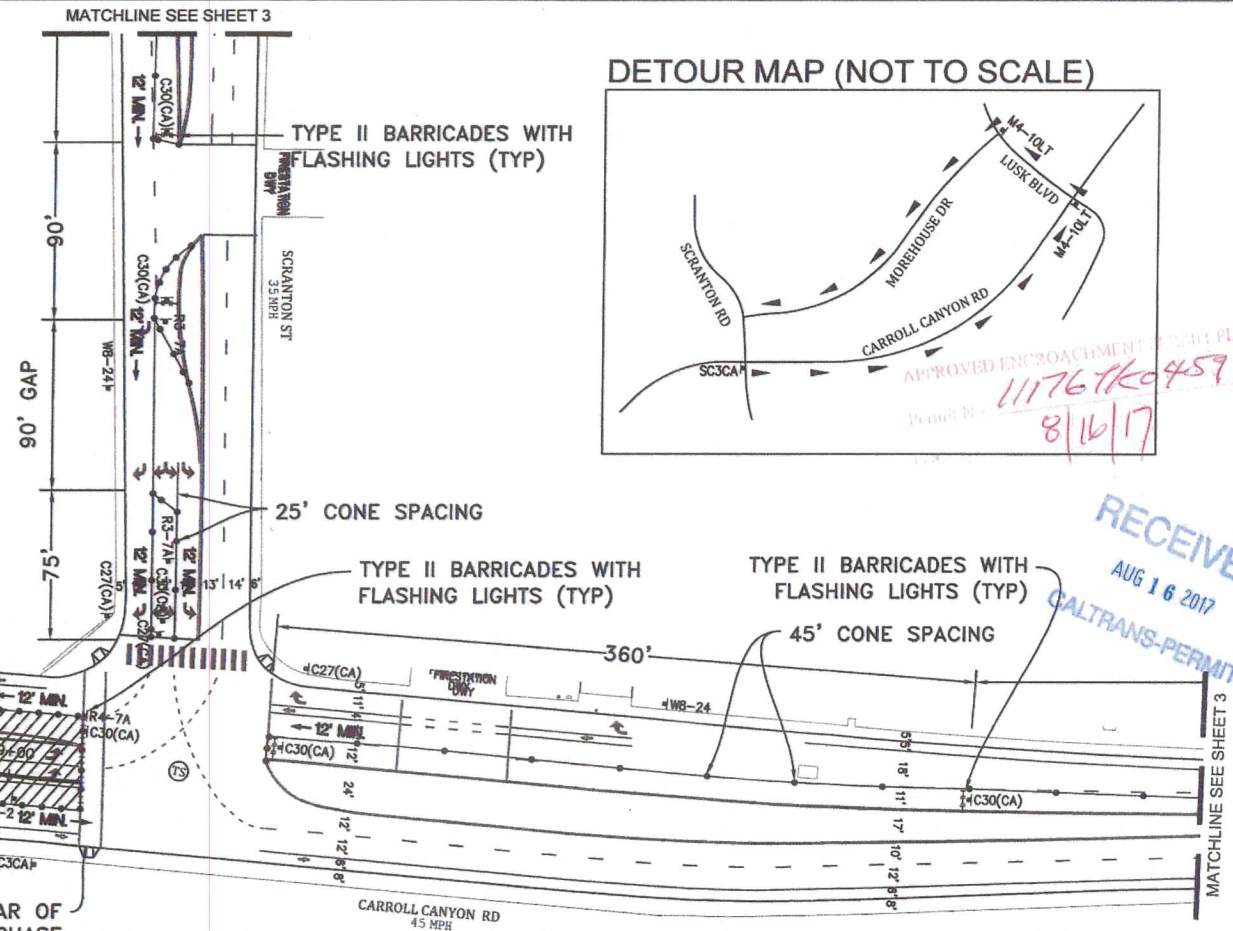

MATCHLINE SEE SHEET A

MATCHLINE SEE SHEET 3

APPROVED TRAFFIC CONTROL PERMIT

GROSSWALK WILL BE CLEAR OF ALL EQUIPMENT IN THIS PHASE

WORK HOURS: \_\_\_\_\_ TO \_\_\_\_\_ PHASE C - 1

PROJECT NAME: TL23071 - Sycamore Canyon Substation To Penasquitos Substation - 230 KV Underground



Gail McMorrin  
President

CITY OF SAN DIEGO  
Development Services  
Engineering Division  
Traffic Section

NV5

15052 AVENUE OF SCIENCE, SUITE 200  
SAN DIEGO, CA 92128  
P. 658.385.0500 WWW.NV5.COM

AIRX JOB#: X160218

MISC/POTHOLE#: \_\_\_\_\_

TYPE OF WORK: TRENCHING / CONDUIT

THOMAS GRID#: 1208-E7

DRAWN FOR: CALTRANS



DATE: 7/12/2017  
DESIGNED: Clint Jones  
CHECKED BY: Mark Webb

SHEET 2 OF 16



SCALE 1"=60'

APPROVED ENCROACHMENT PERMIT PLAN  
 11176 JK 0459  
 8/16/17

NOTE: W8-24 (STEEL PLATES AHEAD) SIGNS WILL REMAIN IN PLACE FOR DURATION OF WORK

ORIGINAL PERMIT MUST BE ON JOB SITE

APPROVED  
 TRAFFIC CONTROL PERMIT  
 DEC 06 2017  
 CITY OF SAN DIEGO  
 Development Services  
 Engineering Division  
 Traffic Control Section

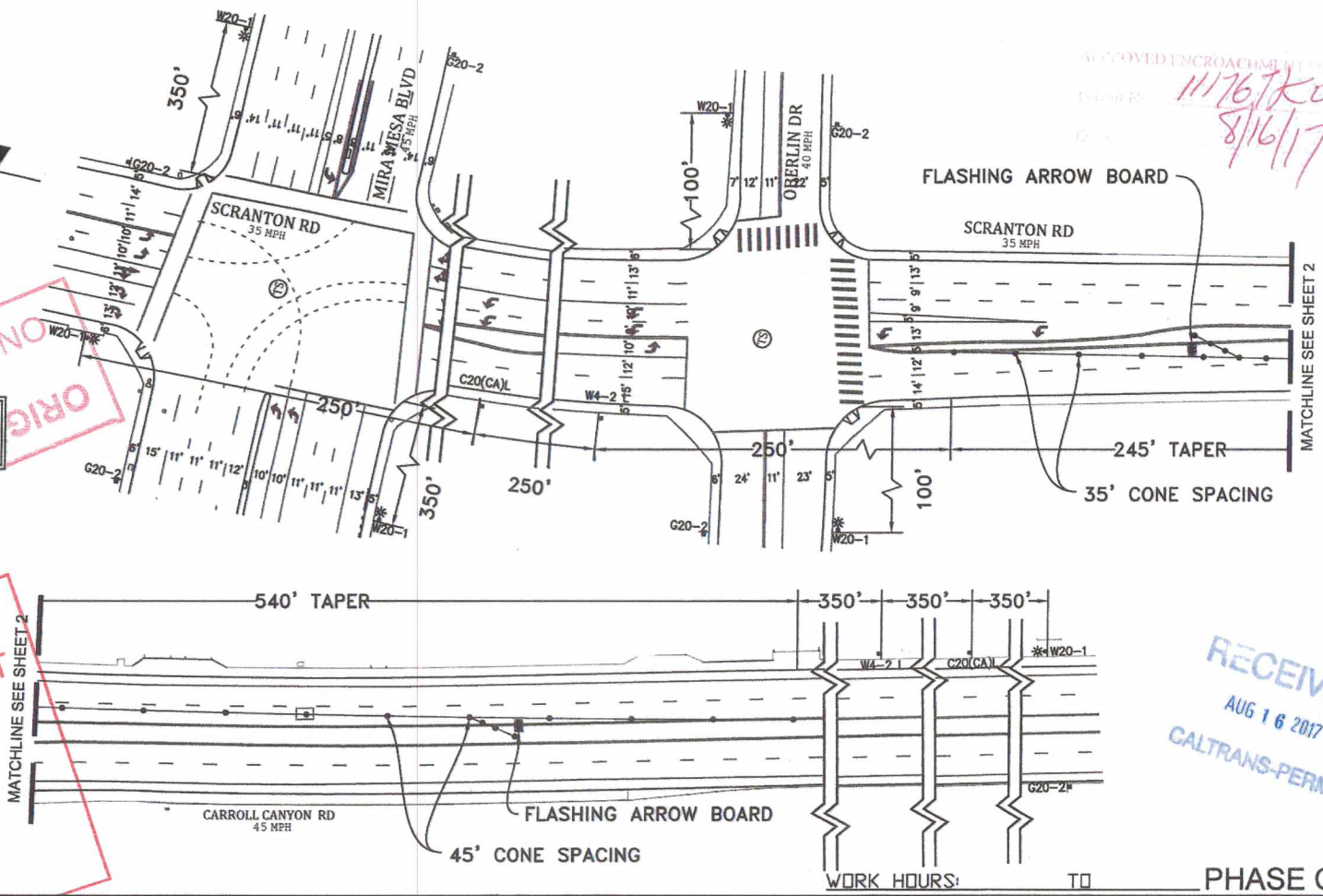

RECEIVED  
 AUG 16 2017  
 CALTRANS-PERMIT

PROJECT NAME: T-23071 - Sycamore Canyon Substation To Penasquitos Substation - 230 KV Underground

**AIRX** SURVEYORS, INC.  
 Gail McMorran  
 President  
 2534 EAST EL NORTE PARKWAY, SUITE C  
 ESCONDIDO, CA 92027  
 PHONE: (760) 480-2347  
 CELL: (760) 419-3738

**N/V/5**  
 15092 AVENUE OF SCIENCE, SUITE 200  
 SAN DIEGO, CA 92128  
 P: 858.385.0500 WWW.NV5.COM

AIRX JOB#: X160218  
 MISC/POTHOLE#:   
 TYPE OF WORK: TRENCHING / CONDUIT

THOMAS GRID#: 1208-E7  
 DRAWN FOR: CALTRANS



DATE: 7/12/2017  
 DESIGNED: Clint Jones  
 CHECKED BY: Mark Webb

SHEET 3 OF 16

SCALE 1"=60'

NOTE: W8-24 (STEEL PLATES AHEAD) SIGNS WILL REMAIN IN PLACE FOR DURATION OF WORK

ORIGINAL PERMIT MUST BE KEPT ON JOB SITE ALL TIMES

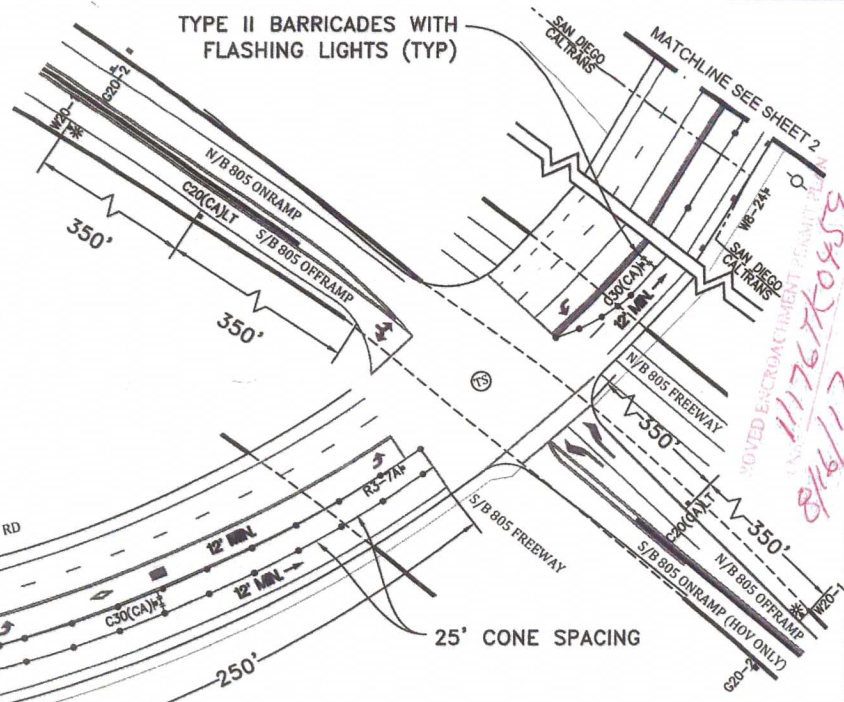
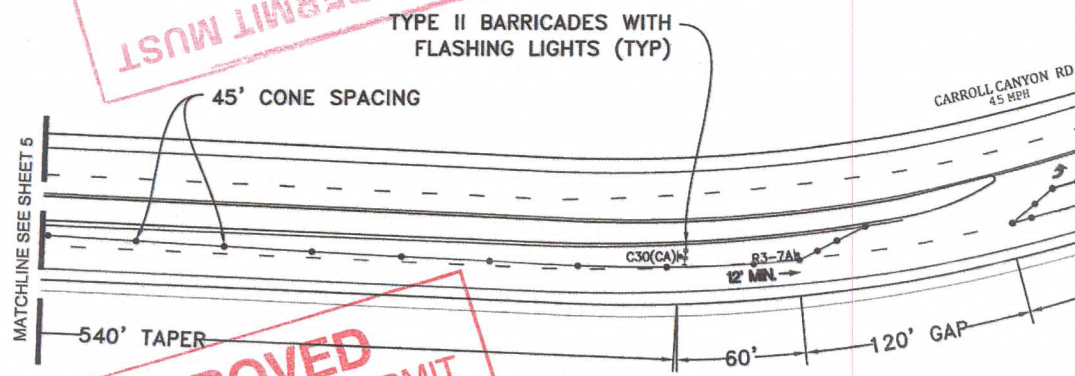

RECEIVED  
AUG 16 2017  
CALTRANS-PERMIT

APPROVED  
TRAFFIC CONTROL PERMIT  
DEC 06 2017

WORK HOURS: \_\_\_\_\_ TO \_\_\_\_\_ PHASE C - 1

PROJECT NAME: H-23071 - Sycamore Canyon Substation To Penasquitos Substation - 230 KV Underground

DATE: 7/12/2017  
DESIGNED: Clint Jones  
CHECKED BY: Mark Webb

**AIRX** SURVEYORS, INC.  
2534 EAST EL NORTE PARKWAY, SUITE C  
ESCONDIDO, CA 92027  
PHONE: (760) 430-2347  
CELL: (760) 419-3738

Gail McMoran  
President

CITY OF SAN DIEGO  
Development Services  
Engineering Division  
Traffic Safety Section

**NV5**  
15092 AVENUE OF SCIENCE, SUITE 200  
SAN DIEGO, CA 92128  
P. 858.385.0500 WWW.NV5.COM

AIRX JOB#: X160218  
THOMAS GRID#: 1208-E7  
MISC/POTHOLE#: \_\_\_\_\_  
DRAWN FOR: CALTRANS



TYPE OF WORK: TRENCHING / CONDUIT

SHEET 4 OF 16

11767K0453  
8/16/17



ORIGINAL PERMIT MUST BE KEPT ON JOB SITE ALL TIMES

ROAD WORK AHEAD  
FROM DATE TO DATE  
FROM TIME TO TIME

SCALE 1"=80'  
APPROVED ENCROACHMENT PERMIT PLAN  
111767K0459  
8/14/17

NOTE: W8-24 (STEEL PLATES AHEAD) SIGNS WILL REMAIN IN PLACE FOR DURATION OF WORK

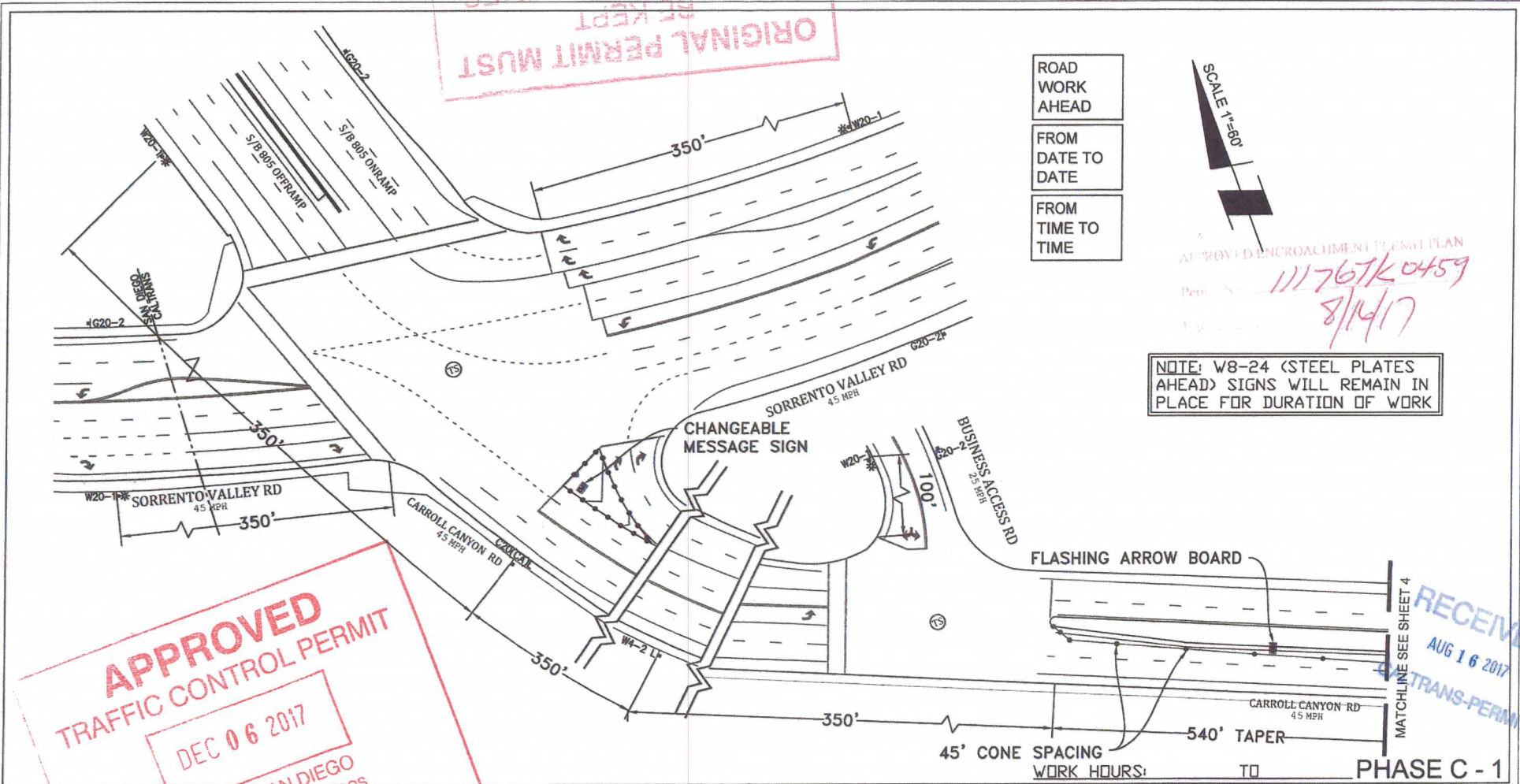

APPROVED TRAFFIC CONTROL PERMIT  
DEC 06 2017

RECEIVED  
AUG 16 2017  
CALTRANS-PERMIT

PROJECT NAME: TL23070 - Sycamore Canyon Substation To Penasquitos Substation - 230 KV Underground

AIRX SURVEYORS, INC.  
Gail McMorran  
President  
2534 EAST EL NORTE PARKWAY, SUITE C  
ESCONDIDO, CA 92027  
PHONE: (760) 486-2047  
CELL: (760) 419-3736

NV5  
15092 AVENUE OF SCIENCE, SUITE 200  
SAN DIEGO, CA 92126  
P: 858.385.0500 WWW.NVS.COM

AIRX JOB#: X160218  
MISC/POTHOLE#:   
TYPE OF WORK: TRENCHING / CONDUIT

THOMAS GRID#: 1208-E  
DRAWN FOR: CALTRANS

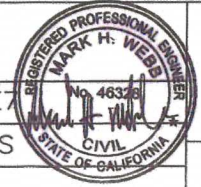

DATE: 7/12/2017  
DESIGNED: Clint Jones  
CHECKED BY: Mark Webb  
SHEET 5 OF 16



ORIGINAL PERMIT MUST BE KEPT ON JOB SITE ALL TIMES

NOTE: W8-24 (STEEL PLATES AHEAD) SIGNS WILL REMAIN IN PLACE FOR DURATION OF WORK

**APPROVED**  
**TRAFFIC CONTROL PERMIT**  
**DEC 06 2017**  
 CITY OF SAN DIEGO  
 Development Services  
 Engineering Division  
 Traffic Safety Section

APPROVED ENCROACHMENT PLAN  
 11176TK0459  
 8/16/17

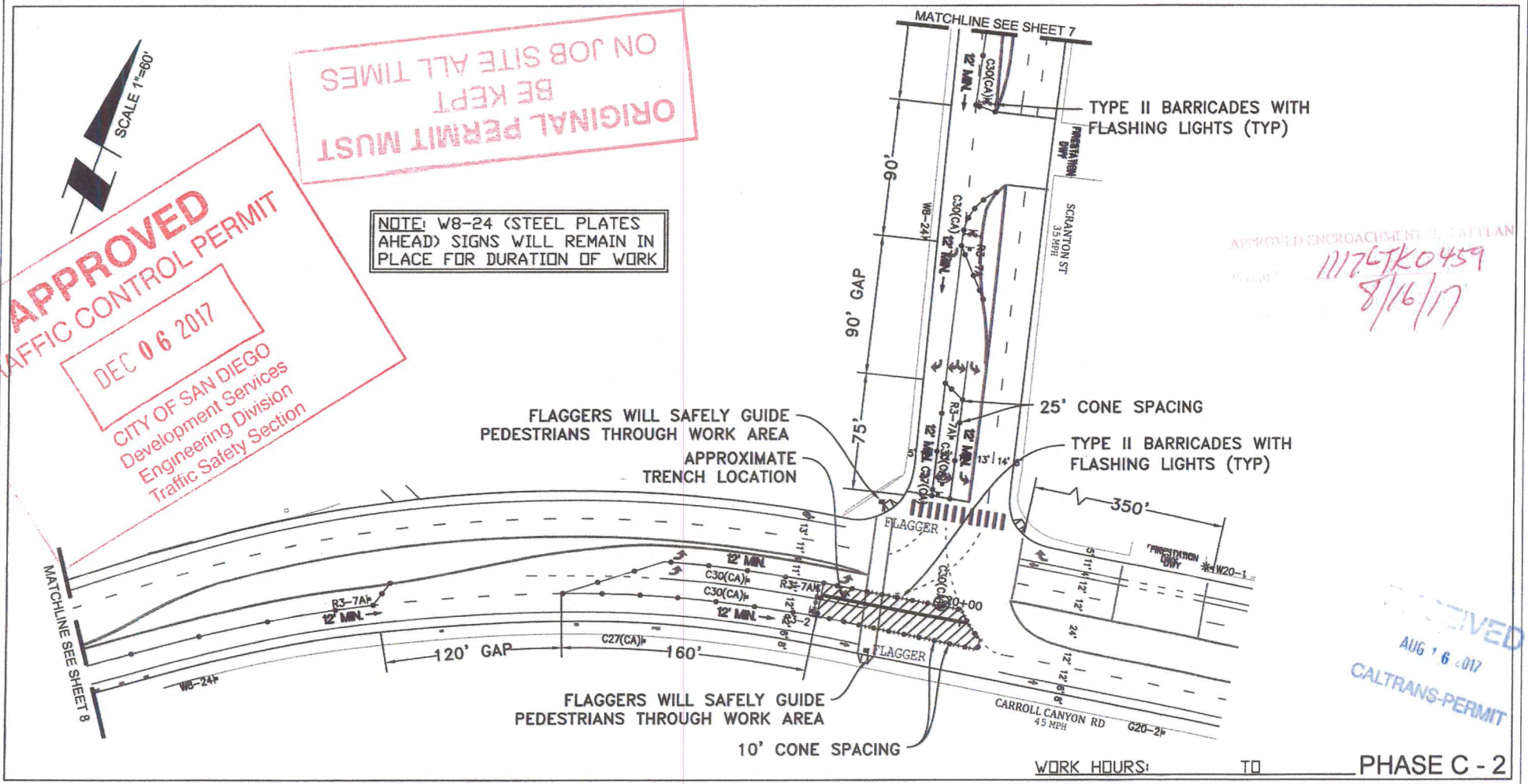

**PROJECT NAME:** TL23071 - Sycamore Canyon Substation To Penasquitos Substation - 230 KV Underground

DATE: 7/12/2017  
 DESIGNED: Clint Jones  
 CHECKED BY: Mark Webb

**AIRX** SURVEYORS, INC.  
 Gail McMorran  
 President  
 2534 EAST EL NORTE PARKWAY, SUITE C  
 ESCONDIDO, CA 92027  
 PHONE: (760) 400-2347  
 CELL: (760) 419-3238

**NV5**  
 15092 AVENUE OF SCIENCE, SUITE 200  
 SAN DIEGO, CA 92128  
 P. 658.385.0500 WWW.NV5.COM

AIRX JOB#: X160218  
 MISC/POTHOLE#: \_\_\_\_\_  
 TYPE OF WORK: TRENCHING / CONDUIT

THOMAS GRID#: 1208-E7  
 DRAWN FOR: CALTRANS

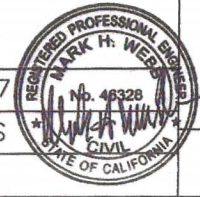

SHEET 6 OF 16



SCALE 1"=60'

**APPROVED**  
TRAFFIC CONTROL PERMIT

DEC 06 2017  
CITY OF SAN DIEGO  
Development Services  
Engineering Division  
Traffic Safety Section

NOTE: W8-24 (STEEL PLATES AHEAD) SIGNS WILL REMAIN IN PLACE FOR DURATION OF WORK

ON JOB SITE ALL TIMES  
BE KEPT  
ORIGINAL PERMIT MUST

AST-01-D-ENCROACHMENT PERMIT PLAN  
11176JK6459  
8/16/17

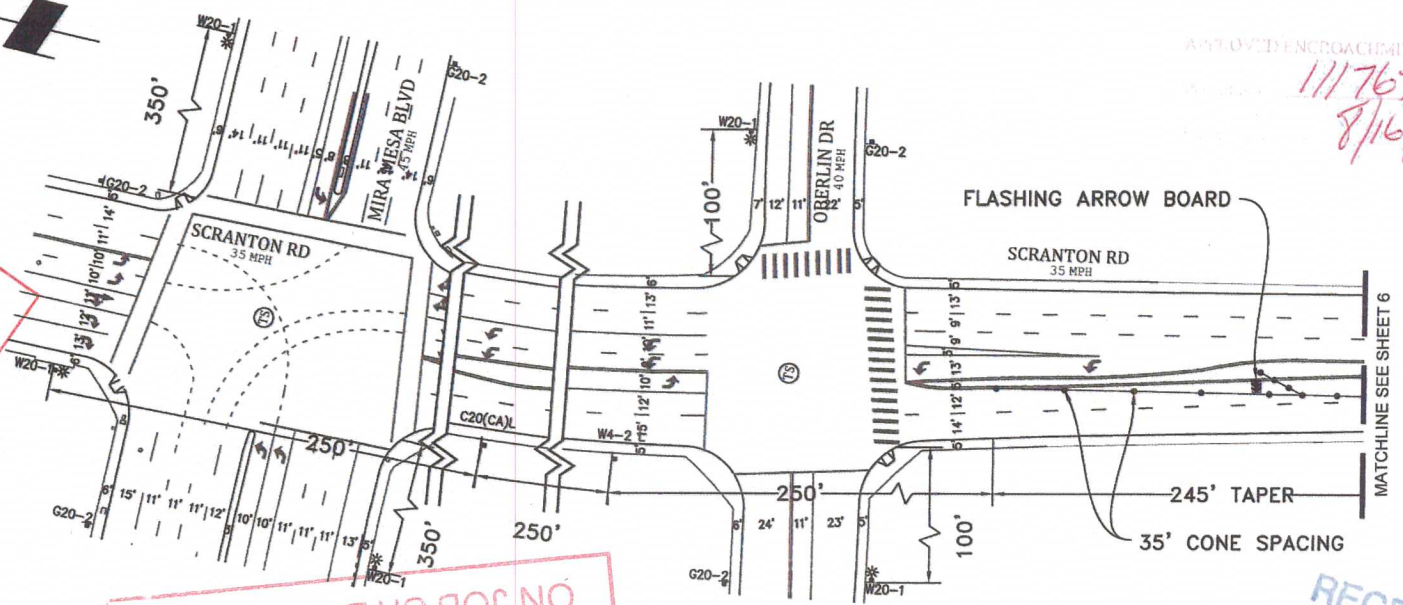

RECEIVED  
AUG 16 2017  
CALTRANS-PERMIT

WORK HOURS: \_\_\_\_\_ TO \_\_\_\_\_ PHASE C - 2

PROJECT NAME: TL23071 - Sycamore Canyon Substation To  
Penasquitos Substation - 230 KV Underground

**AIRX** SURVEYORS, INC.  
Gail McMorrin  
President  
2834 EAST EL NORTE PARKWAY, SUITE C  
ESCONDIDO, CA 92027  
PHONE: (760) 489-2347  
CELL: (760) 419-3728

**NV5**  
15092 AVENUE OF SCIENCE, SUITE 200  
SAN DIEGO, CA 92128  
P: 858.385.0500 WWW.NV5.COM

AIRX JOB#: X160218  
MISC/POTHOLE#: \_\_\_\_\_  
TYPE OF WORK: TRENCHING / CONDUIT

THOMAS GRID#: 1208-E7  
DRAWN FOR: CALTRANS

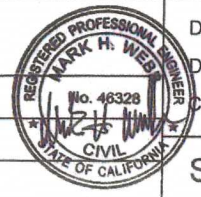

DATE: 7/12/2017  
DESIGNED: Clint Jones  
CHECKED BY: Mark Webb

SHEET 7 OF 16

SCALE 1"=60'

ED ENCROACHMENT PERMIT PLAN  
11/16/17  
8/16/17

NOTE: W8-24 (STEEL PLATES AHEAD) SIGNS WILL REMAIN IN PLACE FOR DURATION OF WORK

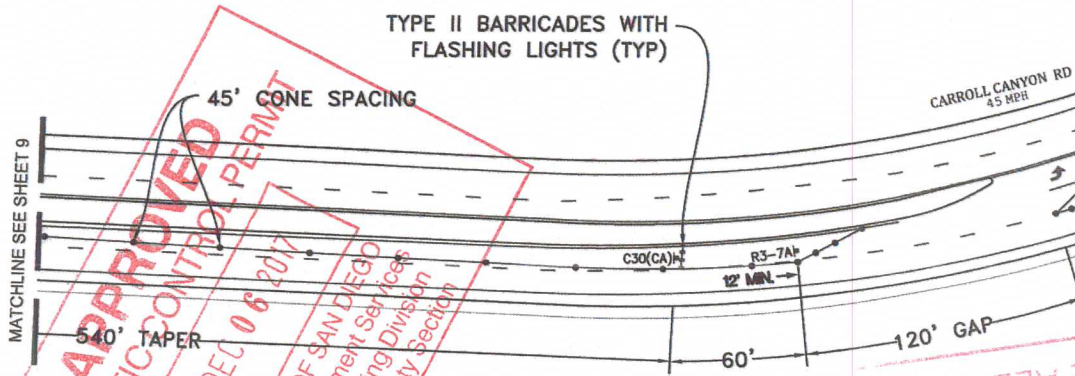
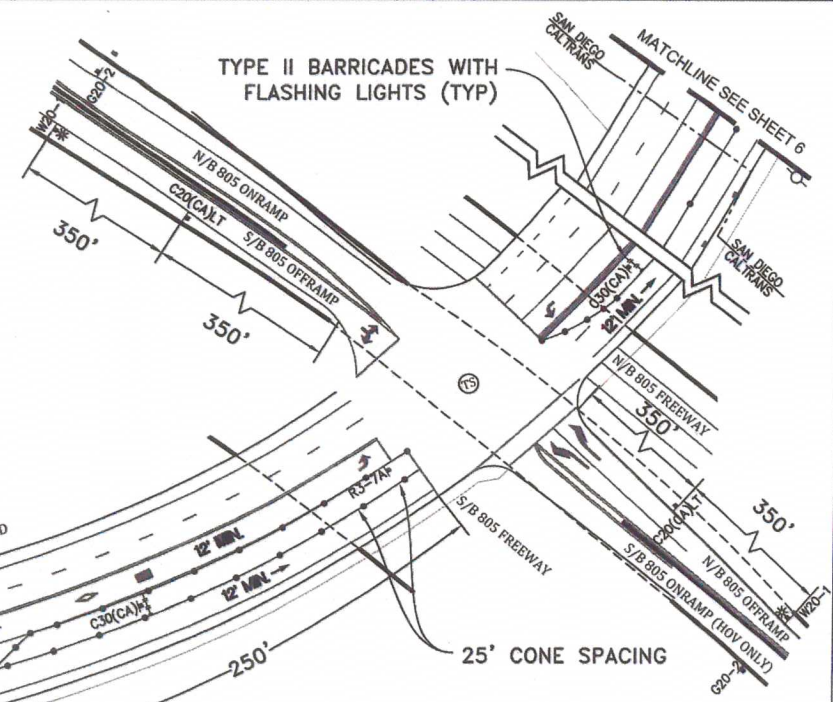

**APPROVED**  
**TRAFFIC CONTROL PERMIT**  
DEC 06 2017  
CITY OF SAN DIEGO  
Development Services  
Engineering Division  
Traffic Safety Section

**ORIGINAL PERMIT MUST BE KEPT ON JOB SITE ALL TIMES**

**RECEIVED**  
AUG 16 2017  
CALTRANS-PERMIT

WORK HOURS: \_\_\_\_\_ TO \_\_\_\_\_ PHASE C - 2

PROJECT NAME: TL23071 - Sycamore Canyon Substation To Penasquitos Substation - 230 KV Underground

DATE: 7/12/2017  
DESIGNED: Clint Jones  
CHECKED BY: Mark Webb

AIRX SURVEYORS, INC.  
Gail McMorran  
President  
2534 EAST EL NORTE PARKWAY, SUITE C  
ESCONDIDO, CA 92027  
PHONE: (760) 450-2547  
CELL: (760) 410-3726

**NV5**  
15092 AVENUE OF SCIENCE, SUITE 200  
SAN DIEGO, CA 92128  
P: 858.385.0500 WWW.NV5.COM

AIRX JOB#: X160218  
MISC/POTHOLE#: \_\_\_\_\_

THOMAS GRID#: 1208-E7  
DRAWN FOR: CALTRANS



TYPE OF WORK: TRENCHING / CONDUIT

SHEET 8 OF 16



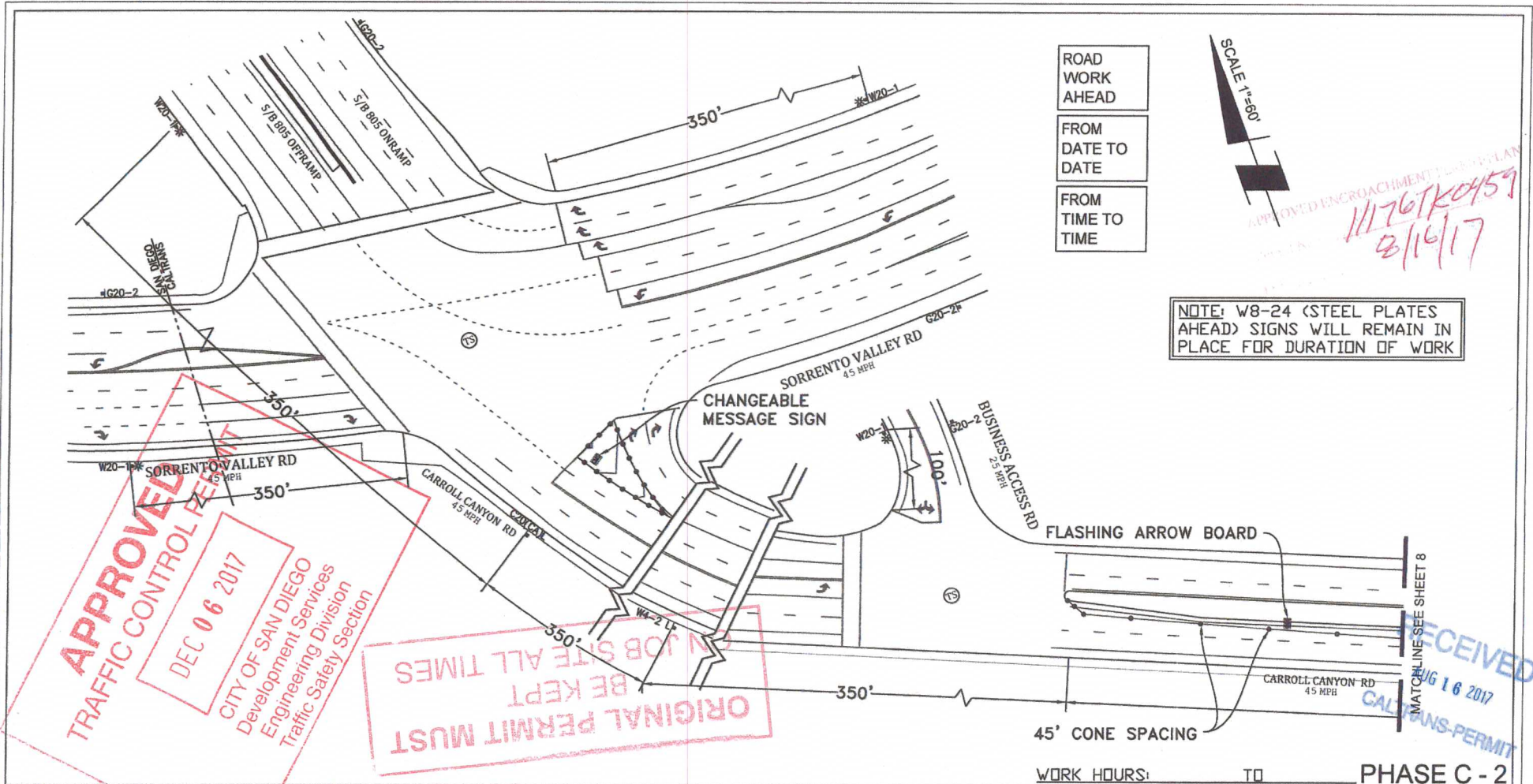

ROAD  
WORK  
AHEAD

FROM  
DATE TO  
DATE

FROM  
TIME TO  
TIME

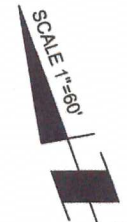

NOTE: W8-24 (STEEL PLATES AHEAD) SIGNS WILL REMAIN IN PLACE FOR DURATION OF WORK

APPROVED ENCROACHMENT PLAN  
11176TK0459  
8/16/17

**APPROVED**  
TRAFFIC CONTROL PERMIT  
DEC 06 2017  
CITY OF SAN DIEGO  
Development Services  
Engineering Division  
Traffic Safety Section

ORIGINAL PERMIT MUST  
BE KEPT  
ON JOB SITE ALL TIMES

RECEIVED  
CALTRANS-PERMIT  
MATCHLINE SEE SHEET 8  
AUG 16 2017

WORK HOURS: \_\_\_\_\_ TO \_\_\_\_\_ PHASE C - 2

<b>PROJECT NAME:</b> TL23071 - Sycamore Canyon Substation To Penasquitos Substation - 230 KV Underground		<b>DATE:</b> 7/12/2017	
 Gail McMorrان President 2534 EAST EL NORTE PARKWAY, SUITE C ESCONDIDO, CA 92027 PHONE: (760) 480-2347 CELL: (760) 419-3728	 15092 AVENUE OF SCIENCE, SUITE 200 SAN DIEGO, CA 92128 P: 658.385.0500 WWW.NV5.COM	<b>AIRX JOB#:</b> X160218	<b>THOMAS GRID#:</b> 1208-E7
		<b>MISC/POTHOLES#:</b>	<b>DRAWN FOR:</b> CALTRANS
<b>TYPE OF WORK:</b> TRENCHING / CONDUIT		 <b>DESIGNED:</b> Clint Jones <b>CHECKED BY:</b> Mark Webb	
		<b>SHEET 9 OF 16</b>	



**APPROVED**  
**TRAFFIC CONTROL PERMIT**  
 DEC 06 2017  
 CITY OF SAN DIEGO  
 Development Services  
 Engineering Division  
 Traffic Safety Section

APPROVED ENCROACHMENT PERMIT PLAT  
 PROJECT # 11176TK0459  
 8/16/17

NOTE: W8-24 (STEEL PLATES AHEAD) SIGNS WILL REMAIN IN PLACE FOR DURATION OF WORK

ON JOB SITE ALL TIMES  
 BE KEPT  
 ORIGINAL PERMIT MUST

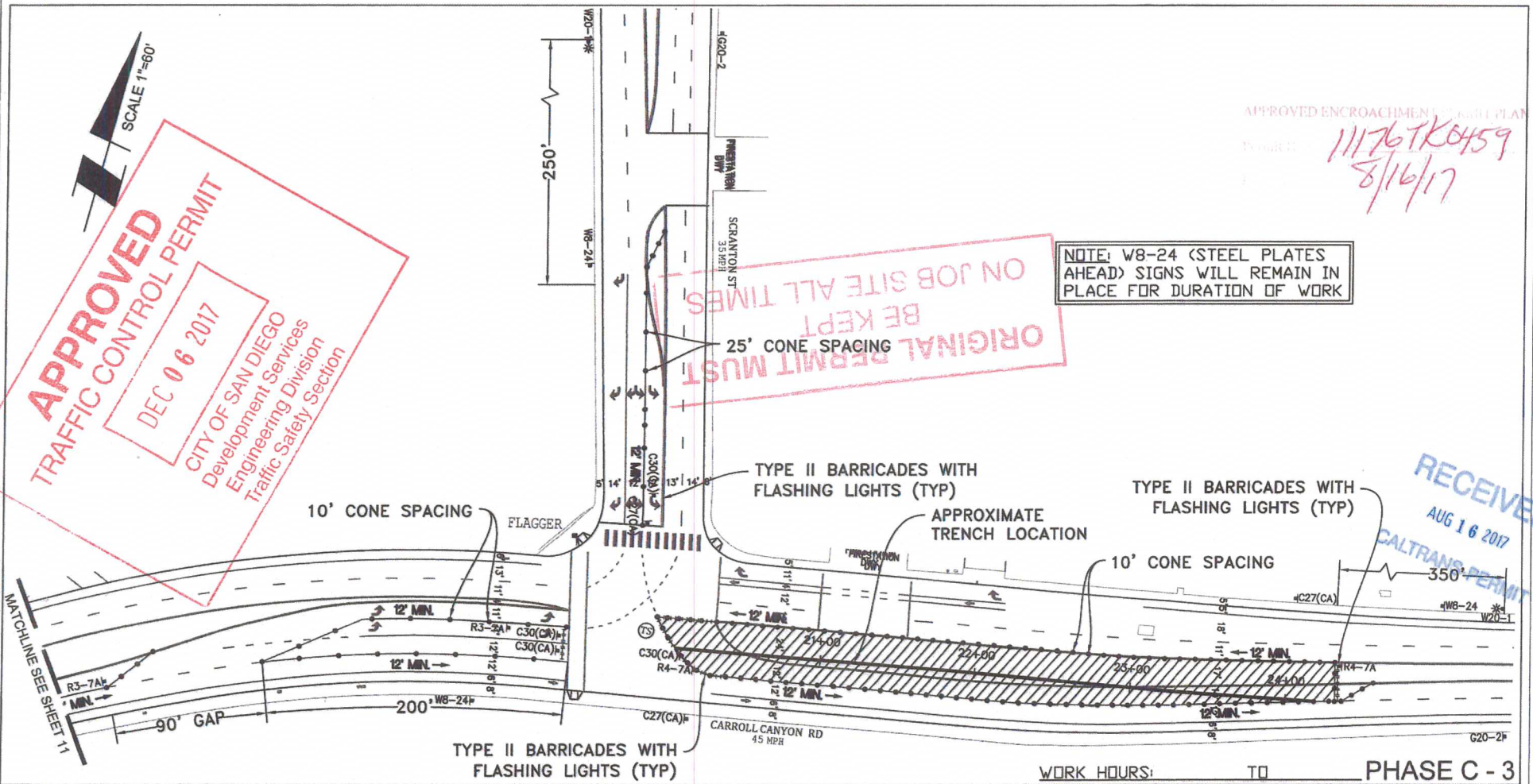

RECEIVED  
 AUG 16 2017  
 CALTRANS PERMIT

WORK HOURS: TO PHASE C - 3

PROJECT NAME: TL23071 - Sycamore Canyon Substation To  
 Penasquitos Substation - 230 KV Underground

**AIRX** SURVEYORS, INC.  
 Gail McMorrin  
 President  
 2534 EAST EL NORTE PARKWAY, SUITE C  
 ESCOBEDO, CA 92027  
 PHONE: (760) 480-2247  
 CELL: (760) 410-3728

**NV5**  
 15092 AVENUE OF SCIENCE, SUITE 200  
 SAN DIEGO, CA 92128  
 P: 858.365.0500 WWW.NV5.COM

AIRX JOB#: X160218  
 MISC/POTHOLES#:

THOMAS GRID#: 1208-E7  
 DRAWN FOR: CALTRANS



DATE: 7/12/2017  
 DESIGNED: Clint Jones  
 CHECKED BY: Mark Webb

TYPE OF WORK: TRENCHING / CONDUIT

SHEET 10 OF 16



SCALE 1"=60'

APPROVED  
 ORIGINAL PERMIT MUST  
 BE KEPT  
 ON JOB SITE ALL TIMES

NOTE: W8-24 (STEEL PLATES AHEAD) SIGNS WILL REMAIN IN PLACE FOR DURATION OF WORK

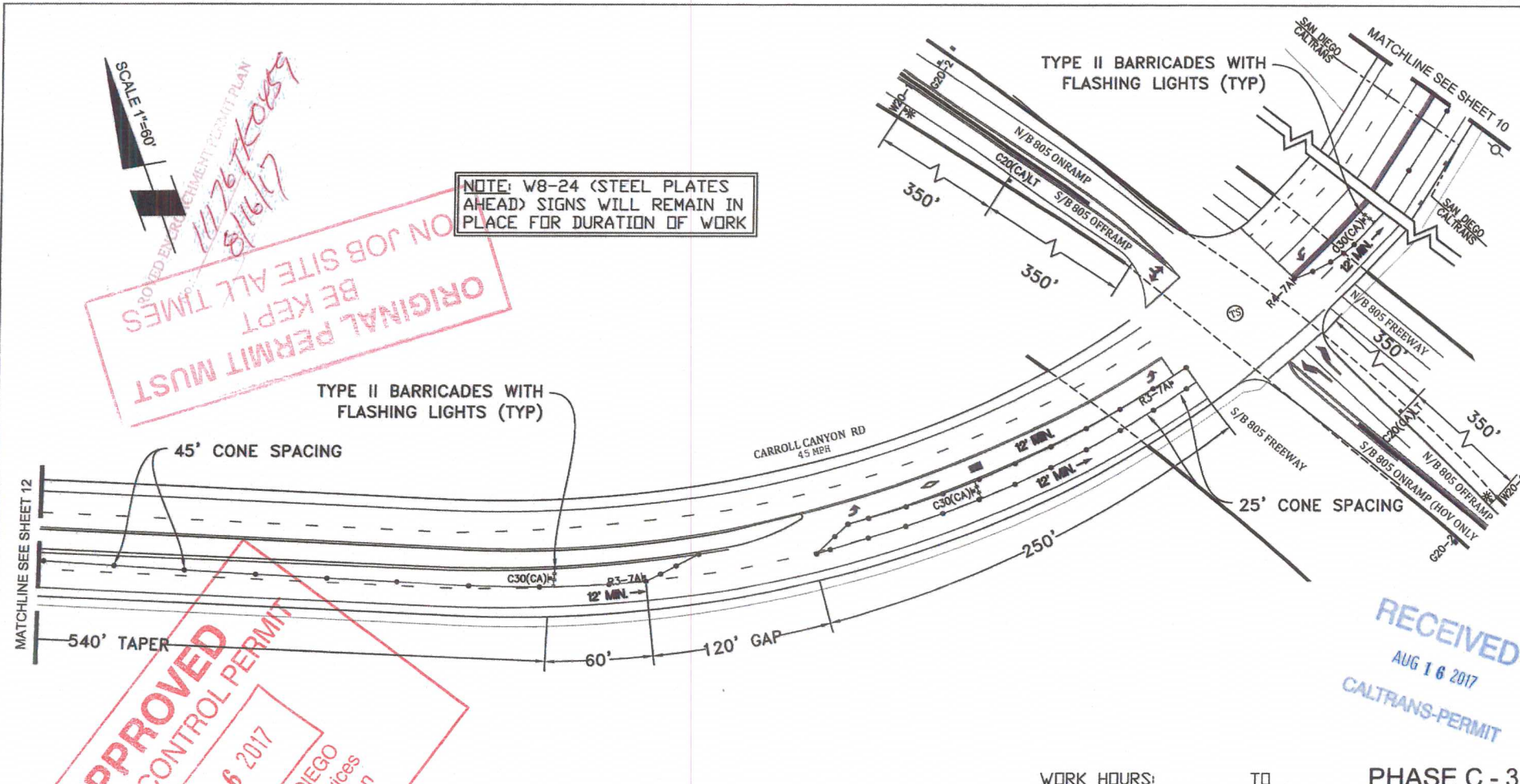

RECEIVED  
 AUG 16 2017  
 CALTRANS-PERMIT

WORK HOURS: \_\_\_\_\_ TO \_\_\_\_\_ PHASE C - 3

PROJECT NAME: **1123071 Sycamore Canyon Substation To Penasquitos Substation - 230 KV Underground**

DATE: 7/12/2017  
 DESIGNED: Clint Jones  
 CHECKED BY: Mark Webb

**AIRX** SURVEYORS, INC.  
 Gail McMorrin  
 President  
 2854 EAST EL NORTE PARKWAY, SUITE C  
 ESCONDIDO, CA 92027  
 PHONE: (760) 450-2347  
 CELL: (760) 419-3728

**NV5**  
 CITY OF SAN DIEGO  
 Development Services  
 Engineering Division  
 Traffic Engineering Section

AIRX JOB#: X160218  
 THOMAS GRID#: 1208-E7  
 MISC/POTHOLE#: \_\_\_\_\_  
 DRAWN FOR: CALTRANS  
 TYPE OF WORK: TRENCHING / CONDUIT



SHEET 11 OF 16

**ON JOB SITE ALL TIMES ORIGINAL PERMIT MUST BE KEPT**

**APPROVED TRAFFIC CONTROL PERMIT**  
**DEC 06 2017**  
 CITY OF SAN DIEGO  
 Development Services  
 Engineering Division  
 Traffic Safety Section

ROAD WORK AHEAD  
 FROM DATE TO DATE  
 FROM TIME TO TIME



11176TK0459  
 8/16/17

NOTE: W8-24 (STEEL PLATES AHEAD) SIGNS WILL REMAIN IN PLACE FOR DURATION OF WORK

RECEIVED  
 AUG 16 2017  
 CALTRANS-PERMIT

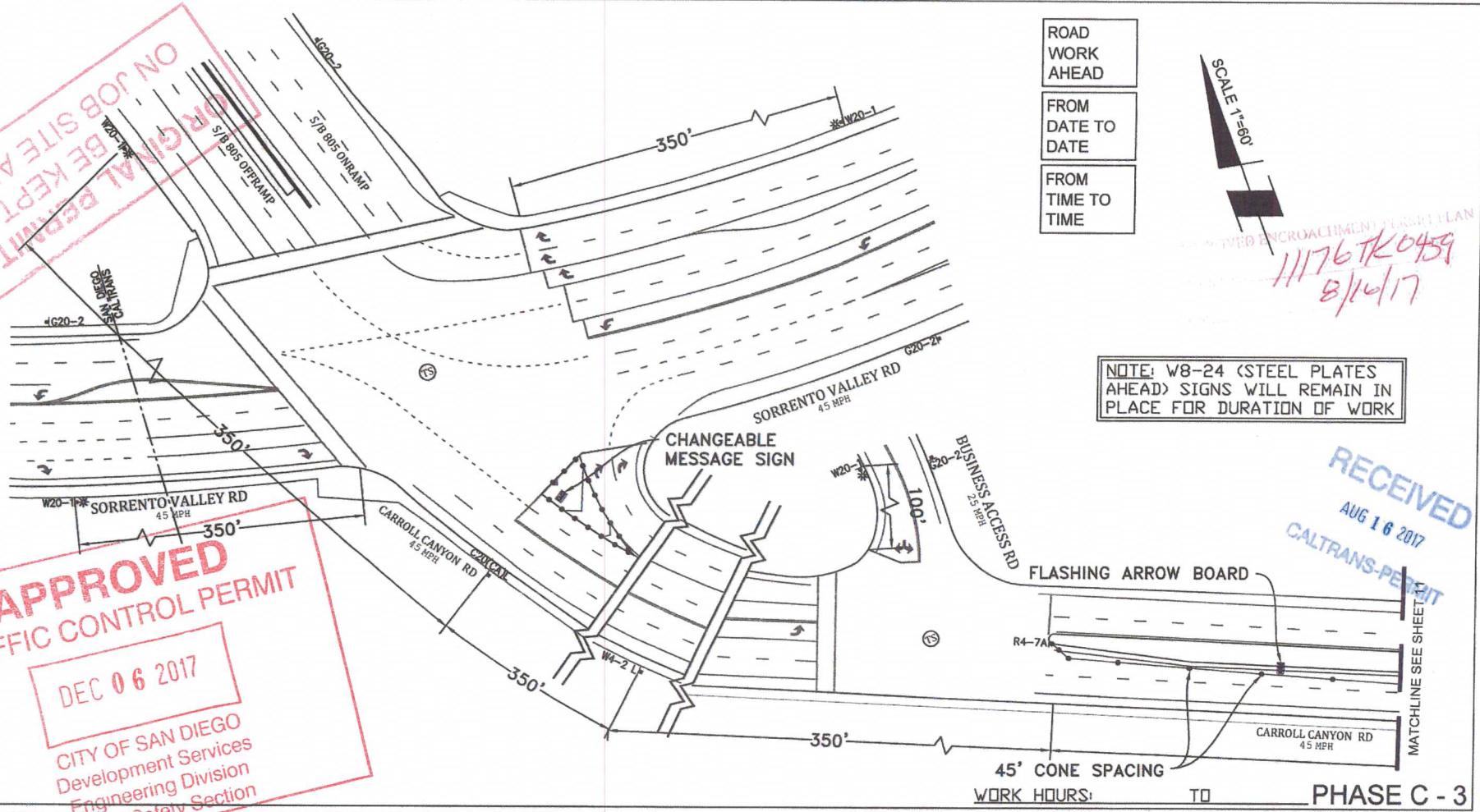

**PROJECT NAME:** TL23071 - Sycamore Canyon Substation To Penasquitos Substation - 230 KV Underground

DATE: 7/12/2017  
 DESIGNED: Clint Jones  
 CHECKED BY: Mark Webb

**AIRX** SURVEYORS, INC.  
 Gail McMorran  
 President  
 2534 EAST EL NORTE PARKWAY, SUITE C  
 ESCONCIDO, CA 92027  
 PHONE: (760) 455-2347  
 CELL: (760) 419-2738

**NV5**  
 15092 AVENUE OF SCIENCE, SUITE 200  
 SAN DIEGO, CA 92128  
 P: 658.385.0500 WWW.NV5.COM

AIRX JOB#: X160218  
 THOMAS GRID#: 1208-E7  
 MISC/POTHoles#: \_\_\_\_\_  
 DRAWN FOR: CALTRANS



TYPE OF WORK: TRENCHING / CONDUIT

**SHEET 12 OF 16**





ORIGINAL PERMIT MUST  
 BE KEPT ON JOB SITE ALL TIMES

NOTE: W8-24 (STEEL PLATES  
 AHEAD) SIGNS WILL REMAIN IN  
 PLACE FOR DURATION OF WORK

APPROVED PERMIT LIGHT PLAN  
 111767K0459  
 8/16/17

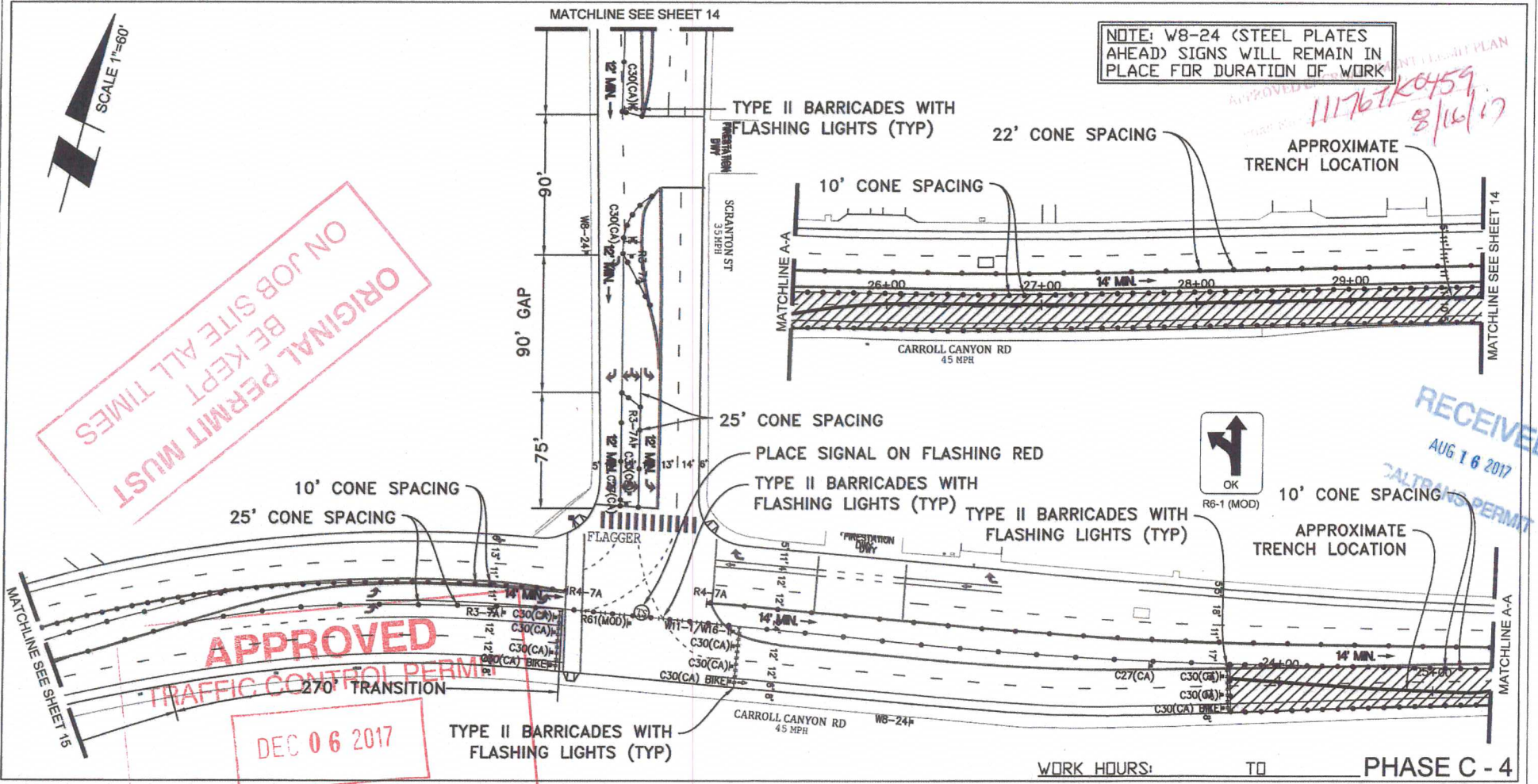

APPROVED  
 TRAFFIC CONTROL PERMIT

DEC 06 2017

RECEIVED  
 AUG 16 2017  
 CALTRANS PERMIT

WORK HOURS: \_\_\_\_\_ TO \_\_\_\_\_ PHASE C - 4

PROJECT NAME: TL23071 - Sycamore Canyon Substation To  
 Penasquitos Substation - 230 KV Underground

**AIRX**  
 SURVEYORS, INC.  
 Gail McMorrin  
 President  
 2534 EAST EL NORTE PARKWAY, SUITE C  
 ESCONDIDO, CA 92027  
 PHONE: (760) 480-2347  
 CELL: (760) 419-3738

CIVIL ENGINEERING  
 NV5  
 15092 AVENUE OF SCIENCE, SUITE 200  
 SAN DIEGO, CA 92128  
 P: 858.385.0500 WWW.NV5.COM

AIRX JOB#: X160218  
 MISC/POTHOLE#: \_\_\_\_\_  
 TYPE OF WORK: TRENCHING / CONDUIT

THOMAS GRID#: 1208-E7  
 DRAWN FOR: CALTRANS

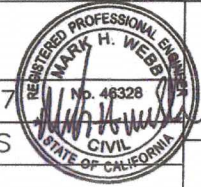

DATE: 7/12/2017  
 DESIGNED: Clint Jones  
 CHECKED BY: Mark Webb  
**SHEET 13 OF 16**



SCALE 1"=60'

SCALE 1"=80'

NOTE: W8-24 (STEEL PLATES AHEAD) SIGNS WILL REMAIN IN PLACE FOR DURATION OF WORK

11176TK0459  
8/16/17

ORIGINAL PERMIT MUST BE KEPT ALL TIMES ON JOB SITE

APPROVED TRAFFIC CONTROL PERMIT

RECEIVED  
AUG 16 2017  
CALTRANS-PERMIT

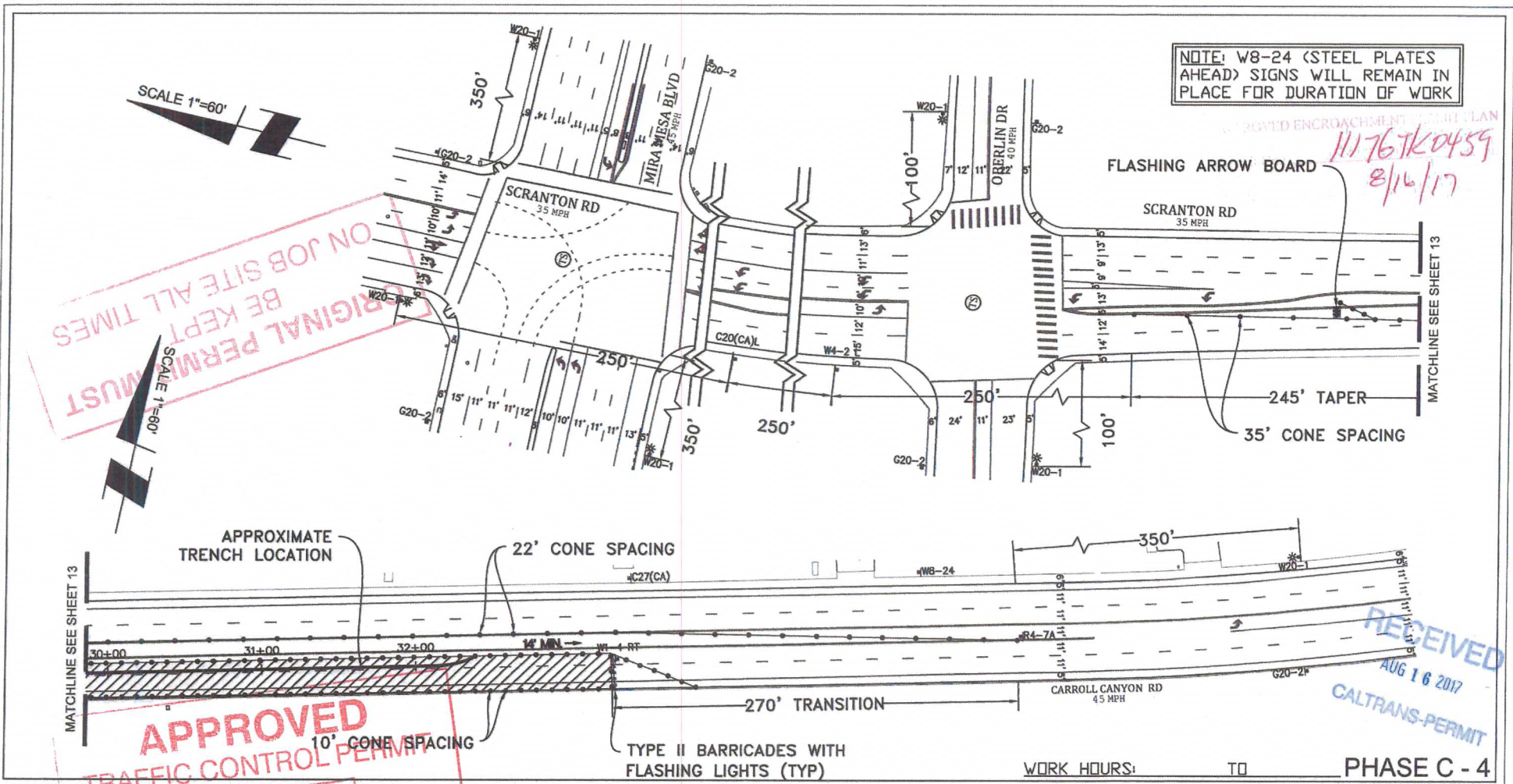

WORK HOURS: TO PHASE C - 4

PROJECT NAME: TL23071 - Sycamore Canyon Substation To Penasquitos Substation - 230 KV Underground

DATE: 7/12/2017  
DESIGNED: Clint Jones  
CHECKED BY: Mark Webb



Gail McMorran  
President

CITY OF SAN DIEGO  
Development Services  
15092 AVENUE OF SCIENCE, SUITE 200  
SAN DIEGO, CA 92128  
P. 858.385.0800 WWW.NVS.COM

AIRX JOB#: X160218

THOMAS GRID#: 1208-E7

MISC/POTHOLE#:

DRAWN FOR: CALTRANS

TYPE OF WORK: TRENCHING / CONDUIT



SHEET 14 OF 16



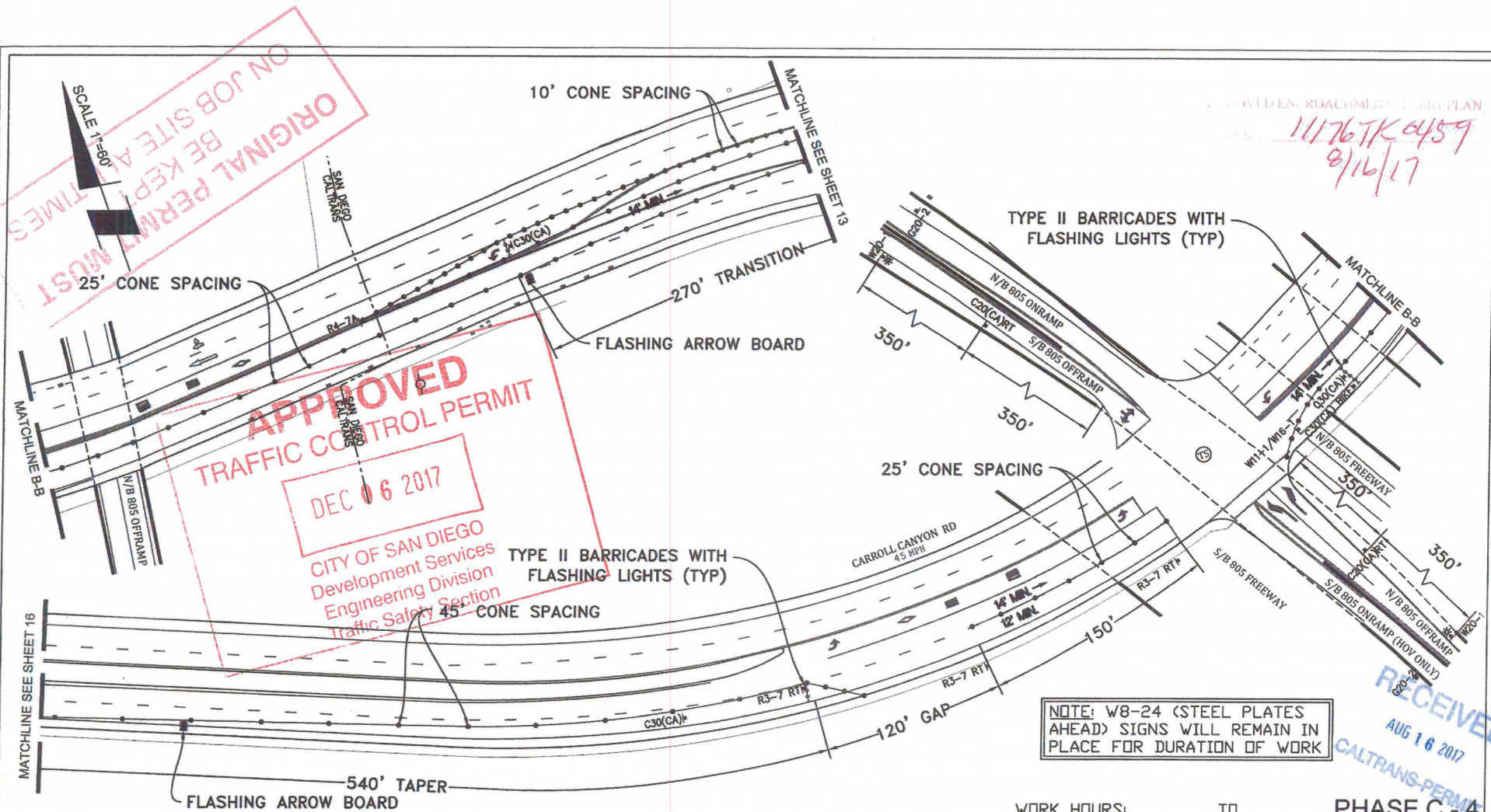

WORK HOURS: \_\_\_\_\_ TO \_\_\_\_\_ PHASE C - 4

**PROJECT NAME:** TL23071 - Sycamore Canyon Substation To Penasquitos Substation - 230 KV Underground

DATE: 7/12/2017  
 DESIGNED: Clint Jones  
 CHECKED BY: Mark Webb

**AIRX** SURVEYORS, INC.  
 Gail McMorran  
 President  
 2534 EAST EL NORTE PARWAY, SUITE C  
 ESCONDIDO, CA 92027  
 PHONE: (760) 480-2347  
 CELL: (760) 419-3728

**N/V/5**  
 15092 AVENUE OF SCIENCE, SUITE 200  
 SAN DIEGO, CA 92128  
 P: 858.385.0500 WWW.NV5.COM

AIRX JOB#: X160218  
 MISC/POTHOLES#: \_\_\_\_\_  
 TYPE OF WORK: TRENCHING / CONDUIT

THOMAS GRID#: 1208-E7  
 DRAWN FOR: CALTRANS



SHEET 15 OF 16

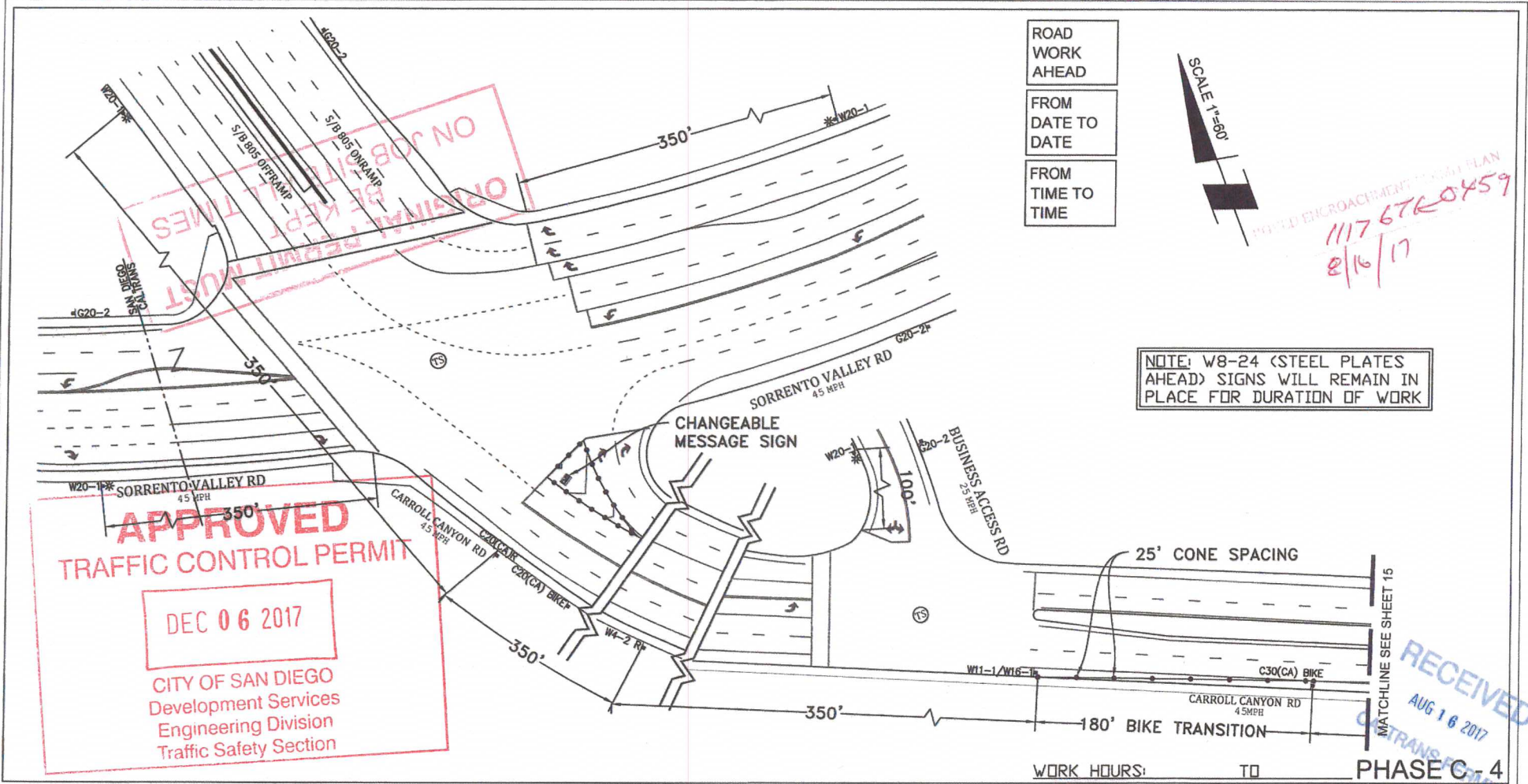

**PROJECT NAME:** TL23071 - Sycamore Canyon Substation To Penasquitos Substation - 230 KV Underground

**AIRX** SURVEYORS, INC.  
 Gail McMorrán  
 President  
 2554 EAST EL NORTE PARKWAY, SUITE C  
 ESCONDIDO, CA 92027  
 PHONE: (760) 455-2247  
 CELL: (760) 419-3738

**NV5**  
 15092 AVENUE OF SCIENCE, SUITE 200  
 SAN DIEGO, CA 92128  
 P: 858.385.0500 WWW.NV5.COM

AIRX JOB#: X160218  
 MISC/POTHOLE#: \_\_\_\_\_  
 TYPE OF WORK: TRENCHING / CONDUIT

THOMAS GRID#: 1208-E7  
 DRAWN FOR: CALTRANS

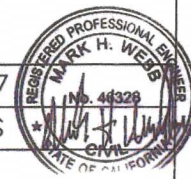

DATE: 7/12/2017  
 DESIGNED: Clint Jones  
 CHECKED BY: Mark Webb  
 SHEET 16 OF 16

RECEIVED  
 AUG 16 2017  
 TRANSPORTATION