

City Use Only

# Traffic Control Permit (TCP) Multiple Location List

( Franchise Utility Company Only - May Not Be submitted By Contractor)

Authorized # \_\_\_\_\_

By Felipe Anlo

Yes  No

Date Reviewed 7/12/17

THE CITY OF SAN DIEGO

ORIGINAL PERMIT MUST BE KEPT ON JOB SITE ALL TIMES

APPROVED TRAFFIC CONTROL PERMIT

JUL 12 2017

To: City of San Diego, Traffic Permit Section

Date: 7/12/2017

From: (Company):

SDG&E

Phone No.: 619-778-2405

Contact Person:

Rod Nelson

Fax.: \_\_\_\_\_

W.O. or Account #: Permit # \_\_\_\_\_

TCP No. \_\_\_\_\_

**TYPE OF WORK**

- 1 = Lane Closure
- 2 = Street Closure
- 3 = Sidewalk Closure
- 4 = Alley Closure
- 5 = Parking Lane
- 6 = Detour
- 7 = Trenching
- 8 = Flagging

Location	From	To	Start Date *	End Date *	Work Hours **	Thomas Bros.	Type of Work
**Pomerado Road	2200' West of Willow Creek Road/Ave of Nations	Willow Creek Road/Ave of Nations	7/17/17	7/21/17	8:30AM - 3:30PM	1209-G6, H5, J5	1,7,8
Pomerado Road	Willow Creek Road/Ave of Nations	Chabad Center Driveway	7/17/17	7/21/17	8:30AM - 3:30PM	1209-G6, H5, J5	1,7,8
Willow Creek Road	Pomerado Road	Caminito Covewood	7/17/17	7/21/17	8:30AM - 3:30PM	1209-G6, G5	8
Avenue of Nations	Pomerado Road	End of Street	7/17/17	7/21/17	8:30AM - 3:30PM	1209-G6, G5	8
Scripps Ranch Blvd	Pomerado Road	Ironwood Road	7/17/17	7/21/17	8:30AM - 3:30PM	1209-H5	8
Scripps Ranch Row	Pomerado Road	Espinosa Square	7/17/17	7/21/17	8:30AM - 3:30PM	1209-H5	8
>>> Place CMS on I-15 (NB and SB): "CONSTRUCTION ON POMERADO RD - EXPECT DELAYS" <<<<							

Vault and Trench Crews - Phases 82-91 - Daytime work hours (M-F, 8:30AM - 3:30PM)  
 \*\*Pomerado Road west of Willow Creek Road/Ave of Nations (County ROW hours agreed to 8:30AM - 3:30PM)

>>> Warning signs on approach to flagging operation will be doubled in east bound and west bound directions along Pomerado Road  
 >>> Flaggers to assist with potential back ups and provide better traffic circulation for all movements at signalized intersections that require flash.

**Comments:** (Minimum 4 flaggers at intersection)

Must be submitted a minimum of 2 working days prior to start of work. All columns must be filled out for proper authorization

Fax or mail to: City of San Diego • Traffic Control Permit Section • 1222 First Avenue, MS 501 • San Diego, CA 92101. Fax (619) 446-5489 Office (619) 446-5150

\* Work Days: Monday Through Friday \*\* Work Hours : 8:30 AM - 3:30PM. Unless other hours are preapproved)

No Work on Saturdays, Sundays, or Holidays Unless Approved and Noted In Comments

Minimum of 5 working days required for construction work which affects traffic signal e-mail info to: [dciafre@sandiego.gov](mailto:dciafre@sandiego.gov)

**SIGN LEGEND**

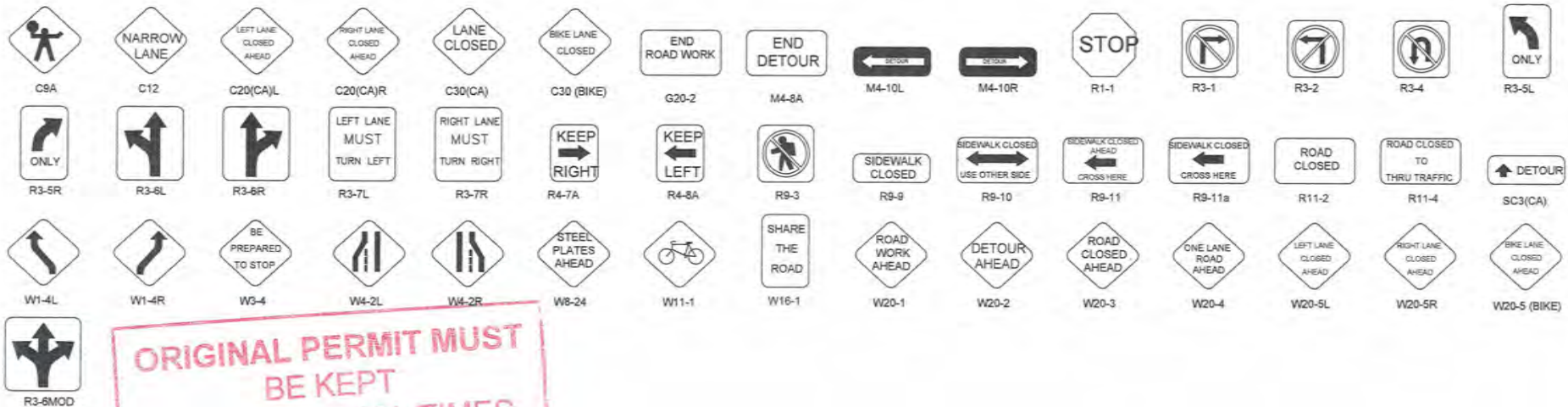

**ORIGINAL PERMIT MUST BE KEPT ON JOB SITE ALL TIMES**

APPROACH SPEED (MPH)
25
30
35
40
45
50
55+

MINIMUM DISTANCE (FEET) BETWEEN SIGNS AND FROM LAST SIGN TO TAPER	
100	
250	
250	
250	
500	
500	
500	

MINIMUM TAPER LENGTHS (L) (FEET) FOR 12-FOOT LANE		
L	1/2L	1/3L
125	65	45
180	90	60
245	125	85
320	160	110
540	270	180
600	300	200
660	330	220

BUFFER LENGTH (FEET)	MAX CONE SPACING		CONFLICT
	TAPER	TANGENT	
155	25	50	12
200	30	60	15
250	35	70	17
305	40	80	20
360	45	90	22
425	50	100	25
495	55	110	27

**APPROVED TRAFFIC CONTROL PERMIT**  
**JUL 12 2017**  
 CITY OF SAN DIEGO  
 Development Services  
 Engineering Division  
 Traffic Safety Section

**LEGEND**

- APPROXIMATE POTHOLE LOCATION
- SIGN
- TRAFFIC CONES / DELINEATOR
- BARRICADE
- FLAGGER
- FLASHING ARROW SIGN
- WORK ZONE
- CONSTRUCTION VEHICLE
- BUS STOP

UTILITY SURVEYORS, INC.  
  
**AIRX**  
 2534 EAST EL NORTE PARKWAY, SUITE C  
 ESCONDIDO, CA 92027  
 PHONE: (760) 480-2347  
 CELL: (760) 419-3738

**Gail McMorran**  
 President

<b>PROJECT NAME:</b> TL23071 – Sycamore Canyon Substation To Penasquitos Substation – 230 KV Underground	
<b>AIRX JOB#:</b> X160218	<b>THOMAS GRID#:</b> --
<b>TYPE OF WORK:</b> TRENCHING / CONDUIT	<b>DRAWN FOR:</b> SAN DIEGO COUNTY
<b>MISC/POTHOLE#:</b>	

<b>DATE:</b> Mar 2, 2017
<b>DESIGNED BY:</b> Clint Jones
<b>SHEET 1 OF 4</b>





NOTE: W8-24 (STEEL PLATES AHEAD) SIGNS WILL REMAIN IN PLACE FOR DURATION OF WORK

NOTE: W8-24 (STEEL PLATES AHEAD) SIGNS WILL REMAIN IN PLACE FOR DURATION OF WORK

NOTE: STEEL PLATE BRIDGING SHALL NOT EXCEED 24 HR AND 50 FEET IN LENGTH IN THE WORK ZONE

**APPROVED**  
**TRAFFIC CONTROL PERMIT**

JUL 12 2017

CITY OF SAN DIEGO  
Development Services  
Engineering Division  
Traffic Safety Section

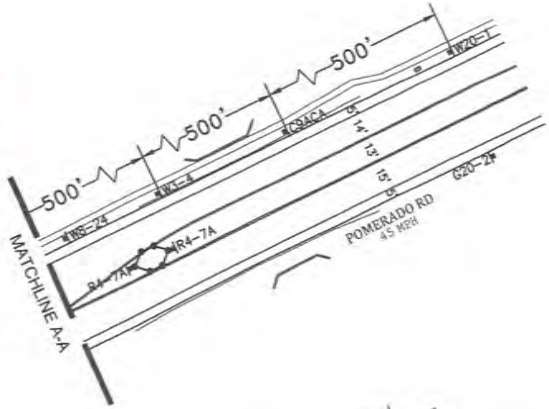

ORIGINAL PERMIT MUST BE KEPT ON JOB SITE ALL TIMES

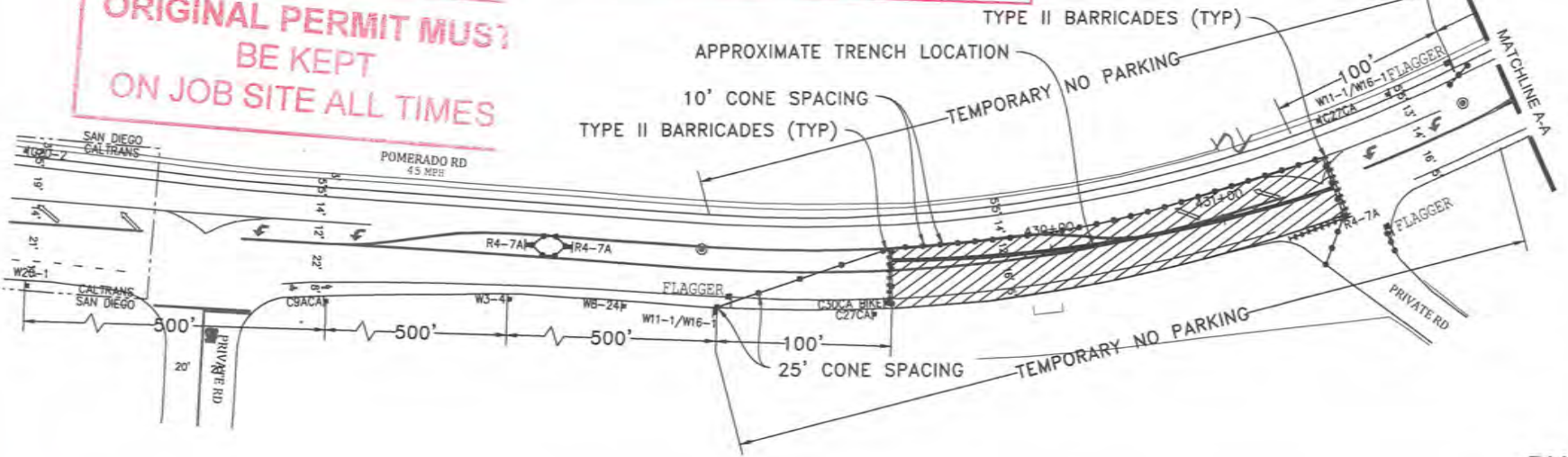

**PHASE 01**

UTILITY SURVEYORS, INC.



**Gail McMorran**  
President

2534 EAST EL NORTE PARKWAY, SUITE C  
ESCONDIDO, CA 92027  
PHONE: (760) 480-2347  
CELL: (760) 419-3738

<b>PROJECT NAME:</b> TL23071 – Sycamore Canyon Substation To Penasquitos Substation – 230 KV Underground	
AIRX JOB#: X160218	THOMAS GRID#: –
TYPE OF WORK: TRENCHING / CONDUIT	DRAWN FOR: SAN DIEGO COUNTY
MISC/POTHOLE#:	

DATE: Mar 2, 2017
DESIGNED BY: Clint Jones
SHEET 2 OF 4



**ORIGINAL PERMIT MUST  
BE KEPT  
ON JOB SITE ALL TIMES**

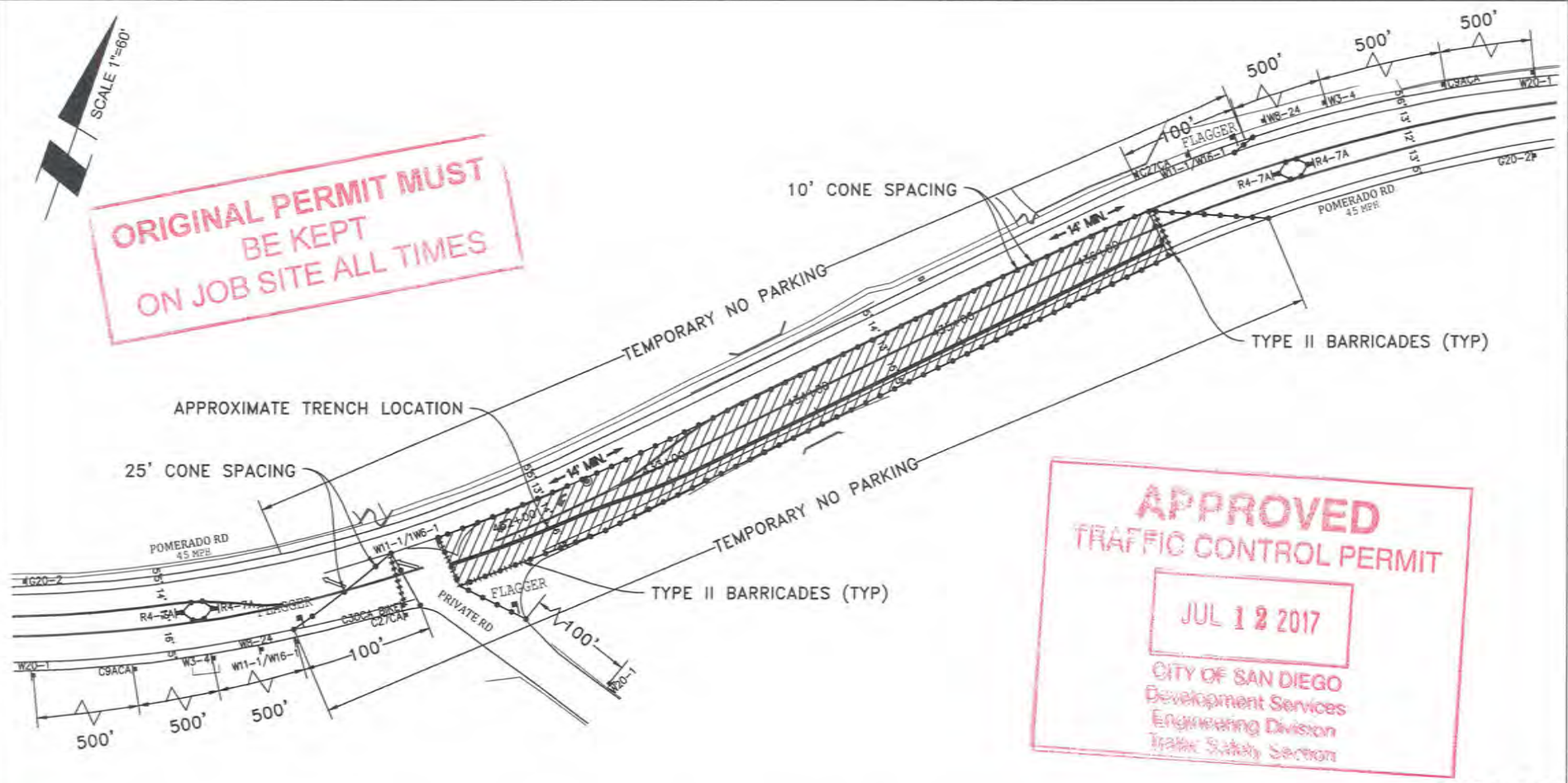

**PHASE 02**

UTILITY SURVEYORS, INC.  
  
**Gail McMorran**  
 President  
 2534 EAST EL NORTE PARKWAY, SUITE C  
 ESCONDIDO, CA 92027  
 PHONE: (760) 480-2347  
 CELL: (760) 419-5738

<b>PROJECT NAME:</b> TL23071 – Sycamore Canyon Substation To Penasquitos Substation – 230 KV Underground	
AIRX JOB#: X160218	THOMAS GRID#: –
TYPE OF WORK: TRENCHING / CONDUIT	DRAWN FOR: SAN DIEGO COUNTY
MISC/POTHOLE#:	

DATE: Mar 2, 2017
DESIGNED BY: Clint Jones
<b>SHEET 3 OF 4</b>





**APPROVED  
TRAFFIC CONTROL PERMIT**

**JUL 12 2017**

CITY OF SAN DIEGO  
Development Services  
Engineering Division  
Traffic Safety Section

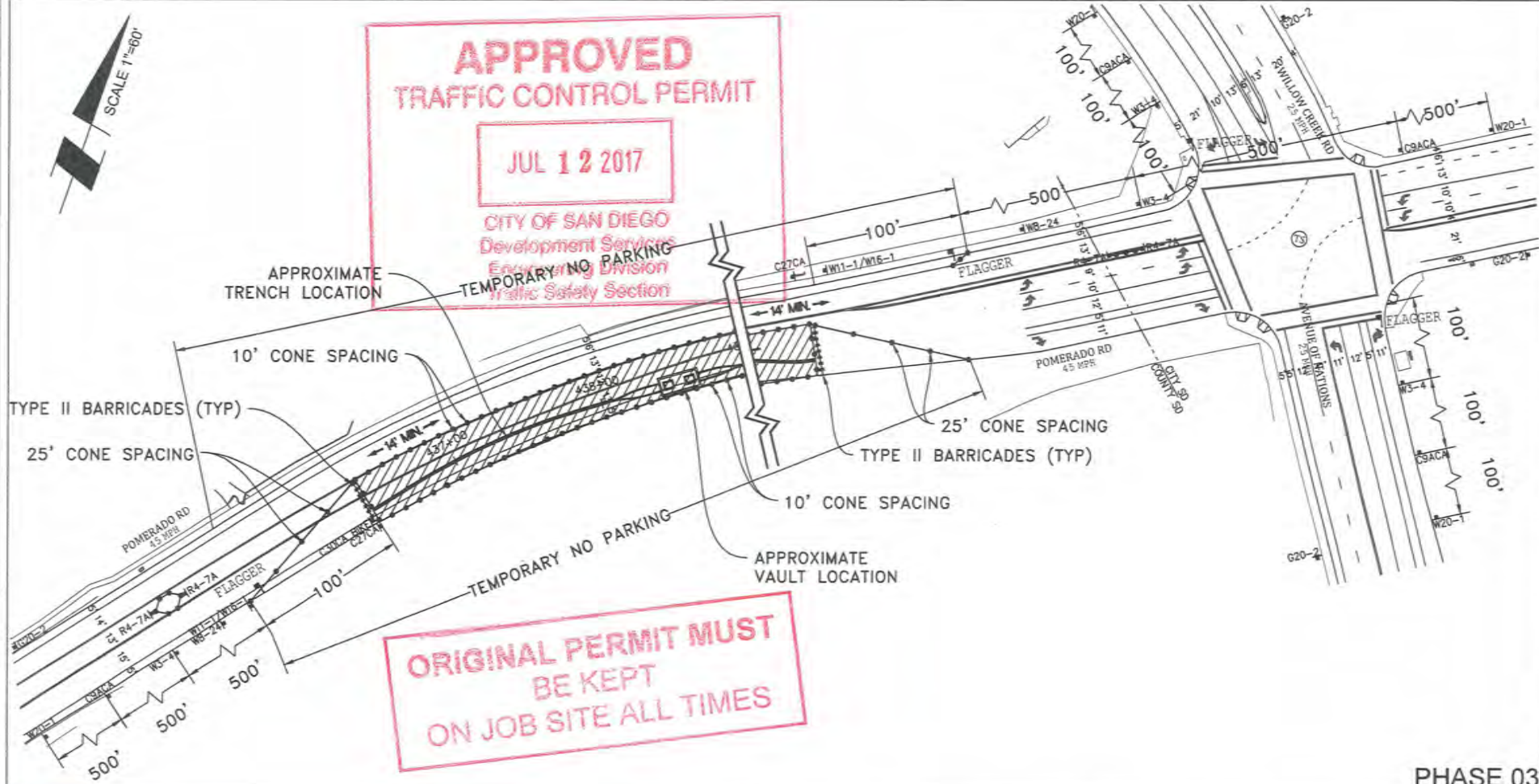

**ORIGINAL PERMIT MUST  
BE KEPT  
ON JOB SITE ALL TIMES**

PHASE 03

UTILITY SURVEYORS, INC.  
  
**Gail McMorran**  
 President  
 2534 EAST EL NORTE PARKWAY, SUITE C  
 ESCONDIDO, CA 92027  
 PHONE: (760) 480-2347  
 CELL: (760) 419-3738

<b>PROJECT NAME:</b> TL23071 – Sycamore Canyon Substation To Penasquitos Substation – 230 KV Underground	
AIRX JOB#: X160218	THOMAS GRID#: –
TYPE OF WORK: TRENCHING / CONDUIT	DRAWN FOR: SAN DIEGO COUNTY
MISC/POTHOLE#:	

DATE: Mar 2, 2017
DESIGNED BY: Clint Jones
<b>SHEET 4 OF 4</b>

**APPROVED  
TRAFFIC CONTROL PERMIT**

**SIGN LEGEND**

**ORIGINAL PERMIT MUST BE KEPT ON JOB SITE ALL TIMES**

**CITY OF SAN DIEGO  
Development Services  
Engineering Division  
Traffic Safety Section**

**LEGEND**

- APPROXIMATE POTHOLE LOCATION
- SIGN
- TRAFFIC CONES / DELINEATOR
- BARRICADE
- FLAGGER
- FLASHING ARROW SIGN
- WORK ZONE
- CONSTRUCTION VEHICLE
- BUS STOP

APPROACH SPEED (MPH)	MINIMUM DISTANCE (FEET) BETWEEN SIGNS AND FROM LAST SIGN TO TAPER	MINIMUM TAPER LENGTHS (L) (FEET) FOR 12-FOOT LANE			BUFFER LENGTH (FEET)	MAX CONE SPACING		
		L	1/2L	1/3L		TAPER	TANGENT	CONFLICT
25	100	125	65	45	155	25	50	12
30	250	180	90	60	200	30	60	15
35	250	245	125	85	250	35	70	17
40	250	320	160	110	305	40	80	20
45	350	540	270	180	360	45	90	22
50	350	600	300	200	425	50	100	25
55+	350	660	330	220	495	55	110	27

**UTILITY SURVEYORS, INC.**  
  
**Gail McMorran**  
 President  
 2534 EAST EL NORTE PARKWAY, SUITE C  
 ESCONDIDO, CA 92027  
 PHONE: (760) 480-2347  
 CELL: (760) 419-3736

**PROJECT NAME:** TL23071 – Sycamore Canyon Substation To Penasquitos Substation – 230 KV Underground

**AIRX JOB#:** X160218      **THOMAS GRID#:** –

**TYPE OF WORK:** TRENCHING / CONDUIT      **DRAWN FOR:** SAN DIEGO COUNTY City

**MISC/POTHOLE#:**

**DATE:** Mar 2, 2017  
**DESIGNED BY:** Clint Jones  
**SHEET 1 OF 4**



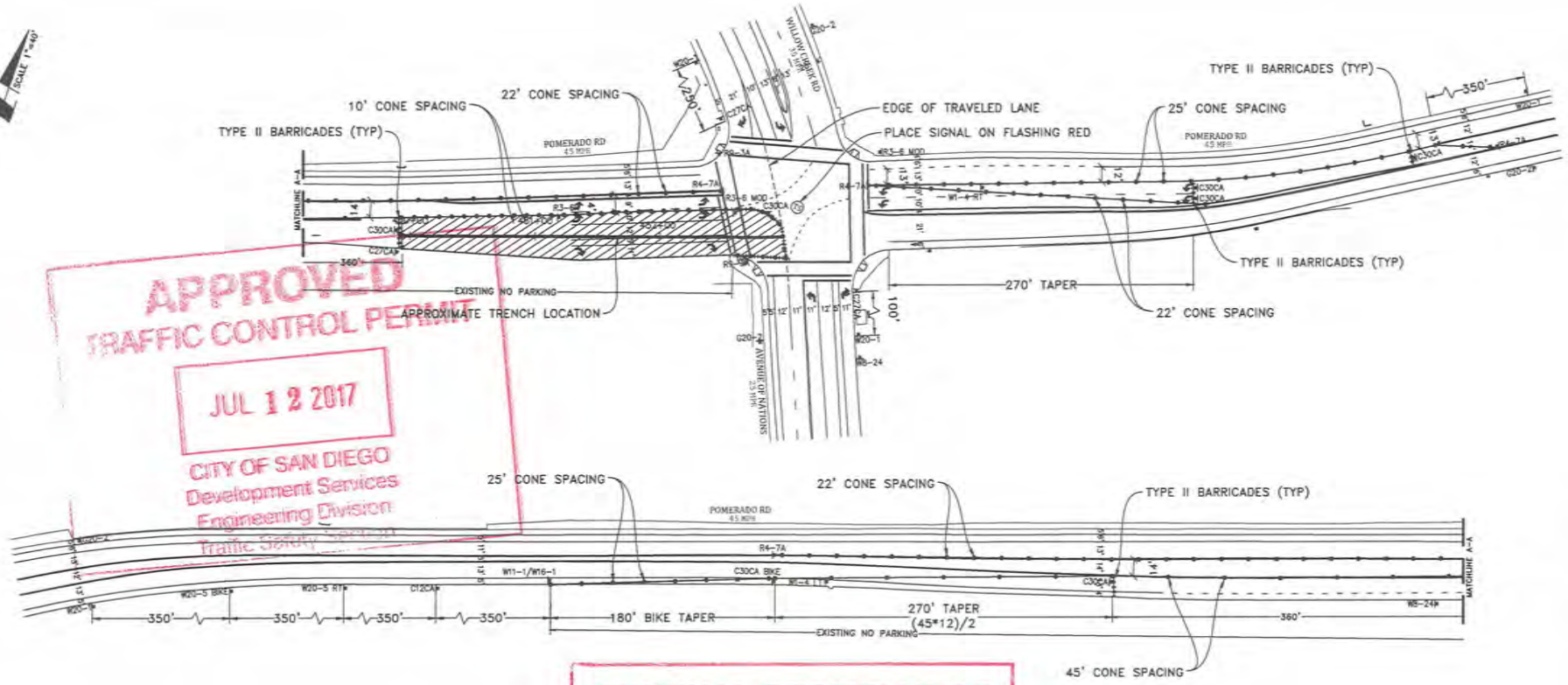

APPROVED  
TRAFFIC CONTROL PERMIT

JUL 12 2017

CITY OF SAN DIEGO  
Development Services  
Engineering Division  
Traffic Safety Section

ORIGINAL PERMIT MUST  
BE KEPT  
ON JOB SITE ALL TIMES

WORK HOURS: TO

- NOTE: CONTRACTOR WILL COORDINATE ALL WORK WITH FIRE STATION PRIOR TO START OF WORK
- NOTE: CONTRACTOR WILL COORDINATE ALL WORK WITH TRANSIT DEPARTMENT 5 DAYS PRIOR TO START OF WORK
- NOTE: CONTRACTOR WILL COORDINATE ALL WORK WITH EXISTING PROJECTS AND NOT CONFLICT WITH EXISTING TRAFFIC CONTROL
- NOTE: CONTRACTOR WILL COORDINATE ALL WORK WITH RESIDENTS PRIOR TO START OF WORK
- NOTE: CONTRACTOR WILL COORDINATE ALL WORK WITH BUSINESSES PRIOR TO START OF WORK

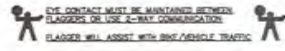

**LEGEND**

- SIGN
- TRAFFIC CONES / DELINEATOR
- BARRICADE
- FLAGGER
- FLASHING ARROW SIGN
- WORK ZONE
- BUS STOP

- NOTE: FLAGGERS WILL PROVIDE ACCESS TO DRIVEWAYS AT ALL TIMES
- NOTE: FLAGGERS WILL SAFELY GUIDE PEDESTRIANS THROUGH WORK AREA
- NOTE: CONTRACTOR WILL ALLOW FIRE STATION INGRESS AND EGRESS AT ALL TIMES
- NOTE: WB-24 (STEEL PLATES AHEAD) SIGNS WILL REMAIN IN PLACE FOR DURATION OF WORK

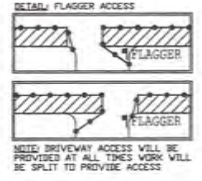

**AIRX** SURVEYORS, INC.  
Gail McMorran  
President  
2534 EAST EL NORTE PARKWAY, SUITE C  
ESCONDIDO, CA 92027  
PHONE: (760) 450-5347  
CELL: (760) 419-3708

PROJECT NAME: TL23071 - SYCAMORE CANYON SUBSTATION TO PENASQUITOS - 230 KV UNDERGROUND	
AIRX JOB#: X160218	THOMAS GRID#:-
TYPE OF WORK: RENCHING / CONDUIT	DRAWN FOR: CALTRANS
MISC./POTHLES#:	

PHASE 82

DATE: Mar. 21, 2017
DESIGNED BY: Clint Jones
SHEET 098 OF 148

# APPROVED TRAFFIC CONTROL PERMIT

JUL 12 2017

CITY OF SAN DIEGO  
Development &  
Engineering Division  
Traffic Safety Section

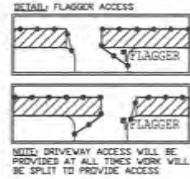
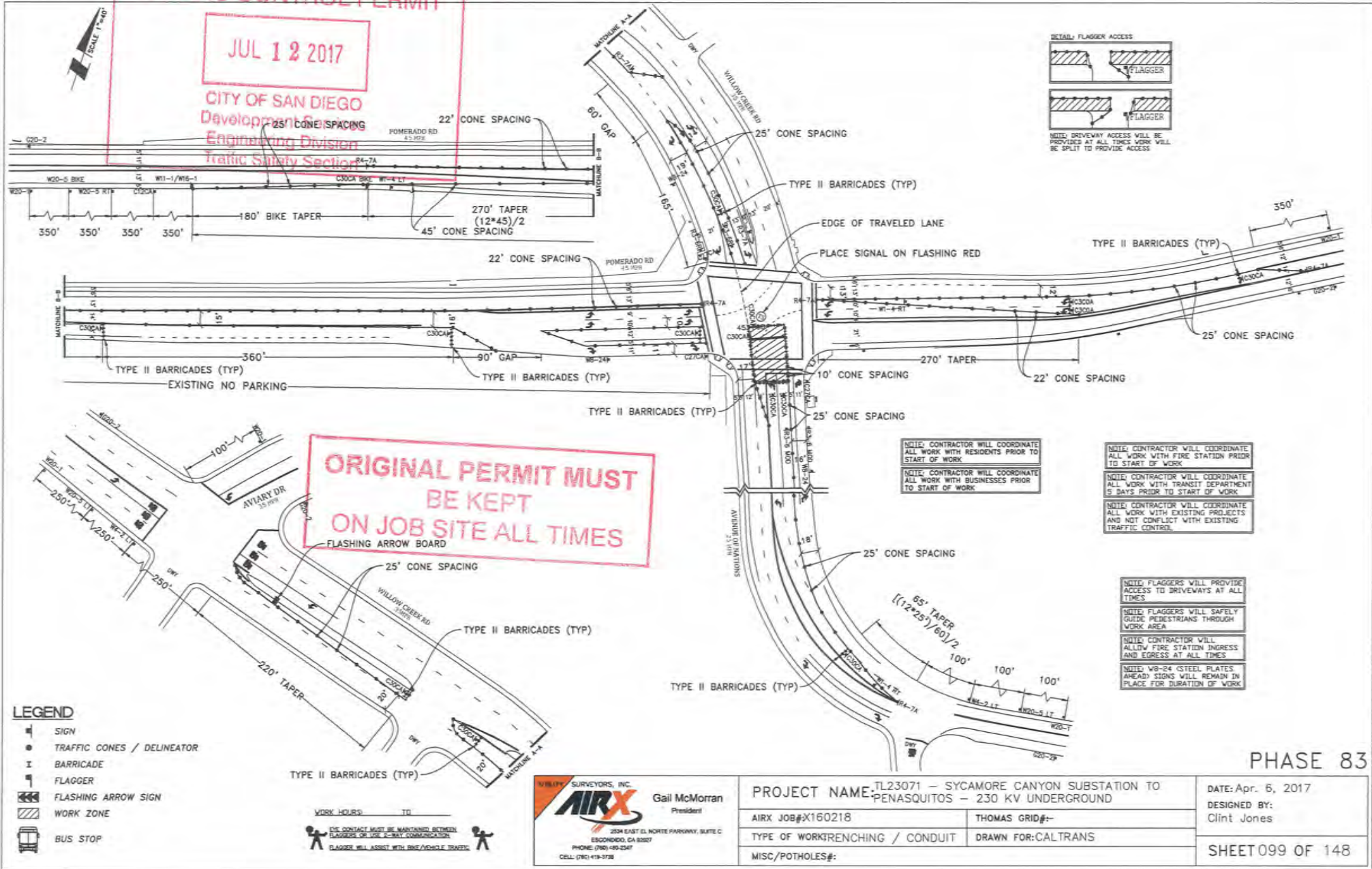

**ORIGINAL PERMIT MUST  
BE KEPT  
ON JOB SITE ALL TIMES**

NOTE: CONTRACTOR WILL COORDINATE ALL WORK WITH RESIDENTS PRIOR TO START OF WORK  
NOTE: CONTRACTOR WILL COORDINATE ALL WORK WITH BUSINESSES PRIOR TO START OF WORK

NOTE: CONTRACTOR WILL COORDINATE ALL WORK WITH FIRE STATION PRIOR TO START OF WORK  
NOTE: CONTRACTOR WILL COORDINATE ALL WORK WITH TRANSIT DEPARTMENT 5 DAYS PRIOR TO START OF WORK  
NOTE: CONTRACTOR WILL COORDINATE ALL WORK WITH EXISTING PROJECTS AND NOT CONFLICT WITH EXISTING TRAFFIC CONTROL.

NOTE: FLAGGERS WILL PROVIDE ACCESS TO DRIVEWAYS AT ALL TIMES  
NOTE: FLAGGERS WILL SAFELY GUIDE PEDESTRIANS THROUGH WORK AREA  
NOTE: CONTRACTOR WILL ALLOW FIRE STATION INGRESS AND EGRESS AT ALL TIMES  
NOTE: W8-24 STEEL PLATES AHEAD SIGNS WILL REMAIN IN PLACE FOR DURATION OF WORK

- LEGEND**
- SIGN
  - TRAFFIC CONES / DELINEATOR
  - BARRICADE
  - FLAGGER
  - FLASHING ARROW SIGN
  - WORK ZONE
  - BUS STOP

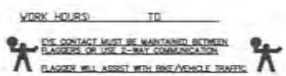

AIRX SURVEYORS, INC.  
**AIRX**  
Gail McMorrin  
President  
2524 EAST EL NORTE PARKWAY, SUITE C  
ESCONDIDO, CA 92027  
PHONE: (760) 492-2347  
CELL: (760) 419-3728

PROJECT NAME: TL23071 - SYCAMORE CANYON SUBSTATION TO PENASQUITOS - 230 KV UNDERGROUND	
AIRX JOB#: X160218	THOMAS GRID#:
TYPE OF WORK: TRENCHING / CONDUIT	DRAWN FOR: CALTRANS
MISC./POTHOLE#:	

PHASE 83

DATE: Apr. 6, 2017  
DESIGNED BY: Clint Jones  
SHEET 099 OF 148



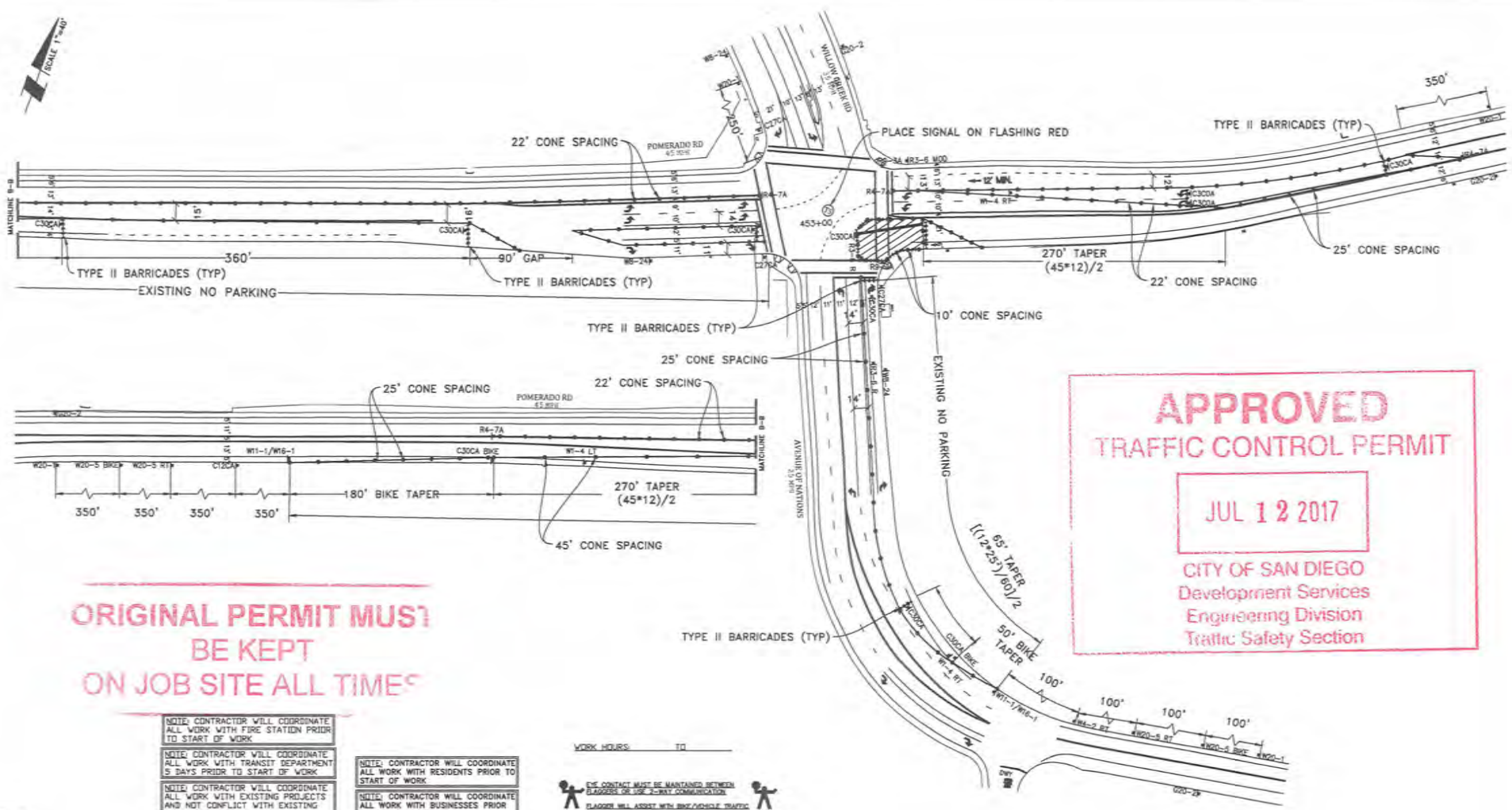

**APPROVED**  
**TRAFFIC CONTROL PERMIT**  

**JUL 12 2017**

**CITY OF SAN DIEGO**  
 Development Services  
 Engineering Division  
 Traffic Safety Section

ORIGINAL PERMIT MUST  
 BE KEPT  
 ON JOB SITE ALL TIMES

- NOTE: CONTRACTOR WILL COORDINATE ALL WORK WITH FIRE STATION PRIOR TO START OF WORK.
- NOTE: CONTRACTOR WILL COORDINATE ALL WORK WITH TRANSIT DEPARTMENT 5 DAYS PRIOR TO START OF WORK.
- NOTE: CONTRACTOR WILL COORDINATE ALL WORK WITH EXISTING PROJECTS AND NOT CONFLICT WITH EXISTING TRAFFIC CONTROL.
- NOTE: CONTRACTOR WILL COORDINATE ALL WORK WITH RESIDENTS PRIOR TO START OF WORK.
- NOTE: CONTRACTOR WILL COORDINATE ALL WORK WITH BUSINESSES PRIOR TO START OF WORK.

- LEGEND**
- SIGN
  - TRAFFIC CONES / DELINEATOR
  - BARRICADE
  - FLAGGER
  - FLASHING ARROW SIGN
  - WORK ZONE
  - BUS STOP

- NOTE: FLAGGERS WILL PROVIDE ACCESS TO DRIVEWAYS AT ALL TIMES**
- NOTE: FLAGGERS WILL SAFELY GUIDE PEDESTRIANS THROUGH WORK AREA**
- NOTE: CONTRACTOR WILL ALLOW FIRE STATION INGRESS AND EGRESS AT ALL TIMES**
- NOTE: WB-24 STEEL PLATES AHEAD SIGNS WILL REMAIN IN PLACE FOR DURATION OF WORK**
- NOTE: DRIVEWAY ACCESS WILL BE PROVIDED AT ALL TIMES. WORK WILL BE SPLIT TO PROVIDE ACCESS**

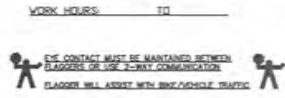

**AIRX SURVEYORS, INC.**  
**AIRX**  
 Gail McMorran  
 President  
 2004 EAST EL NORTE PARKWAY, SUITE C  
 ESCONDIDO, CA 92027  
 PHONE: (760) 489-2547  
 CELL: (951) 418-3728

PROJECT NAME: TL23071 - SYCAMORE CANYON SUBSTATION TO PENASQUITOS - 230 KV UNDERGROUND	
AIRX JOB#X160218	THOMAS GRID#:-
TYPE OF WORK: TRENCHING / CONDUIT	DRAWN FOR: CALTRANS
MISC./POTHOLE#:	

PHASE 84

DATE: Mar. 21, 2017  
 DESIGNED BY:  
 Clint Jones  
 SHEET 100 OF 148

**ORIGINAL PERMIT MUST  
BE KEPT  
ON JOB SITE ALL TIMES**

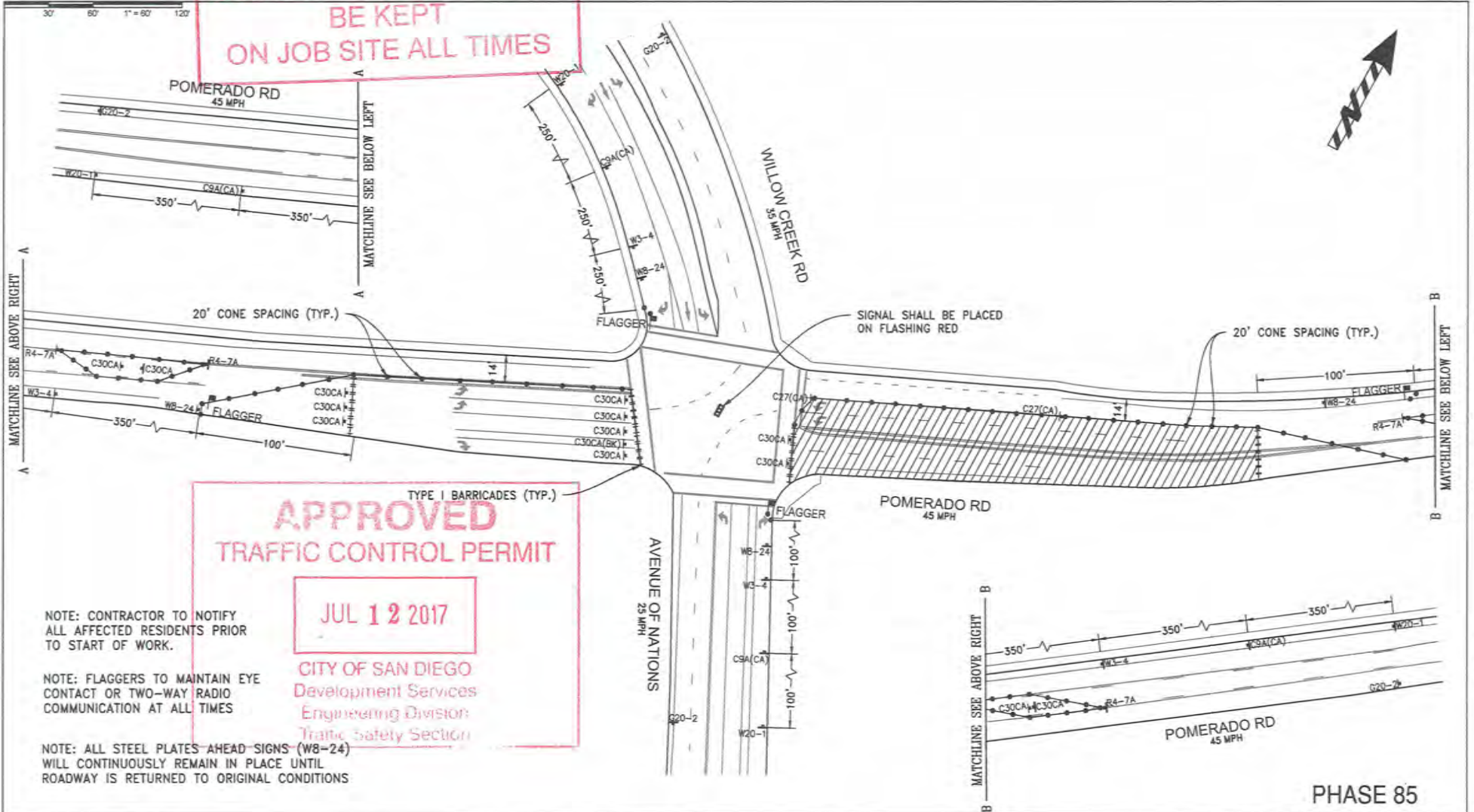

**APPROVED  
TRAFFIC CONTROL PERMIT**

**JUL 12 2017**

**CITY OF SAN DIEGO  
Development Services  
Engineering Division  
Traffic Safety Section**

NOTE: CONTRACTOR TO NOTIFY ALL AFFECTED RESIDENTS PRIOR TO START OF WORK.

NOTE: FLAGGERS TO MAINTAIN EYE CONTACT OR TWO-WAY RADIO COMMUNICATION AT ALL TIMES

NOTE: ALL STEEL PLATES-AHEAD SIGNS (WB-24) WILL CONTINUOUSLY REMAIN IN PLACE UNTIL ROADWAY IS RETURNED TO ORIGINAL CONDITIONS

**PHASE 85**



1221 S. 26TH ST  
SAN DIEGO, CA 92113  
OFFICE: (858) 259-0300  
FAX: (858) 259-0357

POSTED SPEED LIMIT (MPH)	SEE PLAN	MIGUEL URESTI
SIGN SPACING (FEET)	SEE PLAN	DRAWN BY:
TAPER LENGTH (FEET)	SEE PLAN	PROJECT NUMBER:
CONE SPACING (FEET)	SEE PLAN	DATE: July 6, 2017

SXPQ EAST SIDE POMERADO	
PROJECT INFORMATION	
ARB	
COMPANY	
ROD NELSON	619.295.2754
PROJECT CONTACT	PHONE

TRAFFIC CONTROL PLANS	
CITY OF SAN DIEGO	
-	SHEET 101 OF 148





ORIGINAL PERMIT MUST  
BE KEPT  
ON JOB SITE ALL TIMES

APPROVED  
TRAFFIC CONTROL PERMIT

JUL 12 2017

CITY OF SAN DIEGO  
Development Services  
Engineering Division  
Traffic Safety Section

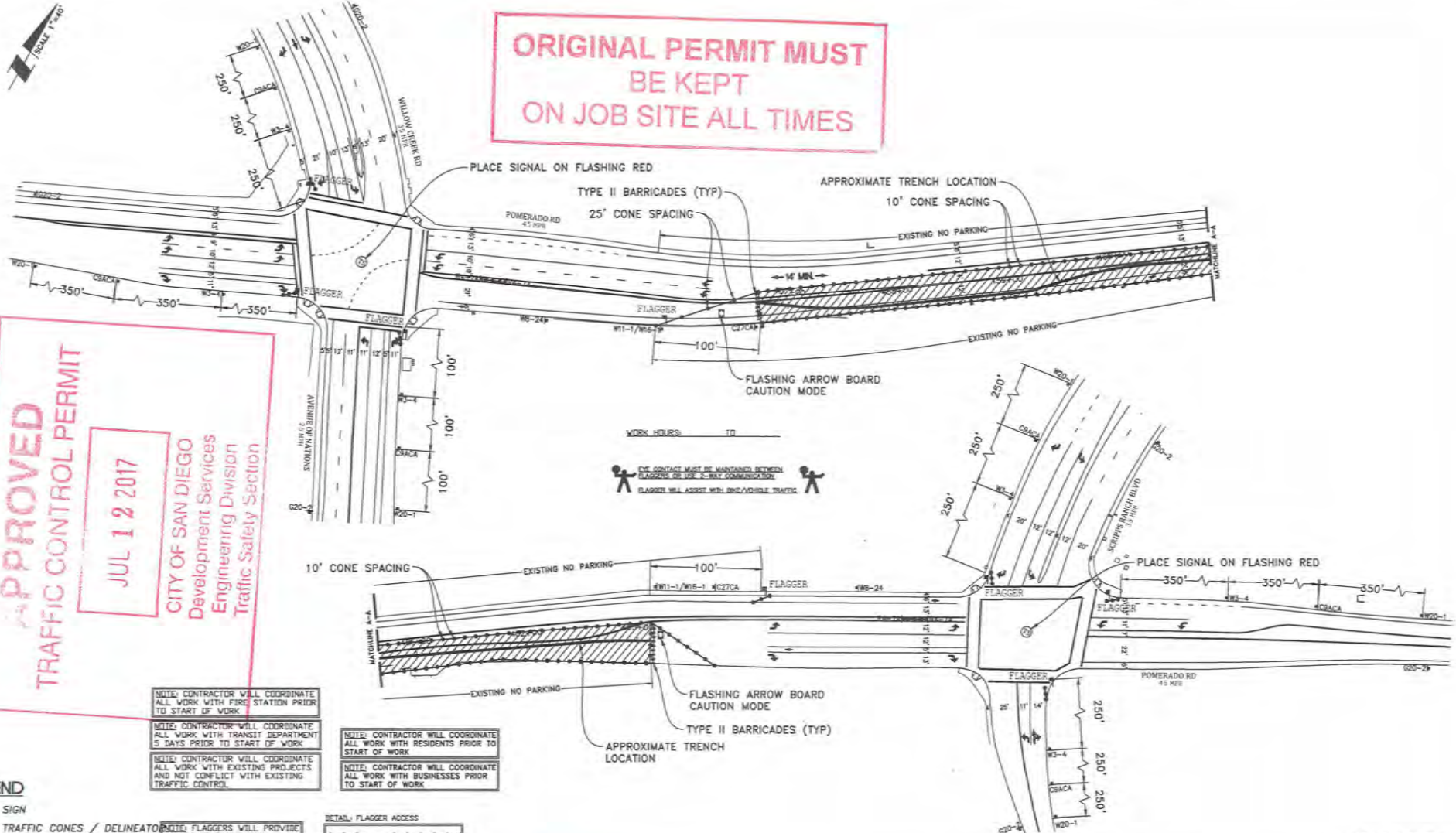

- NOTE: CONTRACTOR WILL COORDINATE ALL WORK WITH FIRE STATION PRIOR TO START OF WORK
- NOTE: CONTRACTOR WILL COORDINATE ALL WORK WITH TRANSIT DEPARTMENT 5 DAYS PRIOR TO START OF WORK
- NOTE: CONTRACTOR WILL COORDINATE ALL WORK WITH EXISTING PROJECTS AND NOT CONFLICT WITH EXISTING TRAFFIC CONTROL
- NOTE: CONTRACTOR WILL COORDINATE ALL WORK WITH RESIDENTS PRIOR TO START OF WORK
- NOTE: CONTRACTOR WILL COORDINATE ALL WORK WITH BUSINESSES PRIOR TO START OF WORK

- LEGEND**
- SIGN
  - TRAFFIC CONES / DELINEATOR
  - BARRICADE
  - FLAGGER
  - FLASHING ARROW SIGN
  - WORK ZONE
  - BUS STOP

- NOTE: FLAGGERS WILL PROVIDE ACCESS TO DRIVEWAYS AT ALL TIMES
- NOTE: FLAGGERS WILL SAFELY GUIDE PEDESTRIANS THROUGH WORK AREA
- NOTE: CONTRACTOR WILL ALLOW FIRE STATION INGRESS AND EGRESS AT ALL TIMES
- NOTE: WB-24 (STEEL PLATES) HEAD SIGN WILL REMAIN IN PLACE FOR DURATION OF WORK

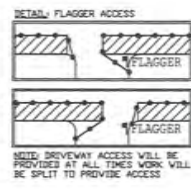

**AIRX** SURVEYORS, INC.  
Gail McMorran  
President  
2534 EAST EL NORTE PARKWAY, SUITE C  
ESCONDIDO, CA 92027  
PHONE: (760) 440-2347  
CELL: (760) 419-3728

<b>PROJECT NAME:</b> TL23071 - SYCAMORE CANYON SUBSTATION TO PENASQUITOS - 230 KV UNDERGROUND	
<b>AIRX JOB#:</b> X160218	<b>THOMAS GRID#:</b>
<b>TYPE OF WORK:</b> TRENCHING / CONDUIT	<b>DRAWN FOR:</b> CALTRANS
<b>MISC./POTHOLE#:</b>	

PHASE 86

**DATE:** Mar. 21, 2017  
**DESIGNED BY:** Clint Jones  
**SHEET:** 102 OF 148

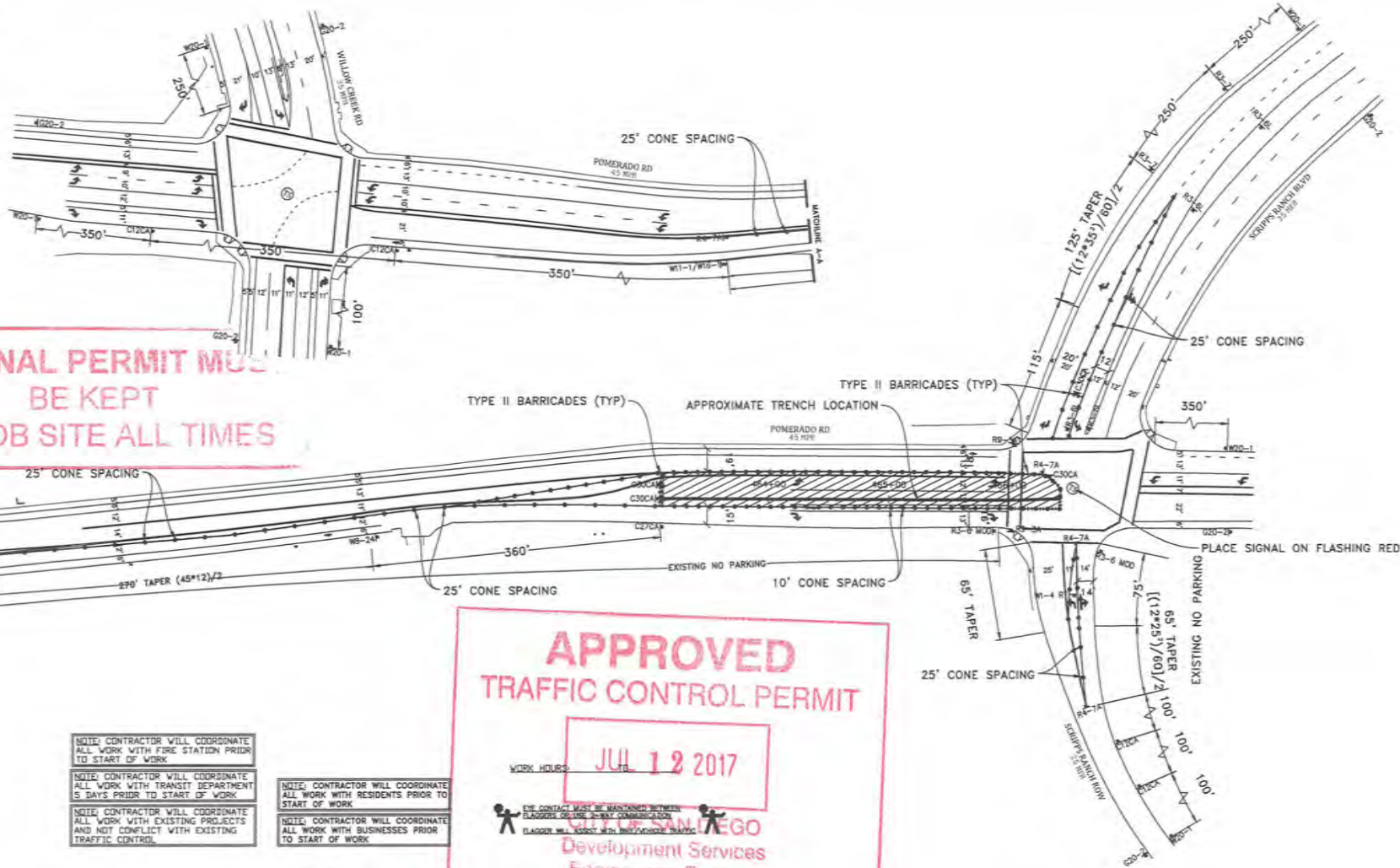

**APPROVED TRAFFIC CONTROL PERMIT**

WORK HOURS: **JUL 1 & 2 2017**

SAFETY SAN DIEGO Development Services Engineering Division Traffic Safety Section

NOTE: CONTRACTOR WILL COORDINATE ALL WORK WITH FIRE STATION PRIOR TO START OF WORK.

NOTE: CONTRACTOR WILL COORDINATE ALL WORK WITH TRANSIT DEPARTMENT 5 DAYS PRIOR TO START OF WORK.

NOTE: CONTRACTOR WILL COORDINATE ALL WORK WITH EXISTING PROJECTS AND NOT CONFLICT WITH EXISTING TRAFFIC CONTROL.

NOTE: CONTRACTOR WILL COORDINATE ALL WORK WITH RESIDENTS PRIOR TO START OF WORK.

NOTE: CONTRACTOR WILL COORDINATE ALL WORK WITH BUSINESSES PRIOR TO START OF WORK.

NOTE: FLAGGERS WILL PROVIDE ACCESS TO DRIVEWAYS AT ALL TIMES.

NOTE: FLAGGERS WILL SAFELY GUIDE PEDESTRIANS THROUGH WORK AREA.

NOTE: CONTRACTOR WILL ALLOW FIRE STATION INGRESS AND EGRESS AT ALL TIMES.

NOTE: WB-24 (STEEL PLATES) (HEAD) SIGNS WILL REMAIN IN PLACE FOR DURATION OF WORK.



- LEGEND**
- SIGN
  - TRAFFIC CONES / DELINEATOR
  - I BARRICADE
  - ⚑ FLAGGER
  - ↔ FLASHING ARROW SIGN
  - ▨ WORK ZONE
  - 🚫 BUS STOP

**AIRX** SURVEYORS, INC.  
 Gail McMorrin  
 President  
 254 EAST EL NORTE PARKWAY, SUITE C  
 ESCONDIDO, CA 92027  
 PHONE: (760) 445-2547  
 CELL: (760) 419-3728

PROJECT NAME: TL23071 - SYCAMORE CANYON SUBSTATION TO PENASQUITOS - 230 KV UNDERGROUND	
AIRX JOB#: X160218	THOMAS GRID#:
TYPE OF WORK: TRENCHING / CONDUIT	DRAWN FOR: CALTRANS
MISC./POTHOLES#:	

**PHASE 87**

DATE: Mar. 21, 2017  
 DESIGNED BY: Clint Jones  
 SHEET 103 OF 148





**ORIGINAL PERMIT MUST BE KEPT ON JOB SITE ALL TIMES**

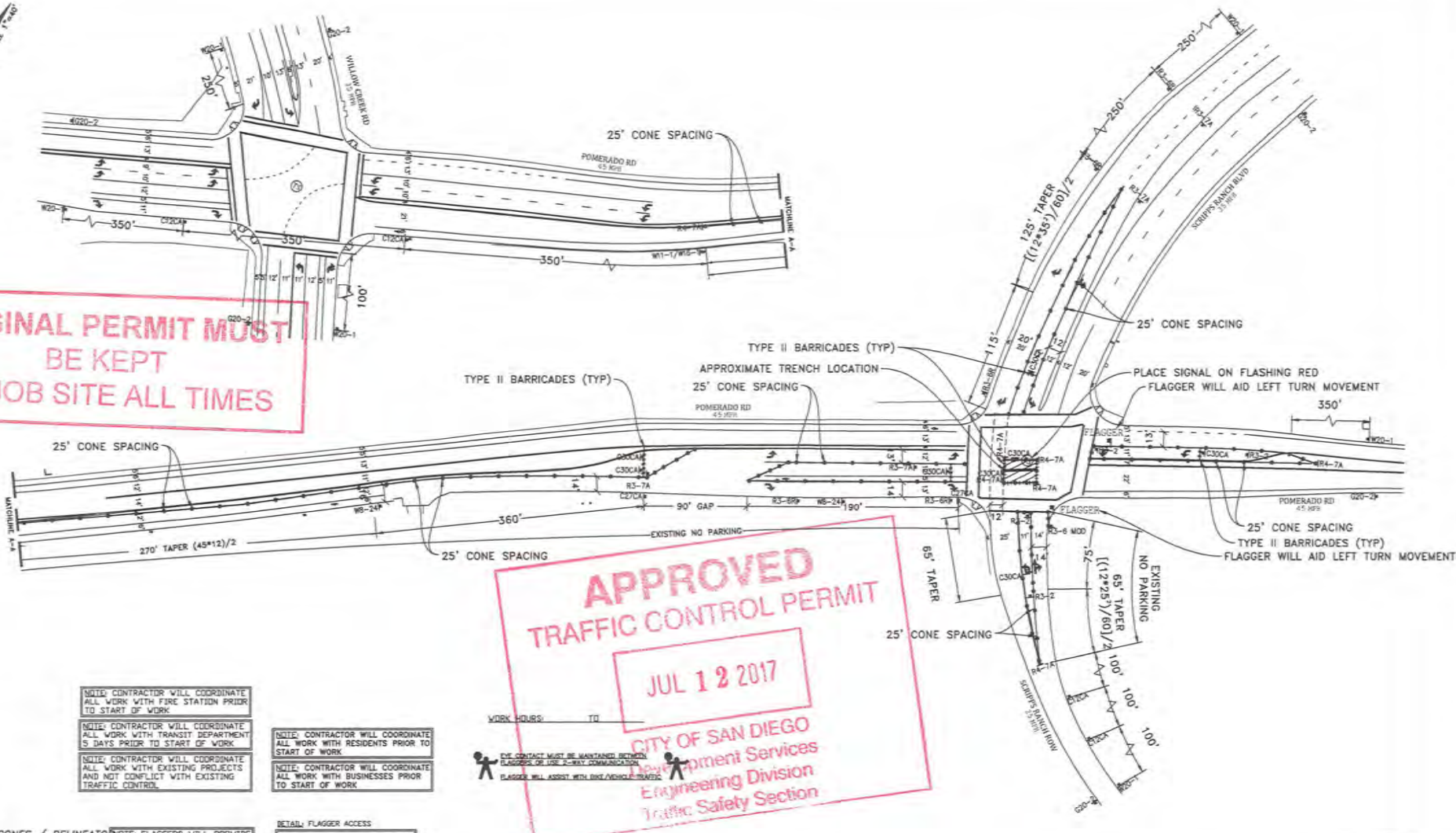

- LEGEND**
- SIGN
  - TRAFFIC CONES / DELINEATOR
  - I BARRICADE
  - ⚡ FLAGGER
  - ➡ FLASHING ARROW SIGN
  - ▨ WORK ZONE
  - 🚌 BUS STOP

**NOTE:** CONTRACTOR WILL COORDINATE ALL WORK WITH FIRE STATION PRIOR TO START OF WORK

**NOTE:** CONTRACTOR WILL COORDINATE ALL WORK WITH TRANSIT DEPARTMENT 5 DAYS PRIOR TO START OF WORK

**NOTE:** CONTRACTOR WILL COORDINATE ALL WORK WITH EXISTING PROJECTS AND NOT CONFLICT WITH EXISTING TRAFFIC CONTROL

**NOTE:** CONTRACTOR WILL COORDINATE ALL WORK WITH RESIDENTS PRIOR TO START OF WORK

**NOTE:** CONTRACTOR WILL COORDINATE ALL WORK WITH BUSINESSES PRIOR TO START OF WORK

**NOTE:** CONTRACTOR WILL COORDINATE ALL WORK WITH EXISTING PROJECTS AND NOT CONFLICT WITH EXISTING TRAFFIC CONTROL

**NOTE:** CONTRACTOR WILL ALLOW FIRE STATION INGRESS AND EGRESS AT ALL TIMES

**NOTE:** W8-24 (STEEL PLATES) SHEARD SIGNS WILL REMAIN IN PLACE FOR DURATION OF WORK

**NOTE:** CONTRACTOR WILL PROVIDE ACCESS TO DRIVEWAYS AT ALL TIMES

**NOTE:** CONTRACTOR WILL SAFELY GUIDE PEDESTRIANS THROUGH WORK AREA

**NOTE:** CONTRACTOR WILL ALLOW FIRE STATION INGRESS AND EGRESS AT ALL TIMES

**NOTE:** DRIVEWAY ACCESS WILL BE PROVIDED AT ALL TIMES WORK WILL BE SPLIT TO PROVIDE ACCESS

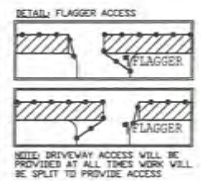

**AIRX** SURVEYORS, INC.  
 Gail McMorran  
 President  
 2534 EAST EL NORTE PARKWAY, SUITE C  
 ESCOBEDO, CA 92027  
 PHONE: (760) 465-0247  
 CELL: (760) 419-5728

PROJECT NAME: TL23071 - SYCAMORE CANYON SUBSTATION TO PENASQUITOS - 230 KV UNDERGROUND	
AIRX JOB#: X160218	THOMAS GRID#:-
TYPE OF WORK: TRENCHING / CONDUIT	DRAWN FOR: CALTRANS
MISC/POTHOLE#:	

**PHASE 88**

DATE: Mar. 21, 2017  
 DESIGNED BY: Clint Jones  
 SHEET 104 OF 148

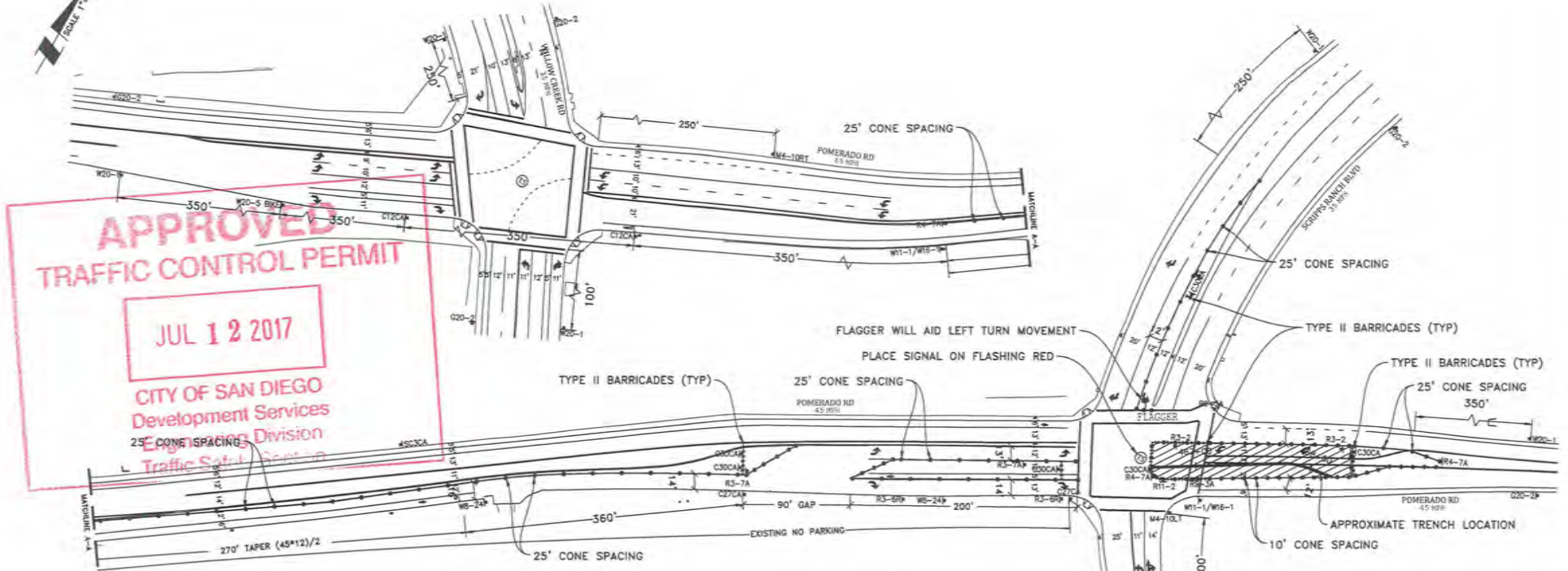

APPROVED  
TRAFFIC CONTROL PERMIT

JUL 12 2017

CITY OF SAN DIEGO  
Development Services  
Engineering Division  
Traffic Safety Section

ORIGINAL PERMIT MUST  
BE KEPT  
ON JOB SITE ALL TIMES

**NOTE:** CONTRACTOR WILL COORDINATE ALL WORK WITH FIRE DEPARTMENT TO START OF WORK

**NOTE:** CONTRACTOR WILL COORDINATE ALL WORK WITH TRANSIT DEPARTMENT 5 DAYS PRIOR TO START OF WORK

**NOTE:** CONTRACTOR WILL COORDINATE ALL WORK WITH EXISTING PROJECTS AND NOT CONFLICT WITH EXISTING TRAFFIC CONTROL

**NOTE:** CONTRACTOR WILL COORDINATE ALL WORK WITH RESIDENTS PRIOR TO START OF WORK

**NOTE:** CONTRACTOR WILL COORDINATE ALL WORK WITH BUSINESSES PRIOR TO START OF WORK

**NOTE:** FLAGGERS WILL PROVIDE ACCESS TO DRIVEWAYS AT ALL TIMES

**NOTE:** FLAGGERS WILL SAFELY GUIDE PEDESTRIANS THROUGH WORK AREA

**NOTE:** CONTRACTOR WILL ALLOW FIRE STATION INGRESS AND EGRESS AT ALL TIMES

**NOTE:** WB-24 STEEL PLATES AHEAD SIGNS WILL REMAIN IN PLACE FOR DURATION OF WORK

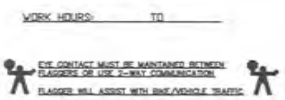
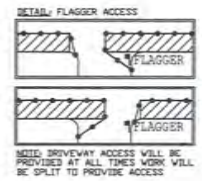

- LEGEND**
- SIGN
  - TRAFFIC CONES / DELINEATOR
  - BARRICADE
  - FLAGGER
  - FLASHING ARROW SIGN
  - WORK ZONE
  - BUS STOP

**AIRX** SURVEYORS, INC.  
Gail McMorrin  
President  
204 EAST EL NORTE PARKWAY, SUITE C  
ESCONDIDO, CA 92027  
PHONE: (760) 485-2547  
CELL: (760) 419-3728

<b>PROJECT NAME:</b> TL23071 - SYCAMORE CANYON SUBSTATION TO PENASQUITOS - 230 KV UNDERGROUND	
<b>AIRX JOB#:</b> X160218	<b>THOMAS GRID#:</b>
<b>TYPE OF WORK:</b> FRENCHING / CONDUIT	<b>DRAWN FOR:</b> CALTRANS
<b>MISC/POTHOLE#:</b>	

PHASE 89

**DATE:** Mar. 21, 2017  
**DESIGNED BY:** Clint Jones  
**SHEET** 105 OF 148



**ORIGINAL PERMIT MUST  
BE KEPT  
ON JOB SITE ALL TIMES**

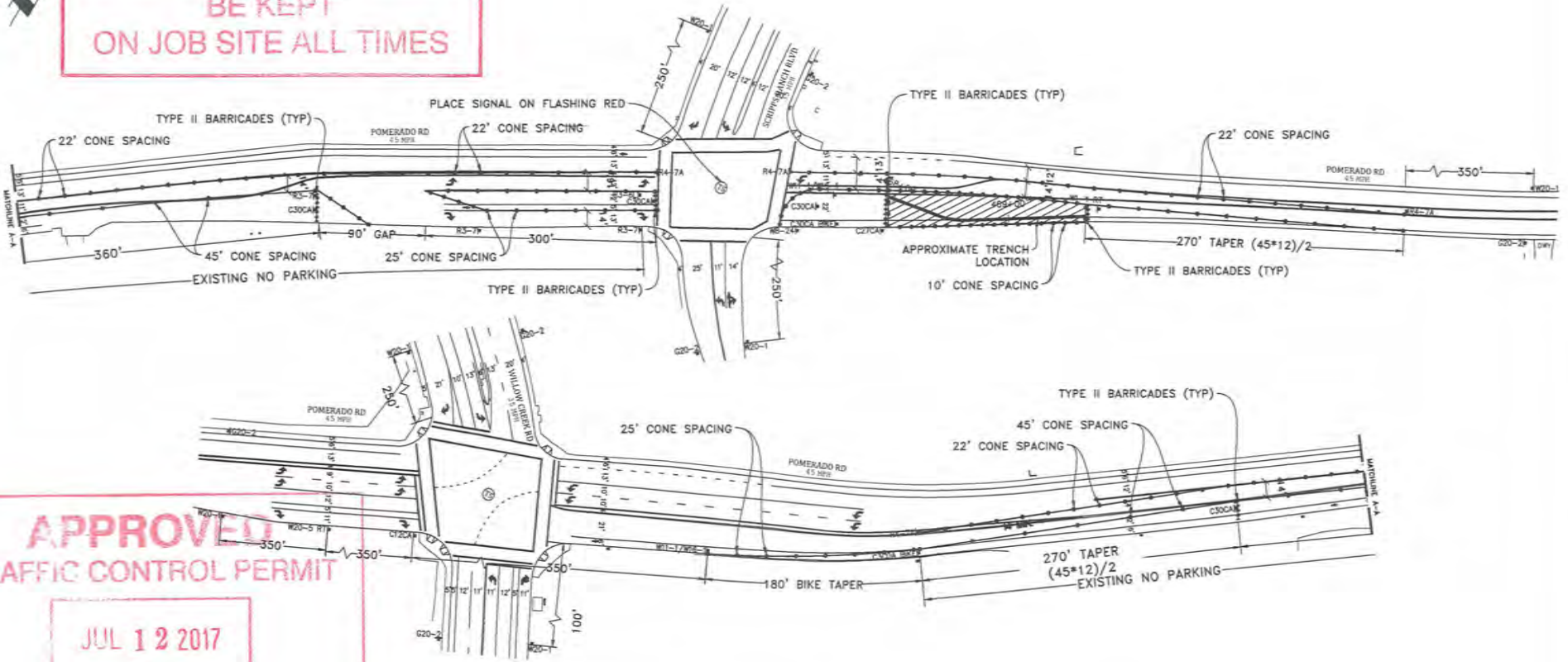

**APPROVED  
TRAFFIC CONTROL PERMIT**

**JUL 12 2017**

**CITY OF SAN DIEGO  
Development Services  
Engineering Division  
Traffic Safety Section**

**LEGEND**

- ▲ SIGN
- TRAFFIC CONES / DELINEATOR
- I BARRICADE
- ⚑ FLAGGER
- ⚡ FLASHING ARROW SIGN
- ▨ WORK ZONE
- 🚌 BUS STOP

NOTE: FLAGGERS WILL PROVIDE ACCESS TO DRIVEWAYS AT ALL TIMES

NOTE: FLAGGERS WILL SAFELY GUIDE PEDESTRIANS THROUGH WORK AREA

NOTE: CONTRACTOR WILL ALLOW FIRE STATION INGRESS AND EGRESS AT ALL TIMES

NOTE: W8-24 STEEL PLATES AHEAD SIGNS WILL REMAIN IN PLACE FOR DURATION OF WORK

**DETAIL: FLAGGER ACCESS**

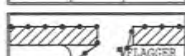
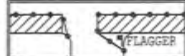

NOTE: DRIVEWAY ACCESS WILL BE PROVIDED AT ALL TIMES WORK WILL BE SPLIT TO PROVIDE ACCESS

NOTE: CONTRACTOR WILL COORDINATE ALL WORK WITH FIRE STATION PRIOR TO START OF WORK

NOTE: CONTRACTOR WILL COORDINATE ALL WORK WITH TRANSIT DEPARTMENT 5 DAYS PRIOR TO START OF WORK

NOTE: CONTRACTOR WILL COORDINATE ALL WORK WITH EXISTING PROJECTS AND NOT CONFLICT WITH EXISTING TRAFFIC CONTROL

NOTE: CONTRACTOR WILL COORDINATE ALL WORK WITH RESIDENTS PRIOR TO START OF WORK

NOTE: CONTRACTOR WILL COORDINATE ALL WORK WITH BUSINESSES PRIOR TO START OF WORK

WORK HOURS: \_\_\_\_\_ TO \_\_\_\_\_

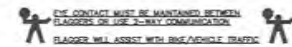

**AIRX** SURVEYORS, INC.  
Gail McMoran  
President  
2534 EAST EL NORTE PARKWAY, SUITE C  
ESCONDIDO, CA 92027  
PHONE: (760) 400-2447  
CELL: (760) 419-3728

PROJECT NAME: TL23071 - SYCAMORE CANYON SUBSTATION TO PENASQUITOS - 230 KV UNDERGROUND	
AIRX JOB#: X160218	THOMAS GRID#:
TYPE OF WORK: TRENCHING / CONDUIT	DRAWN FOR: CALTRANS
MISC./POTHOLE#:	

**PHASE 90**

DATE: Mar. 21, 2017
DESIGNED BY: Clint Jones
SHEET 106 OF 148



# APPROVED TRAFFIC CONTROL PERMIT

JUL 12 2017

CITY OF SAN DIEGO  
Development Services  
Engineering Division  
Traffic Safety Section

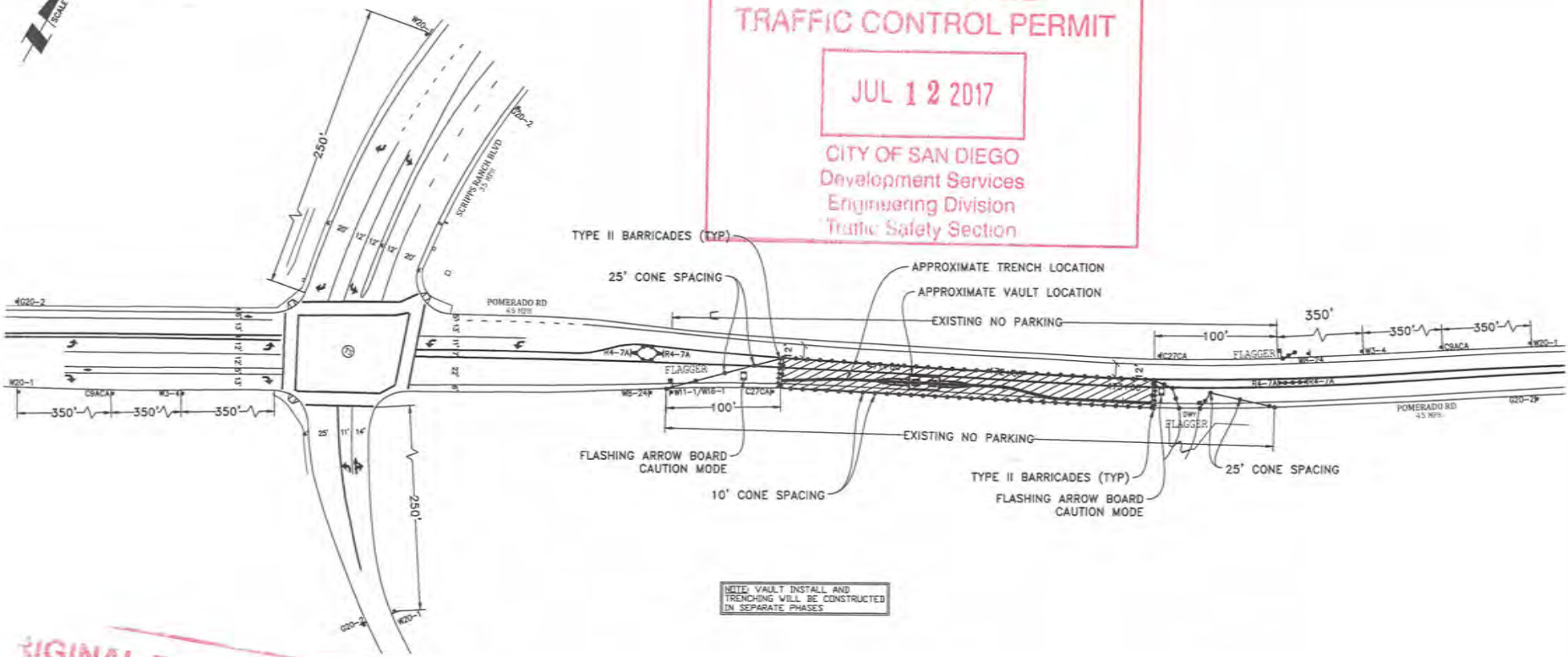

NOTE: VAULT INSTALL AND TRENCHING WILL BE CONSTRUCTED IN SEPARATE PHASES

ORIGINAL PERMIT MUST  
BE KEPT  
JOB SITE ALL TIMES

NOTE: CONTRACTOR WILL COORDINATE ALL WORK WITH FIRE STATION PRIOR TO START OF WORK

NOTE: CONTRACTOR WILL COORDINATE ALL WORK WITH TRANSIT DEPARTMENT 5 DAYS PRIOR TO START OF WORK

NOTE: CONTRACTOR WILL COORDINATE ALL WORK WITH EXISTING PROJECTS AND NOT CONFLICT WITH EXISTING TRAFFIC CONTROL

NOTE: CONTRACTOR WILL COORDINATE ALL WORK WITH RESIDENTS PRIOR TO START OF WORK

NOTE: CONTRACTOR WILL COORDINATE ALL WORK WITH BUSINESSES PRIOR TO START OF WORK

WORK HOURS: \_\_\_\_\_ TO \_\_\_\_\_



**LEGEND**

- SIGN
- TRAFFIC CONES / DELINEATOR
- BARRICADE
- FLAGGER
- FLASHING ARROW SIGN
- WORK ZONE
- BUS STOP

NOTE: FLAGGERS WILL PROVIDE ACCESS TO DRIVEWAYS AT ALL TIMES

NOTE: FLAGGERS WILL SAFELY GUIDE PEDESTRIANS THROUGH WORK AREA

NOTE: CONTRACTOR WILL ALLOW FIRE STATION INGRESS AND EGRESS AT ALL TIMES

NOTE: WB-24 STEEL PLATES AHEAD SIGNS WILL REMAIN IN PLACE FOR DURATION OF WORK

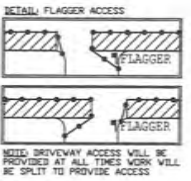

**AIRX** SURVEYORS, INC.  
Gail McMorran  
President  
2504 EAST EL NORTE PARKWAY, SUITE C  
ESCONDIDO, CA 92027  
PHONE: (760) 499-2547  
CELL: (760) 418-3736

PROJECT NAME: TL23071 - SYCAMORE CANYON SUBSTATION TO PENASQUITOS - 230 KV UNDERGROUND	
AIRX JOB#: X160218	THOMAS GRID#:-
TYPE OF WORK: TRENCHING / CONDUIT	DRAWN FOR: CALTRANS
MISC./POTHOLE#:	

PHASE 91

DATE: Mar. 21, 2017
DESIGNED BY: Clint Jones
SHEET 107 OF 148