



Traffic Control Permit (TCP) Multiple Location List

(Franchise Utility Company Only - May Not Be submitted By Contractor)

City Use Only

Authorized # _____

By Felipe Avila

Yes No

Date Reviewed 8/10/17

APPROVED
TRAFFIC CONTROL PERMIT

AUG 10 2017

CITY OF SAN DIEGO
Development Services
Engineering Division
Traffic Safety Section

To: City of San Diego, Traffic Permit Section

Date: 8/10/2017

From: (Company): SDG&E

Phone No.: 619-778-2405

Contact Person: Rod Nelson

Fax.: _____

W.O. or Account #: Permit # _____

TCP No. _____

TYPE OF WORK

- 1 = Lane Closure
- 2 = Street Closure
- 3 = Sidewalk Closure
- 4 = Alley Closure
- 5 = Parking Lane
- 6 = Detour
- 7 = Trenching
- 8 = Flagging

Location	From	To	Start Date *	End Date *	Work Hours **	Thomas Bros.	Type of Work
**Pomerado Road	2200' West of Willow Creek Road/Ave of Nations	Willow Creek Road/Ave of Nations	8/14/17	8/18/17	8:30AM - 3:30PM	1209-G6, H5, J5	1,7,8
Pomerado Road	Willow Creek Road/Ave of Nations	Semillon Blvd	8/14/17	8/18/17	8:30AM - 3:30PM	1209-G6, H5, J5	1,7,8
Willow Creek Road	Pomerado Road	Caminito Covewood	8/14/17	8/18/17	8:30AM - 3:30PM	1209-G6, G5	8
Avenue of Nations	Pomerado Road	End of Street	8/14/17	8/18/17	8:30AM - 3:30PM	1209-G6, G5	8
>>> Place CMS on I-15 (NB and SB): "CONSTRUCTION ON POMERADO RD - EXPECT DELAYS" <<<<							

Vault and Trench Crews - Phases 82-90 and 100 - Daytime work hours (M-F, 8:30AM - 3:30PM)

**Pomerado Road west of Willow Creek Road/Ave of Nations (County ROW hours agreed to 8:30AM - 3:30PM)

>>> Warning signs on approach to flagging operation will be doubled in east bound and west bound directions along Pomerado Road

>>> Flaggers to assist with potential back ups and provide better traffic circulation for all movements at signalized intersections that require flash.

Comments: (Minimum 4 flaggers at intersection)

Must be submitted a minimum of 2 working days prior to start of work. All columns must be filled out for proper authorization

Fax or mail to: City of San Diego • Traffic Control Permit Section • 1222 First Avenue, MS 501 • San Diego, CA 92101. Fax (619) 446-5489 Office (619) 446-5150

* Work Days: Monday Through Friday ** Work Hours : 8:30 AM - 3:30PM. Unless other hours are preapproved)

No Work on Saturdays, Sundays, or Holidays Unless Approved and Noted In Comments

Minimum of 5 working days required for construction work which affects traffic signal e-mail info to: JVaca@sanidiego.gov

**ORIGINAL PERMIT MUST
BE KEPT
ON JOB SITE ALL TIMES**



Traffic Control Permit (TCP) Multiple Location List

(Franchise Utility Company Only - May Not Be submitted By Contractor)

THE CITY OF SAN DIEGO

APPROVED
TRAFFIC CONTROL PERMIT

AUG 10 2017

 CITY OF SAN DIEGO
 Development Services
 Engineering Division
 Traffic Safety Section

To: City of San Diego, Traffic Permit Section

Date: 8/10/2017

From (Company): SDG&E

Phone No.: 619-778-2405

Contact Person: Rod Nelson

Fax.: _____

W.O. or Account #: Permit # _____

TCP No. _____

City Use Only

Authorized # _____

By _____

Yes _____ No _____

Date Reviewed _____

TYPE OF WORK

- 1 = Lane Closure
- 2 = Street Closure
- 3 = Sidewalk Closure
- 4 = Alley Closure
- 5 = Parking Lane
- 6 = Detour
- 7 = Trenching
- 8 = Flagging

Location	From	To	Start Date *	End Date *	Work Hours **	Thomas Bros.	Type of Work
Scripps Ranch Blvd	Pomerado Road	Ironwood Road	8/14/17	8/18/17	8:30AM - 3:30PM	1209-H5	8
Scripps Ranch Row	Pomerado Road	Espinosa Square	8/14/17	8/18/17	8:30AM - 3:30PM	1209-H5	8
Avenida Magnifica	Mesa Madera Dr	Caminito Calor	8/14/17	8/18/17	8:30AM - 3:30PM	1209-J4,J5 1210-A5	8
Fairbrook Road	Pomerado Road	Caminito Magnifico	8/14/17	8/18/17	8:30AM - 3:30PM	1210-A4, B4	8
>>> Place CMS on I-15 (NB and SB): "CONSTRUCTION ON POMERADO RD - EXPECT DELAYS" <<<<							

Vault and Trench Crews - Phases 82-90 and 100 - Daytime work hours (M-F, 8:30AM - 3:30PM)
 **Pomerado Road west of Willow Creek Road/Ave of Nations (County ROW hours agreed to 8:30AM - 3:30PM)

>>> Warning signs on approach to flagging operation will be doubled in east bound and west bound directions along Pomerado Road
 >>> Flaggers to assist with potential back ups and provide better traffic circulation for all movements at signalized intersections that require flash.

Comments: (Minimum 4 flaggers at intersection)

Must be submitted a minimum of 2 working days prior to start of work. All columns must be filled out for proper authorization

Fax or mail to: City of San Diego • Traffic Control Permit Section • 1222 First Avenue, MS 501 • San Diego, CA 92101. Fax (619) 446-5489 Office (619) 446-5150

* Work Days: Monday Through Friday ** Work Hours : 8:30 AM - 3:30PM. Unless other hours are preapproved)

No Work on Saturdays, Sundays, or Holidays Unless Approved and Noted In Comments

Minimum of 5 working days required for construction work which affects traffic signal e-mail info to: JVaca@sanidiego.gov

**ORIGINAL PERMIT MUST
 BE KEPT
 ON JOB SITE ALL TIMES**

SIGN LEGEND

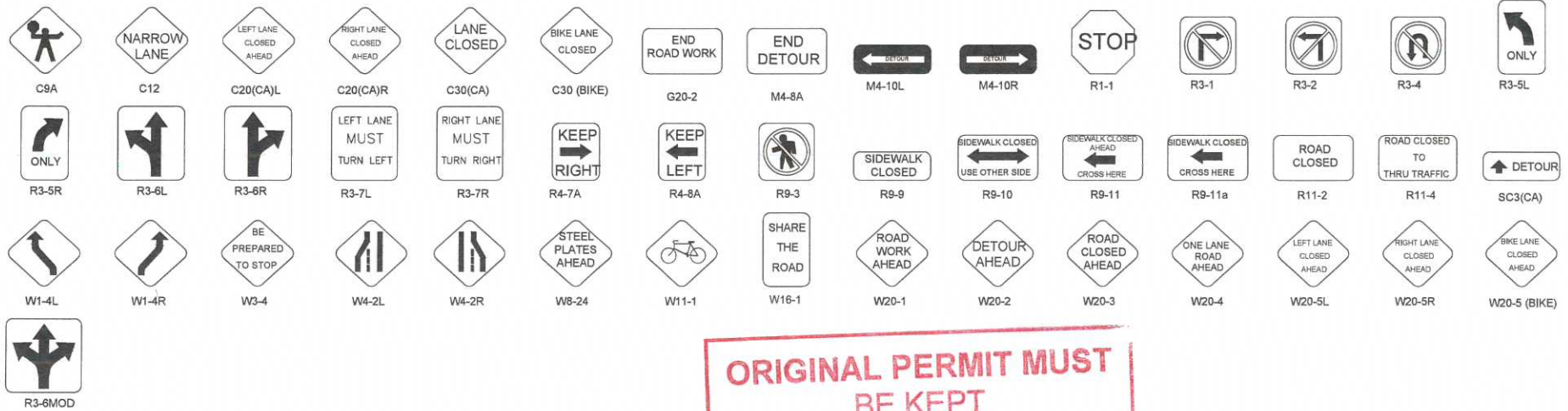

ORIGINAL PERMIT MUST BE KEPT ON JOB SITE ALL TIMES

APPROACH SPEED (MPH)

25
30
35
40
45
50
55+

MINIMUM DISTANCE (FEET) BETWEEN SIGNS AND FROM LAST SIGN TO TAPER

100
250
250
250
500
500
500

MINIMUM TAPER LENGTHS (L) (FEET) FOR 12-FOOT LANE

L	1/2L	1/3L
125	65	45
180	90	60
245	125	85
320	160	110
540	270	180
600	300	200
660	330	220

BUFFER LENGTH (FEET) MAX CONE SPACING

BUFFER LENGTH (FEET)	TAPER	TANGENT	CONFLICT
155	25	50	12
200	30	60	15
250	35	70	17
305	40	80	20
360	45	90	22
425	50	100	25
495	55	110	27

LEGEND

- APPROXIMATE POTHOLE LOCATION
- SIGN
- TRAFFIC CONES / DELINEATOR
- BARRICADE
- FLAGGER
- FLASHING ARROW SIGN
- WORK ZONE
- CONSTRUCTION VEHICLE
- BUS STOP

APPROVED TRAFFIC CONTROL PERMIT

AUG 10 2017
 CITY OF SAN DIEGO
 Development Services
 Engineering Division
 Traffic Safety Section

UTILITY SURVEYORS, INC.



Gail McMorran
President

2534 EAST EL NORTE PARKWAY, SUITE C
ESCONDIDO, CA 92027

PHONE: (760) 480-2347
CELL: (760) 419-3738

PROJECT NAME:

TL23071 - Sycamore Canyon Substation To
Penasquitos Substation - 230 KV Underground

AIRX JOB#: X160218

TYPE OF WORK: TRENCHING / CONDUIT

DRAWN FOR SAN DIEGO COUNTY

MISC/POTHOLE#:

DATE: Mar 2, 2017

DESIGNED BY:
Clint Jones

SHEET 1 OF 4

**ORIGINAL PERMIT MUST
BE KEPT
ON JOB SITE ALL TIMES**

**APPROVED
TRAFFIC CONTROL PERMIT**

AUG 10 2017

**CITY OF SAN DIEGO
Development Services
Engineering Division
Traffic Safety Section**

NOTE: W8-24 (STEEL PLATES AHEAD) SIGNS WILL REMAIN IN PLACE FOR DURATION OF WORK

NOTE: W8-24 (STEEL PLATES AHEAD) SIGNS WILL REMAIN IN PLACE FOR DURATION OF WORK

NOTE: STEEL PLATE BRIDGING SHALL NOT EXCEED 24 HR AND 50 FEET IN LENGTH IN THE WORK ZONE

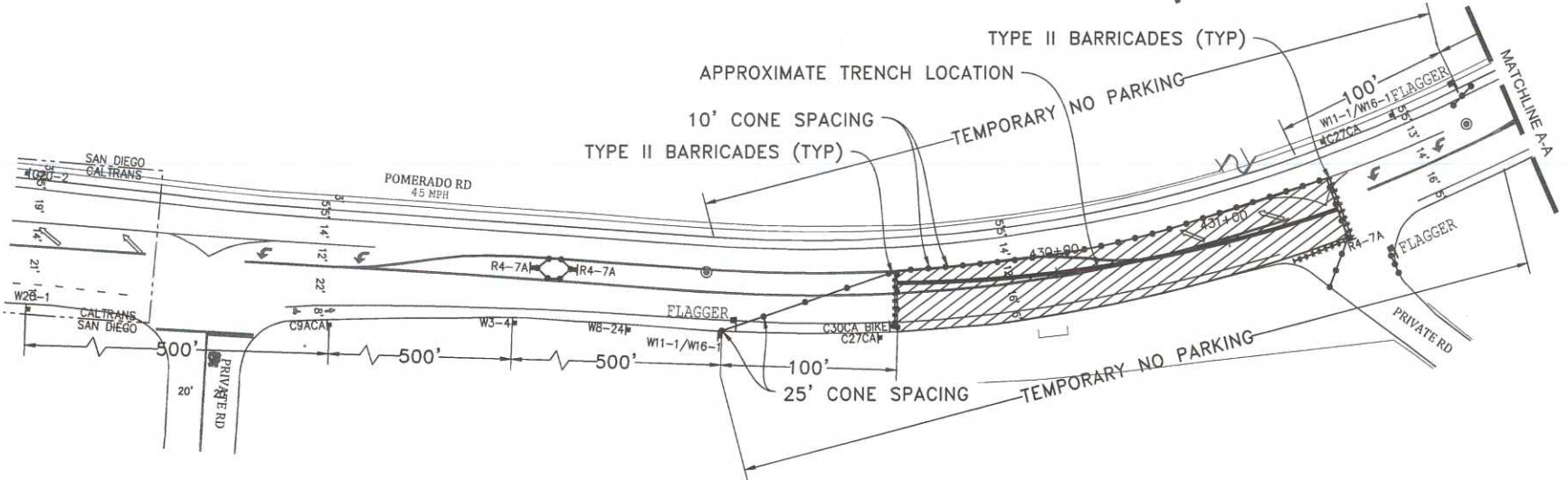
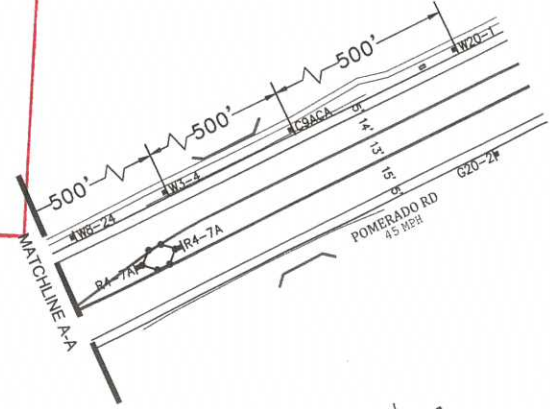

PHASE 01

UTILITY SURVEYORS, INC.

AIRX
 2534 EAST EL NORTE PARKWAY, SUITE C
 ESCONDIDO, CA 92027
 PHONE: (760) 480-2347
 CELL: (760) 419-3738

Gail McMorran
 President

PROJECT NAME: TL23071 - Sycamore Canyon Substation To Penasquitos Substation - 230 KV Underground

AIRX JOB#: X160218

THOMAS GRID#: -

TYPE OF WORK: TRENCHING / CONDUIT

DRAWN FOR: SAN DIEGO COUNTY

MISC/POTHOLE#:

DATE: Mar 2, 2017

DESIGNED BY:
Clint Jones

SHEET 2 OF 4

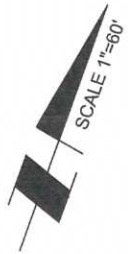

**ORIGINAL PERMIT MUST
BE KEPT
ON JOB SITE ALL TIMES**

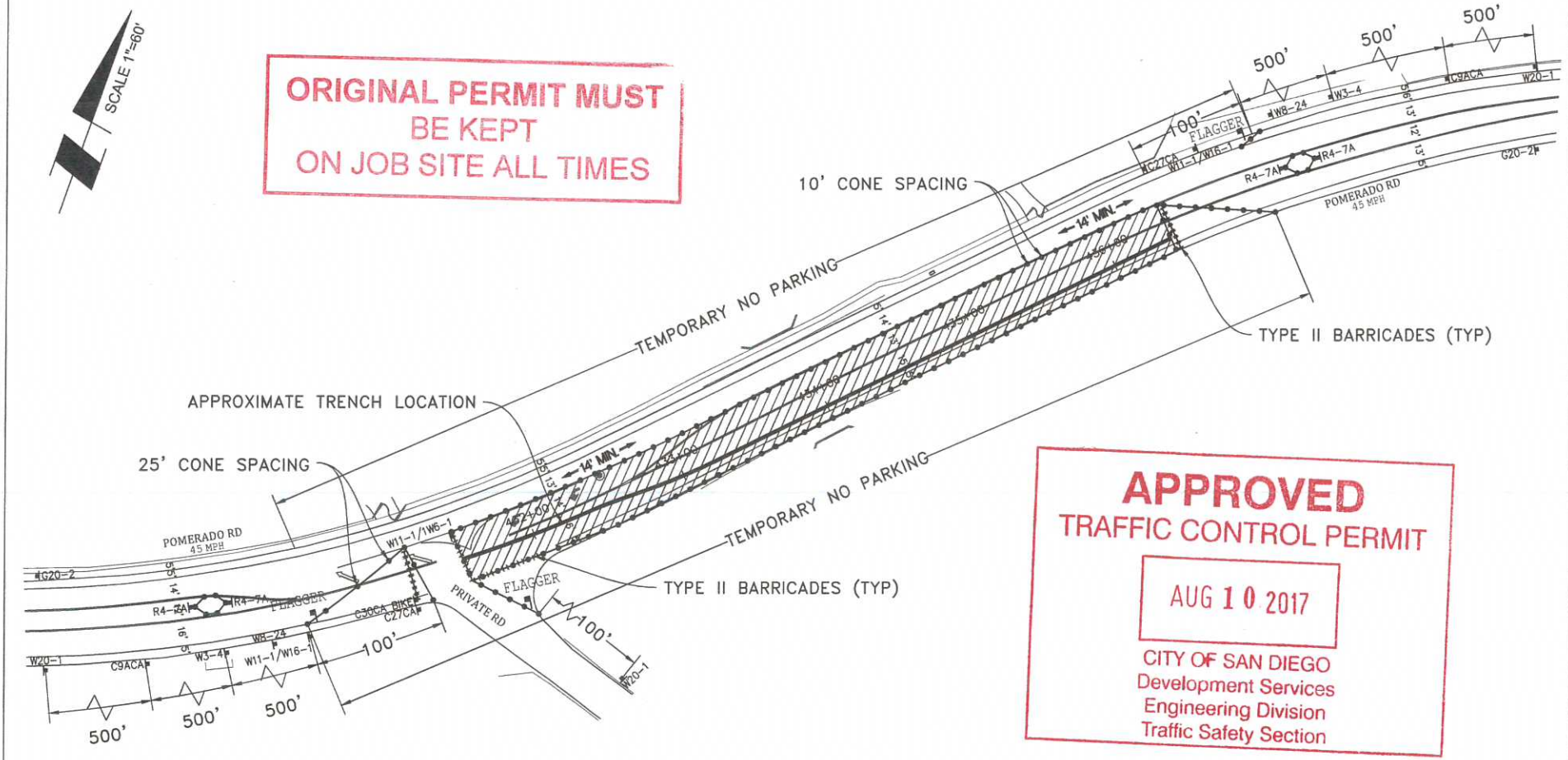

**APPROVED
TRAFFIC CONTROL PERMIT**

AUG 10 2017

CITY OF SAN DIEGO
Development Services
Engineering Division
Traffic Safety Section

PHASE 02

UTILITY SURVEYORS, INC.

Gail McMorran
President

2534 EAST EL NORTE PARKWAY, SUITE C
ESCONDIDO, CA 92027
PHONE: (760) 480-2347
CELL: (760) 419-3738

PROJECT NAME: TL23071 – Sycamore Canyon Substation To Penasquitos Substation – 230 KV Underground	
AIRX JOB#: X160218	THOMAS GRID#: –
TYPE OF WORK: TRENCHING / CONDUIT	DRAWN FOR: SAN DIEGO COUNTY
MISC/POTHOLE#:	

DATE: Mar 2, 2017
DESIGNED BY: Clint Jones
SHEET 3 OF 4



**ORIGINAL PERMIT MUST
BE KEPT
ON JOB SITE ALL TIMES**

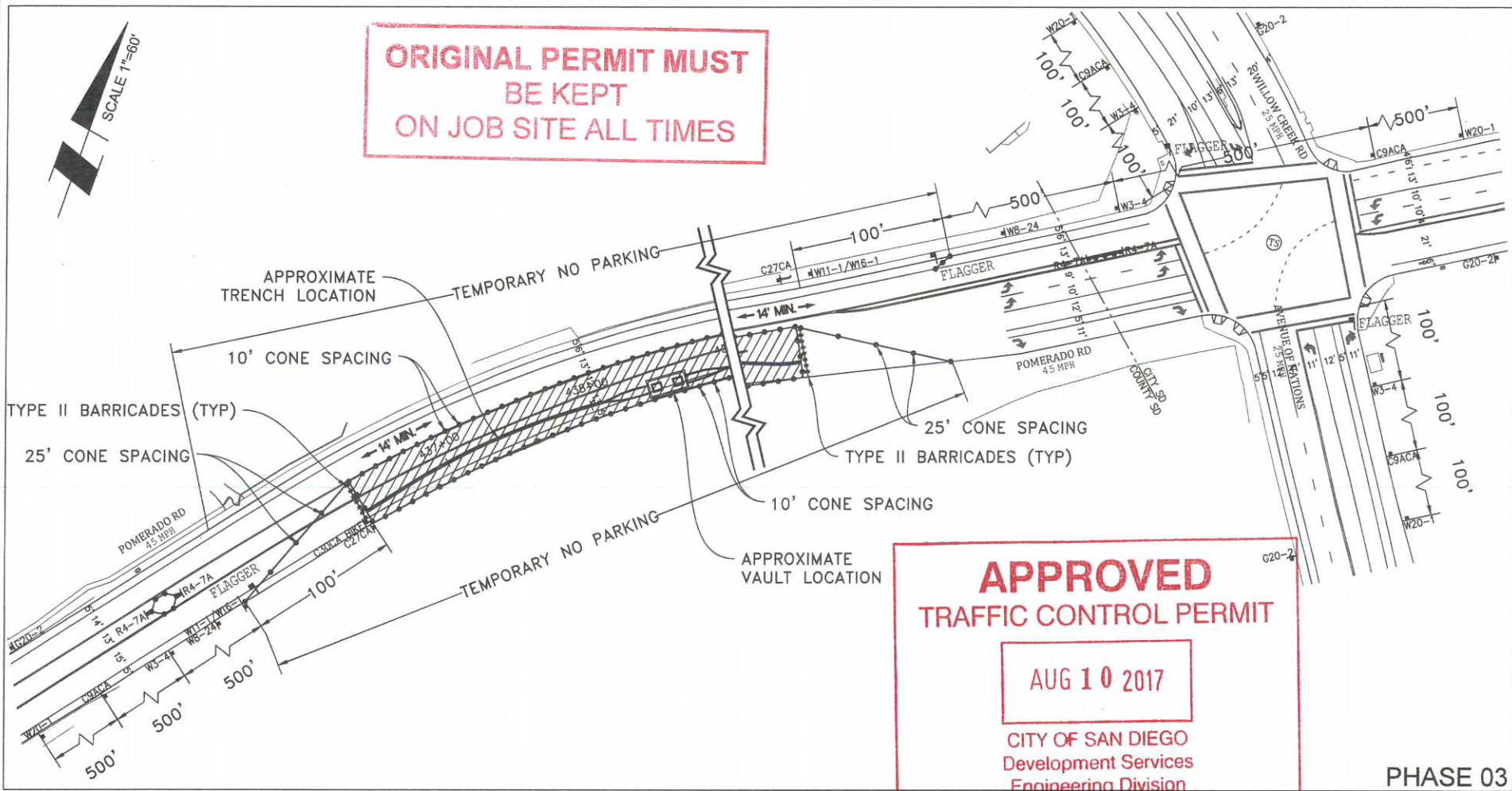

**APPROVED
TRAFFIC CONTROL PERMIT**

AUG 10 2017

CITY OF SAN DIEGO
Development Services
Engineering Division
Traffic Safety Section

PHASE 03

UTILITY SURVEYORS, INC.



Gail McMorran
President

2534 EAST EL NORTE PARKWAY, SUITE C
ESCONDIDO, CA 92027
PHONE: (760) 480-2347
CELL: (760) 419-3738

PROJECT NAME: TL23071 – Sycamore Canyon Substation To Penasquitos Substation – 230 KV Underground	
AIRX JOB#: X160218	THOMAS GRID#: –
TYPE OF WORK: TRENCHING / CONDUIT	DRAWN FOR: SAN DIEGO COUNTY
MISC/POTHOLE#:	

DATE: Mar 2, 2017
DESIGNED BY: Clint Jones
SHEET 4 OF 4

ORIGINAL PERMIT MUST
BE KEPT
ON JOB SITE ALL TIMES

SIGN LEGEND

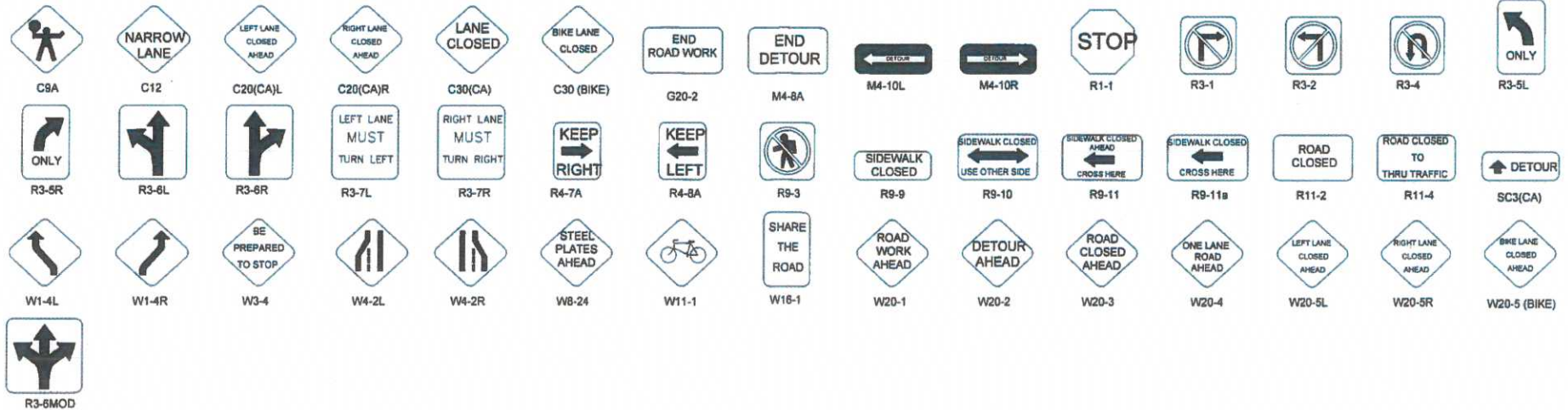

APPROACH SPEED (MPH)	MINIMUM DISTANCE (FEET) BETWEEN SIGNS AND FROM LAST SIGN TO TAPER	MINIMUM TAPER LENGTHS (L) (FEET) FOR 12-FOOT LANE			BUFFER LENGTH (FEET)	MAX CONE SPACING		
		L	1/2L	1/3L		TAPER	TANGENT	CONFLICT
25	100	125	65	45	155	25	50	12
30	250	180	90	60	200	30	60	15
35	250	245	125	85	250	35	70	17
40	250	320	160	110	305	40	80	20
45	350	540	270	180	360	45	90	22
50	350	600	300	200	425	50	100	25
55+	350	660	330	220	495	55	110	27

LEGEND

- APPROXIMATE POTHOLE LOCATION
- SIGN
- TRAFFIC CONES / DELINEATOR
- BARRICADE
- FLAGGER
- FLASHING ARROW SIGN
- WORK ZONE
- CONSTRUCTION VEHICLE
- BUS STOP

APPROVED
TRAFFIC CONTROL PERMIT
AUG 10 2017

UTILITY SURVEYORS, INC.

AIRX
 Gail McMorrان
 President
 2534 EAST EL NORTE PARKWAY, SUITE C
 ESCONDIDO, CA 92027
 PHONE: (760) 480-2347
 CELL: (760) 419-3738

PROJECT NAME: TL23071 - Sycamore Canyon Substation To Penasquitos Substation, 230 KV Underground
AIRX JOB#: X160218
TYPE OF WORK: TRENCHING / CONDUIT
MISC/POTHOLES#:
 SAN DIEGO COUNTY
 Engineering Division
 Traffic Safety Section
 THOMAS GRIDE

DATE: Mar 2, 2017
DESIGNED BY: Clint Jones
SHEET 1 OF 4

**ORIGINAL PERMIT MUST
BE KEPT
ON JOB SITE ALL TIMES**

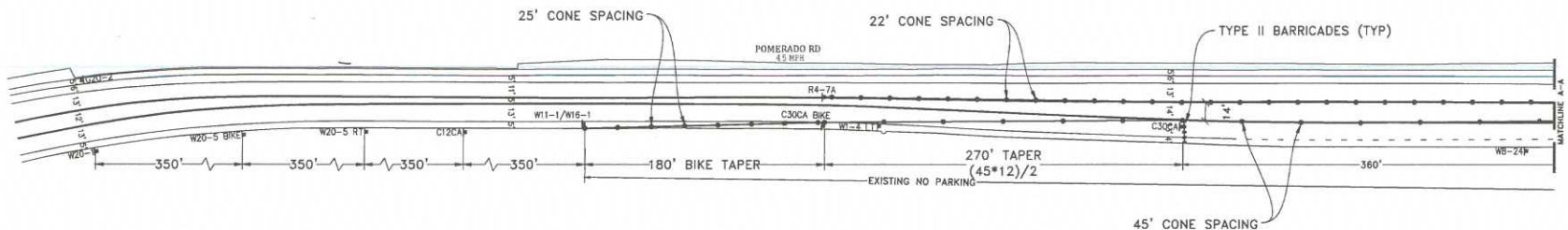
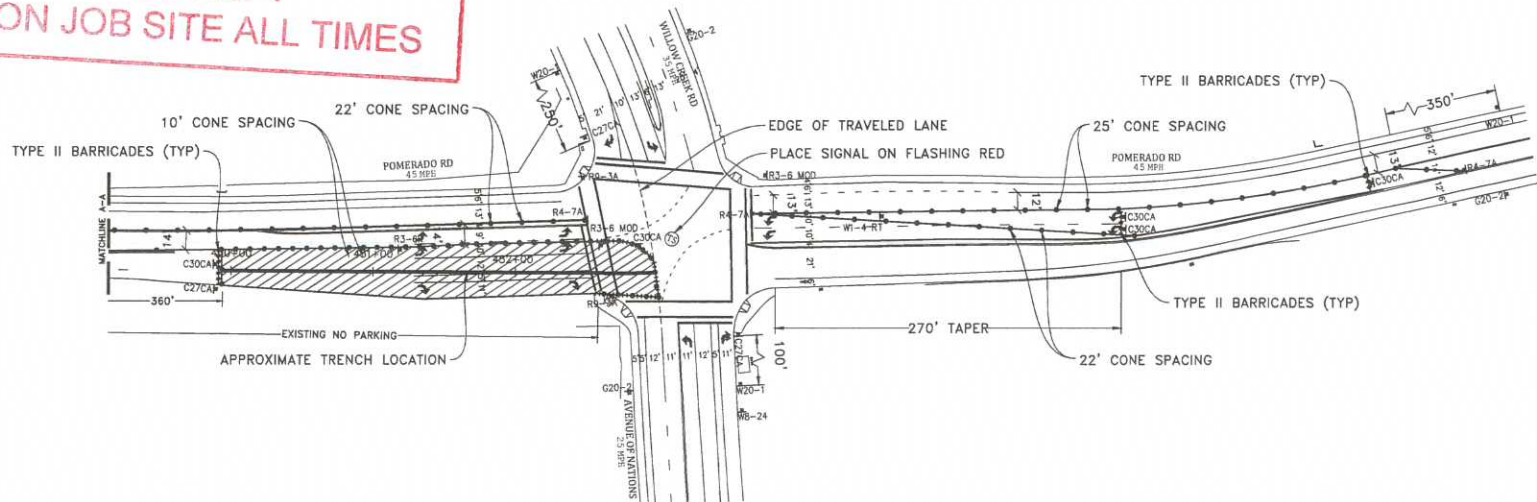

NOTE: CONTRACTOR WILL COORDINATE ALL WORK WITH FIRE STATION PRIOR TO START OF WORK

NOTE: CONTRACTOR WILL COORDINATE ALL WORK WITH TRANSIT DEPARTMENT 5 DAYS PRIOR TO START OF WORK

NOTE: CONTRACTOR WILL COORDINATE ALL WORK WITH EXISTING PROJECTS AND NOT CONFLICT WITH EXISTING TRAFFIC CONTROL





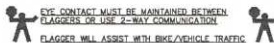

NOTE: CONTRACTOR WILL COORDINATE ALL WORK WITH RESIDENTS PRIOR TO START OF WORK

NOTE: CONTRACTOR WILL COORDINATE ALL WORK WITH BUSINESSES PRIOR TO START OF WORK

WORK HOURS: _____ TO _____



LEGEND

-  SIGN
-  TRAFFIC CONES / DELINEATOR
-  BARRICADE
-  FLAGGER
-  FLASHING ARROW SIGN
-  WORK ZONE
-  BUS STOP

NOTE: FLAGGERS WILL PROVIDE ACCESS TO DRIVEWAYS AT ALL TIMES

NOTE: FLAGGERS WILL SAFELY GUIDE PEDESTRIANS THROUGH WORK AREA

NOTE: CONTRACTOR WILL ALLOW FIRE STATION INGRESS AND EGRESS AT ALL TIMES

NOTE: WB-24 (STEEL PLATES AHEAD) SIGNS WILL REMAIN IN PLACE FOR DURATION OF WORK

DETAIL: FLAGGER ACCESS

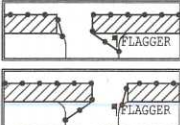

NOTE: DRIVEWAY ACCESS WILL BE PROVIDED AT ALL TIMES WORK WILL BE SPLIT TO PROVIDE ACCESS

**APPROVED
TRAFFIC CONTROL PERMIT**

AUG 10 2017

CITY OF SAN DIEGO
Development Services
Engineering Division
Traffic Safety Section

PHASE 82

UTILITY SURVEYORS, INC.
AIRX
Gail McMoran
President
2534 EAST EL NORTE PARKWAY, SUITE C
ESCONDIDO, CA 92027
PHONE: (760) 480-2347
CELL: (760) 418-3728

PROJECT NAME: TL23071 - SYCAMORE CANYON SUBSTATION TO PENASQUITOS 115.250 KV UNDERGROUND	THOMAS GRID#:
AIRX JOB#X160218	
TYPE OF WORK: TRENCHING / CONDUIT	DRAWN FOR: CALTRANS
MISC./POTHOLES#:	

DATE: Mar. 21, 2017
DESIGNED BY: Clint Jones
SHEET 098 OF 148

**ORIGINAL PERMIT MUST
BE KEPT
ON JOB SITE ALL TIMES**

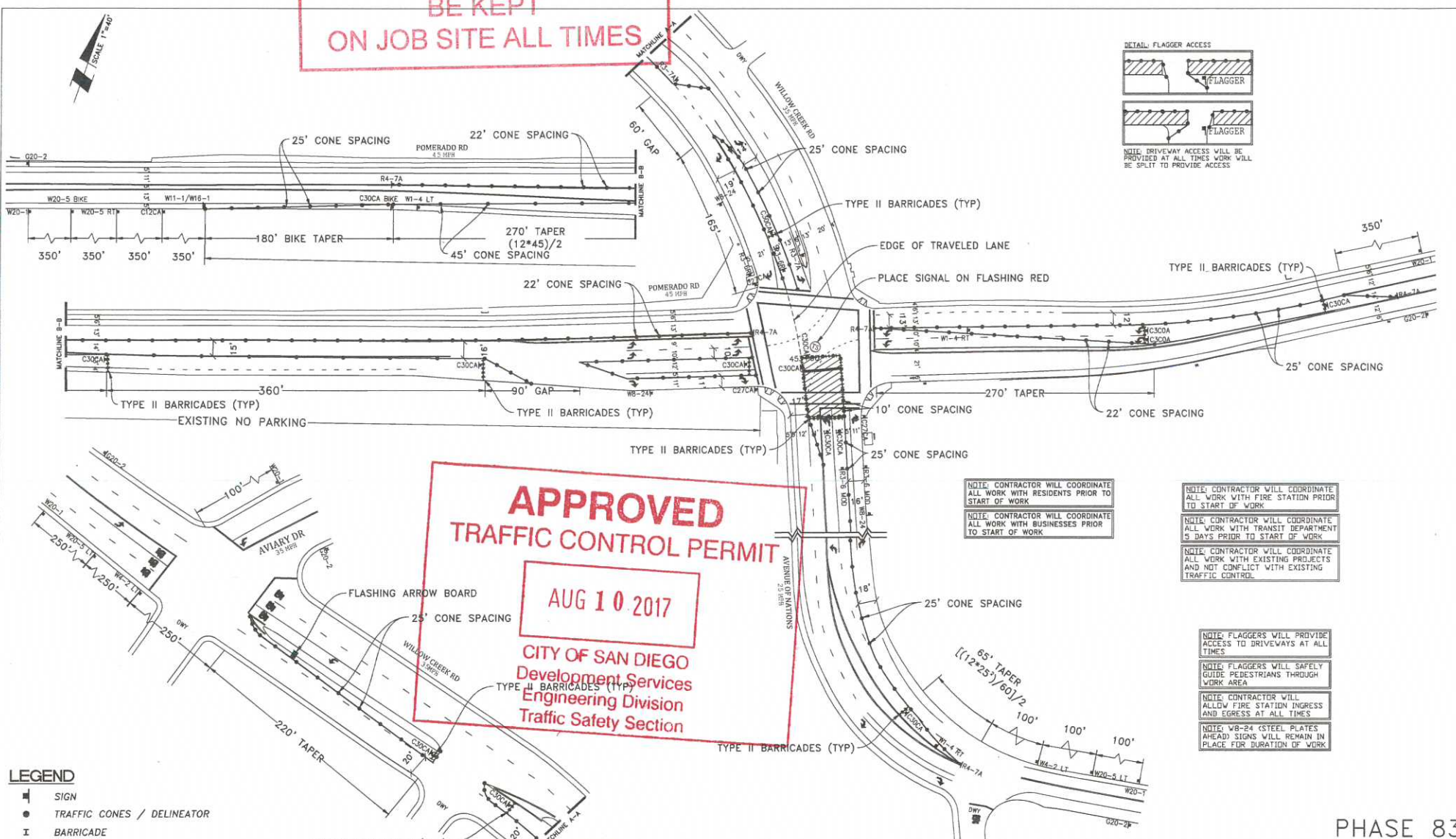
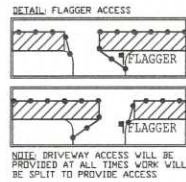

**APPROVED
TRAFFIC CONTROL PERMIT**

AUG 10 2017

**CITY OF SAN DIEGO
Development Services
Engineering Division
Traffic Safety Section**

NOTE: CONTRACTOR WILL COORDINATE ALL WORK WITH RESIDENTS PRIOR TO START OF WORK

NOTE: CONTRACTOR WILL COORDINATE ALL WORK WITH BUSINESSES PRIOR TO START OF WORK

NOTE: CONTRACTOR WILL COORDINATE ALL WORK WITH FIRE STATION PRIOR TO START OF WORK

NOTE: CONTRACTOR WILL COORDINATE ALL WORK WITH TRANSIT DEPARTMENT 5 DAYS PRIOR TO START OF WORK

NOTE: CONTRACTOR WILL COORDINATE ALL WORK WITH EXISTING PROJECTS AND NOT CONFLICT WITH EXISTING TRAFFIC CONTROL

NOTE: FLAGGERS WILL PROVIDE ACCESS TO DRIVEWAYS AT ALL TIMES

NOTE: FLAGGERS WILL SAFELY GUIDE PEDESTRIANS THROUGH WORK AREA

NOTE: CONTRACTOR WILL ALLOW FIRE STATION INGRESS AND EGRESS AT ALL TIMES

NOTE: W8-24 STEEL PLATES AHEAD SIGNS WILL REMAIN IN PLACE FOR DURATION OF WORK

- LEGEND**
- SIGN
 - TRAFFIC CONES / DELINEATOR
 - BARRICADE
 - FLAGGER
 - FLASHING ARROW SIGN
 - WORK ZONE
 - BUS STOP

WORK HOURS: TO

NOTE: CONTACT MUST BE MAINTAINED BETWEEN FLAGGERS ON USE 4-WAY COMMUNICATION

FLAGGER WILL ASSIST WITH BIKE/VEHICLE TRAFFIC

UTILITY SURVEYORS, INC.

AIRX

Gail McMorrin
President

2904 EAST EL NORTE PARKWAY, SUITE C
ESCONDIDO, CA 92027
PHONE: (760) 450-2347
CELL: (760) 419-3758

PROJECT NAME: TL23071 - SYCAMORE CANYON SUBSTATION TO PENASQUITOS - 230 KV UNDERGROUND	
AIRX JOB#X160218	THOMAS GRID#-
TYPE OF WORK#RENCHING / CONDUIT	DRAWN FOR: CALTRANS
MISC./POTHOLES#:	

PHASE 83

DATE: Apr. 6, 2017
DESIGNED BY: Clint Jones
SHEET 099 OF 148

**ORIGINAL PERMIT MUST
BE KEPT
ON JOB SITE ALL TIMES**

**APPROVED
TRAFFIC CONTROL PERMIT**

AUG 10 2017

CITY OF SAN DIEGO
Development Services
Engineering Division
Traffic Safety Section

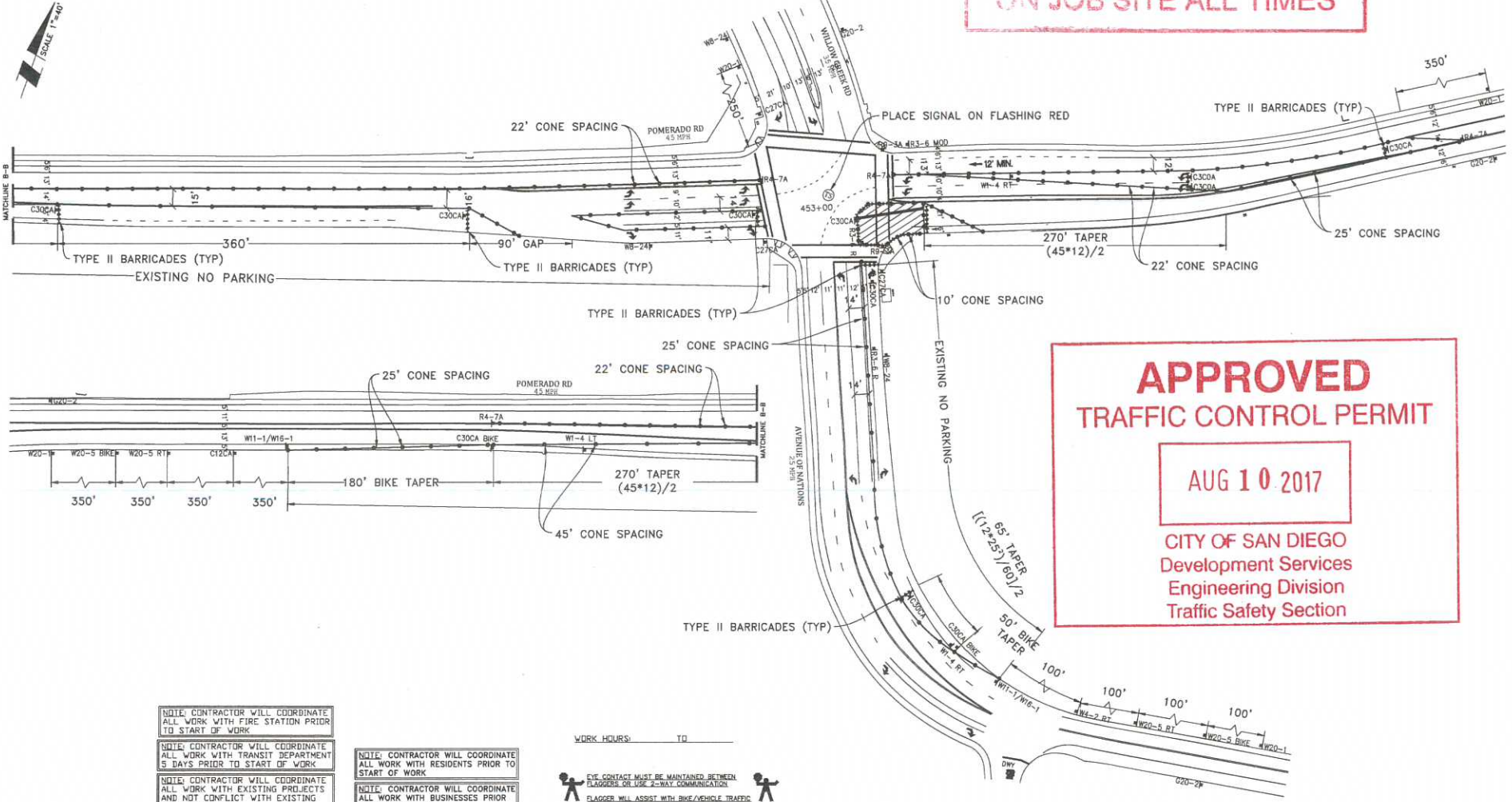

NOTE: CONTRACTOR WILL COORDINATE ALL WORK WITH FIRE STATION PRIOR TO START OF WORK

NOTE: CONTRACTOR WILL COORDINATE ALL WORK WITH TRANSIT DEPARTMENT 5 DAYS PRIOR TO START OF WORK

NOTE: CONTRACTOR WILL COORDINATE ALL WORK WITH EXISTING PROJECTS AND NOT CONFLICT WITH EXISTING TRAFFIC CONTROL

NOTE: CONTRACTOR WILL COORDINATE ALL WORK WITH RESIDENTS PRIOR TO START OF WORK

NOTE: CONTRACTOR WILL COORDINATE ALL WORK WITH BUSINESSES PRIOR TO START OF WORK

WORK HOURS: _____ TO _____

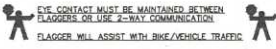

LEGEND

- SIGN
- TRAFFIC CONES / DELINEATOR
- BARRICADE
- FLAGGER
- FLASHING ARROW SIGN
- WORK ZONE
- BUS STOP

NOTE: FLAGGERS WILL PROVIDE ACCESS TO DRIVEWAYS AT ALL TIMES

NOTE: FLAGGERS WILL SAFELY GUIDE PEDESTRIANS THROUGH WORK AREA

NOTE: CONTRACTOR WILL ALLOW FIRE STATION INGRESS AND EGRESS AT ALL TIMES

NOTE: W8-24 (STEEL PLATES AHEAD) SIGNS WILL REMAIN IN PLACE FOR DURATION OF WORK



UTILITY SURVEYORS, INC.

AIRX

Gail McMorran
President

2534 EAST EL NORTE PARKWAY, SUITE C
ESCONDIDO, CA 92027
PHONE: (760) 489-2347
CELL: (760) 419-3728

PROJECT NAME: TL23071 - SYCAMORE CANYON SUBSTATION TO PENASQUITOS - 230 KV UNDERGROUND	
AIRX JOB#X160218	THOMAS GRID#:
TYPE OF WORK: FRENCHING / CONDUIT	DRAWN FOR: CALTRANS
MISC./POTHOLE#:	

PHASE 84

DATE: Mar. 21, 2017
DESIGNED BY: Clint Jones
SHEET 100 OF 148

**ORIGINAL PERMIT MUST
BE KEPT
ON JOB SITE ALL TIMES**

APPROVED
TRAFFIC CONTROL PERMIT

AUG 10 2017

CITY OF SAN DIEGO
Development Services
Engineering Division
Traffic Safety Section

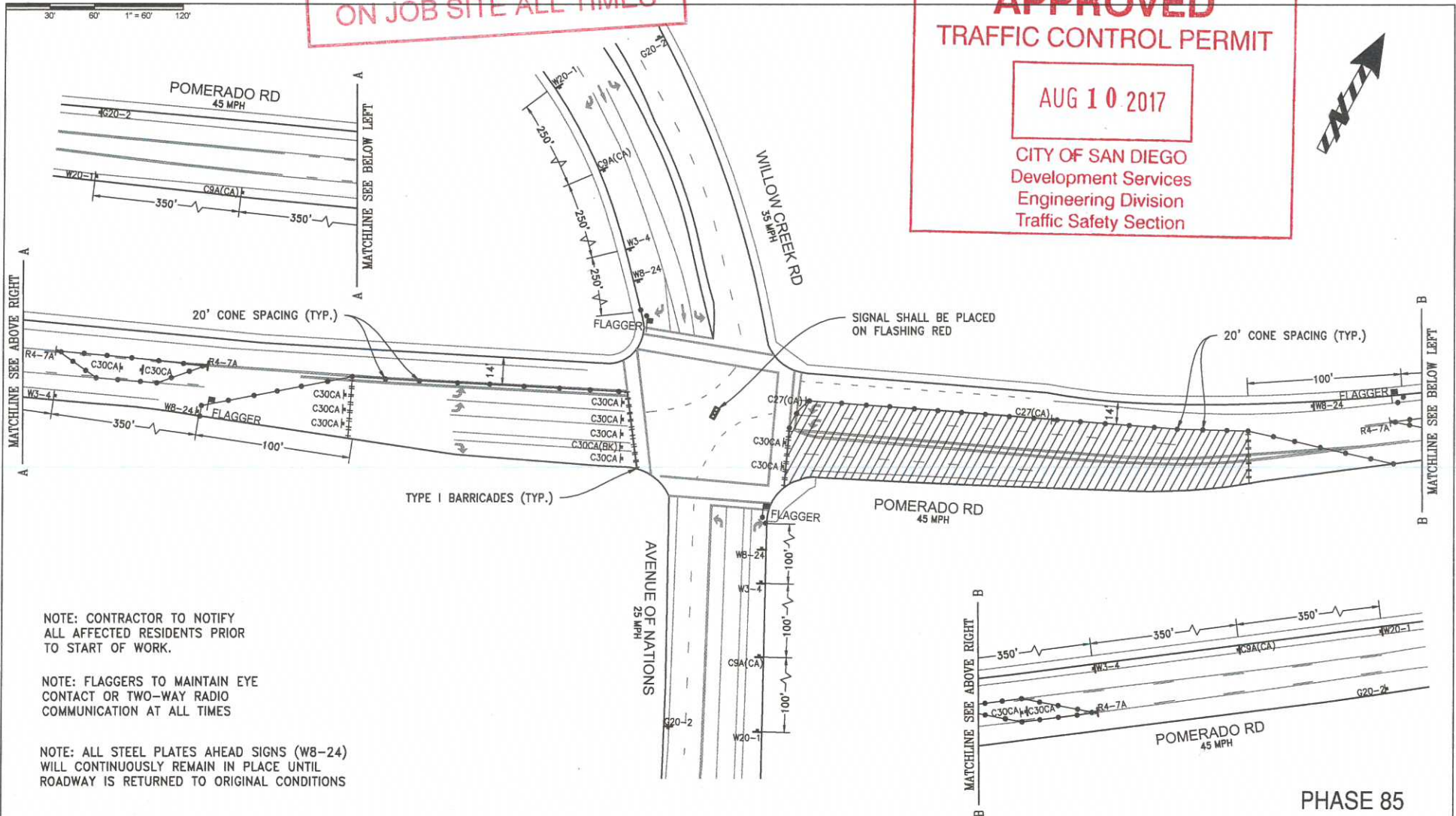

NOTE: CONTRACTOR TO NOTIFY ALL AFFECTED RESIDENTS PRIOR TO START OF WORK.

NOTE: FLAGGERS TO MAINTAIN EYE CONTACT OR TWO-WAY RADIO COMMUNICATION AT ALL TIMES

NOTE: ALL STEEL PLATES AHEAD SIGNS (W8-24) WILL CONTINUOUSLY REMAIN IN PLACE UNTIL ROADWAY IS RETURNED TO ORIGINAL CONDITIONS

PHASE 85

 <p>TRAFFIC CONTROL, INC. LIC# 818076</p>	<p>1221 S. 26TH ST SAN DIEGO, CA 92113 OFFICE: (858) 259-0300 FAX: (858) 259-0357</p>	<p>POSTED SPEED LIMIT (MPH) SEE PLAN</p> <p>SIGN SPACING (FEET) SEE PLAN</p> <p>TAPER LENGTH (FEET) SEE PLAN</p> <p>CONE SPACING (FEET) SEE PLAN</p>	<p>MIGUEL URESTI</p> <p>DRAWN BY:</p> <p>PROJECT NUMBER:</p> <p>DATE: July 6, 2017</p>	<p>SXPQ EAST SIDE POMERADO</p> <p>PROJECT INFORMATION</p> <p>ARB</p> <p>COMPANY</p> <p>ROD NELSON</p> <p>PROJECT CONTACT</p> <p>619.295.2754</p> <p>PHONE</p>	<p>TRAFFIC CONTROL PLANS</p> <p>CITY OF SAN DIEGO</p> <p>SHEET 101 OF 148</p>
--	---	--	--	---	---

APPROVED TRAFFIC CONTROL PERMIT

AUG 10 2017

CITY OF SAN DIEGO
Development Services
Engineering Division
Traffic Safety Section

ORIGINAL PERMIT MUST
BE KEPT
ON JOB SITE ALL TIMES

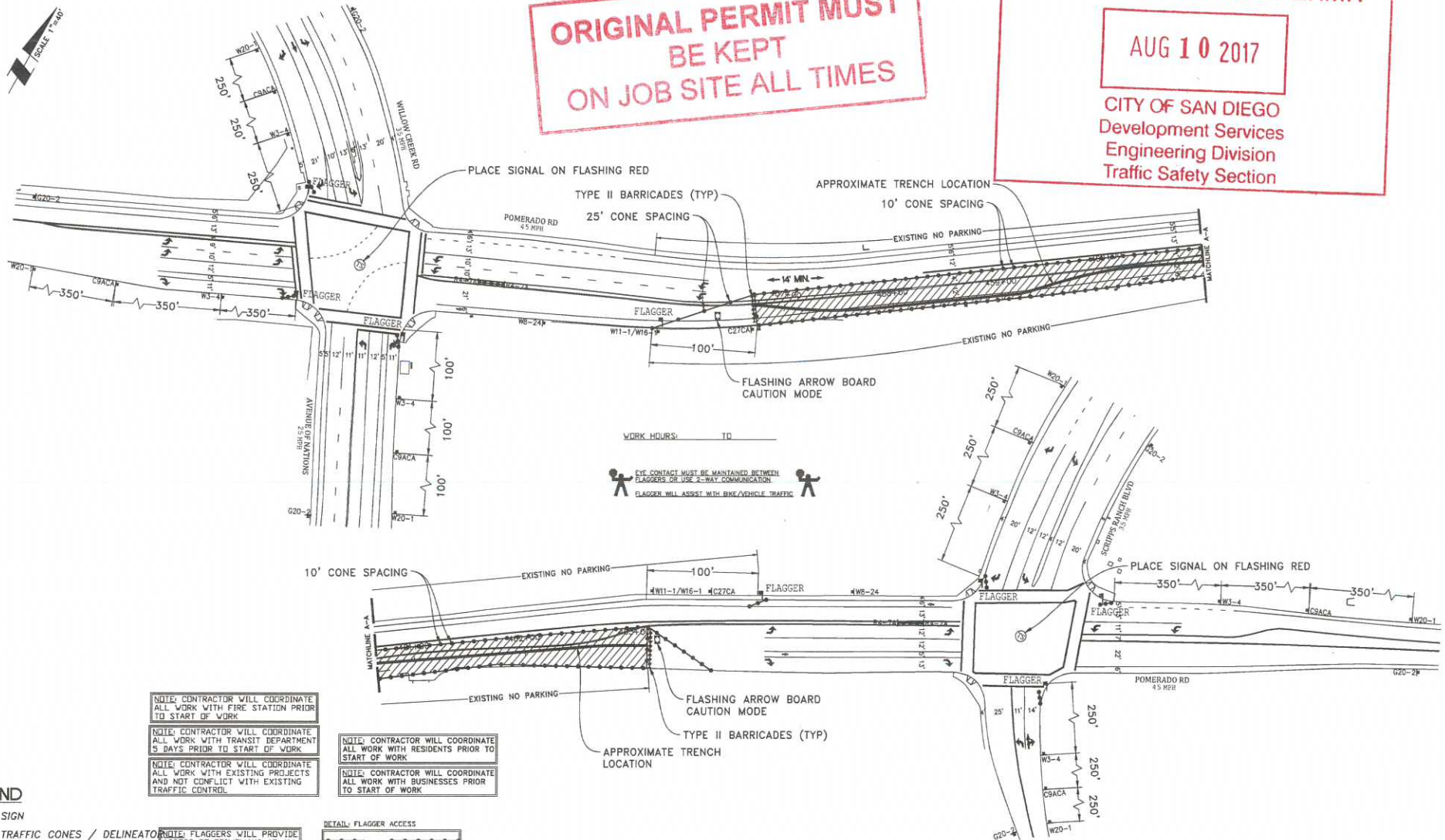

NOTE: CONTRACTOR WILL COORDINATE ALL WORK WITH FIRE STATION PRIOR TO START OF WORK

NOTE: CONTRACTOR WILL COORDINATE ALL WORK WITH TRANSIT DEPARTMENT 5 DAYS PRIOR TO START OF WORK

NOTE: CONTRACTOR WILL COORDINATE ALL WORK WITH EXISTING PROJECTS AND NOT CONFLICT WITH EXISTING TRAFFIC CONTROL

NOTE: CONTRACTOR WILL COORDINATE ALL WORK WITH RESIDENTS PRIOR TO START OF WORK

NOTE: CONTRACTOR WILL COORDINATE ALL WORK WITH BUSINESSES PRIOR TO START OF WORK

NOTE: FLAGGERS WILL PROVIDE ACCESS TO DRIVEWAYS AT ALL TIMES

NOTE: FLAGGERS WILL SAFELY GUIDE PEDESTRIANS THROUGH WORK AREA

NOTE: CONTRACTOR WILL ALLOW FIRE STATION INGRESS AND EGRESS AT ALL TIMES

NOTE: WB-24 (STEEL PLATES AHEAD) SIGNS WILL REMAIN IN PLACE FOR DURATION OF WORK

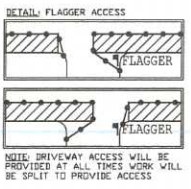

LEGEND

- SIGN
- TRAFFIC CONES / DELINEATOR
- BARRICADE
- FLAGGER
- FLASHING ARROW SIGN
- WORK ZONE
- BUS STOP

UTILITY SURVEYORS, INC.
AIRX
Gail McMorran
President
2534 EAST EL NORTE PARKWAY, SUITE C
ESCONDIDO, CA 92027
PHONE: (760) 450-2347
CELL: (760) 418-3738

PROJECT NAME: TL23071 - SYCAMORE CANYON SUBSTATION TO PENASQUITOS - 230 KV UNDERGROUND	
AIRX JOB# X160218	THOMAS GRID#:
TYPE OF WORK: TRENCHING / CONDUIT	DRAWN FOR: CALTRANS
MISC./POTHOLES#:	

DATE: Mar. 21, 2017
DESIGNED BY:
Clint Jones

SHEET 102 OF 148

PHASE 86

**ORIGINAL PERMIT MUST
BE KEPT
ON JOB SITE ALL TIMES**

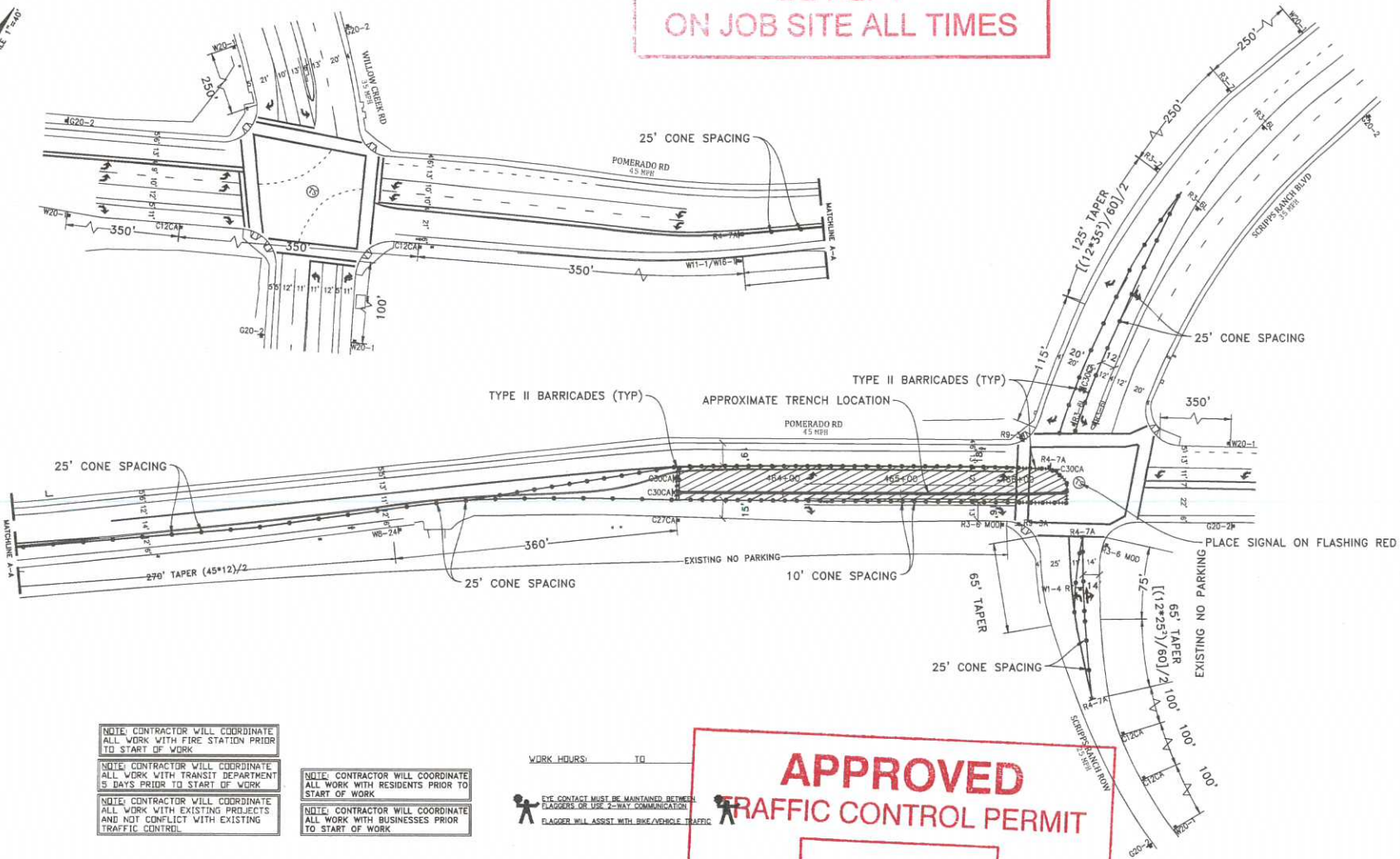

NOTE: CONTRACTOR WILL COORDINATE ALL WORK WITH FIRE STATION PRIOR TO START OF WORK

NOTE: CONTRACTOR WILL COORDINATE ALL WORK WITH TRANSIT DEPARTMENT 5 DAYS PRIOR TO START OF WORK

NOTE: CONTRACTOR WILL COORDINATE ALL WORK WITH EXISTING PROJECTS AND NOT CONFLICT WITH EXISTING TRAFFIC CONTROL.

NOTE: CONTRACTOR WILL COORDINATE ALL WORK WITH RESIDENTS PRIOR TO START OF WORK

NOTE: CONTRACTOR WILL COORDINATE ALL WORK WITH BUSINESSES PRIOR TO START OF WORK

WORK HOURS: _____ TO _____

NOTE: EYE CONTACT MUST BE MAINTAINED BETWEEN FLAGGERS OR USE 2-WAY COMMUNICATION

FLAGGER WILL ASSIST WITH BIKE/VEHICLE TRAFFIC

- LEGEND**
- SIGN
 - TRAFFIC CONES / DELINEATOR
 - BARRICADE
 - FLAGGER
 - FLASHING ARROW SIGN
 - WORK ZONE
 - BUS STOP

NOTE: FLAGGERS WILL PROVIDE ACCESS TO DRIVEWAYS AT ALL TIMES

NOTE: FLAGGERS WILL SAFELY GUIDE PEDESTRIANS THROUGH WORK AREA

NOTE: CONTRACTOR WILL ALLOW FIRE STATION INGRESS AND EGRESS AT ALL TIMES

NOTE: WB-24 (STEEL PLATES) AHEAD SIGNS WILL REMAIN IN PLACE FOR DURATION OF WORK

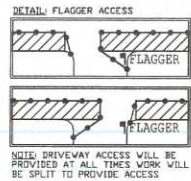

**APPROVED
TRAFFIC CONTROL PERMIT**

AUG 10 2017

CITY OF SAN DIEGO
Development Services
Engineering Division
Traffic Safety Section

UTILITY SURVEYORS, INC.
AIRX
2534 EAST EL NORTE PARKWAY, SUITE C
ESCONDIDO, CA 92027
PHONE: (760) 486-2347
CELL: (760) 419-3738

Gail McMorrán
President

PROJECT NAME: TL2307 - SYCAMORE CANYON SUBSTATION TO
JENASQUITOS - 230 KV UNDERGROUND

PROJECT NUMBER: 160018

TYPE OF WORK: TRENCHING / CONDUIT

DATE: 08/09/17

THOMAS GRID#:-

DRAWN FOR: CALTRANS

PHASE 87

DATE: Mar. 21, 2017
DESIGNED BY: Clint Jones
SHEET 103 OF 148

APPROVED TRAFFIC CONTROL PERMIT

AUG 10 2017

CITY OF SAN DIEGO
Development Services
Engineering Division
Traffic Safety Section

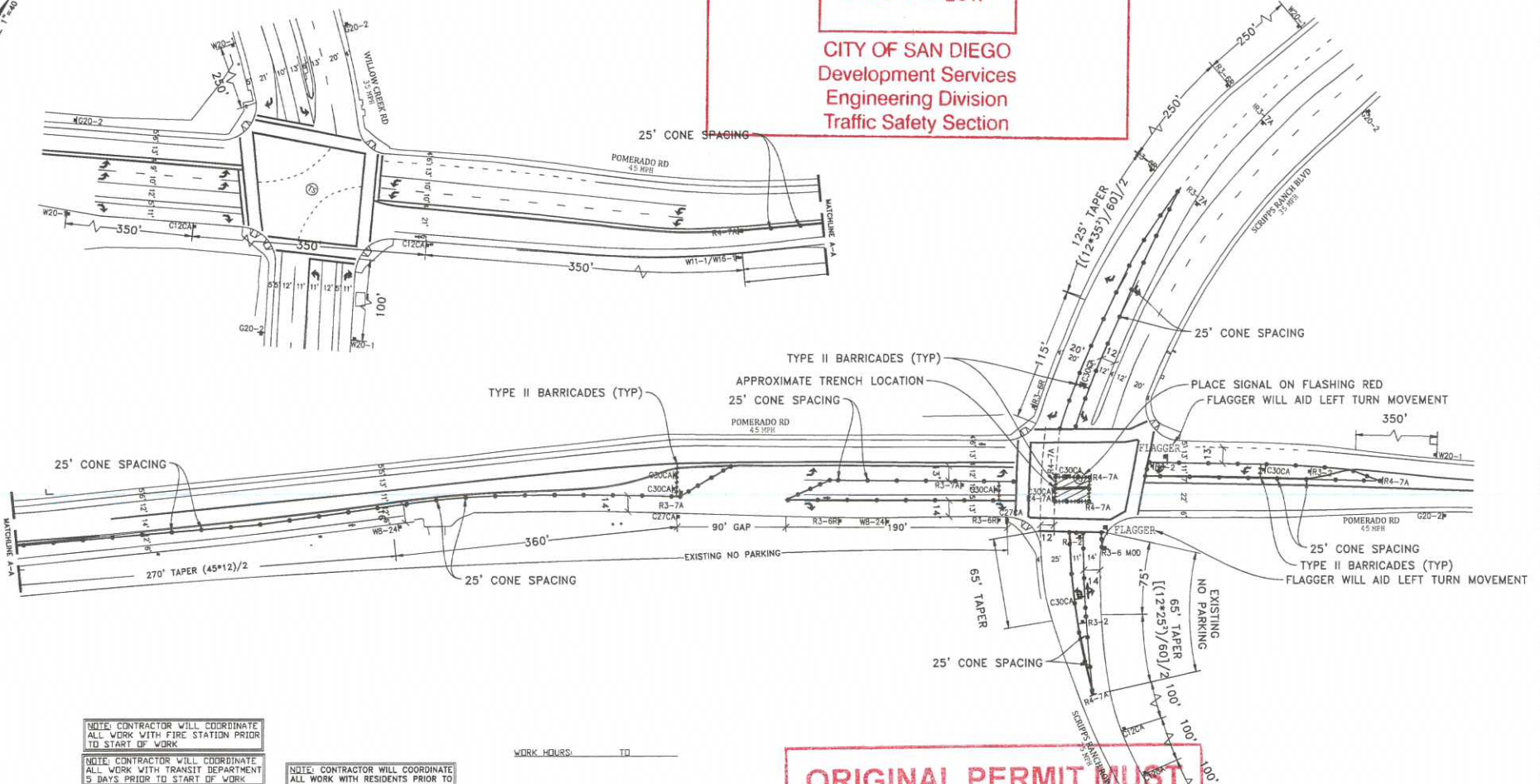

NOTE: CONTRACTOR WILL COORDINATE ALL WORK WITH FIRE STATION PRIOR TO START OF WORK

NOTE: CONTRACTOR WILL COORDINATE ALL WORK WITH TRANSIT DEPARTMENT 5 DAYS PRIOR TO START OF WORK

NOTE: CONTRACTOR WILL COORDINATE ALL WORK WITH EXISTING PROJECTS AND NOT CONFLICT WITH EXISTING TRAFFIC CONTROL.

NOTE: CONTRACTOR WILL COORDINATE ALL WORK WITH RESIDENTS PRIOR TO START OF WORK

NOTE: CONTRACTOR WILL COORDINATE ALL WORK WITH BUSINESSES PRIOR TO START OF WORK

WORK HOURS: _____ TO _____

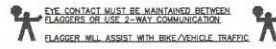

**ORIGINAL PERMIT MUST
BE KEPT
ON JOB SITE ALL TIMES**

LEGEND

-  SIGN
-  TRAFFIC CONES / DELINEATOR
-  BARRICADE
-  FLAGGER
-  FLASHING ARROW SIGN
-  WORK ZONE
-  BUS STOP

NOTE: FLAGGERS WILL PROVIDE ACCESS TO DRIVEWAYS AT ALL TIMES

NOTE: FLAGGERS WILL SAFELY GUIDE PEDESTRIANS THROUGH WORK AREA

NOTE: CONTRACTOR WILL ALLOW FIRE STATION INGRESS AND EGRESS AT ALL TIMES

NOTE: WB-24 (STEEL PLATES AHEAD) SIGNS WILL REMAIN IN PLACE FOR DURATION OF WORK

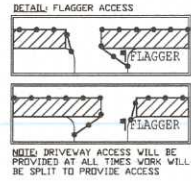

UTILITY SURVEYORS, INC.
AIRX
Gail McMoran
President
2534 EAST EL NORTE PARKWAY, SUITE C
ESCONDIDO, CA 92027
PHONE: (760) 480-2347
CELL: (760) 419-3728

PROJECT NAME: TL23071 - SYCAMORE CANYON SUBSTATION TO PENASQUITOS - 230 KV UNDERGROUND	
AIRX JOB# X160218	THOMAS GRID#:
TYPE OF WORK: TRENCHING / CONDUIT	DRAWN FOR: CALTRANS
MISC/POTHOLE#:	

DATE: Mar. 21, 2017
DESIGNED BY: Clint Jones
SHEET 104 OF 148

APPROVED TRAFFIC CONTROL PERMIT

AUG 10 2017

CITY OF SAN DIEGO
Development Services
Engineering Division
Traffic Safety Section

**ORIGINAL PERMIT MUST
BE KEPT
ON JOB SITE ALL TIMES**

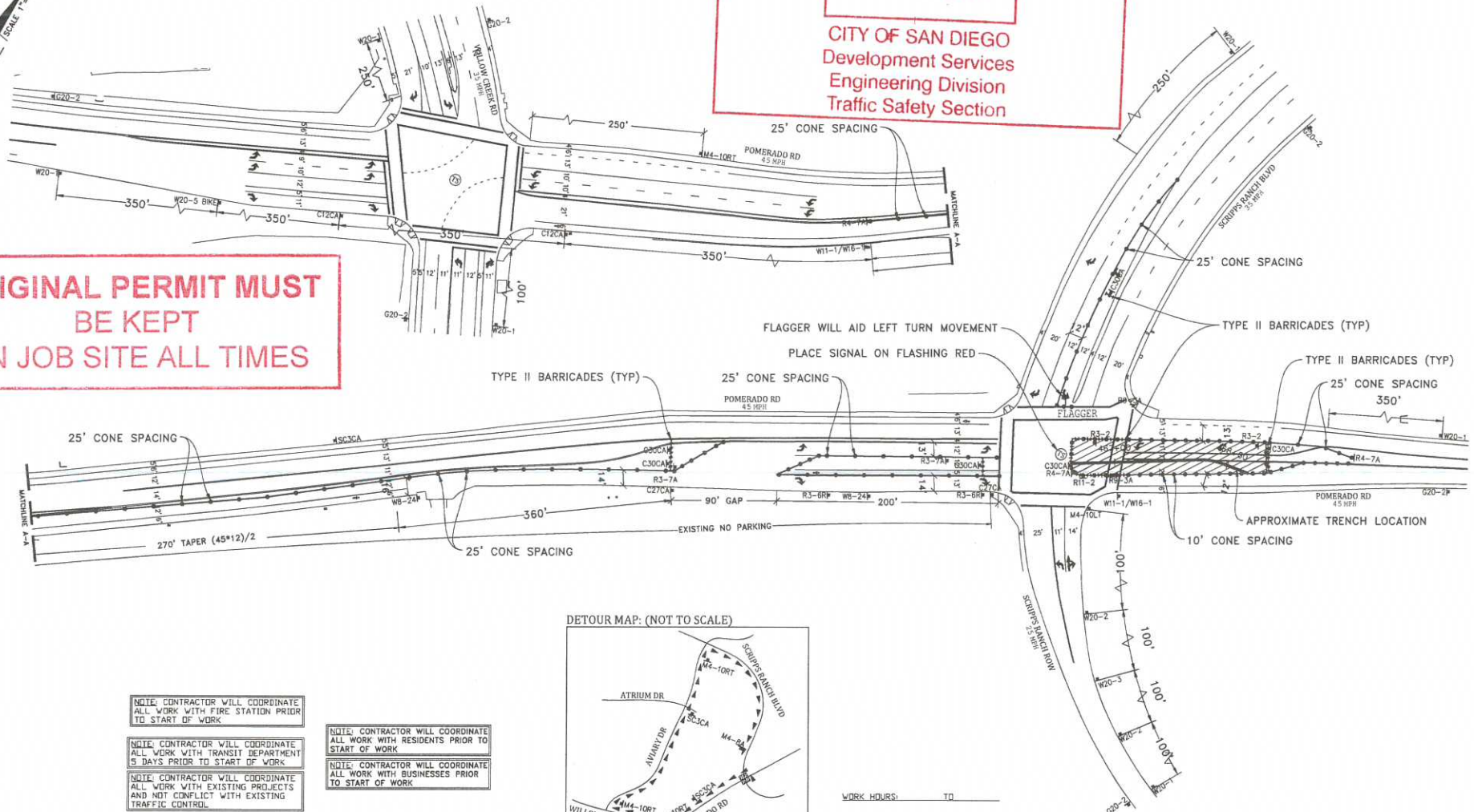

DETOUR MAP: (NOT TO SCALE)

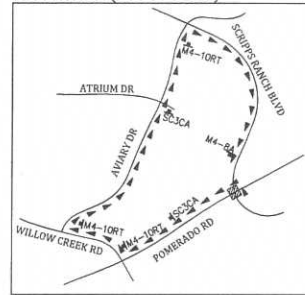

WORK HOURS: _____ TO _____

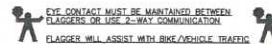

NOTE: CONTRACTOR WILL COORDINATE ALL WORK WITH FIRE STATION PRIOR TO START OF WORK

NOTE: CONTRACTOR WILL COORDINATE ALL WORK WITH TRANSIT DEPARTMENT 5 DAYS PRIOR TO START OF WORK

NOTE: CONTRACTOR WILL COORDINATE ALL WORK WITH EXISTING PROJECTS AND NOT CONFLICT WITH EXISTING TRAFFIC CONTROL

NOTE: FLAGGERS WILL PROVIDE ACCESS TO DRIVEWAYS AT ALL TIMES

NOTE: FLAGGERS WILL SAFELY GUIDE PEDESTRIANS THROUGH WORK AREA

NOTE: CONTRACTOR WILL ALLOW FIRE STATION INGRESS AND EGRESS AT ALL TIMES

NOTE: WB-24 (STEEL PLATES) AHEAD SIGNS WILL REMAIN IN PLACE FOR DURATION OF WORK

NOTE: CONTRACTOR WILL COORDINATE ALL WORK WITH RESIDENTS PRIOR TO START OF WORK

NOTE: CONTRACTOR WILL COORDINATE ALL WORK WITH BUSINESSES PRIOR TO START OF WORK

DETAIL: FLAGGER ACCESS



NOTE: DRIVEWAY ACCESS WILL BE PROVIDED AT ALL TIMES WORK WILL BE SPLIT TO PROVIDE ACCESS

LEGEND

- SIGN
- TRAFFIC CONES / DELINEATOR
- BARRICADE
- FLAGGER
- FLASHING ARROW SIGN
- WORK ZONE
- BUS STOP

UTILITY SURVEYORS, INC.
AIRX
Gail McMorran
President
2534 EAST EL NORTE PARKWAY, SUITE C
ESCONDIDO, CA 92027
PHONE: (760) 460-2547
CELL: (760) 418-3738

PROJECT NAME: TL23071 - SYCAMORE CANYON SUBSTATION TO PENASQUITOS - 230 KV UNDERGROUND		DATE: Mar. 21, 2017
AIRX JOB#: X160218	THOMAS GRID#:	DESIGNED BY: Clint Jones
TYPE OF WORK: TRENCHING / CONDUIT	DRAWN FOR: CALTRANS	
MISC./POTHoles#:		SHEET 105 OF 148

PHASE 89

**ORIGINAL PERMIT MUST
BE KEPT
ON JOB SITE ALL TIMES**

**APPROVED
TRAFFIC CONTROL PERMIT**

AUG 10 2017

CITY OF SAN DIEGO
Development Services
Engineering Division
Traffic Safety Section

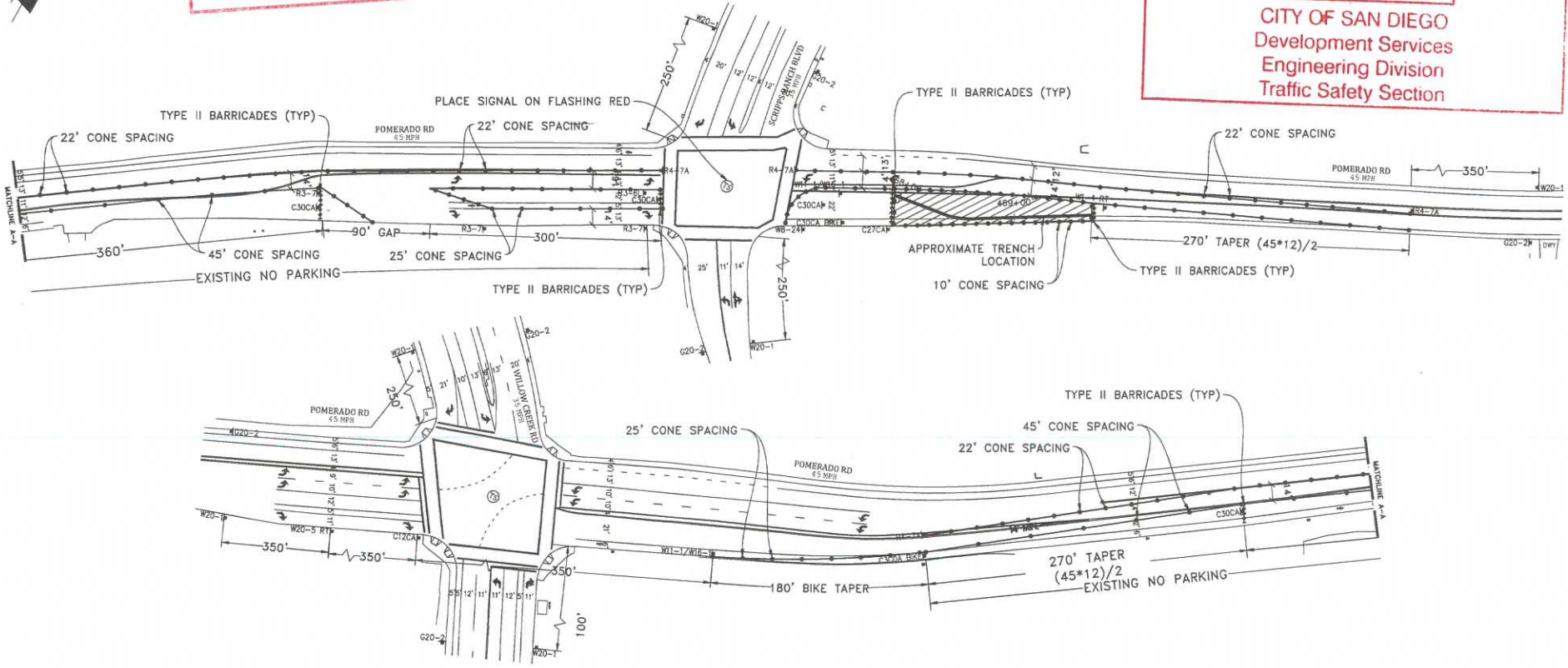

- LEGEND**
- SIGN
 - TRAFFIC CONES / DELINEATOR
 - BARRICADE
 - FLAGGER
 - FLASHING ARROW SIGN
 - WORK ZONE
 - BUS STOP

NOTE: FLAGGERS WILL PROVIDE ACCESS TO DRIVEWAYS AT ALL TIMES

NOTE: FLAGGERS WILL SAFELY GUIDE PEDESTRIANS THROUGH WORK AREA

NOTE: CONTRACTOR WILL ALLOW FIRE STATION INGRESS AND EGRESS AT ALL TIMES

NOTE: WB-24 (STEEL PLATES) AHEAD SIGNS WILL REMAIN IN PLACE FOR DURATION OF WORK



NOTE: CONTRACTOR WILL COORDINATE ALL WORK WITH FIRE STATION PRIOR TO START OF WORK

NOTE: CONTRACTOR WILL COORDINATE ALL WORK WITH TRANSIT DEPARTMENT 5 DAYS PRIOR TO START OF WORK

NOTE: CONTRACTOR WILL COORDINATE ALL WORK WITH EXISTING PROJECTS AND NOT CONFLICT WITH EXISTING TRAFFIC CONTROL

NOTE: CONTRACTOR WILL COORDINATE ALL WORK WITH RESIDENTS PRIOR TO START OF WORK

NOTE: CONTRACTOR WILL COORDINATE ALL WORK WITH BUSINESSES PRIOR TO START OF WORK

WORK HOURS: _____ TO _____

EYE CONTACT MUST BE MAINTAINED BETWEEN FLAGGERS OR USE 2-WAY COMMUNICATION

FLAGGER WILL ASSIST WITH BIKE/VEHICLE TRAFFIC

AIRX SURVEYORS, INC.

Gail McMorran
President

2534 EAST EL NORTE PARKWAY, SUITE C
ESCONDIDO, CA 92027
PHONE: (760) 480-2347
CELL: (760) 419-3738

PROJECT NAME: TL23071 - SYCAMORE CANYON SUBSTATION TO PENASQUITOS - 230 KV UNDERGROUND	
AIRX JOB #X160218	THOMAS GRID#-
TYPE OF WORK: TRENCHING / CONDUIT	DRAWN FOR: CALTRANS
MISC/POTHOLE#:	

PHASE 90

DATE: Mar. 21, 2017
DESIGNED BY: Clint Jones

SHEET 106 OF 148



**ORIGINAL PERMIT MUST
BE KEPT
ON JOB SITE ALL TIMES**

APPROVED
TRAFFIC CONTROL PERMIT

AUG 10 2017

CITY OF SAN DIEGO
Development Services
Engineering Division
Traffic Safety Section

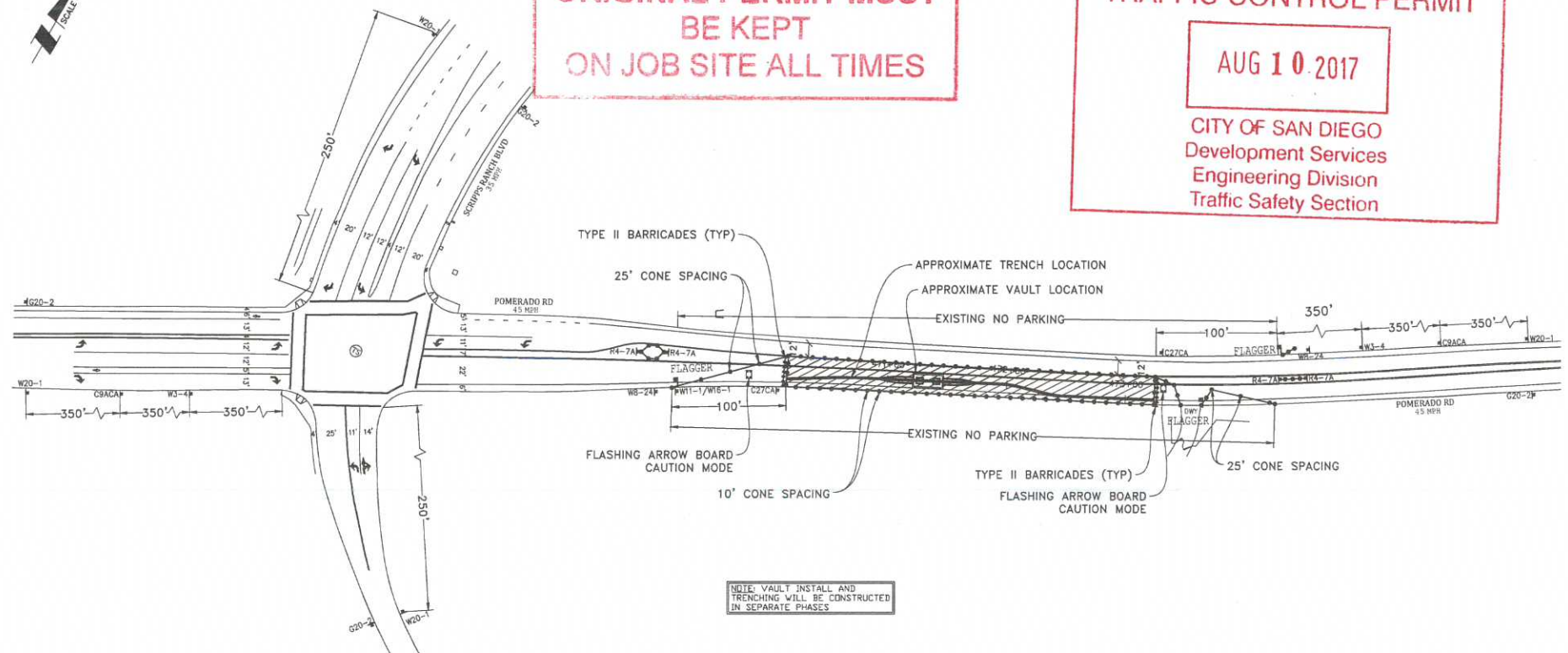

NOTE: VAULT INSTALL AND TRENCHING WILL BE CONSTRUCTED IN SEPARATE PHASES

NOTE: CONTRACTOR WILL COORDINATE ALL WORK WITH FIRE STATION PRIOR TO START OF WORK

NOTE: CONTRACTOR WILL COORDINATE ALL WORK WITH TRANSIT DEPARTMENT 5 DAYS PRIOR TO START OF WORK

NOTE: CONTRACTOR WILL COORDINATE ALL WORK WITH EXISTING PROJECTS AND NOT CONFLICT WITH EXISTING TRAFFIC CONTROL

NOTE: CONTRACTOR WILL COORDINATE ALL WORK WITH RESIDENTS PRIOR TO START OF WORK

NOTE: CONTRACTOR WILL COORDINATE ALL WORK WITH BUSINESSES PRIOR TO START OF WORK

WORK HOURS: _____ TO _____

EYE CONTACT MUST BE MAINTAINED BETWEEN FLAGGERS OR USE 2-WAY COMMUNICATION
FLAGGER WILL ASSIST WITH BIKE/VEHICLE TRAFFIC

LEGEND

-  SIGN
-  TRAFFIC CONES / DELINEATOR
-  BARRICADE
-  FLAGGER
-  FLASHING ARROW SIGN
-  WORK ZONE
-  BUS STOP

NOTE: FLAGGERS WILL PROVIDE ACCESS TO DRIVEWAYS AT ALL TIMES

NOTE: FLAGGERS WILL SAFELY GUIDE PEDESTRIANS THROUGH WORK AREA

NOTE: CONTRACTOR WILL ALLOW FIRE STATION INGRESS AND EGRESS AT ALL TIMES

NOTE: W8-24 (STEEL PLATES AHEAD) SIGNS WILL REMAIN IN PLACE FOR DURATION OF WORK

DETAIL FLAGGER ACCESS

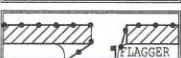

NOTE: DRIVEWAY ACCESS WILL BE PROVIDED AT ALL TIMES WORK WILL BE SPLIT TO PROVIDE ACCESS

UTILITY SURVEYORS, INC.
AIRX
Gail McMoran
President
2534 EAST EL NORTE PARKWAY, SUITE C
ESCONDIDO, CA 92027
PHONE: (760) 440-2347
CELL: (760) 419-3738

PROJECT NAME: TL23071 - SYCAMORE CANYON SUBSTATION TO PENASQUITOS - 230 KV UNDERGROUND	
AIRX JOB# X160218	THOMAS GRID#:-
TYPE OF WORK: TRENCHING / CONDUIT	DRAWN FOR: CALTRANS
MISC/POTHOLE#:	

PHASE 91

DATE: Mar. 21, 2017
DESIGNED BY: Clint Jones
SHEET 107 OF 148

**ORIGINAL PERMIT MUST
BE KEPT
ON JOB SITE ALL TIMES**

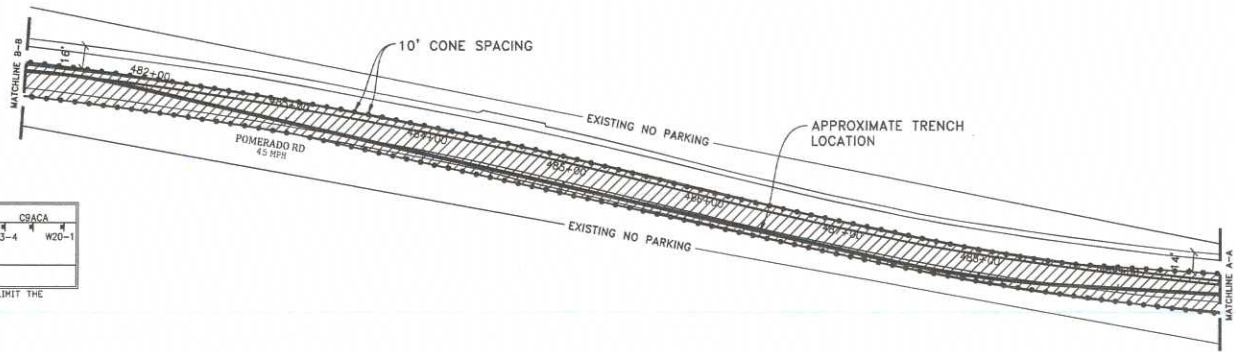
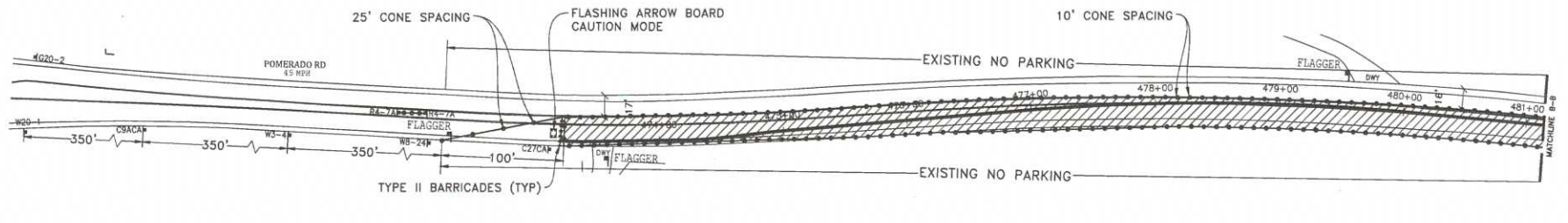

NOTE: VAULT INSTALL AND TRENCHING WILL BE CONSTRUCTED IN SEPARATE PHASES

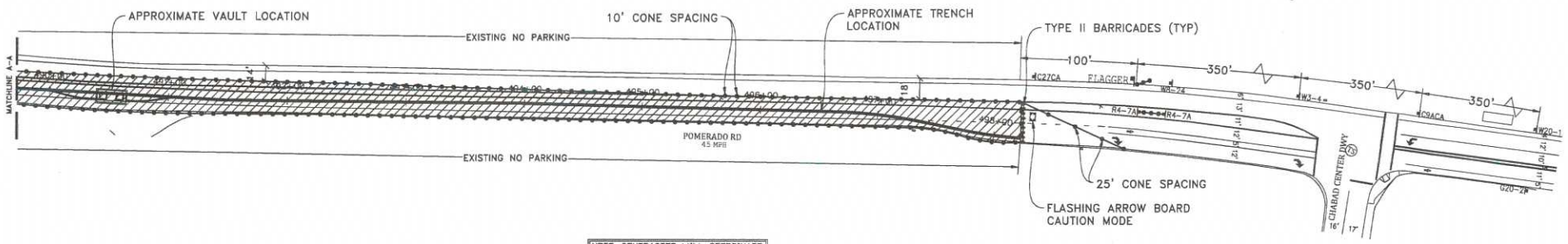
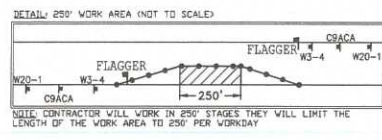

LEGEND

- SIGN
- TRAFFIC CONES / DELINEATOR
- BARRICADE
- FLAGGER
- FLASHING ARROW SIGN
- WORK ZONE
- BUS STOP

NOTE: FLAGGERS WILL PROVIDE ACCESS TO DRIVEWAYS AT ALL TIMES

NOTE: FLAGGERS WILL SAFELY GUIDE PEDESTRIANS THROUGH WORK AREA

NOTE: CONTRACTOR WILL ALLOW FIRE STATION INGRESS AND EGRESS AT ALL TIMES

NOTE: W8-24 (STEEL PLATES AHEAD) SIGNS WILL REMAIN IN PLACE FOR DURATION OF WORK

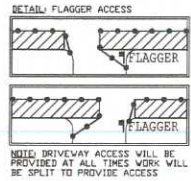

NOTE: CONTRACTOR WILL COORDINATE ALL WORK WITH FIRE STATION PRIOR TO START OF WORK

NOTE: CONTRACTOR WILL COORDINATE ALL WORK WITH TRANSIT DEPARTMENT 5 DAYS PRIOR TO START OF WORK

NOTE: CONTRACTOR WILL COORDINATE ALL WORK WITH EXISTING PROJECTS AND NOT CONFLICT WITH EXISTING TRAFFIC CONTROL

NOTE: CONTRACTOR WILL COORDINATE ALL WORK WITH RESIDENTS PRIOR TO START OF WORK

NOTE: CONTRACTOR WILL COORDINATE ALL WORK WITH BUSINESSES PRIOR TO START OF WORK

WORK HOURS: _____ TO _____

UTILITY SURVEYORS, INC.
AIRX
Gail McMorran
President
2534 EAST EL NORTE PARKWAY, SUITE C
85000000, CA 92027
PHONE: (760) 490-2347
CELL: (760) 418-3738

PROJECT NAME: TL23071 - SYCAMORE CANYON SUBSTATION TO PENASQUITOS - 230 KV UNDERGROUND	DATE: Mar. 21, 2017
AIRX JOB# X160218	DESIGNED BY: Clint Jones
TYPE OF WORK: TRENCHING / CONDUIT	DRAWN FOR: CALTRANS
MISC./POTHOLE#:	SHEET 108 OF 148

APPROVED
TRAFFIC CONTROL PERMIT
AUG 10 2017
CITY OF SAN DIEGO
Development Services
Engineering Division
Traffic Safety Section

PHASE 92

**ORIGINAL PERMIT MUST
BE KEPT
ON JOB SITE ALL TIMES**

**APPROVED
TRAFFIC CONTROL PERMIT**

AUG 10 2017

**CITY OF SAN DIEGO
Development Services
Engineering Division
Traffic Safety Section**

NOTE: VAULT INSTALL AND TRENCHING WILL BE CONSTRUCTED IN SEPARATE PHASES

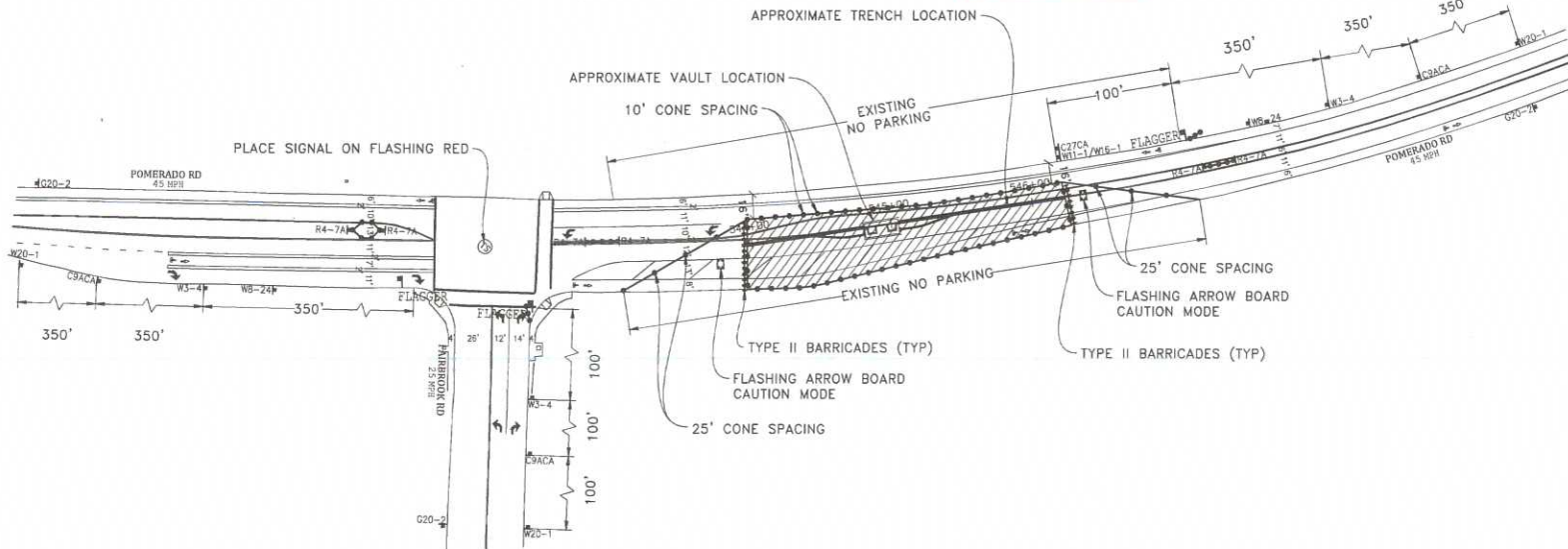

LEGEND

- SIGN
- TRAFFIC CONES / DELINEATOR
- BARRICADE
- FLAGGER
- FLASHING ARROW SIGN
- WORK ZONE
- BUS STOP

NOTE: FLAGGERS WILL PROVIDE ACCESS TO DRIVEWAYS AT ALL TIMES

NOTE: FLAGGERS WILL SAFELY GUIDE PEDESTRIANS THROUGH WORK AREA

NOTE: CONTRACTOR WILL ALLOW FIRE STATION INGRESS AND EGRESS AT ALL TIMES

NOTE: W8-24 (STEEL PLATES AHEAD) SIGNS WILL REMAIN IN PLACE FOR DURATION OF WORK

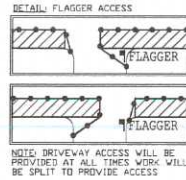

NOTE: CONTRACTOR WILL COORDINATE ALL WORK WITH FIRE STATION PRIOR TO START OF WORK

NOTE: CONTRACTOR WILL COORDINATE ALL WORK WITH TRANSIT DEPARTMENT 5 DAYS PRIOR TO START OF WORK

NOTE: CONTRACTOR WILL COORDINATE ALL WORK WITH EXISTING PROJECTS AND NOT CONFLICT WITH EXISTING TRAFFIC CONTROL

NOTE: CONTRACTOR WILL COORDINATE ALL WORK WITH RESIDENTS PRIOR TO START OF WORK

NOTE: CONTRACTOR WILL COORDINATE ALL WORK WITH BUSINESSES PRIOR TO START OF WORK

WORK HOURS: _____ TO _____

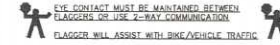

PHASE 103

UTILITY SURVEYORS, INC.
AIRX
2534 EAST EL NORTE PARKWAY, SUITE C
SILICON VALLEY, CA 95051
PHONE: (760) 490-5247
CELL: (760) 419-3758

Gail McMorran
President

PROJECT NAME: TL23071 - SYCAMORE CANYON SUBSTATION TO PENASQUITOS - 230 KV UNDERGROUND	
AIRX JOB#X160218	THOMAS GRID#1-
TYPE OF WORK: TRENCHING / CONDUIT	DRAWN FOR: CALTRANS
MISC./POTHOLE#:	

DATE: Mar. 21, 2017
DESIGNED BY: Clint Jones
SHEET 119 OF 148