

Special Inspection Fees May Be Applied By City of San Diego For Any Night or Weekend Work.

Traffic Control Permit (TCP) Multiple Location List

(Franchise Utility Company Only - May Not Be Submitted By Contractor)

APPROVED
THE CITY OF SAN DIEGO
TRAFFIC CONTROL PERMIT

SEP 06 From: (Company):

Contact Person:

CITY OF SAN DIEGO
Development Services
Engineering
Traffic Safety Section

Work Order Account #: Permit #

City Use Only

Authorized # _____
By Felipe Ariza
Yes X No _____
Date Reviewed 9/6/17

TYPE OF WORK
1 = Lane Closure
2 = Street Closure
3 = Sidewalk Closure
4 = Alley Closure
5 = Parking Lane
6 = Detour
7 = Trenching
8 = Flagging

Date: 9/06/2017
Phone No.: 619-778-2405
Fax: _____
TCP No. _____

Location	From	To	Start Date *	End Date *	Work Hours **	Thomas Bros.	Type of Work
**Pomerado Road	2200' West of Willow Creek Road/Ave of Nations	Willow Creek Road/Ave of Nations	9/11/17	9/15/17	8:30AM - 3:30PM	1209-G6, H5, J5	1, 7, 8
Pomerado Road	Willow Creek Road/Ave of Nations	Semillon Blvd	9/11/17	9/15/17	8:30AM - 3:30PM	1209-G6, H5, J5, 1210-A-4, B4	1, 7, 8
Willow Creek Road	Pomerado Road	Caminito Covewood	9/11/17	9/15/17	8:30AM - 3:30PM	1209-G6, G5	8
Avenue of Nations	Pomerado Road	End of Street	9/11/17	9/15/17	8:30AM - 3:30PM	1209-G6, G5	

>>> Place CMS on I-15 (NB and SB): "CONSTRUCTION ON POMERADO RD - EXPECT DELAYS" <<<<<<

Vault and Trench Crews - Phases 82-94 - Daytime work hours (M-F, 8:30AM - 3:30PM)
 **Pomerado Road west of Willow Creek Road/Ave of Nations (County ROW hours agreed to 8:30AM - 3:30PM)

>>> Warning signs on approach to flagging operation will be doubled in east bound and west bound directions along Pomerado Road
 >>> Flaggers to assist with potential back ups and provide better traffic circulation for all movements at signalized intersections that require flas
 >>> (Minimum 4 flaggers at intersection)

Comments:
 Must be submitted a minimum of 2 working days prior to start of work. All columns must be filled out for proper authorization
 Fax or mail to: City of San Diego • Traffic Control Permit Section • 1222 First Avenue, MS 501 • San Diego, CA 92101. Fax (619) 446-5489 Office (619) 446-5150
 * Work Days: Monday Through Friday ** Work Hours : 8:30 AM - 3:30PM. Unless other hours are preapproved)
 No Work on Saturdays, Sundays, or Holidays Unless Approved and Noted In Comments
 Minimum of 5 working days required for construction work which affects traffic signal e-mail info to: JVaca@sandiego.gov



Traffic Control Permit (TCP) Multiple Location List

(Franchise Utility Company Only - May Not Be Submitted By Contractor)

THE CITY OF SAN DIEGO

APPROVED
TRAFFIC CONTROL PERMIT

SEP 06 2017

CITY OF SAN DIEGO
Development Services
Engineering Division
Traffic Safety Section

To: City of San Diego, Traffic Permit Section
Date: 9/06/2017
From: (Company): SDG&E
Phone No.: 619-778-2405
Contact Person: Rod Nelson
Fax: _____
TCP No. _____

City Use Only
Authorized # _____
By Felipe Ariza
Yes X No _____
Date Reviewed 9/16/17

- TYPE OF WORK**
- 1 = Lane Closure
 - 2 = Street Closure
 - 3 = Sidewalk Closure
 - 4 = Alley Closure
 - 5 = Parking Lane
 - 6 = Detour
 - 7 = Trenching
 - 8 = Flagging

Location	From	To	Start Date *	End Date *	Work Hours **	Thomas Bros.	Type of Work
Scripps Ranch Blvd	Pomerado Road	Ironwood Road	9/11/17	9/15/17	8:30AM - 3:30PM	1209-H5	8
Scripps Ranch Row	Pomerado Road	Espinosa Square	9/11/17	9/15/17	8:30AM - 3:30PM	1209-H5	8
Avenida Magnifica	Mesa Madera Dr	Caminito Calor	9/11/17	9/15/17	8:30AM - 3:30PM	1209-J4,J5 1210-A5	8
Fairbrook Road	Pomerado Road	Caminito Magnifico	9/11/17	9/15/17	8:30AM - 3:30PM	1210-A4, B4	8

>>> Place CMS on I-15 (NB and SB): "CONSTRUCTION ON POMERADO RD - EXPECT DELAYS" <<<<<<

Vault and Trench Crews - Phases 82-94 - Daytime work hours (M-F, 8:30AM - 3:30PM)
**Pomerado Road west of Willow Creek Road/Ave of Nations (County ROW hours agreed to 8:30AM - 3:30PM)

>>> Warning signs on approach to flagging operation will be doubled in east bound and west bound directions along Pomerado Road
>>> Flaggers to assist with potential back ups and provide better traffic circulation for all movements at signalized intersections that require flash.

Comments: (Minimum 4 flaggers at intersection)

Must be submitted a minimum of 2 working days prior to start of work. All columns must be filled out for proper authorization

Fax or mail to: City of San Diego • Traffic Control Permit Section • 1222 First Avenue, MS 501 • San Diego, CA 92101. Fax (619) 446-5489 Office (619) 446-5150

* Work Days: Monday Through Friday ** Work Hours : 8:30 AM - 3:30PM. Unless other hours are preapproved)

No Work on Saturdays, Sundays, or Holidays Unless Approved and Noted In Comments

Minimum of 5 working days required for construction work which affects traffic signal e-mail info to: JVaca@sandiego.gov

ATTENTION UTILITY COMPANY

Special Inspection Fees May Be Applied By City of San Diego For Any Night or Weekend Work.

APPROVED TRAFFIC CONTROL PERMIT
 SEP 08 2017
 ANY OF CERTAIN LEGG
 DEVELOPMENT SERVICES MUST
 TURN LEFT OR VISIION
 ENGINEERING DIVISION
 Traffic Safety Section

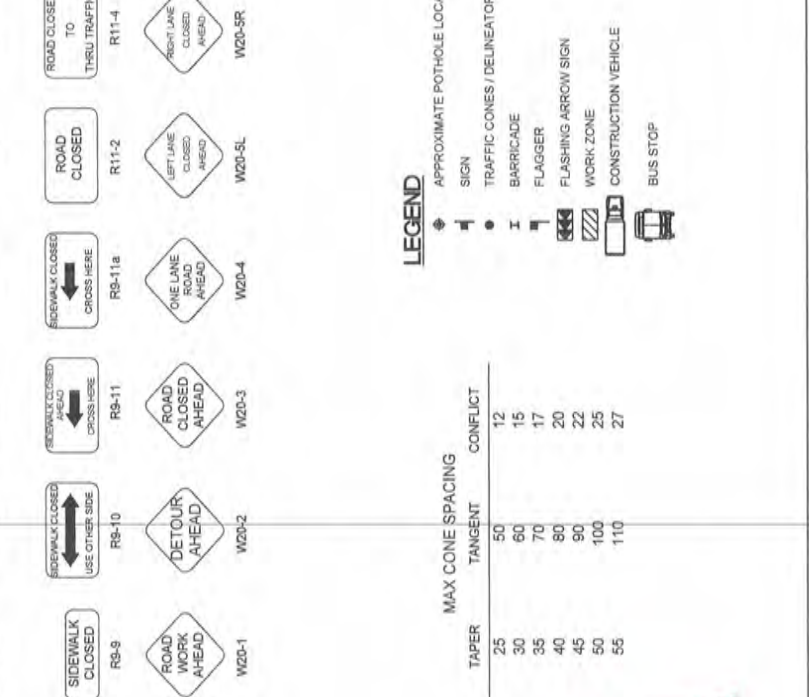

APPROACH SPEED (MPH)	MINIMUM TAPER LENGTHS (L) (FEET) FOR 12-FOOT LANE			CONFLICT
	L	1/2L	1/3L	
25	125	65	45	25
30	180	90	60	30
35	245	125	85	35
40	320	160	110	40
45	540	270	180	45
50	600	300	200	50
55+	660	330	220	55



ORIGINAL PERMIT MUST BE KEPT ON JOB SITE ALL TIMES

UTILITY SURVEYORS, INC.
AIRX
 Gail McMorran
 President
 2634 EAST EL NORTE PARKWAY, SUITE C
 ESCONCODO, CA 92027
 PHONE: (760) 460-2347
 CELL: (760) 415-3738

PROJECT NAME: TL23071 - Sycamore Canyon Substation To Penasquitos Substation - 230 KV Underground
 AIRX JOB#: X160218
 TYPE OF WORK: TRENCHING / CONDUIT
 MISC/POTHOLES#:
 THOMAS GRID#: -
 DRAWN FOR: SAN DIEGO COUNTY

DATE: Mar 2, 2017
 DESIGNED BY: Clint Jones
 SHEET 1 OF 4



NOTE: W8-24 (STEEL PLATES AHEAD) SIGNS WILL REMAIN IN PLACE FOR DURATION OF WORK

NOTE: W8-24 (STEEL PLATES AHEAD) SIGNS WILL REMAIN IN PLACE FOR DURATION OF WORK

NOTE: STEEL PLATE BRIDGING SHALL NOT EXCEED 24 HR AND 50 FEET IN LENGTH IN THE WORK ZONE

ORIGINAL PERMIT MUST
ON JOB SITE ALL TIMES

APPROVED
TRAFFIC CONTROL PERMIT

SEP 06 2017

CITY OF SAN DIEGO
Department of Public Works
Engineering Division
Traffic Safety Section

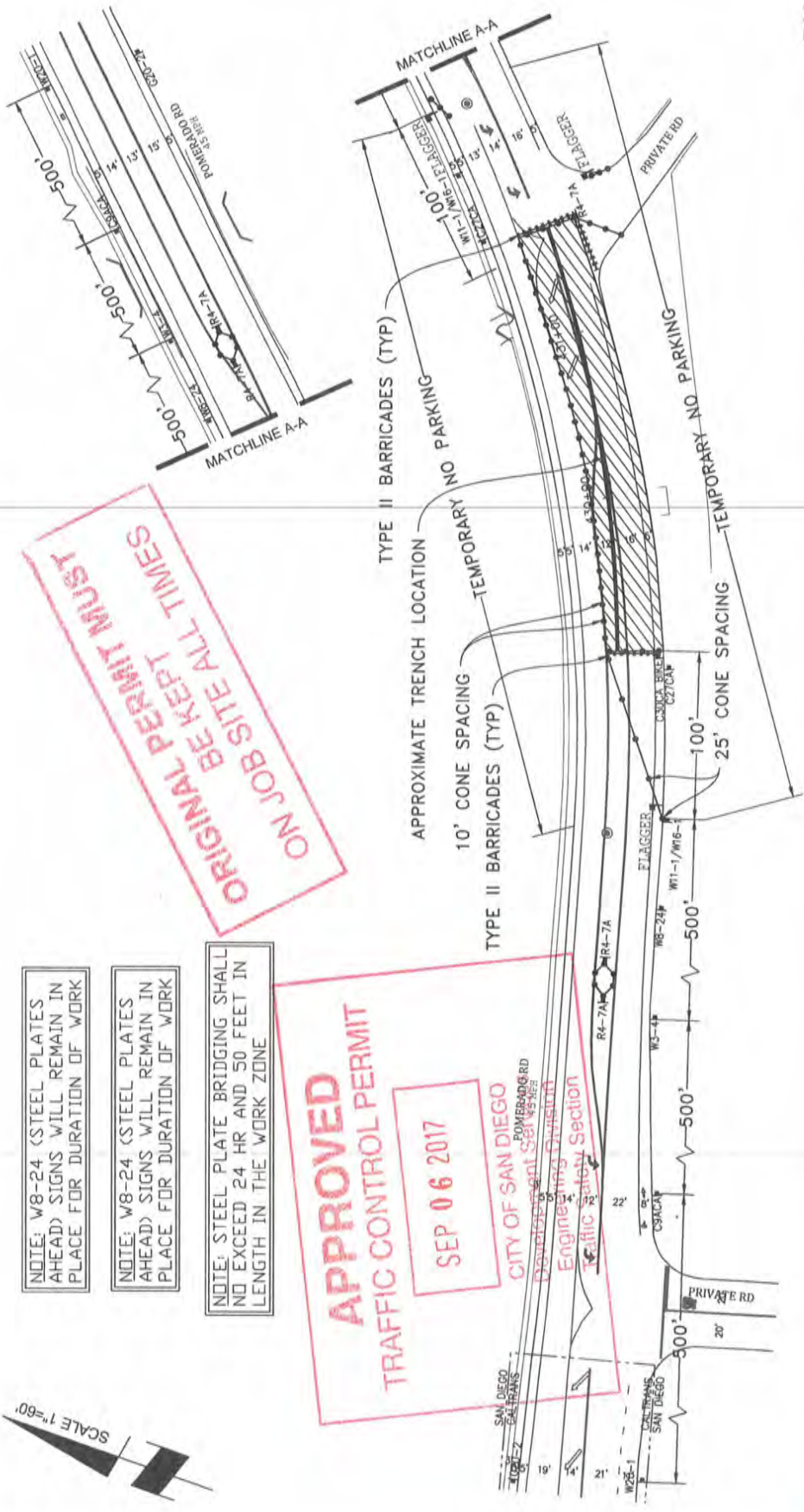

PHASE 01

 <p>UTILITY SURVEYORS, INC. Gail McMoran President 2534 EAST EL NORTE PARKWAY, SUITE C ESCONDIDO, CA 92027 PHONE: (760) 480-2247 CELL: (760) 419-3728</p>	<p>PROJECT NAME: TL23071 – Sycamore Canyon Substation To Penasquitos Substation – 230 KV Underground</p>		<p>DATE: Mar 2, 2017 DESIGNED BY: Clint Jones</p>
	<p>AIRX JOB#: X160218</p>	<p>THOMAS GRID#: –</p>	<p>DRAWN FOR: SAN DIEGO COUNTY</p>
<p>TYPE OF WORK: TRENCHING / CONDUIT</p>		<p>MISC/POTHOLE#:</p>	
<p>SHEET 2 OF 4</p>		<p>SHEET 2 OF 4</p>	

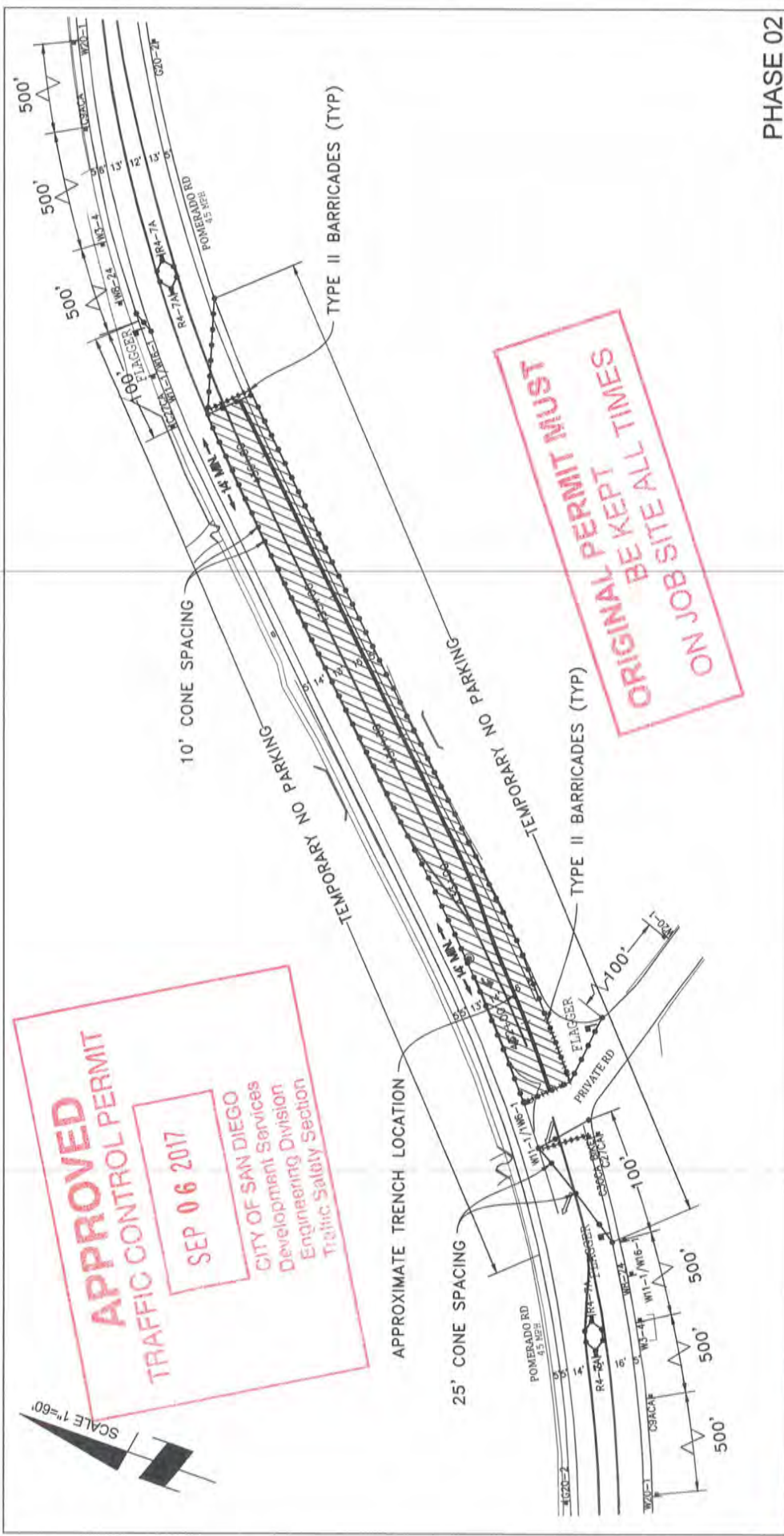

PHASE 02

DATE: Mar 2, 2017
 DESIGNED BY:
 Clint Jones

SHEET 3 OF 4

PROJECT NAME: TL23071 - Sycamore Canyon Substation To
 Penasquitos Substation - 230 KV Underground

AIRX JOB#: X160218

THOMAS GRID#: -

TYPE OF WORK: TRENCHING / CONDUIT

MISC./POTHOLES#:

DRAWN FOR: SAN DIEGO COUNTY

UTILITY SURVEYORS, INC.

Gail McMorrin
 President

2554 EAST EL NORTE PARKWAY, SUITE C
 ESCONDO, CA 92027
 PHONE: (760) 480-2347
 CELL: (760) 418-3738

APPROVED
TRAFFIC CONTROL PERMIT
SEP 06 2017
 CITY OF SAN DIEGO
 Development Services
 Permitting Division
 APPROXIMATE Trench Section
 TRENCH LOCATION

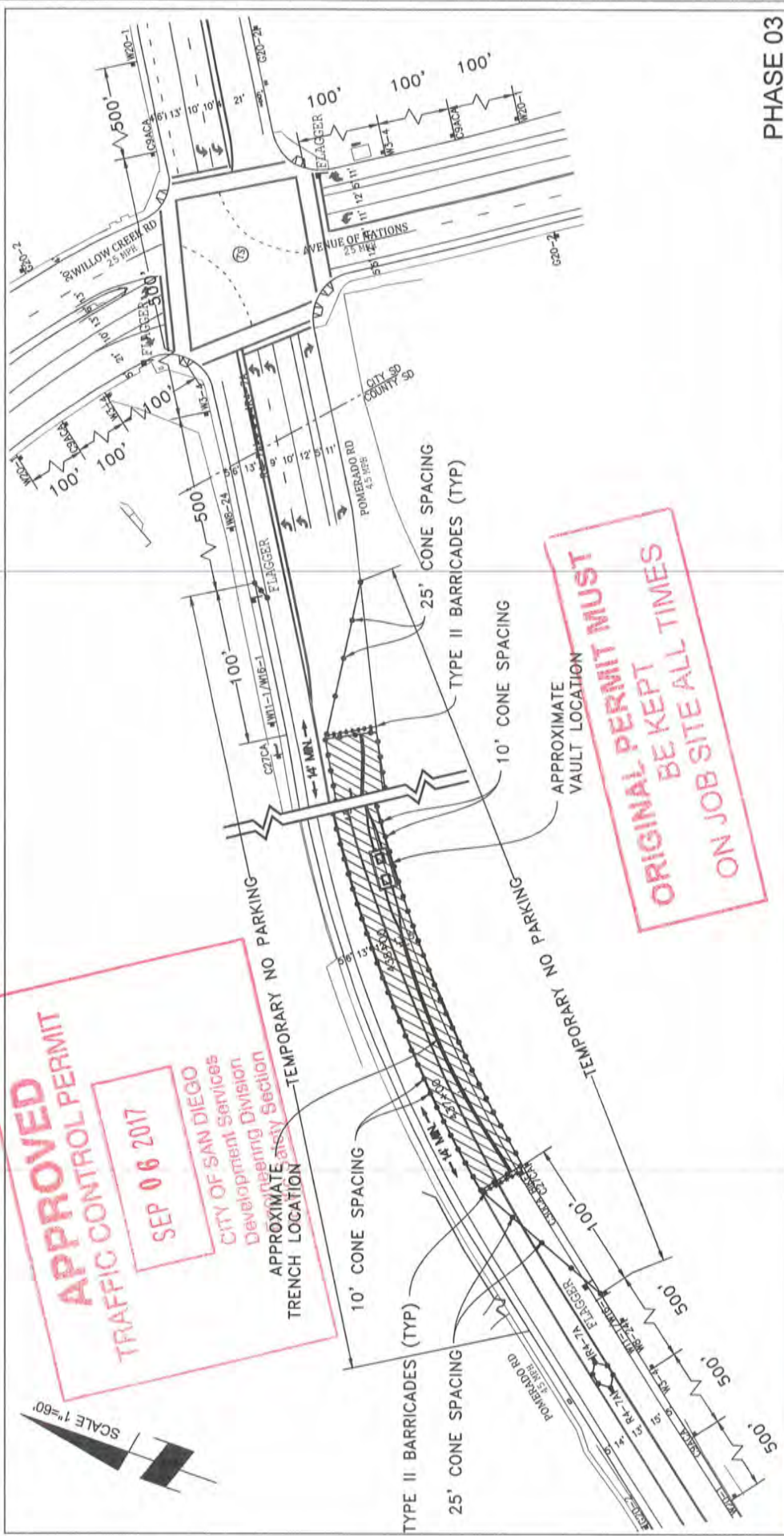

ORIGINAL PERMIT MUST
BE KEPT
ON JOB SITE ALL TIMES

PHASE 03

	PROJECT NAME: TL23071 – Sycamore Canyon Substation To Penosquitos Substation – 230 KV Underground		DATE: Mar 2, 2017 DESIGNED BY: Clint Jones
	AIRX JOB#: X160218	THOMAS GRID#: –	SHEET 4 OF 4
	TYPE OF WORK: TRENCHING / CONDUIT	DRAWN FOR: SAN DIEGO COUNTY	
MISC./POTHOLE#: 			

SIGN LEGEND

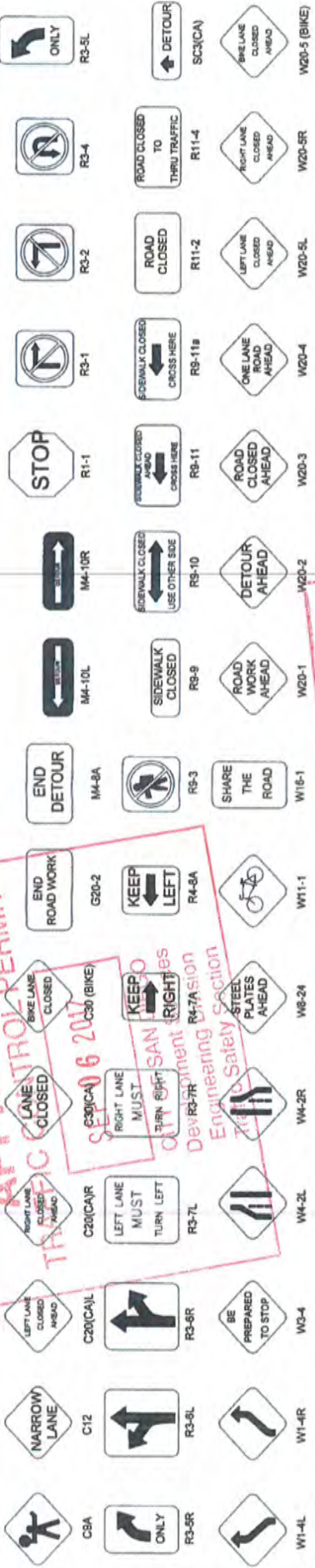

APPROVED
TRAFFIC CONTROL PERMIT
 SET 06 2017
 CITY OF SAN DIEGO
 Engineering Division
 Safety Section

ORIGINAL PERMIT MUST BE KEPT ON JOB SITE ALL TIMES

LEGEND

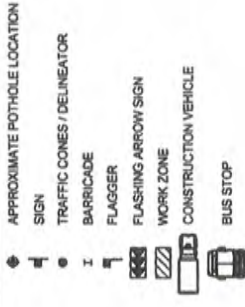

MINIMUM TAPER LENGTHS (L) (FEET) FOR 12-FOOT LANE		MAX CONE SPACING		CONFLICT
L	1/2L	1/3L	TAPER TANGENT	
125	65	45	25	12
180	90	60	30	15
245	125	85	35	17
320	160	110	40	20
540	270	180	45	22
600	300	200	50	25
660	330	220	55	27

MINIMUM DISTANCE (FEET) BETWEEN SIGNS AND FROM LAST SIGN TO TAPER
100
250
250
250
350
350
350

APPROACH SPEED (MPH)
25
30
35
40
45
50
55+



UTILITY SURVEYORS, INC.
 Gail McMorrin
 President
 2534 EAST EL NORTE PARKWAY, SUITE C
 ESCONCIDO, CA 92027
 PHONE: (760) 485-2347
 CELL: (760) 419-3738

PROJECT NAME: TL23071 - Sycamore Canyon Substation To Penasquitos Substation - 230 KV Underground

AIRX JOB#: X160218

TYPE OF WORK: TRENCHING / CONDUIT

MISC/POTHOLE#:

DATE: Mar 2, 2017
DESIGNED BY: Clint Jones

SHEET 1 OF 4

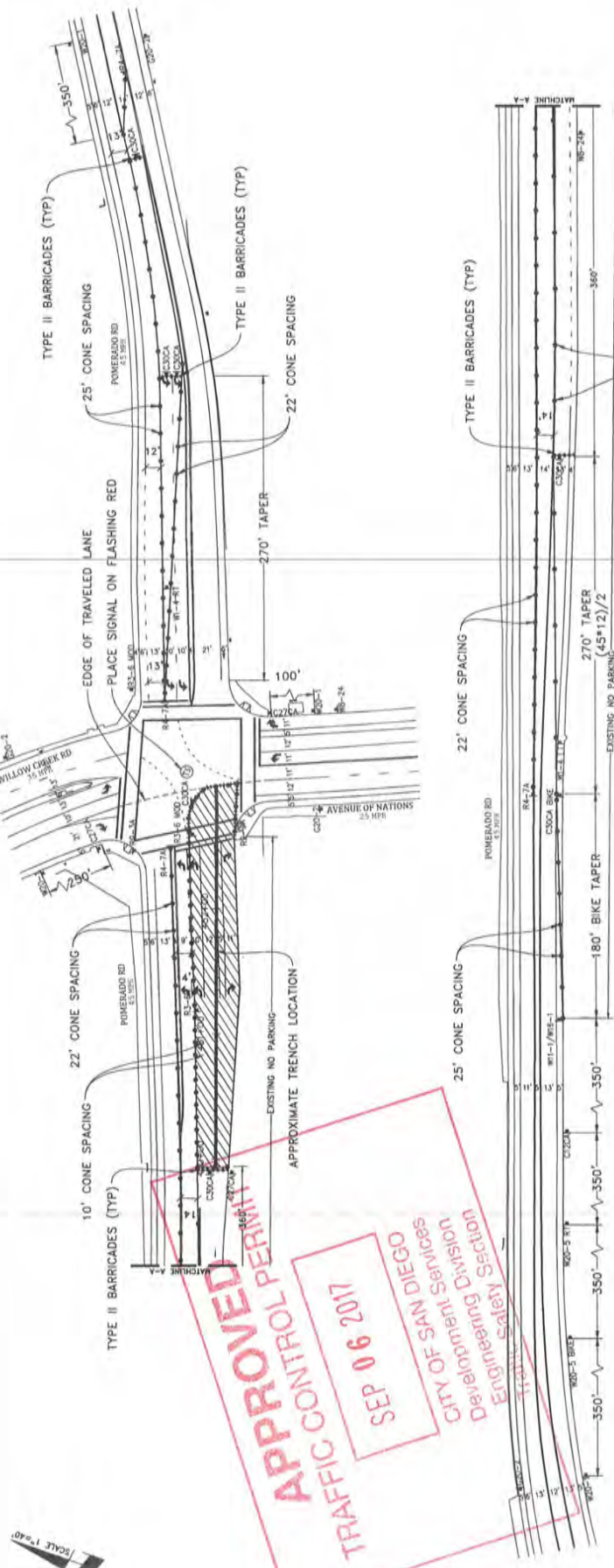

APPROVED
 CONTROL TO PERMIT
SEP 06 2017
 City of San Diego
 Developing Services
 Engineering Section
 Safety Section

**ORIGINAL PERMIT MUST
 BE KEPT
 ON JOB SITE ALL TIMES**

NOTE: CONTRACTOR WILL COORDINATE ALL WORK WITH FIRE STATION PRIOR TO START OF WORK.

NOTE: CONTRACTOR WILL COORDINATE ALL WORK WITH TRAFFIC DEPARTMENT 5 DAYS PRIOR TO START OF WORK.

NOTE: CONTRACTOR WILL COORDINATE ALL WORK WITH BUSINESSSES PRIOR TO START OF WORK.

NOTE: CONTRACTOR WILL COORDINATE ALL WORK WITH BUSINESSSES PRIOR TO START OF WORK.

NOTE: CONTRACTOR WILL COORDINATE ALL WORK WITH BUSINESSSES PRIOR TO START OF WORK.

- LEGEND**
- 1 SIGN
 - TRAFFIC CONES / DELINEATOR
 - BARRICADE
 - FLAGGER
 - FLASHING ARROW SIGN
 - WORK ZONE
 - BUS STOP

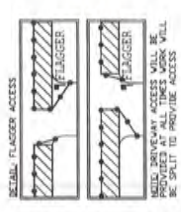

NOTE: CONTRACTOR WILL COORDINATE ALL WORK WITH BUSINESSSES PRIOR TO START OF WORK.

NOTE: CONTRACTOR WILL COORDINATE ALL WORK WITH BUSINESSSES PRIOR TO START OF WORK.

NOTE: CONTRACTOR WILL COORDINATE ALL WORK WITH BUSINESSSES PRIOR TO START OF WORK.

NOTE: CONTRACTOR WILL COORDINATE ALL WORK WITH BUSINESSSES PRIOR TO START OF WORK.

NOTE: CONTRACTOR WILL COORDINATE ALL WORK WITH BUSINESSSES PRIOR TO START OF WORK.

NOTE: CONTRACTOR WILL COORDINATE ALL WORK WITH BUSINESSSES PRIOR TO START OF WORK.

NOTE: CONTRACTOR WILL COORDINATE ALL WORK WITH BUSINESSSES PRIOR TO START OF WORK.

NOTE: CONTRACTOR WILL COORDINATE ALL WORK WITH BUSINESSSES PRIOR TO START OF WORK.

WORK LOGS: _____ TO _____

SEE CONTRACT MUST BE MAINTAINED BETWEEN FLAGGERS OR USE OF ONLY COMMUNICATION FLAGGER WILL ASSIST WITH BRIDGE/SIGNS/TRAFFIC

PHASE 82

PROJECT NAME: TL23071 - SYCAMORE CANYON SUBSTATION TO PENASQUITOS - 230 KV UNDERGROUND		DATE: Mar. 21, 2017
AIRX JOB#X160218		DESIGNED BY: Clint Jones
TYPE OF WORK: RENEWING / CONDUIT		THOMAS GRID#-
MISC./POTHLES#:		DRAWN FOR: CALTRANS
SHEET 098 OF 148		

AIRX SURVEYS, INC.

Gail McMorran
President

204 MARTEL WOOD PARKWAY, SUITE C
 ESSEX, MA 01824
 PHONE: (978) 489-3347
 CELL: (978) 414-3748

SCALE 1"=40'

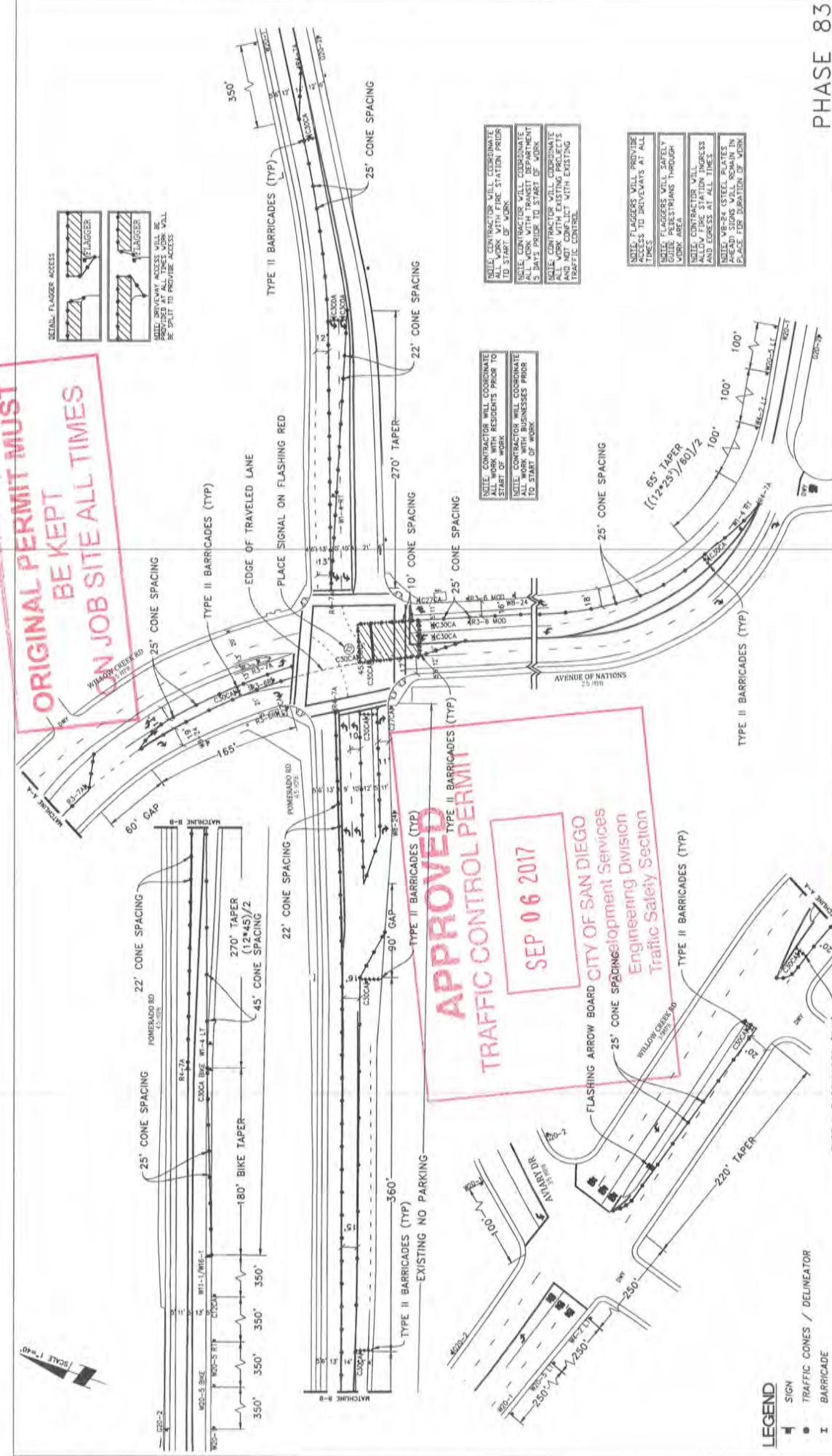

ORIGINAL PERMIT MUST BE KEPT ON JOB SITE ALL TIMES

APPROVED TRAFFIC CONTROL PERMIT
SEP 06 2017

NOTE: CONTRACTOR WILL COORDINATE ALL WORK WITH RESIDENTS PRIOR TO START OF WORK.
 NOTE: CONTRACTOR WILL COORDINATE ALL WORK WITH BUSINESSES PRIOR TO START OF WORK.
 NOTE: CONTRACTOR WILL COORDINATE ALL WORK WITH TRANSIT DEPARTMENT 5 DAYS PRIOR TO START OF WORK.
 NOTE: CONTRACTOR WILL COORDINATE ALL WORK WITH EXISTING UTILITIES AND NOT CONFLICT WITH EXISTING TRAFFIC CONTROL.

NOTE: FLAGGERS WILL PROVIDE ACCESS TO DRIVEWAYS AT ALL TIMES.
 NOTE: FLAGGERS WILL SAFELY GUIDE PEDESTRIANS THROUGH WORK AREA.
 NOTE: CONTRACTOR WILL ALLOW TIME STATION INGRESS AND EGRESS AT ALL TIMES.
 NOTE: W-24 STEEL SLATES WILL BE USED TO PROVIDE A PLACE FOR DURATION OF WORK.

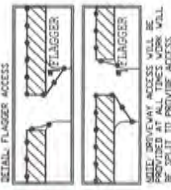

- LEGEND**
- SIGN
 - TRAFFIC CONES / DELINEATOR
 - ▬ BARRICADE
 - ▬ FLAGGER
 - ▬ FLASHING ARROW SIGN
 - ▬ WORK ZONE
 - ▬ BUS STOP

WORK SHEETS TO _____
 ALL CHANGES MUST BE APPROVED BY THE ENGINEER OR THE CITY COMMUNICATOR.
 FLAGGERS MUST ASSIST WITH BARRICADE/TAPERS.

AIRX UTILITY SURVEYORS, INC.
 Gail McMonran, President
 1000 W. NORTH AVENUE, SUITE C
 ESCOBAR, CO 81029
 PHONE: (760) 488-2424
 CELL: (760) 488-2728

PROJECT NAME: TL23071 - SYCAMORE CANYON SUBSTATION TO PENASQUITOS - 230 KV UNDERGROUND
 AIRX JOB # X160218
 TYPE OF WORK: TRENCHING / CONDUIT
 MISC./POTHOLE #:

PHASE 83

DATE: Apr. 6, 2017
 DESIGNED BY: Clint Jones
 SHEET 099 OF 148

SCALE 1"=40'

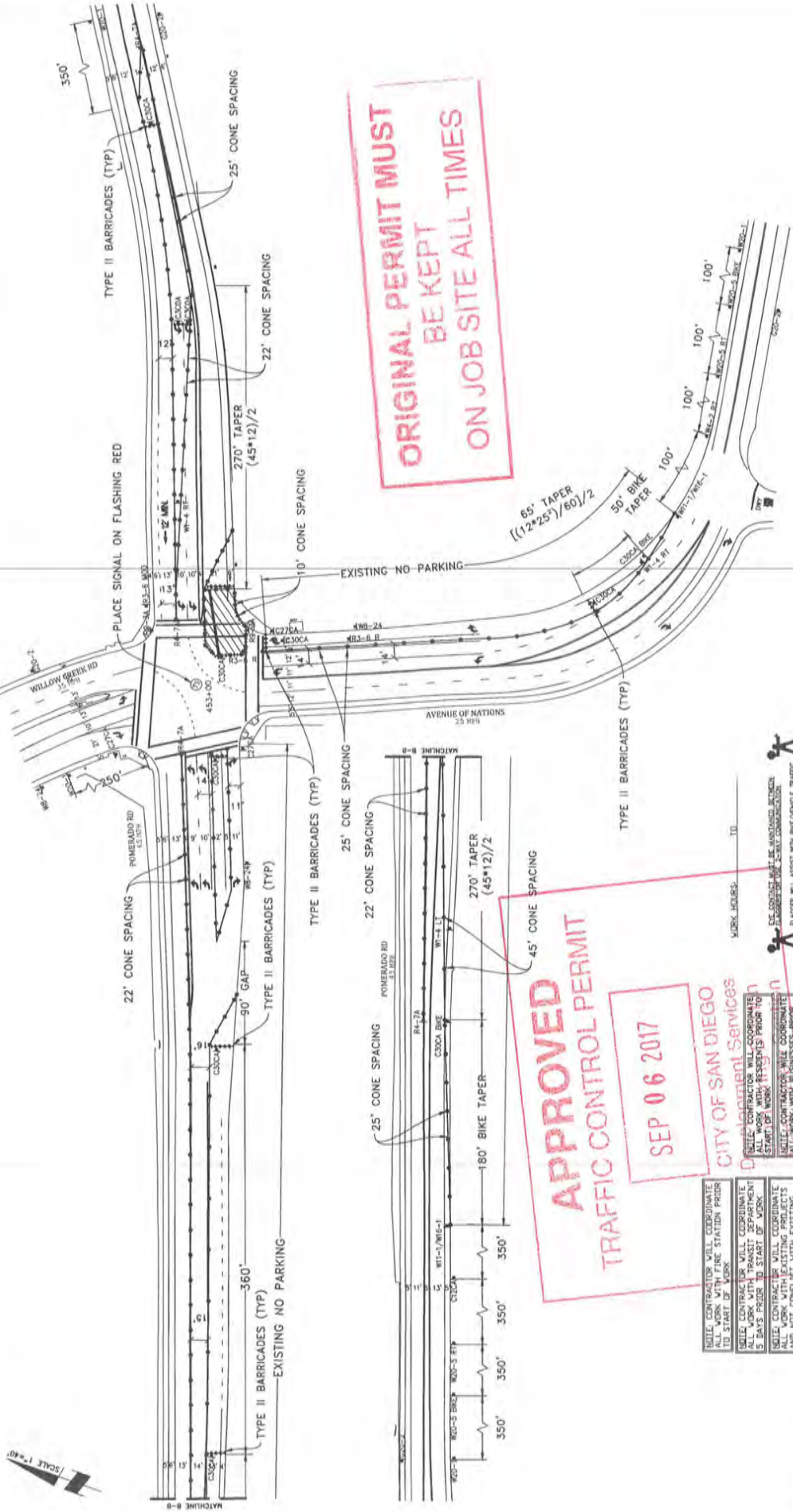

LEGEND

	SIGN
	TRAFFIC CONES / DELINEATORS
	TRAFFIC CONES / DELINEATORS TO DRIVEWAYS AT ALL TIMES
	FLAGGER
	FLASHING ARROW SIGN
	WORK ZONE
	BUS STOP

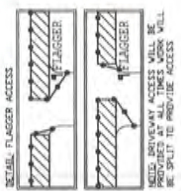

NOTE: CONTRACTOR WILL COORDINATE WITH SAN DIEGO POLICE DEPARTMENT TO START OF WORK.

NOTE: CONTRACTOR WILL COORDINATE WITH TRANSIT DEPARTMENT 5 DAYS PRIOR TO START OF WORK.

NOTE: CONTRACTOR WILL COORDINATE WITH EXISTING PROJECTS WITH EXISTING TRAFFIC CONTROL.

NOTE: CONTRACTOR WILL COORDINATE WITH SAN DIEGO POLICE DEPARTMENT TO START OF WORK.

NOTE: CONTRACTOR WILL COORDINATE WITH TRANSIT DEPARTMENT 5 DAYS PRIOR TO START OF WORK.

NOTE: CONTRACTOR WILL COORDINATE WITH EXISTING PROJECTS WITH EXISTING TRAFFIC CONTROL.

NOTE: CONTRACTOR WILL COORDINATE WITH SAN DIEGO POLICE DEPARTMENT TO START OF WORK.

NOTE: CONTRACTOR WILL COORDINATE WITH TRANSIT DEPARTMENT 5 DAYS PRIOR TO START OF WORK.

NOTE: CONTRACTOR WILL COORDINATE WITH EXISTING PROJECTS WITH EXISTING TRAFFIC CONTROL.

DATE: Mar. 21, 2017
 DESIGNED BY:
 Clint Jones

PROJECT NAME: TL23071 - SYCAMORE CANYON SUBSTATION TO PENASQUITOS - 230 KV UNDERGROUND
 AIRX JOB#: X160218
 THOMAS GRID#:
 TYPE OF WORK: RENEWING / CONDUIT
 MISC./POTHOLES#:

AIRX SURVEYORS, INC.
 Gail McMorran
 President
 3844 MARTELL AVENUE, SUITE 100
 ESCONDIDO, CA 92027
 PHONE: (760) 462-2847
 CELL: (760) 419-3738

DATE: Mar. 21, 2017
 DESIGNED BY:
 Clint Jones



ORIGINAL PERMIT MUST BE KEPT ON JOB SITE ALL TIMES

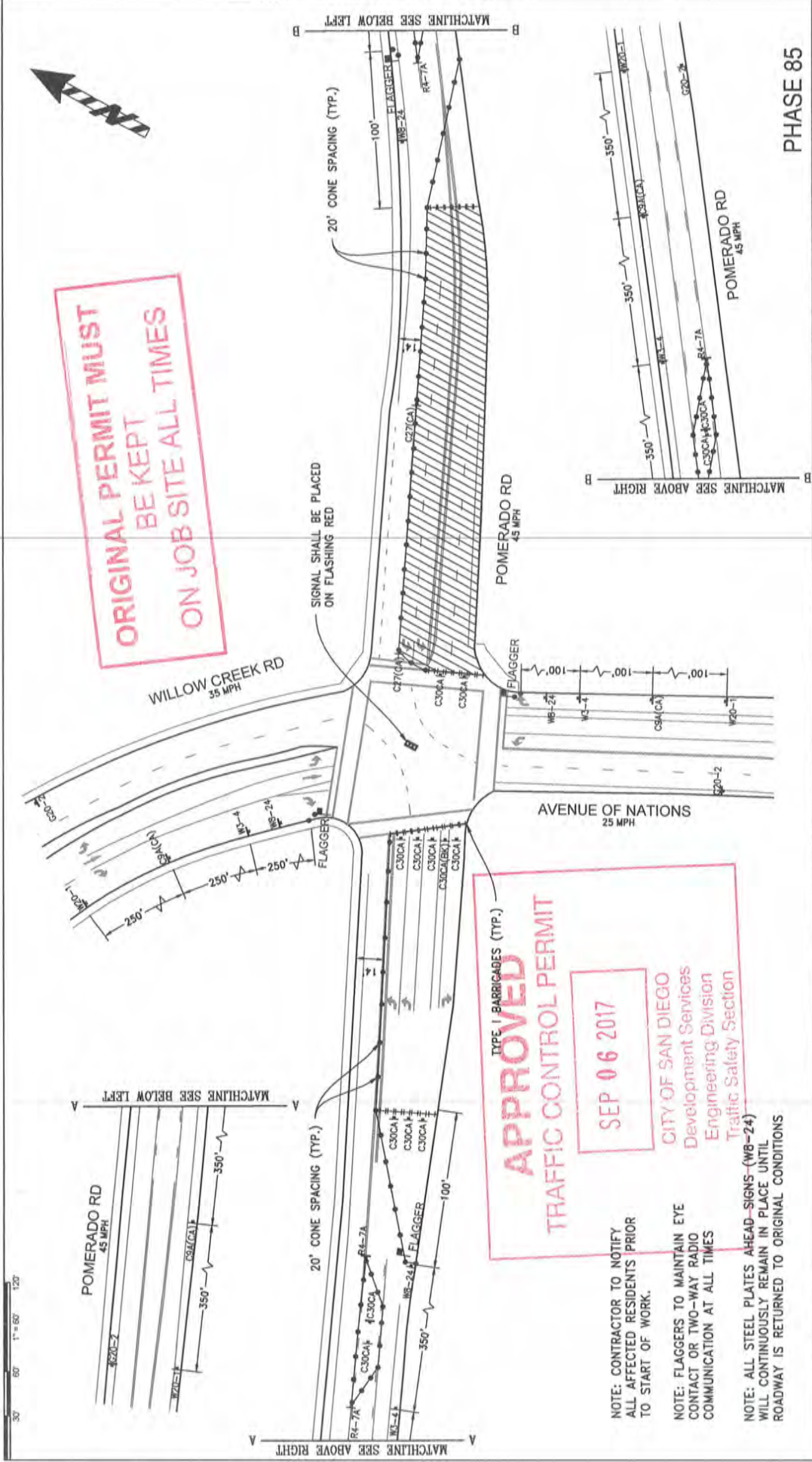

TYPE I BARRICADES (TYP.)
APPROVED
 TRAFFIC CONTROL PERMIT
 SEP 06 2017
 CITY OF SAN DIEGO
 Development Services
 Engineering Division
 Traffic Safety Section

NOTE: CONTRACTOR TO NOTIFY ALL AFFECTED RESIDENTS PRIOR TO START OF WORK.
 NOTE: FLAGGERS TO MAINTAIN EYE CONTACT OR TWO-WAY RADIO COMMUNICATION AT ALL TIMES
 NOTE: ALL STEEL PLATES AHEAD-SIGNS (W8-24) WILL CONTINUOUSLY REMAIN IN PLACE UNTIL ROADWAY IS RETURNED TO ORIGINAL CONDITIONS

PHASE 85

<p>TRAFFIC CONTROL PLANS</p> <p>CITY OF SAN DIEGO</p>		<p>SXPQ EAST SIDE POMERADO</p>	
<p>POSTED SPEED LIMIT (MPH)</p>		<p>PROJECT INFORMATION</p>	
<p>SIGN SPACING (FEET)</p>		<p>ARB</p>	
<p>TAPER LENGTH (FEET)</p>		<p>COMPANY</p>	
<p>CONE SPACING (FEET)</p>		<p>ROD NELSON</p>	
<p>SEE PLAN</p>		<p>619.295.2754</p>	
<p>DATE:</p>		<p>PHONE</p>	
<p>SEP 06 2017</p>		<p>SHEET 101 OF 148</p>	

CO'S
TRAFFIC CONTROL, INC.
 LIC# 818076

1221 S. 26TH ST
 SAN DIEGO, CA 92113
 OFFICE: (858) 259-0300
 FAX: (858) 259-0357



ORIGINAL PERMIT MUST BE KEPT ON JOB SITE ALL TIMES

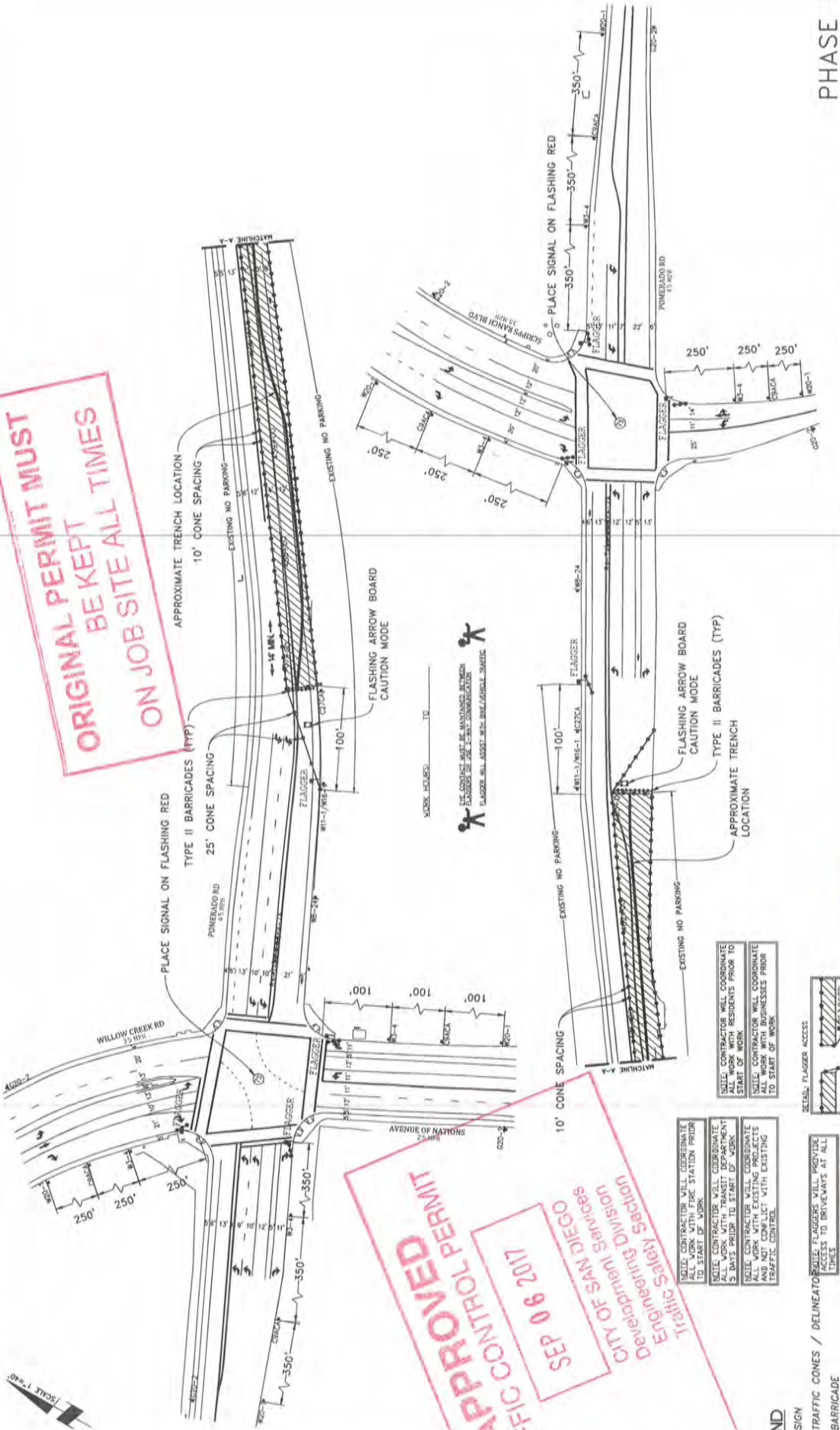

APPROVED
TRAFFIC CONTROL PERMIT
SEP 08 2017
CITY OF SAN DIEGO
Engineering Division
Traffic Safety Section

- NOTE: CONTRACTOR WILL COORDINATE ALL WORK WITH FIRE STATION PRIOR TO START OF WORK.
- NOTE: CONTRACTOR WILL COORDINATE ALL WORK WITH RESIDENTS PRIOR TO START OF WORK.
- NOTE: CONTRACTOR WILL COORDINATE ALL WORK WITH BUSINESSES PRIOR TO START OF WORK.
- NOTE: CONTRACTOR WILL COORDINATE ALL WORK WITH EXISTING PROJECTS AND NOT CONFLICT WITH EXISTING TRAFFIC CONTROL.
- NOTE: CONTRACTOR WILL PROVIDE ACCESS TO DRIVEWAYS AT ALL TIMES.
- NOTE: CONTRACTOR WILL SAFELY ACCESS TO DRIVEWAYS THROUGH WORK AREA.
- NOTE: CONTRACTOR WILL ALLOW FIRE STATION INGRESS AND EGRESS AT ALL TIMES.
- NOTE: 18" x 24" STEEL PLATES WILL BE PLACED AT ALL DRIVEWAY ACCESS POINTS TO PROVIDE ACCESS.

- LEGEND**
- SIGN
 - TRAFFIC CONES / DELINEATOR
 - BARRICADE
 - FLAGGER
 - FLASHING ARROW SIGN
 - WORK ZONE
 - BUS STOP

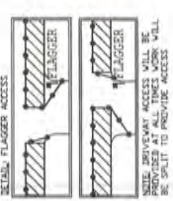

PHASE 86

DATE: Mar. 21, 2017
 DESIGNED BY:
 Clint Jones

PROJECT NAME: TL23071 - SYCAMORE CANYON SUBSTATION TO PENASQUITOS - 230 KV UNDERGROUND

AIRX JOB#X160218
 THOMAS GRID#:

TYPE OF WORK: RENEWING / CONDUIT
 MISC./POTHOLE#:

AIRX SURVIVORS, INC.
 Gail McMoran, President
 200 MARTEL MONTE PARNASSY, SUITE C
 ESCONTO, CA 92527
 PHONE: (760) 492-2247
 CELL: (760) 493-3728

PROJECT NAME: TL23071 - SYCAMORE CANYON SUBSTATION TO PENASQUITOS - 230 KV UNDERGROUND
 AIRX JOB#X160218
 THOMAS GRID#:
 TYPE OF WORK: RENEWING / CONDUIT
 MISC./POTHOLE#:

DATE: Mar. 21, 2017
 DESIGNED BY:
 Clint Jones

**ORIGINAL PERMIT MUST
BE KEPT
ON JOB SITE ALL TIMES**

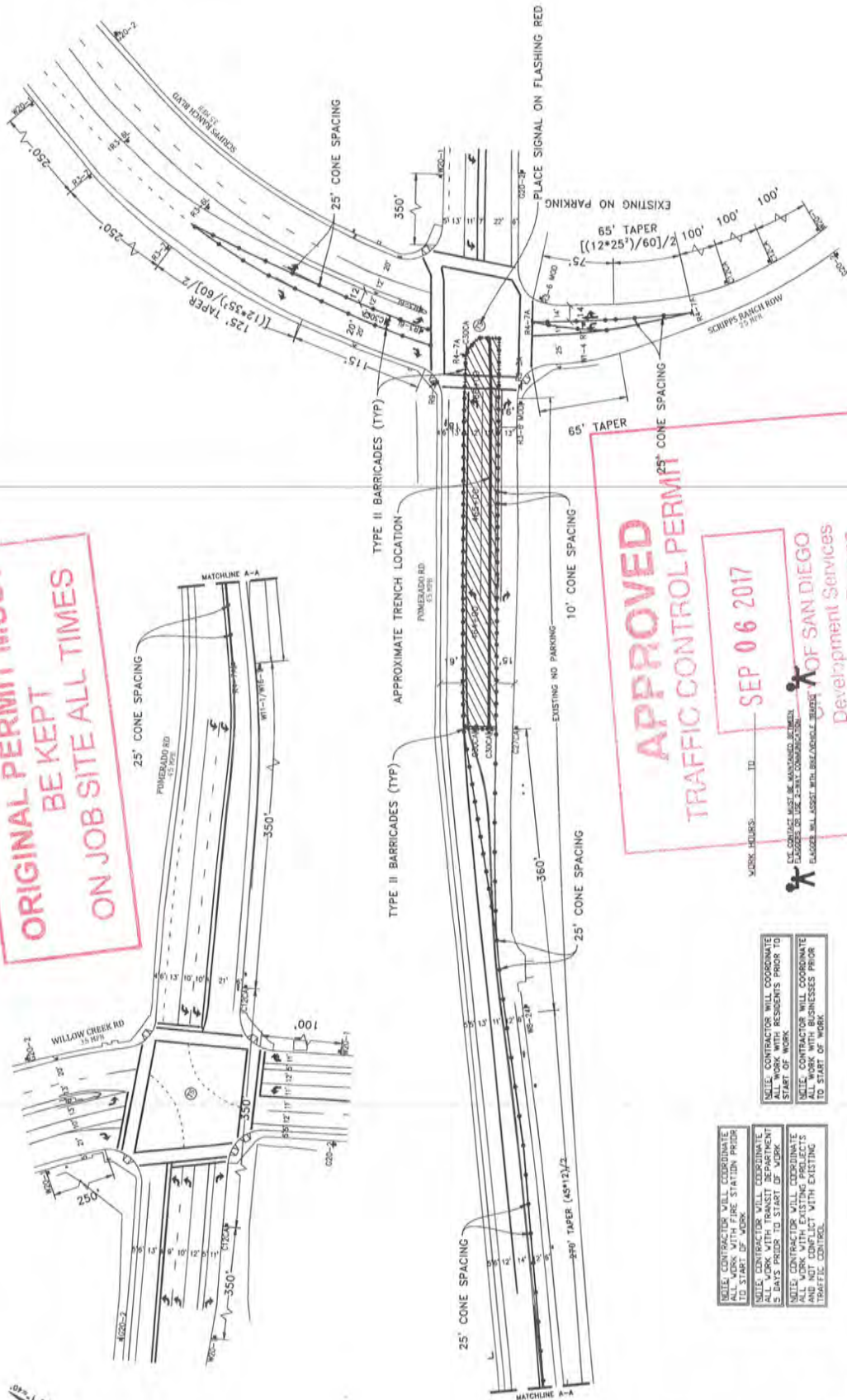

PHASE 87

DATE: Mar. 21, 2017
DESIGNED BY:
Clint Jones

PROJECT NAME: TL23071 - SYCAMORE CANYON SUBSTATION TO
PENASQUITOS - 230 KV UNDERGROUND
AIRX JOB#: X150218
TYPE OF WORK: TRENCHING / CONDUIT
MISC./POTHOLES#: THOMAS GRID#-
DRAWN FOR: CALTRANS

AIRX
UTILITY SERVICES, INC.
304 EAST EL MONTE PARKWAY, SUITE C
ESCONDIDO, CA 92027
PHONE: (760) 488-2847
CELL: (760) 418-0788

Gail McMoran
President

**APPROVED
TRAFFIC CONTROL PERMIT**

SEP 06 2017

OFFICE OF THE CITY ENGINEER
CITY OF SAN DIEGO
Development Services
Engineering Division
Traffic Safety Section

WORK HOURS: _____ TO _____
FLAGGER WILL ASSESS TRAFFIC SIGNALS PRIOR TO START OF WORK.

NOTE: CONTRACTOR WILL COORDINATE ALL WORK WITH RESIDENTS PRIOR TO START OF WORK.
NOTE: CONTRACTOR WILL COORDINATE ALL WORK WITH TRANSIT DEPARTMENT 5 DAYS PRIOR TO START OF WORK.
NOTE: CONTRACTOR WILL COORDINATE ALL WORK WITH BUSINESSES PRIOR TO START OF WORK.
NOTE: CONTRACTOR WILL COORDINATE ALL WORK WITH BUSINESSES PRIOR TO START OF WORK.

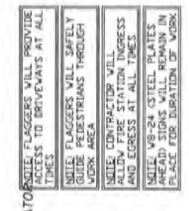
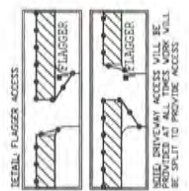

DATE: Mar. 21, 2017
DESIGNED BY:
Clint Jones

SHEET 103 OF 148

ORIGINAL PERMIT MUST BE KEPT ON JOB SITE ALL TIMES

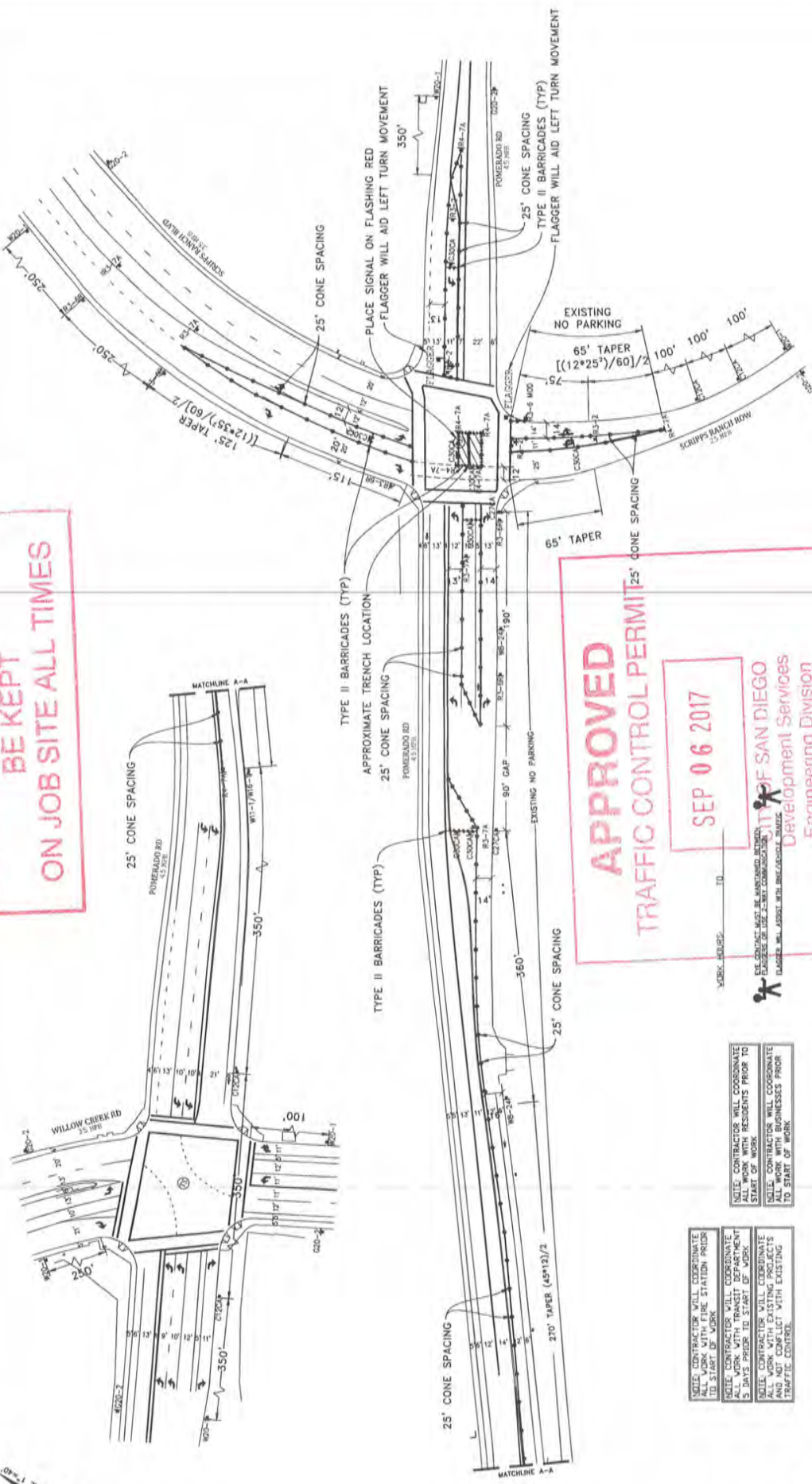

APPROVED
TRAFFIC CONTROL PERMIT
SEP 06 2017

MARK HOLES: _____ TO _____

FLAGGER WILL ASSIST WITH RELOCATING MARKS

NOTE: CONTRACTOR WILL COORDINATE ALL WORK WITH RESIDENTS PRIOR TO START OF WORK

NOTE: CONTRACTOR WILL COORDINATE ALL WORK WITH TRANSIT DEPARTMENT 5 DAYS PRIOR TO START OF WORK

NOTE: CONTRACTOR WILL COORDINATE ALL WORK WITH EXISTING PROJECTS AND CONDUCT WITH EXISTING TRAFFIC CONTROL

DETAIL: FLAGGER ACCESS

NOTE: CONTRACTOR WILL COORDINATE ACCESS TO DRIVEWAYS AT ALL TIMES

NOTE: CONTRACTOR WILL COORDINATE WITH PEDESTRIANS THROUGH WORK AREA

NOTE: CONTRACTOR WILL ALLOW FIRE STATION INGRESS AND EGRESS AT ALL TIMES

NOTE: CONTRACTOR WILL PLACE 24" x 48" GULCH PLATES IN PLACE FOR BARRIAGE OF WORK

- LEGEND**
- 1 SIGN
 - TRAFFIC CONES / DELINEATOR
 - z BARRICADE
 - 1 FLAGGER
 - FLASHING ARROW SIGN
 - WORK ZONE
 - BUS STOP

PHASE 88

DATE: Mar. 21, 2017
 DESIGNED BY: Clint Jones
 SHEET 104 OF 148

PROJECT NAME: TL23071 - SYCAMORE CANYON SUBSTATION TO PENASQUITOS - 230 KV UNDERGROUND
 AIRX JOB#X160218
 TYPE OF WORK: RENEWING / CONDUIT
 MISC./POTHOLE#:

AIRX
 UTILITY SERVICES, INC.
 10000 WILLOW PARKWAY, SUITE C
 BROOMFIELD, CO 80020
 PHONE: (781) 492-5247
 CELL: (781) 419-3728

Gail McMoran
 President

THOMAS GRID#-
 DRAWN FOR: CALTRANS

APPROVED
TRAFFIC CONTROL PERMIT
SEP 06 2017

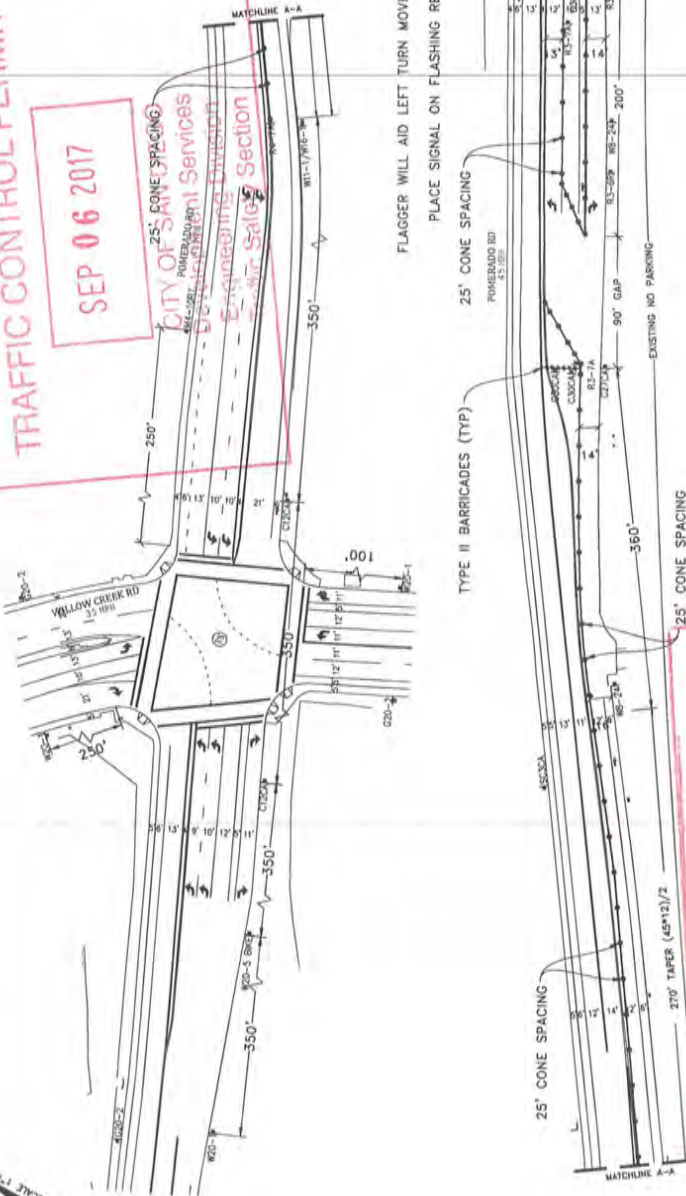

ORIGINAL PERMIT MUST BE KEPT ON JOB SITE ALL TIMES

- LEGEND**
- 1 SIGN
 - TRAFFIC CONES / DELINEATOR
 - I BARRICADE
 - 1 FLAGGER
 - 1 FLASHING ARROW SIGN
 - 1 WORK ZONE
 - 1 BUS STOP

NOTE: CONTRACTOR WILL COORDINATE ALL WORK WITH RESIDENTS PRIOR TO START OF WORK.

NOTE: CONTRACTOR WILL COORDINATE ALL WORK WITH BUSINESSES PRIOR TO START OF WORK.

NOTE: CONTRACTOR WILL COORDINATE ALL WORK WITH TRANSIT DEPARTMENT 5 DAYS PRIOR TO START OF WORK.

NOTE: CONTRACTOR WILL COORDINATE ALL WORK WITH EXISTING PROJECTS THROUGHOUT THE PROJECT DURATION.

NOTE: CONTRACTOR WILL PROVIDE ALL TRAFFIC SIGNS AT ALL TIMES.

NOTE: FLAGGERS WILL SAFELY GUIDE PEDESTRIANS THROUGH WORK AREA.

NOTE: CONTRACTOR WILL PLACE AND REMOVE ALL SIGNS AT ALL TIMES.

NOTE: ALL 24 HOUR SIGNS WILL REMAIN IN PLACE FOR DURATION OF WORK.

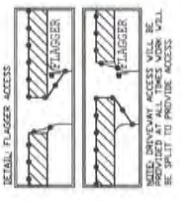

SEE CONTRACT PERMIT FOR WORK ZONE BARRICADES OF THE 2.0 MILE COMMUNICATION FLAGGERS WILL ASSIST WITH BUS/LOADABLE TRUCKS

PHASE 89

DATE: Mar. 21, 2017
 DESIGNED BY: Clint Jones
 SHEET 105 OF 148

PROJECT NAME: TL23071 - SYCAMORE CANYON SUBSTATION TO PENASQUITOS - 230 KV UNDERGROUND
 AIRX JOB#: X160218
 TYPE OF WORK: FENCING / CONDUIT
 MISC/POTHoles: #

AIRX SURVEYORS, INC.
 Gail McMoran, President
 1000 EAST WILSON AVENUE, SUITE C
 ESCOBEDO, CA 92827
 PHONE: (951) 485-2247
 CELL: (951) 418-0758

THOMAS GRID#-
 DRAWN FOR: CALTRANS



ORIGINAL PERMIT MUST BE KEPT ON JOB SITE ALL TIMES

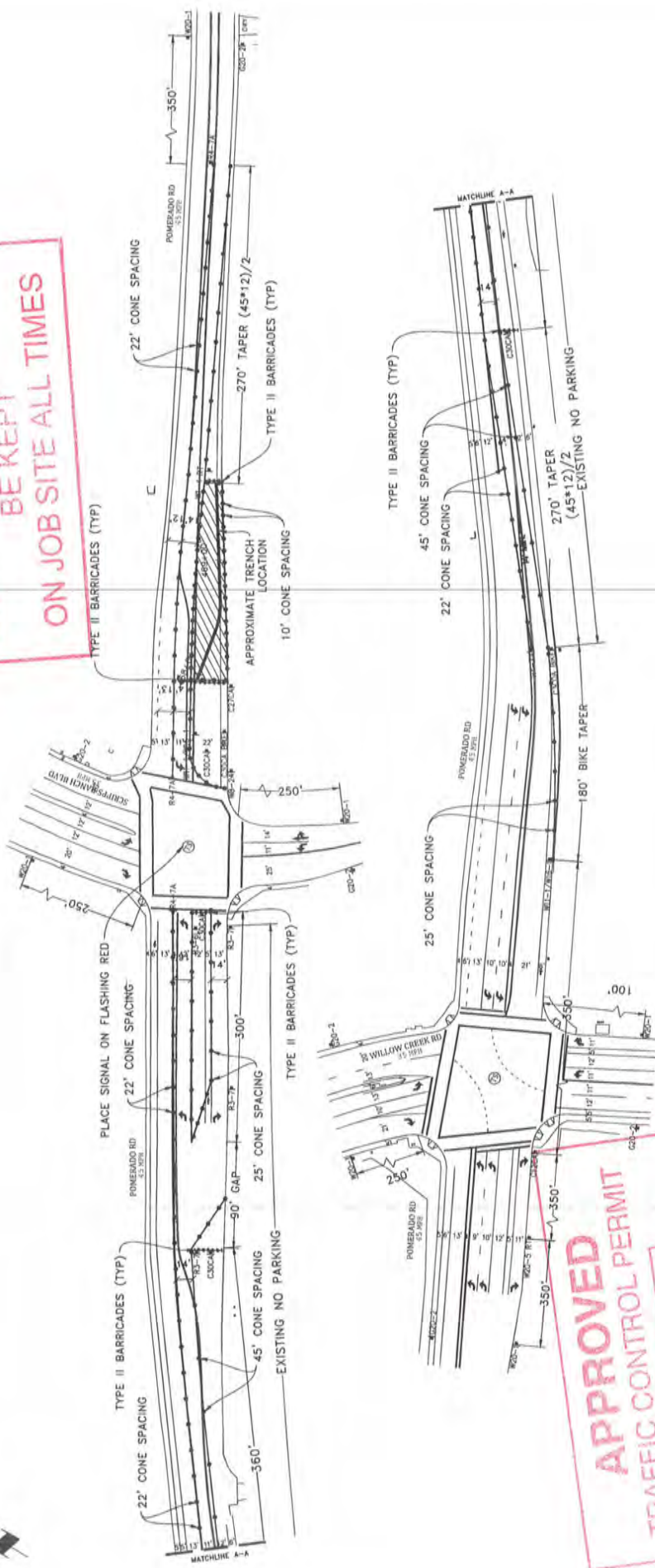

APPROVED
TRAFFIC CONTROL PERMIT
SEP 06 2017

- LEGEND**
- 1 SIGN
 - 2 TRAFFIC CONES / DELINEATOR
 - 3 BARRICADE
 - 4 FLAGGER
 - 5 FLASHING ARROW SIGN
 - 6 WORK ZONE
 - 7 BUS STOP

- 8 DETAIL FLAGGER ACCESS
 - 9 FLAGGER
 - 10 FLAGGER
- NOTE: DRIVEWAY ACCESS WILL BE SPLIT TO PROVIDE ACCESS

NOTE: CONTRACTOR WILL COORDINATE ALL WORK WITH FIRE STATION PRIOR TO START OF WORK.

NOTE: CONTRACTOR WILL COORDINATE ALL WORK WITH TRANSIT DEPARTMENT 5 DAYS PRIOR TO START OF WORK.

NOTE: CONTRACTOR WILL COORDINATE ALL WORK WITH EXISTING TRAFFIC CONTROL.

NOTE: CONTRACTOR WILL COORDINATE ALL WORK WITH REGIONS PRIOR TO START OF WORK.

NOTE: CONTRACTOR WILL COORDINATE ALL WORK WITH BUSINESSES PRIOR TO START OF WORK.

NOTE: CONTRACTOR MUST BE MAINTAINED BETWEEN FLAGGERS OR USE 3-FLAG COMMUNICATION.

FLAGGER WILL ASSIST WITH INEVITABLE TRAFFIC.

WORK HOURS TO



SEE CONTRACT MUST BE MAINTAINED BETWEEN FLAGGERS OR USE 3-FLAG COMMUNICATION.

FLAGGER WILL ASSIST WITH INEVITABLE TRAFFIC.

PHASE 90

DATE: Mar. 21, 2017
 DESIGNED BY: Clint Jones
 SHEET 106 OF 148

PROJECT NAME: TL23071 - SYCAMORE CANYON SUBSTATION TO PENASQUITOS - 230 KV UNDERGROUND

AIRX JOB #X160218

TYPE OF WORK: RENEWING / CONDUIT

MISC./POTHOLE #:

THOMAS GRID#:

DRAWN FOR: CALTRANS

Gail McMoran, President
 AIRX SURVEYORS, INC.
 2004 EAST EL MONTE PARKWAY, SUITE C
 EL MONTE, CA 91734
 PHONE: (909) 483-8247
 CELL: (909) 493-3728

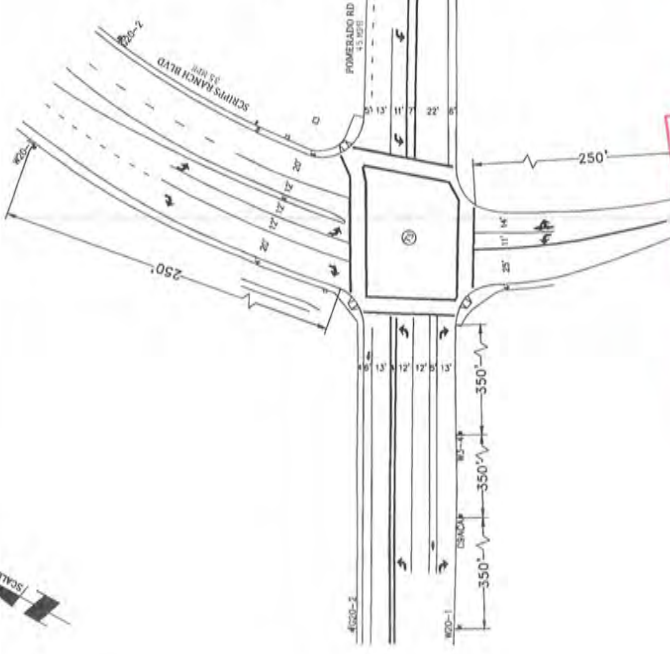

ORIGINAL PERMIT MUST
BE KEPT
ON JOB SITE ALL TIMES

APPROVED
TRAFFIC CONTROL PERMIT

SEP 06 2017

CITY OF SAN DIEGO
Development Services
Engineering Division

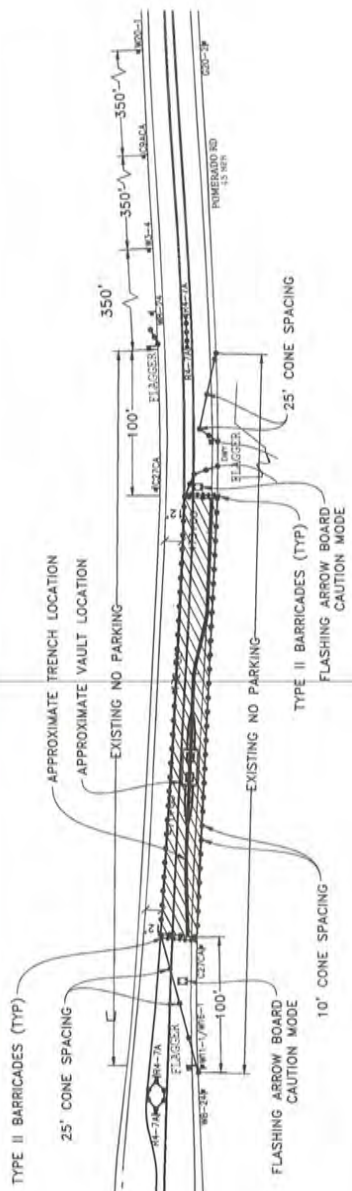

SCALE VAULT INSTALL AND TRENCHING WILL BE CONSTRUCTED IN SEPARATE PHASES

NOTE: CONTRACTOR WILL COORDINATE ALL WORK WITH FIRE STATION PRIOR TO START OF WORK

NOTE: CONTRACTOR WILL COORDINATE ALL WORK WITH RESIDENTS PRIOR TO START OF WORK

NOTE: CONTRACTOR WILL COORDINATE ALL WORK WITH BUSINESSES PRIOR TO START OF WORK

NOTE: CONTRACTOR WILL COORDINATE ALL WORK WITH RESIDENTS PRIOR TO START OF WORK

NOTE: CONTRACTOR WILL COORDINATE ALL WORK WITH BUSINESSES PRIOR TO START OF WORK

- LEGEND**
- 1 SIGN
 - 1 TRAFFIC CONES / DELINEATOR
 - 1 BARRICADE
 - 1 FLAGGER
 - 1 FLASHING ARROW SIGN
 - 1 WORK ZONE
 - 1 BUS STOP

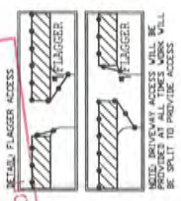

NOTE: CONTRACTOR WILL COORDINATE ALL WORK WITH RESIDENTS PRIOR TO START OF WORK

NOTE: CONTRACTOR WILL COORDINATE ALL WORK WITH BUSINESSES PRIOR TO START OF WORK

WORK SHEETS: TO

NOTE: CONTRACTOR MUST BE MAINTAINED BETWEEN FLAGGER OR USE 3-MINUTE COMMUNICATION

FLAGGER WILL ASSIST WITH BUS/VEHICLE TRAFFIC

PHASE 91

DATE: Mar. 21, 2017
DESIGNED BY: Clint Jones
SHEET 107 OF 148

PROJECT NAME: TL23071 - SYCAMORE CANYON SUBSTATION TO PENASQUITOS - 230 KV UNDERGROUND

AIRX JOB#: X160218

TYPE OF WORK: TRENCHING / CONDUIT

MISC./POTHOLE#:

DESIGNED BY: Gail McMoran, President

THOMAS GRID#:

DRAWN FOR: CALTRANS

PHONE: (760) 499-5247

CELL: (760) 419-5738

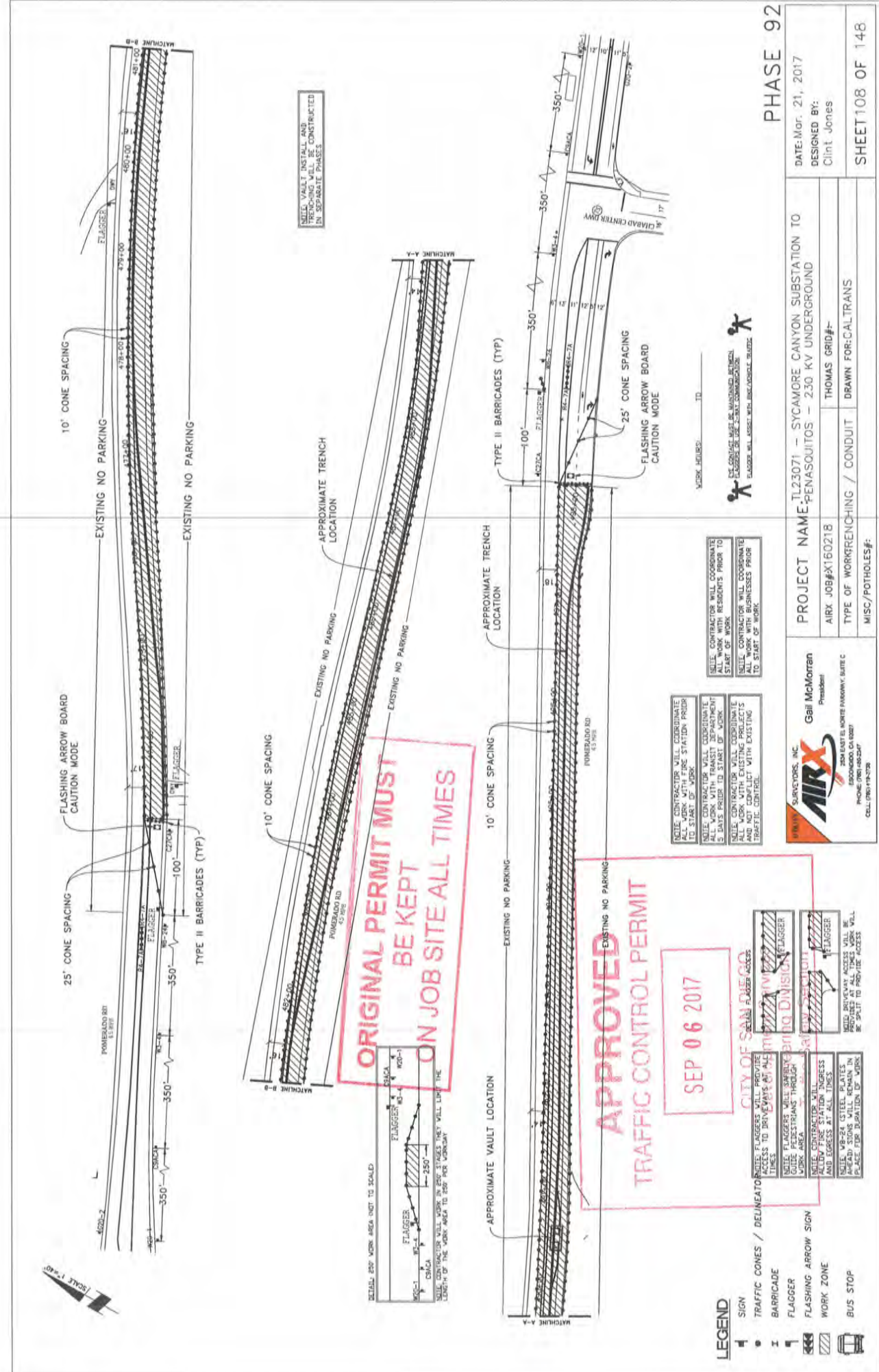

NOTE: VAULT INSTALL AND TRENCHING WILL BE CONSTRUCTED IN SEPARATE PHASES

ORIGINAL PERMIT MUST BE KEPT ON JOB SITE ALL TIMES

APPROVED TRAFFIC CONTROL PERMIT
 SEP 06 2017

- LEGEND**
- 1 SIGN
 - 2 TRAFFIC CONES / DELINEATOR
 - 3 BARRICADE
 - 4 FLAGGER
 - 5 FLASHING ARROW SIGN
 - 6 WORK ZONE
 - 7 BUS STOP

NOTE: CONTRACTOR WILL PROVIDE ALL MATERIALS TO BE USED ON THIS PROJECT. ALL MATERIALS SHALL BE STORED IN A SECURE AREA AND SHALL BE PROTECTED FROM THE ELEMENTS. ALL MATERIALS SHALL BE KEPT IN THE WORK AREA TO BE USED FOR WORK.

NOTE: CONTRACTOR WILL PROVIDE ALL MATERIALS TO BE USED ON THIS PROJECT. ALL MATERIALS SHALL BE STORED IN A SECURE AREA AND SHALL BE PROTECTED FROM THE ELEMENTS. ALL MATERIALS SHALL BE KEPT IN THE WORK AREA TO BE USED FOR WORK.

NOTE: CONTRACTOR WILL PROVIDE ALL MATERIALS TO BE USED ON THIS PROJECT. ALL MATERIALS SHALL BE STORED IN A SECURE AREA AND SHALL BE PROTECTED FROM THE ELEMENTS. ALL MATERIALS SHALL BE KEPT IN THE WORK AREA TO BE USED FOR WORK.

NOTE: CONTRACTOR WILL COORDINATE ALL WORK WITH RESIDENTS PRIOR TO START OF WORK.

NOTE: CONTRACTOR WILL COORDINATE ALL WORK WITH BUSINESSES PRIOR TO START OF WORK.

NOTE: CONTRACTOR WILL MAINTAIN ALL WORK WITH RESIDENTS PRIOR TO START OF WORK.

NOTE: CONTRACTOR WILL MAINTAIN ALL WORK WITH BUSINESSES PRIOR TO START OF WORK.

DATE: Mar. 21, 2017
 DESIGNED BY: Clint Jones
 SHEET 108 OF 148

PHASE 92

PROJECT NAME: TL23071 - SYCAMORE CANYON SUBSTATION TO PENASQUITOS - 230 KV UNDERGROUND
 AIRX JOB# X160218
 TYPE OF WORK: FENCING / CONDUIT
 MISC./POTHOLES#:

GAEL MCMORRAN
 President
 AIRX
 15000 BAYVIEW PARKWAY, SUITE C
 ESCONDIDO, CA 92027
 PHONE: (951) 985-2447
 CELL: (951) 918-5708

THOMAS GRID#:
 DRAWN FOR: CALTRANS

DATE: Mar. 21, 2017
 DESIGNED BY: Clint Jones
 SHEET 108 OF 148



ORIGINAL PERMIT MUST BE KEPT ON JOB SITE ALL TIMES

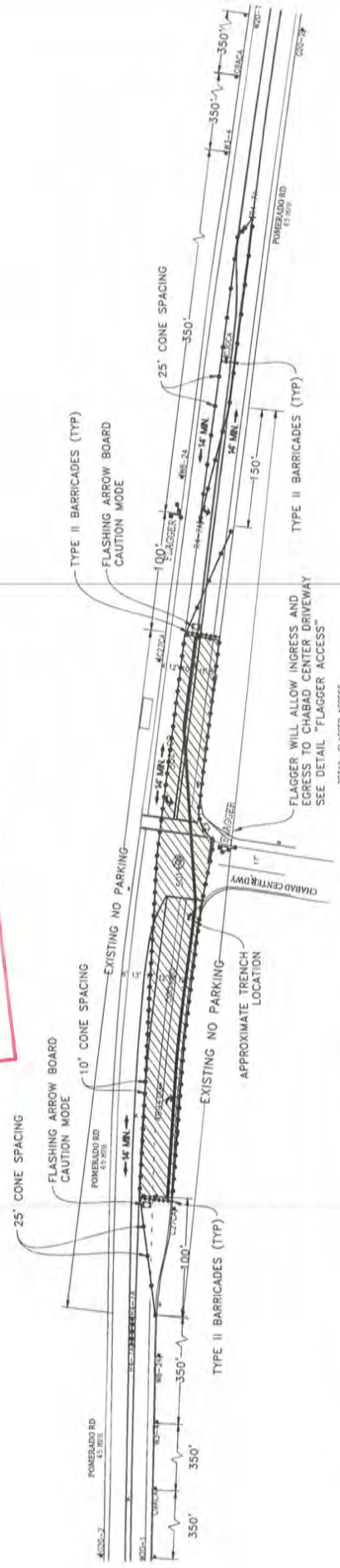

APPROVED TRAFFIC CONTROL PERMIT
SEP 06 2017
 CITY OF SAN DIEGO
 Development Services
 Engineering Division
 Traffic Safety Section

LEGEND

	SIGN
	TRAFFIC CONES / DELINEATORS
	BARRICADE
	FLAGGER
	FLASHING ARROW SIGN
	WORK ZONE
	BUS STOP

NOTE: CONTRACTOR WILL COORDINATE ALL WORK WITH TRANSIT DEPARTMENT 5 DAYS PRIOR TO START OF WORK.
 NOTE: CONTRACTOR WILL COORDINATE ALL WORK WITH BUSINESSES PRIOR TO START OF WORK.
 NOTE: CONTRACTOR WILL COORDINATE ALL WORK WITH BUSINESSES PRIOR TO START OF WORK.

NOTE: CONTRACTOR WILL COORDINATE ALL WORK WITH TRANSIT DEPARTMENT 5 DAYS PRIOR TO START OF WORK.
 NOTE: CONTRACTOR WILL COORDINATE ALL WORK WITH BUSINESSES PRIOR TO START OF WORK.

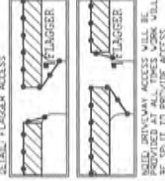

FLAGGER WILL ALLOW INGRESS AND EGRESS TO CHAD CENTER DRIVEWAY. SEE DETAIL FLAGGER ACCESS.

WORK HOURS: _____ TO _____
 IF ANY WORK IS PERFORMED BETWEEN FLAGGERS, SEE JOB PLAN COMMUNICATION.
 FLAGGER WILL ASSIST WITH BARRICADE REBARRIC.

DATE: Mar. 15, 2017
DESIGNED BY: Clint Jones
SHEET 109 OF 148

AIRX SURVEYORS, INC. 3800 MARTEL MORE PARKWAY, SUITE G ESCONDIDO, CA 92027 PHONE: (760) 420-2487 CELL: (760) 418-3728	Gail McMorran President
	PROJECT NAME: TL23071 - SYCAMORE CANYON SUBSTATION TO PENASQUITOS - 230 KV UNDERGROUND AIRX JOB#: X160218 TYPE OF WORK: RENCHING / CONDUIT MISC./POTHOLES#:

PROJECT NAME: TL23071 - SYCAMORE CANYON SUBSTATION TO PENASQUITOS - 230 KV UNDERGROUND AIRX JOB#: X160218 TYPE OF WORK: RENCHING / CONDUIT MISC./POTHOLES#:	THOMAS GRID#: DRAWN FOR: CALTRANS
--	--------------------------------------

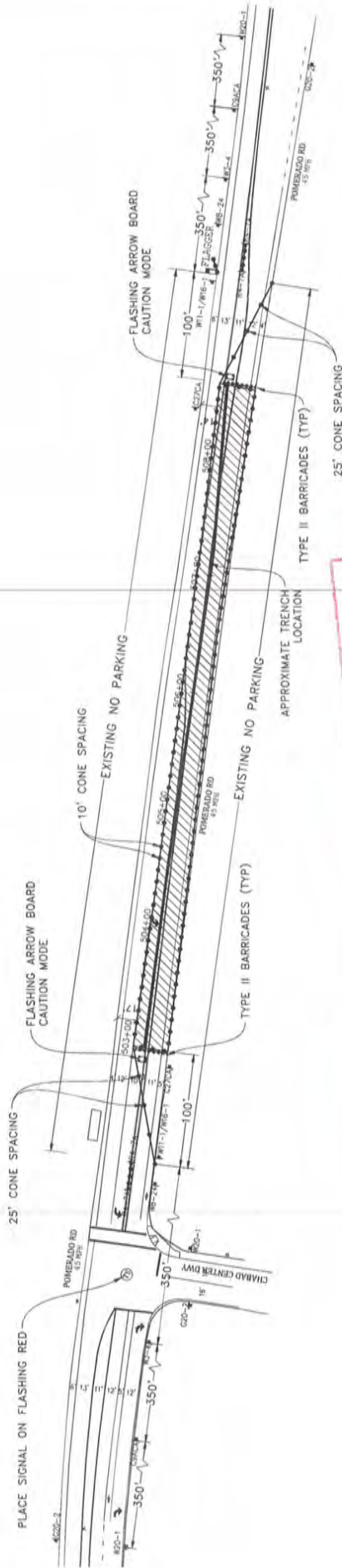

APPROVED
TRAFFIC CONTROL PERMIT
SEP 06 2017
 CITY OF SAN DIEGO
 Development Services
 Engineering Division
 Traffic Safety Section

ORIGINAL PERMIT MUST
BE KEPT
ON JOB SITE ALL TIMES

- LEGEND**
- SIGN
 - TRAFFIC CONES - DELINEATOR
 - BARRICADE
 - FLAGGER
 - FLASHING ARROW SIGN
 - WORK ZONE
 - BUS STOP

TRAFFIC CONES - DELINEATOR
 FLAGGERS WILL PROVIDE ACCESS TO DRIVERS AT ALL TIMES
 FLAGGERS WILL SAFELY GUIDE PEDESTRIANS THROUGH WORK AREA
 CONTRACTOR WILL MAINTAIN ACCESS AND EGRESS AT ALL TIMES
 STEEL OR SA STEEL BRACKET PRELAPED SIGNS WILL REMAIN IN PLACE FOR DURATION OF WORK

NOTE: CONTRACTOR WILL COORDINATE ALL WORK WITH TRANSIT DEPARTMENT 5 DAYS PRIOR TO START OF WORK
 NOTE: CONTRACTOR WILL COORDINATE ALL WORK WITH BUSINESSSES PRIOR TO START OF WORK
 NOTE: CONTRACTOR WILL COORDINATE ALL WORK WITH BUSINESSSES PRIOR TO START OF WORK

NOTE: CONTRACTOR WILL COORDINATE ALL WORK WITH RESIDENTS PRIOR TO START OF WORK
 NOTE: CONTRACTOR WILL COORDINATE ALL WORK WITH BUSINESSSES PRIOR TO START OF WORK

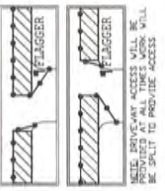

UTILITY SURVEYORS, INC.
AIRX
 GAIL MCMORAN
 President
 4000 W. TELMERE PARKWAY, SUITE C
 ESCROWED ON FILE
 PHONE: (760) 940-5247
 CELL: (951) 418-3728

PROJECT NAME	TL23071 - SYCAMORE CANYON SUBSTATION TO PEVASQUITOS - 230 KV UNDERGROUND
AIRX JOB#	X150218
THOMAS GRID#	
TYPE OF WORK	FENCING / CONDUIT
MISC./POTHLES#	DRAWN FOR: CALTRANS