



L64A-005

Project Information

Project Nbr: 500372 **Title:** Activity Road - Water ROW
Project Mgr: White, Nathan (619)446-5481 NGWhite@sandiego.gov



Approval Information

Approval Nbr: 17 52782 **Type:** Right Of Way Permit **Status:** Pending Invoice Payment
Issued: 04/13/2017 3:02 pm **Issued By:** Gonzalez, Dolores **Permit Holder:** NICHOLS , JEREMY
Completed: **Completed By:** **Owner Occupied:** **Overridden:**
Extension Qty: 0 **Extended By:** **Cancel Reason:**
Scope: Right of Way permit for the trenching and relocation of an existing water main in preparation for the installation of new SDG&E 230kV underground precast vault. **Precancel Status:**
Land Doc Type:
Recorded Map No.:
Recorded Date:
SDF = \$18,805.00



Job Location (39559-D ROW)

Address Assessor Parcel
9115 1/3 ACTIVITY RD

Fee Type Units

Fee Type	Amount
Cost Estimate - LDR	123,480.00
Cost Estimate - Grading	43,426.00
Cost Estimate - Public Improv	74,134.00

Fee Worksheet

Fee	Quantity	Unit	Category
Issuance-With Plans	0.00	Each	Issuance Fees
Records-EngGrad & Public Imprv	0.00	Each	Issuance Fees
Street Damage Fee 2014	0.00	Dollars	Issuance Fees

Permit Expires 4/13/19

GENERAL NOTES

- APPROVAL OF THESE PLANS BY THE CITY ENGINEER DOES NOT AUTHORIZE ANY WORK TO BE PERFORMED UNTIL A PERMIT HAS BEEN ISSUED.
- UPON ISSUANCE OF A PERMIT, NO WORK WILL BE PERMITTED ON WEEKENDS OR HOLIDAYS UNLESS APPROVED BY TRAFFIC CONTROL PERMIT FROM THE DEVELOPMENT SERVICES DEPARTMENT.
- THE APPROVAL OF THIS PLAN OR ISSUANCE OF A PERMIT BY THE CITY OF SAN DIEGO DOES NOT AUTHORIZE THE UTILITY COMPANY TO VIOLATE ANY FEDERAL, STATE OR CITY LAWS, ORDINANCES, REGULATIONS, OR POLICIES.
- IMPORTANT NOTICE: SECTION 4216 OF THE GOVERNMENT CODE REQUIRES A DIG ALERT IDENTIFICATION NUMBER ISSUED BEFORE A "PERMIT TO EXCAVATE" WILL BE VALID. FOR YOUR DIG ALERT I.D. NUMBER, CALL UNDERGROUND SERVICE ALERT, TOLL FREE (800) 422-4133, TWO DAYS BEFORE YOU DIG.
- CONTRACTOR SHALL BE RESPONSIBLE FOR POTHOLING AND LOCATING ALL EXISTING UTILITIES THAT CROSS THE PROPOSED TRENCH LINE WHILE MAINTAINING A 1 FOOT VERTICAL CLEARANCE.
- "PUBLIC IMPROVEMENT SUBJECT TO DESUETUDE OR DAMAGE." IF REPAIR OR REPLACEMENT OF SUCH PUBLIC IMPROVEMENTS IS REQUIRED, CONTRACTOR SHALL OBTAIN THE REQUIRED PERMITS FOR WORK IN THE PUBLIC RIGHT-OF-WAY, SATISFACTORY TO THE PERMIT ISSUING AUTHORITY.
- DEVIATIONS FROM THESE SIGNED PLANS WILL NOT BE ALLOWED UNLESS A CONSTRUCTION CHANGE IS APPROVED BY THE CITY ENGINEER OR THE CHANGE IS REQUIRED BY THE RESIDENT ENGINEER.
- CONTRACTOR SHALL REPLACE OR REPAIR ALL TRAFFIC SIGNAL LOOPS, CONDUITS, AND LANE STRIPPING DAMAGED DURING CONSTRUCTION.
- PRIOR TO SITE DISTURBANCE, CONTRACTOR SHALL MAKE ARRANGEMENTS FOR A PRECONSTRUCTION MEETING WITH THE CITY OF SAN DIEGO, CONSTRUCTION MANAGEMENT AND FIELD ENGINEERING DIVISION (858) 627-3200.
- CONTRACTOR MAY PERFORM SITE SURVEY AND UTILITY MARK OUT SERVICES PRIOR TO THE PRECONSTRUCTION MEETING.
- PRIOR TO DEMOLITION, CONTRACTOR SHALL FURNISH THE RESIDENT ENGINEER WITH A LETTER FROM A LICENSED LAND SURVEYOR THAT HAS RESEARCHED AVAILABLE RECORDS AND FIELD INSPECTED THE SITE, STATING THAT NO SURVEY MONUMENTS EXIST IN THE AREA TO DEMOLISH OR WILL BE DISTURBED OR DESTROYED DURING CONSTRUCTION.
- IF ANY VERTICAL CONTROL IS TO BE DISTURBED OR DESTROYED, THE CITY OF SAN DIEGO FIELD SURVEY SECTION SHALL BE NOTIFIED IN WRITING AT LEAST 7 DAYS PRIOR TO CONSTRUCTION. THE CONTRACTOR SHALL BE RESPONSIBLE FOR THE COST OF REPLACING VERTICAL CONTROL BENCHMARKS DESTROYED BY CONSTRUCTION.
- CONTRACTOR IS RESPONSIBLE FOR THE COST OF REPLACING ALL SURVEY MONUMENTS WHICH ARE DAMAGED OR DESTROYED BY CONSTRUCTION.
- PRIOR TO CONSTRUCTION, SURVEY MONUMENTS THAT ARE LOCATED IN THE CONSTRUCTION AREA SHALL BE TIED-OUT AND REFERENCED BY A LAND SURVEYOR.
- UPON COMPLETION OF CONSTRUCTION, ALL DESTROYED SURVEY MONUMENTS ARE REQUIRED TO BE REPLACED, AND A CORNER RECORD OR RECORD OF SURVEY SHALL BE PREPARED AND FILED WITH THE COUNTY SURVEYOR AS REQUIRED BY THE PROFESSIONAL LAND SURVEYOR ACT, SECTION 8771 OF THE BUSINESS AND PROFESSIONS CODE OF THE STATE OF CALIFORNIA.
- CONTRACTOR SHALL IMPLEMENT AN EROSION CONTROL PROGRAM DURING THE PROJECT CONSTRUCTION ACTIVITIES. THE PROGRAM SHALL COMPLY WITH ALL APPLICABLE REQUIREMENTS OF THE STATE WATER RESOURCE CONTROL BOARD.
- CONTRACTOR SHALL HAVE EMERGENCY MATERIAL AND EQUIPMENT ON HAND FOR UNFORESEEN SITUATIONS, SUCH AS DAMAGE TO UNDERGROUND WATER, SEWER, AND STORM DRAIN FACILITIES WHERE FLOW MAY GENERATE EROSION AND SEDIMENT POLLUTION.
- MANHOLES AND PULL BOX COVER SHALL BE LABELED "NAME OF COMPANY."

GROUND WATER DISCHARGE NOTES

- ALL GROUND WATER EXTRACTIONS AND SIMILAR WASTE DISCHARGES TO SURFACE WATERS NOT TRIBUTARY TO THE SAN DIEGO BAY ARE PROHIBITED UNTIL IT CAN BE DEMONSTRATED THAT THE OWNER HAS APPLIED AND OBTAINED AUTHORIZATION FROM THE STATE OF CALIFORNIA VIA AN OFFICIAL "ENROLLMENT LETTER" FROM THE REGIONAL WATER QUALITY CONTROL BOARD IN ACCORDANCE WITH THE TERMS, PROVISIONS AND CONDITIONS OF STATE ORDER NO R9-2015-0013 NPDES CAG919003.
- THE ESTIMATED MAXIMUM DISCHARGE RATES MUST NOT EXCEED THE LIMITS SET IN THE OFFICIAL "ENROLLMENT LETTER" FROM THE REGIONAL BOARD UNLESS PRIOR NOTIFICATION AND SUBSEQUENT AUTHORIZATION HAS BEEN OBTAINED, AND DISCHARGE OPERATIONS MODIFIED TO ACCOMMODATE THE INCREASED RATES.
- ALL GROUND WATER EXTRACTIONS AND SIMILAR WASTE DISCHARGES TO SURFACE WATERS TRIBUTARY TO THE SAN DIEGO BAY ARE PROHIBITED UNTIL IT CAN BE DEMONSTRATED THAT THE OWNER HAS APPLIED AND OBTAINED AUTHORIZATION FROM THE STATE OF CALIFORNIA VIA AN OFFICIAL "ENROLLMENT LETTER" FROM THE REGIONAL WATER QUALITY CONTROL BOARD IN ACCORDANCE WITH THE TERMS, PROVISIONS AND CONDITIONS OF STATE ORDER NO R9-2015-0013 NPDES NO. CAG919003.

STREET NAME	STREET CLASSIFICATION (ARTERIAL, MAJOR, COLLECTOR, RESIDENTIAL)	UTILITY TYPE (WET OR DRY)	LATERAL OR MAIN	STREET SERVICE AGE (YRS)	INFLUENCE AREA WIDTH (FT) PER SOWC 62.1208	TRENCH WIDTH (FT)	TRENCH LENGTH (FT)
TRADE STREET	COLLECTOR	WET	MAIN	8	15.6	2	231
ACTIVITY ROAD	COLLECTOR	WET	MAIN	10	16.6	3	107
ACTIVITY ROAD	COLLECTOR	WET	LATERAL	10	15.1	1.5	29

NOTE: CURB TO CURB RESURFACING FOR TRADE STREET AND ACTIVITY ROAD TO BE PERFORMED BY PTS NO. 528580 / APPROVAL NO. 1857532

TRADE STREET: ALL EXCAVATIONS SHALL BE SLURRY SEALED FROM CURB TO CURB, OR RAISED MEDIAN IN ORDER TO PRESERVE THE EXISTING STREET CONDITION, TO SATISFACTION OF RESIDENT ENGINEER. NOT LIMITED TO MAINS OR LATERALS, TO INCLUDE APPURTENANCES. RESIDENT ENGINEER HAS THE AUTHORITY TO DIRECT ADDITIONAL PAVEMENT REPAIRS BEYOND INFLUENCE AREA, PRIOR TO SLURRY WORK, TO RESTORE SURFACE TO ORIGINAL CONDITION, AND ENSURE PUBLIC SAFETY.

ACTIVITY ROAD: THE EXCAVATION IS IN THE DIRECTION OF TRAFFIC. THE EXCAVATOR SHALL RESURFACE THE ENTIRE EXCAVATION AREA PLUS THE EXCAVATION INFLUENCE AREA ON EACH END OF THE EXCAVATION AREA, AND THE ENTIRE WIDTH OF THE STREET FROM CURB TO CURB OR WHERE A RAISED MEDIAN IS PRESENT THE EXCAVATOR SHALL RESURFACE FROM CURB LINE TO RAISE MEDIAN. THE INFLUENCE AREA EXTENDED AROUND THE PERIMETER OF THE EXCAVATION IS 82 INCHES.

IMPROVEMENT PLANS FOR:

**UTILITY RELOCATION
TRADE STREET AND
ACTIVITY ROAD**

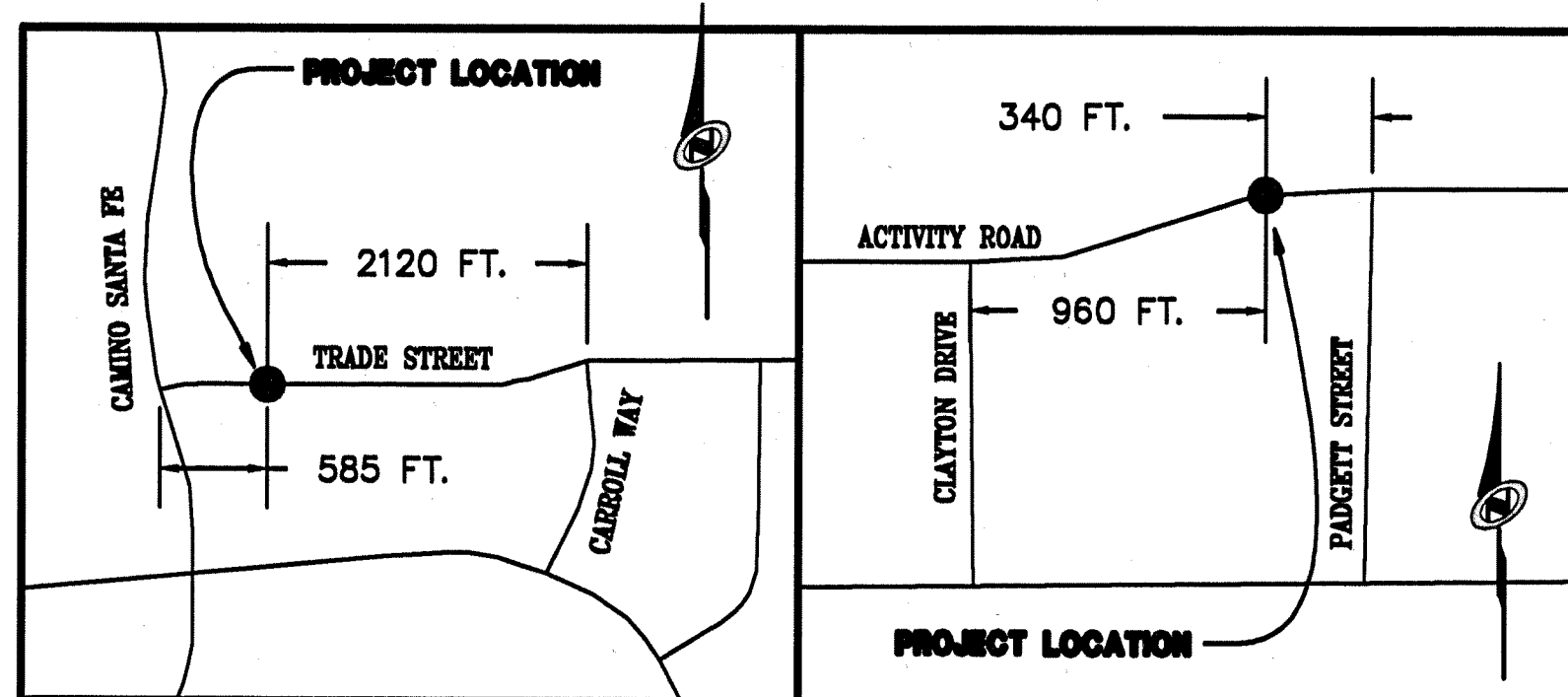

KEY MAP

NO SCALE

LEGEND (CONTINUED)

EXISTING IMPROVEMENTS

ITEM	SYMBOL
TELECOM RISER	[Symbol]
POWER POLE	[Symbol]
TRAFFIC SIGN	[Symbol]
BACKFLOW PREVENTER	[Symbol]
SEWER MANHOLE	[Symbol]
IRRIGATION BOX	[Symbol]
ELECTRICAL POLE BOX	[Symbol]
STREET LIGHT	[Symbol]
TREE/OBSCURED	[Symbol]
HOUSE/STRUCTURE	[Symbol]

EXISTING IMPROVEMENTS

ITEM	SYMBOL
ELECTRICAL LINE	E
STORM DRAIN LINE	SD
WATER LINE	W
RECLAIMED WATER LINE	RW
GAS LINE	G
CABLE TELEVISION LINE	TV
TRAFFIC SIGNAL LINE	TS
TELECOM LINE	T
SEWER LINE	S
FIBER OPTIC LINE	FO
FENCE LINE	[Symbol]
EDGE OF ROAD	[Symbol]
CONTOURS	[Symbol]
EASEMENT LINE	[Symbol]
PROPERTY LINE	[Symbol]
ROW LINE	[Symbol]

DECLARATION OF RESPONSIBLE CHARGE

I HEREBY DECLARE THAT I AM THE ENGINEER OF WORK FOR THIS PROJECT, THAT I HAVE EXERCISED RESPONSIBLE CHARGE OVER THE DESIGN OF THE PROJECT AS DEFINED IN SECTION 8703 OF THE BUSINESS AND PROFESSIONS CODE, AND THAT THE DESIGN IS CONSISTENT WITH CURRENT STANDARDS.

I UNDERSTAND THAT THE CHECK OF PROJECT DRAWINGS AND SPECIFICATIONS BY THE CITY OF SAN DIEGO IS CONFINED TO A REVIEW ONLY AND DOES NOT RELIEVE ME, AS ENGINEER OF WORK, OF MY RESPONSIBILITIES FOR PROJECT DESIGN.

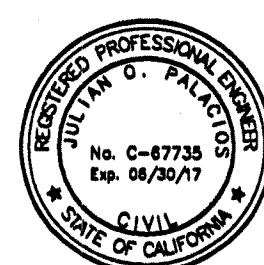

JULIAN O. PALACIOS R.C.E. NO. C-67735 EXP. 8-30-17
DATE 3/29/17

The City of **SAN DIEGO**
DEVELOPMENT SERVICES DEPARTMENT

OWNER/APPLICANT

SDG&E
9305 LIGHTWAVE AVE, SAN DIEGO, CA 92123
(800) 411-7343

REFERENCE DRAWINGS

8" RW PIPELINE PLAN & PROFILE STA 1011+57 TO STA 1021+00.....28211-53-D
PLANS FOR THE IMPR. FOR ACTIVITY ROAD.....17763-3-D
TRADE STREET MIRAMAR POINT INDUSTRIAL PARK UNIT NO. 2.....19367-5-D
STORM DRAIN FOR MIRAMAR POINT INDUSTRIAL PARK UNIT NO. 2.....19367-10-D

SITE ADDRESS

TRADE STREET, SAN DIEGO, CA 92121
ACTIVITY ROAD, SAN DIEGO, CA 92126

BENCHMARK

NWBP NORTHWEST CORNER TRADE PLACE AND TRADE STREET. ELEVATION = 402.71 M.S.L./N.G.V.D. '29.

NOTE: ALL ELEVATIONS SHOWN ON THE PLANS ARE BASED FROM N.A.V.D. '88 DATUM. THE DIFFERENCE BETWEEN N.A.V.D. '88 AND N.G.V.D. '29 IS 2.12 FT.

SHEET INDEX

- 1 - TITLE SHEET
- 2 - NOTES
- 3 - DETAILS
- 4 - IMPROVEMENT PLAN TRADE STREET - STA 1+00 - STA 3+30.86
- 5 - IMPROVEMENT PLAN ACTIVITY ROAD - STA 1+00 - STA 2+07.19
- 6 - EROSION CONTROL PLAN - TRADE STREET
- 7 - EROSION CONTROL PLAN - ACTIVITY ROAD
- T01 - TRAFFIC CONTROL PLANS - SHEET T01 OF T03
- T02 - TRAFFIC CONTROL PLANS - SHEET T02 OF T03
- T03 - TRAFFIC CONTROL PLANS - SHEET T03 OF T03

CONSTRUCTION STORM WATER PROTECTION NOTES

1. TOTAL SITE DISTURBANCE AREA (ACRES): 0.018

HYDROLOGIC UNIT / WATERSHED HYDROLOGIC: PENASQUITOS HYDROLOGIC UNIT.

HYDRAULIC SUB AREA NAME AND NUMBER: N/A

2. THE PROJECT SHALL COMPLY WITH THE REQUIREMENTS OF THE

WPCP

THE PROJECT IS SUBJECT TO MUNICIPAL STORM WATER PERMIT NUMBER R9-2013-0001 AND SUBSEQUENT AMENDMENTS.

SWPPP

THE PROJECT IS SUBJECT TO MUNICIPAL STORM WATER PERMIT NUMBER R9-2013-0001 AND CONSTRUCTION GENERAL PERMIT ORDER NUMBER 2009-009-DWQ AS AMENDED BY ORDER 2010-0014 DWQ AND 2012-0006-DWQ

TRADITIONAL: RISK LEVEL 1 2 3
LUP RISK LEVEL 1 2 3

3. CONSTRUCTION SITE PRIORITY

ASBS HIGH MEDIUM LOW

MOID NO: N/A

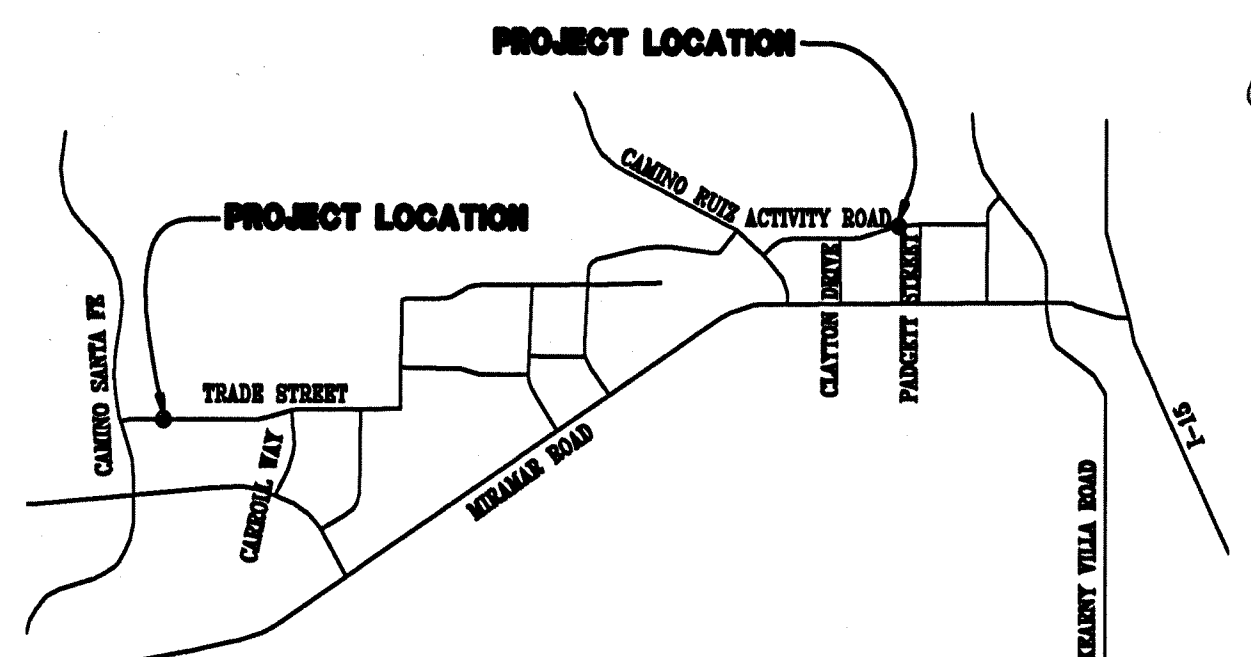

VICINITY MAP

NO SCALE

NIV15

15092 AVENUE OF SCIENCE, SUITE 200
SAN DIEGO, CA 92128
658.388.0800 TEL
658.388.0400 FAX
WWW.NIV5.COM

WORK TO BE DONE

THE IMPROVEMENTS CONSIST OF THE FOLLOWING WORK TO BE DONE ACCORDING TO THESE PLANS AND THE SPECIFICATIONS AND STANDARD DRAWINGS OF THE CITY OF SAN DIEGO.

STANDARD SPECIFICATIONS:

DOCUMENT NO.	DESCRIPTION
PWP070116-01	STANDARD SPECIFICATIONS FOR PUBLIC WORKS CONSTRUCTION (GREENBOOK), 2015 EDITION
PWP070116-02	CITY OF SAN DIEGO STANDARD SPECIFICATIONS FOR PUBLIC WORKS CONSTRUCTION (WHITEBOOK), 2015 EDITION
PWP092816-04	CITYWIDE COMPUTER AIDED DESIGN AND DRAFTING (CADD) STANDARDS
PWP092816-07	CALIFORNIA DEPARTMENT OF TRANSPORTATION MANUAL OF UNIFORM TRAFFIC CONTROL DEVICES, 2014 EDITION
PWP092816-05	CALIFORNIA DEPARTMENT OF TRANSPORTATION U.S. CUSTOMARY STANDARD SPECIFICATIONS, 2015 EDITION
PWP070116-03	CITY OF SAN DIEGO STANDARD DRAWINGS FOR PUBLIC WORKS CONSTRUCTION, 2016 EDITION
PWP092816-06	CALIFORNIA DEPARTMENT OF TRANSPORTATION U.S. CUSTOMARY STANDARD PLANS, 2015 EDITION

LEGEND

PROPOSED IMPROVEMENTS

IMPROVEMENT	STANDARD DWGS	SYMBOL
PROPOSED THRUST BLOCK	SDW-151	[Symbol]
PROPOSED WATER GATE VALVE	SDW-109, SDW-151, SDW-152, SDW-153, WV-04	[Symbol]
PROPOSED WATER PIPE BEDDING AND TRENCH RESURFACING	SDG-107, SDRW-101	[Symbol]
CONCRETE CURB, GUTTER, SIDEWALK, AND PAVEMENT REMOVAL AND REPLACEMENT	SDG-156	[Symbol]
PROPOSED CUTTING AND PLUGGING	WP-03	[Symbol]
PIPE TO BE ABANDONED BY OWNER FOLLOWING CONSTRUCTION		[Symbol]
FIRE HYDRANT RECONNECTION	SDW-104	[Symbol]
FIRE SERVICE CONNECTION AND ASSEMBLY	SDW-118	[Symbol]
AUTOMATIC COMBINATION AIR RELEASE & AIR/VACUUM VALVE INSTALLATIONS	SDW-159	[Symbol]

EXISTING IMPROVEMENTS

ITEM	SYMBOL
WHARF HYDRANT	[Symbol]
WATER VALVE	[Symbol]
WATER/RECLAIMED WATER METER	[Symbol]

ENGINEERING PERMIT NO: _____
DISCRETIONARY PERMIT NO: _____
RETAINING WALL PROJECT NO: _____
CONSTRUCTION SITE STORM WATER PRIORITY: _____

PRIVATE CONTRACT

**TITLE SHEET FOR
UTILITY RELOCATION TRADE
STREET AND ACTIVITY ROAD**

CITY OF SAN DIEGO, CALIFORNIA
DEVELOPMENT SERVICES DEPARTMENT
SHEET 1 OF 7 SHEETS

I.D. NO. 24008833
PROJECT NO. 500372

FOR CITY ENGINEER: [Signature] DATE: 3/29/17
V.T.M.

DESCRIPTION	BY	APPROVED	DATE	FILED
ORIGINAL	NIV5			

AS-BUILTS

CONTRACTOR: _____ DATE STARTED: _____
INSPECTOR: _____ DATE COMPLETED: _____

39559-1D

CONSTRUCTION CHANGE TABLE

CHANGE	DATE	EFFECTED OR ADDED SHEET NUMBERS	APPROVAL NO.	PROJECT NO.

WARNING
0 1/2 1
IF THIS BAR DOES NOT MEASURE 1" THEN DRAWING IS NOT TO SCALE.

CONSTRUCTION BMP GENERAL NOTES

PRIOR TO ANY SOIL DISTURBANCE, TEMPORARY EROSION AND SEDIMENT CONTROL SHALL BE INSTALLED BY THE CONTRACTOR OR QUALIFIED PERSON(S) AS INDICATED BELOW:

- ALL REQUIREMENTS OF THE CITY OF SAN DIEGO "LAND DEVELOPMENT MANUAL, STORM WATER STANDARDS" MUST BE INCORPORATED INTO THE DESIGN AND CONSTRUCTION OF THE PROPOSED GRADING/IMPROVEMENTS CONSISTENT WITH THE APPROVED STORM WATER POLLUTION PREVENTION PLAN (SWPPP) AND/OR WATER POLLUTION CONTROL PLAN (WPCP) FOR CONSTRUCTION LEVEL BMP'S AND, IF APPLICABLE, THE STORM WATER QUALITY MANAGEMENT PLAN (SWQMP) FOR POST CONSTRUCTION TREATMENT CONTROL BMP'S.
- THE CONTRACTOR SHALL INSTALL AND MAINTAIN ALL STORM DRAIN INLETS. INLET PROTECTION IN THE PUBLIC RIGHT OF WAY MAY BE TEMPORARILY REMOVED WHERE IT IS PRONE TO FLOODING PRIOR TO A RAIN EVENT AND REINSTALLED AFTER RAIN IS OVER.
- ALL CONSTRUCTION BMP'S SHALL BE IN PLACE AT THE END OF EACH WORKING DAY WHEN RAIN IS IMMINENT.
- THE CONTRACTOR SHALL ONLY GRADE, INCLUDING CLEARING AND GRUBBING, AREAS FOR WHICH THE CONTRACTOR OR QUALIFIED PERSON CAN PROVIDE EROSION AND SEDIMENT CONTROL MEASURES.
- THE CONTRACTOR IS RESPONSIBLE FOR ENSURING THAT ALL SUB-CONTRACTORS AND SUPPLIERS ARE AWARE OF ALL STORM WATER QUALITY MEASURES AND IMPLEMENT SUCH MEASURES. FAILURE TO COMPLY WITH THE APPROVED SWPPP/WPCP WILL RESULT IN THE ISSUANCE OF CORRECTION NOTICES, CITATIONS, CIVIL PENALTIES AND/OR STOP WORK NOTICES.
- THE CONTRACTOR OR QUALIFIED PERSON SHALL BE RESPONSIBLE FOR CLEANUP OF ALL SILT, DEBRIS AND MUD ON AFFECTED AND ADJACENT STREET(S) AND WITHIN STORM DRAIN SYSTEM DUE TO CONSTRUCTION VEHICLES/EQUIPMENT AND CONSTRUCTION ACTIVITY AT THE END OF EACH WORK DAY.
- THE CONTRACTOR SHALL PROTECT NEW AND EXISTING STORM WATER CONVEYANCE SYSTEMS FROM SEDIMENTATION, CONCRETE RUNSE, OR OTHER CONSTRUCTION RELATED DEBRIS AND DISCHARGES WITH THE APPROPRIATE BMP'S THAT ARE ACCEPTABLE TO THE ENGINEER AND AS INDICATED IN THE SWPPP/WPCP.
- THE CONTRACTOR OR QUALIFIED PERSON SHALL CLEAR DEBRIS, SILT AND MUD FROM ALL DITCHES AND SWALES PRIOR TO AND AFTER EACH RAIN EVENT.
- IF A NON-STORM WATER DISCHARGE LEAVES THE SITE, THE CONTRACTOR SHALL IMMEDIATELY STOP THE ACTIVITY AND REPAIR THE DAMAGES. THE CONTRACTOR SHALL IMMEDIATELY NOTIFY THE ENGINEER OF THE DISCHARGE. AS SOON AS PRACTICAL, ANY AND ALL WASTE MATERIAL, SEDIMENT AND DEBRIS FROM EACH NON STORM WATER DISCHARGE SHALL BE REMOVED FROM THE STORM DRAIN CONVEYANCE SYSTEM AND PROPERLY DISPOSED OF BY THE CONTRACTOR.
- EQUIPMENT AND WORKERS FOR EMERGENCY WORK SHALL BE MADE AVAILABLE AT ALL TIMES. ALL NECESSARY MATERIALS SHALL BE STOCKPILED ON SITE AT CONVENIENT LOCATIONS TO FACILITATE RAPID DEPLOYMENT OF CONSTRUCTION BMP'S WHEN RAIN IS IMMINENT.
- THE CONTRACTOR SHALL RESTORE AND MAINTAIN ALL EROSION AND SEDIMENT CONTROL BMP'S TO WORKING ORDER YEAR ROUND.
- THE CONTRACTOR SHALL INSTALL ADDITIONAL EROSION AND SEDIMENT CONTROL MEASURES DUE TO GRADING INACTIVITY OR UNFORESEEN CIRCUMSTANCES TO PREVENT NON-STORM WATER AND SEDIMENT-LADEN DISCHARGES.
- THE CONTRACTOR SHALL BE RESPONSIBLE AND SHALL TAKE NECESSARY PRECAUTIONS TO PREVENT PUBLIC TRESPASS ONTO AREAS WHERE IMPOUNDED WATERS CREATE A HAZARDOUS CONDITION.
- ALL EROSION AND SEDIMENT CONTROL MEASURES PROVIDED PER THE APPROVED SWPPP/WPCP SHALL BE INSTALLED AND MAINTAINED. ALL EROSION AND SEDIMENT CONTROL FOR INTERIM CONDITIONS SHALL BE PROPERLY DOCUMENTED AND INSTALLED TO THE SATISFACTION OF THE RESIDENT ENGINEER.
- UPON NOTIFICATION BY THE RESIDENT ENGINEER, THE CONTRACTOR SHALL ARRANGE FOR MEETINGS DURING OCTOBER 1ST TO APRIL 30TH FOR PROJECT TEAM (GENERAL CONTRACTOR, QUALIFIED PERSON, EROSION CONTROL SUBCONTRACTOR IF ANY, ENGINEER OF WORK, OWNER/DEVELOPER AND THE RESIDENT ENGINEER) TO EVALUATE THE ADEQUACY OF THE EROSION AND SEDIMENT CONTROL MEASURES AND OTHER BMP'S RELATIVE TO ANTICIPATED CONSTRUCTION ACTIVITIES.
- THE CONTRACTOR SHALL CONDUCT VISUAL INSPECTIONS DAILY AND MAINTAIN ALL BMP'S AS NEEDED. VISUAL INSPECTIONS AND MAINTENANCE OF ALL BMP'S SHALL BE CONDUCTED BEFORE, DURING AND AFTER EVERY RAIN EVENT AND EVERY 24 HOURS DURING ANY PROLONGED RAIN EVENT. THE CONTRACTOR SHALL MAINTAIN AND REPAIR ALL BMP'S AS SOON AS POSSIBLE AS SAFETY ALLOWS.
- CONSTRUCTION ENTRANCE AND EXIT AREA. TEMPORARY CONSTRUCTION ENTRANCE AND EXIT AREA SHALL BE ON LEVEL, STABILIZED GROUND. THE ENTRANCE AND EXIT AREA SHALL BE CONSTRUCTED BY OVERLAYING THE STABILIZED ACCESS AREA WITH 3 TO 6" DIAMETER STONES. THE AREA SHALL BE MINIMUM 50' LONG X 30' WIDE. IN LIEU OF STONE COVERED AREA, THE CONTRACTOR MAY CONSTRUCT RUMBLE RACKS OF STEEL PANELS WITH RIDGES MINIMUM 20' LONG X 30' WIDE CAPABLE OF PREVENTING THE MIGRATION OF CONSTRUCTION MATERIALS INTO THE TRAVELED WAYS.

18. PERFORMANCE STANDARDS. THE CONTRACTOR SHALL BE RESPONSIBLE FOR IMPLEMENTING WATER POLLUTION CONTROL MEASURES BASED ON PERFORMANCE STANDARDS. PERFORMANCE STANDARDS SHALL INCLUDE:
- NON-STORM WATER DISCHARGES FROM THE SITE SHALL NOT OCCUR TO THE MEP'S. STORM WATER DISCHARGES SHALL BE FREE OF POLLUTANTS INCLUDING SEDIMENT TO THE MEP.
 - EROSION SHALL BE CONTROLLED BY ACCEPTABLE BMP'S TO THE MEP. IF RILLS AND GULLIES APPEAR THEY SHALL BE REPAIRED AND ADDITIONAL BMP'S INSTALLED TO PREVENT A REOCCURRENCE OF EROSION.
 - AN INACTIVE AREA SHALL BE PROTECTED TO PREVENT POLLUTANT DISCHARGES. A SITE OR PORTIONS OF A SITE SHALL BE CONSIDERED INACTIVE WHEN CONSTRUCTION ACTIVITIES HAVE CEASED FOR A PERIOD OF 14 OR MORE CONSECUTIVE DAYS.

WATER NOTES

- EACH LOT SHALL RECEIVE A 1-INCH WATER SERVICE, UNLESS INDICATED ON THE PLANS OR SPECIAL SPECIFICATIONS. LOCATIONS ARE TO BE DETERMINED IN THE FIELD BY THE ENGINEER OF WORK. THE "AS-BUILT" LOCATIONS SHALL BE SHOWN ON THESE PLANS AND THE SEWER LATERAL TABLE COMPLETED PRIOR TO ACCEPTANCE OF THE WATER FACILITIES.
- LOCATE WATER SERVICE HOUSE CONNECTIONS OUT OF DRIVEWAYS. THE SEWER HOUSE CONNECTIONS SHALL BE A MINIMUM OF 5 FEET DOWNHILL FROM THE WATER SERVICE.
- ALL CONNECTIONS TO EXISTING WATER MAINS ARE TO BE DONE BY THE CITY'S DEPARTMENT FOR WHICH THE FOLLOWING FEES WILL BE CHARGED. IF THE WATER CONNECTIONS ARE NOT READY TO BE MADE AND THE FEES PAID BEFORE, THE CITY RESERVES THE RIGHT TO ADJUST THE FEES ACCORDING TO THE FEE SCHEDULE IN EFFECT AT THE TIME THE CONNECTIONS ARE MADE. IT IS THE RESPONSIBILITY OF THE CONTRACTOR TO EXPOSE THE EXISTING MAIN AT THE CONNECTION POINT AND TO INSTALL THE NEW MAIN AT THE ALIGNMENT AND GRADE WHICH WILL PERMIT THE CITY TO MAKE A "STRAIGHT-IN" CONNECTION WITHOUT USING MORE THAN 10 LINEAL FEET OF PIPE.

ITEM #:	COST	TYPE OF CONNECTION	SHEET
ITEM #1:	\$2,833	TEMPORARY 8" CUT & PLUG	4
ITEM #2:	\$4,174	8"X8" STRAIGHT-IN CONNECTION	4
ITEM #3:	\$2,833	TEMPORARY 8" CUT & PLUG	4
ITEM #4:	\$4,174	8"X8" STRAIGHT-IN CONNECTION	4
ITEM #5:	\$5,107	TEMPORARY 12" CUT & PLUG	5
ITEM #6:	\$5,691	12"X12" STRAIGHT-IN CONNECTION	5
ITEM #7:	\$5,107	TEMPORARY 12" CUT & PLUG	5
ITEM #8:	\$5,691	12"X12" STRAIGHT-IN CONNECTION	5

CONTRACTOR TO SET SADDLE/TAPPING SLEEVE AND CORPORATION STOP/TAPPING VALVE FOR ALL WET TAPS APPROVAL BY THE SHUTDOWN COMMITTEE IS REQUIRED FOR ALL MAJOR PIPELINES 16" AND LARGER. SHUTDOWN WINDOW PERIOD IS BETWEEN NOVEMBER 1 TILL APRIL 1 OF THE FOLLOWING YEAR, WHEN WATER DEMAND IS LOWER.

- PROVIDING WATER FOR THIS DEVELOPMENT IS DEPENDENT UPON PRIOR CONSTRUCTION OF CERTAIN WATER FACILITIES IN PREVIOUSLY APPROVED DEVELOPMENTS. IF THESE FACILITIES HAVE NOT BEEN CONSTRUCTED AND ACCEPTED BY THE CITY AT THE TIME OF CONNECTION, THEN CERTAIN PORTIONS OF THESE PREVIOUSLY APPROVED OR PLANNED WATER FACILITIES, AS REQUIRED BY THE CITY ENGINEER, WILL BECOME OFF-SITE IMPROVEMENTS AS PART OF THIS DEVELOPMENT. PRIOR TO CONNECTION TO PUBLIC WATER FACILITIES, THESE OFF-SITE IMPROVEMENTS MUST BE CONSTRUCTED AND ACCEPTED BY THE CITY AND DOCUMENTED AS A CONSTRUCTION CHANGE TO THE ORIGINAL APPROVED WATERS FOR THIS DEVELOPMENT. THIS DEVELOPMENT'S WATER FACILITIES ARE DEPENDENT UPON THE COMPLETION AND ACCEPTANCE OF THE FOLLOWING APPROVED WATER FACILITIES:

(TITLE) (DRAWING NUMBER)

- ALL VALVES WILL BE FLANGED TO CROSSES AND TEES. ONLY GATE VALVES SHALL BE USED IN FIRE HYDRANT INSTALLATIONS. ALL BURIED DUCTILE AND GRAY CAST IRON PIPE, FITTINGS, VALVES AND APPURTENANCES SHALL BE COATED WITH A DIELECTRIC COATING: A LIQUID EPOXY COATING SYSTEM PER AWWA C-210 AT 24 MILS MINIMUM DRY FILM THICKNESS (MDF), OR A COLD APPLIED THREE PART SYSTEM PETROLEUM WAX TAPE PER AWWA C-217, OR A 100% POLYURETHANE COATING OF 24 MILS MDF SUITABLE FOR BURIED USE.
- ALL PROPOSED WATER FACILITY INSTALLATIONS SHALL BE CONSTRUCTED WITH MATERIALS CURRENTLY LISTED IN THE MOST CURRENT EDITION OF THE CITY OF SAN DIEGO WATER UTILITIES DEPARTMENT APPROVED MATERIALS LIST AS REFERENCED IN THE STANDARD SPECIFICATIONS FOR PUBLIC WORKS CONSTRUCTION. RECENT REVISIONS INCLUDE BUT IS NOT LIMITED TO THE REQUIREMENT FOR POLYMER CONCRETE WATER METER BOXES INSTEAD OF THE STANDARD PRECAST WATER METER BOXES.
- ALL HORIZONTAL AND VERTICAL SEPARATION DIMENSIONS SHOWN BETWEEN WATER AND SEWER MAINS SHALL BE MEASURED FROM THE NEAREST EDGE OF EACH PIPELINE PER STATE OF CALIFORNIA, DEPARTMENT OF HEALTH SERVICES, BASIC SEPARATION STANDARDS. MINIMUM SEPARATION BETWEEN WATER AND SEWER MAINS SHALL BE 10 FOOT HORIZONTAL AND 1 FOOT VERTICAL.
- ALL EXISTING UNUSED SEWER LATERALS SHALL BE PLUGGED AT THE PROPERTY LINE OR FACE OF SHORING BY CONTRACTOR.
- THE MAJORITY OF THE ONSITE SOIL MATERIALS ARE SUITABLE FOR RE-USE AS TRENCH BACKFILL PROVIDED THEY ARE FREE OF DEBRIS, CLASTS GREATER THAN 3 INCHES IN DIAMETER, AND OTHER DELETERIOUS MATERIALS. BACKFILL SHOULD BE PLACED IN LOOSE LIFTS NOT EXCEEDING 8 INCHES IN THICKNESS AND COMPACTED TO AT LEAST 90 PERCENT OF THE MAXIMUM DRY DENSITY AS EVALUATED BY THE LATEST VERSION OF ASTM D1557. WATER JETTING SHOULD NOT BE USED FOR COMPACTING. IMPORTED BACKFILL SHOULD CONSIST OF GRANULAR, NON-EXPANSIVE SOIL WITH AN EXPANSION INDEX OF 20 OR LESS AND SHOULD NOT CONTAIN ANY CONTAMINATED SOIL, EXPANSIVE SOIL, DEBRIS, ORGANIC MATTER, OR OTHER DELETERIOUS MATERIALS. THE SAND EQUIVALENT OF THE IMPORTED MATERIAL SHALL BE 20 OR GREATER. IMPORT MATERIAL SHOULD BE EVALUATED FOR SUITABILITY BY THE GEOTECHNICAL CONSULTANT PRIOR TO TRANSPORT TO THE SITE.
- COORDINATE CONNECTION AND SHUTDOWNS WITH THE CITY'S WATER DEPARTMENT. CONTRACTOR TO PROVIDE FULL PIPELINE SIZE HIGHLINE DURING SHUTDOWN. HIGHLINE SHALL MEET ALL CONNECTION AND TESTING REQUIREMENTS OF THE CITY OF SAN DIEGO STANDARD SPECIFICATIONS FOR PUBLIC WORKS CONSTRUCTION (WHITEBOOK) 2015 EDITION, SECTIONS 900 AND 901.

SITE DESIGN BMP CHECKLIST FOR STANDARD PROJECTS		FORM I-5	
ALL DEVELOPMENT PROJECTS MUST IMPLEMENT SITE DESIGN BMP'S SD-1 THROUGH SD-8. REFER TO CHAPTER 4 AND APPENDIX E OF THE BMP DESIGN MANUAL FOR INFORMATION TO IMPLEMENT BMP'S SHOWN IN THIS CHECKLIST			
NOTE: ALL SELECTED BMP'S MUST BE SHOWN ON THE CONSTRUCTION PLANS			
SITE DESIGN REQUIREMENT		APPLIED?	
SD-1 MAINTAIN NATURAL DRAINAGE PATHWAYS AND HYDROLOGIC FEATURES	<input type="checkbox"/> YES <input type="checkbox"/> NO <input type="checkbox"/> N/A	<input type="checkbox"/> YES <input type="checkbox"/> NO <input type="checkbox"/> N/A	<input type="checkbox"/> YES <input type="checkbox"/> NO <input type="checkbox"/> N/A
SD-2 CONSERVE NATURAL AREAS, SOILS, AND VEGETATION	<input type="checkbox"/> YES <input type="checkbox"/> NO <input type="checkbox"/> N/A	<input type="checkbox"/> YES <input type="checkbox"/> NO <input type="checkbox"/> N/A	<input type="checkbox"/> YES <input type="checkbox"/> NO <input type="checkbox"/> N/A
SD-3 MINIMIZE IMPERVIOUS AREA	<input type="checkbox"/> YES <input type="checkbox"/> NO <input type="checkbox"/> N/A	<input type="checkbox"/> YES <input type="checkbox"/> NO <input type="checkbox"/> N/A	<input type="checkbox"/> YES <input type="checkbox"/> NO <input type="checkbox"/> N/A
SD-4 MINIMIZE SOIL COMPACTION	<input type="checkbox"/> YES <input type="checkbox"/> NO <input type="checkbox"/> N/A	<input type="checkbox"/> YES <input type="checkbox"/> NO <input type="checkbox"/> N/A	<input type="checkbox"/> YES <input type="checkbox"/> NO <input type="checkbox"/> N/A
SD-5 IMPERVIOUS AREA DISPERSION	<input type="checkbox"/> YES <input type="checkbox"/> NO <input type="checkbox"/> N/A	<input type="checkbox"/> YES <input type="checkbox"/> NO <input type="checkbox"/> N/A	<input type="checkbox"/> YES <input type="checkbox"/> NO <input type="checkbox"/> N/A
SD-6 RUNOFF COLLECTION	<input type="checkbox"/> YES <input type="checkbox"/> NO <input type="checkbox"/> N/A	<input type="checkbox"/> YES <input type="checkbox"/> NO <input type="checkbox"/> N/A	<input type="checkbox"/> YES <input type="checkbox"/> NO <input type="checkbox"/> N/A
SD-7 LANDSCAPING WITH NATIVE OR DROUGHT TOLERANT SPECIES	<input type="checkbox"/> YES <input type="checkbox"/> NO <input type="checkbox"/> N/A	<input type="checkbox"/> YES <input type="checkbox"/> NO <input type="checkbox"/> N/A	<input type="checkbox"/> YES <input type="checkbox"/> NO <input type="checkbox"/> N/A
SD-8 HARVESTING AND USING PRECIPITATION	<input type="checkbox"/> YES <input type="checkbox"/> NO <input type="checkbox"/> N/A	<input type="checkbox"/> YES <input type="checkbox"/> NO <input type="checkbox"/> N/A	<input type="checkbox"/> YES <input type="checkbox"/> NO <input type="checkbox"/> N/A
DISCUSSION / JUSTIFICATION FOR ALL "NO" ANSWERS SHOWN ABOVE:			

SOURCE CONTROL BMP CHECKLIST FOR STANDARD PROJECTS		FORM I-4	
ALL DEVELOPMENT PROJECTS MUST IMPLEMENT SITE DESIGN BMP'S SD-1 THROUGH SD-8. REFER TO CHAPTER 4 AND APPENDIX E OF THE BMP DESIGN MANUAL FOR INFORMATION TO IMPLEMENT BMP'S SHOWN IN THIS CHECKLIST			
NOTE: ALL SELECTED BMP'S MUST BE SHOWN ON THE CONSTRUCTION PLANS			
SOURCE CONTROL REQUIREMENT		APPLIED?	
SC-1 PREVENTION OF ILLICIT DISCHARGES INTO THE MSA	<input type="checkbox"/> YES <input type="checkbox"/> NO <input type="checkbox"/> N/A	<input type="checkbox"/> YES <input type="checkbox"/> NO <input type="checkbox"/> N/A	<input type="checkbox"/> YES <input type="checkbox"/> NO <input type="checkbox"/> N/A
SC-2 STORM DRAIN STENCILING OR SIGNAGE	<input type="checkbox"/> YES <input type="checkbox"/> NO <input type="checkbox"/> N/A	<input type="checkbox"/> YES <input type="checkbox"/> NO <input type="checkbox"/> N/A	<input type="checkbox"/> YES <input type="checkbox"/> NO <input type="checkbox"/> N/A
SC-3 PROTECT OUTDOOR MATERIALS STORAGE AREAS FROM RAINFALL, RUN-ON, RUNOFF, AND WIND DISPERSION	<input type="checkbox"/> YES <input type="checkbox"/> NO <input type="checkbox"/> N/A	<input type="checkbox"/> YES <input type="checkbox"/> NO <input type="checkbox"/> N/A	<input type="checkbox"/> YES <input type="checkbox"/> NO <input type="checkbox"/> N/A
SC-4 PROTECT MATERIALS STORED IN OUTDOOR WORK AREAS FROM RAINFALL, RUN-ON, RUNOFF, AND WIND DISPERSION	<input type="checkbox"/> YES <input type="checkbox"/> NO <input type="checkbox"/> N/A	<input type="checkbox"/> YES <input type="checkbox"/> NO <input type="checkbox"/> N/A	<input type="checkbox"/> YES <input type="checkbox"/> NO <input type="checkbox"/> N/A
SC-5 PROTECT TRASH STORAGE AREAS FROM RAINFALL, RUN-ON, RUNOFF, AND WIND DISPERSION	<input type="checkbox"/> YES <input type="checkbox"/> NO <input type="checkbox"/> N/A	<input type="checkbox"/> YES <input type="checkbox"/> NO <input type="checkbox"/> N/A	<input type="checkbox"/> YES <input type="checkbox"/> NO <input type="checkbox"/> N/A
SC-6 BMP'S BASED ON POTENTIAL SOURCES OF RUNOFF POLLUTANTS	<input type="checkbox"/> YES <input type="checkbox"/> NO <input type="checkbox"/> N/A	<input type="checkbox"/> YES <input type="checkbox"/> NO <input type="checkbox"/> N/A	<input type="checkbox"/> YES <input type="checkbox"/> NO <input type="checkbox"/> N/A
ON-SITE STORM DRAIN INLETS	<input type="checkbox"/> YES <input type="checkbox"/> NO <input type="checkbox"/> N/A	<input type="checkbox"/> YES <input type="checkbox"/> NO <input type="checkbox"/> N/A	<input type="checkbox"/> YES <input type="checkbox"/> NO <input type="checkbox"/> N/A
INTERIOR FLOOR DRAINS AND ELEVATOR SHAFT SUMP PUMPS	<input type="checkbox"/> YES <input type="checkbox"/> NO <input type="checkbox"/> N/A	<input type="checkbox"/> YES <input type="checkbox"/> NO <input type="checkbox"/> N/A	<input type="checkbox"/> YES <input type="checkbox"/> NO <input type="checkbox"/> N/A
INTERIOR PARKING GARAGES	<input type="checkbox"/> YES <input type="checkbox"/> NO <input type="checkbox"/> N/A	<input type="checkbox"/> YES <input type="checkbox"/> NO <input type="checkbox"/> N/A	<input type="checkbox"/> YES <input type="checkbox"/> NO <input type="checkbox"/> N/A
NEED FOR FUTURE INDOOR & STRUCTURAL PEST CONTROL	<input type="checkbox"/> YES <input type="checkbox"/> NO <input type="checkbox"/> N/A	<input type="checkbox"/> YES <input type="checkbox"/> NO <input type="checkbox"/> N/A	<input type="checkbox"/> YES <input type="checkbox"/> NO <input type="checkbox"/> N/A
LANDSCAPE/OUTDOOR PESTICIDE USE	<input type="checkbox"/> YES <input type="checkbox"/> NO <input type="checkbox"/> N/A	<input type="checkbox"/> YES <input type="checkbox"/> NO <input type="checkbox"/> N/A	<input type="checkbox"/> YES <input type="checkbox"/> NO <input type="checkbox"/> N/A
POOLS, SPAS, PONDS, DECORATIVE FOUNTAINS, AND OTHER WATER FEATURES	<input type="checkbox"/> YES <input type="checkbox"/> NO <input type="checkbox"/> N/A	<input type="checkbox"/> YES <input type="checkbox"/> NO <input type="checkbox"/> N/A	<input type="checkbox"/> YES <input type="checkbox"/> NO <input type="checkbox"/> N/A
FOOD SERVICE	<input type="checkbox"/> YES <input type="checkbox"/> NO <input type="checkbox"/> N/A	<input type="checkbox"/> YES <input type="checkbox"/> NO <input type="checkbox"/> N/A	<input type="checkbox"/> YES <input type="checkbox"/> NO <input type="checkbox"/> N/A
REFUSE AREAS	<input type="checkbox"/> YES <input type="checkbox"/> NO <input type="checkbox"/> N/A	<input type="checkbox"/> YES <input type="checkbox"/> NO <input type="checkbox"/> N/A	<input type="checkbox"/> YES <input type="checkbox"/> NO <input type="checkbox"/> N/A
INDUSTRIAL PROCESSES	<input type="checkbox"/> YES <input type="checkbox"/> NO <input type="checkbox"/> N/A	<input type="checkbox"/> YES <input type="checkbox"/> NO <input type="checkbox"/> N/A	<input type="checkbox"/> YES <input type="checkbox"/> NO <input type="checkbox"/> N/A
OUTDOOR STORAGE OF EQUIPMENT OR MATERIALS	<input type="checkbox"/> YES <input type="checkbox"/> NO <input type="checkbox"/> N/A	<input type="checkbox"/> YES <input type="checkbox"/> NO <input type="checkbox"/> N/A	<input type="checkbox"/> YES <input type="checkbox"/> NO <input type="checkbox"/> N/A
VEHICLE/EQUIPMENT REPAIR AND MAINTENANCE	<input type="checkbox"/> YES <input type="checkbox"/> NO <input type="checkbox"/> N/A	<input type="checkbox"/> YES <input type="checkbox"/> NO <input type="checkbox"/> N/A	<input type="checkbox"/> YES <input type="checkbox"/> NO <input type="checkbox"/> N/A
FUEL DISPENSING AREA	<input type="checkbox"/> YES <input type="checkbox"/> NO <input type="checkbox"/> N/A	<input type="checkbox"/> YES <input type="checkbox"/> NO <input type="checkbox"/> N/A	<input type="checkbox"/> YES <input type="checkbox"/> NO <input type="checkbox"/> N/A
LOADING DOCKS	<input type="checkbox"/> YES <input type="checkbox"/> NO <input type="checkbox"/> N/A	<input type="checkbox"/> YES <input type="checkbox"/> NO <input type="checkbox"/> N/A	<input type="checkbox"/> YES <input type="checkbox"/> NO <input type="checkbox"/> N/A
FIRE SPRINKLER TEST WATER	<input type="checkbox"/> YES <input type="checkbox"/> NO <input type="checkbox"/> N/A	<input type="checkbox"/> YES <input type="checkbox"/> NO <input type="checkbox"/> N/A	<input type="checkbox"/> YES <input type="checkbox"/> NO <input type="checkbox"/> N/A
MISCELLANEOUS DRAIN OR WASH WATER	<input type="checkbox"/> YES <input type="checkbox"/> NO <input type="checkbox"/> N/A	<input type="checkbox"/> YES <input type="checkbox"/> NO <input type="checkbox"/> N/A	<input type="checkbox"/> YES <input type="checkbox"/> NO <input type="checkbox"/> N/A
PLAZAS, SIDEWALKS, AND PARKING LOTS	<input type="checkbox"/> YES <input type="checkbox"/> NO <input type="checkbox"/> N/A	<input type="checkbox"/> YES <input type="checkbox"/> NO <input type="checkbox"/> N/A	<input type="checkbox"/> YES <input type="checkbox"/> NO <input type="checkbox"/> N/A
SC-6A: LARGE TRASH GENERATING FACILITIES	<input type="checkbox"/> YES <input type="checkbox"/> NO <input type="checkbox"/> N/A	<input type="checkbox"/> YES <input type="checkbox"/> NO <input type="checkbox"/> N/A	<input type="checkbox"/> YES <input type="checkbox"/> NO <input type="checkbox"/> N/A
SC-6B: ANIMAL FACILITIES	<input type="checkbox"/> YES <input type="checkbox"/> NO <input type="checkbox"/> N/A	<input type="checkbox"/> YES <input type="checkbox"/> NO <input type="checkbox"/> N/A	<input type="checkbox"/> YES <input type="checkbox"/> NO <input type="checkbox"/> N/A
SC-6C: PLANT NURSERIES AND GARDEN CENTERS	<input type="checkbox"/> YES <input type="checkbox"/> NO <input type="checkbox"/> N/A	<input type="checkbox"/> YES <input type="checkbox"/> NO <input type="checkbox"/> N/A	<input type="checkbox"/> YES <input type="checkbox"/> NO <input type="checkbox"/> N/A
SC-6D: AUTOMOTIVE-RELATED USES	<input type="checkbox"/> YES <input type="checkbox"/> NO <input type="checkbox"/> N/A	<input type="checkbox"/> YES <input type="checkbox"/> NO <input type="checkbox"/> N/A	<input type="checkbox"/> YES <input type="checkbox"/> NO <input type="checkbox"/> N/A
DISCUSSION / JUSTIFICATION FOR ALL "NO" ANSWERS SHOWN ABOVE:			

N:\SDB090102.01\CADD\CIVIL\WATER



JULIAN O. PALACIOS R.C.E. NO. C-67735 EXP. 06-30-17

3/28/2017 DATE

NIVIS

15022 AVENUE OF SCIENCE, SUITE 200
SAN DIEGO, CA 92128
658.385.0500 TEL
658.385.0400 FAX
WWW.NIVIS.COM

PRIVATE CONTRACT

NOTES FOR:
UTILITY RELOCATION TRADE STREET AND ACTIVITY ROAD

CITY OF SAN DIEGO, CALIFORNIA
DEVELOPMENT SERVICES DEPARTMENT
SHEET # OF 7 SHEETS

I.O. NO. 24006833
PROJECT NO. 500372

FOR CITY ENGINEER DATE 3/29/17 V.T.M.

DESCRIPTION	BY	APPROVED	DATE	FILED
ORIGINAL	NVS			

AS-BUILTS

CONTRACTOR DATE STARTED
INSPECTOR DATE COMPLETED

1902-6279 NAD83 COORDINATES
262-1719 LAMBERT COORDINATES

39559- 2-D

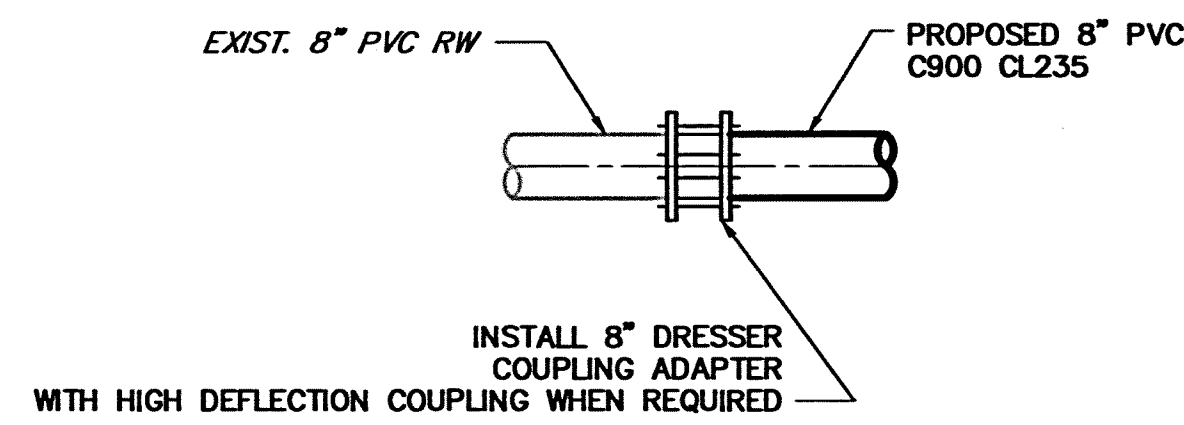

CONNECTION DETAIL
TRADE STREET - STA 1+00 AND
STA 3+31
SCALE: 1/2"=1'-0"

1
4

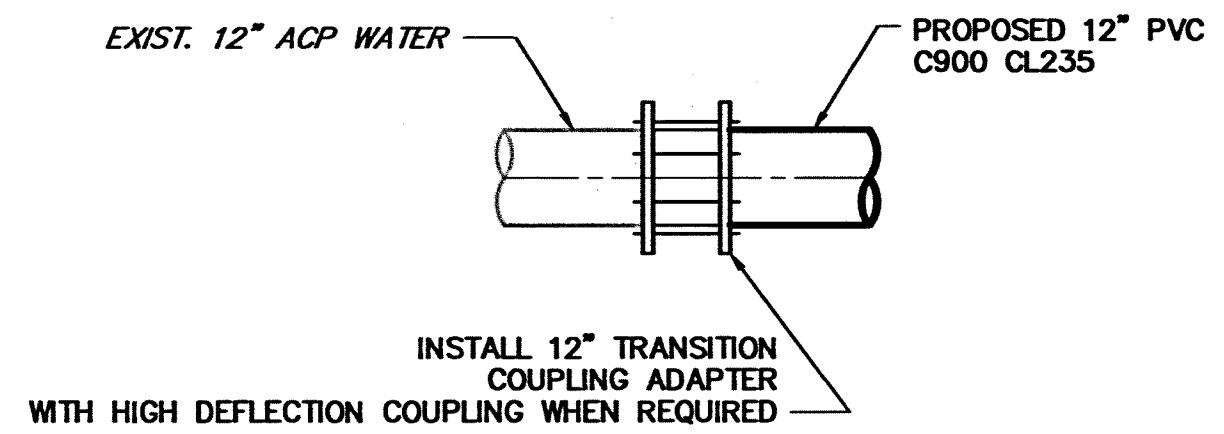

CONNECTION DETAIL
ACTIVITY ROAD - STA 1+00 AND
STA 2+07
SCALE: 1/2"=1'-0"

2
5

THRUST BLOCK SIZING TABLE			
PIPE SIZE (IN)	TB AREA @ 11.25° BEND (TRADE ST) (FT ²)	TB AREA @ 22.5° BEND (ACTIVITY RD) (FT ²)	TB AREA @ TEE (FT ²)
6	1.0	2.1	5.3
8	1.8	3.7	9.4
12	4.2	8.3	21.2

*NOTE: TEE SHALL BE CONCRETE BLOCKED A MINIMUM OF 6" ON ALL THREE SIDES PER STD DWG SDW-151.

THRUST BLOCK SIZING DETAIL

3
TYP

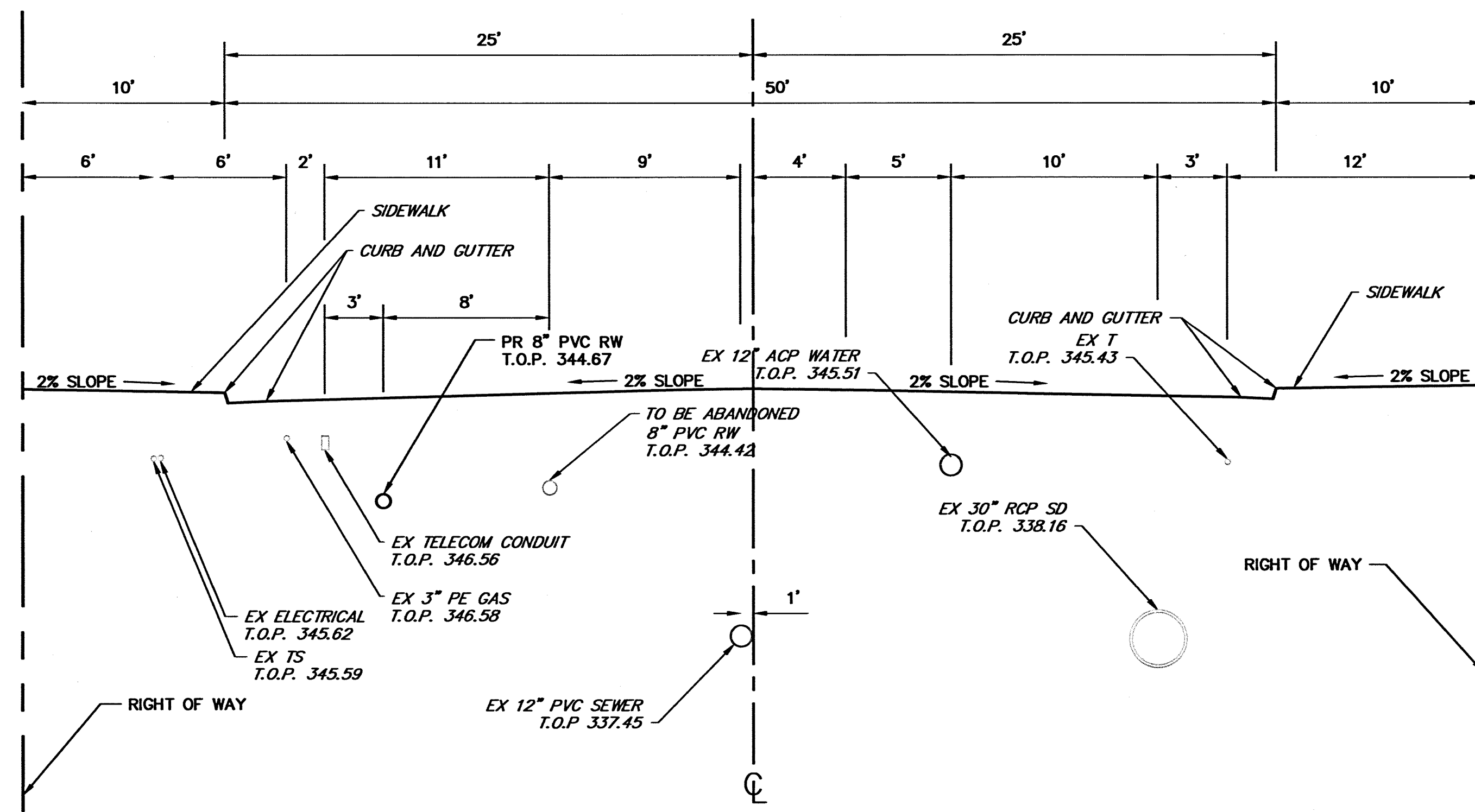

TRADE STREET
SECTION A-A @ STA 2+24
SCALE: 1"=5'

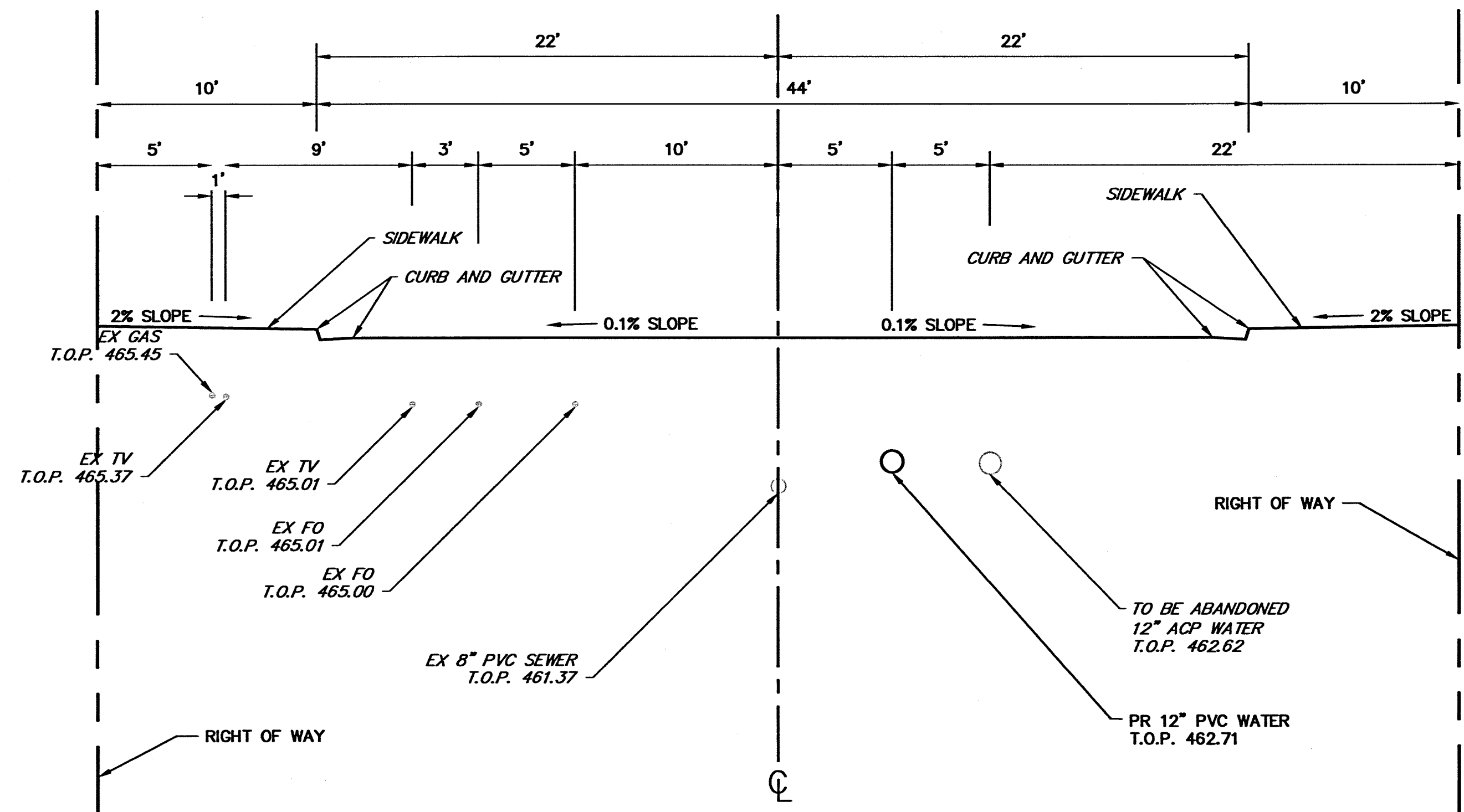

ACTIVITY ROAD
SECTION B-B @ STA 1+49
SCALE: 1"=5'

N:\SDB090102.01\CADD\CIVIL\WATER



JULIAN O. PALACIOS R.C.E. NO. C-67735 EXP. 06-30-17

3/20/2017
DATE

NIVI5

15092 AVENUE OF SCIENCE, SUITE 200
SAN DIEGO, CA 92128
858.385.0500 TEL
858.385.0400 FAX
WWW.NIVI5.COM

PRIVATE CONTRACT				
DETAILS FOR:				
UTILITY RELOCATION TRADE STREET AND ACTIVITY ROAD				
CITY OF SAN DIEGO, CALIFORNIA DEVELOPMENT SERVICES DEPARTMENT SHEET 3 OF 7 SHEETS				I.O. NO. 24006833 PROJECT NO. 500372
FOR CITY ENGINEER				V.T.M.
DESCRIPTION	BY	APPROVED	DATE	FILMED
ORIGINAL	NIV5		3/29/17	
AS-BUILTS				
CONTRACTOR	DATE STARTED			39559-3-D
INSPECTOR	DATE COMPLETED			

1902-6279
NAD83 COORDINATES
262-1719
LAMBERT COORDINATES

INSTALL 231 LF 8" RECLAIMED WATER PVC C900 DR14 HGL = 550 FT

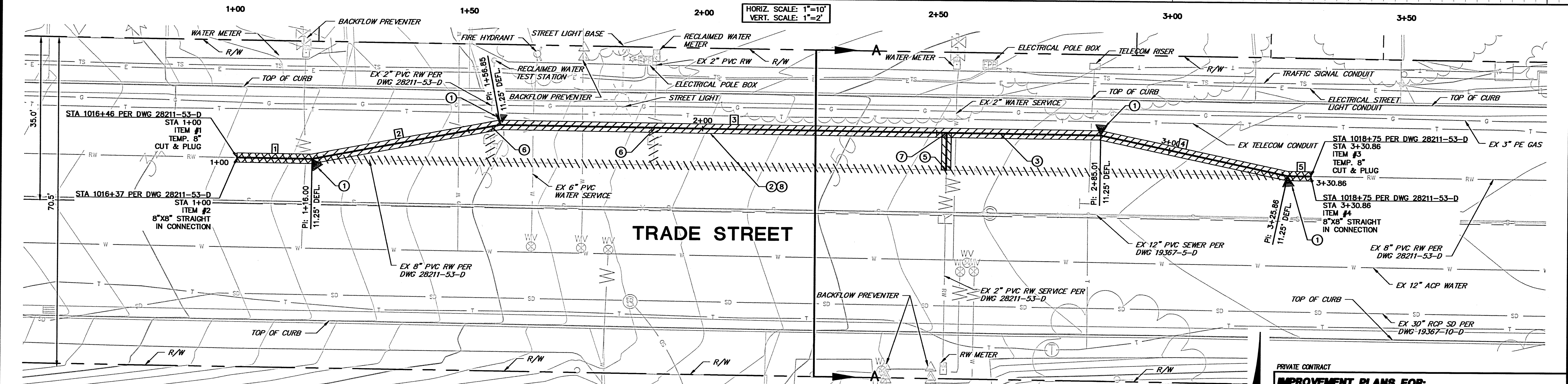
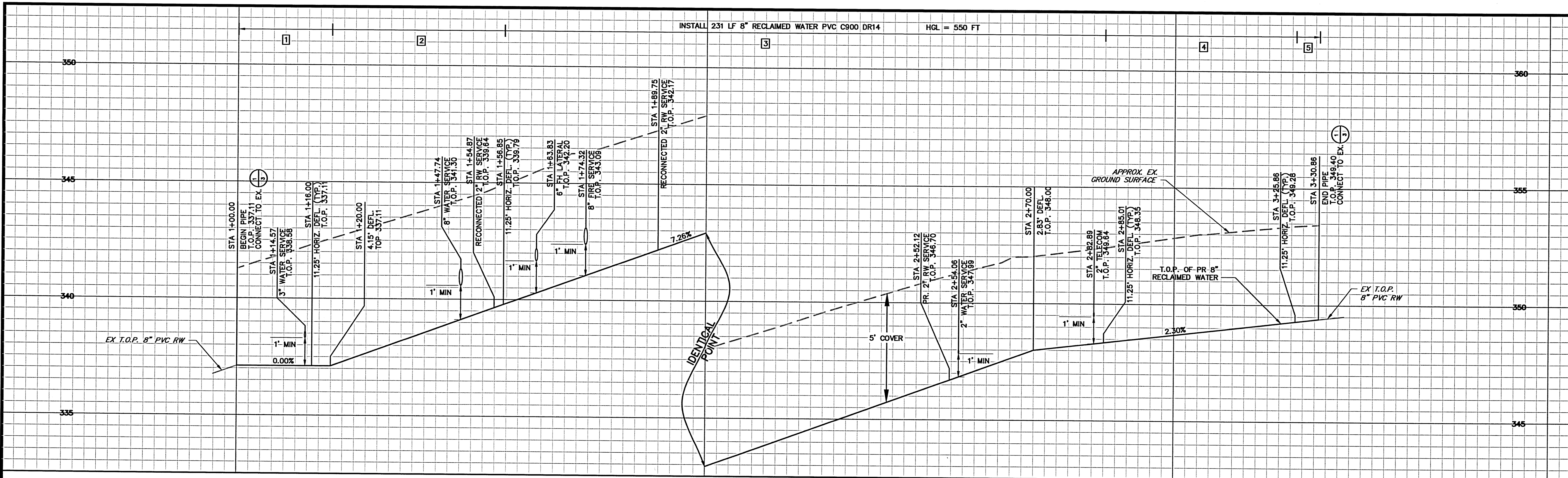

RECLAIMED WATER PIPELINE DATA TABLE					
NO	LENGTH	BEARING	RADIUS	DELTA	Ø, MATERIAL, CLASS
1	16.00'	S89°23'57"E	—	—	8" PVC C900 CL305
2	40.85'	N79°19'23"E	—	—	8" PVC C900 CL305
3	128.16'	S89°25'37"E	—	—	8" PVC C900 CL305
4	40.85'	S78°10'37"E	—	—	8" PVC C900 CL305
5	5.00'	S89°25'37"E	—	—	8" PVC C900 CL305

CONSTRUCTION NOTES

- 1 INSTALL THRUST BLOCK PER STD DWG SDW-151. SEE DETAIL 3, SHEET 3
- 2 TRENCH BEDDING AND BACKFILL PER STD DWG SDRW-101 (SEE NOTE 8 WATER + SEWER NOTES, SHEET 2)
- 3 INSTALL 8" PVC C900 DR14 RECLAIMED WATER PIPE
- 4 COORDINATE CONNECTION AND SHUTDOWNS WITH THE CITY'S WATER DEPARTMENT. CONTRACTOR TO PROVIDE FULL PIPELINE SIZE HIGHLINE DURING SHUTDOWN. HIGHLINE SHALL MEET ALL CONNECTION AND TESTING REQUIREMENTS OF THE CITY OF SAN DIEGO STANDARD SPECIFICATIONS FOR PUBLIC WORKS CONSTRUCTION (WHITEBOOK) 2015 EDITION, SECTIONS 900 AND 901. SEE WATER + SEWER NOTES, SHEET 2.
- 5 EXTEND 2" PVC RW METER LATERAL TO PROPOSED 8" RW PIPELINE (RECONNECT) PER STD SDRW-102
- 6 RECONNECT EXISTING RW SERVICE TO PROPOSED 8" RW PIPELINE PER STD DWG SDRW-102
- 7 INSTALL 2" CORP STOP AND DOUBLE STRAP SERVICE CLAMP PER STD DWG SDRW-102
- 8 RESURFACE TRENCH PER STD DWG SDG-107 TYPE 2 FOR COLLECTOR MIX DESIGN
- 9 ANY DAMAGE TO CURRENT STRIPING AS A RESULT OF THE TRENCHING NEEDS TO BE REPLACED BY THE CONTRACTOR

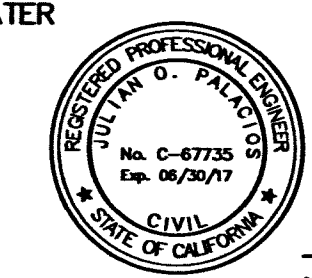

JULIAN O. PALACIOS R.C.E. NO. C-67735 EXP. 06-30-17

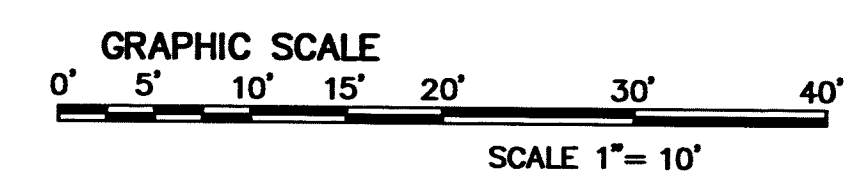

RW MAIN ABANDONMENT			
NO.	SIZE (IN)	TYPE LENGTH (FT)	YEAR INSTALLED
1	8	PVC 230	1998



15092 AVENUE OF SCIENCE, SUITE 200
SAN DIEGO, CA 92128
858.385.0500 TEL
858.385.0400 FAX
WWW.NIV5.COM

PRIVATE CONTRACT

IMPROVEMENT PLANS FOR:

TRADE STREET

BETWEEN CAMINO SANTA FE AND CARROL WAY

CITY OF SAN DIEGO, CALIFORNIA
DEVELOPMENT SERVICES DEPARTMENT
SHEET 4 OF 7 SHEETS

L.O. NO. 24006833
PROJECT NO. 500372

FOR CITY ENGINEER: [Signature] DATE: 3/29/17

DESCRIPTION	BY	APPROVED	DATE	FILED
ORIGINAL	NVS			

AS-BUILTS

CONTRACTOR: [Blank] DATE STARTED: [Blank]
INSPECTOR: [Blank] DATE COMPLETED: [Blank]

1902-6279
NAD83 COORDINATES
262-1719
LAMBERT COORDINATES

39559-4-D

N:\SDB090102\01\CADD\CIVIL\WATER

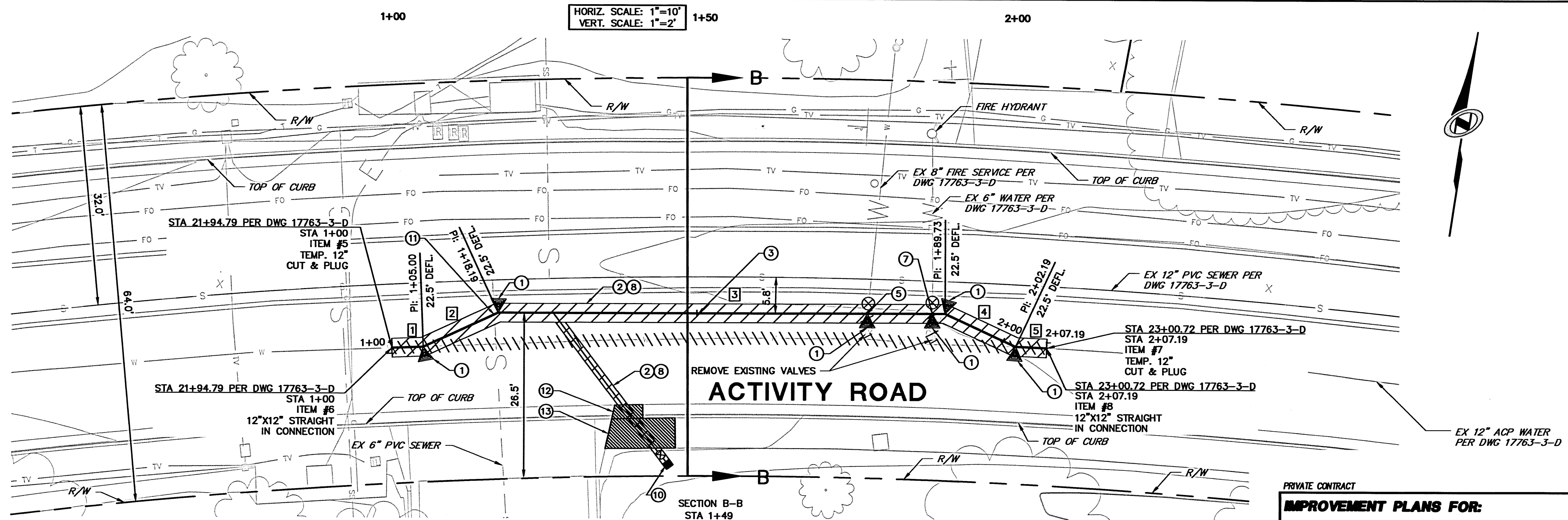
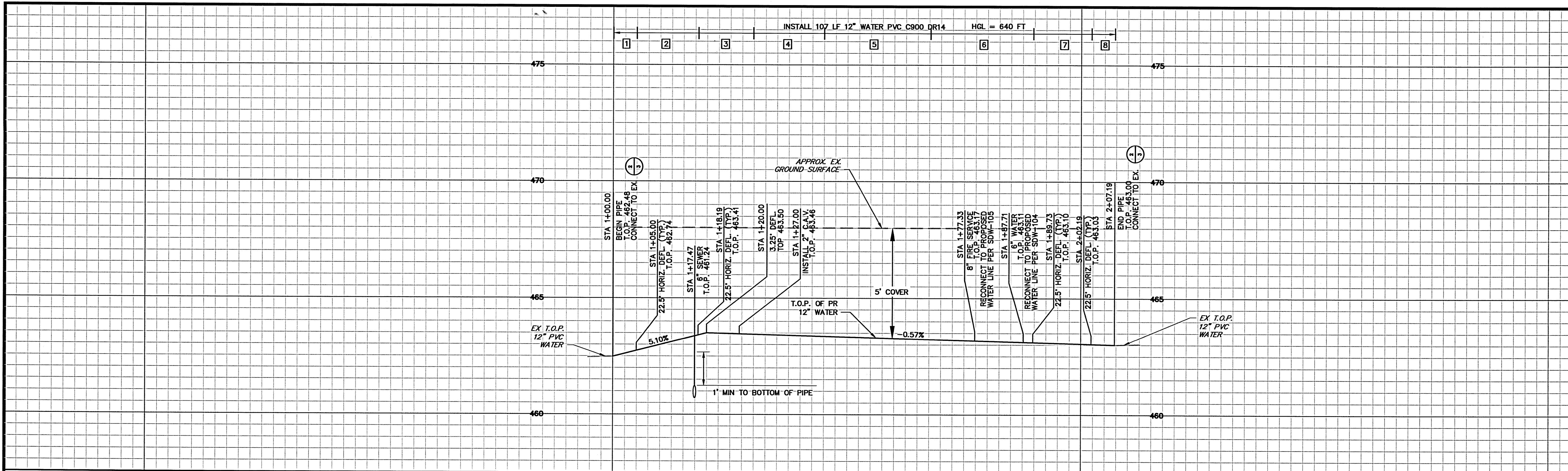

CONSTRUCTION NOTES

- ① INSTALL THRUST BLOCK PER STD DWG SDW-151. SEE DETAIL 3, SHEET 3
- ② TRENCH BEDDING AND BACKFILL PER STD DWG SDW-110 (SEE NOTE 8 WATER + SEWER NOTES, SHEET 2)
- ③ INSTALL 12" PVC C900 DR14 WATER PIPE
- ④ COORDINATE CONNECTION AND SHUTDOWNS WITH THE CITY'S WATER DEPARTMENT. CONTRACTOR TO PROVIDE FULL PIPELINE SIZE HIGHLINE DURING SHUTDOWN. HIGHLINE SHALL MEET ALL CONNECTION AND TESTING REQUIREMENTS OF THE CITY OF SAN DIEGO STANDARD SPECIFICATIONS FOR PUBLIC WORKS CONSTRUCTION (WHITEBOOK) 2015 EDITION, SECTIONS 900 AND 901. SEE WATER + SEWER NOTES, SHEET 2.
- ⑤ RECONNECT EXISTING FIRE SERVICE TO PROPOSED WATER PIPELINE PER STD DWG SDW-118
- ⑥ NOT USED
- ⑦ RECONNECT EXISTING 6" FIRE HYDRANT LATERAL TO PROPOSED WATER PIPELINE PER STD DWG SDW-104
- ⑧ RESURFACE TRENCH PER STD DWG SDG-107 TYPE 2 FOR COLLECTOR MIX DESIGN
- ⑨ ANY DAMAGE TO CURRENT STRIPING AS A RESULT OF THE TRENCHING NEEDS TO BE REPLACED BY THE CONTRACTOR
- ⑩ INSTALL 2" COMBINATION AIR VALVE ASSEMBLY PER STD DWG SDW-159
- ⑪ PROVIDE MINIMUM 1' VERTICAL CLEARANCE BETWEEN BOTTOM OF PROPOSED PIPE AND TOP OF EXISTING SEWER LATERAL
- ⑫ REPLACE CONCRETE CURB AND GUTTER PER STD DWG SDG-156. CONTRACTOR MUST REPLACE CURB AND GUTTER FROM JOINT TO JOINT.
- ⑬ REPLACE CONCRETE SIDEWALK PER STD DWG SDG-156. CONTRACTOR MUST REPLACE EACH ENTIRE SIDEWALK PANEL THAT IS WITHIN THE TRENCH FROM JOINT TO JOINT.

WATER PIPELINE DATA TABLE					
NO	LENGTH	BEARING	RADIUS	DELTA	#, MATERIAL, CLASS
1	5.00'	N79°06'59"E	—	—	12" PVC C900 CL305
2	13.19'	N56°36'10"E	—	—	12" PVC C900 CL305
3	71.54'	N81°19'03"E	—	—	12" PVC C900 CL305
4	12.46'	S73°44'47"E	—	—	12" PVC C900 CL305
5	5.00'	N83°44'08"E	—	—	12" PVC C900 CL305

WATER MAIN ABANDONMENT			
NO.	SIZE (IN)	TYPE	YEAR INSTALLED
1	12	ACP	1984

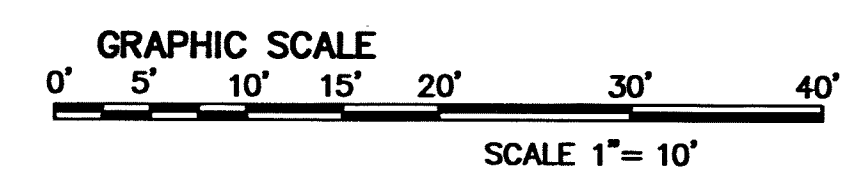

JULIAN O. PALACIOS R.C.E. NO. C-67735 EXP. 09-30-17

3/20/2017 DATE

NIVIS

15092 AVENUE OF SCIENCE, SUITE 200
SAN DIEGO, CA 92128
858.385.0500 TEL
858.385.0400 FAX
WWW.NIVIS.COM

PRIVATE CONTRACT

IMPROVEMENT PLANS FOR:

ACTIVITY ROAD
BETWEEN CLAYTON DRIVE AND PADGETT STREET

CITY OF SAN DIEGO, CALIFORNIA
DEVELOPMENT SERVICES DEPARTMENT
SHEET 5 OF 7 SHEETS

FOR CITY ENGINEER: *[Signature]* DATE: 3/29/17

DESCRIPTION	BY	APPROVED	DATE	FILED
ORIGINAL	KM			

AS-BUILTS

CONTRACTOR: _____ DATE STARTED: _____
INSPECTOR: _____ DATE COMPLETED: _____

I.D. NO. 24006833
PROJECT NO. 500372
V.T.M.
1906-6289
NAD83 COORDINATES
266-1729
LAMBERT COORDINATES

39559- 5-D

N:\SDB090102.01\CADD\CIVIL\WATER

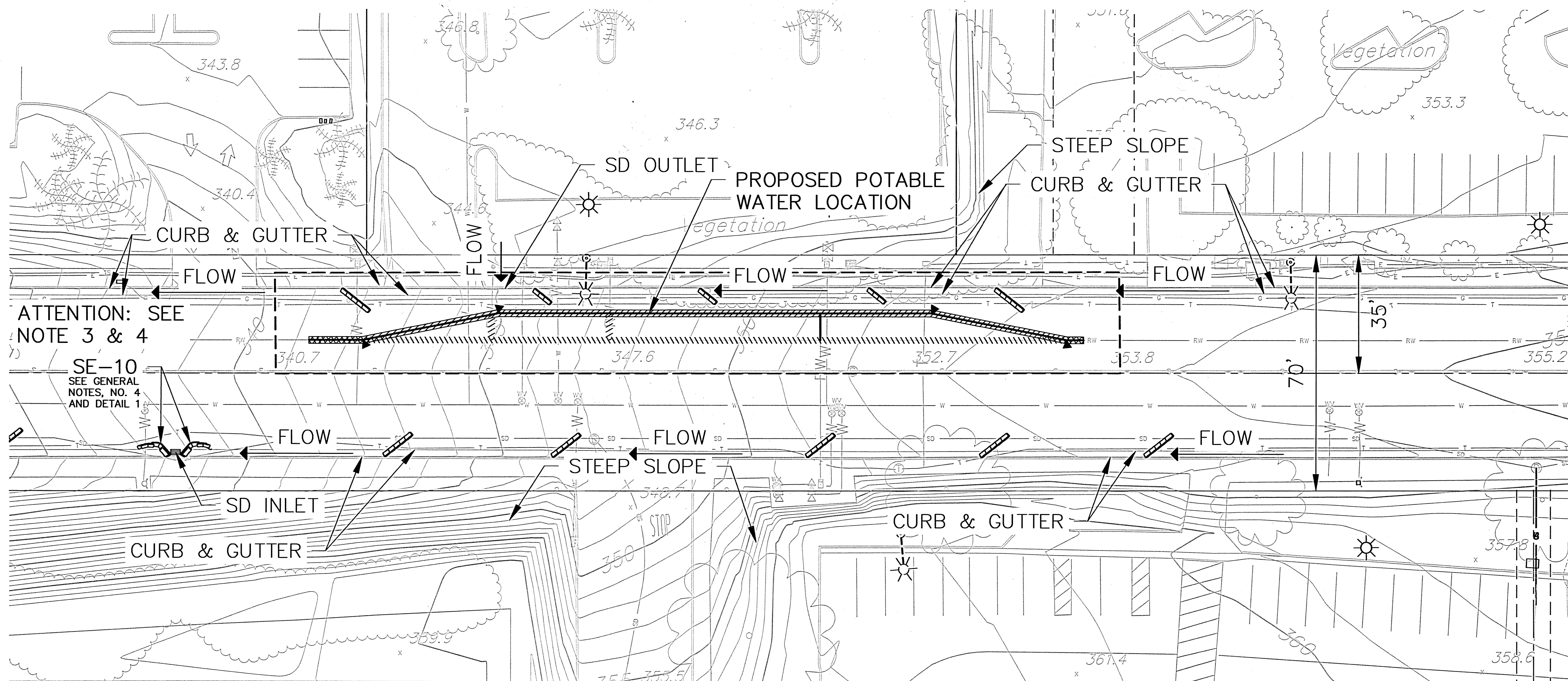

LEGEND

- | | | | |
|--|--|--|--|
| | | | |
| | | | |
| | | | |
| | | | |
| | | | |
| | | | |
| | | | |
| | | | |

TRADE STREET

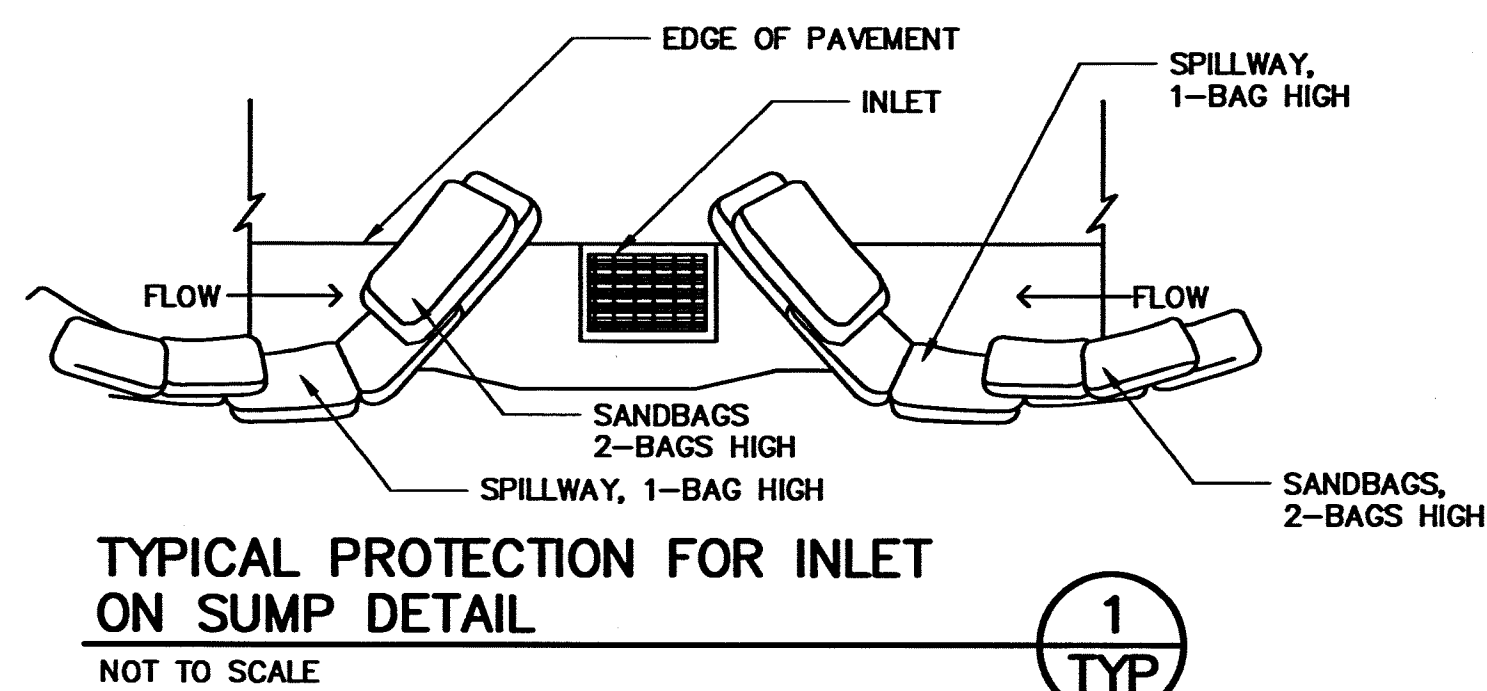
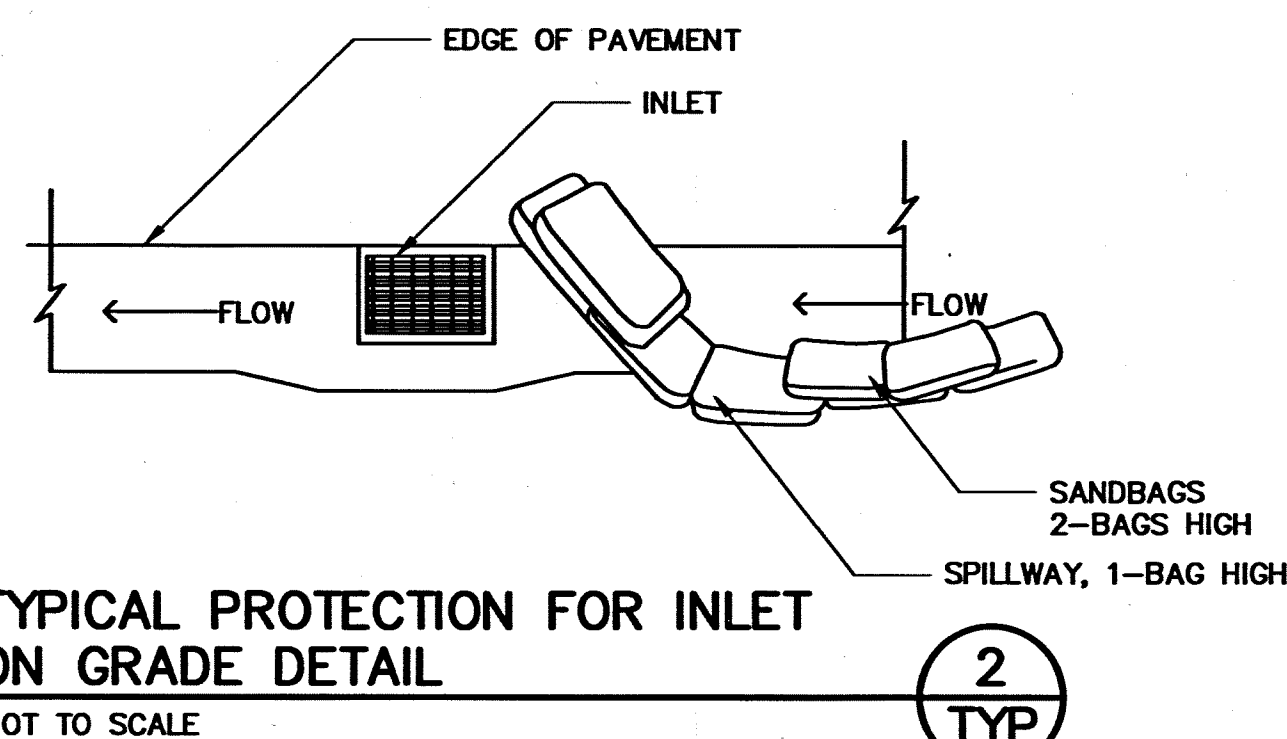

GENERAL NOTES

1. STAGING YARD IS OFF-SITE @ THE CROSS STREETS OF NANCY RIDGE DR AND CARROLL CANYON RD.
2. TRENCHES ARE TO BE COVERED AT THE END OF EACH WORKING DAY.
3. PROTECT STORM DRAIN INLET LOCATED ON THE NORTH EDGE OF PAVEMENT ON TRADE ST. APPROX. LOCATED AT THE INTERSECTION OF TRADE ST AND CAMINO SANTA FE RD. USING SE-10 AND DETAIL 2.
4. SE-10: STORM DRAIN INLET PROTECTION PER CASQA CONSTRUCTION HANDBOOK.

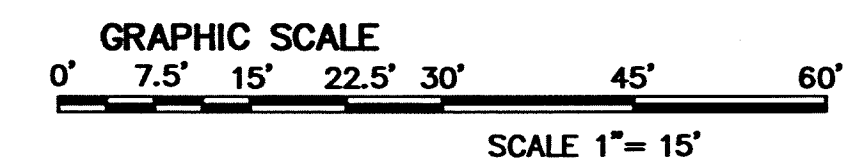

**EROSION CONTROL PLANS FOR:
UTILITY RELOCATION TRADE
STREET AND ACTMITY ROAD**

CITY OF SAN DIEGO, CALIFORNIA DEVELOPMENT SERVICES DEPARTMENT SHEET 6 OF 7 SHEETS				I.O. NO. 24006833 PROJECT NO. 500372
FOR/CITY ENGINEER		DATE 3/29/17		V.T.M.
DESCRIPTION	BY	APPROVED	DATE	FILMED
ORIGINAL	NVS			
AS-BUILTS				NAD83 COORDINATES
CONTRACTOR				LAMBERT COORDINATES
INSPECTOR				39559-6-D
DATE STARTED		DATE COMPLETED		



JULIAN O. PALACIOS R.C.E. NO. C-67735 EXP. 06-30-17

3/26/2017 DATE

NIVI5

15092 AVENUE OF SCIENCE, SUITE 200
SAN DIEGO, CA 92128
858.385.0500 TEL.
858.385.0400 FAX
WWW.NIVI5.COM

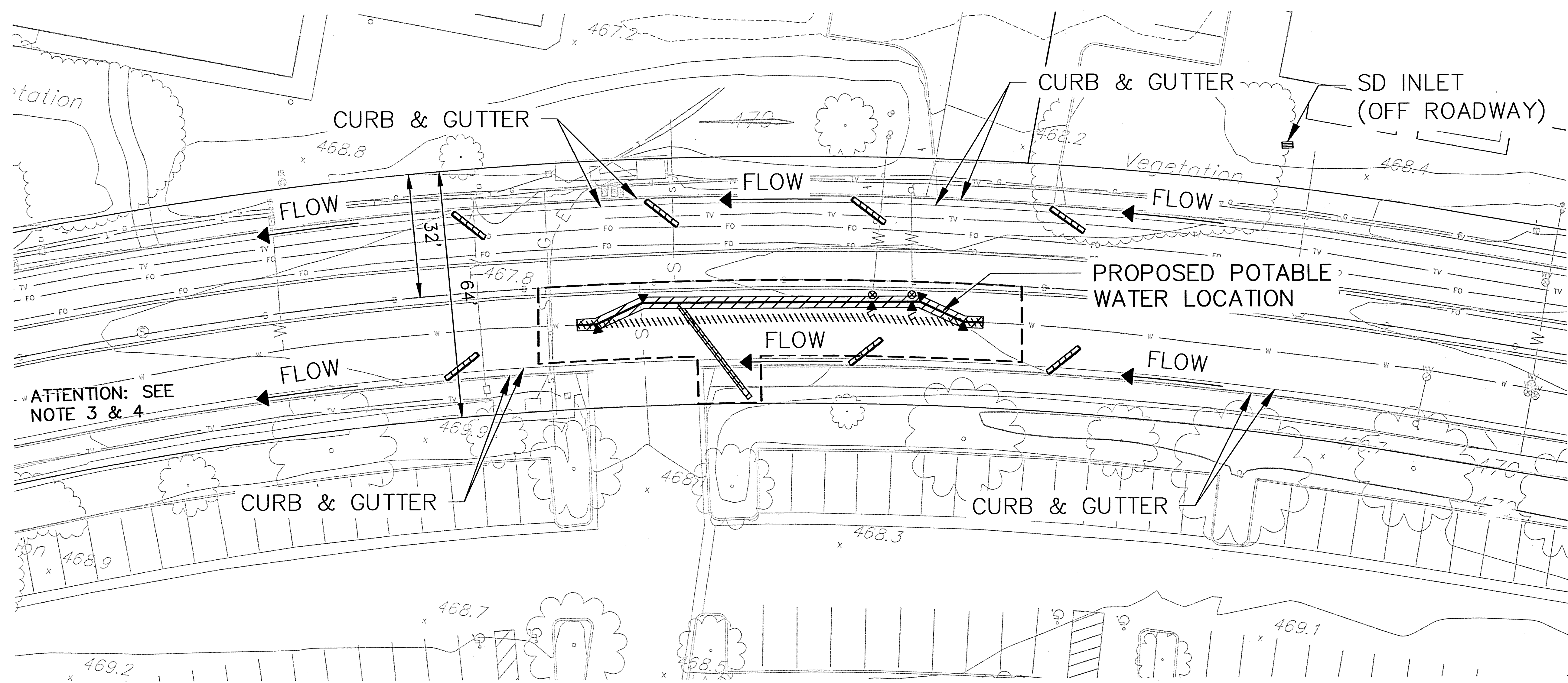

LEGEND

- | | | | | | |
|--|---------------------|----------|-----------------------|--|----------------------------------|
| | BACKFLOW PREVENTER | — RW — | RECLAIMED WATER LINE | | GRAVEL BAGS
2-BAGS HIGH |
| | SEWER MANHOLE | — G — | GAS LINE | | EX. WATERLINE TO
BE ABANDONED |
| | IRRIGATION BOX | — TV — | CABLE TELEVISION LINE | | FLOW DIRECTION |
| | ELECTRICAL POLE BOX | — FO — | FIBER OPTIC LINE | | |
| | STREET LIGHT | — S — | SEWER LINE | | |
| | ELECTRICAL LINE | — — | EDGE OF ROAD | | |
| | STORM DRAIN LINE | — 3160 — | CONTOURS | | |
| | WATER LINE | — — | PROPERTY LINE | | |
| | | | THRUST BLOCK | | |

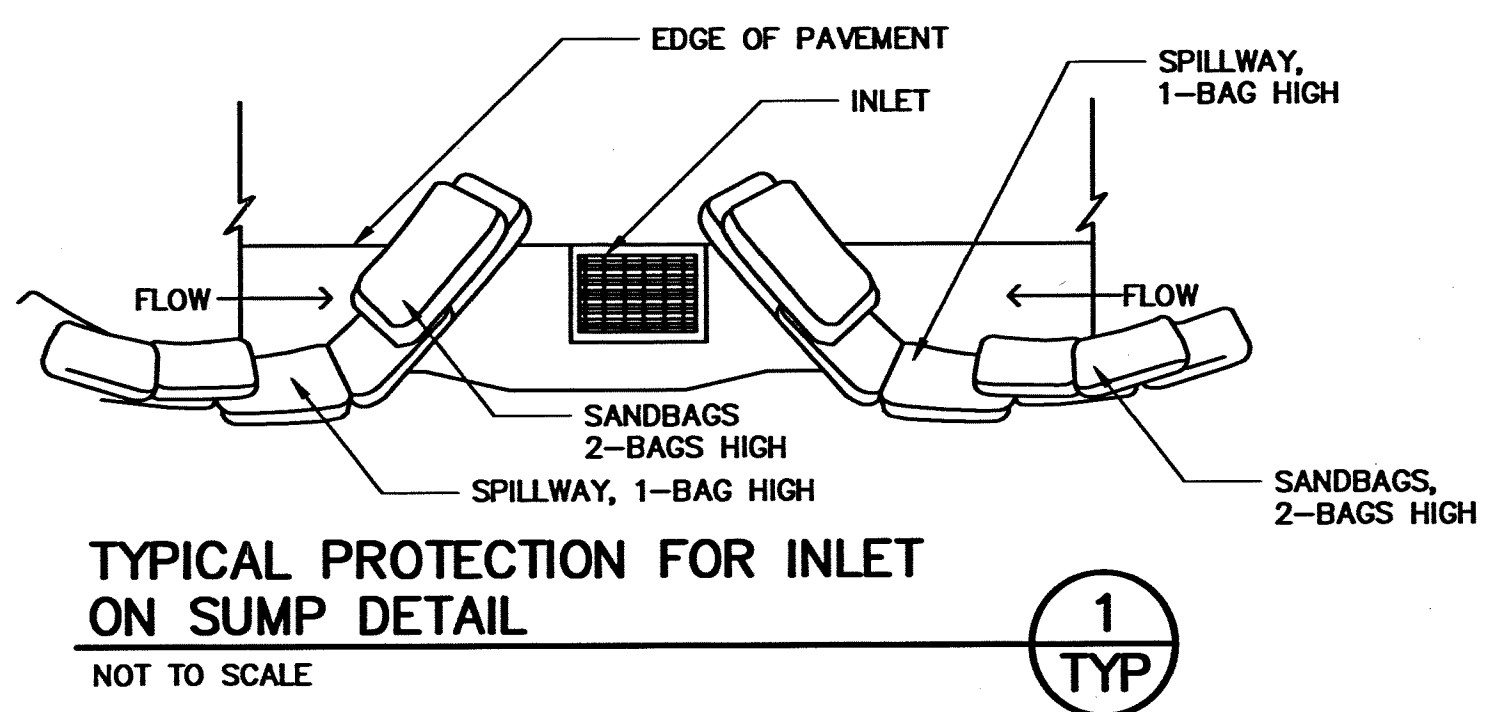

GENERAL NOTES

1. STAGING YARD IS OFF-SITE @ THE CROSS STREETS OF NANCY RIDGE DR AND CARROLL CANYON RD.
2. TRENCHES ARE TO BE COVERED AT THE END OF EACH WORKING DAY.
3. PROTECT STORM DRAIN INLET USING SE-10 (SEE NOTE 4) AND DETAIL 1 TO THE WEST @ THE CROSS STREETS OF ACTIVITY ROAD AND CLAYTON DRIVE (ALONG THE EAST SIDE GUTTER OF CLAYTON DRIVE).
4. SE-10: STORM DRAIN INLET PROTECTION PER CASQA CONSTRUCTION HANDBOOK.

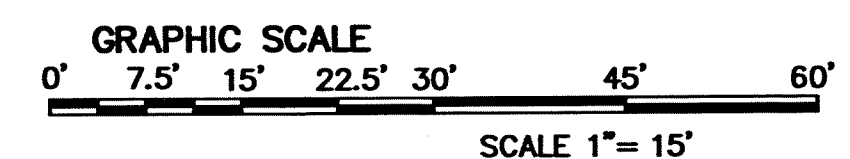

N:\SDB090102.01\CADD\CIVIL\WATER



JULIAN O. PALACIOS R.C.E. NO. C-67735 EXP. 06-30-17

3/26/2017 DATE

NIVIS

15092 AVENUE OF SCIENCE, SUITE 200
SAN DIEGO, CA 92128
858.385.0500 TEL.
858.385.0400 FAX
WWW.NIVIS.COM

PRIVATE CONTRACT			
EROSION CONTROL PLANS FOR: UTILITY RELOCATION TRADE STREET AND ACTMITY ROAD			
CITY OF SAN DIEGO, CALIFORNIA DEVELOPMENT SERVICES DEPARTMENT SHEET 7 OF 7 SHEETS		I.O. NO. 24006833 PROJECT NO. 500372	
FOR CITY ENGINEER		DATE 3/29/17	
DESCRIPTION	BY	APPROVED	DATE FILMED
ORIGINAL	KM		
AS-BUILTS			
CONTRACTOR	DATE STARTED		39559-7-D
INSPECTOR	DATE COMPLETED		
		NAD83 COORDINATES	
		LAMBERT COORDINATES	

TRAFFIC CONTROL NOTES

STREETS WITH ADT OF 5,000 AND OVER

1. VALIDATION: THE TRAFFIC CONTROL PLAN IS NOT VALID UNTIL WORK DATES AND WORK HOURS ARE APPROVED. THE CONTRACTOR SHALL SUBMIT TWO (2) REDUCED COPIES OF TRAFFIC CONTROL PLANS (11"x17") TO THE TRAFFIC CONTROL PERMIT COUNTER, LAND DEVELOPMENT REVIEW DIVISION, 3RD FLOOR DEVELOPMENT SERVICES CENTER, 1222 FIRST AVENUE, SAN DIEGO. THE CONTRACTOR SHALL OBTAIN A TRAFFIC CONTROL PERMIT A MINIMUM OF TWO (2) WORKING DAYS PRIOR TO STARTING WORK, AND A MINIMUM OF FIVE (5) DAYS IF WORK WILL AFFECT A BUS STOP OR AN EXISTING TRAFFIC SIGNAL, OR IF WORK WILL REQUIRE A ROAD OR ALLEY CLOSURE.

2. STANDARDS: THE TRAFFIC CONTROL PLAN SHALL CONFORM TO THE MOST RECENT ADOPTED EDITION OF EACH OF THE FOLLOWING MANUALS:

CITY OF SAN DIEGO STANDARD DRAWINGS, APPENDIX "A"
CALTRANS MANUAL OF TRAFFIC CONTROLS FOR CONSTRUCTION AND MAINTENANCE WORK ZONES
STANDARD SPECIFICATIONS FOR PUBLIC WORKS CONSTRUCTION, INCLUDING THE REGIONAL AND CITY OF SAN DIEGO SUPPLEMENTAL AMENDMENTS.

3. NOTIFICATIONS: THE CONTRACTOR SHALL NOTIFY THE FOLLOWING AGENCIES A MINIMUM OF FIVE (5) WORKING DAYS PRIOR TO ANY EXCAVATION, CONSTRUCTION, OR TRAFFIC CONTROL AFFECTING THE AGENCIES LISTED BELOW:

FIRE DEPARTMENT DISPATCH (STREET OR ALLEY CLOSURE) (858) 573-1300
POLICE DEPARTMENT DISPATCH (STREET OR ALLEY CLOSURE) (619) 531-2000
ENVIRONMENTAL SERVICES (REFUSE COLLECTION) (858) 492-5060
STREET DIVISION (TRAFFIC SIGNALS) (619) 527-7500
SAN DIEGO TRANSIT (BUS STOPS) (619) 239-0100 EXT. 424
UNDERGROUND SERVICE ALERT (ANY EXCAVATION) (800) 422-4133

THE CONTRACTOR SHALL NOTIFY PROPERTY OWNERS AND TENANTS A MINIMUM OF FIVE (5) WORKING DAYS PRIOR TO CLOSURE OF DRIVEWAYS. THE CONTRACTOR SHALL POST SIGNS NOTIFYING THE PUBLIC A MINIMUM OF FIVE (5) WORKING DAYS PRIOR TO CLOSURE OF STREETS.

THE CONTRACTOR SHALL NOTIFY ENGINEERING FIELD DIVISION AT (858) 627-3200 AND ARRANGE FOR INSPECTION A MINIMUM OF FIVE (5) WORKING DAYS PRIOR TO STARTING ANY WORK INVOLVING NIGHTTIME OR WEEKEND HOURS.

4. POSTING PARKING RESTRICTIONS: THE CONTRACTOR SHALL POST TOW-AWAY/NO PARKING SIGNS TWENTY FOUR (24) HOURS IN ADVANCE OF PARKING REMOVAL. SIGNS SHALL INDICATE SPECIFIC DAYS, DATES AND TIMES OF RESTRICTIONS. PARKING METERS SHALL BE BAGGED WHERE APPLICABLE.

5. EXCAVATIONS: EXCEPT WHEN OTHERWISE SHOWN ON THE PLANS, ALL TRENCHES SHALL BE BACKFILLED OR TRENCH-PLATED AT THE END OF EACH WORK DAY. AN ASPHALT RAMP SHALL BE PLACED AROUND EACH TRENCH PLATE TO PREVENT THE PLATE FROM BEING DISLODGED. CONTRACTOR SHALL MONITOR TRENCH PLATES DURING NON-WORKING HOURS TO ENSURE THAT THEY DO NOT BECOME DISLODGED. UPON COMPLETION OF EXCAVATION BACKFILL, THE CONTRACTOR SHALL PROVIDE A SATISFACTORY SURFACE FOR TRAFFIC. WHEN CONSTRUCTION OPERATIONS ARE NOT ACTIVELY IN PROGRESS, THE CONTRACTOR SHALL MAINTAIN ALL TRAVEL LANES, BIKE LANES, AND PEDESTRIAN WALKWAYS IN THE RIGHT-OF-WAY EXCEPT WHEN OTHERWISE SHOWN ON THE PLANS.

6. RESTORATION OF ROADWAY: THE CONTRACTOR SHALL REPAIR OR REPLACE ALL EXISTING IMPROVEMENTS WITHIN THE RIGHT-OF-WAY NOT DESIGNATED FOR PERMANENT REMOVAL (TRAFFIC SIGNS, STRIPING, PAVEMENT MARKERS, PAVEMENT MARKINGS, LEGENDS, CURB MARKINGS, LOOP DETECTORS, TRAFFIC SIGNAL EQUIPMENT, ETC.) WHICH ARE DAMAGED OR REMOVED AS A RESULT OF OPERATIONS. REPAIRS AND REPLACEMENTS SHALL BE AT LEAST EQUAL TO EXISTING IMPROVEMENT.

7. CHANGE IN WORK: THE CITY ENGINEER RESERVES THE RIGHT TO OBSERVE THESE TRAFFIC CONTROL PLANS IN OPERATION AND TO MAKE ANY CHANGES AS FIELD CONDITIONS WARRANT. ANY CHANGES SHALL BE DOCUMENTED AND SUPERSEDE THESE PLANS.

STREETS WITH ADT OF LESS THAN 5,000

THE CONTRACTOR SHALL SUBMIT A TRAFFIC CONTROL PLAN (11"x17") FOR APPROVAL PRIOR TO STARTING WORK. THE PLAN SHOULD BE SUBMITTED TO THE TRAFFIC CONTROL PERMIT COUNTER, 3RD FLOOR, BOOTH 22, LAND DEVELOPMENT REVIEW DIVISION, DEVELOPMENT SERVICES CENTER, 1222 FIRST AVENUE, SAN DIEGO (619-446-5150). CONTRACTOR SHALL OBTAIN A TRAFFIC CONTROL PERMIT A MINIMUM OF TWO (2) WORKING DAYS PRIOR TO STARTING WORK, AND A MINIMUM OF FIVE (5) DAYS IF WORK WILL AFFECT A BUS STOP OR AN EXISTING TRAFFIC SIGNAL, OR IF WORK WILL REQUIRE A ROAD OR ALLEY CLOSURE.

STRIPING & SIGNING GENERAL NOTES

1. INSTALLATION OF ALL STRIPING, SIGNS AND PAVEMENT MARKERS SHALL BE THE RESPONSIBILITY OF THE CONTRACTOR.

2. ALL STRIPING AND SIGNING SHALL CONFORM TO THE MOST RECENTLY ADOPTED EDITION OF THE FOLLOWING MANUALS:

DESCRIPTION	EDITION	DOCUMENT NO.
CITYWIDE COMPUTER AIDED DESIGN AND DRAFTING (CADD) STANDARDS	2016	PWPI092816-04
CALIFORNIA DEPARTMENT OF TRANSPORTATION (CALTRANS) STANDARD SPECIFICATIONS	2015	PWPI092816-05
CALTRANS STANDARD PLANS	2015	PWPI092816-06
CALIFORNIA MANUAL ON UNIFORM TRAFFIC CONTROL DEVICES REVISION 1 (CA MUTCD Rev1)	2014	PWPI092816-07

3. ALL SIGNING AND STRIPING IS SUBJECT TO THE APPROVAL OF THE CITY ENGINEER PRIOR TO INSTALLATION AND/OR REMOVAL.

4. THE CONTRACTOR SHALL REMOVE ALL CONFLICTING STRIPING, PAVEMENT MARKINGS AND LEGENDS BY SANDBLASTING AND/OR GRINDING WITH THE SEAL. ANY DEBRIS SHALL BE PROMPTLY REMOVED BY THE CONTRACTOR.

5. SIGN POSTS SHALL BE INSTALLED WITH SQUARE PERFORATED STEEL TUBING WITH A BREAKAWAY BASE PER CITY OF SAN DIEGO STANDARD DRAWING M-45.

6. ALL RAISED MEDIAN NOSES SHALL BE PAINTED YELLOW.

7. ALL SIGNS SHOWN ON THE STRIPING AND SIGNING PLANS SHALL BE NEW SIGNS PROVIDED AND INSTALLED BY THE CONTRACTOR, EXCEPT FOR EXISTING SIGNS SPECIFICALLY INDICATED TO BE RELOCATED OR TO REMAIN.

8. STRIPED CROSSWALKS SHALL HAVE AN INSIDE DIMENSION OF 10 FEET UNLESS INDICATED OTHERWISE.

9. ALL LIMIT LINES/STOP LINES, CROSSWALK LINES, PAVEMENT LEGENDS, AND ARROWS (EXCEPT WITHIN BIKE LANES) SHALL BE THERMOPLASTIC.

10. THE CONTRACTOR SHALL NOTIFY THE CITY TRAFFIC ENGINEER AT (858) 495-4741 A MINIMUM OF FIVE (5) WORKING DAYS PRIOR TO AND UPON COMPLETION OF STRIPING AND SIGNING.

SIGN LEGEND

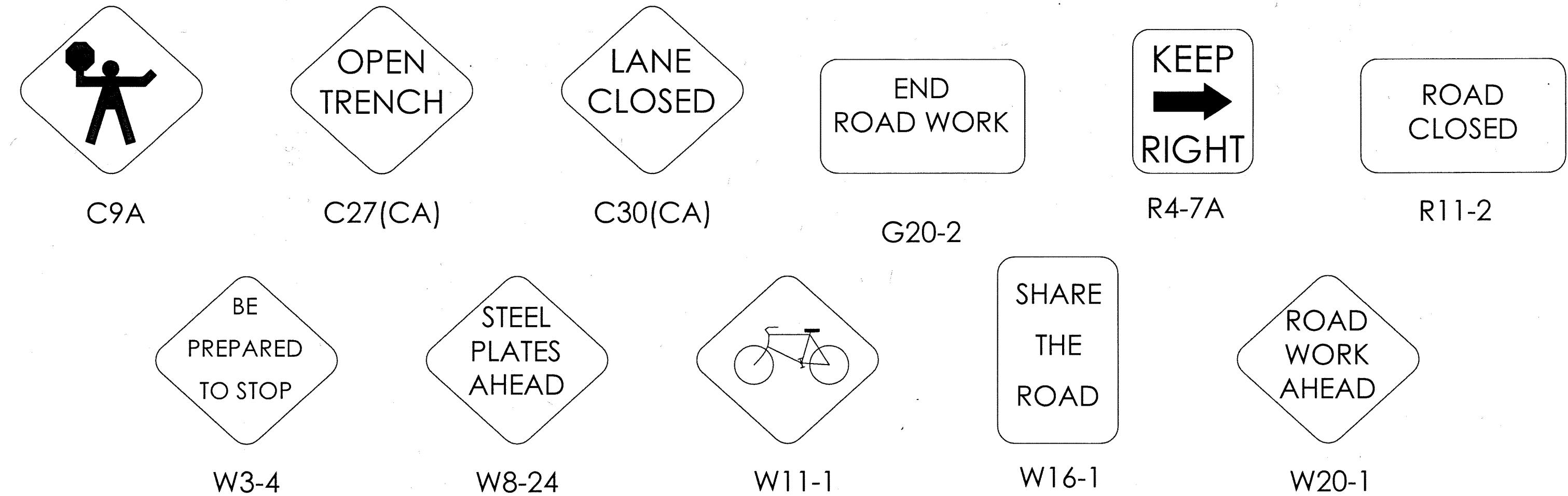

SPEED / DISTANCE TABLES

APPROACH SPEED (MPH)	MINIMUM DISTANCE (FEET) BETWEEN SIGNS AND FROM LAST SIGN TO TAPER	MINIMUM TAPER LENGTHS (L) (FEET) FOR 12-FOOT LANE			BUFFER LENGTH (FEET)	MAX CONE SPACING		
		L	1/2L	1/3L		TAPER	TANGENT	CONFLICT
25	100	125	65	45	155	25	50	12
30	100	180	90	60	200	30	60	15
35	350	245	125	85	250	35	70	17
40	350	320	160	110	305	40	80	20
45	500	540	270	180	360	45	90	22
50	500	600	300	200	425	50	100	25
55+	1000	660	330	220	495	55	110	27

SYMBOL LEGEND

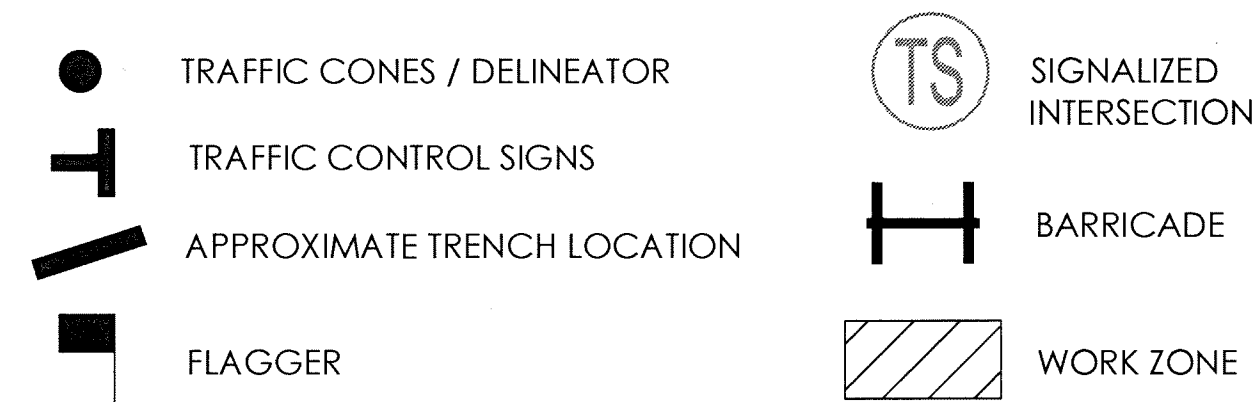

ENGINEER: *[Signature]*
R.C.E. NO. C-46328
EXP. 12-31-2018
DATE 3-20-2017

N|V|5

15092 AVENUE OF SCIENCE, SUITE 200
SAN DIEGO, CA 92128
858.385.0500 TEL
858.385.0400 FAX
WWW.NV5.COM



PRIVATE CONTRACT

**TRAFFIC CONTROL PLANS FOR:
UTILITY RELOCATION
TRADE ST & ACTIVITY RD**

CITY OF SAN DIEGO, CALIFORNIA
DEVELOPMENT SERVICES DEPARTMENT
SHEET 101 OF 103 SHEETS

I.O. NO. 24006833
PROJECT NO. 500372

FOR CITY ENGINEER: *[Signature]* DATE: 3/29/17 V.T.M. _____

DESCRIPTION	BY	APPROVED	DATE	FILMED
ORIGINAL	NVS			

1902-6279
NAD83 COORDINATES

262-1719
LAMBERT COORDINATES

AS-BUILTS

CONTRACTOR: _____ DATE STARTED: _____
INSPECTOR: _____ DATE COMPLETED: _____

39559-T01-D

ACTIVITY ROAD WATER RELOCATION



FLAGGER WILL MAINTAIN DRIVEWAY ACCESS AT ALL TIMES
COORDINATE WITH DRIVEWAY OWNER 48 HOURS PRIOR TO START OF WORK

NOTE: ALL "STEEL PLATES AHEAD" SIGNS (W8-24) SHALL REMAIN IN PLACE UNTIL THE TRAVELED WAY HAS BEEN RESURFACED TO CITY STANDARD SPECIFICATIONS.

TEMPORARY NO PARKING SIGNS WILL BE PLACED 48 HOURS IN ADVANCE

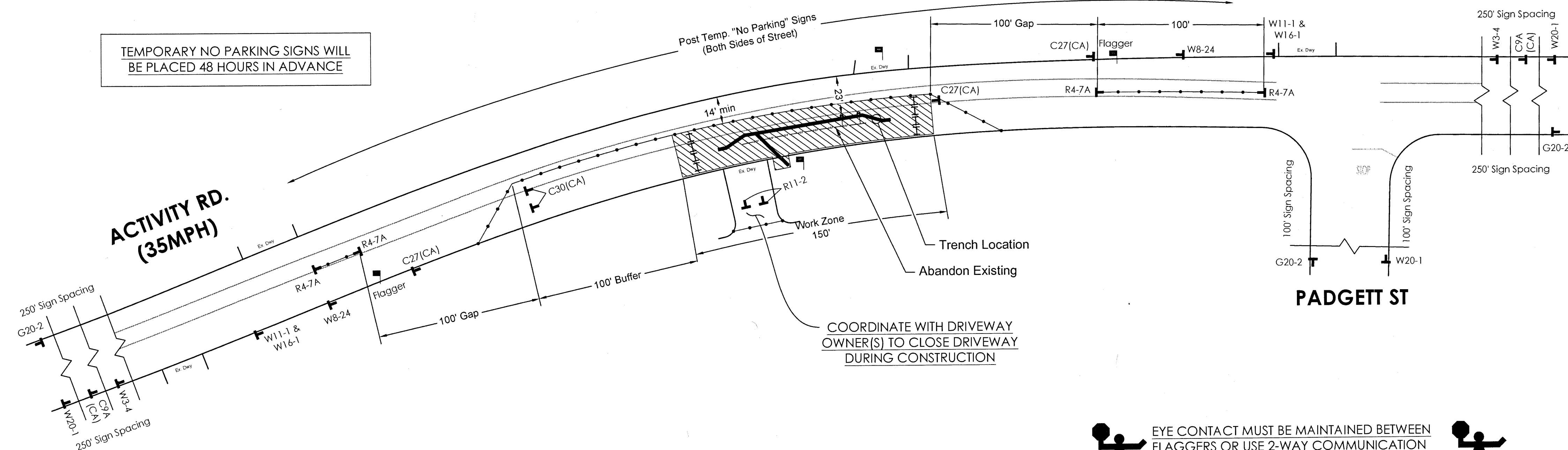

COORDINATE WITH DRIVEWAY OWNER(S) TO CLOSE DRIVEWAY DURING CONSTRUCTION



EYE CONTACT MUST BE MAINTAINED BETWEEN FLAGGERS OR USE 2-WAY COMMUNICATION
FLAGGER WILL ASSIST WITH PEDESTRIAN/BIKE/VEHICLE TRAFFIC AS NEEDED



SIGN LEGEND

C9A	C27(CA)	C30(CA)	G20-2	R4-7A	R11-2
W3-4	W8-24	W11-1	W16-1	W20-1	

SYMBOL LEGEND

	TRAFFIC CONES / DELINEATOR		SIGNALIZED INTERSECTION
	TRAFFIC CONTROL SIGNS		BARRICADE
	APPROXIMATE TRENCH LOCATION		WORK ZONE
	FLAGGER		



PRIVATE CONTRACT

TRAFFIC CONTROL PLANS FOR:

ACTIVITY ROAD

CITY OF SAN DIEGO, CALIFORNIA DEVELOPMENT SERVICES DEPARTMENT SHEET 103 OF 103 SHEETS				I.O. NO. 2408833 PROJECT NO. 500372
FOR CITY ENGINEER	DATE	APPROVED	DATE	V.T.M.
DESCRIPTION	BY	APPROVED	DATE	FILMED
ORIGINAL	NVS			
AS-BUILTS				
CONTRACTOR	DATE STARTED	INSPECTOR	DATE COMPLETED	39559-T03-D

Mark H. Ward 2-96328 12-31-2018 3-20-2017
ENGINEER R.C.E. NO. EXP. DATE

NIVIS
15092 AVENUE OF SCIENCE, SUITE 200
SAN DIEGO, CA 92128
858-385-0500 TEL.
858-385-0400 FAX
WWW.NVS.COM

